

**Application of Pennsylvania-American Water Company for Acquisition of  
the Water Assets of the Steelton Borough Authority**

**66 Pa. C.S. § 1329**

**Application Filing Checklist – Water/Wastewater**

**Docket No. A-2019-\_\_\_\_\_**

22. Other requirements. Demonstrate compliance with the following:
- e. Provide evidence the filing is consistent with the affected municipality and county's comprehensive plans.

**RESPONSE:**

- e. The filing is consistent with the Dauphin County, Borough of Steelton, and Swatara Township Comprehensive Plans as reflected on the enclosed letters from the municipalities. PAWC is awaiting receipt of the Dauphin County responses. See also Direct Testimony of David R. Kaufman, Vice President - Engineering, on behalf of Pennsylvania-American Water Company, PAWC Statement No. 2, at pp. 9-10, enclosed at **Appendix A-14**.

Websites for Comprehensive Plans:

<https://www.dauphincountycompplan.org/>

<http://www.steeltonpa.com/documents/2002-comprehensive-plan/>

[http://lowerswatara.org/documents/LST\\_CompPlan2017\\_w11x17Maps.pdf](http://lowerswatara.org/documents/LST_CompPlan2017_w11x17Maps.pdf)

UNITED STATES POSTAL SERVICE

PA 171  
18 DEC 18



First-Class Mail  
Postage & Fees Paid  
USPS  
Permit No. G-10

• 8  
**Scott Fogelsanger**  
**50 Utley Drive**  
**Suite 100**  
**Camp Hill, PA 17011**



**SENDER: COMPLETE THIS SECTION**

- Complete items 1, 2, and 3. Also complete item 4 if Restricted Delivery is desired.
- Print your name and address on the reverse so that we can return the card to you.
- Attach this card to the back of the mailpiece, or on the front if space permits.

1. Article Addressed to:

John Kerschner, Chairman, AICP  
Dauphin County Planning Commission  
Tri-County Regional Planning Commission  
112 Market Street, 2<sup>nd</sup> Floor  
Harrisburg, PA 17101

**COMPLETE THIS SECTION ON DELIVERY**

A. Signature  Agent  
 Addressee  
*Steven B Deek*

B. Received by (Printed Name) C. Date of Delivery  
*Steven B Deek 12/18/18*

D. Is delivery address different from item 1?  Yes  
 If YES, enter delivery address below:  No

3. Service Type  
 Certified Mail  Express Mail  
 Registered  Return Receipt for Merchandise  
 Insured Mail  C.O.D.

4. Restricted Delivery? (Extra Fee)  Yes

7004 2890 0000 1878 8017



50 Utley Drive  
Suite 100  
Camp Hill, PA 17011  
717-790-3044 Office  
717-875-2282 Cell  
[scott.fogelsanger@amwater.com](mailto:scott.fogelsanger@amwater.com)  
[www.amwater.com](http://www.amwater.com)

VIA Certified Mail

December 14, 2018

John Kerschner, Chairman, AICP  
Dauphin County Planning Commission  
Tri-County Regional Planning Commission  
112 Market Street, 2<sup>nd</sup> Floor  
Harrisburg, PA 17101

Re: Pennsylvania-American Water Company application to acquire the  
Steelton Borough Authority Water System, Dauphin County, Pennsylvania

Dear Mr. Kerschner:

Pennsylvania-American Water Company (Pennsylvania American Water) will soon be submitting an application under Section 1329 of the Pennsylvania Public Utility Commission (PUC) Code, 66 Pa. C.S. § 1329 for the acquisition of Steelton Borough Authority's water treatment, transportation and distribution facilities.

Prior to filing the application, and pursuant to our application filing requirements, we are to request evidence that the filing is consistent with your county's comprehensive plan, specifically our certificated service territory aligns with your Comprehensive Plan and Zoning. I have attached a map identifying the certificated service territory (bold line) for the existing water area for your reference.

Specifically, the PUC requests the County provide a response (yes/no) to the following questions:

1. Are there adopted municipal comprehensive plans for the townships/boroughs involved? \_\_\_\_\_
2. Is there an adopted county comprehensive plan? \_\_\_\_\_
3. Is there an adopted multi-municipal or multi-county comprehensive plan? \_\_\_\_\_
4. Is there an adopted county or municipal zoning ordinance or joint municipal zoning ordinance? \_\_\_\_\_
5. Is the proposed project consistent with these comprehensive plans and/or zoning ordinances? \_\_\_\_\_
6. If the answer is "yes" to any of the above questions, please sign below, or submit a letter, indicating that the application is consistent with the applicable comprehensive plans and zoning ordinances. If not, please provide an explanation.

Would you please review, complete, sign below and return to my attention?

Please feel free to contact me at 717-790-3044 or e-mail at [scott.fogelsanger@amwater.com](mailto:scott.fogelsanger@amwater.com) if you have any additional questions.

If possible, kindly return by December 31, 2018.

Sincerely,



Scott Fogelsanger  
Senior Manager, Business Development

---

Pennsylvania American Water's application is consistent with the applicable comprehensive plans and zoning ordinances.

Dauphin County Signature \_\_\_\_\_

Printed Name/Title \_\_\_\_\_ Date \_\_\_\_\_

Please send/e-mail this form to: Scott Fogelsanger at [scott.fogelsanger@amwater.com](mailto:scott.fogelsanger@amwater.com).



LOWER SWATARA

76

HIGHSPIRE  
LOWER SWATARA

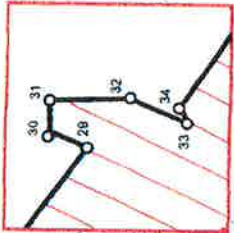

SWATARA

36

Disturb: Bearings and distances were not developed as a result of a physical survey except for through easements of 1843, 1808, 1800 and 1801. Bearings and Distances attached separately.

4,200 Feet

1 inch = 2,100 feet

2,100

0

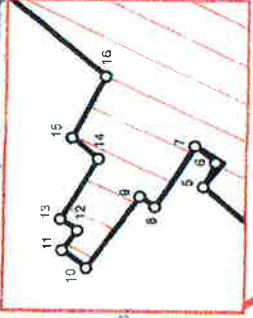

11

13

15

10

12

14

16

8

9

11

13

15

7

8

10

12

14

16

5

6

8

10

12

14

16

4

5

7

9

11

13

15

2

3

5

7

9

11

13

15

17

19

21

23

25

27

29

31

33

35

36

38

40

42

44

46

48

50

52

54

56

58

60

62

64

66

68

70

72

74

76

78

80

82

84

86

88

FAIRVIEW

Pennsylvania-American Water Company  
Mechanicsburg Operating Area  
Proposed Steelton Service Territory  
Approximately 1,453 Acres  
Steelton Borough, Dauphin County



Pennsylvania American Water  
802 Wesley Drive  
Mechanicsburg, PA 17055

Date: 1/26/2014

○ Bearings and Distance Points  
Applied For Service Territory  
Municipality

TO BE USED FOR REFERENCE ONLY  
This document is not intended to be used for any other purpose.  
It is the responsibility of the user to verify the accuracy of the information provided.



UNITED STATES POSTAL SERVICE



First-Class Mail  
Postage & Fees Paid  
USPS  
Permit No. G-10

Scott Fogelsanger  
50 Utley Drive  
Suite 100  
Camp Hill, PA 17011

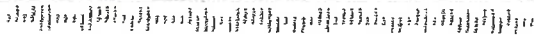

**SENDER: COMPLETE THIS SECTION**

- Complete items 1, 2, and 3. Also complete item 4 if Restricted Delivery is desired.
- Print your name and address on the reverse so that we can return the card to you.
- Attach this card to the back of the mailpiece, or on the front if space permits.

1. Article Addressed to:

Brian Proctor, Council President  
Borough of Steelton  
Steelton Borough Hall  
123 North Front Street  
Steelton, PA 17113

**COMPLETE THIS SECTION ON DELIVERY**

A. Signature  Agent  
 Addressee

B. Received by (Printed Name) C. Date of Delivery

D. Is delivery address different from item 1?  Yes  
If YES, enter delivery address below:  No

3. Service Type  
 Certified Mail  Express Mail  
 Registered  Return Receipt for Merchandise  
 Insured Mail  C.O.D.

4. Restricted Delivery? (Extra Fee)  Yes

7004 2890 0000 1878 8024



50 Utley Drive  
Suite 100  
Camp Hill, PA 17011  
717-790-3044 Office  
717-875-2282 Cell  
[scott.fogelsanger@amwater.com](mailto:scott.fogelsanger@amwater.com)  
[www.amwater.com](http://www.amwater.com)

VIA Certified Mail

December 14, 2018

Brian Proctor  
Council President  
Borough of Steelton  
Steelton Borough Hall  
123 North Front Street  
Steelton, PA 17113

Re: Pennsylvania-American Water Company application to acquire the  
Steelton Borough Authority Water System, Dauphin County, Pennsylvania

Dear Mr. Proctor:

Pennsylvania-American Water Company (Pennsylvania American Water) will soon be submitting an application under Section 1329 of the Pennsylvania Public Utility Commission (PUC) Code, 66 Pa. C.S. § 1329 for the acquisition of Steelton Borough Authority's water treatment, transportation and distribution facilities.

Prior to filing the application, and pursuant to our application filing requirements, we are to request evidence that the filing is consistent with your municipality's comprehensive plan. I have attached a map identifying the certificated service territory for the existing water area for your reference.

Specifically, the PUC requests that the Borough review the following questions:

1. Are there adopted municipal comprehensive plans for the townships/boroughs involved? Yx
2. Is there an adopted county comprehensive plan? Yx
3. Is there an adopted multi-municipal or multi-county comprehensive plan? Yx
4. Is there an adopted county or municipal zoning ordinance or joint municipal zoning ordinance? Yx
5. Is the proposed project consistent with these comprehensive plans and/or zoning ordinances? Yx
6. If the answer is "yes" to any of the above questions, please sign below, or submit a letter, indicating that the application is consistent with the applicable comprehensive plans and zoning ordinances. If not, please provide an explanation.

Please feel free to contact me at 717-790-3044 or e-mail [scott.fogelsanger@amwater.com](mailto:scott.fogelsanger@amwater.com) if you have any additional questions.

If possible, kindly return by December 31, 2018.

Sincerely,



Scott Fogelsanger  
Senior Manager, Business Development

---

Pennsylvania American Water's application is consistent with the applicable comprehensive plans and zoning ordinances.

Borough of Steelton Signature



Printed Name/Title

BRIAN D. PROCTOR / PRESIDENT

Date

12/29/18

Please e-mail this form to: Scott Fogelsanger at [scott.fogelsanger@amwater.com](mailto:scott.fogelsanger@amwater.com).



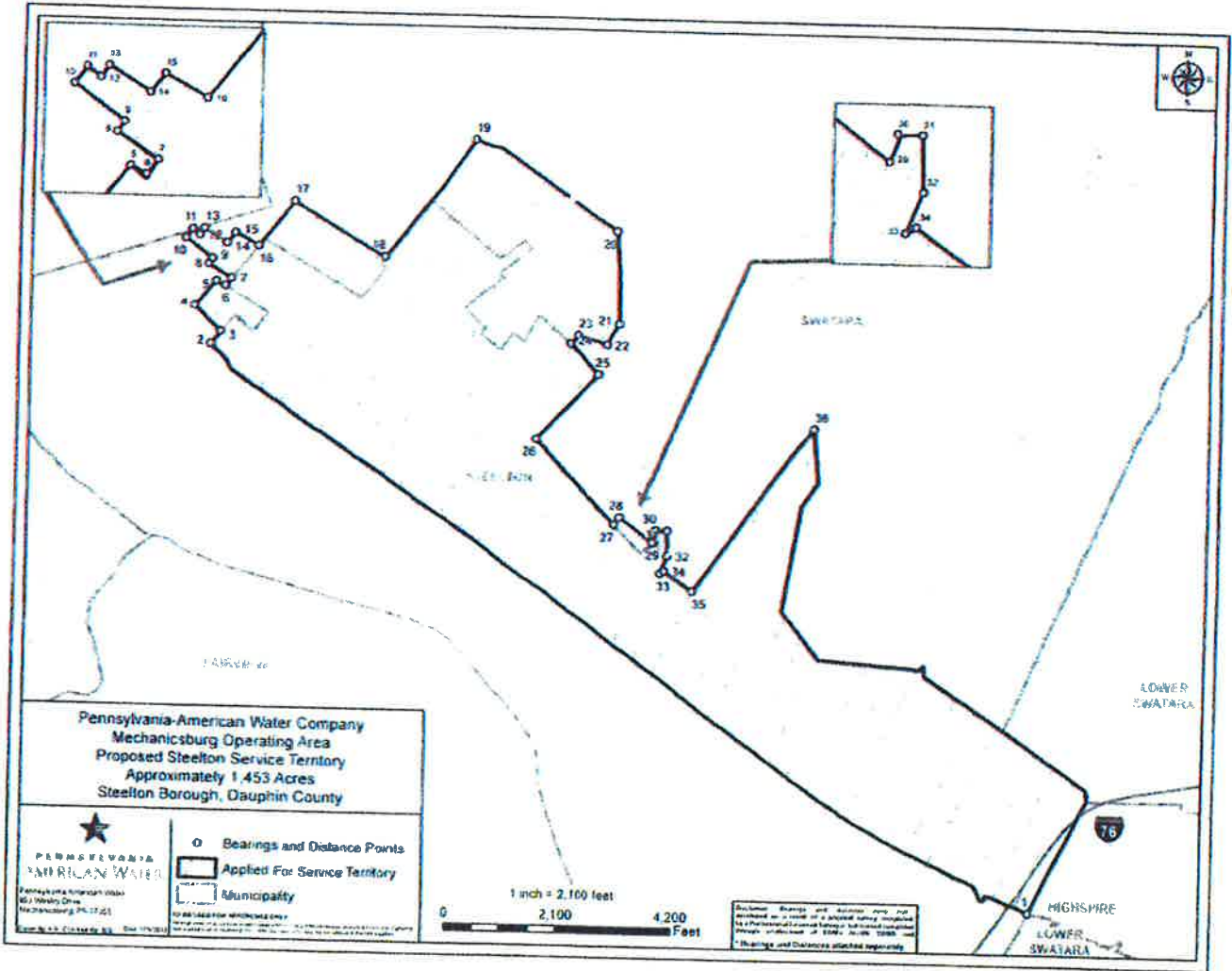

Pennsylvania-American Water Company  
 Mechanicsburg Operating Area  
 Proposed Steelton Service Territory  
 Approximately 1,453 Acres  
 Steelton Borough, Dauphin County

**★**  
 PENNSYLVANIA  
 AMERICAN WATER  
 Pennsylvania American Water  
 601 Walnut Drive  
 Mechanicsburg, PA 17251  
 Date: 11/17/2011

○ Bearings and Distance Points  
 Applied For Service Territory  
 Municipality

1 inch = 2,100 feet  
 0 2,100 4,200  
 Feet

Beatings, bearings and distance points not included on a record as a platting survey completed by a Professional Land Surveyor but instead compiled through verification of 1886, 1898, 1928, and 1954 bearings and distances attached hereto.

UNITED STATES POSTAL SERVICE



First-Class Mail  
Postage & Fees Paid  
USPS  
Permit No. G-10

• Sen

Scott Fogelsanger  
50 Utley Drive  
Suite 100  
Camp Hill, PA 17011

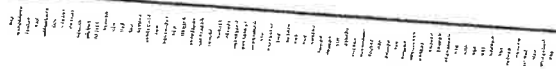

**SENDER: COMPLETE THIS SECTION**

- Complete items 1, 2, and 3. Also complete item 4 if Restricted Delivery is desired.
- Print your name and address on the reverse so that we can return the card to you.
- Attach this card to the back of the mailpiece, or on the front if space permits.

1. Article Addressed to:

Robert E. Ihlein, Director of Planning and Zoning  
Township of Swatara  
Planning Commission  
599 Eisenhower Boulevard  
Harrisburg, PA 17111

**COMPLETE THIS SECTION ON DELIVERY**

A. Signature  Agent  
*Scott Fogelsanger*  Addressee

B. Received by (Printed Name) C. Date of Delivery  
*Brittany Jarvinen Day*

D. Is delivery address different from item 1?  Yes  
If YES, enter delivery address below:  No

3. Service Type  
 Certified Mail  Express Mail  
 Registered  Return Receipt for Merchandise  
 Insured Mail  C.O.D.

4. Restricted Delivery? (Extra Fee)  Yes

2. 7004 2890 0000 1878 8000



PENNSYLVANIA  
AMERICAN WATER

50 Utley Drive  
Suite 100  
Camp Hill, PA 17011  
717-790-3044 Office  
717-875-2282 Cell  
[scott.fogelsanger@amwater.com](mailto:scott.fogelsanger@amwater.com)  
[www.amwater.com](http://www.amwater.com)

VIA Certified Mail

December 14, 2018

Robert E. Ihlein, Director of Planning and Zoning  
Township of Swatara  
Planning Commission  
599 Eisenhower Boulevard  
Harrisburg, PA 17111

Re: Pennsylvania-American Water Company application to acquire the  
Steelton Borough Authority Water System, Dauphin County, Pennsylvania

Dear Mr. Ihlein:

Pennsylvania-American Water Company (Pennsylvania American Water) will soon be submitting an application under Section 1329 of the Pennsylvania Public Utility Commission (PUC) Code, 66 Pa. C.S. § 1329 for the acquisition of Steelton Borough Authority's water treatment, transportation and distribution facilities.

Prior to filing the application, and pursuant to our application filing requirements, we are to request evidence that the filing is consistent with your municipality's comprehensive plan. I have attached a map identifying the certificated service territory for the existing water area for your reference.

Specifically, the PUC requests that the Township review the following questions:

1. Are there adopted municipal comprehensive plans for the townships/boroughs involved? YES
2. Is there an adopted county comprehensive plan? YES
3. Is there an adopted multi-municipal or multi-county comprehensive plan? NO
4. Is there an adopted county or municipal zoning ordinance or joint municipal zoning ordinance? YES
5. Is the proposed project consistent with these comprehensive plans and/or zoning ordinances? YES
6. If the answer is "yes" to any of the above questions, please sign below, or submit a letter, indicating that the application is consistent with the applicable comprehensive plans and zoning ordinances. If not, please provide an explanation.

Please feel free to contact me at 717-790-3044 or e-mail [scott.fogelsanger@amwater.com](mailto:scott.fogelsanger@amwater.com) if you have any additional questions.

If possible, kindly return by December 31, 2018.

Sincerely,

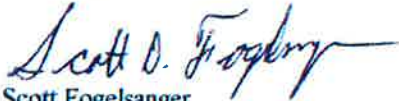

Scott Fogelsanger  
Senior Manager, Business Development

---

Pennsylvania American Water's application is consistent with the applicable comprehensive plans and zoning ordinances.

Township of Swatara Signature Robert E. Ahlein

Printed Name/Title ROBERT E. AHLEIN, DIRECTOR OF PLANNING & ZONING, SWATARA TOWNSHIP Date DEC-27, 2018

Please e-mail this form to: Scott Fogelsanger at [scott.fogelsanger@amwater.com](mailto:scott.fogelsanger@amwater.com).





LOWER SWATARA

HIGHSPIRE  
LOWER SWATARA

76

SWATARA

STEELTON

FAIRVIEW

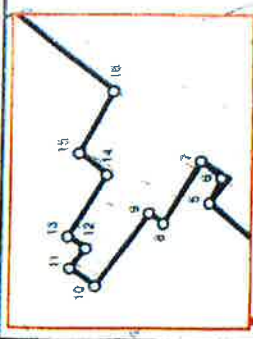

Distances, bearings and distances were not developed as a result of a physical survey completed through employment of EMT, AUGUST 2005 land. Bearings and Distances attached hereto.



Pennsylvania-American Water Company  
Mechanicsburg Operating Area  
Proposed Steelton Service Territory  
Approximately 1,453 Acres  
Steelton Borough, Dauphin County

Bearings and Distance Points  
 Applied For Service Territory  
 Municipality  
 TO BE USED FOR REFERENCE ONLY  
 Pennsylvania American Water Company  
 652 Wacker Drive  
 Mechanicsburg, PA 17055  
 State of PA, Charter No. 10 Date 1/24/2005