



RECEIVED

2010 NOV 12 PM 3:41

PA.P.U.C.
SECRETARY'S BUREAU

November 4, 2010

Ms. Rosemary Chiavetta, Secretary
Pennsylvania Public Utility Commission
P.O. Box 3265
Harrisburg, PA 17105-3265

RE: PUC Docket # A-2008-2067958: Application of the Department of Transportation of the Commonwealth of Pennsylvania for the approval to widen S.R. 0019, Section P02, which crosses under one track of Norfolk Southern Railway Company (DOT # 367-280 V) in Waynesburg Borough, Greene County; and the allocation of costs incident thereto.

Dear Secretary Chiavetta:

Enclosed for filing, please find three copies of the approved TS&L Plan for the subject project. This project is part of proposed capacity, safety, and geometric improvements to S.R. 0019, which also includes the replacement of the existing adjacent roadway bridge over Ten Mile Creek. The roadway under the rail structure will be widened to accommodate an additional lane of traffic in each direction, and replace the existing sidewalk. The existing vertical profile of the roadway will be modified to improve vertical clearance under the rail structure, and improved horizontal geometry will increase sight distance at the structure. The replacement railroad structure is proposed to be a simple span, steel through-girder bridge adjacent to the existing structure for constructability and maintenance of rail traffic during construction. At this time, the District would like to request a PUC Field Conference be scheduled.

Also, please update the official Parties of Record to the following:

Mr. David C. Hart, P.E., Manager
Rail Safety Division
Public Utility Commission
3rd Floor, Keystone Building

Mr. Mark Chappell, PE, Chief
Utilities and Right-of-Way Section
Bureau of Design, PennDOT
7th Floor, Keystone Building

Ms. Rachel D. Duda, PE, Assistant District Executive - Design
Engineering District 12-0
Pennsylvania Department of Transportation
825 North Gallatin Avenue
Uniontown, PA 15401
Attention: Mr. Brian C. Svesnik



pennsylvania

DEPARTMENT OF TRANSPORTATION

www.dot.state.pa.us

Mr. Thomas M. Bracey
Senior Engineer - Public Improvements
Norfolk Southern Corporation
1200 Peachtree Street
Atlanta, GA 30309

Mr. T. David Wyatt, P.E.
Systems Engineer - Public Improvements
Norfolk Southern Corporation
1200 Peachtree Street
Atlanta, GA 30309

Mr. Randal S. Noe, Esquire
Assistant General Attorney
Norfolk Southern Corporation
Three Commercial Place
Norfolk, VA 23510-9207

Ms. Pam Snyder, County Commissioner
Greene County, County Commissioners
93 East High Street
Waynesburg, PA 15370

Mr. Edward G. Howard, Borough Manager
Borough of Waynesburg
90 East High Street
Waynesburg, PA 15370

Mr. T. Reed Kiger, Township Supervisor
Franklin Township
568 Rolling Meadows Road
Waynesburg, PA 15370

Mr. Tim Blasinsky
Allegheny Power Company
Jefferson Division
1879 Jefferson Road
Rice Landing, PA 15357

Ms. Lisa Marinelli
Allegheny Power Company
800 Cabin Hill Drive
Greensburg, PA 15601



pennsylvania

DEPARTMENT OF TRANSPORTATION

www.dot.state.pa.us

Mr. Ron Anderson
Alltel of Pennsylvania, Inc.
427 Jefferson Road
Waynesburg, PA 15370

Mr. Rick Molsen
Comcast
300 Corliss Street
Pittsburgh, PA 15220-4815

Ms. Sasha Furkak-Roy
Columbia Gas of PA, Inc.
150 Hillside Drive
Bethel Park, PA 15102

Mr. Kevin Foreman
Columbia Gas Transmission
950 Manifold Road
Washington, PA 15301

Mr. Sean Kozielec
Equitable Gas
225 North Shore Drive
Pittsburgh, PA 15212

Mr. Rob Springer
Equitrans L.P.
175 Industrial Road
Waynesburg, PA 15370

Mr. Joe Simatic
Southwest PA Water Authority
P.O. Box 219
1442 Jefferson Road
Jefferson, PA 15344-0187

Mr. Dennis Uchal
Verizon – Pennsylvania, Inc.
27 West Church Street
Uniontown, PA 15401



pennsylvania

DEPARTMENT OF TRANSPORTATION

www.dot.state.pa.us

RECEIVED

2010 NOV 12 PM 3:41

PA.P.U.C.
SECRETARY'S BUREAU

Mr. George Scott
Franklin Township Sewer Authority
P.O. Box 752
568 Rolling Meadows Road
Waynesburg, PA 15370

Mr. Jeff Mickelson
Dominion Transmission, Inc.
P.O. Box 66, Route 22
Delmont, PA 15626

Ms. Laurie Sphar
Dominion Peoples Gas Company
1291 W. Main Street
Monongahela, PA 15063

Mr. Randy Putt
Spectra Energy
217 University Drive
Lemont Furnace, PA 15446

A copy of the approved TS&L Plan and this letter has been served upon the parties of record.

Sincerely,

A handwritten signature in black ink, appearing to read "B. C. Svesnik".

Brian C. Svesnik
Grade Crossing Administrator
Engineering District 12-0

Enclosure

cc: Parties of Record

Gina M. D'Alfonso, Office of Chief Counsel, 9th Floor, Keystone Building

PLAN PREPARATION
 TRANS ASSOCIATES F. JAMES PRISK, P.E.
 MICHELE ACITELLI, P.E.
 NATHANIEL SHAFFER, E.I.T.

FEDERAL PROJECT NO.

DISTRICT	COUNTY	TOWNSHIP	BOROUGH/TOWN	ROUTE	SECTION	TOTAL SHEETS
12	GREENE	FRANKLIN	WAYNESBURG	0019	P02	9

SYS	S. R. or W. O.	SPUR	PHA	SECTION	DIST.	CO
x	0 0 1 9			P 0 2	12	2
x	x x x x			x x x	x	x

S. R. 0019 NB PREVIOUSLY KNOWN AS L. R. 110.
 S. R. 0019 SB PREVIOUSLY KNOWN AS L. R. 31024.

COMMONWEALTH OF PENNSYLVANIA



DEPARTMENT OF TRANSPORTATION

DRAWINGS
 FOR
 PUC EXHIBIT "A"
 FOR

STATE ROUTE 0019 SECTION P02
 IN GREENE COUNTY

FROM STA. 39+00.00 NB TO STA. 52+00.00 NB LENGTH 1142.25 FT. 0.216 MI.
 FROM SEG. 0310 OFFSET 0366 TO SEG. 0300 OFFSET 0915

AND

FROM STA. 8+00.00 SB TO STA. 17+23.50 SB LENGTH 878.50 FT. 0.166 MI.
 FROM SEG. 0311 OFFSET 0539 TO SEG. 0300 OFFSET 1525

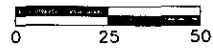

HORIZONTAL SCALE
SCALE IN FEET

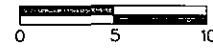

VERTICAL SCALE
SCALE IN FEET

SHEET INDEX BLOCK	
DESCRIPTION	SHEET
TITLE SHEET	1
PROJECT LOCATIONS & INDEX MAP	2
TYPICAL SECTIONS	3-4
DETAIL PLAN SHEET	5
VERTICAL PROFILE SHEETS	6-9
SUPPLEMENTARY PLANS	
TSL S. R. 0019 BRIDGE	1
TSL NORFOLK SOUTHERN RAIL BRIDGE	1

DESIGN DESIGNATION

TRAFFIC DATA	S. R. 0019
HIGHWAY CLASSIFICATION ROADWAY TYPOLOGY	URBAN PRINCIPAL ARTERIAL REGIONAL ARTERIAL/ SUBURBAN CENTER
DESIGN SPEED	S. R. 0019 NB 30 M.P.H. S. R. 0019 SB 30 M.P.H.
PAVEMENT WIDTH	VARIES 24' - 62.2'
SHOULDER WIDTH	5.5' SHOULDER & 2.67' CURB GUTTER
CURRENT A.D.T.	24,750 (2012)
DESIGN YEAR A.D.T.	28,250 (2032)
D. H. V.	2,825
D	55%
T	4%

SURVEYED BY: MONALOH BASIN ENGINEERS CAMPBELLS RUN BUSINESS CENTER 300 BUSINESS CENTER DRIVE, SUITE 304 PITTSBURGH, PA 15205	PREPARED BY: TRANS ASSOCIATES TWIN TOWERS, SUITE 400 4955 STEUBENVILLE PIKE PITTSBURGH, PA 15205	RECOMMENDED	DATE: _____
		RECOMMENDED	DATE: _____
PROFESSIONAL LAND SURVEYOR	REGISTERED PROFESSIONAL ENGINEER	APPROVED	DATE: _____
P.L.S. NUMBER	DATE	P.E. NUMBER	DATE

SECRETARY OF TRANSPORTATION
 (ON BEHALF OF THE GOVERNOR
 AS WELL AS HIMSELF)

RECEIVED
 2010 NOV 12 PM 3:41
 PA.P.U.C.
 SECRETARY'S BUREAU

PLOTTED: 10/29/2010
 FILE NAME: P:\p006100\99196\puc_application\TITLE SHEET.dgn

DISTRICT	COUNTY	ROUTE	SECTION	SHEET
12-0	GREENE	0019	P02	2 OF 9
WAYNESBURG BOROUGH/FRANKLIN TOWNSHIP				
REVISION NUMBER	REVISION	DATE	BY	

TABULATION OF SEGMENT EQUALITIES

SR 0019 NB/SB
SEGMENT 0300, OFFSET 0915 = STA. 52+00.00

SR 0019 NB
SEGMENT-0310--STATION-42+66.00
SEGMENT 0310, OFFSET 0366 = STA. 39+00.00

LIST OF EQUALITIES

S.R. 0019 NB/SB
STA. 44+22.95 BK = STA. 44+21.10 AHD
STA. 50+55.93 BK = STA. 50+55.61 AHD

S.R.-0019-NB/SB-STA.-46+60.00--
S.R. 0019 SB STA. 17+23.50
38.23 FT. N63°27'05"E

TABULATION OF OVERALL LENGTH

S.R. 0019 NB
STA. 39+00.00 TO STA. 44+22.95 BK = 522.95 FT.
STA. 44+21.10 AHD TO STA. 50+55.93 BK = 634.83 FT.
STA. 50+55.61 AHD TO STA. 52+00.00 = 144.39 FT.
1302.17 FT. = 0.247 MI.

S.R. 0019 SB
STA. 8+00.00 TO STA. 17+23.50 = 923.50 FT. = 0.175 MI.

TABULATION OF CONSTRUCTION LENGTH

S.R. 0019 NB
STA. 39+90.00 TO STA. 44+22.95 BK = 432.95 FT.
STA. 44+21.10 AHD TO STA. 50+55.93 BK = 634.83 FT.
STA. 50+55.61 AHD TO STA. 51+30.00 = 74.39 FT.
1142.25 FT. = 0.216 MI.

S.R. 0019 SB
STA. 8+45.00 TO STA. 17+23.50 = 878.50 FT. = 0.166 MI.

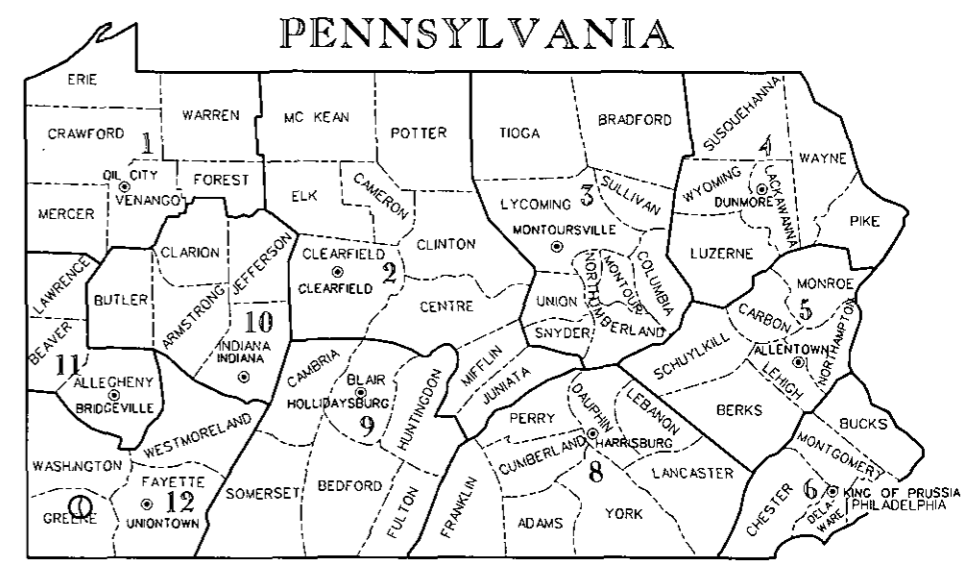

⊙ DISTRICT OFFICE
⊙ PROJECT LOCATION
12 DISTRICT

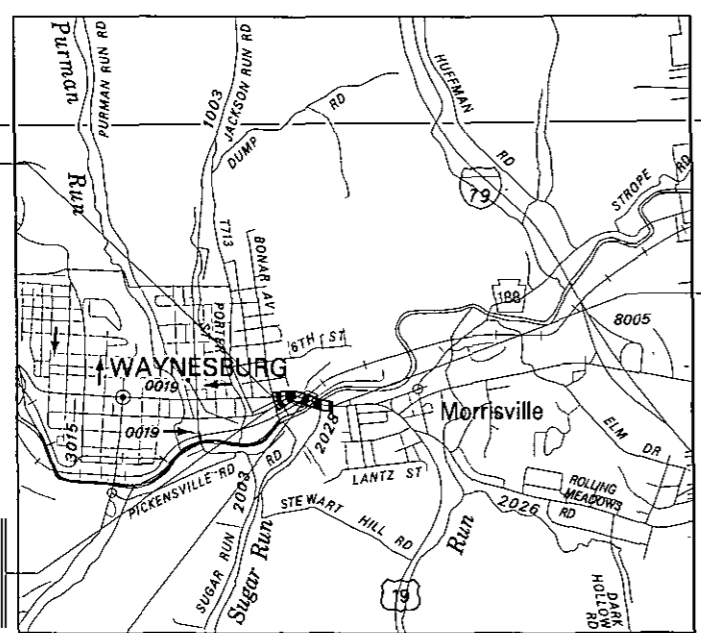

LEGEND

▬ PROJECT LOCATION

3036 STATE HIGHWAY WITH INDENTIFIER

— TOWNSHIP ROAD

356 PENNSYLVANIA TRAFFIC ROUTE

422 U.S. TRAFFIC ROUTE

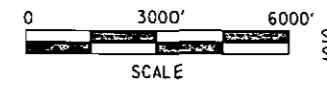

LIMIT OF WORK
STA. 39+00.00
SEG. 0310, OFFSET 0366
S.R. 0019 NB, SEC. P02
FRANKLIN TOWNSHIP
GREENE COUNTY

LIMIT OF WORK
STA. 8+00.00
SEG. 0311, OFFSET 0539
S.R. 0019 SB, SEC. P02
FRANKLIN TOWNSHIP
GREENE COUNTY

LIMIT OF WORK
STA. 17+23.50
SEG. 0300, OFFSET 1525
S.R. 0019 SB, SEC. P02
FRANKLIN TOWNSHIP
GREENE COUNTY

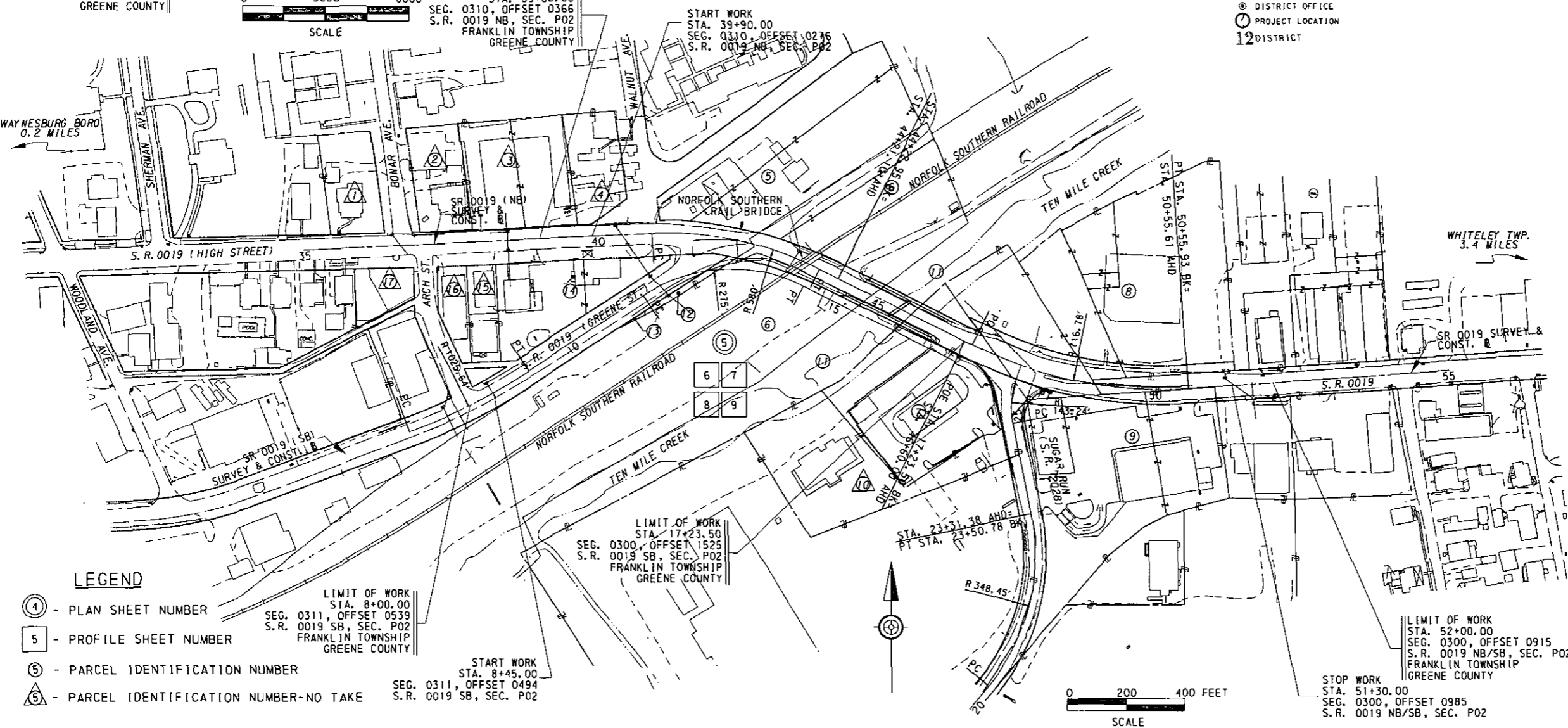

LIST OF PROPERTY OWNERS

- ① DAVID A. BYRD AND CONNIE S. BYRD, HIS WIFE
- ② RICHARD STUCK AND ELLEN STUCK, HIS WIFE
- ③ CHAMPAK N. PATEL AND JASHANTI C. PATEL, HUSBAND AND WIFE
- ④ FRANK BEBOUT
- ⑤ HIRAN K. WATSON AND MARCELLA R. WATSON, HIS WIFE
- ⑥ NORFOLK SOUTHERN RAILWAY COMPANY
- ⑦ LEASE BETWEEN DOROTHY B. KORATICH, WIDOW (THE LANDLORD) AND THE MCDONALDS CORPORATION (THE TENANT)
- ⑧ ANCHOR CORPORATE DEVELOPMENTS, INC.
- ⑨ HPT (WAYNESBURG), LP.
- ⑩ DOROTHY B. KORATICH, WIDOW
- ⑪ UNKNOWN
- ⑫ JOHN C. MCNAY AND KATHY E. MCNAY, HUSBAND AND WIFE
- ⑬ UNKNOWN
- ⑭ PAUL R. HOWARD AND ROBERTA K. HOWARD, HIS WIFE
- ⑮ JEFFREY W. HUGHES AND KATHRYN W. HUGHES, HIS WIFE
- ⑯ PAUL R. HOWARD AND ROBERTA K. HOWARD, HIS WIFE
- ⑰ CURTIS A. PRICE AND AMY M. PRICE, HUSBAND AND WIFE

LEGEND

④ - PLAN SHEET NUMBER

⑤ - PROFILE SHEET NUMBER

⑥ - PARCEL IDENTIFICATION NUMBER

⑦ - PARCEL IDENTIFICATION NUMBER-NO TAKE

LIMIT OF WORK
STA. 8+00.00
SEG. 0311, OFFSET 0539
S.R. 0019 SB, SEC. P02
FRANKLIN TOWNSHIP
GREENE COUNTY

START WORK
STA. 8+45.00
SEG. 0311, OFFSET 0494
S.R. 0019 SB, SEC. P02

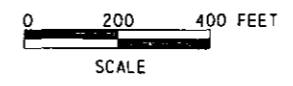

LIMIT OF WORK
STA. 52+00.00
SEG. 0300, OFFSET 0915
S.R. 0019 NB/SB, SEC. P02
FRANKLIN TOWNSHIP
GREENE COUNTY

STOP WORK
STA. 51+30.00
SEG. 0300, OFFSET 0985
S.R. 0019 NB/SB, SEC. P02

DISTRICT	COUNTY	ROUTE	SECTION	SHEET
12-0	GREENE	0019	P02	3 OF 9
WAYNESBURG BOROUGH/FRANKLIN TOWNSHIP				
REVISION NUMBER	REVISION	DATE	BY	

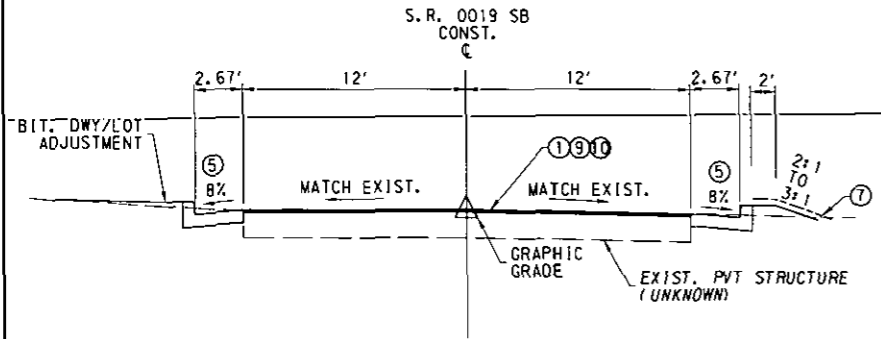

S.R. 0019 SOUTHBOUND TYPICAL SECTION
STA. 8+45.00 TO STA. 10+50.00
N.T.S.

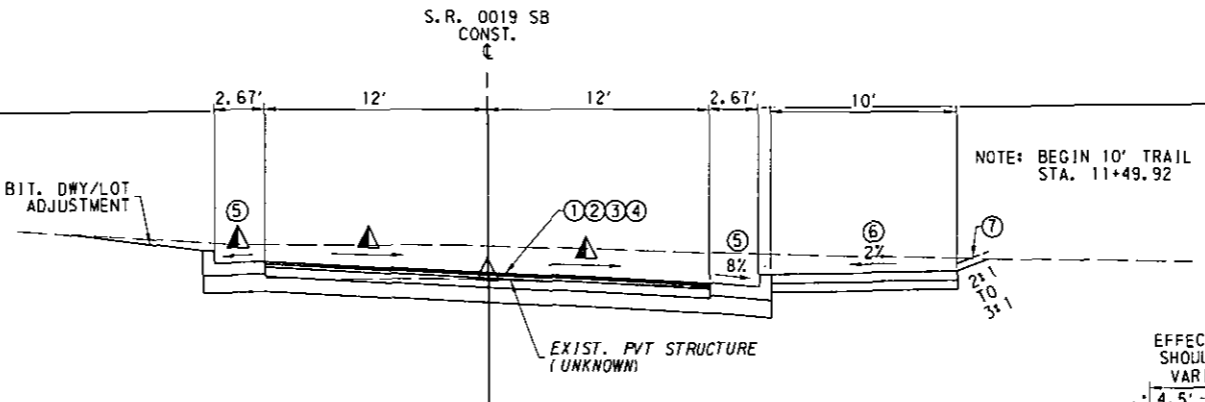

S.R. 0019 SOUTHBOUND TYPICAL SECTION
STA. 10+50.00 TO STA. 10+77.18 (TRANSITION TO EXIST.)
STA. 10+77.18 TO STA. 11+49.92 (SUPERELEVATION TRANSITION)
STA. 11+49.92 TO STA. 12+52.31 (FULL SUPERELEVATION)
N.T.S.

NOTE: BEGIN 10' TRAIL
STA. 11+49.92

NOTE: BEGIN CONCRETE
CURB GUTTER
STA. 41+00.00

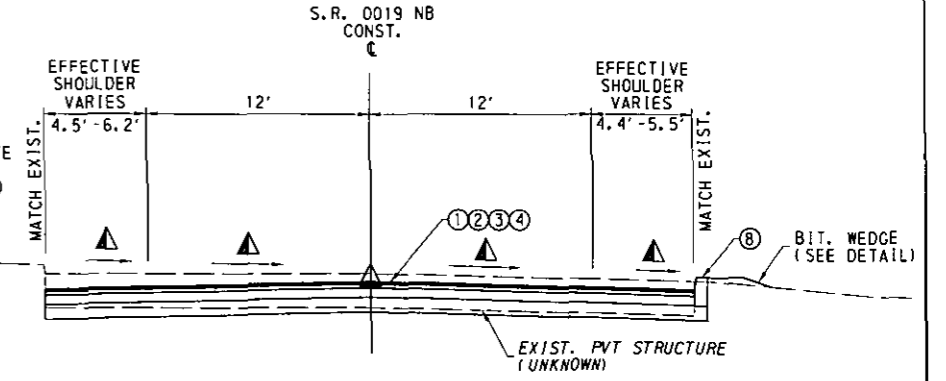

S.R. 0019 NORTHBOUND TYPICAL SECTION
STA. 39+90.00 TO STA. 40+08.88 (TRANSITION TO EXIST.)
STA. 40+08.88 TO STA. 40+91.64 (SUPERELEVATION TRANSITION)
STA. 40+91.64 TO STA. 41+62.61 (SUPERELEVATION)
N.T.S.

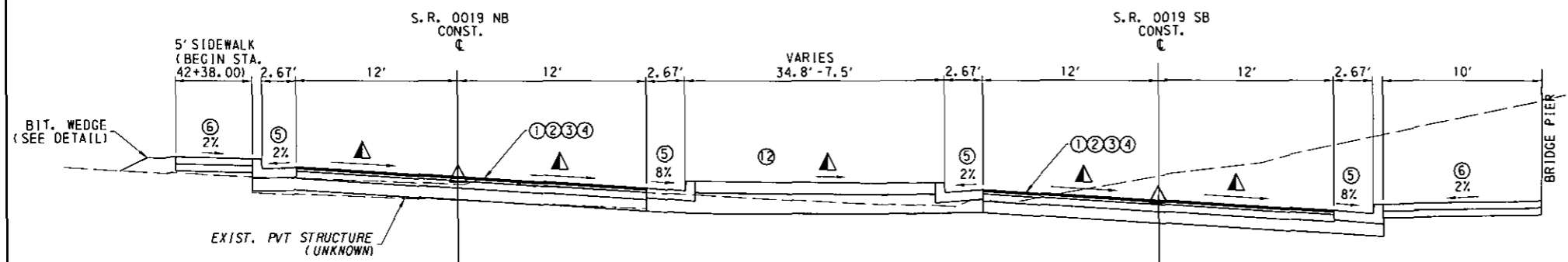

S.R. 0019 NORTHBOUND TYPICAL SECTION
STA. 41+62.61 TO STA. 43+59.47 (SUPERELEVATION)
STA. 43+59.47 TO STA. 44+63.37 (TRANSITION TO BRIDGE)
N.T.S.

S.R. 0019 SOUTHBOUND TYPICAL SECTION
STA. 12+52.31 TO STA. 13+89.03 (SUPERELEVATION)
STA. 13+89.03 TO STA. 15+05.00 (TRANSITION TO BRIDGE)
N.T.S.

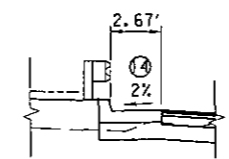

DETAIL A
STA. 12+52.31 TO STA. 13+35.00
N.T.S.

LIST OF MATERIALS

- ① SUPERPAVE ASPHALT MIXTURE DESIGN, HMA WEARING COURSE, PG 64-22, 0.3 < 3 MILLION ESALS, 9.5 MM MIX, 1 1/2" DEPTH, SRL-E
- ② SUPERPAVE ASPHALT MIXTURE DESIGN, HMA BINDER COURSE, PG 64-22, 0.3 < 3 MILLION ESALS, 19.0 MM MIX, 2 1/2" DEPTH
- ③ SUPERPAVE ASPHALT MIXTURE DESIGN, HMA BASE COURSE, PG 64-22, 0.3 < 3 MILLION ESALS, 25.0 MM MIX, 7 1/2" DEPTH
- ④ SUBBASE 8" DEPTH (NO. 2A)
- ⑤ PLAIN CEMENT CONCRETE CURB GUTTER
- ⑥ SIDEWALK
- ⑦ SEEDING AND SOIL SUPPLEMENTS - SIDEWALK/LAWN AREAS - FORMULA B
- SLOPES < 3:1 - FORMULA D
- SLOPES > 3:1 - FORMULA L
- ⑧ PLAIN CEMENT CONCRETE CURB
- ⑨ MILLING OF BITUMINOUS PAVEMENT SURFACE
- ⑩ BITUMINOUS TACK COAT
- ⑪ PLAIN CEMENT CONCRETE PAVEMENT, 8" DEPTH
- ⑫ PLAIN CEMENT CONCRETE PAVEMENT, 4" DEPTH
- ⑬ PLAIN CONCRETE MOUNTABLE CURB, TYPE A
- ⑭ PLAIN CEMENT CONCRETE CURB GUTTER, MODIFIED (REDUCED CURB HEIGHT)

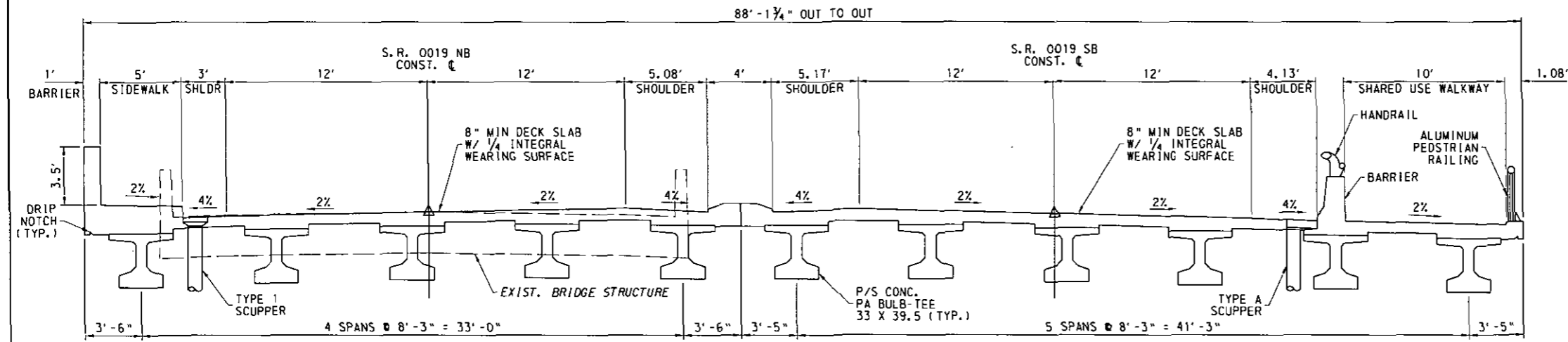

S.R. 0019 NORTHBOUND TYPICAL SECTION - BRIDGE
STA. 44+63.37 TO STA. 46+18.73
N.T.S.

S.R. 0019 SOUTHBOUND TYPICAL SECTION - BRIDGE
STA. 15+05.00 TO STA. 16+60.16
N.T.S.

▲ REFER TO THE CROSS SECTIONS FOR SLOPES.
△ PROFILE GRADE POINT

TYPICAL SECTIONS

PLOTTED: 10/29/2010
FILE NAME: P:\pccdo00\991916\PLC application\Typicals.dgn

DISTRICT	COUNTY	ROUTE	SECTION	SHEET
12-0	GREENE	0019	P02	4 OF 9
WAYNESBURG BOROUGH/FRANKLIN TOWNSHIP				
REVISION NUMBER	REVISION	DATE	BY	

LIST OF MATERIALS

- ① SUPERPAVE ASPHALT MIXTURE DESIGN, HMA WEARING COURSE, PG 64-22, 0.3 < 3 MILLION ESALS, 9.5 MM MIX, 1 1/2" DEPTH, SRL-E
- ② SUPERPAVE ASPHALT MIXTURE DESIGN, HMA BINDER COURSE, PG 64-22, 0.3 < 3 MILLION ESALS, 19.0 MM MIX, 2 1/2" DEPTH
- ③ SUPERPAVE ASPHALT MIXTURE DESIGN, HMA BASE COURSE, PG 64-22, 0.3 < 3 MILLION ESALS, 25.0 MM MIX, 7 1/2" DEPTH
- ④ SUBBASE 8" DEPTH (NO. 2A)
- ⑤ PLAIN CEMENT CONCRETE CURB GUTTER
- ⑥ SIDEWALK
- ⑦ SEEDING AND SOIL SUPPLEMENTS - SIDEWALK/LAWN AREAS - FORMULA B
- SLOPES < 3:1 - FORMULA D
- SLOPES > 3:1 - FORMULA L
- ⑧ PLAIN CEMENT CONCRETE CURB
- ⑨ MILLING OF BITUMINOUS PAVEMENT SURFACE
- ⑩ BITUMINOUS TACK COAT
- ⑪ PLAIN CEMENT CONCRETE PAVEMENT, 8" DEPTH
- ⑫ PLAIN CEMENT CONCRETE PAVEMENT, 4" DEPTH
- ⑬ PLAIN CONCRETE MOUNTABLE CURB, TYPE A
- ⑭ PLAIN CEMENT CONCRETE CURB GUTTER, MODIFIED (REDUCED CURB HEIGHT)

▲ REFER TO THE CROSS SECTIONS FOR SLOPES.
△ PROFILE GRADE POINT

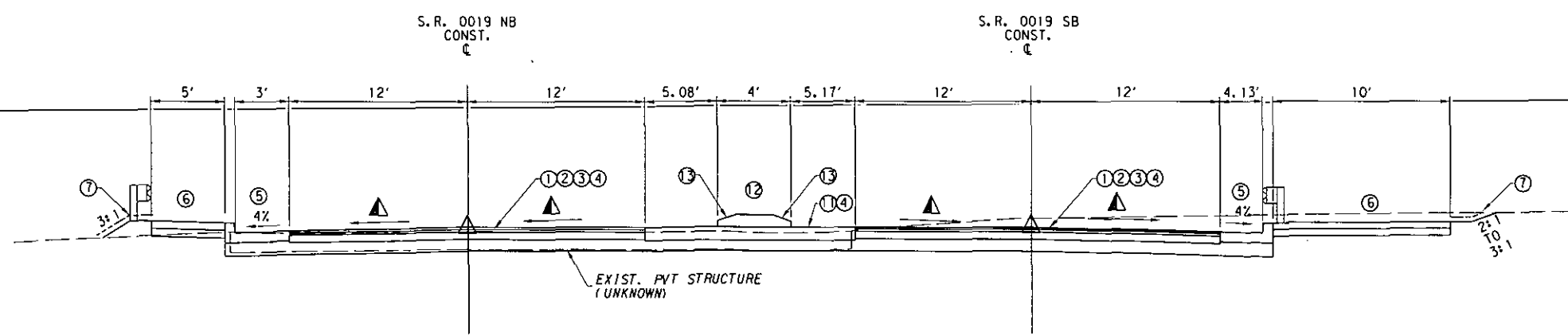

S.R. 0019 NORTHBOUND TYPICAL SECTION
STA. 46+18.73 TO STA. 46+60.00
N. T. S.

S.R. 0019 SOUTHBOUND TYPICAL SECTION
STA. 16+60.16 TO STA. 17+23.50
N. T. S.

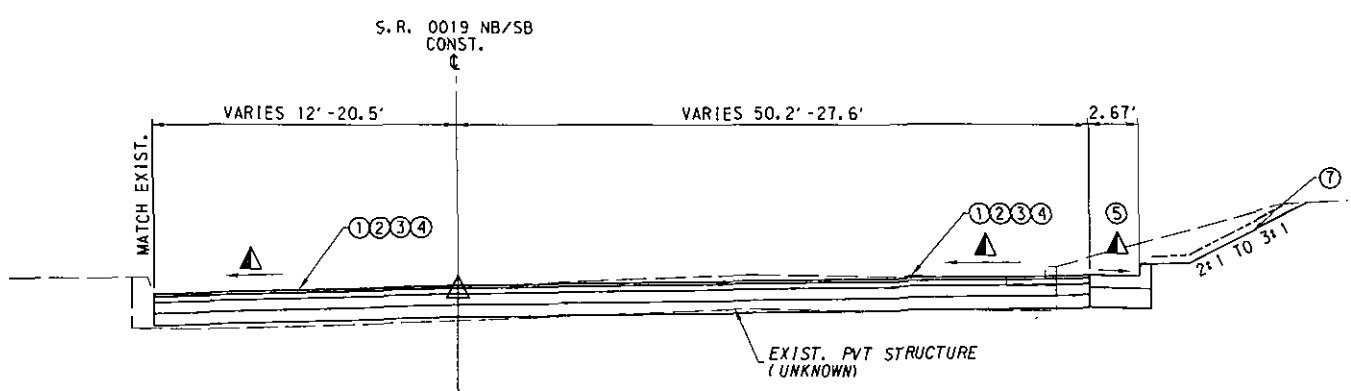

S.R. 0019 NORTHBOUND/SOUTHBOUND TYPICAL SECTION
STA. 46+60.00 TO STA. 48+06.03
N. T. S.

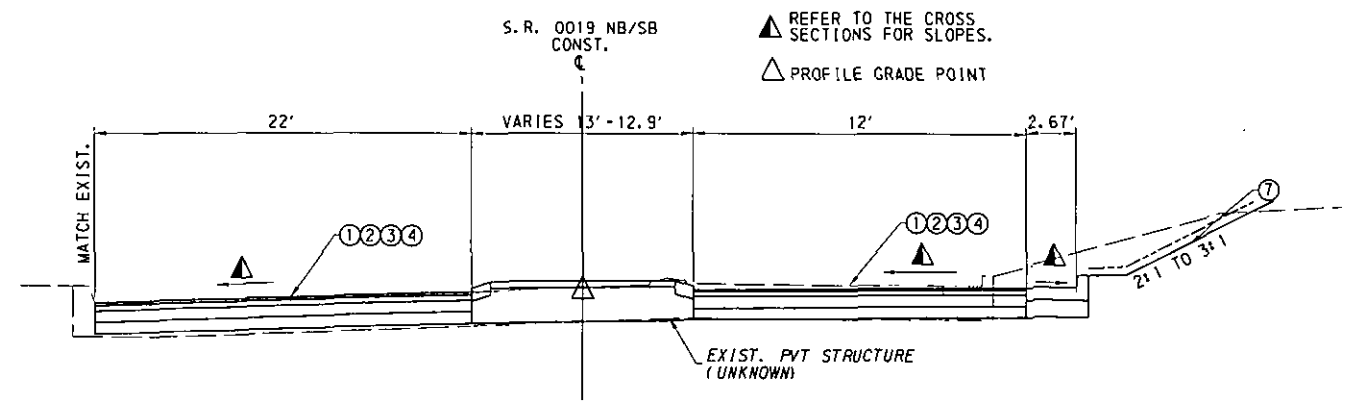

S.R. 0019 NORTHBOUND/SOUTHBOUND TYPICAL SECTION
STA. 48+06.03 TO STA. 48+52.23
N. T. S.

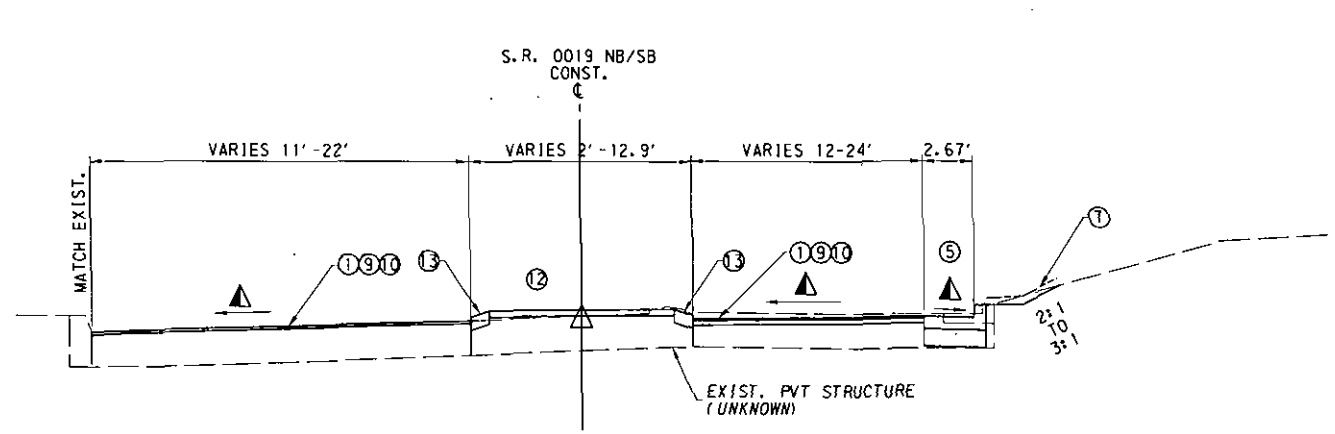

S.R. 0019 NORTHBOUND/SOUTHBOUND TYPICAL SECTION
STA. 48+52.23 TO STA. 50+60.17
N. T. S.

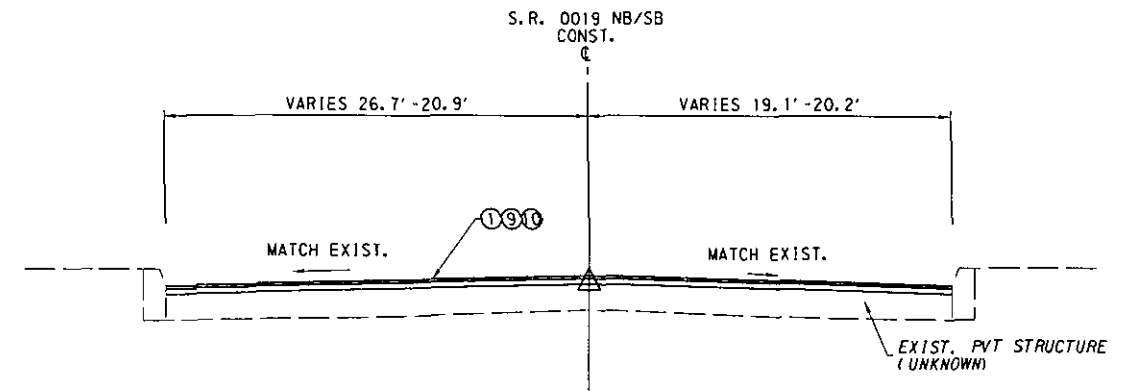

S.R. 0019 NORTHBOUND/SOUTHBOUND TYPICAL SECTION
STA. 50+60.17 TO STA. 51+30.00
N. T. S.

TYPICAL SECTIONS

FILE NAME: P:\pda\100\99196\PUC application\Typicals.dgn

DISTRICT	COUNTY	ROUTE	SECTION	SHEET
12-0	GREENE	0019	P02	5 OF 9
WAYNESBURG BOROUGH/FRANKLIN TOWNSHIP				
REVISION NUMBER	REVISION	DATE	BY	

PLOTTED: 11/23/2010

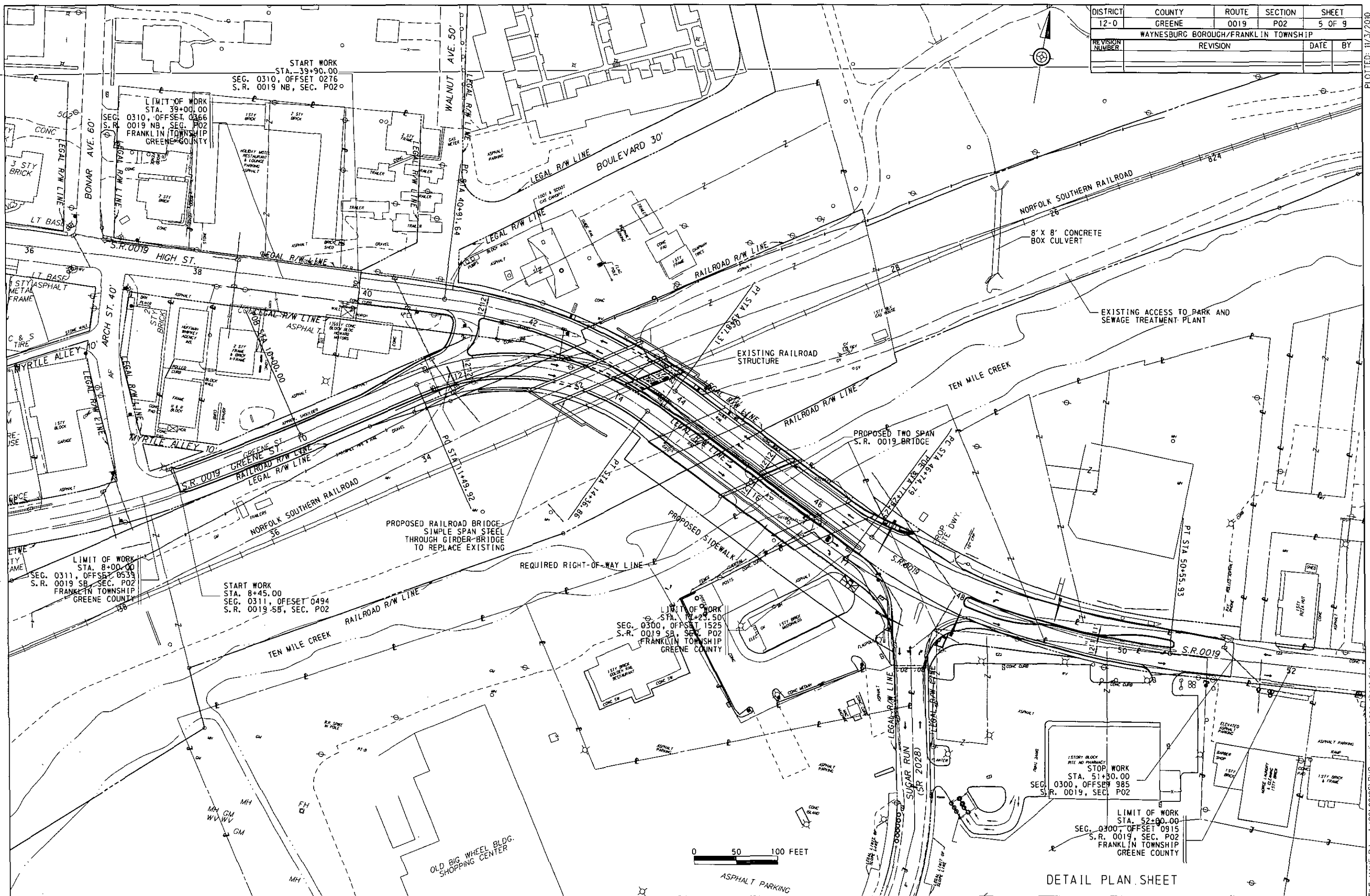

DETAIL PLAN SHEET

FILE NAME: P:\pdc00\99196\PUC application\con sheet.dgn

DISTRICT	COUNTY	ROUTE	SECTION	SHEET
12-0	GREENE	0019	P02	6 OF 9
WAYNESBURG BOROUGH/FRANKLIN TOWNSHIP				
REVISION NUMBER	REVISION	DATE	BY	

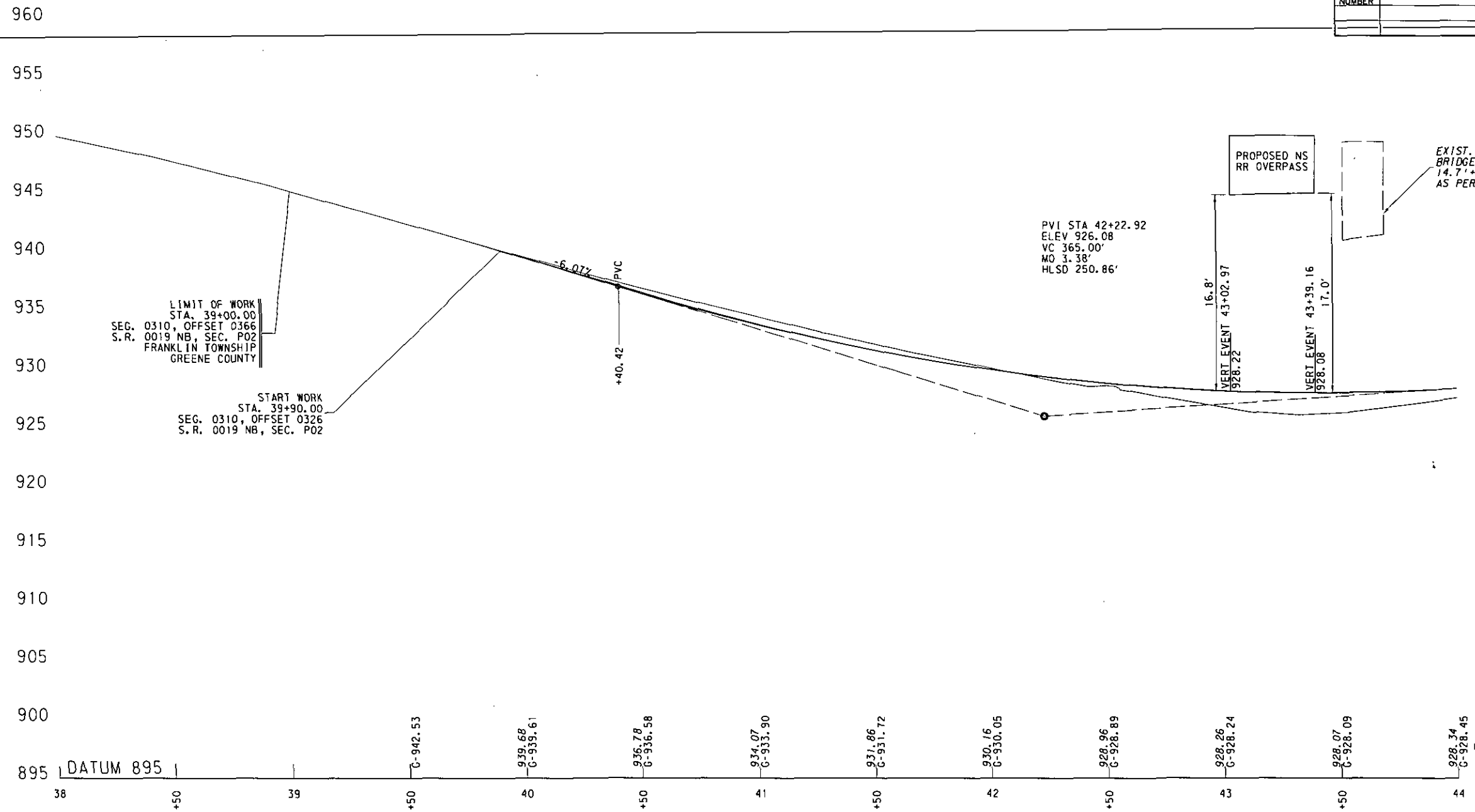

CONSTRUCTION C PROFILE S.R. 0019 NB
SCALE IN FEET

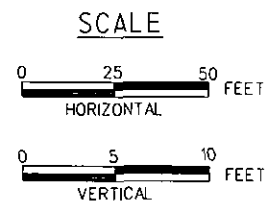

VERTICAL PROFILE

FILE NAME: P:\p00100\99196\puc application\profile sheet A nb 19 .dgn PLOTTED: 11/3/2010

DISTRICT	COUNTY	ROUTE	SECTION	SHEET
12-0	GREENE	0019	P02	7 OF 9
WAYNESBURG BOROUGH/FRANKLIN TOWNSHIP				
REVISION NUMBER	REVISION	DATE	BY	

FILE NAME: P:\p000100\99\96\puc application\profile sheet B nb 19 .dgn PLOTTED: 10/29/2010

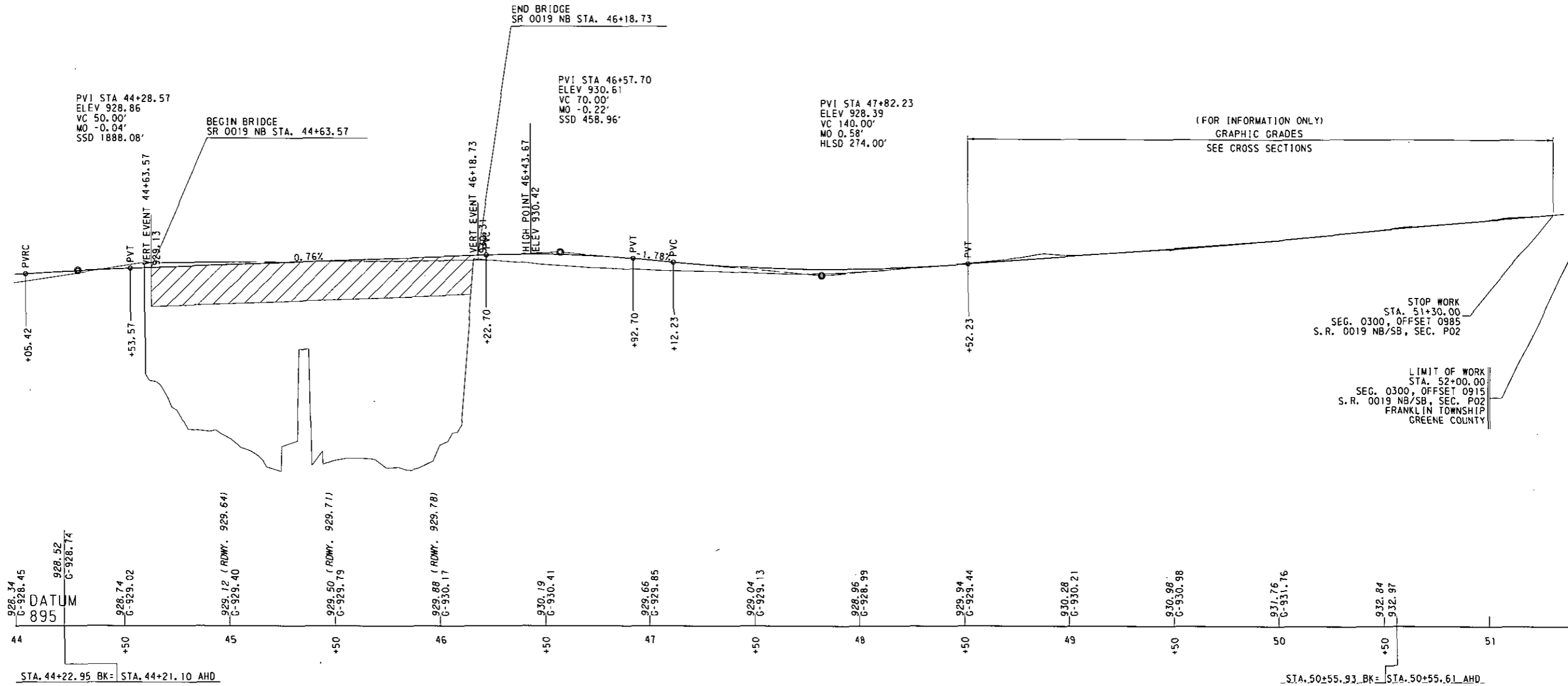

CONSTRUCTION PROFILE S.R. 0019 NB
SCALE IN FEET

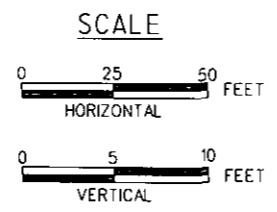

VERTICAL PROFILE

DISTRICT	COUNTY	ROUTE	SECTION	SHEET
12-0	GREENE	0019	P02	8 OF 9
WAYNESBURG BOROUGH/FRANKLIN TOWNSHIP				
REVISION NUMBER	REVISION	DATE	BY	

PLOTTED: 11/3/2010

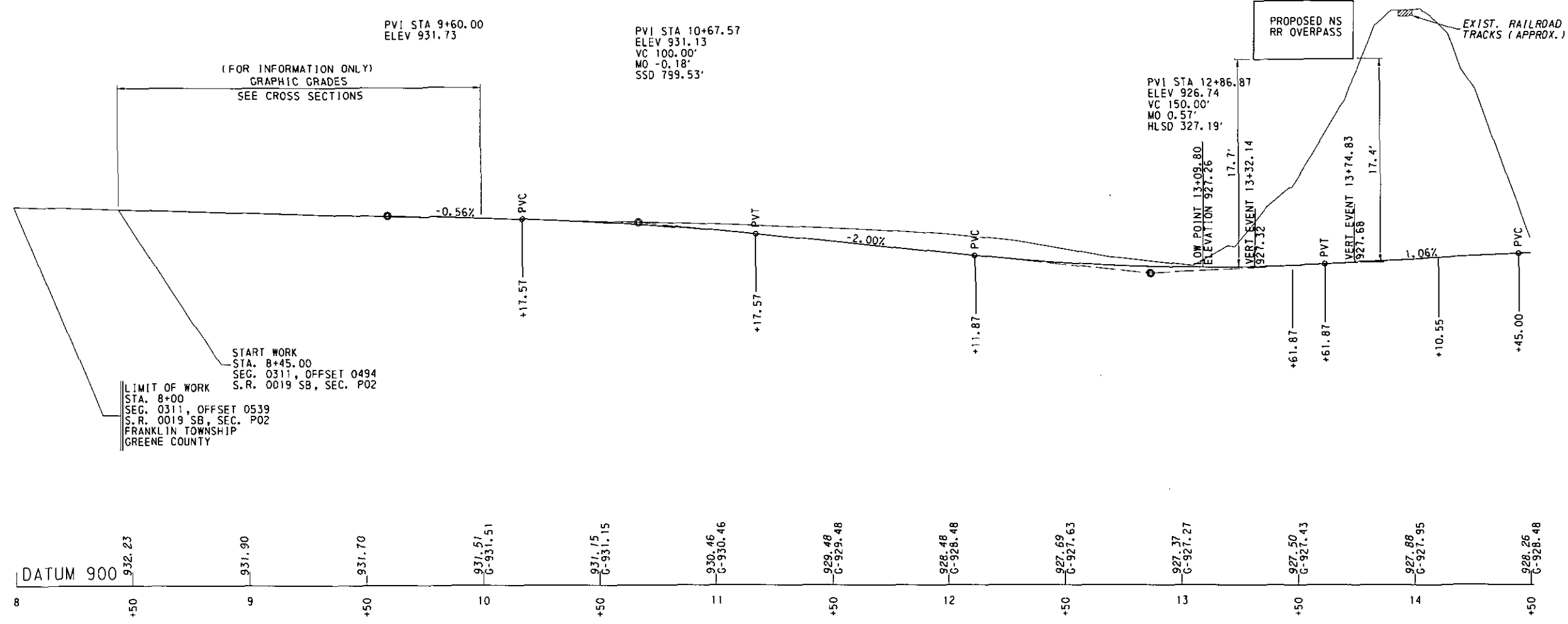

START WORK
 STA. 8+45.00
 SEG. 0311, OFFSET 0494
 S.R. 0019 SB, SEC. P02

LIMIT OF WORK
 STA. 8+00
 SEG. 0311, OFFSET 0539
 S.R. 0019 SB, SEC. P02
 FRANKLIN TOWNSHIP
 GREENE COUNTY

(FOR INFORMATION ONLY)
 GRAPHIC GRADES
 SEE CROSS SECTIONS

CONSTRUCTION & PROFILE S.R. 0019 SB
 SCALE IN FEET

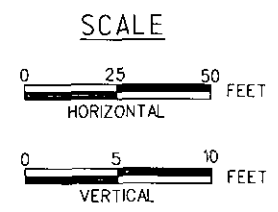

VERTICAL PROFILE

DISTRICT	COUNTY	ROUTE	SECTION	SHEET
12-0	GREENE	0019	P02	9 OF 9
WAYNESBURG BOROUGH/FRANKLIN TOWNSHIP				
REVISION NUMBER	REVISION	DATE	BY	

PLOTTED: 10/29/2010

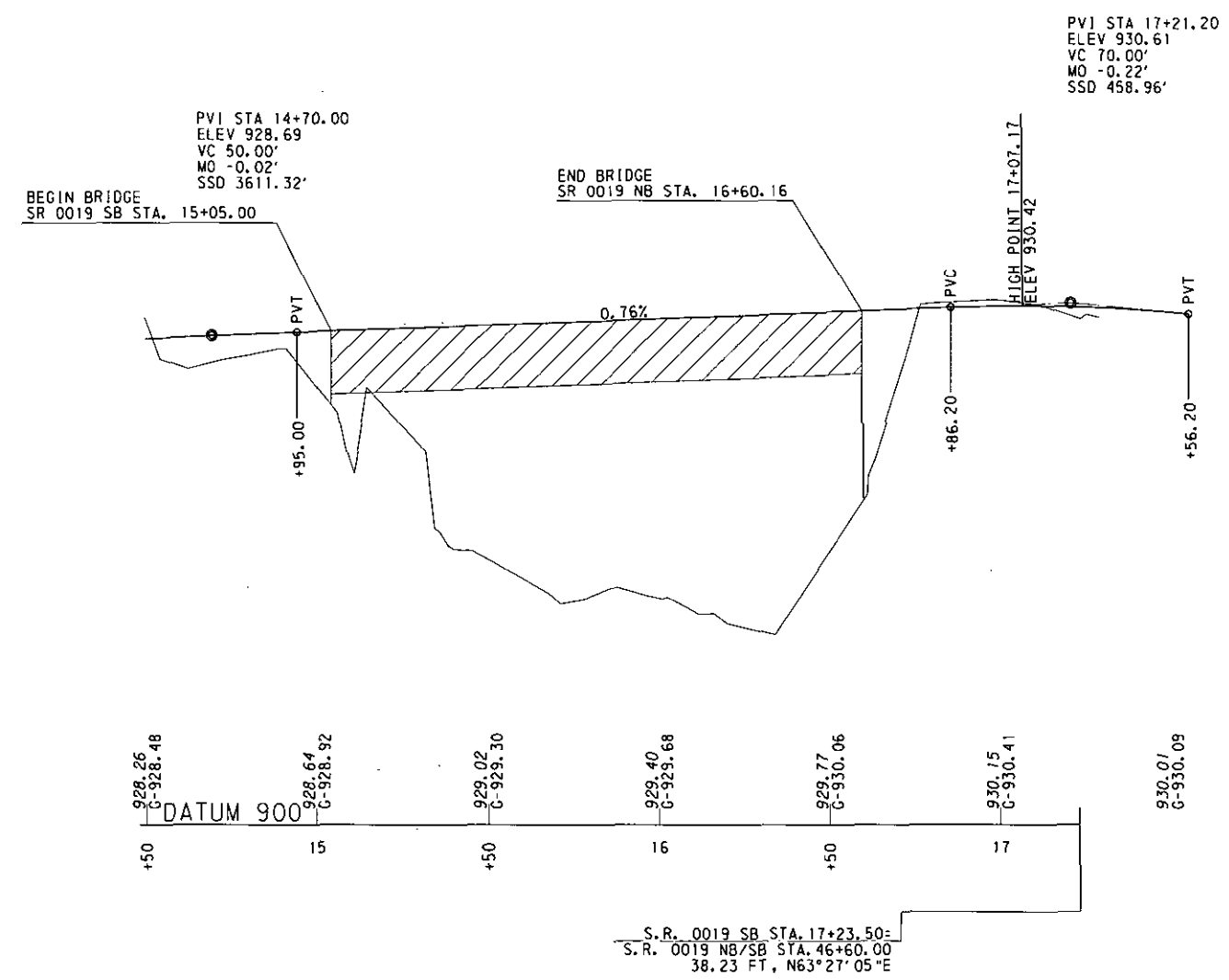

S.R. 0019 SB STA. 17+23.50 =
 S.R. 0019 NB/SB STA. 46+60.00
 38.23 FT, N63°27'05"E

CONSTRUCTION ϕ PROFILE S.R. 0019 SB

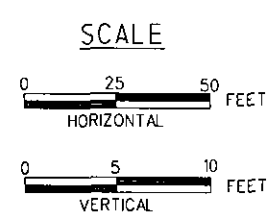

VERTICAL PROFILE

FILE NAME: P:\padd\00\99\96\puc application\profile sheet D sb 19 .dgn

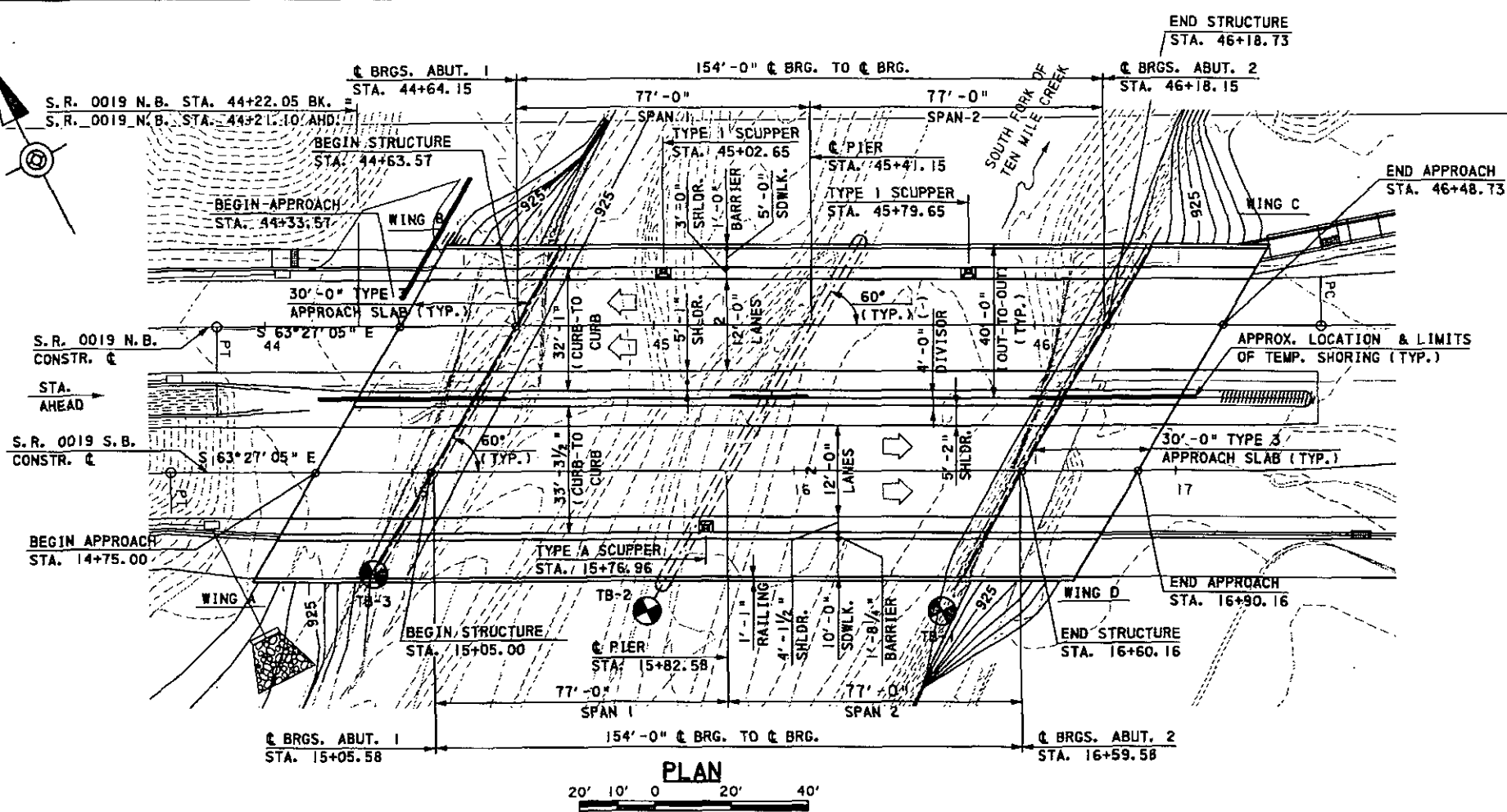
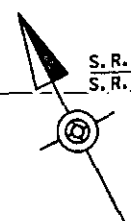

GENERAL NOTES:

- PROVIDE MATERIALS AND PERFORM WORK IN ACCORDANCE WITH SPECIFICATIONS PUBLICATION 408 2007.

DESIGN SPECIFICATIONS:

- AASHTO LRFD BRIDGE DESIGN SPECIFICATIONS 2004, AND AS SUPPLEMENTED BY DESIGN MANUAL, PART 4 2007.
- LIVE LOAD DISTRIBUTION TO BEAMS IS BASED ON DM-4 DISTRIBUTION FACTOR METHOD.
- DESIGN IS IN ACCORDANCE WITH THE LRFD METHOD.

DESIGN LOADS:

- DESIGN LIVE LOADS: PHL-93 OR P-82 (204 KIP PERMIT LOAD)
- DECK LOADS: INCLUDES A SURFACE AREA DENSITY OF 30 PSF FOR FUTURE WEARING SURFACE ON THE DECK SLAB.
- INCLUDES A SURFACE AREA DENSITY OF 15 PSF FOR PERMANENT DECK FORMS WHICH TAKES INTO ACCOUNT THE WEIGHT OF THE FORM, PLUS THE WEIGHT OF THE CONCRETE IN THE VALLEYS OF THE FORMS.

LEGEND:

- - PROPOSED BORING LOCATION
- - LAMINATED ELASTOMERIC BEARINGS REQUIRED
- ➔ - DIRECTION OF TRAFFIC

REFERENCES:

1. FOR TYPICAL SECTION, ADDITIONAL DETAILS AND LOAD RATINGS, SEE SHEET 2.

HYDRAULIC DATA

	50-YEAR	100-YEAR
DRAINAGE AREA	132.3 SQ. MI.	132.3 SQ. MI.
DISCHARGE	10,578 CFS	11,613 CFS
WATER SURFACE ELEVATION	931.26	931.83
STREAM VELOCITY	4.24 FT/S	4.31 FT/S

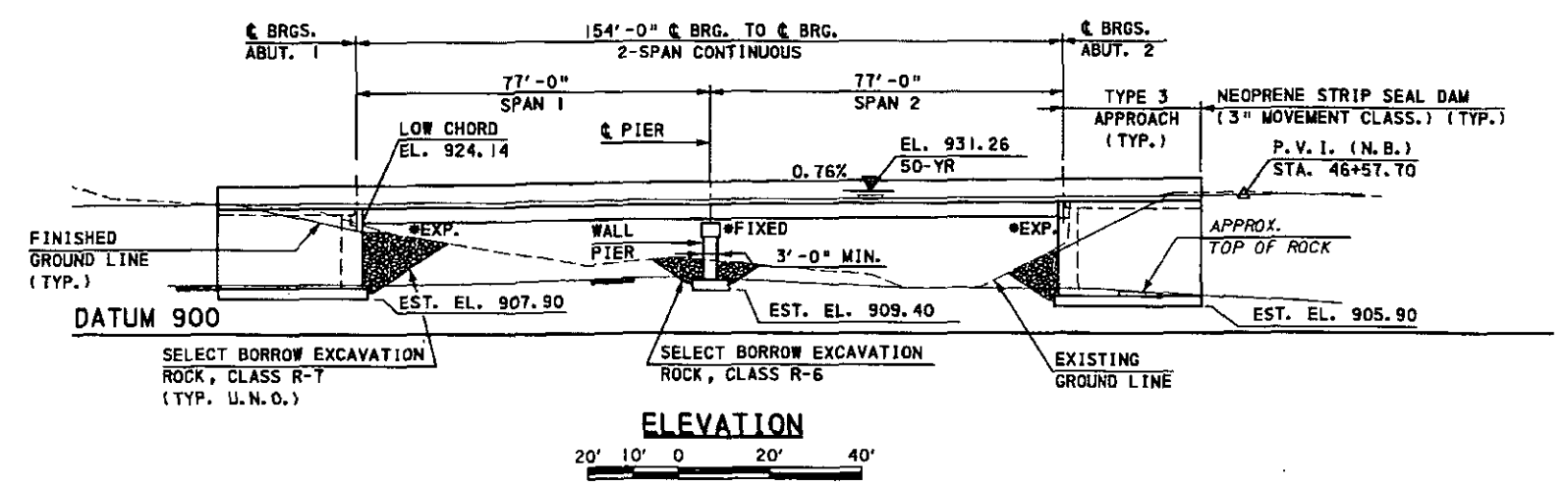

Mark	Description	By	Chk'd	App'd	Date
REVISIONS					

HORIZONTAL CURVE DATA

S.R. 0019 NB	S.R. 0019 SB
PI STA. 42+42.76	PI STA. 13+08.00
Δ = 29° 12' 30" RT.	Δ = 59° 46' 56" RT.
D = 9° 52' 43"	D = 20° 50' 05"
T = 151.12'	T = 158.08'
L = 295.67'	L = 286.93'
R = 580.00'	R = 275.00'
E = 19.36'	E = 42.20'
P. C. = STA. 40+91.64	P. C. = STA. 11+49.92
P. T. = STA. 43+87.31	P. T. = STA. 14+36.86

VERTICAL CURVE DATA

NORTHBOUND	SOUTHBOUND
P. V. I. STA. 46+57.70	P. V. I. STA. 14+70.00
ELEV. 930.61	ELEV. 928.69
V. C. = 70.00'	V. C. = 50.00'
M. O. = -0.22'	M. O. = -0.02'
S. S. D. = 458.96'	S. S. D. = 3611.32'

DESCRIPTION	DWG. NO.	APP. DATE
WALL CONSTRUCTION & EXP. JOINT DETAILS	BC-735M	1-21-03
REINFORCEMENT BAR FABRICATION DETAILS	BC-736M	1-21-03
BRIDGE DRAINAGE	BC-751M	12-29-08
CONCRETE DECK SLAB DETAILS	BC-752M	7-29-05
BEARINGS	BC-755M	12-29-08
NEOPRENE STRIP SEAL DAM FOR PRESTRESSED CONCRETE & STEEL I-BEAM BRIDGES	BC-767M	7-20-07
MISCELLANEOUS PRESTRESS DETAILS	BC-775M	7-20-07
TYPICAL WATERPROOFING AND EXPANSION DAM DETAILS	BC-788M	1-21-03
CLASSIFICATION OF EARTHWORK FOR STRUCTURES	RC-10M	4-15-04
BACKFILL AT STRUCTURES	RC-12M	3-30-06

COMMONWEALTH OF PENNSYLVANIA
DEPARTMENT OF TRANSPORTATION

GREENE COUNTY
S.R. 0019, SECTION P02
SEGMENT 0300 OFFSET 1574 (NB) & 1956 (SB)
S.R. 0019 STA. 45+41.15 (NB) & 15+82.58 (SB)
S.R. 0019 BRIDGE OVER TEN MILE CREEK
2-SPAN, CONCRETE PA BULB-TEE BEAM BRIDGE
TS&L GENERAL PLAN & ELEVATION

SHEET OF 2

S-XXXXX

FILE: K:\051427 - Tron Assoc. - Project Working Files\VA_CADD\Bridges\0300.dwg
 DATE: 09-Jun-2010 12:55
 DESIGNED: KRS
 DRAWN: JWM
 CHECKED: CTY

GENERAL NOTES:

1. PROVIDE MATERIAL AND PERFORM WORK IN ACCORDANCE WITH A.R.E.M.A. MANUAL FOR RAILWAY ENGINEERING, 2010 AS SUPPLEMENTED BY NORFOLK SOUTHERN GUIDELINES FOR DESIGN OF GRADE SEPERATION STRUCTURES, 1999, SPECIFICATIONS PUBLICATION 408/2007, AASHTO/AWS D1.5M 2008 BRIDGE WELDING CODE.
2. DESIGN SPECIFICATIONS:
 - A.R.E.M.A. MANUAL FOR RAILWAY ENGINEERING, 2010 AS SUPPLEMENTED BY NORFOLK SOUTHERN GUIDELINES FOR DESIGN OF GRADE SEPERATION STRUCTURES, 1999.
 - LIVE LOAD DISTRIBUTION TO THROUGH GIRDERS IS BASED UPON SIMPLE BEAM METHOD.
 - DESIGN IN ACCORDANCE WITH THE ALLOWABLE STRESS DESIGN METHOD FOR STRUCTURAL STEEL AND THE LOAD FACTOR DESIGN METHOD FOR REINFORCED CONCRETE.
3. DESIGN LIVE LOADS:
 - SUPERSTRUCTURE: COOPER E-80 OR ALTERNATIVE LIVE LOAD WITH DIESEL LOCOMOTIVE IMPACT.
 - SUBSTRUCTURE: COOPER E-80 LIVE LOAD WITH DIESEL LOCOMOTIVE IMPACT.
 - FATIGUE DESIGN: 2,000,000 CYCLES.
 - DESIGN SPEED: 30 MPH (FRA CLASS 3 TRACK)
4. DEAD LOADS:
 - INCLUDES THE WEIGHT OF AN ADDITIONAL 6" OF BALLAST TO ACCOUNT FOR FUTURE TRACK SURFACING.
5. GENERAL
 - FRACTURE CRITICAL MEMBERS (FCM) INCLUDE THROUGH GIRDER WEB PLATES AND BOTTOM FLANGE PLATES.
 - ALL WORK IS TO BE COORDINATED WITH THE RAILROAD. THE RAILROAD IS TO FURNISH AND PLACE BALLAST, TIES AND RAILS.

LEGEND:

• - MEASURED TO INSTANTANEOUS TANGENT

Mark	Description	By	Chk'd	App'd	Date
REVISIONS					

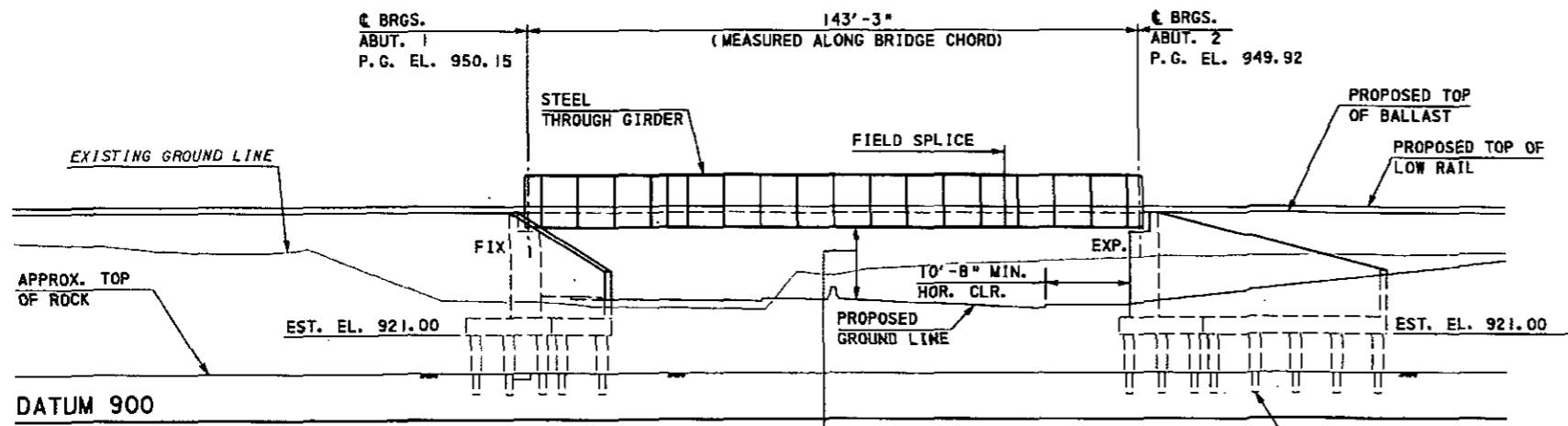
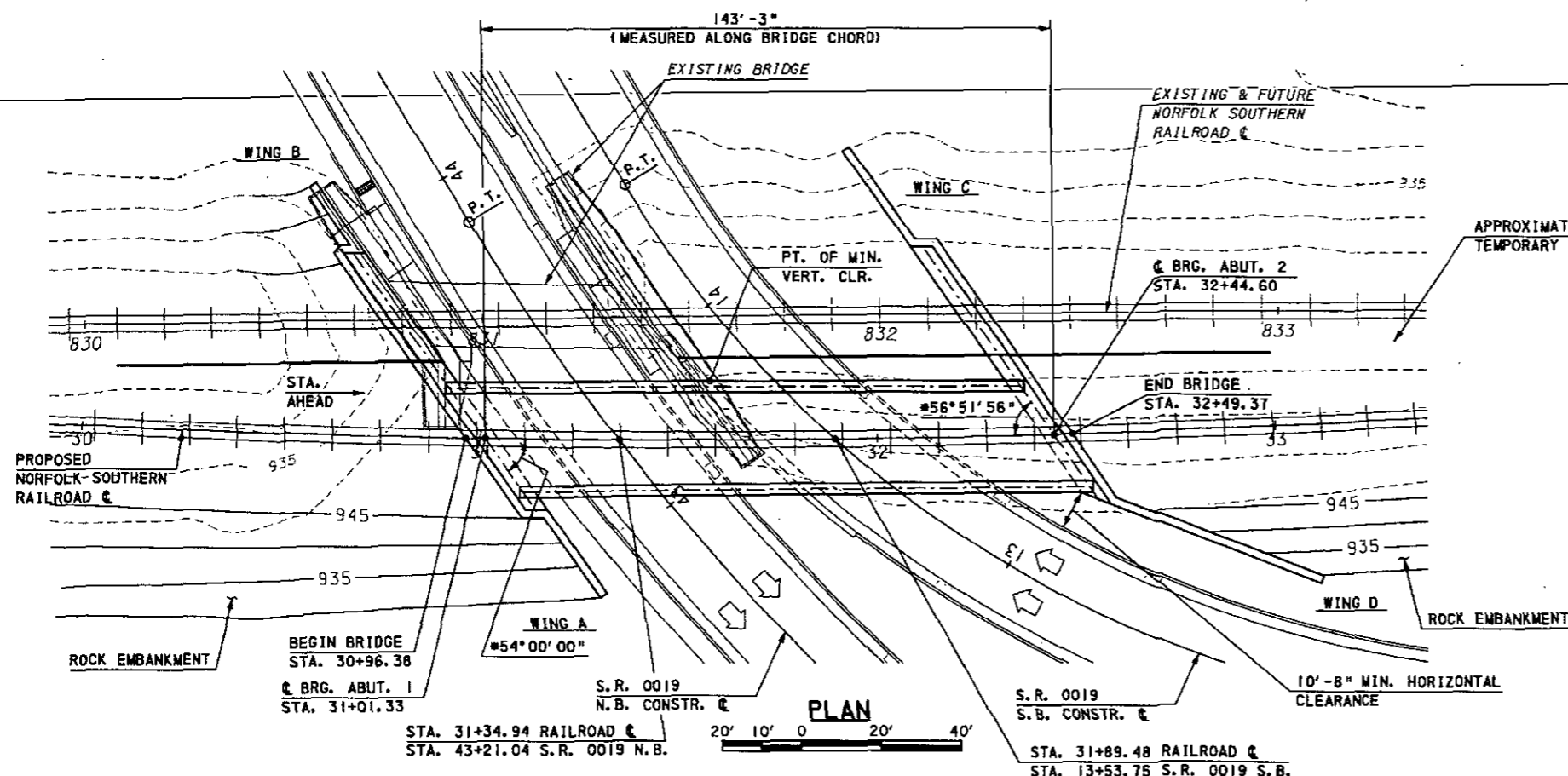

VERTICAL CURVE DATA

PROPOSED NS RAILROAD
 PVI STA. 33+17.38
 ELEV. 950.57
 VC = 817.67'
 MO = -0.84'
 S.S.D. = 1728.62'

HORIZONTAL CURVE DATA

PROPOSED NS RAILROAD
 P.I STA. 31+55.50
 $\Delta = 7^{\circ}10'05''$ LT.
 $\Delta_a = 5^{\circ}55'41''$ LT.
 Ro = 2864.93'
 Lo = 296.42'
 LS = 62.00'
 $\theta = 0^{\circ}37'12''$ LT
 Ts = 210.34'
 Es = 5.675'
 K = 31.00'
 P = 0.06'
 Xc = 62.00'
 Yc = 0.22'
 Lt = 41.33'
 St = 20.67'
 Lc = 62.00'

MIN. PROPOSED VERT. CLR. = 16'-8 1/2"
 MIN. REQUIRED VERT. CLR. = 16'-6"

ELEVATION



PREPARED BY:
 GANNETT FLEMING, INC.
 PITTSBURGH, PA.
 REG. PROF. ENGINEER
 2010

DESCRIPTION	DWG. NO.	APP. DATE
WALL CONSTRUCTION & EXP. JOINT DETAILS	BC-735M	1-21-03
REINFORCEMENT BAR FABRICATION DETAILS	BC-736M	1-21-03
BRIDGE DRAINAGE	BC-751M	12-29-08
NEOPRENE STRIP SEAL DAM FOR PRESTRESSED CONCRETE & STEEL I-BEAM BRIDGES	BC-767M	7-20-07
TYPICAL WATERPROOFING AND EXPANSION DETAILS	BC-788M	1-21-03
CLASSIFICATION OF EARTHWORK FOR STRUCTURES	RC-10M	4-15-04
BACKFILL AT STRUCTURES	RC-12M	3-30-06

COMMONWEALTH OF PENNSYLVANIA
 DEPARTMENT OF TRANSPORTATION

GREENE COUNTY
 S.R. 0019, SECTION P02
 SEGMENT 0000 OFFSET 0000
 RAILROAD & STATION 31+72.97
 NORFOLK SOUTHERN RAILROAD BR OVER S.R. 0019
 SIMPLE SPAN STEEL THROUGH GIRDER BRIDGE
TS&L GENERAL PLAN & ELEVATION

RECOMMENDED _____ SHEET 1 OF 2
S-XXXXX

FILE: M:\051427 - Trane AssocVE - Proj\001 Working Files\A. CAD\Br 100\BR-100.dwg
 DATE: 01-Apr-2010 08:17
 DESIGNED:KRS
 DRAWN:JWM
 CHECKED:CTV



pennsylvania

DEPARTMENT OF TRANSPORTATION

www.dot.state.pa.us

**PENNDOT
DISTRICT 12-0
P.O. BOX 459
UNIONTOWN, PA 15401**



UNITED STATES POSTAGE

02 1A \$ 02.75⁰
0004621459 NOV 08 2010
MAILED FROM ZIP CODE 15401

PA DEPARTMENT OF TRANSPORTATION
P.O. Box 459
Uniontown, PA 15401



Ms. Rosemary Chiavetta, Secretary
Pennsylvania Public Utility Commission
P.O. Box 3265
Harrisburg, PA 17105-3265

RECEIVED
2010 NOV 12 PM 3:41
PA.P.U.C.
SECRETARY'S BUREAU

10