

COUNTY OF



ALLEGHENY

RICH FITZGERALD  
COUNTY EXECUTIVE

March 4, 2015

Rosemary Chivetta, Secretary  
Pennsylvania Public Utility Commission  
P.O. Box 3265  
Harrisburg, PA 17105-3265

**Re: PUC Application Docket No.  
Application of the County of Allegheny for approval of the alteration  
of an existing crossing where the S. Tenth Street Bridge (AAR 918499V)  
crosses above grade, the tracks of CSX Transportation, Inc. in the  
City of Pittsburgh, Allegheny County**

Dear Secretary Chivetta:

Enclosed please find for filing with the Commission, the original and two (2) copies of an application from the County of Allegheny seeking issuance of an order for the construction of the S. Tenth Street Bridge at its initial cost and expense, provided a hearing is held at a subsequent date for the allocation of costs and expenses incident to the project.

The filing of this application is incident to a project that will rehabilitate the existing bridge over the railroad. Plan sheets showing the location, plan view and typical roadway section are attached.

Very truly yours,

Stephen G. Shanley, P.E.  
Director

SGS/RLC/ms

Enclosures

cc: Richard Connors (ACDPW), David Wright (ACDPW), Matthew Steele (CDR Maguire)

BRDG-15-0164

PA P.U.C.  
SECRETARY'S BUREAU

2015 MAR 18 AM 10:14

RECEIVED



STEPHEN G. SHANLEY, P.E., DIRECTOR  
DEPARTMENT OF PUBLIC WORKS  
501 COUNTY OFFICE BUILDING • 542 FORBES AVENUE  
PITTSBURGH, PA 15219  
PHONE (412) 350-4005 • WWW.ALLEGHENYCOUNTY.US

BEFORE THE  
PENNSYLVANIA PUBLIC UTILITY COMMISSION

In Re: PUC Application Docket No. )	APPLICATION DOCKET
Application of the County of Allegheny for )	No.
approval of the alteration of an existing )	
crossing where the S. Tenth Street Bridge )	
(AAR 918499V) crosses above grade, the )	
tracks of CSX Transportation, Inc. in the )	
City of Pittsburgh, Allegheny County )	2015

TO THE PENNSYLVANIA PUBLIC UTILITY COMMISSION:

1. The name and address of the applicant is Allegheny County, County Manager, County Courthouse, Pittsburgh, PA 15219.
2. The name and address of the Counsel for the applicant is Michael H. Wojcik, County Solicitor, 300 Fort Pitt Commons Building, 445 Fort Pitt Boulevard, Pittsburgh, PA 15219.
3. The specific matter of this application is as follows:
  - a) The subject of this application is the rehabilitation of the structure that carries S. Tenth Street over the tracks of CSX Transportation, Inc.
  - b) The rehabilitation of the structurally deficient bridge is necessary for the safety and convenience of the traveling public.
  - c) The rehabilitation consists of painting, sidewalk and roadway replacement, steel and cable repairs, substructure repairs including abutments, piers and retaining walls and a dehumidification system for the cable vault.
  - d) The ADT in 2015 is 12,002 and is projected to be 13,671 in the year 2035.
4. Applicant believes that the following are affected by this application and should respond thereto:
  - a) Duquesne Light Company, 2825 New Beaver Avenue, Pittsburgh, PA 15233  
Attn: Jim Runatz 412-393-7813
  - b) Peoples Gas Company, 1201 Pitt Street, Pittsburgh, PA 15221  
Attn: Shane Moriarty 412-473-3962
  - c) Verizon of Pennsylvania, 15 E. Montgomery Avenue, Second Floor, Pittsburgh, PA 15212  
Attn: Mr. Jon Gaunt 412-255-8941

RECEIVED  
2015 MAR 18 AM 10:14  
PA P.U.C.  
SECRETARY'S BUREAU

- d) Level 3 Communications LLC, 122 Capital of TX Highway S,  
Austin, TX 78746  
Attn: Mr. Travor Pecvey 512-742-3700
  - e) Comcast, 300 Corliss Street, Pittsburgh, PA 15220  
Attn: Mr. Rick Moslen 412-999-0590
  - f) CSXT, 4901 Belfort Road, Jacksonville, FL 32256  
Attn: Leslie L. Scherr 904-366-3057
  - g) Pennsylvania Dept of Transportation, Office of Chief Counsel,  
Keystone Bldg., 400 North Street, Harrisburg, PA 17120  
Attn: Gina Alfonso, Esq. 717-787-3128
  - h) Pennsylvania Department of Transportation, District 11-0,  
45 Thoms Run Road, Bridgeville, PA 15017  
Attn: Malek Francis 412-429-4949
5. Applicant proposes to perform the work specified above at its initial cost and expense, utilizing funding assistance from the Commonwealth and Federal funding. The relocation of utilities, if required, should be at the initial cost and expense of the utility company involved.
6. Applicant requests field conferences and hearings to determine the allocation of the costs thereof.

WHEREFORE, applicant prays that your Honorable Commission approve this application.

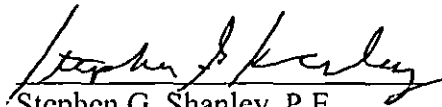
  
Stephen G. Shanley, P.E.  
Director, Allegheny County  
Department of Public Works

AFFIDAVIT

COMMONWEALTH OF PENNSYLVANIA )
) SS:
COUNTY OF ALLEGHENY )

STEPHEN G. SHANLEY, P.E., being duly sworn according to law deposes and says that he is the Director of the Department of Public Works of Allegheny County; that he is authorized to and does make this affidavit for the County of Allegheny; and that the facts set forth in the foregoing petition are true and correct to the best of his knowledge, information and belief.

Stephen G. Shanley, P.E.
Director, Allegheny County
Department of Public Works

Sworn to and Subscribed

before me this 11th

day of March, 2015

Jennifer M. Hayes
Notary Public
My Commission Expires 6/21/16

COMMONWEALTH OF PENNSYLVANIA
Notarial Seal
Jennifer M. Hayes, Notary Public
City of Pittsburgh, Allegheny County
My Commission Expires June 21, 2016
MEMBER, PENNSYLVANIA ASSOCIATION OF NOTARIES

RECEIVED
2015 MAR 18 AM 10:14
PA P.U.C. SECRETARY'S BUREAU



FEDERAL PROJECT NO. X-111-547-LICE

DISTRICT	COUNTY	TOWNSHIP	BOROUGH	ROUTE	SECTION	TOTAL SHEETS												
B00	11-0	ALLEGHENY	PITTSBURGH	SOUTH		14												
			1ST WARD &	TENTH														
			17TH WARD	STREET														
WBS ELEMENT																		
T/P	SYS	WO	SPUR	PHA	SECTION	ORG.	PRG.	P_C										
P	0	9	6	5	8	2	0	7	0	0	0	1	1	0	2	2	3	1

ECMS 79881

# COUNTY OF ALLEGHENY



## DEPARTMENT OF PUBLIC WORKS

### DRAWINGS

FOR

### DESIGN FIELD VIEW

OF

### PHILIP MURRAY BRIDGE (SOUTH TENTH STREET BRIDGE)

IN ALLEGHENY COUNTY

FROM STA. 0+00.00 TO STA. 21+70.00 LENGTH 2121.65 FT. 0.402 MI.

#### ALSO PLANS:

TRAFFIC CONTROL PLAN	15 SHEETS
SIGNING AND PAVEMENT MARKING PLAN	3 SHEETS
EROSION AND SEDIMENT CONTROL PLANS	6 SHEETS
STRUCTURE PLANS	2 SHEETS
EXISTING STRUCTURE PLANS (FOR INFORMATION ONLY)	X SHEETS

RECEIVED  
2015 MAR 18 AM 10:15  
PA. P.U.S. BUREAU  
SECRETARY'S BUREAU

#### SCALE

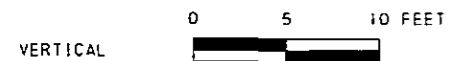
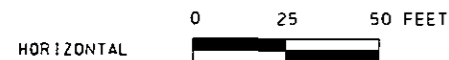

#### DESIGN DESIGNATION

HIGHWAY CLASSIFICATION - URBAN PRINCIPAL ARTERIAL  
ROADWAY TYPOLOGY - COMMUNITY ARTERIAL - URBAN CORE  
DESIGN SPEED - 25 MPH  
PAVEMENT WIDTH - 3, 10'-0" / 2, 5'-0"  
MEDIAN WIDTH - N/A  
SHOULDER WIDTH - N/A

#### TRAFFIC DATA

CURRENT A. D. T. - 12002 (2015)  
DESIGN YEAR A. D. T. - 13671 (2035)  
D. H. V. - 1486  
D - 55%  
T - 5%

#### APPROVED

BY THE COUNTY MANAGER  
OF ALLEGHENY COUNTY

\_\_\_\_\_  
DATED \_\_\_\_\_ THAT AUTHORIZED THE ADVERTISEMENT  
OF THIS PROJECT FOR CONSTRUCTION

PREPARED BY:

**AECOM** AECOM TECHNICAL SERVICES, Inc.  
707 GRANT STREET  
GULF TOWER, 5TH FLOOR  
PITTSBURGH, PA 15219

REG. PROF. ENGR. PENNA NO. \_\_\_\_\_

DATE: \_\_\_\_\_

#### APPROVED

COMMONWEALTH OF PENNSYLVANIA  
DEPARTMENT OF TRANSPORTATION

RECOMMENDED \_\_\_\_\_ DATE \_\_\_\_\_

DISTRICT EXECUTIVE \_\_\_\_\_ DATE \_\_\_\_\_

#### APPROVED

ALLEGHENY COUNTY  
DEPARTMENT OF PUBLIC WORKS

CHIEF BRIDGE ENGINEER \_\_\_\_\_ DATE \_\_\_\_\_

DEPUTY DIRECTOR \_\_\_\_\_ DATE \_\_\_\_\_

DIRECTOR \_\_\_\_\_ DATE \_\_\_\_\_

# County of Allegheny



Pittsburgh, Pennsylvania

Department of Public Works

### CONSTRUCTION DRAWINGS

FOR  
RECONSTRUCTION  
OF  
PHILIP MURRAY BRIDGE-PHASE 2  
(SOUTH TENTH STREET BRIDGE)

COUNTY PROJECT NO. MA11-3511

DES. JLT	DRN. BEH	CHK. JAS	26099-B
DATE 10/3/13	SCALE AS NOTED	SHEET 1 OF 14	

1/10/2/8/1

SHEET INDEX	
DESCRIPTION	SHEET
TITLE SHEET	1
INDEX MAP	2
LOCATION MAP AND GENERAL NOTES	3
TYPICAL SECTION SHEET	4
DRAINAGE DETAILS	5 TO 6
ROADWAY PLAN	7 TO 11
PROFILE	12 TO 14
SUPPLEMENTAL PLANS	
TRAFFIC CONTROL PLAN	1 TO 15
SIGNING AND PAVEMENT MARKING PLAN	1 TO 3
EROSION AND SEDIMENT CONTROL PLANS	1 TO 6
STRUCTURE PLANS	1 TO 2
EXISTING STRUCTURE PLANS (FOR REFERENCE ONLY)	1 TO X

**RECORD OF EXISTING ROAD TYPES**

NOTE: THE DEPTHS OF MATERIAL SHOWN ARE FOR DESIGN PURPOSES ONLY. ANY RISK OF UNANTICIPATED COST ASSOCIATED WITH DIFFERENCES BETWEEN THE LISTED DEPTHS AND THE ACTUAL DEPTHS SHALL BE ACCEPTED BY THE CONTRACTOR.

- STA. 0+00.00 TO STA. 7+71.16  
6 1/4" BITUMINOUS WEARING COURSE OR MASONRY OVERLAY ON 9" REINFORCED PCC BASE COURSE ON 8" BALLAST SUBBASE
- STA. 7+71.16 TO STA. 20+46.16  
2 - 3 1/2" BITUMINOUS WEARING COURSE ON 1" BITUMINOUS LEVELING COURSE ON 3" CONCRETE FILLED GRID
- STA. 20+46.16 TO STA. 21+70.00  
6 1/4" BITUMINOUS WEARING COURSE OR MASONRY OVERLAY ON 9" REINFORCED PCC BASE COURSE ON 8" BALLAST SUBBASE

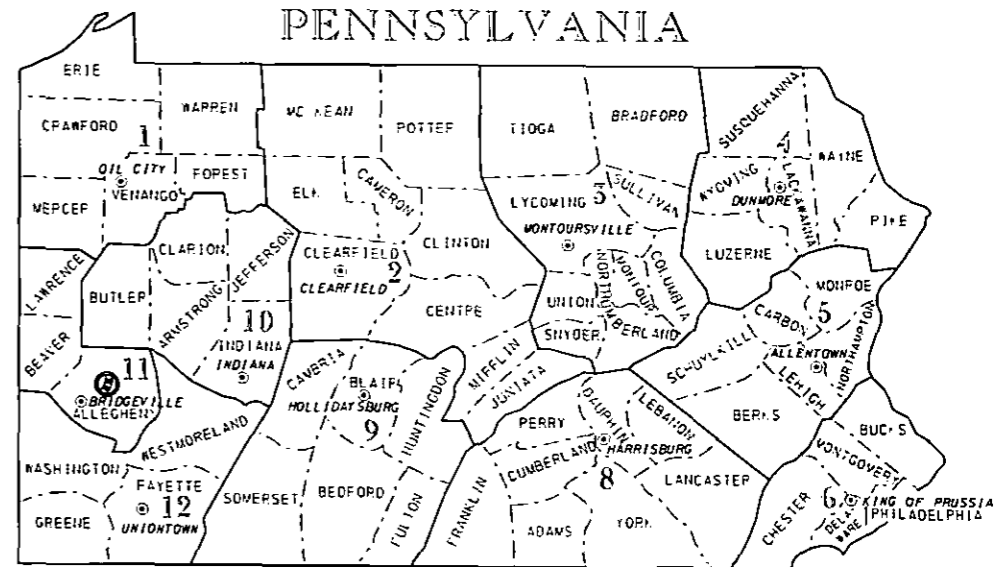

11 DISTRICT  
DISTRICT OFFICE  
PROJECT LOCATION

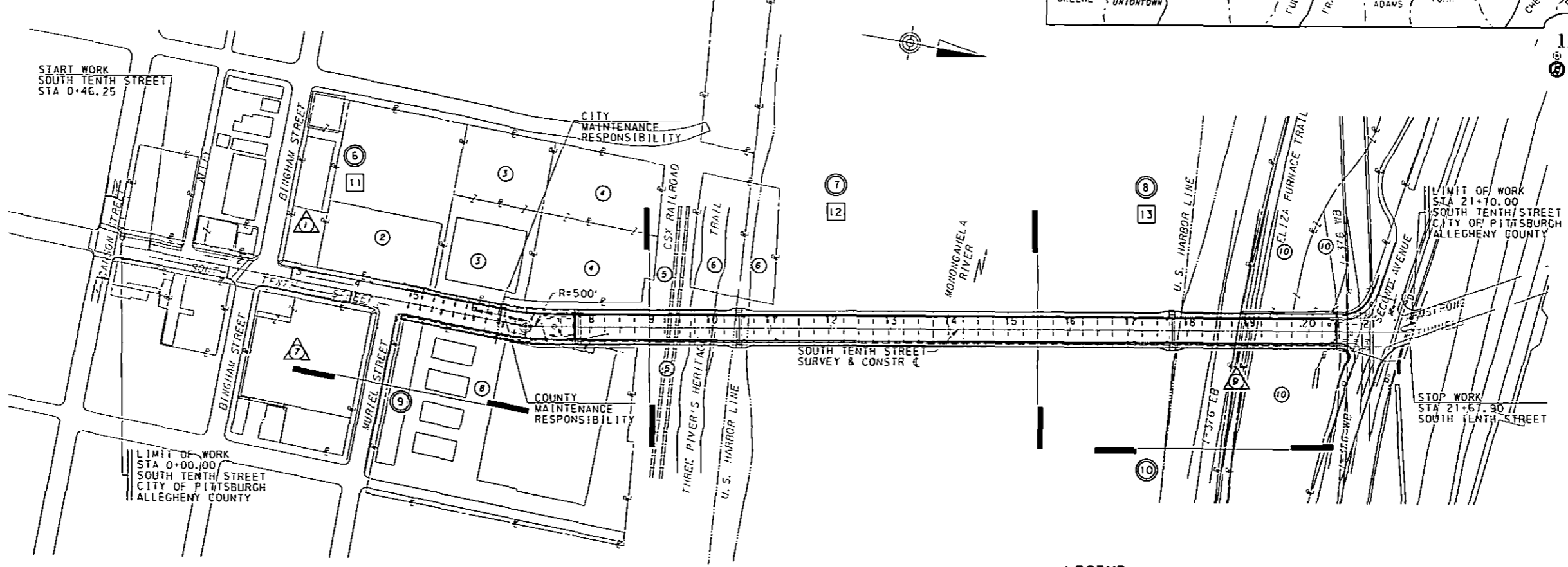

**LIST OF PROPERTY OWNERS**

- 1 CITY OF PITTSBURGH
- 2 IRONWORKS PLAZA, L.P.
- 3 10TH STREET BUSINESS ASSOCIATES, A PENNSYLVANIA LIMITED PARTNERSHIP
- 4 PWA 10TH STREET DEVELOPMENT, LP, A PENNSYLVANIA LIMITED PARTNERSHIP
- 5 CSX TRANSPORTATION, INC
- 6 CITY OF PITTSBURGH
- 7 UNIVERSITY OF PITTSBURGH MEDICAL CENTER SYSTEM
- 8 D. THOMAS MISTIC & M. ROBERT MISTIC
- 9 CITY OF PITTSBURGH
- 10 PUBLIC PARKING AUTHORITY OF PITTSBURGH

**LEGEND**

- PLAN SHEET
- PROFILE SHEET
- PARCEL IDENTIFICATION NUMBER
- △ PARCEL IDENTIFICATION NUMBER - NO TAKE
- SHEET LIMITS

SCALE: 0 100 200 FEET

**County of Allegheny**  
Billsburg, Pennsylvania  
Department of Public Works

CONSTRUCTION DRAWING  
INDEX MAP

PHASE 2  
PHILIP MURRAY BRIDGE  
MA11-3511

DES.	DRN.	CHK.	26099-B
DATE 10/9/13	SCALE NOTED	SHEET 2 OF 14	

I:\1600506\10 51011 5111-up\plans\Phase 2\102 - Index map.dgn 9:15:43 AM 1/8/2014

**TABULATION OF OVERALL AND CONSTRUCTION LENGTH**

**OVERALL LENGTH**

SOUTH TENTH STREET STA 0+00.00 TO STA 21+70.00 = 2170 FT = 0.411 MILES

**CONSTRUCTION LENGTH**

SOUTH TENTH STREET STA 0+46.25 TO STA 21+67.90 = 2121.65 FT = 0.402 MILES

**TABULATION OF EQUALITIES**

NONE

**SUMMARY OF PROJECT COORDINATES**

BASED ON PENNSYLVANIA STATE PLAN COORDINATE SYSTEM (SOUTH ZONE) COMBINED FACTOR 0.99992670

ROUTE	STATION	POINT	COORDINATES		BEARING
			NORTH	EAST	
SOUTH TENTH STREET SURVEY & CONSTR C	0+00.00	POT	406952.0777	1345363.7608	N0°25'42"W
	6+42.10	PC	407594.1632	1345358.9606	
	6+90.01	PI	407642.0726	1345358.6024	
	7+37.63	PT	407689.0421	1345349.1528	N11°22'31"W
	21+70.00	POT	409093.2711	1345066.6423	

NOTE: FOUR (4) PLACE COORDINATES ARE USED FOR COMPUTATIONAL PURPOSES ONLY AND DO NOT IMPLY A PRECISION BEYOND TWO (2) DECIMAL PLACES.

**GENERAL NOTES**

THE LEGAL RIGHT-OF-WAY ON SOUTH TENTH STREET FROM STATION 2+50.00 TO STATION 10+38.94 IS VARIABLE IN WIDTH BASED ON COUNTY OF ALLEGHENY DEPARTMENT OF ENGINEERING AND CONSTRUCTION CONDEMNATION PLAN FOR REHABILITATION OF SOUTH TENTH STREET BRIDGE, COUNTY PROJECT NO. MA11-3506, DATED JULY 7, 1989 AND APPROVED JULY 24, 1989.

THE LEGAL RIGHT-OF-WAY ON SOUTH TENTH STREET FROM STATION 10+38.94 TO STATION 17+33.80 AND FROM STATION 18+81.89 TO STATION 20+43.31 IS VARIABLE IN WIDTH BASED ON THE COURT OF QUARTER SESSIONS AUTHORIZED ALLEGHENY COUNTY TO OPEN, CONSTRUCT, AND MAINTAIN THE BRIDGE BY IT'S COMMISSIONERS ROAD DOCKET NO. 3 MAY SESSIONS 1930.

THE LEGAL RIGHT-OF-WAY ON SOUTH TENTH STREET FROM STATION 17+33.80 TO STATION 18+81.89 IS VARIABLE IN WIDTH BASED ON DEPARTMENT OF HIGHWAYS DRAWINGS FOR CONDEMNATION OF RIGHT-OF-WAY FOR L.R. 764 SECTION C-10 AS RECORDED IN HIGHWAY PLAN BOOK VOLUME 10, PAGES 28 TO 41, INCLUSIVE ON SEPTEMBER 8, 1952.

THE LEGAL RIGHT-OF-WAY ON SOUTH TENTH STREET FROM STATION 20+43.31 TO STATION 21+70.00 IS VARIABLE IN WIDTH BASED ON DEPARTMENT OF HIGHWAYS DRAWINGS FOR CONDEMNATION OF RIGHT-OF-WAY FOR L.R. 764 SECTION C-10 AS RECORDED IN HIGHWAY PLAN BOOK VOLUME 10, PAGES 28 TO 41, INCLUSIVE ON SEPTEMBER 8, 1952.

PRIVATE PROPERTY LINES ARE PLOTTED FROM THE DEED OF RECORD, RECORDED SUBDIVISION OR LOT PLANS, EXISTING TOPOGRAPHICAL FEATURES AND LIMITED FIELD DATA. PRIVATE PROPERTY LINES WERE NOT SURVEYED BY THE PROFESSIONAL LAND SURVEYOR RESPONSIBLE FOR THE PROJECT.

THE COUNTY DOES NOT GUARANTEE THE ACCURACY OF THE LOCATIONS OF THE EXISTING SUBSURFACE UTILITY STRUCTURES SHOWN ON THE PLANS, NOR DOES THE COUNTY GUARANTEE THAT ALL SUBSURFACE STRUCTURES ARE SHOWN.

THREE WORKING DAYS PRIOR TO EXCAVATION, THE CONTRACTOR MUST CONTACT THE PA ONE CALL SYSTEM INC., PHONE: 1-800-242-1776, SERIAL NUMBER \_\_\_\_\_ FOR 1ST WARD AND SERIAL NUMBER \_\_\_\_\_ FOR 17TH WARD.

TEMPORARY CONSTRUCTION EASEMENT. AN EASEMENT TO USE THE LAND AS NECESSARY DURING CONSTRUCTION OF THE PROJECT. THE EASEMENT IS REQUIRED ONLY UNTIL THE CONSTRUCTION OR WORK INDICATED BY THE PLAN IS COMPLETED, UNLESS SOONER RELINQUISHED IN WRITING BY THE DEPARTMENT.

"ONE CALL" SERVICES DO NOT LOCATE BURIED RAILROAD SIGNAL AND COMMUNICATIONS LINES. THE CONTRACTOR SHALL CONTACT THE RAILROAD'S REPRESENTATIVE 2 DAYS IN ADVANCE OF WORK AT THOSE PLACES WHERE EXCAVATION, PILE DRIVING, OR HEAVY LOADS MAY DAMAGE RAILROAD UNDERGROUND LINES ON RAILROAD PROPERTY. UPON REQUEST FROM THE CONTRACTOR OR AGENCY, RAILROAD SIGNAL FORCES WILL LOCATE AND PAINT MARK OR FLAG RAILROAD UNDERGROUND SIGNAL, COMMUNICATION, AND POWER LINES IN THE AREA TO BE DISTURBED FOR THE CONTRACTOR. THE CONTRACTOR SHALL AVOID EXCAVATION OR OTHER DISTURBANCE OF THESE LINES WHICH ARE CRITICAL TO THE SAFETY OF THE RAILROAD AND THE PUBLIC. IF DISTURBANCE OR EXCAVATION IS REQUIRED NEAR A BURIED RAILROAD SIGNAL, COMMUNICATION, OR POWER LINE, THE CONTRACTOR SHALL COORDINATE WITH THE RAILROAD TO HAVE THE LINE POTHOLED MANUALLY WITH CAREFUL HAND EXCAVATION. THE LINE SHALL BE PROTECTED BY THE CONTRACTOR DURING THE COURSE OF THE DISTURBANCE UNDER THE SUPERVISION AND DIRECTION OF A RAILROAD SIGNAL REPRESENTATIVE.

CONSTRUCT PROJECT IN ACCORDANCE WITH THE LATEST EDITION OF PUBLICATION 40B SPECIFICATIONS.

DO NOT INTERFERE WITH THE OPERATION OF ANY FIRE HYDRANT, FIRE CALL BOX OR POLICE CALL BOX.

THIS IS A FEDERAL-AID PROJECT AND AS SUCH IS SUBJECT TO INSPECTION BY REPRESENTATIVES OF THE FEDERAL HIGHWAY ADMINISTRATION AND THE PENNSYLVANIA DEPARTMENT OF TRANSPORTATION.

VERTICAL CONTROL IS BASED ON NATIONAL GEODETIC VERTICAL DATUM (NAVD) OF 1988.

HORIZONTAL CONTROL IS TIED TO THE PENNSYLVANIA STATE PLANE COORDINATE SYSTEM (SOUTH ZONE) BASED ON THE NORTH AMERICAN DATUM 1983 (NAD83).

ALL CURVE DATA IS BASED ON THE ARC DEFINITION UNLESS OTHERWISE INDICATED.

MONONGAHELA RIVER IS A NAVIGABLE RIVER.

**CALL BEFORE YOU DIG!**  
PENNSYLVANIA LAW REQUIRES 3 WORKING DAYS NOTICE FOR CONSTRUCTION PHASE AND 10 WORKING DAYS IN DESIGN STAGE - STOP CALL  
PENNSYLVANIA ONE CALL SYSTEM, INC



1-800-242-1776

DESIGN SERIAL NO. 20132771830 (17TH WARD)  
20132771829 (1ST WARD)

LIMIT OF WORK  
STA 21+70.00  
SOUTH TENTH STREET  
CITY OF PITTSBURGH  
ALLEGHENY COUNTY

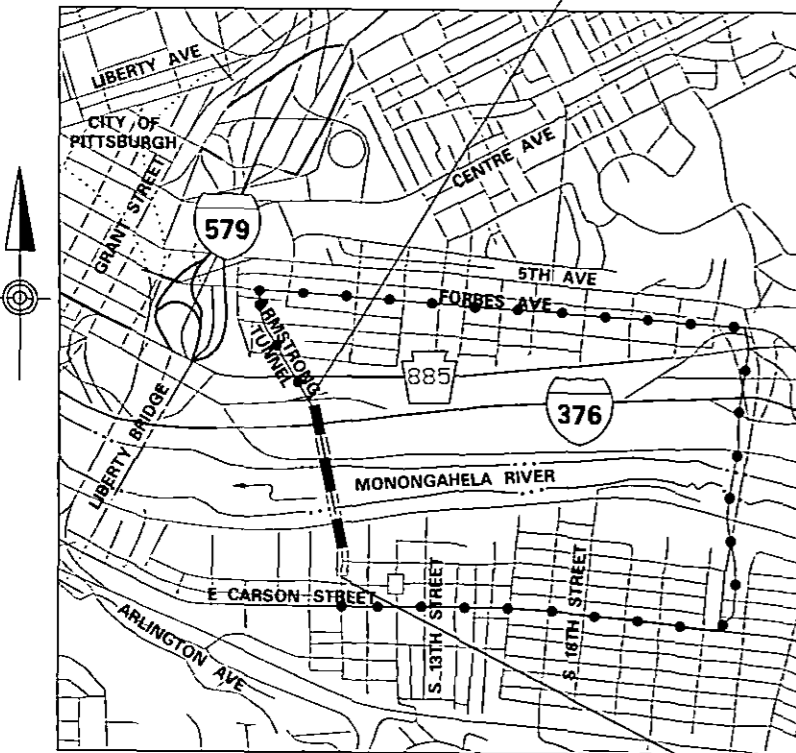

**LOCATION MAP**

SCALE IN MILES

0 0.75 1.5

**LEGEND**

- PROJECT
- STATE ROUTE
- TOWNSHIP ROAD
- LOCAL STREET
- STREAM/RIVER
- DETOUR ROUTE

EQUITABLE GAS COMPANY  
200 ALLEGHENY CENTER  
PITTSBURGH, PA 15212  
PHONE: 412-395-3642  
ATTN: SEAN KOZIELEC

VERIZON PENNSYLVANIA, INC.  
131 SETON HILL DRIVE - FLOOR 3B  
GREENSBURG, PA 15601  
PHONE: 412-255-8941  
ATTN: JON GAUNT

COLUMBIA GAS OF PA  
150 HILLSIDE DRIVE  
BETHEL PARK, PA 15102  
PHONE: 412-409-4068  
ATTN: DUSTIN HAGG

ALLEGHENY COUNTY SANITARY AUTHORITY  
3300 PREBLE AVENUE  
PITTSBURGH, PA 15233  
PHONE: 412-766-4810 EXT 8283  
ATTN: KENNETH M. BABIN

THE PITTSBURGH WATER AND SEWER AUTHORITY  
PENN LIBERTY PLAZA I  
1200 PENN AVENUE - 2ND FLOOR  
PITTSBURGH, PA 15222-4204  
PHONE: 724-678-7193  
ATTN: ANTHONY TETI

LEVEL 3 COMMUNICATIONS LLC  
200 TECHNOLOGY DRIVE  
PITTSBURGH, PA 15219  
PHONE: 412-770-9285  
ATTN: STEPHEN PUTT

AT&T  
4310 DUTCH RIDGE ROAD  
PITTSBURGH, PA 15220  
PHONE: 412-979-4452  
ATTN: FRANK FISHER  
(MICHAEL BAKER CORPORATION)

DUQUESNE LIGHT COMPANY  
2601 PREBLE AVENUE  
PITTSBURGH, PA 15233  
PHONE: 412-393-7813  
ATTN: RUSTY HUGHES

VERIZON BUSINESS  
200 CHESTNUT STREET  
PHILADELPHIA, PA 19106  
PHONE: 610-337-6707  
ATTN: JOHN ALESSANDRINI

AT&T METRO/LSN  
2500 ALLEGHENY CENTER  
PITTSBURGH, PA 15212  
PHONE: 412-316-9930  
ATTN: JAMES SCHRENK

DQE COMMUNICATIONS  
411 SEVENTH AVENUE  
PITTSBURGH, PA 15219  
PHONE: 412-779-0221  
ATTN: JAMES SCANLON

CITY OF PITTSBURGH STREET LIGHTING  
414 GRANT STREET, ROOM 301  
PITTSBURGH, PA 15219  
ATTN: BEN CARLISE

CITY OF PITTSBURGH TRAFFIC SIGNALS  
414 GRANT STREET, ROOM 301  
PITTSBURGH, PA 15219  
ATTN: MS. AMANDA PURCELL, P. E.

CSXT  
500 WATER STREET, C907  
JACKSONVILLE, FL 32202  
PHONE: 904-359-1036  
ATTN: CARL A. ROE, JR. P. E.

**LIST OF NON-UTILITIES**

DETAILS OTHER THAN THOSE INDICATED, ARE ON THE FOLLOWING STANDARD DRAWINGS.

RC-20M (7 SHEETS)	JUNE 1, 2010	TC-8600	JUNE 23, 2009
RC-21M	JUNE 1, 2010	TC-8716	JUNE 23, 2009
RC-27M (2 SHEETS)	JUNE 1, 2010	TC-8717	JUNE 23, 2009
RC-30M (5 SHEETS)	JUNE 1, 2010	TC-8604	JUNE 23, 2009
RC-64M	JUNE 1, 2010	TC-8700C	JUNE 23, 2009
RC-67M (14 SHEETS)	JUNE 10, 2013	TC-8800	DECEMBER 12, 2011
BC-701M (3 SHEETS)	MAY 18, 2012		
BC-713M (13 SHEETS)	OCTOBER 26, 2010		
BC-716M (2 SHEETS)	MAY 18, 2012		
BC-721M (2 SHEETS)	OCTOBER 26, 2010		
BC-736M (3 SHEETS)	MAY 18, 2012		
BC-767M (6 SHEETS)	MAY 18, 2012		
BC-783M (4 SHEETS)	MAY 18, 2012		
BC-788M (11 SHEETS)	MAY 18, 2012		

**EARTHWORK SUMMARY ENTIRE PROJECT**

THE INFORMATION ON ESTIMATED AMOUNTS OF EARTHWORK HAS BEEN USED IN THE PRELIMINARY ESTIMATE. DO NOT USE AS A WAIVER OF ANY PROVISIONS OF THE SPECIFICATIONS AND CONTRACTS.

CUBIC YARDS OF EXCAVATION						CUBIC YARDS OF COMPLETED EMBANKMENT *	CUBIC YARDS OF SELECTED BORROW EXCAVATION	CUBIC YARDS OF FOREIGN BORROW EXCAVATION	CUBIC YARDS OF WASTE
CLASS 1	CLASS 1A	CLASS 1B	CLASS 2	CLASS 3 **	CLASS 4				
0	0	0	0	0	0	0	0	0	0

\* INCLUDES ALL BORROW ITEMS  
\*\* INCLUDED IN LUMP SUM STRUCTURE ITEMS

**County of Allegheny**

Pittsburgh, Pennsylvania  
Department of Public Works

REVISIONS  
CONSTRUCTION DRAWING  
LOCATION MAP AND GENERAL NOTES

PHASE 2  
PHILIP MURRAY BRIDGE  
MA11-3511

DES.	DRN.	CHK.	26099-B
DATE 10/9/13	SCALE NOTED	SHEET 3 OF 14	

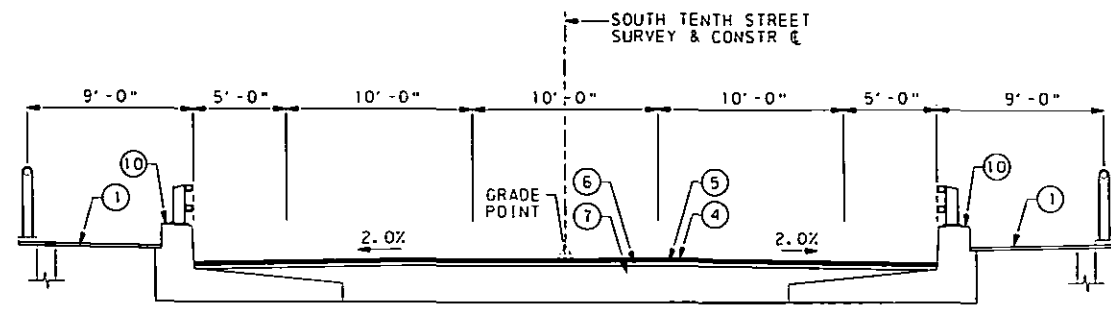

**SOUTH TENTH STREET  
PROPOSED TYPICAL SECTION**

NTS  
STA 4+82.21 TO STA 6+97.16

EXISTING SIDEWALK  
(TO REMAIN)  
EXISTING RAILING  
(TO REMAIN)  
REPLACE EXISTING  
FENCING WITH NEW  
RAILING (TYP)  
(SEE STRUCTURE PLANS)

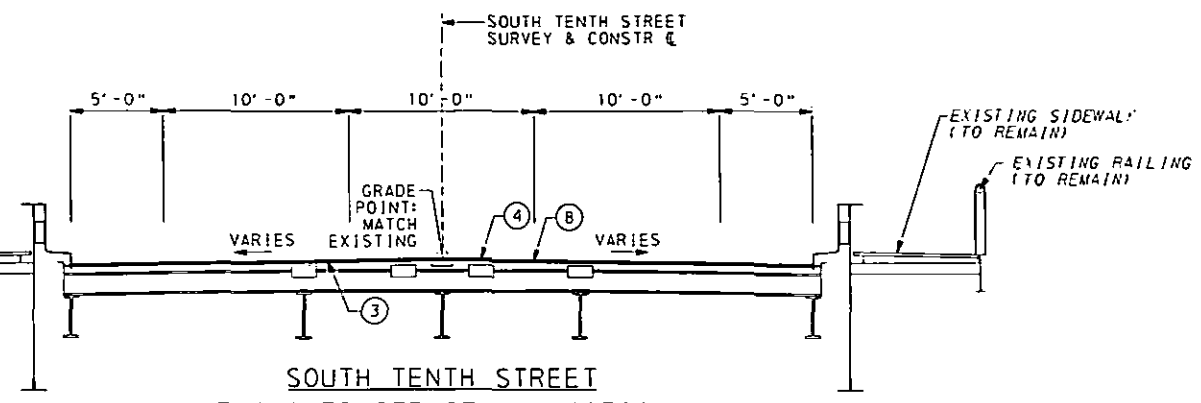

**SOUTH TENTH STREET  
PROPOSED STRUCTURE SECTION**

NTS  
STA 7+71.16 TO STA 20+46.16

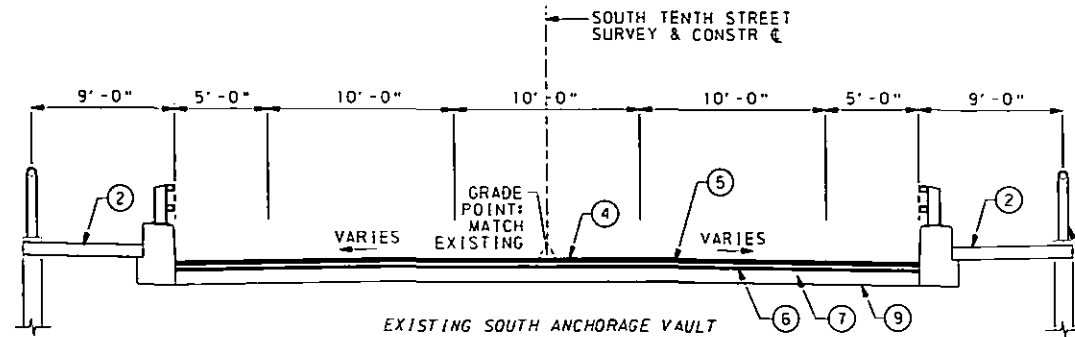

**SOUTH TENTH STREET  
PROPOSED TYPICAL SECTION**

NTS  
STA 6+97.16 TO STA 7+71.16

REPLACE EXISTING  
FENCING WITH NEW  
RAILING (TYP)  
(SEE STRUCTURE PLANS)

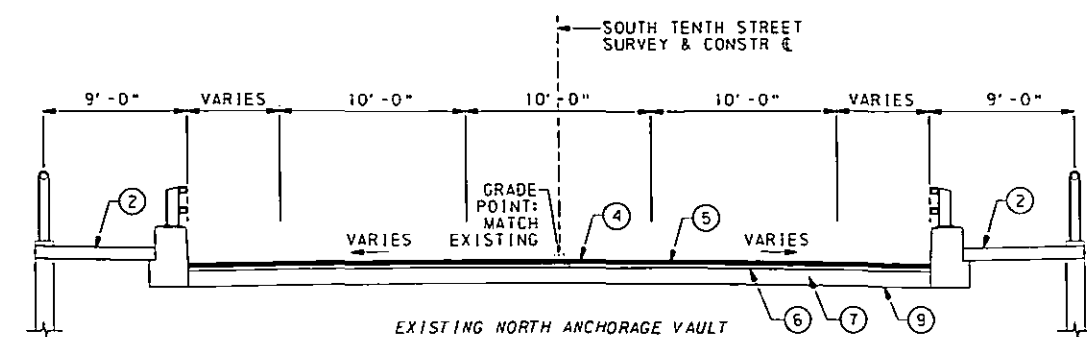

**SOUTH TENTH STREET  
PROPOSED TYPICAL SECTION**

NTS  
STA 20+46.16 TO STA 21+03.66

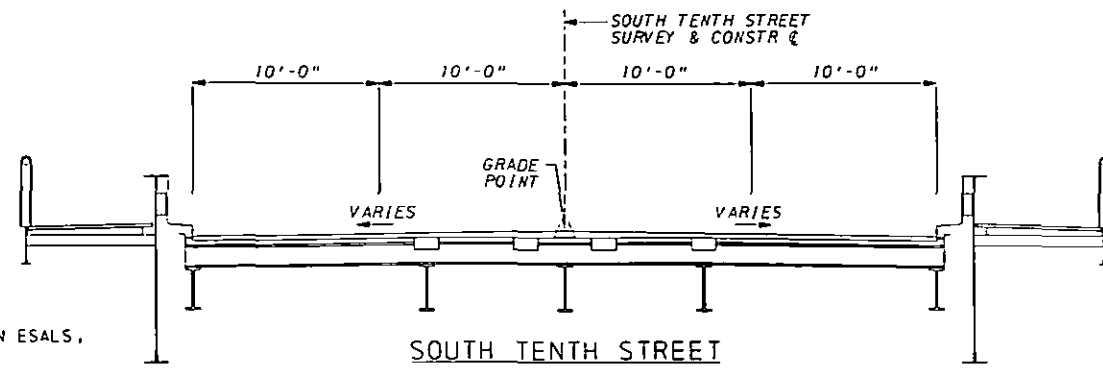

**SOUTH TENTH STREET  
EXISTING STRUCTURE SECTION**

NTS  
STA 7+71.16 TO STA 20+46.16

**NOTES:**

- ① SIDEWALK STEEL GRID REPLACEMENT (SEE STRUCTURAL PLANS)
- ② REINFORCED CONCRETE VAULT ROOF /SIDEWALK AREA (SEE STRUCTURAL PLANS AND DETAIL SHEETS)
- ③ MILLING OF BITUMINOUS PAVEMENT SURFACE, 4" DEPTH MILLED MATERIAL RETAINED BY CONTRACTOR.
- ④ SUPERPAVE ASPHALT MIXTURE DESIGN, WMA WEARING COURSE, PG 64-22, 3 TO <10 MILLION ESALS, 12.5 MM MIX, 2" DEPTH, SRL-E
- ⑤ SUPERPAVE ASPHALT MIXTURE DESIGN, WMA BINDER COURSE, PG 64-22, 3 TO <10 MILLION ESALS, 19.0 MM MIX, 2 1/2" DEPTH
- ⑥ SUPERPAVE ASPHALT MIXTURE DESIGN, WMA BASE COURSE, PG 64-22, 3 TO <10 MILLION ESALS, 25.00 MM MIX, 5" DEPTH
- ⑦ SUBBASE, 12" DEPTH MIN (NO 2A) MODIFIED
- ⑧ SUPERPAVE ASPHALT MIXTURE DESIGN, WMA WEARING COURSE (LEVELING), PG 64-22, 3 TO <10 MILLION ESALS, 12.5 MM MIX, SRL-E
- ⑨ WATERPROOFING MEMBRANE (APPLIED TO TOP OF VAULT ROOF)
- ⑩ PA BRIDGE BARRIER AND MOMENT SLAB (SEE STRUCTURAL PLANS)

**County of Allegheny**  
Pittsburgh, Pennsylvania  
Department of Public Works

REVISIONS		

**CONSTRUCTION DRAWING**  
TYPICAL SECTION SHEET

PHASE 2  
PHILIP MURRAY BRIDGE  
MA11-3511

DES.	DRN.	CHK.	26099-B
DATE 10/9/13	SCALE NOTED	SHEET 4 OF 14	

1/8/2014 9:23:01 AM I:\0050610\_510\trk\51\rdplans\Phase 2\04-typical.s.dgn



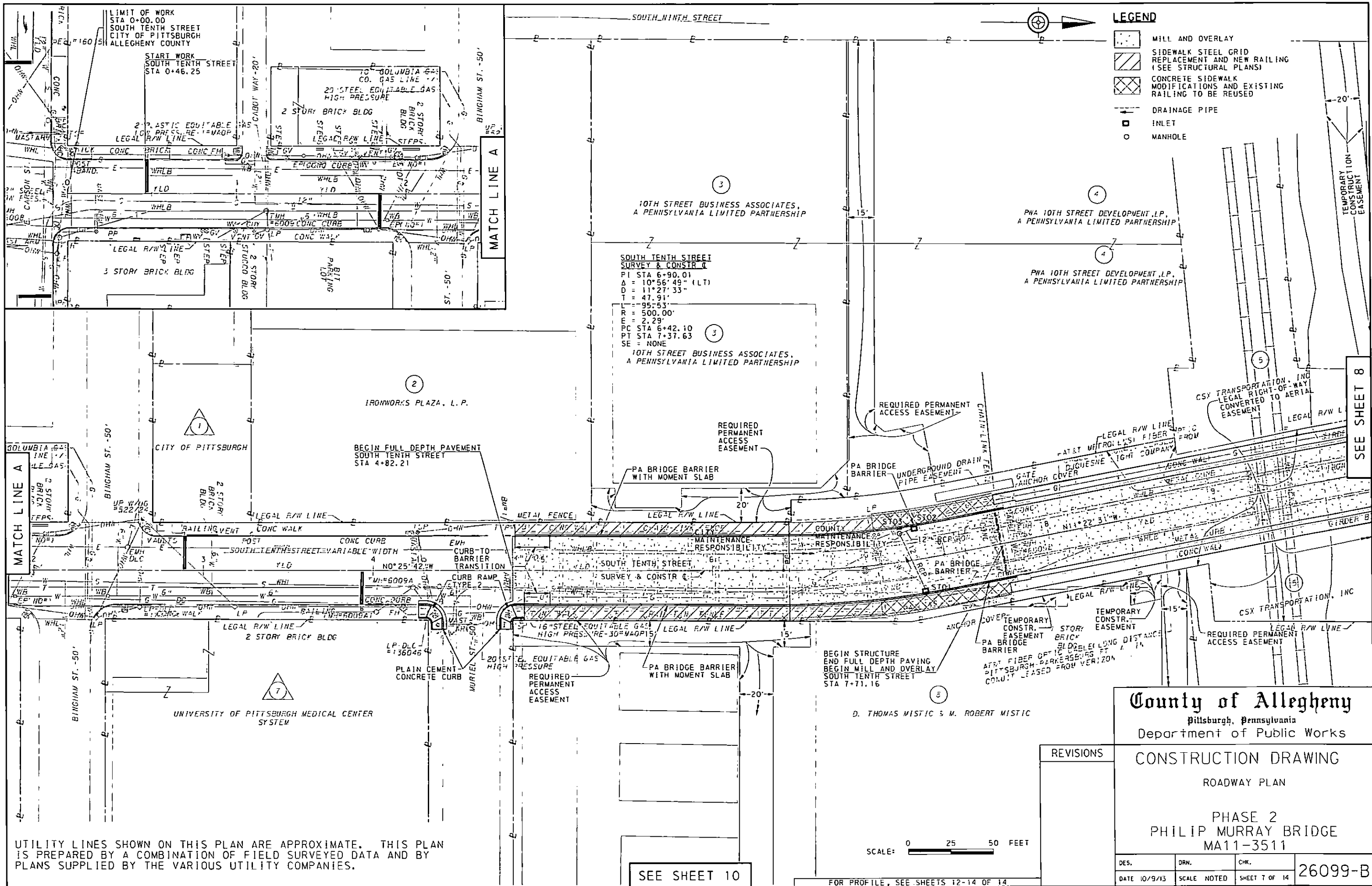

**LEGEND**

- MILL AND OVERLAY
- SIDEWALK STEEL GRID REPLACEMENT AND NEW RAILING (SEE STRUCTURAL PLANS)
- CONCRETE SIDEWALK MODIFICATIONS AND EXISTING RAILING TO BE REUSED
- DRAINAGE PIPE
- INLET
- MANHOLE

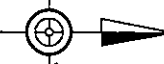

LIMIT OF WORK  
STA 0+00.00  
SOUTH TENTH STREET  
CITY OF PITTSBURGH  
ALLEGHENY COUNTY

START WORK  
SOUTH TENTH STREET  
STA 0+46.25

MATCH LINE A

MATCH LINE A

SEE SHEET 8

UTILITY LINES SHOWN ON THIS PLAN ARE APPROXIMATE. THIS PLAN IS PREPARED BY A COMBINATION OF FIELD SURVEYED DATA AND BY PLANS SUPPLIED BY THE VARIOUS UTILITY COMPANIES.

**SOUTH TENTH STREET SURVEY & CONSTR C**  
 PI STA 6+90.01  
 Δ = 10°56'49" (LT)  
 D = 11°27'33"  
 T = 47.91'  
 R = 95.53'  
 E = 500.00'  
 F = 2.29'  
 PC STA 6+42.10  
 PT STA 7+37.63  
 SE = NONE

10TH STREET BUSINESS ASSOCIATES, A PENNSYLVANIA LIMITED PARTNERSHIP

PWA 10TH STREET DEVELOPMENT, L.P., A PENNSYLVANIA LIMITED PARTNERSHIP

PWA 10TH STREET DEVELOPMENT, L.P., A PENNSYLVANIA LIMITED PARTNERSHIP

IRONWORKS PLAZA, L.P.

BEGIN FULL DEPTH PAVEMENT SOUTH TENTH STREET STA 4+82.21

UNIVERSITY OF PITTSBURGH MEDICAL CENTER SYSTEM

BEGIN STRUCTURE END FULL DEPTH PAVING BEGIN MILL AND OVERLAY SOUTH TENTH STREET STA 7+71.16

D. THOMAS MISTIC & M. ROBERT MISTIC

**County of Allegheny**  
 Pittsburgh, Pennsylvania  
 Department of Public Works

REVISIONS			
CONSTRUCTION DRAWING ROADWAY PLAN			
PHASE 2 PHILIP MURRAY BRIDGE MA11-3511			
DES.	DRN.	CHK.	26099-B
DATE 10/9/13	SCALE NOTED	SHEET 7 OF 14	

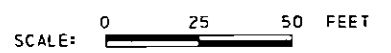

SEE SHEET 10

FOR PROFILE, SEE SHEETS 12-14 OF 14

1:\6050610 510m 51xv.dwg ransPhase 207-r.dwg 10/01/13 2:21:48 PM 1/28/2014

**LEGEND**

 MILL AND OVERLAY

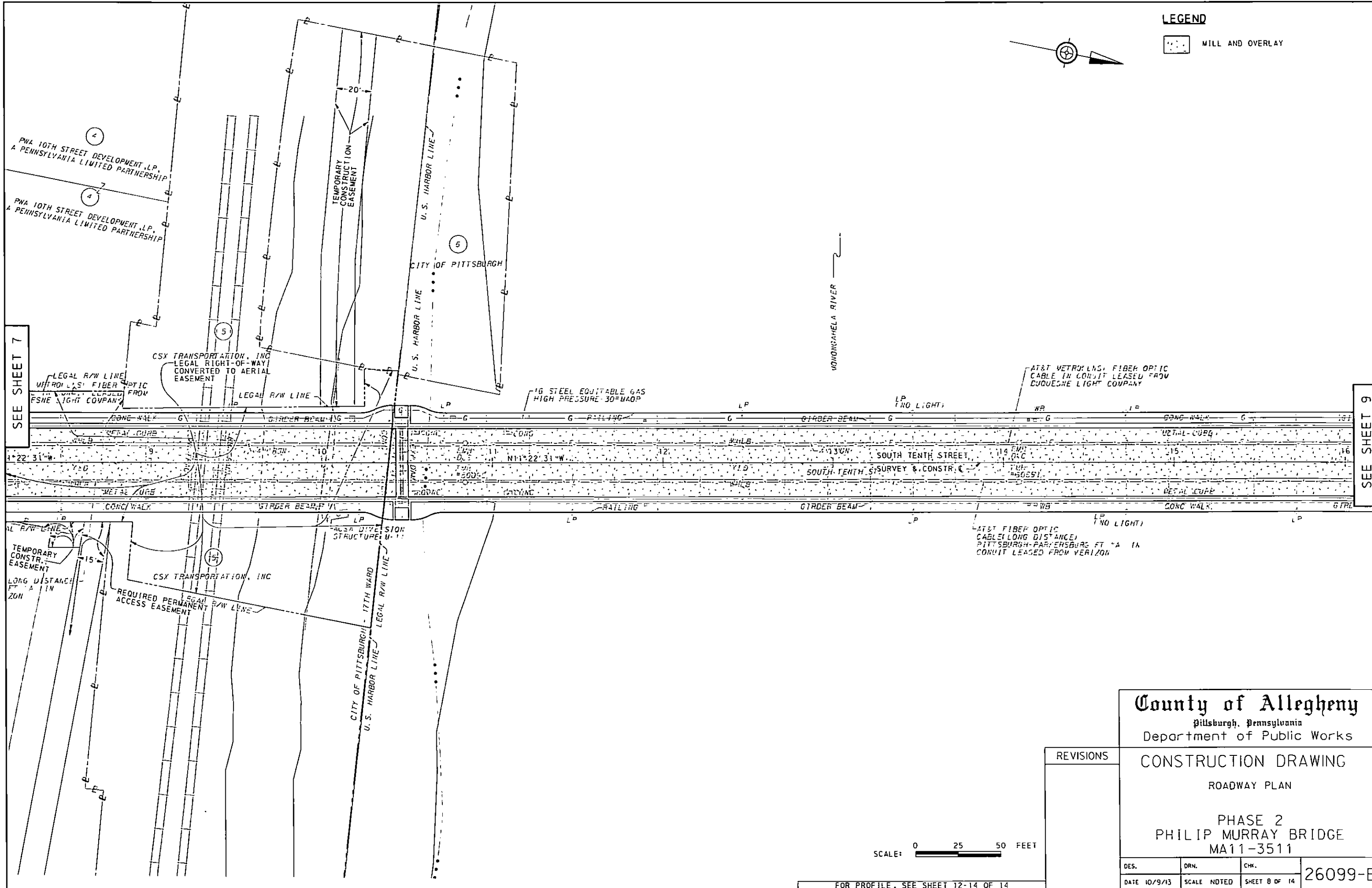

SEE SHEET 7

SEE SHEET 9

**County of Allegheny**  
Pittsburgh, Pennsylvania  
Department of Public Works

**CONSTRUCTION DRAWING**  
ROADWAY PLAN  
  
PHASE 2  
PHILIP MURRAY BRIDGE  
MA11-3511

REVISIONS	

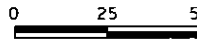
SCALE:  FEET

DES.	DRN.	CHK.	26099-B
DATE 10/9/13	SCALE NOTED	SHEET 8 OF 14	

FOR PROFILE, SEE SHEET 12-14 OF 14



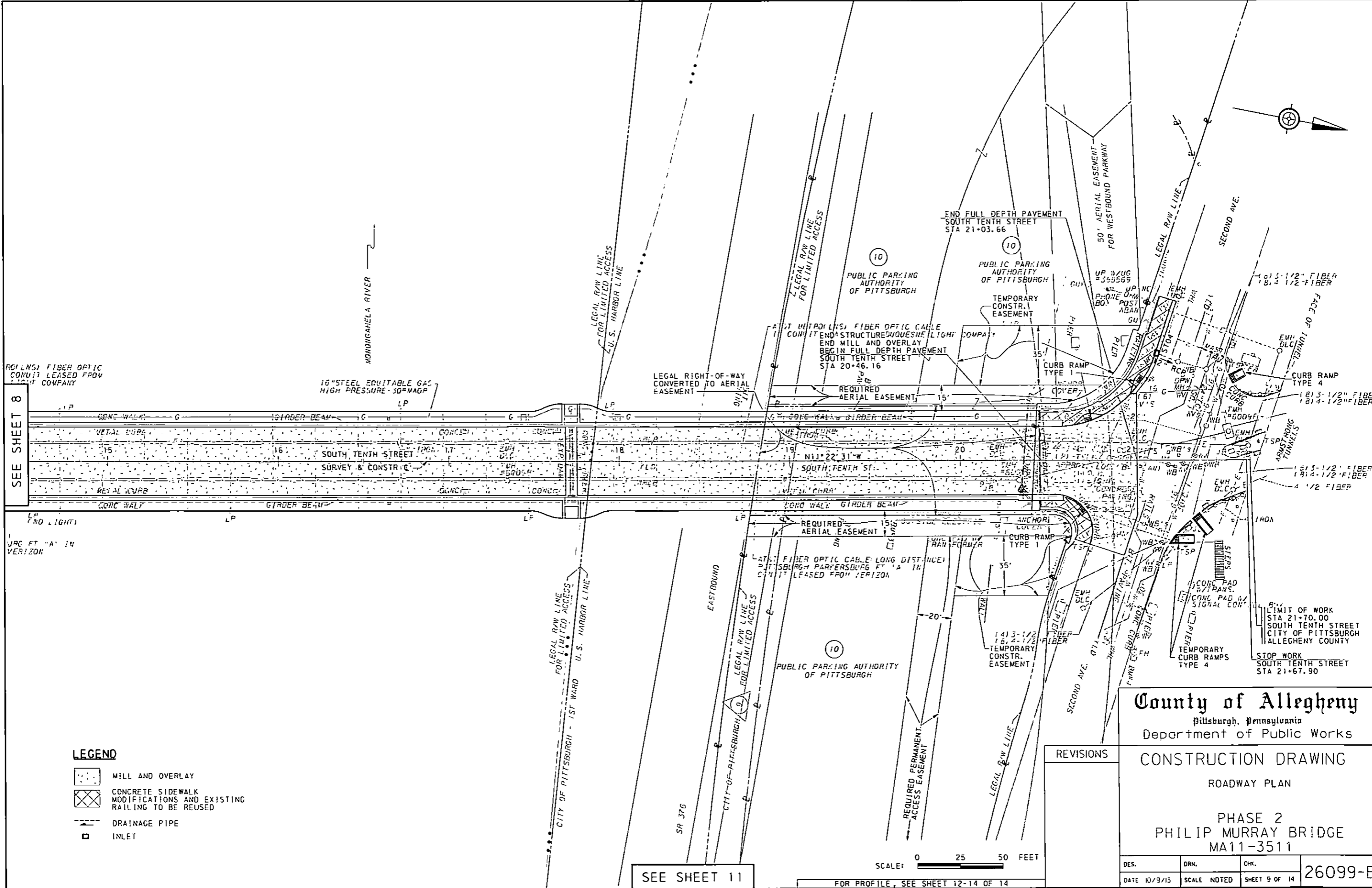

I:\1\0050610\_510111\_51\rdp\plans\Phase 2\08-rdp\m02.dgn 2/21/13 4:17 PM 1/28/2014



SEE SHEET 8

SEE SHEET 11

**LEGEND**

-  MILL AND OVERLAY
-  CONCRETE SIDEWALK MODIFICATIONS AND EXISTING RAILING TO BE REUSED
-  DRAINAGE PIPE
-  INLET

SCALE: 0 25 50 FEET

FOR PROFILE, SEE SHEET 12-14 OF 14

**County of Allegheny**  
 Pittsburgh, Pennsylvania  
 Department of Public Works

REVISIONS

CONSTRUCTION DRAWING  
 ROADWAY PLAN

PHASE 2  
 PHILIP MURRAY BRIDGE  
 MA11-3511

DES.	DRN.	CHK.	26099-B
DATE 10/9/13	SCALE NOTED	SHEET 9 OF 14	

1:\60050610\_510111\_5111.dwg 2/11/15 10:03:48

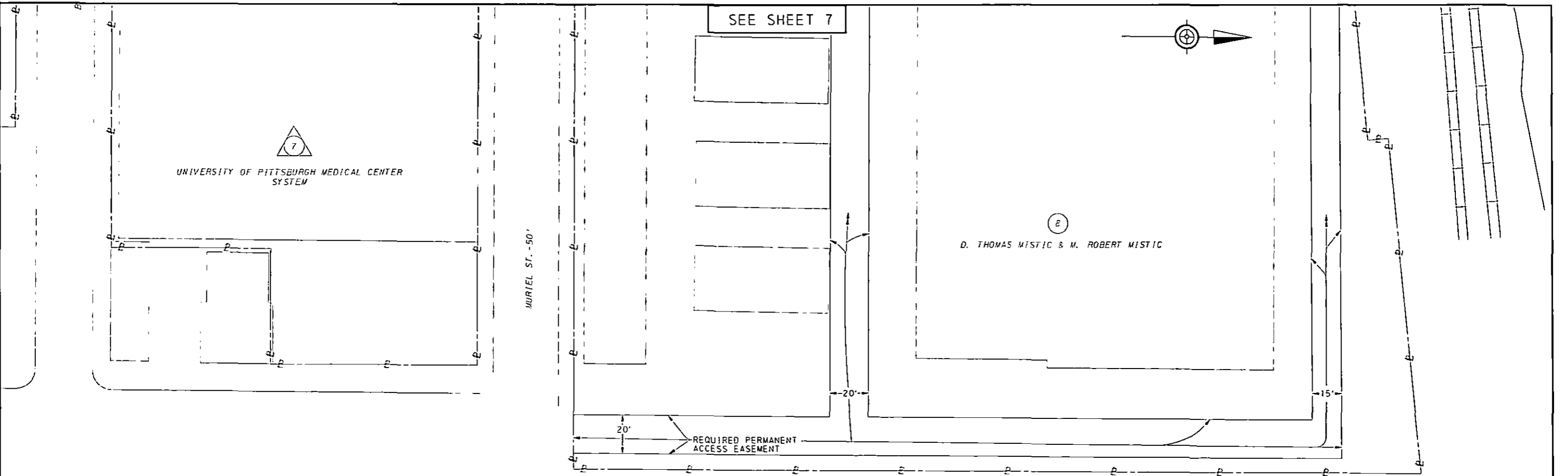

SCALE: 0 25 50 FEET

**County of Allegheny**  
 Pittsburgh, Pennsylvania  
 Department of Public Works

REVISIONS

CONSTRUCTION DRAWING  
 ROADWAY PLAN  
 PHASE 2  
 PHILIP MURRAY BRIDGE  
 MA11-3511

DES.	DRN.	CHK.	26099-B
DATE 10/9/13	SCALE NOTED	SHEET 10 OF 14	

I:\000506\10\_510.mxd 5/1/2014 5:14:00 PM 2/21/13 50 PW 1/28/2014

MONONGAHELA RIVER

SEE SHEET 9



CITY OF PITTSBURGH - 1ST WARD  
LEGAL RAW LINE FOR LIMITED ACCESS  
U. S. HARBOR LINE

SR 376

EASTBOUND

CITY OF PITTSBURGH 9  
LEGAL RAW LINE FOR LIMITED ACCESS

10  
PUBLIC PARKING AUTHORITY OF PITTSBURGH

REQUIRED PERMANENT ACCESS EASEMENT

20'

LEGAL RAW LINE

SECOND AVE.

REQUIRED PERMANENT ACCESS EASEMENT

ENTRANCE TO PUBLIC PARKING

SCALE: 0 25 50 FEET

REVISIONS

County of Allegheny  
Pittsburgh, Pennsylvania  
Department of Public Works

CONSTRUCTION DRAWING  
ROADWAY PLAN

PHASE 2  
PHILIP MURRAY BRIDGE  
MA11-3511

DES.	DRN.	CHK.
DATE 10/9/13	SCALE NOTED	SHEET 11 OF 14

26099-B

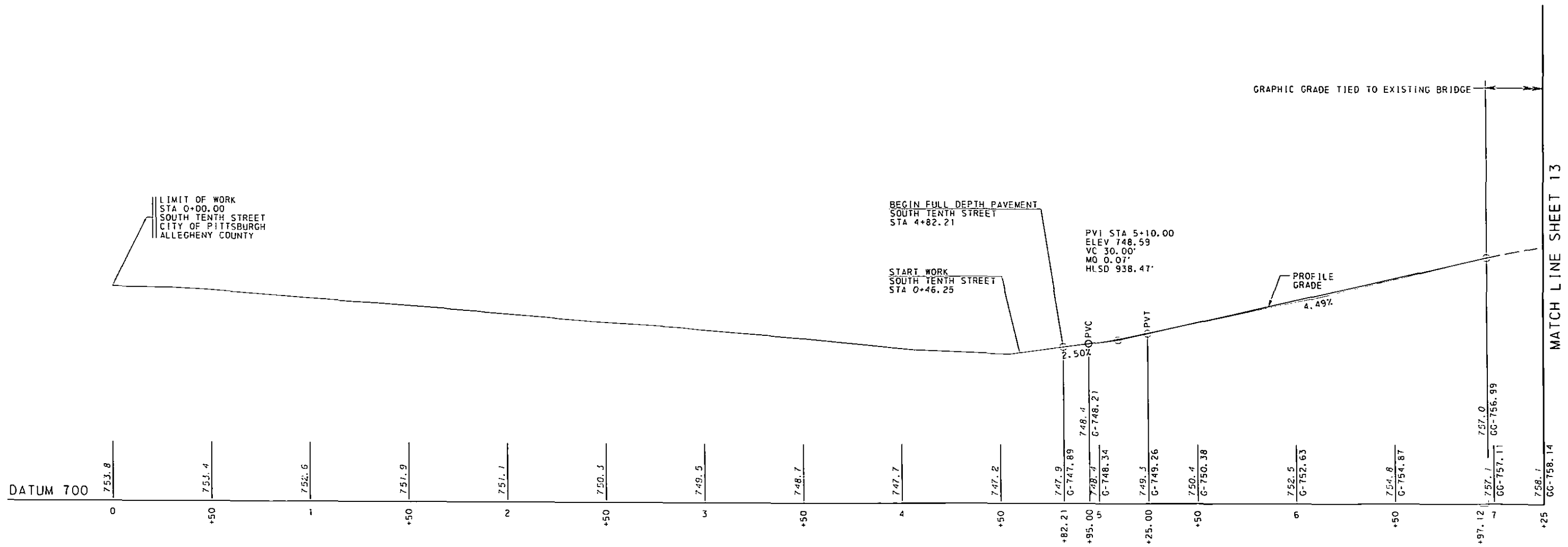

SOUTH TENTH STREET PROFILE

FOR PLAN - SEE SHEET 7 OF 14

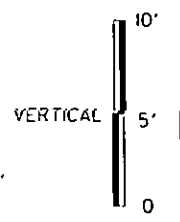
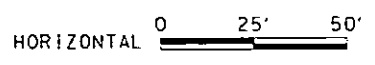

REVISIONS

**County of Allegheny**  
 Pittsburgh, Pennsylvania  
 Department of Public Works

**CONSTRUCTION DRAWING**  
 PROFILE

PHASE 2  
 PHILIP MURRAY BRIDGE  
 MA11-3511

DES.	DRN.	CHK.	26099-B
DATE 10/9/13	SCALE NOTED	SHEET 12 OF 14	

MATCH LINE SHEET 13

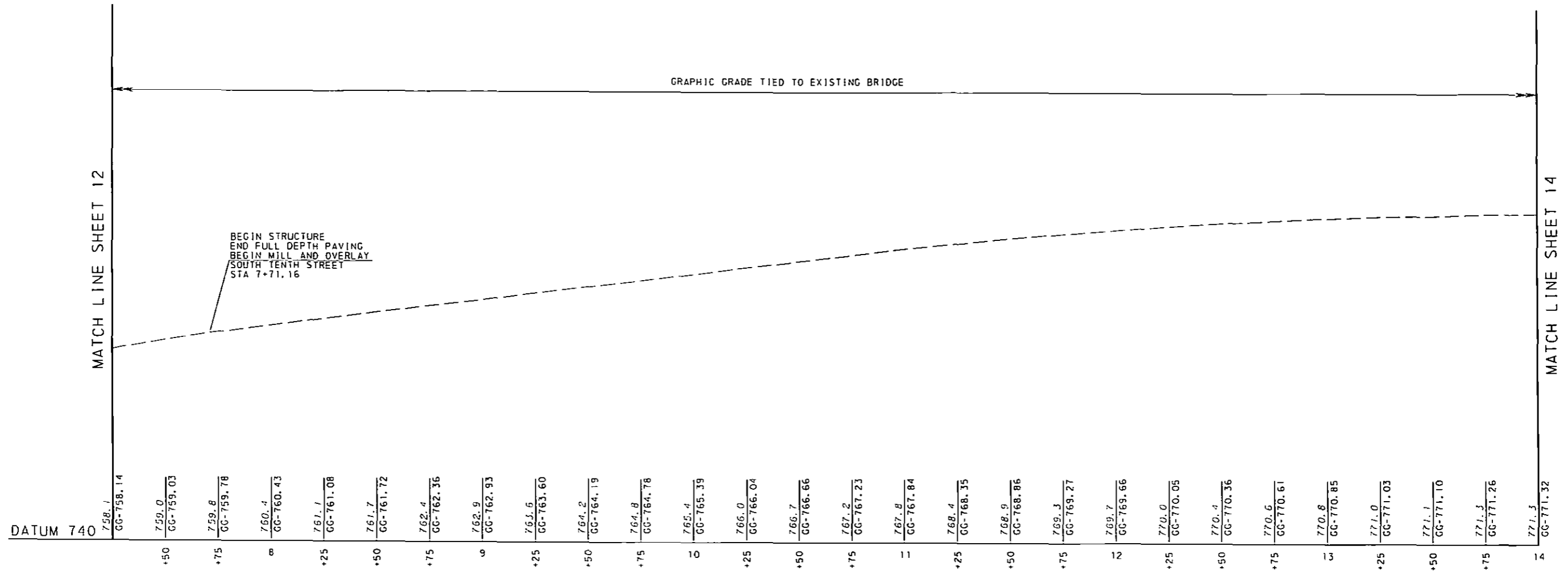

**SOUTH TENTH STREET PROFILE**

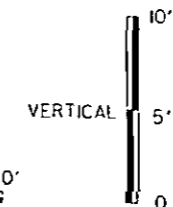
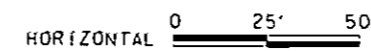

FOR PLAN - SEE SHEET 7 AND 8 OF 14

**County of Allegheny**  
Pittsburgh, Pennsylvania  
Department of Public Works

REVISIONS

CONSTRUCTION DRAWING  
PROFILE  
PHASE 2  
PHILIP MURRAY BRIDGE  
MA11-3511

DES.	DRN.	CHK.	26099-B
DATE 10/9/13	SCALE NOTED	SHEET 13 OF 14	

GRAPHIC GRADE TIED TO EXISTING BRIDGE

MATCH LINE SHEET 13

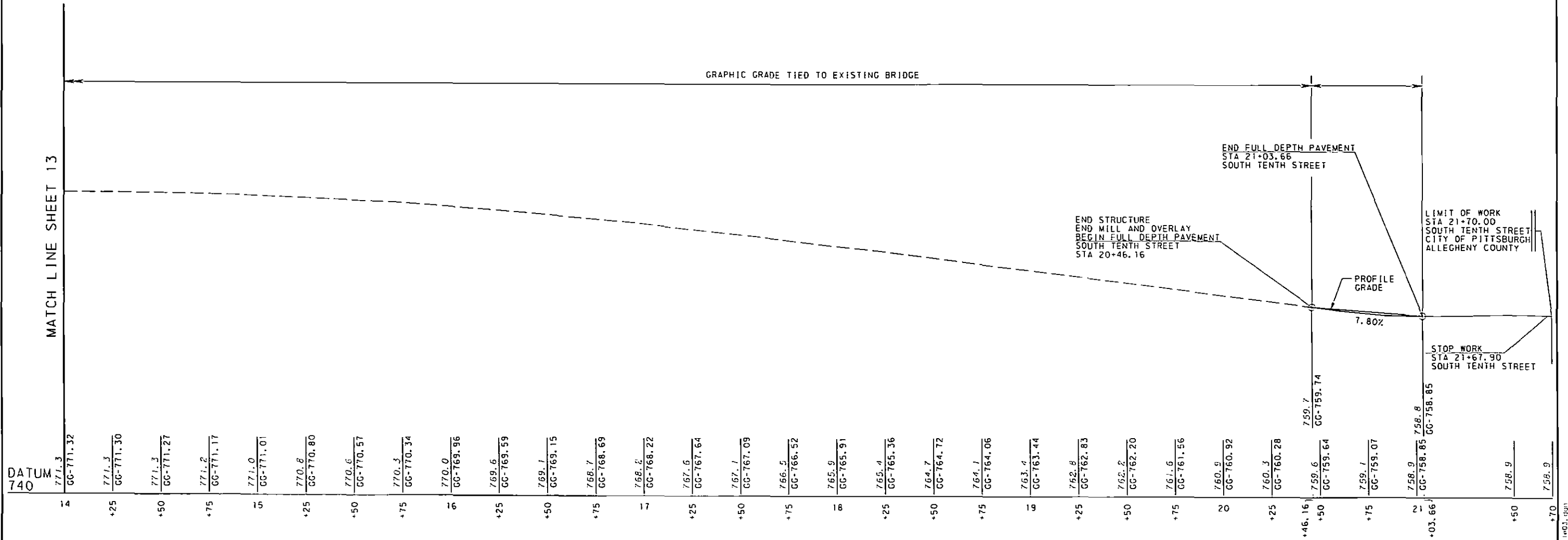

SOUTH TENTH STREET PROFILE

County of Allegheny  
Pittsburgh, Pennsylvania  
Department of Public Works

CONSTRUCTION DRAWING  
PROFILE

PHASE 2  
PHILIP MURRAY BRIDGE  
MA11-3511

DES.	DRN.	CHK.	26099-B
DATE 10/9/13	SCALE NOTED	SHEET 14 OF 14	

REVISIONS

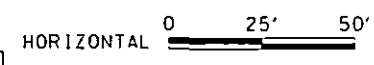
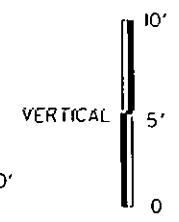

FOR PLAN - SEE SHEET 8 AND 9 OF 14

1:16000000.10 510 in 514-pp10nsVPhase 2\14-pp10nsV1.mxd, dgn 10/21/13 10:56 AM



**GENERAL NOTES**

THIS WORK CONSISTS OF THE MAINTENANCE OF TRAFFIC AND THE PROTECTION OF THE TRAVELING PUBLIC APPROACHING THE CONSTRUCTION AREA AND WITHIN THE LIMITS OF CONSTRUCTION.

FURNISH, ERECT, PLACE AND MAINTAIN TRAFFIC CONTROL SIGNS AND DEVICES AND MAINTAIN TRAFFIC DURING HOURS OF CONSTRUCTION AND AT ALL OTHER TIMES IN ACCORDANCE WITH THE METHODS INDICATED ON THESE DRAWINGS AND THE FOLLOWING:

- THE SPECIAL PROVISIONS OF THE CONTRACT.
- PA CODE, TITLE 67, CHAPTER 212, OFFICIAL TRAFFIC CONTROL DEVICES.
- PENNDOT PUBLICATION 35, APPROVED CONSTRUCTION MATERIALS (BULLETIN 15).
- PENNDOT PUBLICATION 213, TEMPORARY TRAFFIC CONTROL GUIDELINES (APRIL 2010 ED.)
- PENNDOT PUBLICATION 234, FLAGGING HANDBOOK.
- PENNDOT PUBLICATION 236, HANDBOOK OF APPROVED SIGNS, FEBRUARY 2012.
- PENNDOT PUBLICATION 408/2011, SPECIFICATIONS, LATEST VERSION.
- PENNDOT STANDARD TC-8600 AND TC-8700, TRAFFIC CONTROL SIGNING STANDARD PUBLICATION 111M.
- MANUAL ON UNIFORM TRAFFIC CONTROL DEVICES (MUTCD), (2009 ED.)
- PENNDOT STANDARD TC-8800, TRAFFIC STANDARDS-SIGNALS PUBLICATION 148

IMMEDIATELY UPON COMPLETION OF THE WORK, REMOVE THE DEVICES. UNLESS OTHERWISE SPECIFIED, THEY REMAIN THE PROPERTY OF THE CONTRACTOR. THE DEPARTMENT WILL REMOVE ANY TRAFFIC CONTROL DEVICES ERECTED BY DEPARTMENT FORCES.

THE COUNTY CONSTRUCTION ENGINEER OR REPRESENTATIVE WILL INSPECT ALL TRAFFIC CONTROL DEVICES PRIOR TO THE START OF WORK.

AN ALTERNATE TRAFFIC CONTROL PLAN (TCP) MAY BE SUBMITTED FOR COUNTY APPROVAL. HAVE THE ALTERNATE TCP SIGNED AND SEALED BY A PROFESSIONAL ENGINEER REGISTERED IN THE STATE OF PENNSYLVANIA AND BE CONSISTENT WITH STANDARD MPT PRACTICES. THE COUNTY NEEDS TO APPROVE, IN WRITING, ANY TCP MODIFICATIONS BEFORE IMPLEMENTATION BY THE CONTRACTOR.

LANE WIDTHS FOR TWO WAY TRAFFIC SHOULD GENERALLY BE EQUAL TO LANE WIDTHS OF THE EXISTING FACILITY, BUT NOT LESS THAN 10 FEET FOR TEMPORARY TRAVEL LANES. LANES SHALL BE PAVED UNLESS EXCEPTIONS ARE PRE-APPROVED BY THE PROJECT ENGINEER. WHEN ONE LANE, ONE-WAY OPERATION IS NECESSARY, A MINIMUM WIDTH OF 11 FEET SHALL BE MAINTAINED.

MAINTAIN ACCESS TO ALL SIDE STREETS AND DRIVEWAYS, BOTH COMMERCIAL AND RESIDENTIAL, AT ALL TIMES.

PROVIDE ALL REQUIRED TEMPORARY PAVEMENT MARKINGS AS INDICATED ON THE PLANS. REMOVE ALL PAVEMENT MARKINGS WHEN THEY ARE NO LONGER REQUIRED OR AS DIRECTED. REMOVE ANY PAVEMENT MARKINGS THAT ARE IN CONFLICT WITH THE TEMPORARY TRAFFIC PATTERNS.

LONG TERM WARNING SIGNS SHALL UTILIZE PENNDOT APPROVED FLUORESCENT SHEETING. ALL OTHER SIGNS SHALL UTILIZE PENNDOT APPROVED SHEETING OR BETTER. MOUNT ALL LONG TERM SIGNS ON TYPE III BARRICADES UNLESS DIRECTED OTHERWISE.

THE PROJECT TRAFFIC CONTROLS INCLUDING SIGNING, PAVEMENT MARKINGS, WARNING LIGHTS AND REFLECTIVE DEVICES SHOULD BE INSPECTED DAILY (INCLUDING WEEKENDS, HOLIDAYS AND NIGHT TIME). ADVISE PENNDOT OF THE INSPECTION SCHEDULE AND PROVIDE AN OPPORTUNITY FOR PENNDOT PARTICIPATION.

FLAGGING PERSONNEL AND EQUIPMENT WILL BE IN ACCORDANCE WITH PA CODE, TITLE 67 CHAPTER 212 AND PUBLICATION 234 FLAGGING HANDBOOK AND IN RADIO COMMUNICATION AT ALL TIMES. PAID FOR UNDER ITEM 0901-0001.

TEMPORARY TRAFFIC CONTROL SIGNS AND DEVICES INDICATED ARE THE MINIMUM REQUIRED. IF NECESSARY, THE COUNTY MAY REQUIRE THE FURNISHING AND PLACEMENT OF ADDITIONAL TRAFFIC CONTROL DEVICES. PLACE ADDITIONAL SIGNS AND DEVICES AS REQUIRED.

MAINTAIN POSITIVE GUIDANCE TO ALL MOTORISTS WITHIN THE CONSTRUCTION AREA. INCORPORATE EXISTING AND EVENTUALLY FINAL SIGNING AND PAVEMENT MARKINGS AS THE PHASES OF CONSTRUCTION ARE COMPLETED. REFERENCE THE SIGNING AND PAVEMENT MARKING PLANS CONTAINED IN THIS PLAN SET FOR FINAL SIGNING AND PAVEMENT MARKINGS.

THIS TRAFFIC CONTROL PLAN DOES NOT RELIEVE THE CONTRACTOR OF ITS RESPONSIBILITY AS SPECIFIED IN SECTION 901.3(c) OF PUBLICATION 408/2011 SPECIFICATION.

ALL SIGNS SHALL BE PLACED SO THAT A MINIMUM CLEAR PATH OF 4 FEET IS MAINTAINED FOR PEDESTRIAN ACCESS.

ALL SIGN DISTANCES MAY BE ADJUSTED SLIGHTLY TO FIT FIELD CONDITIONS.

USE TYPE "C" LIGHTS ON EVERY CHANNELIZING DEVICE IN TRANSITION AREAS, AND EVERY THIRD DEVICE IN TANGENT SECTIONS.

**GENERAL NOTES (CONT'D)**

ALL POST MOUNTED SIGNS MUST BE MOUNTED ON BREAKAWAY STEEL POSTS AS SPECIFIED IN SECTION 1103.08 OF PENNDOT PUBLICATION 408/2011.

LOCATIONS OF ALL SIGNS ARE TO MEET CURRENT STANDARDS FOR OFFSET, MOUNTINGS HEIGHT AND BE PROPERLY BALLASTED.

CONTACT THE COUNTY TRAFFIC ENGINEER PRIOR TO OPENING ROAD TO TRAFFIC TO REVIEW SIGNS AND PAVEMENT MARKING PATTERNS.

CONSTRUCTION DETAILS OTHER THAN THOSE SHOWN ON THESE DRAWINGS SHALL CONFORM TO THE FOLLOWING STANDARD DRAWINGS:

TC-8600	JUNE 13, 2013
TC-8716	JUNE 13, 2013
TC-8717	JUNE 13, 2013
TC-8604	JUNE 13, 2013
TC-8700C	JUNE 13, 2013
TC-8800	DECEMBER 12, 2011
BC-719M	OCTOBER 26, 2010

**SEQUENCE OF CONSTRUCTION**

**OVERVIEW**

THIS WORK IS FOR THE REHABILITATION OF THE EXISTING SIDEWALKS, BRIDGE AND VAULT ROOF. THE FOLLOWING CONSTRUCTION STAGES WILL FACILITATE THE REHABILITATION OF THE BRIDGE.

**STAGE 1**

10 DAYS PRIOR TO THE START OF PHYSICAL WORK, ERECT ADVANCE CONSTRUCTION ADVISORY SIGNS AS INDICATED IN THE SPECIAL PROVISION SECTION 901.

SET UP THE TEMPORARY TRAFFIC CONTROL DEVICES DURING OFF-PEAK HOURS USING THE APPROPRIATE PATA FIGURE FOR THE OPERATION AND AS INDICATED IN THE TRAFFIC CONTROL PLAN.

CONSTRUCT THE NORTHEAST HANDICAP RAMPS AT THE INTERSECTION OF 2ND AVENUE AND SOUTH 10TH STREET PRIOR TO CLOSING THE EAST SIDE OF THE BRIDGE AND SIDEWALK.

COVER EXISTING SIGNS RESTRICTING PARKING BETWEEN 3PM-7PM ALONG 2ND AVENUE.

CLOSE THE EAST SIDEWALK AND PROVIDE TEMPORARY PEDESTRIAN CROSSING AT SECOND AVENUE AND MURIEL STREET.

SET UP TRUCK DETOUR PRIOR TO CLOSING THE EAST SIDE OF THE BRIDGE.

CLOSE THE TWO EAST LANES AND SHIFT TRAFFIC TO THE WEST LANE AS INDICATED IN THE TRAFFIC CONTROL PLAN.

RECONSTRUCT THE EAST PORTION OF THE BRIDGE, VAULT ROOF, SIDEWALK AND HANDICAP RAMPS.

MILL AND OVERLAY THE EXISTING EAST LANES UP TO THE BINDER COURSE. (STA. 7+71.16 TO STA. 20+46.16)

**STAGE 2**

SET UP THE TEMPORARY TRAFFIC CONTROL DEVICES DURING OFF-PEAK HOURS USING THE APPROPRIATE PATA FIGURE FOR THE OPERATION AND AS INDICATED IN THE TRAFFIC CONTROL PLAN.

CLOSE THE WEST SIDEWALK AND PROVIDE TEMPORARY PEDESTRIAN CROSSING AT SECOND AVENUE AND MURIEL STREET.

SET UP DETOUR PRIOR TO CLOSING THE WEST SIDE OF THE BRIDGE.

CLOSE THE WEST SIDE OF THE BRIDGE AND SHIFT TRAFFIC BACK TO THE EAST LANE AS INDICATED IN THE TRAFFIC CONTROL PLAN.

RECONSTRUCT THE WEST PORTION OF THE BRIDGE, VAULT ROOFS, SIDEWALK AND HANDICAP RAMPS.

MILL AND OVERLAY THE EXISTING WEST LANES UP TO THE BINDER COURSE. (STA. 7+71.16 TO STA. 20+46.16)

PLACE WEARING COURSE AFTER TRAFFIC CONTROL DEVICES HAVE BEEN REMOVED. UTILIZE SHORT-TERM TRAFFIC CONTROL DURING OVERNIGHT HOURS, AS STATED IN SECTION 901.

REOPEN THE SIDEWALKS AND ROADWAY TO UNRESTRICTED TRAFFIC.

CONSTRUCT REMAINING HANDICAP RAMPS AT THE INTERSECTION OF SOUTH 10TH STREET AND MURIEL STREET IN ACCORDANCE WITH PATA 16 AND 41.

CONSTRUCT NORTHWEST HANDICAP RAMPS AT THE INTERSECTION OF SOUTH 10TH STREET AND SECOND AVENUE IN ACCORDANCE WITH PATA 16 AND 41

REMOVE NORTHEAST HANDICAP RAMPS AND RETURN BACK TO ORIGINAL CONDITION.

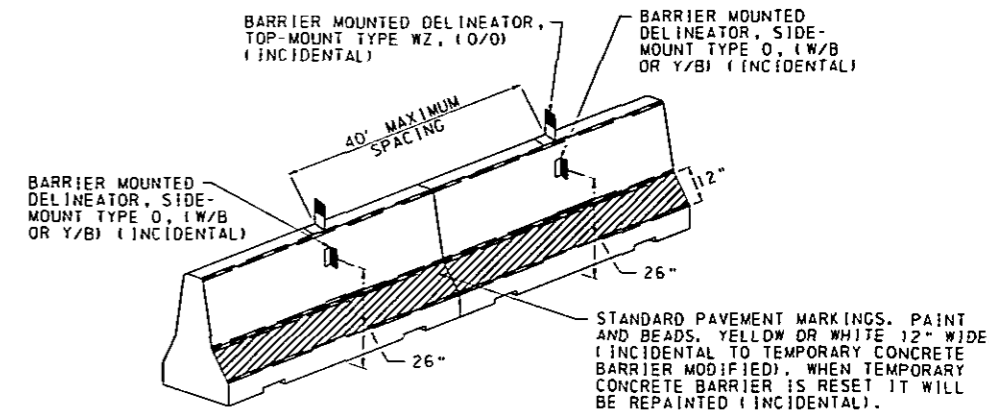

**TEMPORARY BARRIER, TEST LEVEL 3,  
BARRIER DEFLECTION DISTANCE <= 2' MODIFIED  
ITEM 4627-3020**

**RESET TEMPORARY BARRIER, TEST LEVEL 3,  
BARRIER DEFLECTION DISTANCE <= 2' MODIFIED  
ITEM 4628-3020  
NTS**

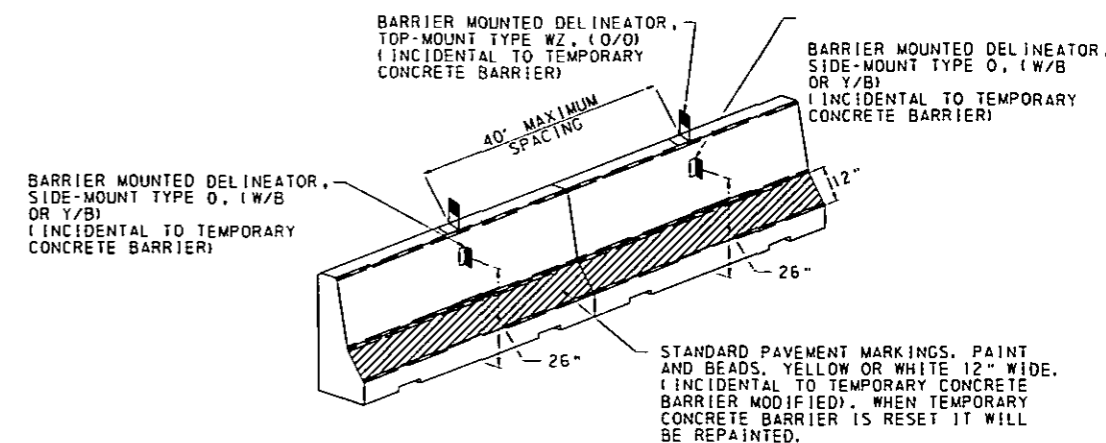

**TEMPORARY CONCRETE BARRIER STRUCTURE MOUNTED MODIFIED  
ITEM 4643-000**

**TEMPORARY CONCRETE BARRIER STRUCTURE MOUNTED, RESET MODIFIED  
ITEM 4644-000  
NTS**

NOTE:  
WATER BLAST ALL TEMPORARY CONCRETE BARRIER WITH A MINIMUM OF 3000 PSI BEFORE PAINTING. (INCIDENTAL TO ITEMS 4627-0001 AND 4643-0001)

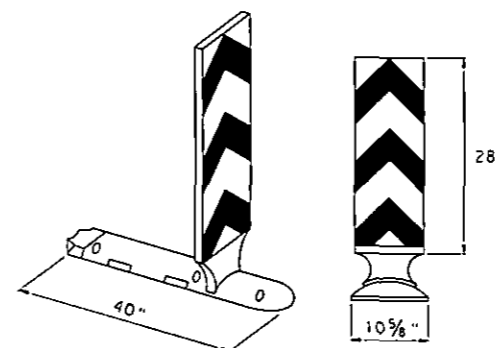

**TEMPORARY LANE SEPARATOR CURB  
ITEM 9901-0825  
NTS**

**County of Allegheny**  
Pittsburgh, Pennsylvania  
Department of Public Works

**CONSTRUCTION DRAWING**  
TRAFFIC CONTROL PLAN  
GENERAL NOTES  
PHASE 2  
PHILIP MURRAY BRIDGE  
MA11-3511

DES. JPP	DRN. JPP	CHK. SIS	26099-B
DATE 10/9/13	SCALE NOTED	SHEET 1 OF 15	

RECOMMENDED \_\_\_\_\_ 20 \_\_\_\_\_  
DISTRICT TRAFFIC ENGINEER

11/000506.10 \$10.00 S:\11\g11\g11\mason 2\01\ten-notes.dwg 12/2/2014

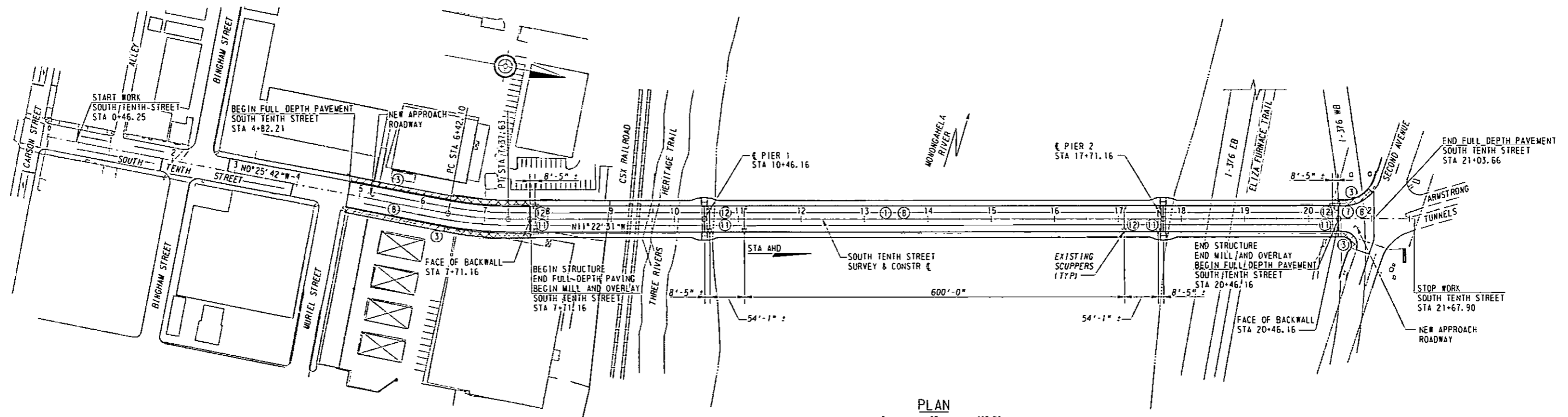

PLAN  
0 50 100 FT

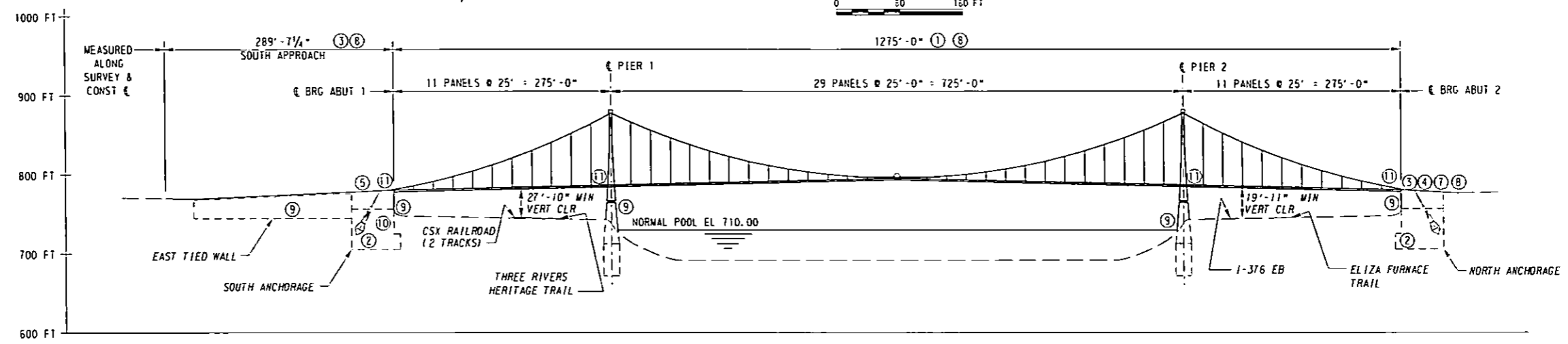

ELEVATION  
0 50 100 FT

**PHASE 2 SCOPE OF WORK:**

- ① PAINTING OF THE SUPERSTRUCTURE
- ② ANCHORAGE VAULT AND MAIN CABLE DEHUMIDIFICATION SYSTEM
- ③ SIDEWALK REPLACEMENT BEYOND THE MAIN STRUCTURE LIMITS
- ④ REPLACE ROADWAY AND STRUCTURAL ROOF SYSTEM ON THE NORTH VAULT
- ⑤ REMOVE AND REPLACE ROADWAY AT SOUTH APPROACH. PROVIDE WATERPROOFING SYSTEM ON THE SOUTH VAULT ROOF
- ⑥ STRUCTURAL STEEL REPAIRS ON THE BRIDGE AND FLOOR SYSTEM
- ⑦ BARRIER IMPROVEMENTS AT THE NORTH VAULT MAIN CABLE BLOCKOUTS
- ⑧ APPROACH ROADWAY PAVING AND MILLING/OVERLAY OF BRIDGE DECK
- ⑨ REINFORCED CONCRETE SUBSTRUCTURE REPAIRS TO ABUTMENTS, PIERS, AND RETAINING WALLS
- ⑩ STRAND RE-SOCKETING
- ⑪ REPLACE ROADWAY PORTION OF EXPANSION DAMS AT ABUTMENTS AND PIERS WITH STRIP SEALS  
3 1/2" MOVEMENT CLASSIFICATION AT ABUTMENTS AND END SPANS NEAR TOWERS  
5" MOVEMENT CLASSIFICATION IN MAIN SPAN NEAR TOWERS
- ⑫ MISCELLANEOUS DRAINAGE REPAIRS AND FLUSHING OF SCUPPERS AND DOWNSPOUTS

INDEX OF SHEETS	
SHEET NO.	DESCRIPTION
1	GENERAL PLAN AND ELEVATION
2	TYPICAL SECTIONS

- LEGEND:**
- SIDEWALK GRID DECK REPLACEMENT AND NEW RAILING
  - CONCRETE SIDEWALK MODIFICATIONS AND EXISTING RAILING TO BE REUSED
  - ①-⑫ LOCATION AND DESCRIPTION OF REPAIRS

**SOUTH TENTH STREET SURVEY & CONSTR @ HORIZONTAL CURVE DATA**

P1 STA 6+90.01  
 $\Delta = 10^{\circ}56'49''$  LT  
 $T = 47.91'$   
 $L = 95.53'$   
 $R = 500.00'$   
 $E = 2.29'$   
 PC STA 6+42.10  
 PT STA 7+37.63  
 SE = NONE

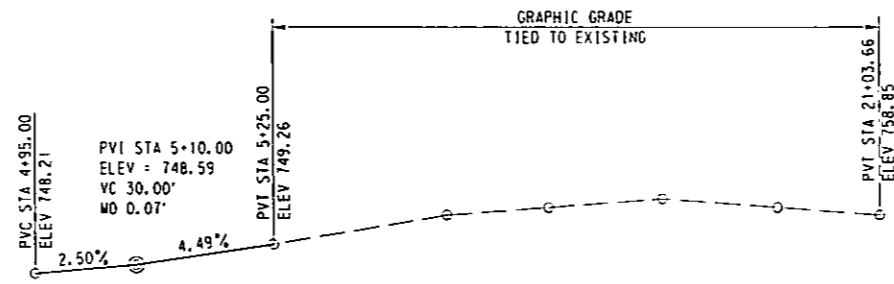

**SOUTH TENTH STREET SURVEY & CONSTR @ PROFILE GRADE DATA**

DESIGN BY  
**AECOM**  
 COMMONWEALTH OF PENNSYLVANIA  
 REGISTERED PROFESSIONAL ENGINEER/ARCHITECT

**SEAL**

NOT FOR CONSTRUCTION  
 TS & L PHASE 2  
 JANUARY 2012  
 FOR DFV SUBMISSION  
 I-23-14

SIGNATURE \_\_\_\_\_ DATE \_\_\_\_\_  
 REGISTRATION NO. \_\_\_\_\_

REVISIONS

FOR STRUCTURAL ADEQUACY \_\_\_\_\_  
 \_\_\_\_\_  
 DISTRICT BRIDGE ENGINEER

**County of Allegheny**  
 Pittsburgh, Pennsylvania  
 Department of Public Works

**TYPE, SIZE AND LOCATION DRAWING**

PHASE 2 CONSTRUCTION  
 GENERAL PLAN AND ELEVATION  
 PHILIP MURRAY BRIDGE  
 MA11-3511

DES. JPH	DRN. JWH	CHK. JPH	26099-B
DATE 1/9/12	SCALE NOTED	SHEET 1 OF 2	

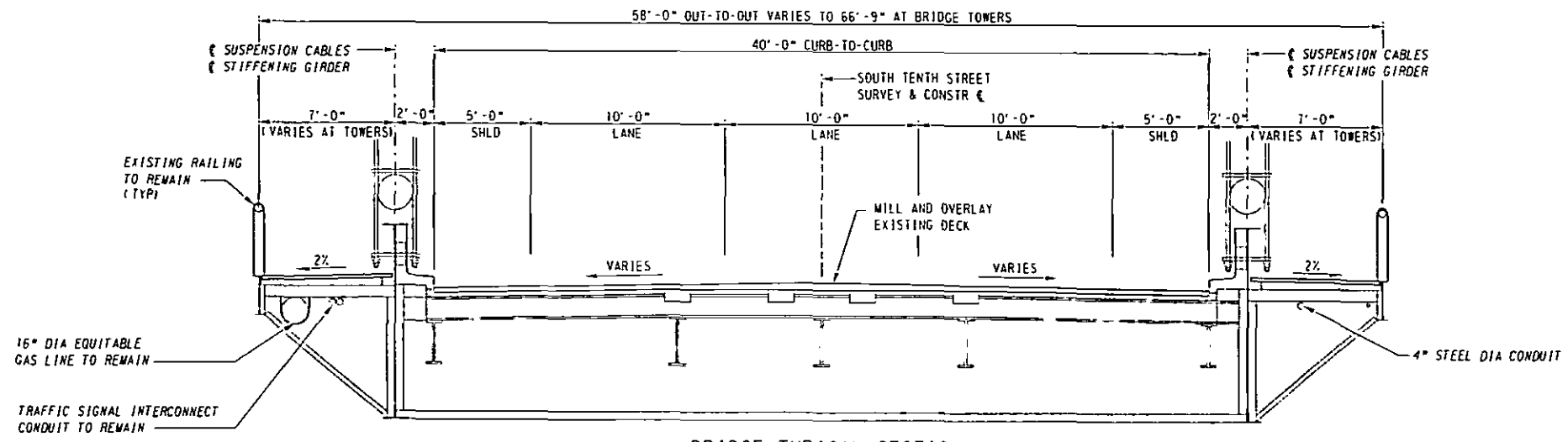

**BRIDGE TYPICAL SECTION**  
(LOOKING STATIONS AHEAD)  
0 5 10 FT

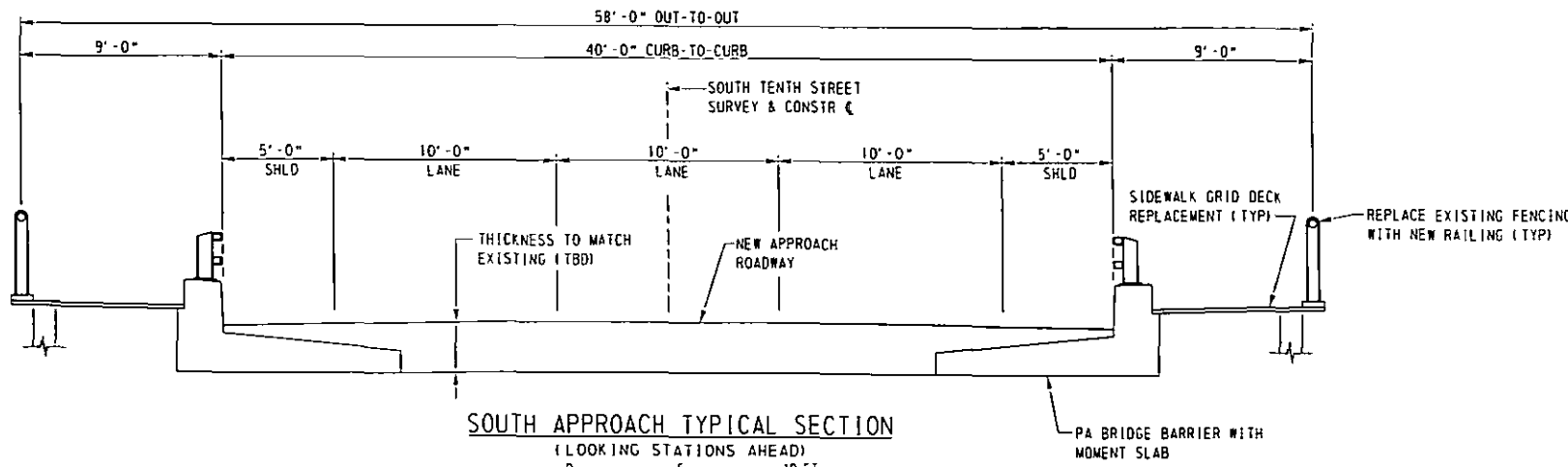

**SOUTH APPROACH TYPICAL SECTION**  
(LOOKING STATIONS AHEAD)  
0 5 10 FT  
STA 4+82.21 TO STA 6+97.16

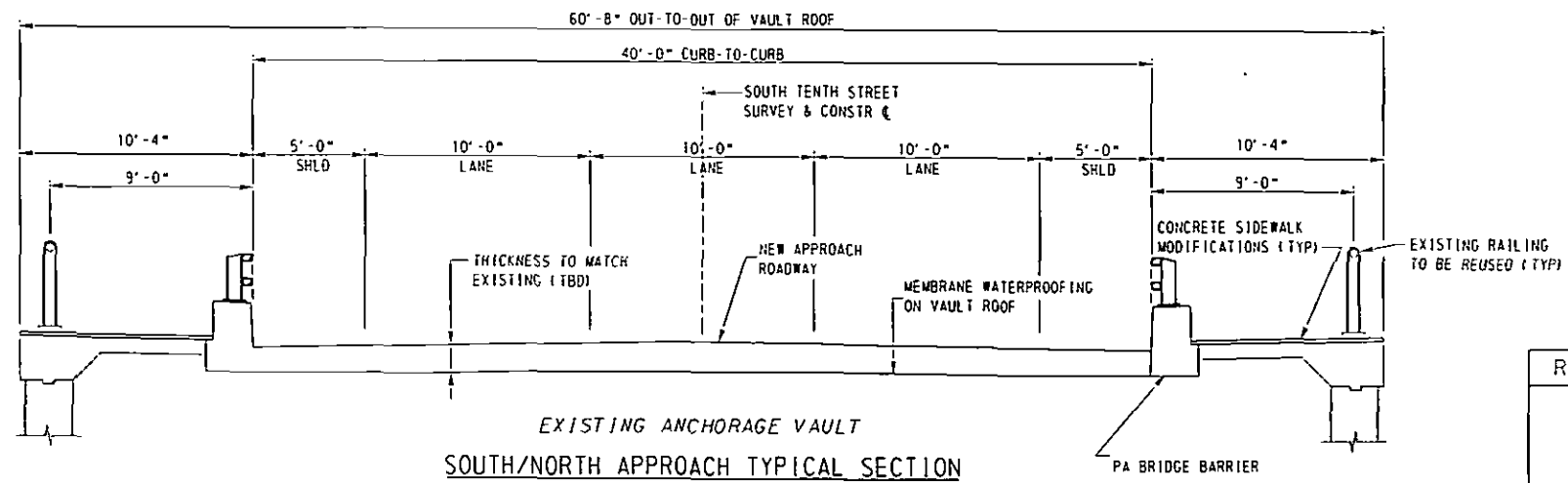

**SOUTH/NORTH APPROACH TYPICAL SECTION**  
(LOOKING STATIONS AHEAD)  
0 5 10 FT  
STA 6+97.16 TO STA 7+71.16 OVER SOUTH VAULT  
STA 20+46.16 TO STA 21+03.66 OVER NORTH VAULT

**NOTE:**

1. NORTH APPROACH TYPICAL SECTION WIDENS OUT INTO INTERSECTION WITH SECOND AVENUE. SEE SHEET 1.

**REVISIONS**

--	--

**AECOM**  
COMMONWEALTH OF PENNSYLVANIA  
REGISTERED PROFESSIONAL ENGINEER/ARCHITECT  
**SEAL**  
NOT FOR CONSTRUCTION  
TS & L PHASE 2  
JANUARY 2012  
FOR DFV  
SUBMISSION  
1-23-14

**County of Allegheny**  
Pittsburgh, Pennsylvania  
Department of Public Works  
**TYPE, SIZE AND LOCATION  
DRAWING**  
PHASE 2 CONSTRUCTION  
TYPICAL SECTIONS  
PHILIP MURRAY BRIDGE  
MA11-3511

DES. JPH	DRN. JWH	CHK. JPH	26099-B
DATE 1/9/12	SCALE NOTED	SHEET 2 OF 2	

4:04:52 PW'S:V6005 South 10th ST/15th. Phase 1/1P/1ans/03-11p/1car FOR DFV.dgn 1/23/2014

BEFORE THE  
PENNSYLVANIA PUBLIC UTILITY COMMISSION

In Re: PUC Application Docket No.	)	APPLICATION DOCKET
Application of the County of Allegheny for	)	No.
approval of the alteration of an existing	)	
crossing where the S. Tenth Street Bridge	)	
(AAR 918499V) crosses above grade, the	)	
tracks of CSX Transportation, Inc. in the	)	
City of Pittsburgh, Allegheny County	)	2015

**CERTIFICATE OF SERVICE**

I hereby certify that I have served a true copy of the foregoing document upon the participants, listed below, in accordance with the requirements of §1.54 (*relating to service by participant*).

Date: March 4, 2015

**Service by USPS First-Class Mail, Postage Prepaid Addressed as Follows:**

Duquesne Light Company  
2825 New Beaver Avenue  
Pittsburgh, PA 15233  
Attn: Jim Runatz 412-393-7813

CSXT, 4901 Belfort Road  
Jacksonville, FL 32256  
Attn: Leslie L. Scherr 904-366-3057

Peoples Gas Company,  
1201 Pitt Street  
Pittsburgh, PA 15221  
Attn: Shane Moriarty 412-473-3962

Pennsylvania Dept of Transportation  
Office of Chief Counsel  
Keystone Bldg.  
400 North Street, Harrisburg, PA 17120  
Attn: Gina Alfonso, Esq. 717-787-3128

Verizon of Pennsylvania  
15 E. Montgomery Avenue,  
Second Floor, Pittsburgh, PA 15212  
Attn: Mr. Jon Gaunt 412-255-8941

Pennsylvania Department of Transportation,  
District 11-0  
45 Thoms Run Road  
Bridgeville, PA 15017  
Attn: Malek Francis 412 429 4949

Level 3 Communications LLC, 122 Capital  
of TX Highway S  
Austin, TX 78746  
Attn: Mr. Trevor Peevey 512-742-3700

Comcast  
300 Corliss Street  
Pittsburgh, PA 15220  
Attn: Mr. Rick Moslen 412-999-0590

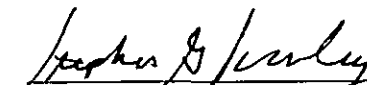
  
Stephen G. Shanley, P.E.  
Director, Allegheny County  
Department of Public Works

PA P.U.C.  
SECRETARY'S BUREAU

2015 MAR 18 AM 10:14

RECEIVED

Stephen G. Shanley, P.E. Director  
Department of Public Works  
501 County Office Building  
542 Forbes Avenue  
Pittsburgh, PA 15219

RECEIVED  
2015 MAR 18 AM 10:17  
PA P.U.C.  
SECRETARY'S BUREAU

Rosemary Chivetta, Secretary  
Pennsylvania Public Utility Commission  
PO Box 3265  
Harrisburg, PA 17105-3265

