

Charlotte Krupa
Agency Coordinator

PPL Electric Utilities Corporation
Two North Ninth Street
Allentown, PA 18101-1179
Tel. 610.774.6287 Fax 610.774.6875
cakrupa@pplweb.com



September 23, 2015

Ms. Rosemary Chiavetta, Secretary
Pennsylvania Public Utility Commission
P. O. Box 3265
Harrisburg, PA 17105

Dear Secretary Chiavetta:

Enclosed herewith for filing under Section 507 of the Public Utility Code, Title 66, are one (1) original and three (3) copies of Right of Way Agreement, adopted September 17, 2015 by the City of Wilkes-Barre and accepted September 25, 2015, by PPL Electric Utilities Corporation (PPL), wherein the City of Wilkes-Barre grants to PPL the right to construct, operate and maintain its electric line facilities in the City of Wilkes-Barre, Luzerne County.

Should you have any questions please call me.

Sincerely,

A handwritten signature in black ink that reads 'Charlotte Krupa'. The signature is fluid and cursive, with the first letters of each word being capitalized and prominent.

Charlotte Krupa
Agency Coordinator

Enclosure

RECEIVED
2015 OCT -1 AM 10:47
PA P.U.C.
SECRETARY'S BUREAU

Prepared by: PPL Electric Utilities
Return to: PPL Electric Utilities
ROW Department
344 S. Poplar St.
Hazleton, PA 18201

RECEIVED
2015 OCT -1 AM 10:47
PA P.U.C. BUREAU
SECRETARY'S BUREAU

**This instrument solely grants, vests
or confirms a public utility easement.**

Form 4337 (8/2014)

W.O. Number:							
5	8	0	3	8	7	1	2



GRANT OF RIGHT-OF-WAY

KNOW ALL MEN BY THESE PRESENTS, That the City of Wilkes-Barre, a City of Third Class organized and existing under a Home Rule Charter hereinafter called "GRANTOR", intending to be legally bound, does hereby for itself and its successors and assigns grant unto **PPL ELECTRIC UTILITIES CORPORATION ("PPL")**, its successors and assigns, the right to *construct, reconstruct, operate and maintain its electric and communication facilities* consisting of one (1) pole and overhead facilities as shown on the plan hereto attached and made a part hereof including such other wires, cables, fixtures and apparatus necessary for the convenient transaction of the business of PPL, upon, across, over, under and along the property identified as County Tax Parcel No. H9SE2-018-01A and H9SE2-018-015 which the undersigned owns or has any interest located along North Franklin Street situate in the City of Wilkes-Barre, County of Luzerne, Commonwealth of Pennsylvania; including the right of ingress and egress to and from the said lines for any of the aforesaid purposes; also the right to cut down any and all trees within twenty-five (25) feet each side of centerline of the electric/communication line and the right to trim any and all trees within twenty-five (25) Feet each side of centerline of the electric/communication line and to remove brush along said lines which in the judgment of said PPL menace the said lines; and also the right to permit the attachment of wires and cables of any other person or company to said poles. Any poles or facilities erected hereunder along a highway, whether within or outside the highway limits, may be relocated to conform to new or relocated highway limits. PPL shall restore the property to substantially the same condition that the property was in prior to installation, maintenance or repair of the electric facilities.

A copy of this agreement and an acceptance hereof by PPL shall be filed by PPL with the Pennsylvania Public Utility Commission, and this agreement shall thereafter become effective in accordance with the provisions of the Public Utility Law.

IN WITNESS WHEREOF, Grantor has caused this agreement to be executed in its corporate name by its proper officers, this 17th day of September, 2015.

ATTEST:

City of Wilkes-Barre
By:

Jim Ryan
City Clerk

Thomas M. Leighton
Name: Thomas M. Leighton
Title: Mayor

Kathy Kane
Name: Kathy Kane
Title: City Controller

COMMONWEALTH OF PENNSYLVANIA)
COUNTY OF LuZerne) : SS

On this, the 17th day of September, 2015, before me, the undersigned officer, personally appeared Mayor Thomas M. Leighton of the City of Wilkes-Barre, known to me (or satisfactorily proven) to be the person described in the foregoing instrument, and acknowledged that he/she executed the same in the capacity therein stated and for the purposes therein contained.

IN WITNESS WHEREOF, I have hereunto set my hand and notarial seal.

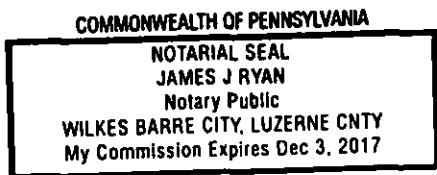

James J. Ryan
Notary Public

ACCEPTED AND CONDITIONS AGREED TO:

WITNESS:

PPL Electric Utilities Corporation
By:

Alvin Schleds 9/25/15 Charlotte Krump 9-25-15

RECEIVED

2015 OCT -1 AM 10:47

PA P.U.C.
SECRETARY'S BUREAU
LEBEND

11

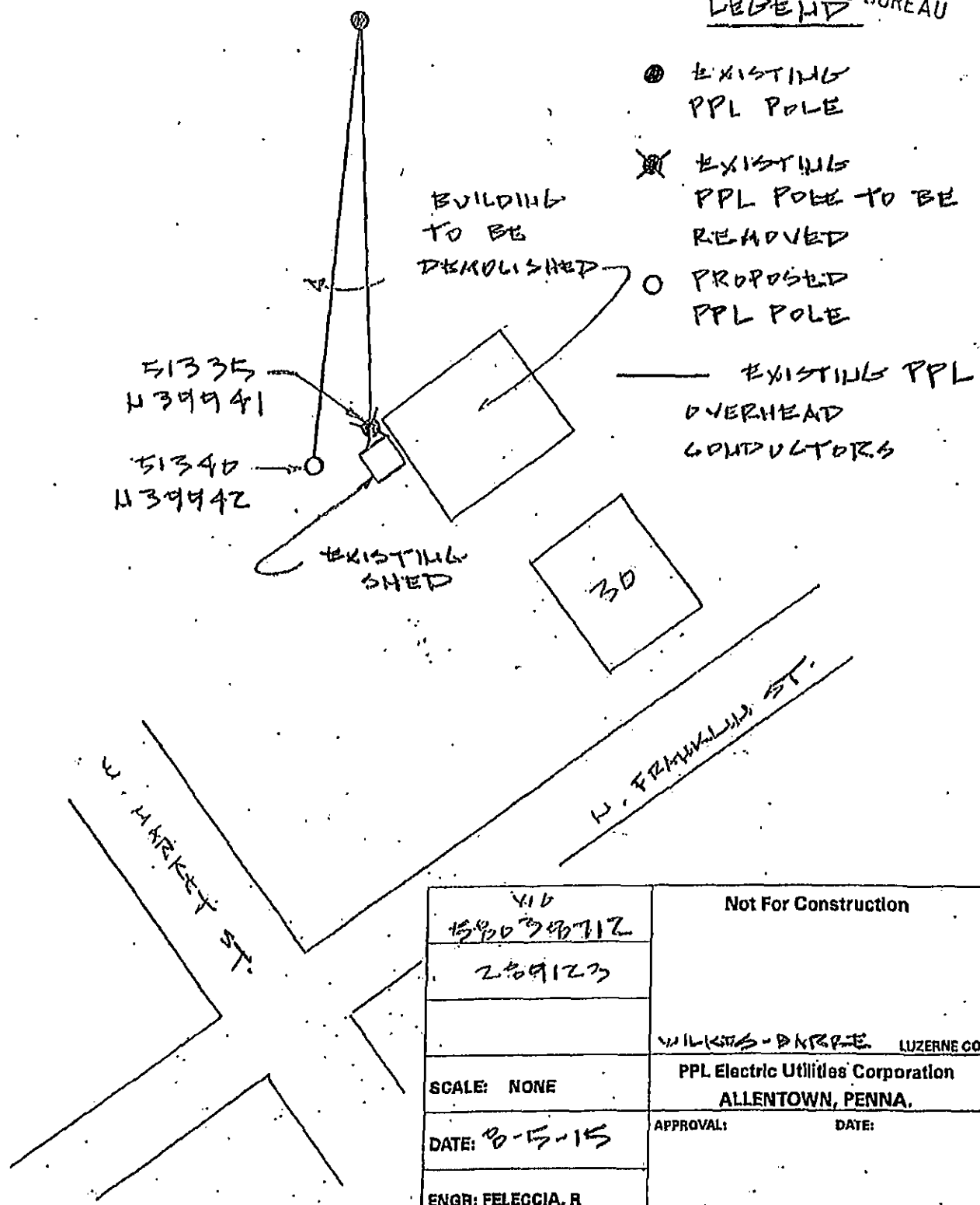

- EXISTING PPL POLE
- ✕ EXISTING PPL POLE TO BE REMOVED
- PROPOSED PPL POLE
- EXISTING PPL OVERHEAD CONDUCTORS

416 1500790712 289123	Not For Construction WILKES-BARRE LUZERNE CO PPL Electric Utilities Corporation ALLENTOWN, PENNA.
SCALE: NONE DATE: 10-15-15 ENGR: FELECCIA, R	APPROVAL: _____ DATE: _____ DWG NO: _____

RECEIVED
2015 OCT -1 AM 10:47
PA P.U.C.
SECRETARY'S BUREAU

Prepared by: PPL Electric Utilities
Return to: PPL Electric Utilities
ROW Department
344 S. Poplar St.
Hazleton, PA 18201

This instrument solely grants, vests
or confirms a public utility easement.

Form 4337 (8/2014)

W.O. Number:							
5	8	0	3	8	7	1	2



GRANT OF RIGHT-OF-WAY

KNOW ALL MEN BY THESE PRESENTS, That the City of Wilkes-Barre, a City of Third Class organized and existing under a Home Rule Charter hereinafter called "GRANTOR", intending to be legally bound, does hereby for itself and its successors and assigns grant unto **PPL ELECTRIC UTILITIES CORPORATION ("PPL")**, its successors and assigns, the right to construct, reconstruct, operate and maintain its electric and communication facilities consisting of one (1) pole and overhead facilities as shown on the plan hereto attached and made a part hereof including such other wires, cables, fixtures and apparatus necessary for the convenient transaction of the business of PPL, upon, across, over, under and along the property identified as County Tax Parcel No. H9SE2-018-01A and H9SE2-018-015 which the undersigned owns or has any interest located along North Franklin Street situate in the City of Wilkes-Barre, County of Luzerne, Commonwealth of Pennsylvania; including the right of ingress and egress to and from the said lines for any of the aforesaid purposes; also the right to cut down any and all trees within twenty-five (25) feet each side of centerline of the electric/communication line and the right to trim any and all trees within twenty-five (25) Feet each side of centerline of the electric/communication line and to remove brush along said lines which in the judgment of said PPL menace the said lines; and also the right to permit the attachment of wires and cables of any other person or company to said poles. Any poles or facilities erected hereunder along a highway, whether within or outside the highway limits, may be relocated to conform to new or relocated highway limits. PPL shall restore the property to substantially the same condition that the property was in prior to installation, maintenance or repair of the electric facilities.

A copy of this agreement and an acceptance hereof by PPL shall be filed by PPL with the Pennsylvania Public Utility Commission, and this agreement shall thereafter become effective in accordance with the provisions of the Public Utility Law.

IN WITNESS WHEREOF, Grantor has caused this agreement to be executed in its corporate name by its proper officers, this 17th day of September, 2015.

ATTEST:

City of Wilkes-Barre
By:

Jim Ryan
City Clerk

Thomas M. Leighton
Name: Thomas M. Leighton
Title: Mayor

Kathy Kane
Name: Kathy Kane
Title: City Controller

COMMONWEALTH OF PENNSYLVANIA)

COUNTY OF LuZerne) : SS

On this, the 17th day of September, 2015, before me, the undersigned officer, personally appeared Mayor Thomas M. Leighton of the City of Wilkes-Barre, known to me (or satisfactorily proven) to be the person described in the foregoing instrument, and acknowledged that he/she executed the same in the capacity therein stated and for the purposes therein contained.

IN WITNESS WHEREOF, I have hereunto set my hand and notarial seal.

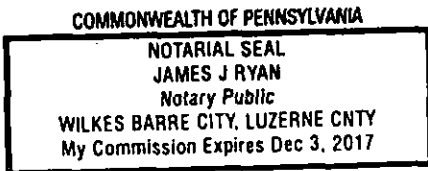

James J. Ryan
Notary Public

ACCEPTED AND CONDITIONS AGREED TO:

WITNESS:

PPL Electric Utilities Corporation
By:

Alvin Schuch 9/25/15 Charlotte Krups 9-25-15

11

LEGEND

- EXISTING PPL POLE
- ✕ EXISTING PPL POLE TO BE REMOVED
- PROPOSED PPL POLE
- EXISTING PPL OVERHEAD CONDUCTORS

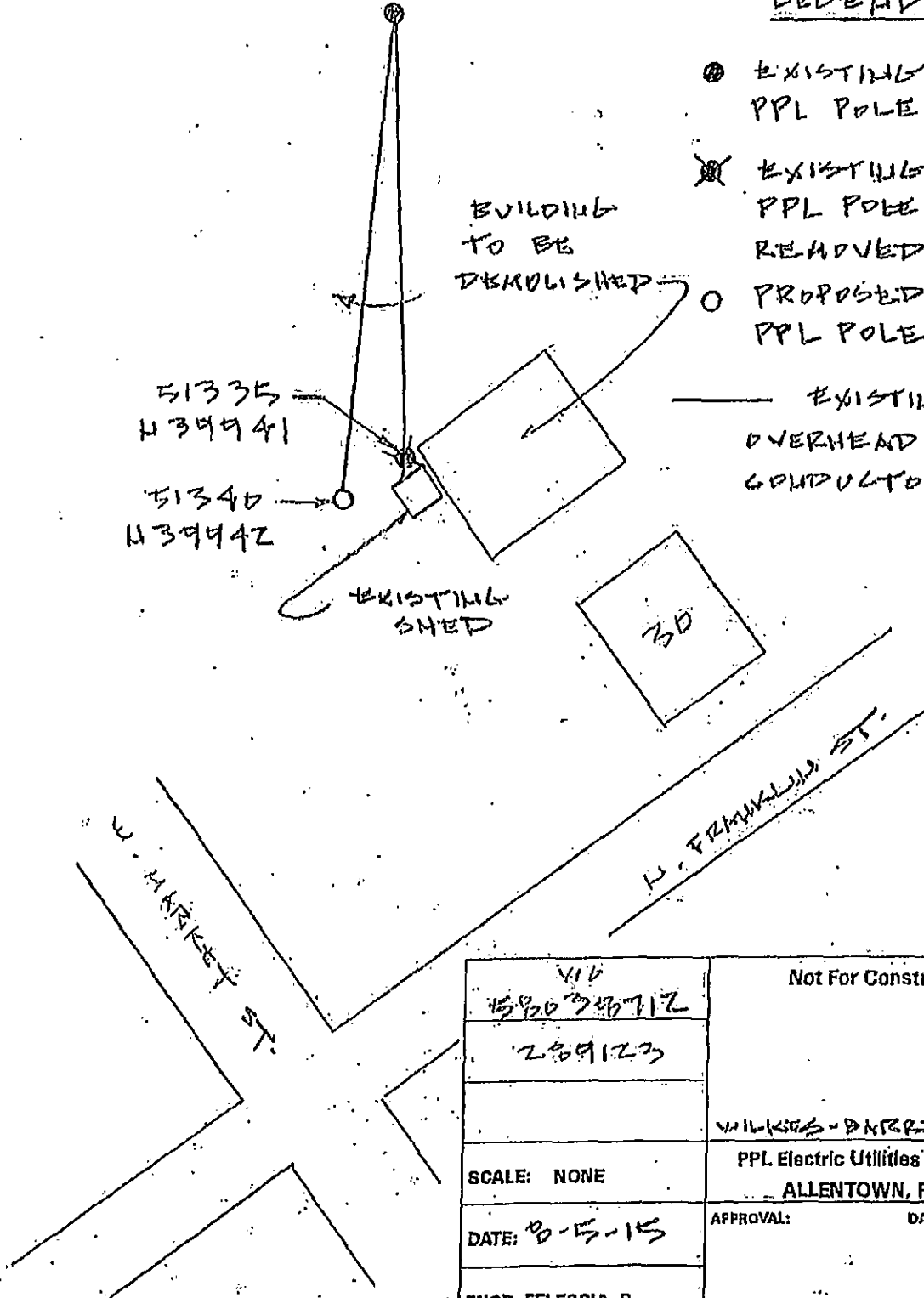

VIB		Not For Construction	
1592079712			
289123			
		WILKES-BARRE LUZERNE CO	
SCALE: NONE		PPL Electric Utilities Corporation ALLENTOWN, PENNA.	
DATE: 8-5-15		APPROVAL:	DATE:
ENGR: FELECCIA, R		DWG NO:	

CHARLOTTE KRUPA
PPL UTILITIES
2 NORTH 9TH ST - GENN3
ALLENTOWN PA 18101



FIRST CLASS MAIL

MS ROSEMARY CHIAVETTA
SECRETARY
PA PUBLIC UTILITY COMMISSION
P O BOX 3265
HARRISBURG PA 17105

