



pennsylvania

DEPARTMENT OF TRANSPORTATION

7000 Geerdes Boulevard
King of Prussia, PA 19406
August 15, 2016

Rosemary Chiavetta, Secretary
Pennsylvania Public Utility Commission
P. O. Box 3265
Harrisburg, PA 17105-3265

Philadelphia County
City of Philadelphia
S.R. 0095, Section BS4 Aramingo Avenue Reconstruction
DOT#531096H
PUC #A-2016-2559976
ECMS#103562

RECEIVED
2016 AUG 18 AM 10:26
PA.P.U.C.
SECRETARY'S BUREAU

Dear Secretary Chiavetta:

We are submitting four sets of relative pages of the final construction plans for review and approval.

Please review and approve these plans, so we may proceed with the construction of this project. A Certificate-of-Service, as required by the Rules of Procedure found in the Pennsylvania Code, are attached for this filing.

Should you have any questions or concerns, please feel free to contact me at 610-205-6532.

Sincerely,

Tom French, District Grade Crossing Administrator
Engineering District 6-0
Department of Transportation

Attachments

cc: Parties of Record
Chief, Right-of-Way and Utilities Section, 7th Floor, CKB
Gina M. D'Alfonso, Office of Chief Counsel, 9th Floor, CKB
Supervisor, Rail Safety Engineering Section, PUC, 3rd Floor, CKB

CERTIFICATE OF SERVICE

I hereby certify that I have this day served a true copy of the foregoing document upon the participants listed below, in accordance with the requirements of 52 Pa. Code §1.54, by first class mail, postage prepaid:

Mr. William Kaeser, Design & Construction Director
Consolidated Rail Corporation
1000 Howard Blvd. – 4th Floor
Mount Laurel, NJ 08054

Mr. Charles Johnson
NJ Transit
One Penn Plaza East
Newark, New Jersey, 07105

Mr. Sozi Pedro Tulante, City Solicitor
City of Philadelphia Law Department
1515 Arch Street – 17th floor
Philadelphia, PA 19102-1595

Mr. David Perri, Chief Engineer
City of Philadelphia Department of Streets
1401 JFK Blvd. – Room 830
Philadelphia, PA 19102-1676

Mr. Patrick O'Donnell, Right-of-Way Manager
City of Philadelphia Department of Streets
1401 JFK Blvd. – Room 940 MSB
Philadelphia, PA 19102-1676

Mr. Bill Hensil, Program Manager
PECO Energy Company
1050 West Swedesford Road
Berwyn, PA 19312

Mr. Ryan Bream
Philadelphia Gas Works
800 W. Montgomery Ave.
Planning Section – 2nd floor
Philadelphia, PA 19122-2898

Mr. Michael Lavery, Design Branch Manager
City of Philadelphia Water Department
1101 Market Street – 5th floor
Philadelphia, PA 19107-2994

RECEIVED

AUG 18 2016

PA PUBLIC UTILITY COMMISSION
SECRETARY'S BUREAU

Ms. Deborah Barum, Section Manager
Verizon Pennsylvania, Inc.
15 Montgomery Place – Floor 2
Pittsburgh, PA 15212

Dated this 15th day of August 2016



Tom French
District 6-0 Grade Crossing Administrator

RECEIVED

2016 AUG 18 AM 10:26

PA.P.U.C.
SECRETARY'S BUREAU

8/2/2016
2:44:57 PM

ESTABLISHED AS A LIMITED ACCESS HIGHWAY FROM STATION 345+00 TO STATION 846+50 BY PLAN FOR LEGISLATIVE ROUTE 1000, SECTION 2E, APPROVED BY GOVERNOR GEORGE LEADER, DECEMBER 27, 1956.

ESTABLISHED AND RE-ESTABLISHED AS A LIMITED ACCESS HIGHWAY FROM STATION 424+10 TO STATION 493+00 BY PLAN FOR LEGISLATIVE ROUTE 1000, SECTION H-1 R/W AND FROM STATION 256+92 TO STATION 265+20 BY PLAN FOR LEGISLATIVE ROUTE 1078, SECTION C-3 R/W, APPROVED BY GOVERNOR MILTON J. SHAPP, MARCH 8, 1972.

RE-ESTABLISHED AS A LIMITED ACCESS HIGHWAY FROM STATION 479+24 TO STATION 537+58.55 BY PLAN FOR LEGISLATIVE ROUTE 1000, SECTION H-2 R/W, AND FROM STATION 229+70.41 TO STATION 256+92 BY PLAN FOR LEGISLATIVE ROUTE 1078, SECTION C-2 R/W, APPROVED BY GOVERNOR MILTON J. SHAPP, APRIL 19, 1972.

ESTABLISHED AS A LIMITED ACCESS HIGHWAY FROM STATION 27+20 TO STATION 50+73 BY PLAN FOR STATE ROUTE 1026, SECTION H03 R/W, APPROVED BY SECRETARY OF TRANSPORTATION BRADLEY L. MALLORY ON BEHALF OF GOVERNOR THOMAS J. RIDGE, APRIL 5, 1997.

RE-ESTABLISHED AS A LIMITED ACCESS HIGHWAY FROM STATION 492+35.06 TO STATION 493+87.25 BY PLAN FOR STATE ROUTE 0095, SECTION BRO R/W, APPROVED BY THE SECRETARY OF TRANSPORTATION, MARCH 7, 2013, AND RECORDED ON MARCH 27, 2013.

RE-ESTABLISHED AS A LIMITED ACCESS HIGHWAY FROM STATION 492+35.06 TO STATION 493+87.25 BY PLAN FOR STATE ROUTE 0095, SECTION BRO R/W REVISION 1, APPROVED BY THE SECRETARY OF TRANSPORTATION, JANUARY 16, 2014, AND RECORDED ON FEBRUARY 11, 2014.

RE-ESTABLISHED AS A LIMITED ACCESS HIGHWAY FROM STATION 492+35.06 TO STATION 493+87.25 BY PLAN FOR STATE ROUTE 0095, SECTION BRO R/W REVISION 2, APPROVED BY THE SECRETARY OF TRANSPORTATION, APRIL 1, 2014, AND RECORDED ON MAY 7, 2014.

THE LEGAL RIGHT-OF-WAY FOR SR 1026 FROM STATION 1010+50.00 TO STATION 1027+17.38 IS VARIABLE IN WIDTH BASED ON THE DRAWINGS ESTABLISHING LIMITED ACCESS HIGHWAY AND AUTHORIZING ACQUISITION OF RIGHT-OF-WAY FOR SR 1026, SECTION BRO R/W, APPROVED BY THE SECRETARY OF TRANSPORTATION ON MARCH 7, 2013, AND RECORDED ON MARCH 27, 2013 IN THE PHILADELPHIA COUNTY RECORDER'S OFFICE IN PLAN BOOK 95, PAGE 1184.

DISTRICT	COUNTY	TOWNSHIP	CITY	ROUTE	SECTION	TOTAL SHEETS
6-0	PHILADELPHIA	-	PHILADELPHIA	0095	BS4	142
				1026	BS4	
				2009	BS4	

SR 0095 PREVIOUSLY KNOWN AS LR 1000 ECMS NO. 103562
SR 1026 PREVIOUSLY KNOWN AS LR 1078
SR 2009 PREVIOUSLY KNOWN AS LR 67047

COMMONWEALTH OF PENNSYLVANIA



DEPARTMENT OF TRANSPORTATION

DRAWINGS FOR CONSTRUCTION OF

STATE ROUTE 0095 SECTION BS4
IN PHILADELPHIA COUNTY

AND

STATE ROUTE 1026 SECTION BS4

FROM STA 1010+50.00 TO STA 1027+63.02 LENGTH 1676.38 FT 0.317 MI
FROM SEG 0010 OFFSET 0945 TO SEG 0010 OFFSET 2658

AND

STATE ROUTE 2009 SECTION BS4

FROM STA 183+00.00 TO STA 224+00.00 LENGTH 3838.00 FT 0.727 MI
FROM SEG 0060 OFFSET 1155 TO SEG 0070 OFFSET 2556
FROM SEG 0061 OFFSET 1151 TO SEG 0071 OFFSET 2556

TOTAL CONSTRUCTION LENGTH 5514.38 FT 1.044 MI

ALSO

STATE ROUTE 8017

ALSO INCLUDED:

TRAFFIC CONTROL PLAN	184 SHEETS
SIGNING AND SIGN LIGHTING PLAN	72 SHEETS
PAVEMENT MARKING PLAN	20 SHEETS
PWD SEWER RECONSTRUCTION PLAN	
S-40911-AD	73 SHEETS
LANDSCAPING PLAN	15 SHEETS
EROSION AND SEDIMENT POLLUTION CONTROL PLAN	84 SHEETS
POST CONSTRUCTION STORMWATER MANAGEMENT PLAN	30 SHEETS
HIGHWAY LIGHTING PLAN	38 SHEETS
TRAFFIC SIGNAL PLAN	12 SHEETS
PHILADELPHIA GAS WORKS GAS RELOCATION PLAN	3 SHEETS
PECO RELOCATION PLAN - ELECTRICAL DESIGN	5 SHEETS
PECO RELOCATION PLAN - CIVIL DESIGN	10 SHEETS
STRUCTURE PLANS	
S-33518	70 SHEETS
CROSS SECTIONS	119 SHEETS
EXISTING STRUCTURE PLANS (FOR INFORMATION ONLY)	
S-32642 (RAMP C)	43 SHEETS
S-32058 (RAMP D)	162 SHEETS
S-34262 (RAMP F)	26 SHEETS
S-32057 (RAMP I)	134 SHEETS
S-32640 (RAMP JJ)	174 SHEETS

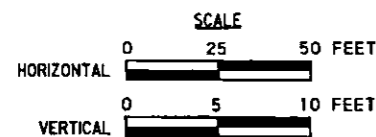

SR 1026 DESIGN DESIGNATION

HIGHWAY CLASSIFICATION - URBAN MINOR ARTERIAL
DESIGN SPEED - 30 MPH
PAVEMENT WIDTH - 36'-48'
SHOULDER WIDTH - 0'-3'

TRAFFIC DATA

CURRENT ADT - N/A
DESIGN YEAR ADT - 19,342 (2040)
DHV - 1,470
D - 60%
T - 10%

SR 2009 DESIGN DESIGNATION

HIGHWAY CLASSIFICATION - URBAN PRINCIPAL ARTERIAL
DESIGN SPEED - 30 MPH
PAVEMENT WIDTH - 44'-72'
SHOULDER WIDTH - 0'-7' BIKE LANE
MEDIAN WIDTH - 0'-23'

TRAFFIC DATA

CURRENT ADT - 29,548 (2016)
DESIGN YEAR ADT - 39,548 (2040)
DHV - 2,950
D - 55%
T - 10%

RECEIVED
2016 AUG 18 AM 10:28
P.A.P.U.C.
SECRETARY'S BUREAU

PREPARED BY:
CDM Smith
3605 Harton Way, Suite 202
Harrisburg, PA 17110
Tel: (717) 541-4001

ROBERT S. KOCHER
REGISTERED PROFESSIONAL ENGINEER
PE-6840-1

8/2/2016
DATE:

PREPARED BY:
AMMANN & WHITNEY
PENNSYLVANIA, INC.
CONSULTING ENGINEERS
2401 WALNUT STREET
PHILADELPHIA, PA 19103

IRENE B. EELLS
REGISTERED PROFESSIONAL ENGINEER
PE-14123

8-2-2016
DATE:

RECOMMENDED DATE: 8/3/2016
DISTRICT EXECUTIVE

RECOMMENDED DATE: 8/4/2016
DEPUTY SECRETARY

APPROVED DATE: 8/4/2016
SECRETARY OF TRANSPORTATION
(ON BEHALF OF THE GOVERNOR AS WELL AS HERSELF)

OPERATOR: Hommerber.od
M:\1955\SR F\In\BSA\Roadway\Final\Drawings\01.C01.BS4.CDMS.dgn

A-2016-2559976

TABULATION OF OVERALL LENGTH

SR 1026 STA 1010+50.00 TO STA 1027+63.02 = 1713.02 FEET = 0.324 MILE
 SR 2009 STA 183+00.00 TO STA 224+00.00 = 4100.00 FEET = 0.777 MILE
OVERALL LENGTH = 5813.02 FEET = 1.101 MILES

TABULATION OF CONSTRUCTION LENGTH

SR 1026 STA 1010+50.00 TO STA 1027+26.38 = 1676.38 FEET = 0.317 MILE
 SR 2009 STA 184+36.00 TO STA 222+74.00 = 3838.00 FEET = 0.727 MILE
CONSTRUCTION LENGTH = 5514.38 FEET = 1.044 MILES

LIST OF PUBLIC UTILITIES

- CU - PECO ENERGY C/O USIC
1050 WEST SWEDSFORD ROAD
BERWYN, PA 19312
LOU ROBINSON
215-731-3283
BILL HENSIL
610-725-7129
- W - CITY OF PHILADELPHIA WATER DEPT.
ARAMARK TOWER, 2ND FLOOR
1101 MARKET ST
PHILADELPHIA, PA 19107
BILL DOBBINS
215-685-6290
VINU VARGHESE
215-685-6332
- G - PHILADELPHIA GAS WORKS
800 W. MONTGOMERY AVE.
PHILADELPHIA, PA 19122
TOM PENDERGAST
215-684-6344
RYAN BREAM
215-684-6719
- TU - VERIZON PENNSYLVANIA LLC.
900 RACE ST, 6TH FLOOR
PHILADELPHIA, PA 19107
DAVID HUFFNAGLE
215-351-6080
BRIAN WAGEE
215-351-6051

PENNSYLVANIA ONE CALL SYSTEM, INC.
 925 Irwin Run Road
West Mifflin, Pennsylvania
15122-1078

BEFORE YOU DIG ANYWHERE IN PENNSYLVANIA CALL 1-800-242-1776
 NON-MEMBERS MUST BE CONTACTED DIRECTLY
 PA LAW REQUIRES THREE WORKING DAYS NOTICE TO UTILITIES BEFORE YOU EXCAVATE, DRILL, BLAST OR DEMOLISH

DISTRICT	COUNTY	ROUTE	SECTION	SHEET
6-0	PHILADELPHIA	0095	BS4	3 OF 142
		1026	BS4	
		2009	BS4	

CITY OF PHILADELPHIA

REVISION NUMBER	REVISIONS	DATE	BY

GENERAL NOTES

THE LEGAL RIGHT-OF-WAY FOR SR 1026 FROM STATION 1010+50.00 TO STATION 1027+17.38 IS VARIABLE IN WIDTH IN ACCORDANCE WITH THE DRAWINGS ESTABLISHING LIMITED ACCESS HIGHWAY AND AUTHORIZING ACQUISITION OF RIGHT-OF-WAY FOR SR 1026, SECTION BRO R/W, APPROVED BY THE SECRETARY OF TRANSPORTATION ON MARCH 7, 2013, AND RECORDED ON MARCH 27, 2013, IN THE PHILADELPHIA COUNTY RECORDER'S OFFICE IN PLAN BOOK 95, PAGE 1184, SUBSEQUENTLY REVISED ON JANUARY 16, 2014, AND RE-RECORDED ON FEBRUARY 11, 2014, IN PLAN BOOK 85, PAGES 44 TO 81, AND REVISED ON APRIL 1, 2014, AND RE-RECORDED ON MAY 7, 2014, IN PLAN BOOK 85, PAGES 88 TO 110.

THE LEGAL RIGHT-OF-WAY WIDTH FOR SR 1026 ON THE WEST SIDE OF THE WESTERLY LEGAL RIGHT-OF-WAY LINE OF SR 2009 (ARAMINGO AVENUE) IS VARIABLE IN WIDTH IN ACCORDANCE WITH DRAWINGS ESTABLISHING LIMITED ACCESS HIGHWAY AND AUTHORIZING ACQUISITION OF RIGHT-OF-WAY FOR SR 1026, SECTION HO3 R/W, APPROVED BY THE SECRETARY OF TRANSPORTATION ON APRIL 5, 1997, AND RECORDED ON APRIL 24, 1997, IN THE PHILADELPHIA COUNTY RECORDER'S OFFICE IN PLAN BOOK 82, PAGES 39 TO 89.

THE LEGAL RIGHT-OF-WAY WIDTH FOR SR 2009 (ARAMINGO AVENUE) FROM STATION 189+30.00 TO STATION 197+60.00 AND FROM STATION 217+75.00 TO STATION 218+34.47 IS 108.27 FEET (CITY OF PHILADELPHIA DISTRICT STANDARD MEASUREMENT OF 108 FEET) AND VARIES BASED ON CITY STREET PLAN REVISING PORTIONS OF CITY PLANS NOS. 55 AND 187 OF THE 23RD AND 45TH WARDS AND AUTHORIZED BY ORDINANCES OF COUNCIL APPROVED FEBRUARY 17, 1948 AND DECEMBER 13, 1950, CONFIRMED BY BOARD OF SURVEYORS ON JANUARY 15, 1951 AND FILED IN THE CITY PLANS OFFICE, DEPARTMENT OF STREETS, PHILADELPHIA, PA.

THE LEGAL RIGHT-OF-WAY WIDTH FOR SR 2009 (ARAMINGO AVENUE) FROM STATION 197+60.00 TO STATION 217+75.00 IS VARIABLE IN WIDTH BASED ON PLAN OF SR 2009, SECTION BRO R/W, APPROVED BY THE SECRETARY OF TRANSPORTATION ON MARCH 7, 2013 AND RECORDED ON MARCH 27, 2013 IN THE PHILADELPHIA COUNTY RECORDER'S OFFICE IN PLAN BOOK 95, PAGE 1184, SUBSEQUENTLY REVISED ON JANUARY 16, 2014, AND RE-RECORDED ON FEBRUARY 11, 2014, IN PLAN BOOK 85, PAGES 44 TO 81, AND REVISED ON APRIL 1, 2014, AND RE-RECORDED ON MAY 7, 2014, IN PLAN BOOK 85 PAGES 88 TO 110.

THE LEGAL RIGHT-OF-WAY WIDTH FOR CHURCH STREET FROM SEPVIVA STREET TO SR 2009 (ARAMINGO AVENUE) IS 60.15 FEET (CITY OF PHILADELPHIA DISTRICT STANDARD MEASUREMENT OF 60 FEET) BASED ON CITY STREET PLAN REVISING PORTIONS OF CITY PLANS NOS. 55 AND 187 OF THE 23RD AND 45TH WARDS AND AUTHORIZED BY ORDINANCES OF COUNCIL APPROVED FEBRUARY 17, 1948 AND DECEMBER 13, 1950, CONFIRMED BY BOARD OF SURVEYORS ON JANUARY 15, 1951 AND FILED IN THE CITY PLANS OFFICE, DEPARTMENT OF STREETS, PHILADELPHIA, PA.

THE LEGAL RIGHT-OF-WAY WIDTH FOR DUNCAN STREET FROM SEPVIVA STREET TO SR 2009 (ARAMINGO AVENUE) IS 50.13 FEET (CITY OF PHILADELPHIA DISTRICT STANDARD MEASUREMENT OF 50 FEET) BASED ON CITY STREET PLAN REVISING PORTIONS OF CITY PLANS NOS. 55 AND 187 OF THE 23RD AND 45TH WARDS AND AUTHORIZED BY ORDINANCES OF COUNCIL APPROVED FEBRUARY 17, 1948 AND DECEMBER 13, 1950, CONFIRMED BY BOARD OF SURVEYORS ON JANUARY 15, 1951 AND FILED IN THE CITY PLANS OFFICE, DEPARTMENT OF STREETS, PHILADELPHIA, PA.

THE DEPARTMENT RESERVES THE RIGHT TO ELIMINATE ANY OR ALL THIS WORK. DO NOT PERFORM WORK EXCEPT THAT WHICH IS WITHIN THE HIGHWAY RIGHT-OF-WAY UNTIL SO ORDERED IN WRITING BY THE ENGINEER.

THIS IS A FEDERAL-AID PROJECT AND AS SUCH IS SUBJECT TO INSPECTION BY REPRESENTATIVES OF THE FEDERAL HIGHWAY ADMINISTRATION AND THE PENNSYLVANIA DEPARTMENT OF TRANSPORTATION.

LIST OF EQUALITIES

NONE

UTILITY NOTES

THE DEPARTMENT OF TRANSPORTATION DOES NOT GUARANTEE THE ACCURACY OF THE LOCATIONS OF THE EXISTING SUBSURFACE UTILITY STRUCTURES SHOWN ON THE PLANS, NOR DOES THE DEPARTMENT GUARANTEE THAT ALL STRUCTURES ARE SHOWN.

THREE WORKING DAYS PRIOR TO EXCAVATION THE CONTRACTOR MUST CONTACT THE PA ONE-CALL SYSTEM INC., PHONE 1-800-242-1776 SERIAL NUMBERS ARE ALL FOR THE CITY OF PHILADELPHIA:

- 20150821209
- 20150821227
- 20150821228
- 20150821324
- 20150821325

TABULATION OF SEGMENT EQUALITIES

SR 1026 (ADAMS AVENUE)
 SEGMENT 0010 OFFSET 0000 = STATION 1001+05.00
 SEGMENT 0010 OFFSET 0945 = STATION 1010+50.00
 SEGMENT 0010 OFFSET 2658 = STATION 1027+63.02

SR 2009 NORTHBOUND (ARAMINGO AVENUE)
 SEGMENT 0060 OFFSET 1155 = STATION 183+00.00
 SEGMENT 0060 OFFSET 2699 = STATION 198+44.00
 SEGMENT 0070 OFFSET 0000 = STATION 198+44.00
 SEGMENT 0080 OFFSET 0000 = STATION 225+42.00

SR 2009 SOUTHBOUND (ARAMINGO AVENUE)
 SEGMENT 0061 OFFSET 1151 = STATION 183+00.00
 SEGMENT 0061 OFFSET 2695 = STATION 198+44.00
 SEGMENT 0071 OFFSET 0000 = STATION 198+44.00
 SEGMENT 0081 OFFSET 0000 = STATION 225+34.00

SR 8017 (RAMP C)
 SEGMENT 0020 OFFSET 2808 = STATION 107+28.00
 SEGMENT 0020 OFFSET 3266 = STATION 111+85.72

SR 8017 (RAMP D)
 SEGMENT 0250 OFFSET 0000 = STATION 50+00.00
 SEGMENT 0250 OFFSET 1900 = STATION 69+00.00

SR 8017 (RAMP F)
 SEGMENT 0500 OFFSET 0000 = STATION 811+25.00
 SEGMENT 0500 OFFSET 3161 = STATION 842+86.31

SR 8017 (RAMP I)
 SEGMENT 0770 OFFSET 0000 = STATION 295+00.00
 SEGMENT 0770 OFFSET 2745 = STATION 322+44.83

SR 8017 (RAMP JJ)
 SEGMENT 0270 OFFSET 0000 = STATION 247+59.75
 SEGMENT 0270 OFFSET 1660 = STATION 264+20.00

SR 8017 (RAMP KK)
 SEGMENT 0510 OFFSET 0000 = STATION 399+27.95
 SEGMENT 0510 OFFSET 1284 = STATION 412+11.65

EARTHWORK SUMMARY ENTIRE PROJECT

THE INFORMATION ON ESTIMATED AMOUNTS OF EARTHWORK HAS BEEN USED IN THE PRELIMINARY ESTIMATE. DO NOT USE AS A WAIVER OF ANY PROVISIONS OF THE SPECIFICATIONS AND CONTRACTS.

CUBIC YARDS OF EXCAVATION						CUBIC YDS. OF COMPLETED EMBANKMENT *	CUBIC YDS. OF FOREIGN BORROW EXCAVATION	CUBIC YDS. OF COMMON BORROW EXCAVATION
CLASS 1 MODIFIED	CLASS 1A MODIFIED	CLASS 1B MODIFIED	CLASS 2 MODIFIED	CLASS 3** MODIFIED	CLASS 4 MODIFIED			
112,706	-----	4,291	2,013	3,215	9,900	64,666	30,492	0

* INCLUDES ALL BORROW ITEMS
 ** 3,215 CY PART OF LUMP SUM STRUCTURE ITEM.

EARTHWORK SUMMARY ENTIRE PROJECT, CONT.

THE INFORMATION ON ESTIMATED AMOUNTS OF EARTHWORK HAS BEEN USED IN THE PRELIMINARY ESTIMATE. DO NOT USE AS A WAIVER OF ANY PROVISIONS OF THE SPECIFICATIONS AND CONTRACTS.

CUBIC YARDS OF ROCK, CLASS R-3	CUBIC YARDS OF ROCK, CLASS R-4	CUBIC YARDS OF ROCK, CLASS R-7	CUBIC YARDS OF SELECTED BORROW EXC. ROCK, R-6	CUBIC YARDS OF SELECTED BORROW EXC. ROCK, R-8	CUBIC YARDS OF SELECTED BORROW EXC. STRUCTURE BACKFILL ***	TOPSOIL (TON)▲	CUBIC YDS. OF AMENDED SOILS	DISPOSAL OF RESIDUAL WASTE (TON)▲▲	DISPOSAL OF HAZARDOUS WASTE (TON)▲▲▲	DISPOSAL OF CLEAN FILL (TON)▲▲▲▲
261	2	245	841	419	598	17,611	4,887	98,848	84,605	30,791

▲UNIT WEIGHT = 110 PCF
 ▲▲UNIT WEIGHT = 128 PCF
 ▲▲▲UNIT WEIGHT = 155 PCF
 *** 598 CY PART OF LUMP SUM STRUCTURE ITEM.
 ▲▲▲▲UNIT WEIGHT = 145 PCF (EXISTING PAVEMENT)

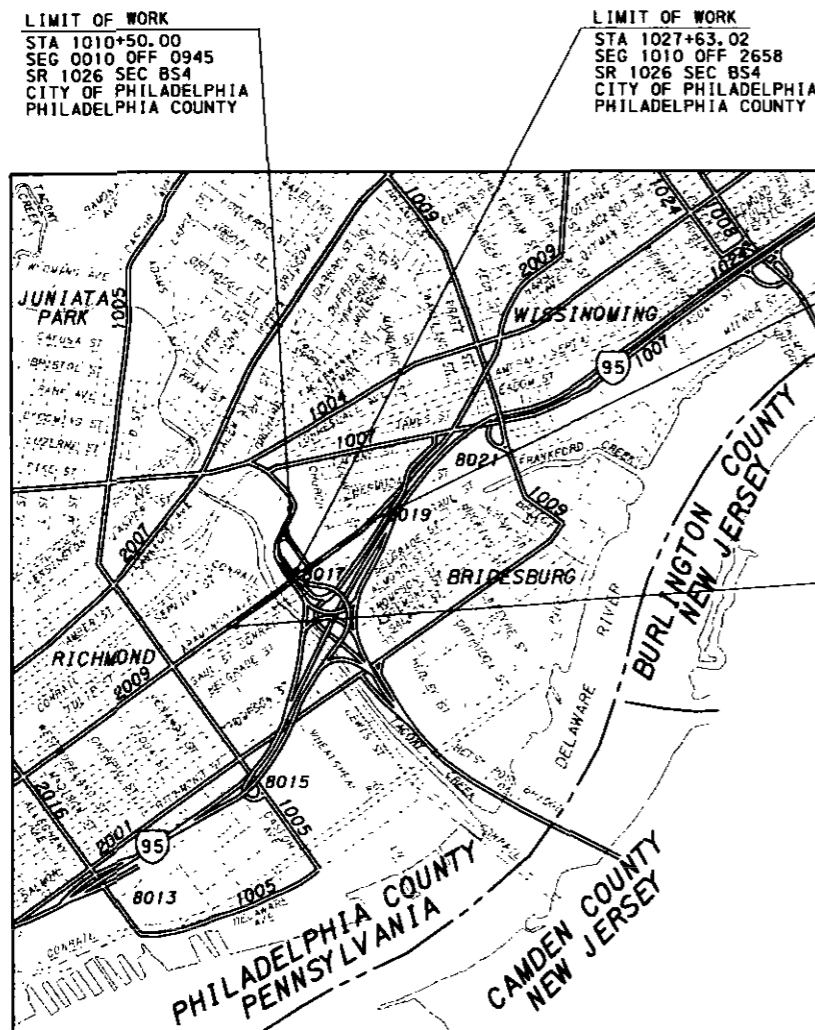

LOCATION MAP

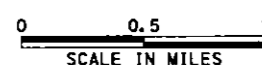

LEGEND

- PROJECT
- STATE HIGHWAY
- CITY STREET
- COUNTY BOUNDARY

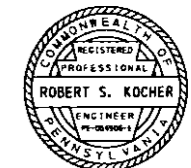

DISTRICT	COUNTY	ROUTE	SECTION	SHEET
6-0	PHILADELPHIA	0095	BS4	105 OF 142
		1026	BS4	
		2009	BS4	

CITY OF PHILADELPHIA			
REVISION NUMBER	REVISIONS	DATE	BY

BM #100 ELEV 17.00'
30.56' LT, STA 194+79.67 SR 2009
BRASS SURVEY DISK

SR 2009 (ARAMINGO AVE)
SURVEY & CONSTR @
PI STA 194+59.95
 $\Delta = 1^{\circ}20'13''$ LT
NO CURVE

1 STY "PUBLIC STORAGE" OFFICE BUILDING

1 STY BLOCK STORAGE UNITS

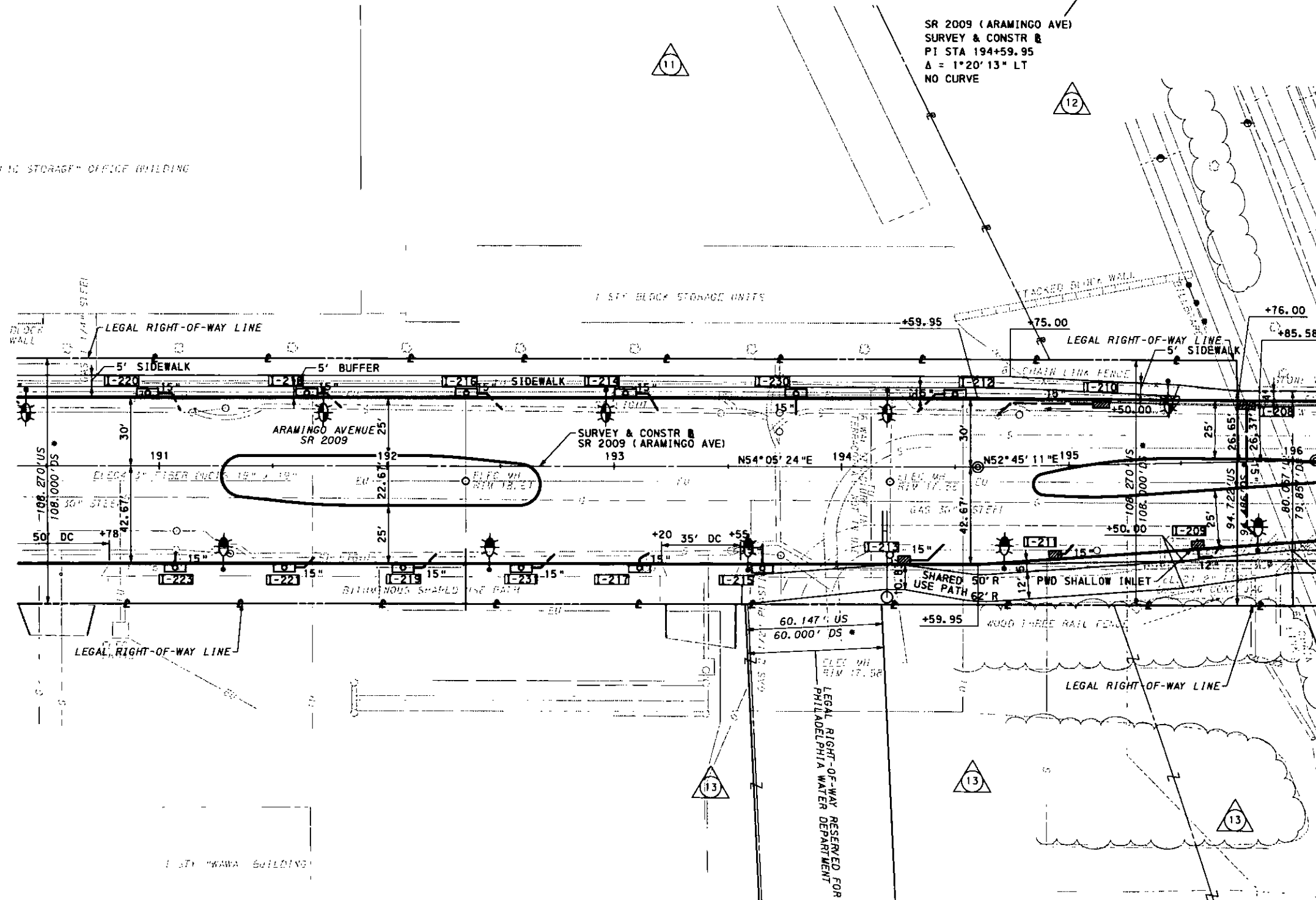

SEE SHEET 104

SEE SHEET 106

LEGEND



STAMPED
PLAIN CEMENT
CONCRETE
PAVEMENT

SR 2009 (ARAMINGO AVE)
SURVEY & CONSTR @
PI STA 196+09.94
 $\Delta = 1^{\circ}20'13''$ RT
NO CURVE

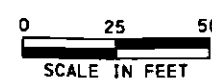
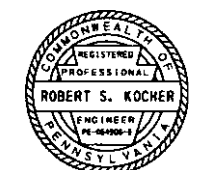

FOR ISLAND DETAIL, SEE SHEETS 11 & 12 FOR PROFILE SR 2009, SEE SHEET 118
FOR REFERENCE CIRCLES, SEE SHEET 7 SURVEY BOOK # 10373, 10418, & 10423

M:\1955secBSR - F:\m\BSA\p\roadway\F:\m\ID\as\LocaP\10373_002_Cop - BS4_CONS.dgn
8/8/2016 2:14:30 PM OPERATOR1081 hammar@arad

DISTRICT	COUNTY	ROUTE	SECTION	SHEET
6-0	PHILADELPHIA	0095	BS4	106 OF 142
		1026	BS4	
		2009	BS4	
CITY OF PHILADELPHIA				
REVISION NUMBER	REVISIONS	DATE	BY	

PROPOSED STRUCTURE DATA

STA 199+22.90
 TYPE 2 SPAN CONTINUOUS STEEL MULTI GIRDER
 SPANS 91'-6" AND 91'-6"
 CLEAR SPANS 88'-6" AND 88'-6"
 VERTICAL CLEARANCE - 15'-1 1/2" MIN
 SKEW 90° 0' 00"
 CLEAR ROADWAY 71'-6"
 STRUCTURE - S-33518

HYDRAULIC DATA

DRAINAGE AREA 33.8± SQ MILES
 FLOOD OF RECORD -
 DESIGN FREQUENCY = 50 YEARS (PENNDOT)
 DISCHARGE = 14,500 CFS
 VELOCITY = 6.53 FT/S
 W.S. ELEV = 15.14'
 DESIGN FREQUENCY = 100 YEARS (DEP)
 DISCHARGE = 17,500 CFS
 VELOCITY = 7.36 FT/S
 W.S. ELEV = 16.39'

EXISTING STRUCTURE DATA

STA 199+22.62
 TYPE 2 SPAN STEEL ROLLED BEAM
 SPANS 76'-4" AND 76'-4"
 VERTICAL CLEARANCE - TBD
 SKEW 90°
 CLEAR ROADWAY 72'-2" ±

SR 2009 (ARAMINGO AVENUE)
 SURVEY & CONSTR
 PI STA 196+09.94
 Δ = 1°20'13" RT
 NO CURVE

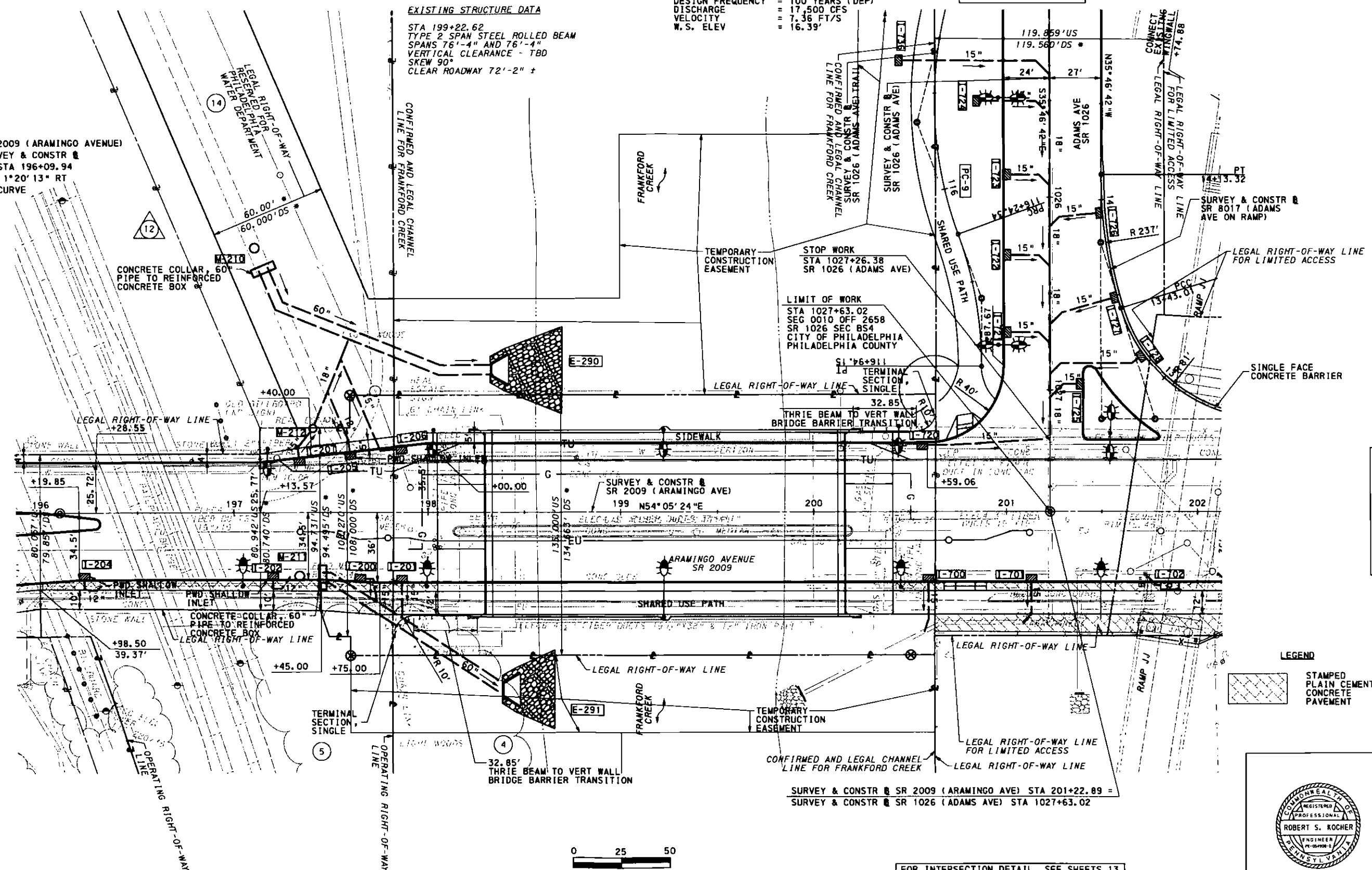

SEE SHEET 113

SEE SHEET 105

SEE SHEET 107

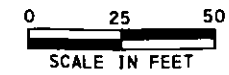

FOR ISLAND DETAIL, SEE SHEETS 12
 FOR INTERSECTION DETAIL, SEE SHEETS 13
 FOR REFERENCE CIRCLES, SEE SHEET 7
 SURVEY BOOK # 10373, 10418, & 10423

LEGEND
 STAMPED PLAIN CEMENT CONCRETE PAVEMENT

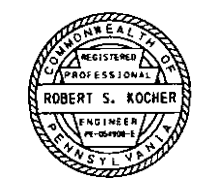

M:\1955ecBSR\Final\19554_Roadway\19554_Roadway.dwg
 8/28/2016 2:14:52 PM
 D:\1955ecBSR\19554_Roadway\19554_Roadway.dwg