

Kimberly A. Klock
Senior Counsel

PPL
Two North Ninth Street
Allentown, PA 18101-1179
Tel. 610.774.5696 Fax 610.774.6726
KKlock@pplweb.com



E-File

November 15, 2016

Rosemary Chiavetta, Secretary
Pennsylvania Public Utility Commission
Commonwealth Keystone Building
400 North Street, 2nd Floor North
P.O. Box 3265
Harrisburg, PA 17120-3265

**Re: PPL Electric Utilities Corporation Right of Way Agreement;
Bethlehem Parking Authority,
Bethlehem, Northampton County, Pennsylvania**

Dear Secretary Chiavetta:

Enclosed for filing on behalf of PPL Electric Utilities Corporation ("PPL Electric") is a Right of Way Agreement between PPL Electric and the Bethlehem Parking Authority located in Bethlehem, Northampton County, Pennsylvania. This agreement is being filed pursuant to 66 Pa. C.S.A. § 507.

Pursuant to 52 Pa. Code § 1.11, the enclosed document is to be deemed filed on November 15, 2016, which is the date it was filed electronically using the Commission's E-filing system.

If you have any questions please do not hesitate to contact me.

Respectfully submitted,

Kimberly A. Klock

Enclosure

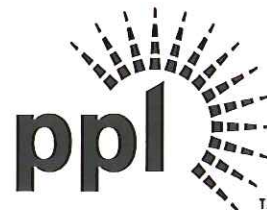

November 10, 2016

TO: Randy Quinby

LIST OF AGENCIES:

- DEPT OF AGRICULTURE
- ARMY CORP OF ENGINEERS
- DEPT OF ARMY
- DEPT OF CONSERVATION & NATURAL RESOURCES:
- BUREAU OF FORESTRY
- BUREAU OF STATE PARKS
- DEPT OF CORRETION
- DEPT OF FOREST & WATER
- GSA (STATE)
- GSA (FEDERAL)
- DEPT OF MILITARY AFFAIRS
- DEPT OF WELFARE
- PA FISH & BOAT COMMISSION
- PA GAME COMMISSION
- PA DEPT OF TRANSPORTATION
- PA TURNPIKE COMMISSION
- PUC

COAL COMPANY

Name: _____
Agrt. Date: _____
File ID#: _____

Rental:
Non-Rental

RAILROAD: _____

DESCRIPTION OF WORK: TT & TC: 25' C/L

NAME AND TELEPHONE NUMBER OF CONTACT: Ron Borger at 570-620-3380 or 610-782-5814

Agency Contact: Bethlehem Parking Authority
Attn: Kevin Livingston, Director
85 W. North Street
Bethlehem, Pa. 18018



Prepared by: PPL Electric Utilities
Return to: PPL Electric Utilities
ROW Department
1047 North Plymouth Street
Allentown, Pa. 18109
Attn. Ron Borger

4671ETCI (8/2014)

W.O. Number:							
4	4	0	8	4	3	6	2



RIGHT OF WAY GRANT FOR TREE WORK
(Corporation)

KNOW ALL MEN BY THESE PRESENTS, That Bethlehem Parking Authority, a parking authority of Pennsylvania hereinafter called "GRANTOR," intending to be legally bound, does hereby for itself, its successors and assigns, grant unto PPL Electric Utilities Corporation, hereinafter called "COMPANY" its successors and assigns, the right, privilege and authority to cut down any and all trees within twenty-five (25) feet each side of centerline of the electric/communication line and the right to trim any and all trees within twenty-five (25) feet each side of centerline of the electric line and to remove brush along said lines which in the judgment of the said Company menace the said lines; on property identified as County Tax Parcel No. P6SE2A 29 31 0204E which the undersigned owns or has any interest located along Atlantic Street situate in the City of Bethlehem, County of Northampton, Commonwealth of Pennsylvania.

A copy of this agreement and an acceptance hereof by PPL shall be filed by PPL with the Pennsylvania Public Utility Commission, and this agreement shall thereafter become effective in accordance with the provisions of the Public Utility Law.

IN WITNESS WHEREOF, Grantor has caused this agreement to be executed in its corporate name by its proper officers, this 19th day of January, 2015.¹⁶

ATTEST:

Bethlehem Parking Authority

Secretary

By: 

Name: Kevin Livingston
Title: Director

66144 5 47364 - 66143 5 47370

COMMONWEALTH OF PENNSYLVANIA)
 : SS
COUNTY OF LEHIGH)

On this 19th day of JANUARY, 2016 before me, the undersigned officer,
personally appeared KEVIN LIVINGSTON who acknowledged himself to be the
DIRECTOR of Bethlehem Parking Authority a municipal parking authority,
and that he as such DIRECTOR, being authorized to do so, executed the
foregoing instrument for the purposes therein contained by signing the name of the corporation by
himself as BETHLEHEM PARKING AUTHORITY

IN WITNESS WHEREOF, I have hereunto set my hand and notarial seal.

Linda V. Fuisz
Notary Public

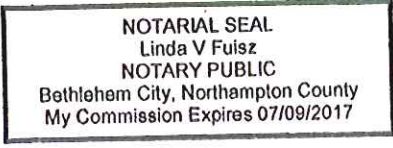

ACCEPTED AND CONDITIONS AGREED TO:

WITNESS: PPL Electric Utilities Corporation
By:

Handwritten Signature

Randal P Quinby
Randal P Quinby
Supervisor - Right of Way

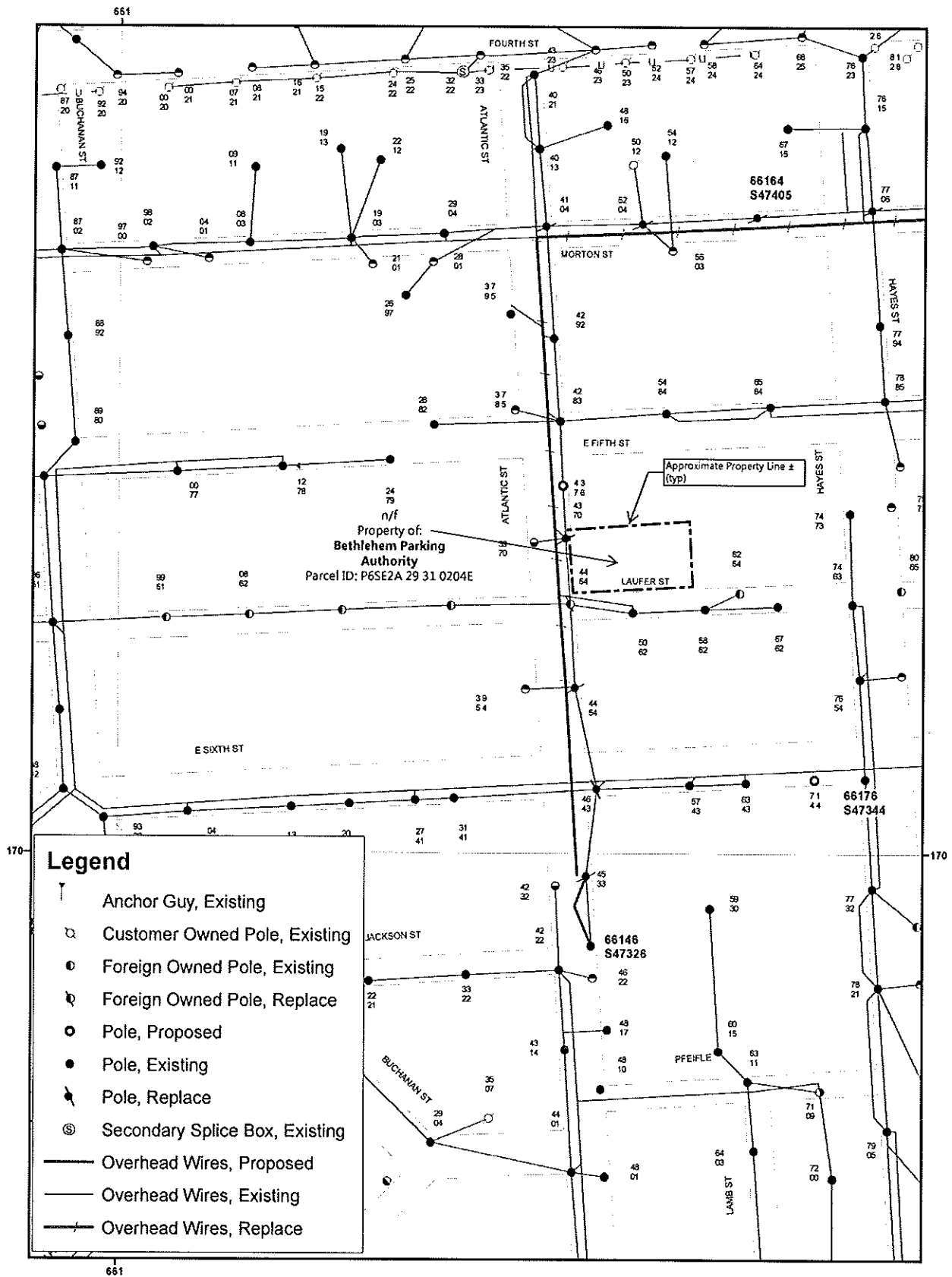

Legend

- Anchor Guy, Existing
- Customer Owned Pole, Existing
- Foreign Owned Pole, Existing
- Foreign Owned Pole, Replace
- Pole, Proposed
- Pole, Existing
- Pole, Replace
- Secondary Splice Box, Existing
- Overhead Wires, Proposed
- Overhead Wires, Existing
- Overhead Wires, Replace

****All Facilities in Highway Right of Way unless otherwise noted****

Note:
For exact location of right-of-way and/or facilities within right-of-way, contact the local PPL Electric Utilities Corporation office.

Not for Construction

WS-Design 44084362/49817	PLAN SHOWING FACILITIES ON PROPERTY OF:
BR 200689	Bethlehem Parking Authority
SCALE None	BETHLEHEM NORTHAMPTON COUNTY
DATE 10/19/2015	PPL Electric Utilities Corporation ALLENTOWN, PENNA.
ENGR [Signature]	APPROVAL DATE
	SIGNATURE
	DWG NO 44084362-00-ROW-SHT 03/03

