

Susan Englehardt  
PPL Electric Utilities  
600 Larch Street  
Scranton, PA 18509  
sbenglehardt@pplweb.com



March 1, 2017

Ms. Rosemary Chiavetta, Secretary  
Pennsylvania Public Utility Commission  
PO Box 3265  
Harrisburg, PA 17105

Dear Secretary Chiavetta:

Enclosed please find for filing under Section 507 of the Public Utility Code, Title 66, one (1) original and three (3) copies of the right-of-way agreement, adopted May 10, 2016 by The County of Pike and also accepted on May 10, 2016 by PPL Electric Utilities Corporation (PPL), wherein the County of Pike grants PPL the right to construct, operate, and maintain its electric line facilities in the County of Pike.

If you have any questions, please call Margy Alvarez, Right-of-Way Agent, at 570-253-7054.

Sincerely,

A handwritten signature in black ink that reads "Susan B. Englehardt". The signature is fluid and cursive, with a long horizontal flourish extending to the right.

Susan B. Englehardt

Enclosures

PA P.U.C.  
SECRETARY'S BUREAU

2017 MAR -3 AM 10:56

RECEIVED

Prepared by: PPL Electric Utilities  
Return to: PPL Electric Utilities  
ROW Department

4671ETCI (8/2014)

|              |   |   |   |   |   |   |   |
|--------------|---|---|---|---|---|---|---|
| W.O. Number: |   |   |   |   |   |   |   |
| 5            | 8 | 0 | 4 | 4 | 9 | 0 | 2 |



**RIGHT OF WAY GRANT FOR TREE WORK**  
**(Municipal Authority)**

KNOW ALL MEN BY THESE PRESENTS, That Pike County, a municipal authority of Pennsylvania hereinafter called "GRANTOR," intending to be legally bound, does hereby for itself, its successors and assigns, grant unto PPL Electric Utilities Corporation, hereinafter called "COMPANY" its successors and assigns, the right, privilege and authority to cut down any and all trees within fifteen (15) feet each side of centerline of the electric/communication line and the right to trim any and all trees within fifteen (15) feet each side of centerline of the electric line and to remove brush along said lines which in the judgment of the said Company menace the said lines; on property identified as County Tax Parcel No. 058.00-01-19 which the undersigned owns or has any interest located along Route 739 situate in the Township of Blooming Grove, County of Pike, Commonwealth of Pennsylvania.

A copy of this agreement and an acceptance hereof by PPL shall be filed by PPL with the Pennsylvania Public Utility Commission and this agreement shall thereafter become effective in accordance with the provisions of the Public Utility Law.

IN WITNESS WHEREOF GRANTOR has caused this agreement to be executed by its proper officer, this 10th day of May, 2016

**Pike County**  
By:

ATTEST:

[Signature]

[Signature]  
Matthew M. Osterberg, Chairman

[Signature]  
Rich Caridi, Vice-Chairman

[Signature]  
Guccini, Commissioner

PA P.U.C. SECRETARY'S BUREAU

MAR -3 AM 10:54

RECEIVED

COMMONWEALTH OF PENNSYLVANIA ) RECEIVED

COUNTY OF Pike ) : SS  
2017 MAR -3 AM 10:54

PA P.U.C.  
SECRETARY'S BUREAU

On this 10<sup>th</sup> day of May, 2016 before me, the undersigned officer, personally appeared Matthew M. Osterberg who acknowledged himself to be the Chairman of the Pike County Commissioners, a Municipal Authority and that he as such Chairman being authorized to do so, executed the foregoing instrument for the purposes therein contained by signing the name of the Authority by himself as Chairman.

IN WITNESS WHEREOF, I have hereunto set my hand and notarial seal.

NOTARIAL SEAL  
ANNA M. DUFFY, NOTARY PUBLIC  
MILFORD BOROUGH, PIKE COUNTY  
MY COMMISSION EXPIRES 1/26/2018

Anna M Duffy  
Notary Public

COMMONWEALTH OF PENNSYLVANIA )

COUNTY OF Pike ) : SS

On this 10<sup>th</sup> day of May, 2016 before me, the undersigned officer, personally appeared Rich Caridi who acknowledged himself to be the Vice Chairman of the Pike County Commissioners, a Municipal Authority and that he as such Vice Chairman being authorized to do so, executed the foregoing instrument for the purposes therein contained by signing the name of the Authority by himself as Vice Chairman.

IN WITNESS WHEREOF, I have hereunto set my hand and notarial seal.

NOTARIAL SEAL  
ANNA M. DUFFY, NOTARY PUBLIC  
MILFORD BOROUGH, PIKE COUNTY  
MY COMMISSION EXPIRES 1/26/2018

Anna M Duffy  
Notary Public

COMMONWEALTH OF PENNSYLVANIA )  
 : SS  
COUNTY OF Pike )

On this 10<sup>th</sup> day of May, 2016 before me, the undersigned officer, personally appeared Steve Guccini who acknowledged himself to be a Commissioner of the Pike County Commissioners, a Municipal Authority and that he as such Commissioners being authorized to do so, executed the foregoing instrument for the purposes therein contained by signing the name of the Authority by himself as Commissioners.

IN WITNESS WHEREOF, I have hereunto set my hand and notarial seal.

NOTARIAL SEAL  
ANNA M. DUFFY, NOTARY PUBLIC  
MILFORD BOROUGH, PIKE COUNTY  
MY COMMISSION EXPIRES 1/26/2018

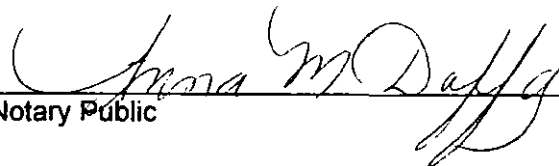
  
Notary Public

ACCEPTED AND CONDITIONS AGREED TO:

PPL Electric Utilities Corporation

Witness:

By: Randal P Quinby  
Supervisor - Right of Way

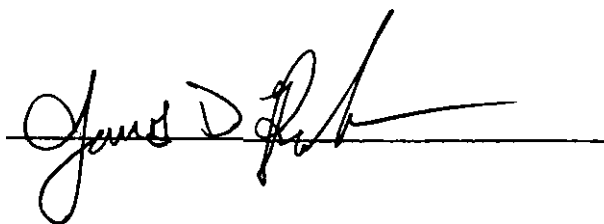

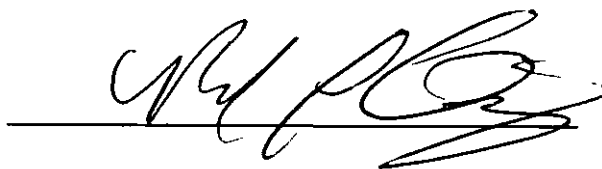

SECRETARY'S BUREAU  
PA P.U.C.

2017 MAR -3 AM 10:54

RECEIVED

RECEIVED

MAR 3 - 2017

PA PUBLIC UTILITY COMMISSION  
SECRETARY'S BUREAU

Exhibit A

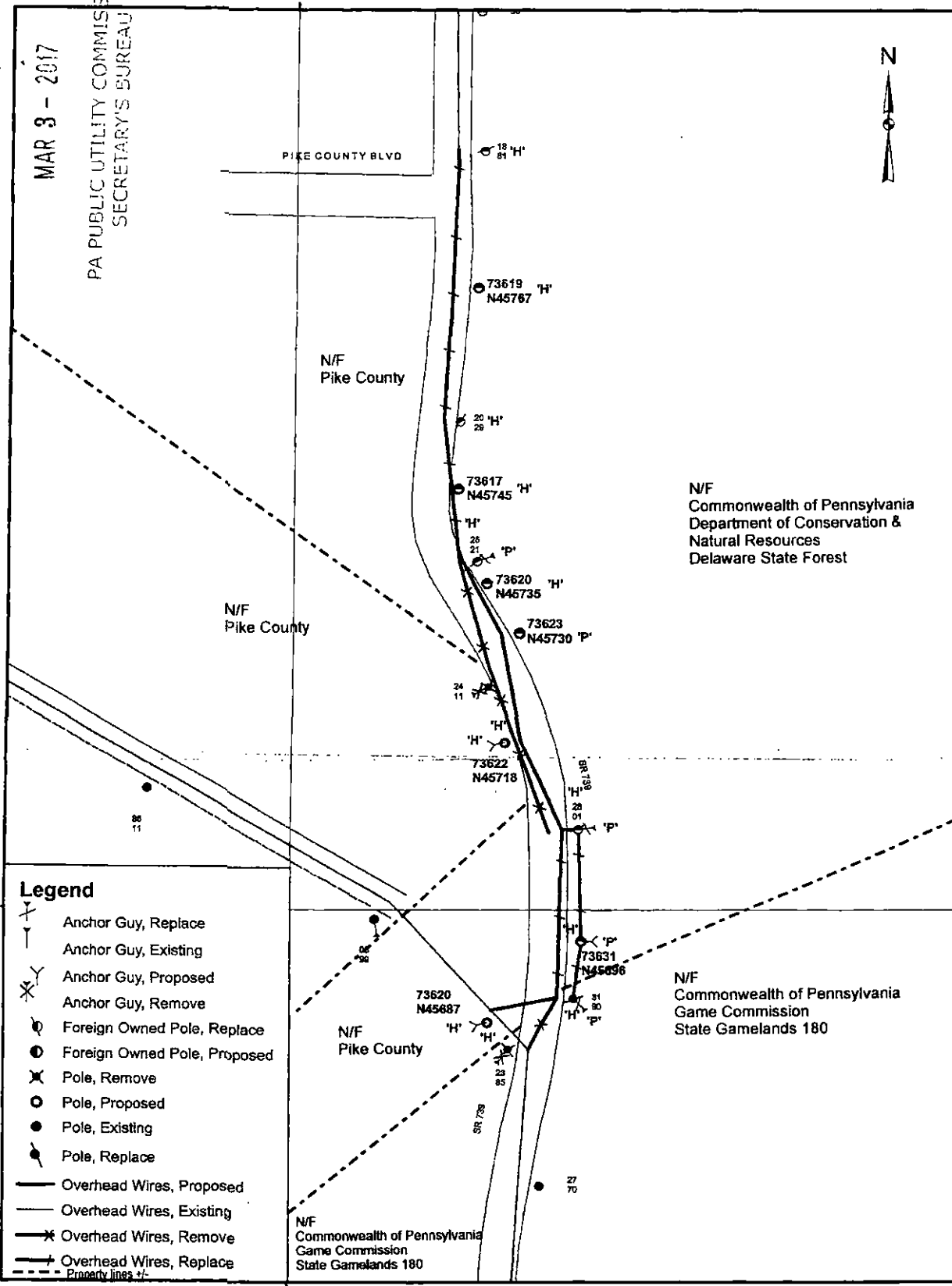

Legend

- Anchor Guy, Replace
- Anchor Guy, Existing
- Anchor Guy, Proposed
- Anchor Guy, Remove
- Foreign Owned Pole, Replace
- Foreign Owned Pole, Proposed
- Pole, Remove
- Pole, Proposed
- Pole, Existing
- Pole, Replace
- Overhead Wires, Proposed
- Overhead Wires, Existing
- Overhead Wires, Remove
- Overhead Wires, Replace
- Property lines

NOTES

'P' - PRIVATE RIGHT OF WAY  
'H' - HIGHWAY RIGHT OF WAY

Note:

For exact location of right-of-way and/or facilities within right-of-way, contact the local PPL Electric Utilities Corporation office.

Not for Construction

|                          |   |                          |
|--------------------------|---|--------------------------|
| WDDesign: 58044902/60030 | PLAN SHOWING FACILITIES ON PROPERTY OF:                 |                          |
| ER: 252127               | <b>Pike County</b>                                      |                          |
| SR:                      | BLOOMING GROVE TWP                                      | PIKE COUNTY              |
| SCALE: None              | PPL Electric Utilities Corporation<br>ALLENTOWN, PENNA. |                          |
| DATE: 3/21/2016          | APPROVAL:   | DATE:                    |
| ENGR: RYAN HAAS          | SIGNATURE: <i>B. O'Han</i> 3/21/16                      | DWG. NO.: 58044902-RW-00 |

FIRST CLASS  
FIRST CLASS  
FIRST CLASS  
FIRST CLASS  
FIRST CLASS  
FIRST CLASS

Susan B. Englehardt  
600 Larch Street  
Scranton, PA 18509

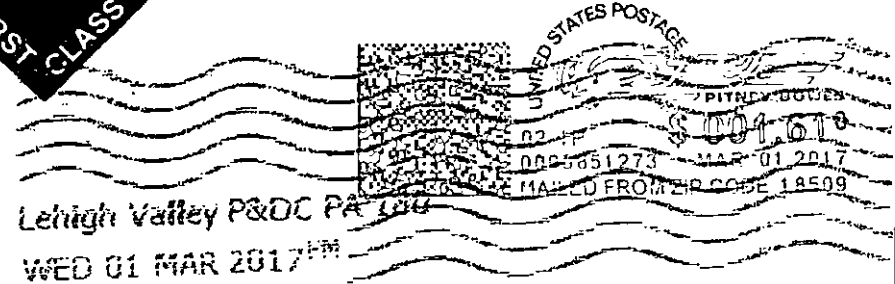

Lehigh Valley P&DC PA 180

WED 01 MAR 2017 PM

**FIRST CLASS MAIL**

Ms. Rosemary Chiavetta, Secretary  
Pennsylvania Public Utility Commission  
P.O. Box 3265  
Harrisburg, PA 17105

FIRST CLASS  
FIRST CLASS