



August 16, 2017

Ms. Rosemary Chiavetta, Secretary
Pennsylvania Public Utility Commission
P.O. Box 3265
Harrisburg, PA 17105-3265

Re: Application of the Department of Transportation of the Commonwealth of Pennsylvania for approval to replace the existing bridge where State Route 0095 crosses above the three tracks of Consolidated Rail Corporation, DOT No. 858 110 H in the City of Philadelphia, Philadelphia County and the allocation of costs incident thereto.

Dear Secretary Chiavetta:

Enclosed for filing, please find the Application of the Department of Transportation.

Copies of this Application and Exhibits have been served upon the parties in the Certificate of Service to the Application.

Sincerely,

A handwritten signature in blue ink that reads "Mary Ann Lang".

Mary Ann Lang, District Utility Manager
Engineering District 6-0
Department of Transportation

Enclosures

cc: Parties of Record

M. J. Chappell, P.E., Right-of-Way and Utilities Section, 7th Floor, CKB

Gina M. D'Alfonso, Office of Chief Counsel, 9th Floor, CKB

Ron Hull, P.E., Rail Safety Engineering Section PUC, 3rd Floor, CKB

**BEFORE THE
PENNSYLVANIA PUBLIC UTILITY COMMISSION**

Application of the Department of Transportation of the Commonwealth of Pennsylvania for approval to replace the existing bridge where State Route 0095 crosses above the three tracks of Consolidated Rail Corporation, DOT No. 858 110 H in the City of Philadelphia, Philadelphia County and the allocation of costs incident thereto.

Application
Docket No. _____

Electronically Filed

To the Pennsylvania Public Utility Commission:

1. The name and address of Applicant are Commonwealth of Pennsylvania, Department of Transportation by Louis Belmonte, P.E., Assistant District Executive, Engineering District 6-0, 7000 Geerdes Boulevard, King of Prussia, PA 19406
2. The name and address of attorney for the Applicant are Jason D. Sharp, Acting Chief Counsel, Commonwealth of Pennsylvania, Department of Transportation, Office of Chief Counsel, PO Box 8212, Harrisburg, PA 17105-8212.
3. The Applicant is an agency of Commonwealth of Pennsylvania, organized and existing under the Administrative Code of 1929, 71 P.S. § 511, et seq. and generally 36 P.S. § 670 - 401 et seq.
4. The names and addresses of the persons, parties and entities concerned in, or affected by the proposed construction, to the best of the Applicant's knowledge, are shown in the certificate of service. In addition to those served, the Applicant requests that the following also receive service of all documents in this matter:

| | |
|---|---|
| Mark J. Chappel, P.E., Chief Utilities and Right of Way Section Pennsylvania Department of Transportation P.O. Box 3362 Harrisburg, PA 17105-3362 | Gina M. D'Alfonso, Senior Counsel-in-Charge Office of Chief Counsel Pennsylvania Department of Transportation P.O. Box 3265 Harrisburg, PA 17105-3265 |
|---|---|
5. It is desirable to replace the existing bridge carrying State Route 0095, Segment 0150 Offset 2215 and Segment 0150, Offset 1858, over the three tracks of Consolidated Rail Corporation. A Location Map is attached hereto and marked as Exhibit "A". Additionally, a copy of the preliminary Construction Plan has been attached hereto and marked as Exhibit "B".
6. The Average Daily Traffic (ADT) for State Route 0095 is 94,975 vehicles with 10% trucks.
7. The estimated total cost for the replacement superstructure is \$300,000,000. The funding for the project will be 90% Federal Funds and 10% State Funds.
8. This project is necessary and proper for the safety and convenience of the public.

9. A conference of all parties of interest should be held to discuss the proposed alteration.

Wherefore, Applicant respectfully requests that the Public Utility Commission approve this application:

Respectfully Submitted:

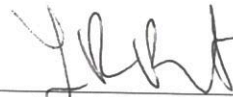

Louis Belmonte, P.E.
Assistant District Executive
Engineering District 6-0
Department of Transportation
7000 Geerdes Boulevard
King of Prussia, PA 19406
Phone (610) 205-6550
Fax (610) 205-6915

Dated: _____

8/16/17

**BEFORE THE
PENNSYLVANIA PUBLIC UTILITY COMMISSION**

Application of the Department of Transportation of the Commonwealth of Pennsylvania for approval to replace the existing bridge where State Route 0095 crosses above the three tracks of Consolidated Rail Corporation, DOT No. 858 110 H in the City of Philadelphia, Philadelphia County and the allocation of costs incident thereto.

Application

Docket No. _____

Electronically Filed

VERIFICATION

I, Mary Ann Lang, District Utility Manager, hereby state that the facts above set forth are true and correct to the best of my knowledge, information and belief and that I expect to be able to prove the same at a hearing held in this matter. I understand that the statements herein are made subject to the penalties of 18 Pa.C.S. §4904 (relating to unsworn falsification to authorities).

Date: 8/16/17

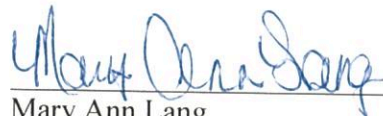

Mary Ann Lang
District Utility Manager

**BEFORE THE
PENNSYLVANIA PUBLIC UTILITY COMMISSION**

Application of the Department of Transportation of the Commonwealth of Pennsylvania for approval to replace the existing bridge where State Route 0095 crosses above the three tracks of Consolidated Rail Corporation, DOT No. 858 110 H in the City of Philadelphia, Philadelphia County and the allocation of costs incident thereto.

Application

Docket No. _____

Electronically Filed

CERTIFICATE OF SERVICE

I hereby certify that I have this day served a true copy of the foregoing document upon the participants listed below, in accordance with the requirements of 52 Pa. Code § 1.54, by first class mail, postage prepaid:

Ryan Hill, Director Design and Construction
Consolidated Rail Corporation
1000 Howard Boulevard – 4th floor
Mount Laurel, NJ 08054

Kevin Hauschildt, Chief Engineer
Norfolk Southern Railway Corporation
Bridges & Structures Department
1200 Peachtree Street, NE
Department Box 142
Atlanta, GA 30309

Jason M. Morris, Assistant General Counsel
Norfolk Southern Railway Corporation
Three Commercial Place
Norfolk, VA 23510

Anthony Clark, Chairman
Philadelphia City Commissioners
City Hall, Room 130
Philadelphia, PA 19107

Sozi Pedro Tulante, City Solicitor
City of Philadelphia Law Department
1515 Arch Street – 17th floor
Philadelphia, PA 19102

Monica Lyv, Senior Staff Engineer
Philadelphia Gas Works
800 West Montgomery Avenue
Planning Section – 2nd floor
Philadelphia PA 19122-2898

Patrick O'Donnell, Right-of-Way Manager
City of Philadelphia Department of Streets
1401 JFK Boulevard – Room 940 MSB
Philadelphia, PA 19102-1676

Vahe Hovsepian, Design Manager
City of Philadelphia Water Department
1101 Market Street – 5th floor
Philadelphia, PA 19107-2994

Laura Lippincott, Section Manager
Verizon Pennsylvania, LLC
1050 Virginia Drive – Floor 4
Fort Washington, PA 19034

Chris Ricciuti, Engineer
Zayo Bandwidth
170 Robbins Road
Downingtown, PA 19335

Andrew McGinnis
Sunesys, LLC
11 Grandview Circle
Canonsburg, PA 15317

Bill Hensil, Program Manager
PECO Energy Company
1050 West Swedesford Road
Berwyn, PA 19312

Carlo Verdi, Project Engineer
Teleport Communications America, LLC
175 West Main Street
Freehold, NJ 07728

Dated this 16th Day of August 2017

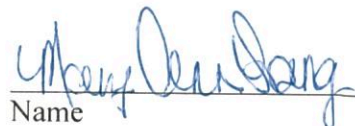
Name

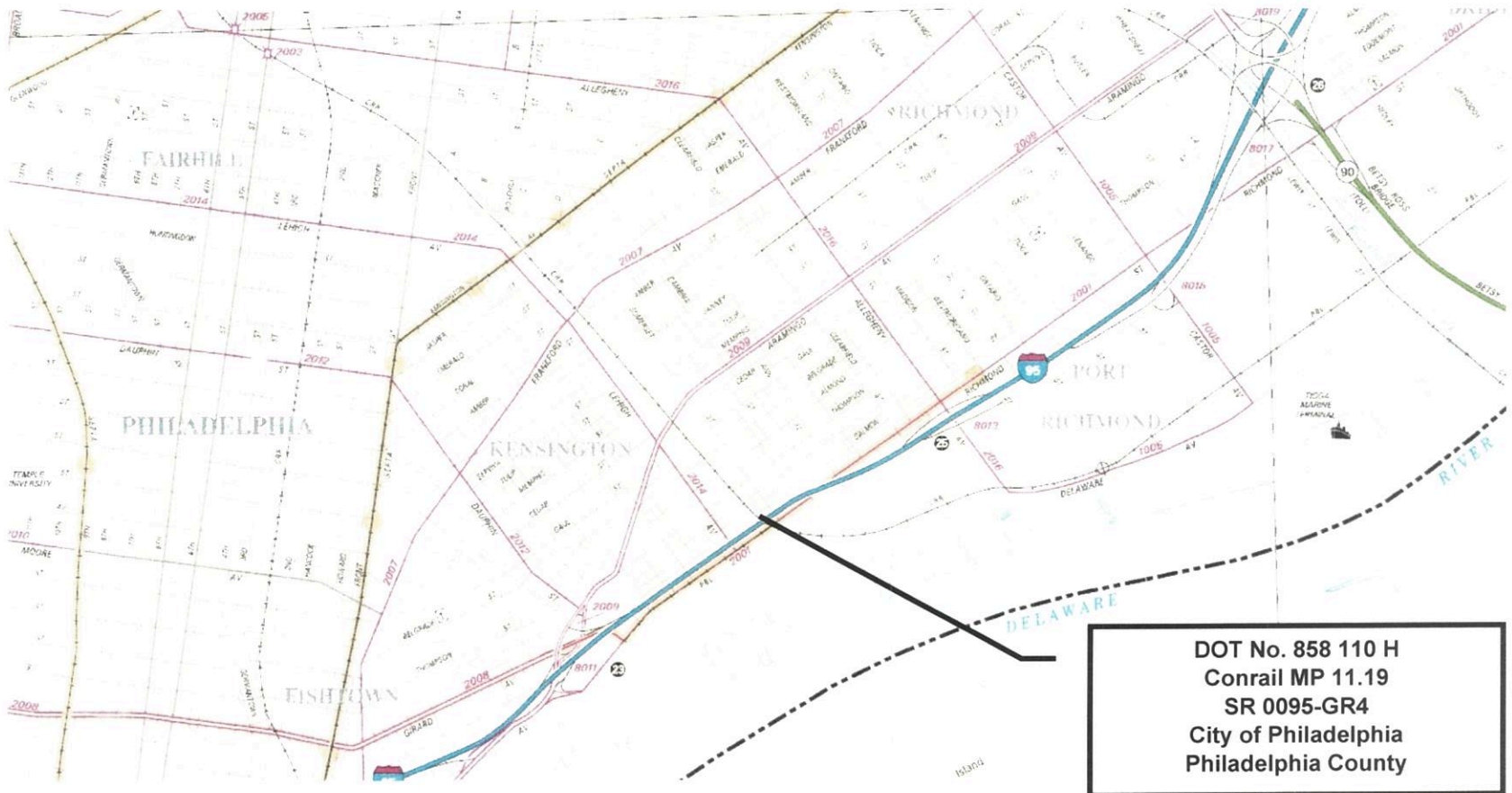

EXHIBIT "A"
LOCATION MAP

COMMONWEALTH OF PENNSYLVANIA



DEPARTMENT OF TRANSPORTATION

DRAWINGS

FOR

CONSTRUCTION

OF

STATE ROUTE 0095 SECTION GR4

IN PHILADELPHIA COUNTY

ESTABLISHED AS A LIMITED ACCESS HIGHWAY FROM STATION 288+69.06 TO STATION 303+95.80 BY CONDEMNATION PLAN OF LEGISLATIVE ROUTE 1000 SECTION B-6 R/W APPROVED ON MAY 24, 1966

ESTABLISHED AS A LIMITED ACCESS HIGHWAY FROM STATION 303+20.14 TO STATION 308+80.77 BY RIGHT OF WAY PLAN FOR LR 1000 SECTION B-7 R/W APPROVED ON MAY 24, 1966

ESTABLISHED AS A LIMITED ACCESS HIGHWAY FROM STATION 348+16.71 TO STATION 350+10.76 BY RIGHT OF WAY PLAN FOR SR 0095 SECTION GR1 R/W APPROVED ON FEBRUARY 11, 2008

ESTABLISHED AS A LIMITED ACCESS HIGHWAY FROM STATION 308+80.77 TO STATION 412+55.98 BY RIGHT OF WAY PLAN FOR SR 0095 SECTION GR1 R/W APPROVED ON APRIL 3, 2009 AND REVISED AND RE-APPROVED ON NOVEMBER 1, 2012

ESTABLISHED AS A LIMITED ACCESS HIGHWAY FROM STATION 412+55.98 TO STATION 419+00 BY CONDEMNATION PLAN OF LEGISLATIVE ROUTE 1000 SECTION C-3 R/W APPROVED ON OCTOBER 30, 1962

ESTABLISHED AS A LIMITED ACCESS HIGHWAY FROM STATION 308+80.77 TO STA 412+55.98 BY RIGHT OF WAY PLAN FOR SR 0095 SECTION GR1 R/W APPROVED ON NOVEMBER 1, 2010.

FROM STA 300+44.00 SB TO STA 485+38.34 SB LENGTH 18294.34 FT 3.465 MI

FROM SEG 0225 OFFSET 1389 TO SEG 0261 OFFSET 0825

ALSO

STATE ROUTE 2001

FROM STA 74+36.91 TO STA 85+90.45

ALSO

STATE ROUTE 2009

FROM STA 10+55.35 TO STA 27+81.05 NB

FROM STA 10+49.39 TO STA 28+53.13 SB

FROM STA 27+81.05 TO STA 33+64.69

ALSO

STATE ROUTE 8011

LIMIT OF ITS

STATE ROUTE 0413

FROM SEG 0180 OFFSET 0000 SEG 0180 OFFSET 2649

FROM SEG 0181 OFFSET 0000 TO SEG 0181 OFFSET 2610 BUCKS COUNTY

ALSO

STATE ROUTE 2037

FROM SEG 0130 OFFSET 0919 SEG 0130 OFFSET 1319

FROM SEG 0131 OFFSET 0919 TO SEG 0131 OFFSET 1319 BUCKS COUNTY

ALSO

STATE ROUTE 0332

FROM SEG 0270 OFFSET 0000

FROM SEG 0271 OFFSET 0000 TO SEG 0290 OFFSET 0415 BUCKS COUNTY

| DISTRICT | COUNTY | TOWNSHIP | CITY | ROUTE | SECTION | TOTAL SHEETS |
|----------|--------------|-----------------|--------------|-------|---------|--------------|
| 6-0 | PHILADELPHIA | - | PHILADELPHIA | 0095 | GR4 | 253 |
| | BUCKS | MIDDLETOWN | - | 0413 | GR4 | |
| | BUCKS | MIDDLETOWN | - | 2037 | GR4 | |
| | BUCKS | LOWER MAKEFIELD | - | 0332 | GR4 | |

SR 0095, PREVIOUSLY KNOWN AS LR 1000
 SR 2009, PREVIOUSLY KNOWN AS LR 67047
 SR 8011, PREVIOUSLY KNOWN AS LR 1000
 SR 2001, PREVIOUSLY KNOWN AS LR 67348

MPMS/ECMS NO: 79827

| ALSO INCLUDED: | SHEETS |
|---|------------|
| TRAFFIC CONTROL PLAN | 301 SHEETS |
| SIGNING AND SIGN LIGHTING PLAN | 90 SHEETS |
| PAVEMENT MARKING PLAN | 123 SHEETS |
| LANDSCAPING PLAN | 94 SHEETS |
| EROSION AND SEDIMENT POLLUTION CONTROL PLAN | 160 SHEETS |
| PHILADELPHIA WATER DEPARTMENT SEWER RECONSTRUCTION PLAN | 35 SHEETS |
| S-40952-RD | |
| PHILADELPHIA GAS WORKS UTILITY RELOCATION PLAN | 3 SHEETS |
| B-4146 | |
| PHILADELPHIA WATER DEPARTMENT UTILITY RELOCATION PLAN-WATER | 12 SHEETS |
| S-40952-RD | |
| PHILADELPHIA WATER DEPARTMENT UTILITY RELOCATION PLAN-SEWER | 10 SHEETS |
| S-40952-RD | |
| HIGHWAY LIGHTING PLAN | 73 SHEETS |
| TRAFFIC SIGNAL PLAN | 19 SHEETS |
| ITS PLAN | 68 SHEETS |
| SOIL PROFILE PLAN | 47 SHEETS |

| STRUCTURE PLANS | SHEETS |
|-----------------|------------|
| S-26898 | 60 SHEETS |
| S-26906 | 30 SHEETS |
| S-26907 | 68 SHEETS |
| S-27048 | 95 SHEETS |
| S-27050 | 80 SHEETS |
| S-27051 | 35 SHEETS |
| S-27131 | 142 SHEETS |
| S-32135 | 266 SHEETS |
| S-32476 | 108 SHEETS |
| S-34769 | 68 SHEETS |
| S-35232 | 61 SHEETS |

| RETAINING WALL PLANS | SHEETS |
|----------------------|----------|
| S-XXXXX (WALL 16) | 9 SHEETS |
| S-XXXXX (WALL 17) | 1 SHEETS |
| S-XXXXX (WALL 18) | 1 SHEETS |

| SOUND BARRIER WALL PLANS | SHEETS |
|--------------------------------|--------|
| S-XXXXX (SOUND BARRIER WALL 3) | SHEETS |
| S-XXXXX (SOUND BARRIER WALL 4) | SHEETS |

| SIGN STRUCTURE PLANS | SHEETS |
|----------------------|--------|
| S-37230 (SS5) | SHEETS |
| S-37231 (SS9) | SHEETS |
| S-37232 (SS12) | SHEETS |
| S-37233 (SS10) | SHEETS |
| S-37234 (SS11) | SHEETS |
| S-37235 (SS14) | SHEETS |
| S-37236 (SS13) | SHEETS |
| S-37237 (SS15) | SHEETS |
| S-37238 (SS16) | SHEETS |
| S-37239 (SS18) | SHEETS |
| S-37240 (SS17) | SHEETS |

| ITS SUPPORT STRUCTURE PLANS | SHEETS |
|-----------------------------|--------|
| S-XXXXX (DMS 4R1) | SHEETS |
| S-XXXXX (DMS 4N3) | SHEETS |

| CROSS SECTIONS | SHEETS |
|--------------------------|------------|
| EXISTING STRUCTURE PLANS | |
| S-5014A | 15 SHEETS |
| S-5016 | 54 SHEETS |
| S-5017 | 52 SHEETS |
| S-6496 | 158 SHEETS |
| S-6499 | 14 SHEETS |
| S-6501 | 16 SHEETS |
| S-6502 | 30 SHEETS |

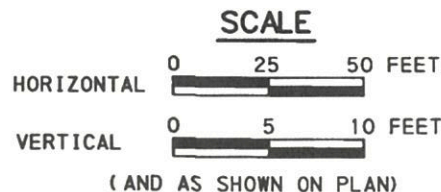

DESIGN DESIGNATION

SR 0095

TRAFFIC DATA

| | | | |
|------------------------|----------------------|-----------------|-----------------|
| HIGHWAY CLASSIFICATION | — INTERSTATE HIGHWAY | CURRENT ADT | — 87,000 (2017) |
| DESIGN SPEED | — 60 MPH | DESIGN YEAR ADT | — 99,000 (2040) |
| PAVEMENT WIDTH | — 60' | DHV | — 7,430 |
| SHOULDER WIDTH | — 12' | D | — 55% |
| MEDIAN WIDTH | — 26' AND VARIES | T | — 10% |

EXHIBIT "B"

1 of 10

PUC APPLICATION DOCKET NUMBER _____

PREPARED BY:
AECOM
 625 WEST RIDGE PIKE
 CONSHOHOCKEN, PA.

RECOMMENDED DATE: _____

DISTRICT EXECUTIVE

RECOMMENDED DATE: _____

DEPUTY SECRETARY

APPROVED DATE: _____

SECRETARY OF TRANSPORTATION
 (ON BEHALF OF THE GOVERNOR
 AS WELL AS HERSELF)

DATE

| | | | | |
|----------------------|--------------|-------|---------|----------|
| DISTRICT | COUNTY | ROUTE | SECTION | SHEET |
| 6-0 | PHILADELPHIA | 0095 | GR4 | 5 OF 253 |
| CITY OF PHILADELPHIA | | | | |
| REVISION NUMBER | REVISIONS | | | DATE BY |
| | | | | |

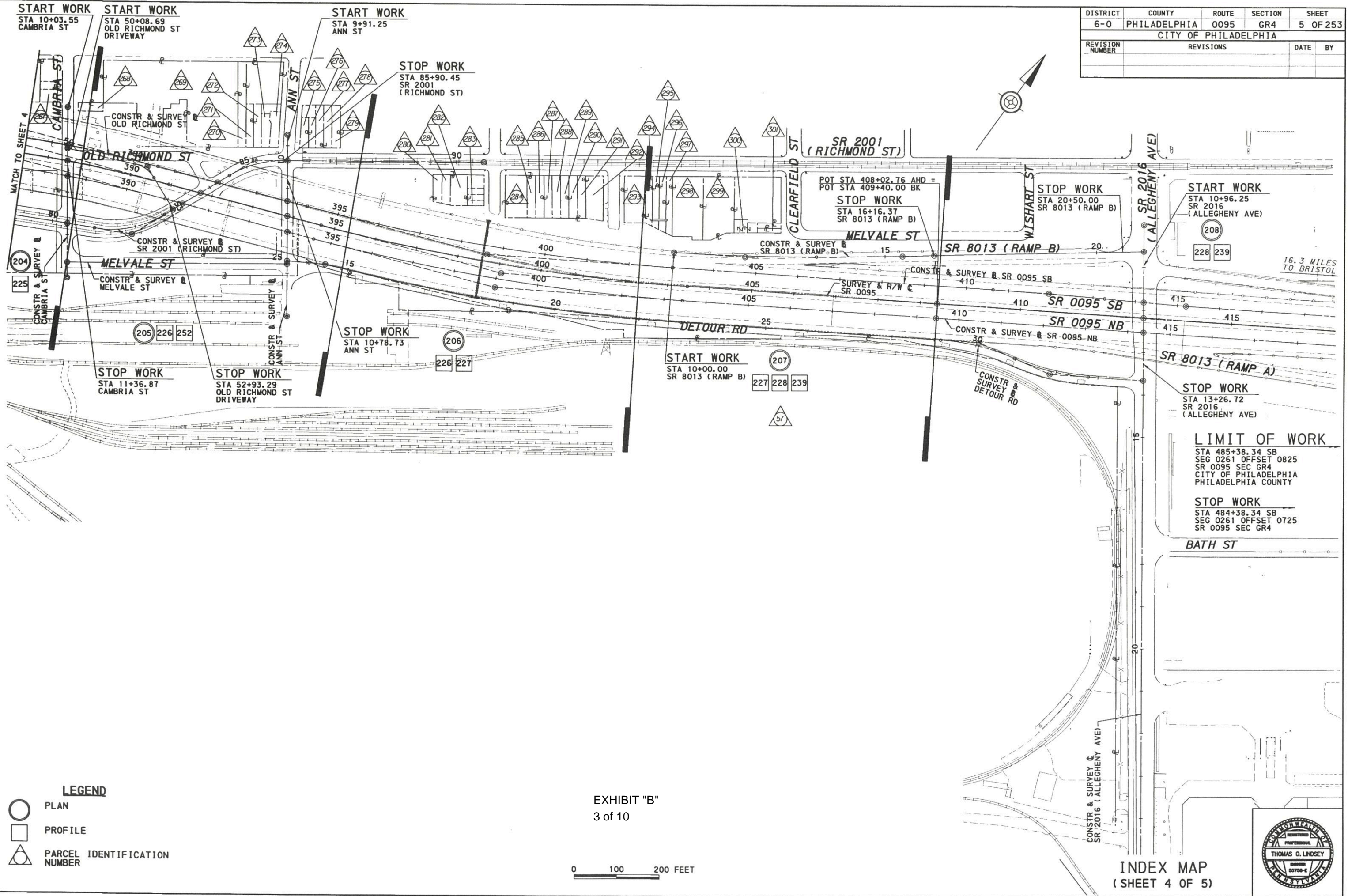

16.3 MILES TO BRISTOL

LEGEND



-  PLAN
-  PROFILE
-  PARCEL IDENTIFICATION NUMBER

EXHIBIT "B"
3 of 10



INDEX MAP
(SHEET 4 OF 5)

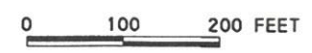

C:\p\huckey\Projects\Transportation\0400655_01\CADD\11\1150003\SR2001\04\04.dwg
 11/20/11 10:41:21 AM 11/20/11 10:41:21 AM

| | | | | |
|----------------------|--------------|-------|---------|----------|
| DISTRICT | COUNTY | ROUTE | SECTION | SHEET |
| 6-0 | PHILADELPHIA | 0095 | GR4 | 7 OF 253 |
| CITY OF PHILADELPHIA | | | | |
| REVISION NUMBER | REVISIONS | DATE | BY | |

| LIST OF PUBLIC UTILITIES | | | | |
|--------------------------|---|---|---|--------------|
| SYMBOL | OWNER | ADDRESS | REPRESENTATIVE | TELEPHONE |
| W | CITY OF PHILADELPHIA WATER DEPARTMENT | ARAMARK TOWER 1101 MARKET STREET, 5TH FLOOR PHILADELPHIA, PA 19107-2994 | MR. MICHAEL LAVERY CHIEF, DESIGN BRANCH | 215-685-6280 |
| S | CITY OF PHILADELPHIA WATER DEPARTMENT | ARAMARK TOWER 1101 MARKET STREET, 5TH FLOOR PHILADELPHIA, PA 19107-2994 | MR. MICHAEL LAVERY CHIEF, DESIGN BRANCH | 215-685-6280 |
| T1 | VERIZON PENNSYLVANIA LCC | 15 MONTGOMERY PLACE, FLOOR 2 PITTSBURGH, PA 15212 | MS. DEBORAH BARUM SECTION MANAGER | 412-237-2285 |
| T2 | PECO ENERGY COMPANY (KEYSTONE TELEPHONE) | 1050 W. SWEDSFORD ROAD BERWYN, PA 19312 | MR. BILL HENSIL PROGRAM MANAGER | 610-725-7129 |
| E | PECO ENERGY COMPANY | 1050 W. SWEDSFORD ROAD BERWYN, PA 19312 | MR. BILL HENSIL PROGRAM MANAGER | 610-725-7129 |
| G | PHILADELPHIA GAS WORKS | 800 W. MONTGOMERY AVENUE PHILADELPHIA, PA 19122-2898 | MR. RYAN BREAM | 215-684-6719 |
| EB | CITY OF PHILADELPHIA DEPARTMENT OF PUBLIC PROPERTY | ROOM 790, CITY HALL PHILADELPHIA, PA 19107 | MR. LEONARD GIPSON DEPUTY COMMISSIONER | 215-686-4524 |
| CTV | COMCAST CABLE COMMUNICATIONS | 4400 WAYNE AVENUE PHILADELPHIA, PA 19140 | MR. BOB HARVEY CONSTRUCTION MANAGER | 215-588-1966 |
| SEPTA | SOUTHEASTERN PENNSYLVANIA TRANSIT AUTHORITY (SEPTA) | 1234 MARKET STREET, 12TH FLOOR PHILADELPHIA, PA 19107-3780 | MR. ROBERT L. LUND JR. ASSISTANT GENERAL MANAGER | 215-580-8215 |

PA ONE CALL SERIAL NO:
 20120520651, 20120520652, 20120520653, 20120520654, 20120520655, 20122750904, 20122750976, 20122750977, 20122752313,
 20122752478, 20122791072, 20122791598, 20122830777, 20122831135, 20122831387, 20122831388, 20122831436, 20122831437,
 20122831968, 20122832311, 20132540939, 20132540940, 20133080938, 20140570381, 20140581464, 20162591821, 20162591894,
 20162592424, 20162592497, 20162592498

EARTHWORK SUMMARY ENTIRE PROJECT

THE INFORMATION ON ESTIMATED AMOUNTS OF EARTHWORK HAS BEEN USED IN THE PRELIMINARY ESTIMATE. DO NOT USE AS A WAIVER OF ANY PROVISIONS OF THE SPECIFICATIONS AND CONTRACTS.

| CUBIC YARDS OF EXCAVATION | | | | | | CUBIC YARDS OF COMPLETED EMBANKMENT* | CUBIC YARDS OF BORROW EXCAVATION | CUBIC YARDS OF SELECT BORROW*** | CUBIC YARDS OF WASTE |
|---------------------------|----------|----------|---------|-----------|---------|--------------------------------------|----------------------------------|---------------------------------|----------------------|
| CLASS 1 | CLASS 1A | CLASS 1B | CLASS 2 | CLASS 3** | CLASS 4 | | | | |
| --- | --- | --- | --- | --- | --- | --- | --- | --- | --- |

- * INCLUDES ALL BORROW ITEMS
- ** INCLUDES XXXXX CUBIC YARDS INCIDENTAL TO PRE-FABRICATED MODULAR RETAINING WALLS
- *** ITEM 1001-0730 SELECTED BORROW EXCAVATION STRUCTURE BACKFILL
 ITEM 0703-0020 NO. 1 COARSE AGGREGATE
 ITEM 0703-0024 NO. 2A COARSE AGGREGATE
 ITEM 0703-0025 NO. 57 COARSE AGGREGATE
 ITEM 0703-0026 NO. 3 COARSE AGGREGATE
 ITEM 9703-XXXX COARSE AGGREGATE, SPECIAL FOR STRUCTURES

LIST OF EQUALITIES

SR 0095 SB 304+89.27 BK = SR 0095 SB 304+82.80 AHD
 SR 0095 C 409+40.00 BK = SR 0095 C 408+02.76 AHD

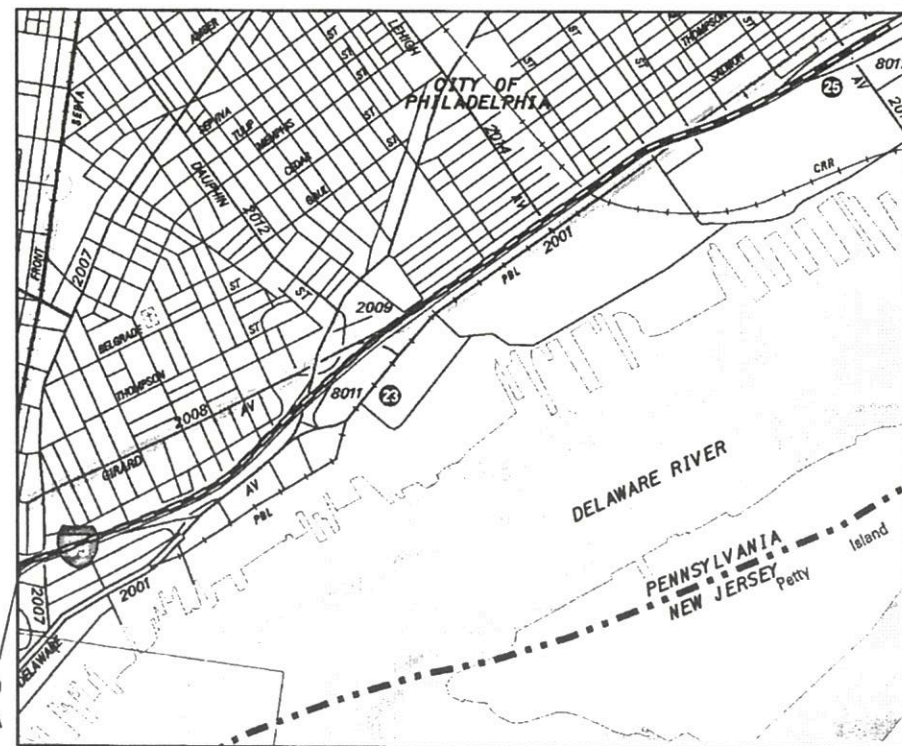

LIMIT OF WORK
 STA 300+44.00 SB
 SEG 0225 OFFSET 1389
 SR 0095 SEC GR4
 CITY OF PHILADELPHIA
 PHILADELPHIA COUNTY



LEGEND

- PROPOSED HEADWALL
- PROPOSED PIPE
- PROPOSED WEIR
- === UNDERDRAIN
- STORMWATER MANAGEMENT PRACTICE (SMP) DEVICE EXTENTS
- EXISTING DRAINAGE
- REMOVE EXISTING DRAINAGE
- PERMANENT PIPE CAP
- RIGHT-OF-WAY FENCE
- PROPOSED INLET (PADOT)
- PERMANENT INLET CAP
- GABION WALL
- GEOMETRY CURVE NUMBER DESIGNATION
- BULKHEAD
- MANHOLE
- PROPOSED CONDUIT
- LIMIT OF STRUCTURE FOOTING
- IMPACT ATTENUATOR
- PROPOSED UTILITY FROM GR1 (CONSTRUCTED BY OTHERS)
- OPEN MOUTH GRATE INLET
- HIGHWAY GRATE INLET
- TYPE M INLET
- CONCRETE CURB CUT
- CATENARY POLE
- GEOMETRY CURVE NUMBER DESIGNATION
- LIMITS OF PAVEMENT REMOVAL
- ABANDON EXISTING DRAINAGE
- ABANDONED UTILITY
- ABANDON EXISTING UTILITY
- MILL AND OVERLAY
- PEDESTRIAN LIGHT FIXTURE

RECORD OF EXISTING ROAD TYPES

| | |
|--|---|
| SR 0095 SOUTHBOUND: SEGMENT 0241 OFFSET 0000 TO SEGMENT 0241 OFFSET 0906 | 1/4" LATEX CONCRETE (1984) |
| SEGMENT 0241 OFFSET 0906 TO SEGMENT 0241 OFFSET 1835 | 1 1/2" HEAVY DUTY BITUMINOUS WEARING COURSE (1997) 10" REINFORCED CEMENT CONCRETE (1968) 6" UNKNOWN SUBBASE (1968) DRAINAGE BASE WITH EDGE DRAINS (1968, UNKNOWN DEPTH) |
| SEGMENT 0245 OFFSET 0000 TO SEGMENT 0245 OFFSET 0277 | 1 1/2" HEAVY DUTY BITUMINOUS WEARING COURSE (1997) 10" REINFORCED CEMENT CONCRETE (1968) 6" UNKNOWN SUBBASE (1968) DRAINAGE BASE WITH EDGE DRAINS (1968, UNKNOWN DEPTH) |
| SEGMENT 0245 OFFSET 0277 TO SEGMENT 0245 OFFSET 0285 | 1 1/2" HMA WEARING COURSE, 64-22, 9.5 MM, E (2009) 10" REINFORCED CEMENT CONCRETE (1968) 6" UNKNOWN SUBBASE (1968) DRAINAGE BASE WITH EDGE DRAINS (1968, UNKNOWN DEPTH) |
| SEGMENT 0245 OFFSET 0285 TO SEGMENT 0245 OFFSET 1035 | 1 1/2" HMA WEARING COURSE, 64-22, 9.5 MM, E (2009) 10" REINFORCED CEMENT CONCRETE (1968) 6" UNKNOWN SUBBASE (1968) DRAINAGE BASE WITH EDGE DRAINS (1968, UNKNOWN DEPTH) |
| SR 8011 SPUR A: SEGMENT 0260 OFFSET 0000 TO SEGMENT 0260 OFFSET 0335 | 1 1/2" BITUMINOUS WEARING COURSE (1997) 8" UNKNOWN PCCP (1971) |
| SR 8011 RAMP B: SEGMENT 0500 OFFSET 0000 TO SEGMENT 0500 OFFSET 0360 | 8" UNKNOWN PCCP (1971) |
| SEGMENT 0500 OFFSET 0360 TO SEGMENT 0500 OFFSET 1275 | 1/4" LATEX CONCRETE (1984) |
| SEGMENT 0500 OFFSET 1275 TO SEGMENT 0500 OFFSET 1400 | 1/2" CONCRETE (2010) |
| SEGMENT 0500 OFFSET 1400 TO SEGMENT 0500 OFFSET 1427 | 8" UNKNOWN PCCP (1971) |
| SEGMENT 0510 OFFSET 0000 TO SEGMENT 0510 OFFSET 0926 | 3" UNKNOWN BITUMINOUS WEARING COURSE (1971) 10" PLAIN CEMENT CONCRETE BASE COURSE (1971) |
| SR 8011 RAMP D: SEGMENT 0250 OFFSET 0000 TO SEGMENT 0250 OFFSET 0214 | 1 1/2" BITUMINOUS WEARING COURSE (1997) 8" UNKNOWN PCCP (1971) |
| SEGMENT 0250 OFFSET 0214 TO SEGMENT 0250 OFFSET 0385 | 1" LATEX CONCRETE |
| SEGMENT 0260 OFFSET 0000 TO SEGMENT 0260 OFFSET 0100 | 1 1/2" BITUMINOUS WEARING COURSE (1997) 8" UNKNOWN PCCP (1971) |
| SEGMENT 0260 OFFSET 0100 TO SEGMENT 0260 OFFSET 0335 | 1 1/2" BITUMINOUS WEARING COURSE (1997) 8" UNKNOWN PCCP (1971) |
| SR 2009 SOUTHBOUND: SEGMENT 0011 OFFSET 0000 TO SEGMENT 0011 OFFSET 0575 | 1 1/2" HEAVY DUTY BITUMINOUS WEARING COURSE (1997) 3" BITUMINOUS WEARING COURSE (1971) 10" PCCP (1971) |
| SEGMENT 0011 OFFSET 0575 TO SEGMENT 0011 OFFSET 0750 | 3" BITUMINOUS (1968) |
| SEGMENT 0011 OFFSET 0750 TO SEGMENT 0011 OFFSET 1875 | 1 1/2" HEAVY DUTY BITUMINOUS WEARING COURSE (1997) 3" BITUMINOUS WEARING COURSE (1971) 10" PCCP (1971) |
| SR 2009 NORTHBOUND: SEGMENT 0010 OFFSET 0000 TO SEGMENT 0010 OFFSET 1144 | 1 1/2" HEAVY DUTY BITUMINOUS WEARING COURSE (1997) 3" BITUMINOUS WEARING COURSE (1971) 10" PCCP (1971) |
| SEGMENT 0010 OFFSET 1144 TO SEGMENT 0010 OFFSET 1850 | 1 1/2" HEAVY DUTY BITUMINOUS WEARING COURSE (1997) 3" BITUMINOUS WEARING COURSE (1971) 10" PCCP (1971) |
| SEGMENT 0010 OFFSET 1850 TO SEGMENT 0010 OFFSET 2152 | 1 1/2" HEAVY DUTY BITUMINOUS WEARING COURSE (1997) 3" BITUMINOUS WEARING COURSE (1971) 10" PCCP (1971) |
| SEGMENT 0010 OFFSET 2152 TO SEGMENT 0010 OFFSET 2276 | 1 1/2" HMA WEARING COURSE, 64-22, 9.5 MM, E (2011) 2 1/2" HMA BINDER COURSE, 64-22, 19 MM (2011) 10" BITUMINOUS WEARING COURSE (1971) 10" PCCP (1971) |
| SEGMENT 0010 OFFSET 2276 TO SEGMENT 0010 OFFSET 2375 | 1 1/2" HMA WEARING COURSE, 64-22, 9.5 MM, E (2011) 2 1/2" HMA BINDER COURSE, 64-22, 19 MM (2011) 2 1/2" UNKNOWN BITUMINOUS WEARING COURSE (1953) 6" BELGIAN ROCK (1914) 6" PLAIN CEMENT CONCRETE BASE COURSE (1914) |

NOTE:
 THE DEPTHS OF MATERIAL SHOWN ARE FOR DESIGN PURPOSES ONLY. ANY RISK OF UNANTICIPATED COSTS ASSOCIATED WITH DIFFERENCES BETWEEN THE LISTED DEPTHS AND THE ACTUAL DEPTHS SHALL BE ACCEPTED BY THE CONTRACTOR.

TABULATION OF SEGMENT EQUALITIES

SEG 0225 OFFSET 0000 = STA 288+30.54 SB
 SEG 0231 OFFSET 0000 = STA 322+02.07 SB
 SEG 0235 OFFSET 0000 = STA 358+82.07 SB
 SEG 0241 OFFSET 0000 = STA 385+01.07 SB
 SEG 0245 OFFSET 0000 = STA 403+36.07 SB

TABULATION OF OVERALL LENGTH

SR 0095 SB STA 300+44.00 TO STA 485+38.34 = 18,494.34 FT = 3.503 MILE

TABULATION OF CONSTRUCTION LENGTH

SR 0095 SB STA 301+44.00 TO STA 484+38.34 = 18294.34 FT = 3.465 MILE
 SR 2009 NB STA 10+55.35 TO STA 33+64.69 = 2309.34 FT = 0.437 MILE
 SR 2009 SB STA 10+49.39 TO STA 28+53.13 = 1803.74 FT = 0.342 MILE

EXHIBIT "B"
 5 of 10

LOCATION MAP
 (SHEET 1 OF 4)

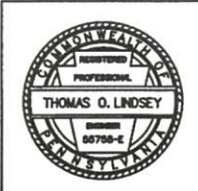

| DISTRICT | COUNTY | ROUTE | SECTION | SHEET | |
|----------------------|--------------|-------|---------|------------|----|
| 6-0 | PHILADELPHIA | 0095 | GR4 | 204 OF 253 | |
| CITY OF PHILADELPHIA | | | | | |
| REVISION NUMBER | REVISIONS | | | DATE | BY |
| | | | | | |

PROPOSED STRUCTURE
 SR 0095 SB STA 382+91.76 TO STA 388+70.44
 TYPE: FIVE SPAN PRESTRESSED CONCRETE I-BEAM BRIDGE
 SPANS:
 1: 123'-8 5/8"
 2: 124'-10 3/4"
 3: 104'-10 3/4"
 4: 104'-10 3/4"
 5: 117'-9 3/4"
 UNDERCLEARANCE:
 CAMBRIA ST: 29'-6 1/2"
 LATERAL CLEARANCE:
 CAMBRIA ST: 16'-0"
 SKEW: 80°07'47" TO 90°00'00"
 CLEAR ROADWAY WIDTH: 76'-1 3/4" TO 81'-8 3/8"
 MINIMUM SHOULDER WIDTH: 4'-0"
 STRUCTURE: S-34769
 RECOMMENDED

BM-7 ELEV. 22.60
 115.37' LT STA 388+14.15
 SURVEY & R/W C SR 0095
 BOX-CUT TOP OF CONC CURB

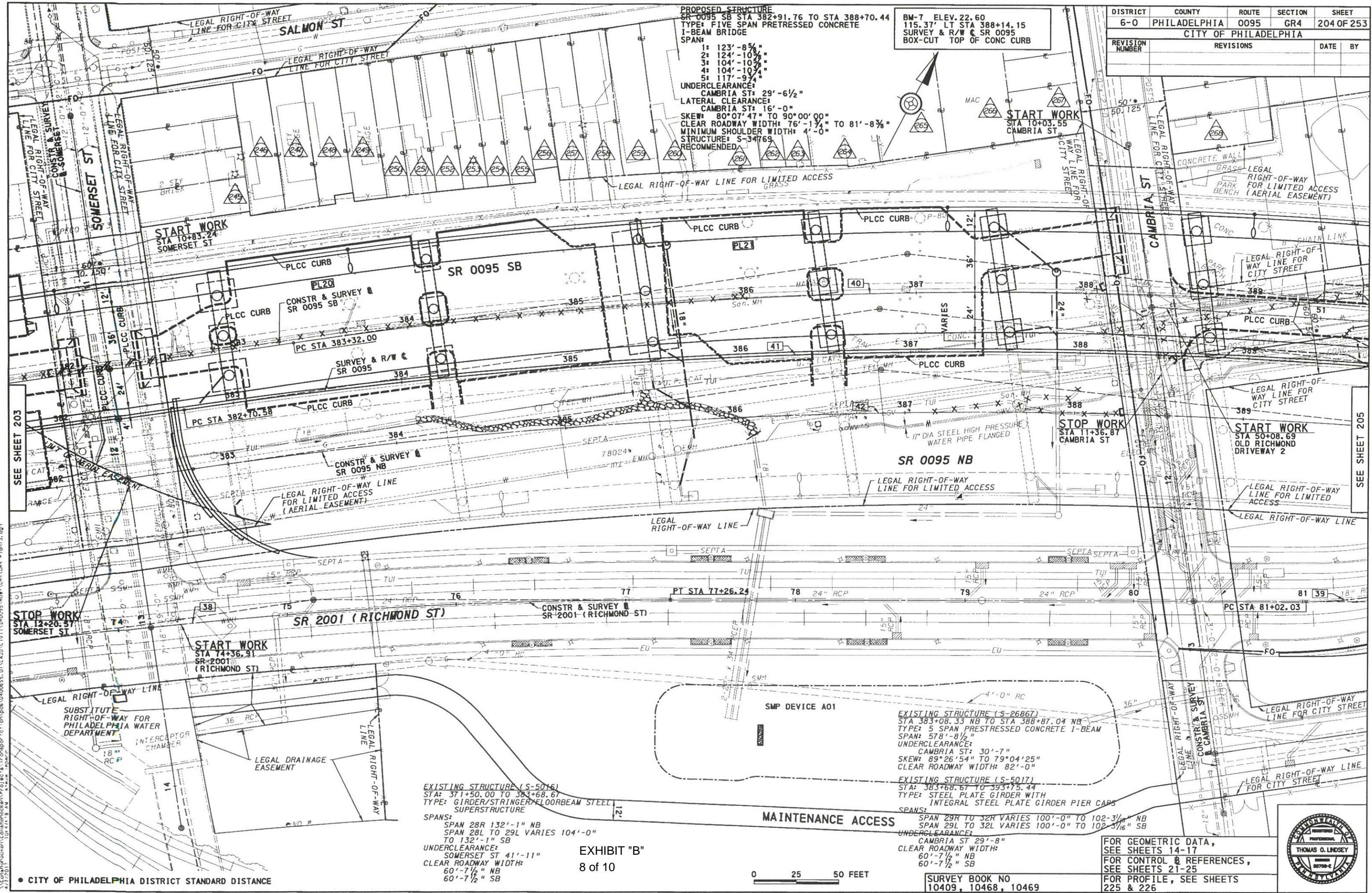

EXISTING STRUCTURE (S-5016)
 STA: 371+50.00 TO 383+68.61
 TYPE: GIRDER/STRINGER/FLOORBEAM STEEL SUPERSTRUCTURE
 SPANS:
 SPAN 28R 132'-1" NB
 SPAN 28L TO 29L VARIES 104'-0" TO 132'-1" SB
 UNDERCLEARANCE:
 SOMERSET ST 41'-11"
 CLEAR ROADWAY WIDTH:
 60'-7 1/2" NB
 60'-7 1/2" SB

EXISTING STRUCTURE (S-26867)
 STA 383+08.33 NB TO STA 388+87.04 NB
 TYPE: 5 SPAN PRESTRESSED CONCRETE I-BEAM
 SPAN: 578'-8 1/2"
 UNDERCLEARANCE:
 CAMBRIA ST: 30'-7"
 SKEW: 89°26'54" TO 79°04'25"
 CLEAR ROADWAY WIDTH: 82'-0"
EXISTING STRUCTURE (S-5017)
 STA: 383+68.67 TO 393+75.44
 TYPE: STEEL PLATE GIRDER WITH INTEGRAL STEEL PLATE GIRDER PIER CAPS
 SPANS:
 SPAN 29R TO 32R VARIES 100'-0" TO 102'-3 1/8" NB
 SPAN 29L TO 32L VARIES 100'-0" TO 102'-3 1/8" SB
 UNDERCLEARANCE:
 CAMBRIA ST 29'-8"
 CLEAR ROADWAY WIDTH:
 60'-7 1/2" NB
 60'-7 1/2" SB

EXHIBIT "B"
 8 of 10

0 25 50 FEET

SURVEY BOOK NO
 10409, 10468, 10469

FOR GEOMETRIC DATA,
 SEE SHEETS 14-17
 FOR CONTROL & REFERENCES,
 SEE SHEETS 21-25
 FOR PROFILE, SEE SHEETS
 225 & 226



\\conshohocken\conshohocken\Projects\Transportation\SR 0095 SB S-27051\FINAL\PRESENTATION\001_CPE01.LNB.dgn
 4/5/2017 12:11:42 PM br lon...traxler

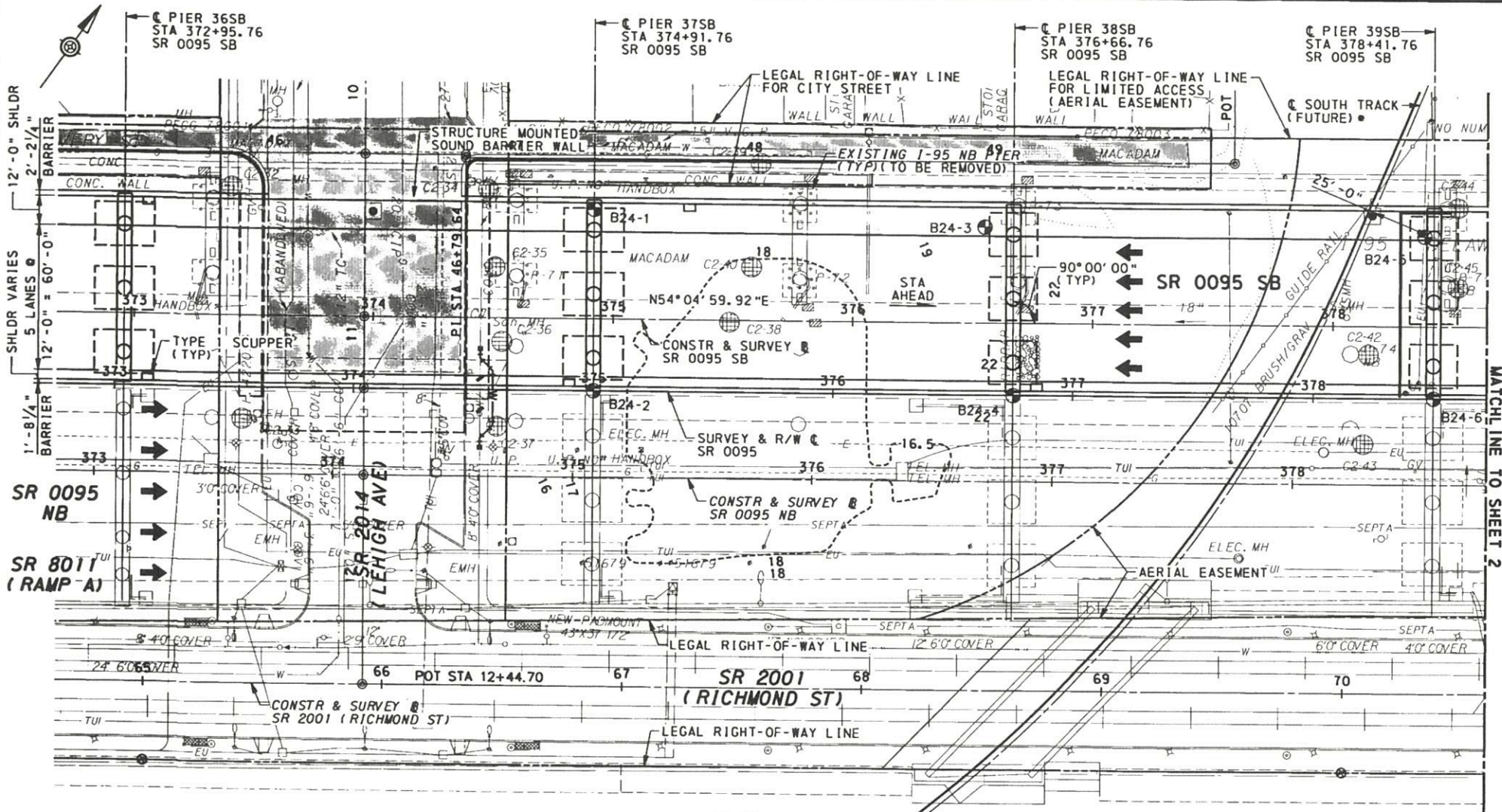

HORIZONTAL GEOMETRY

CONSTR & SURVEY SR 0095 SB
 PI STA 386+97.16
 $\Delta = 14^{\circ}24'30''$ RT
 $D = 1^{\circ}59'00.18''$
 $T = 365.15'$
 $L = 726.45'$
 $R = 2888.79'$
 $E = 22.99'$

VERTICAL GEOMETRY

CONSTR & SURVEY SR 0095 SB
 PVI STA 367+95.75
 EL 43.05
 $+1.90\%$
 PVC STA 378+30.81
 EL 62.69

CONSTR & SURVEY SR 0095 SB
 PVI STA 383+80.81
 ELEV 73.12
 VC 1100.00 FT
 MO -6.73 FT
 $+1.90\%$ -3.00%

BORING SCHEDULE

| BORING NUMBER | SURVEY & R/W STATION | OFFSET |
|---------------|----------------------|--------|
| B24-1 | 375+00 | 75' LT |
| B24-2 | 375+00 | 0' |
| B24-3 | 376+63 | 70' LT |
| B24-4 | 376+75 | 0' |
| B24-5 | 378+46 | 67' LT |
| B24-6 | 378+50 | 0' |
| B24-7 | 381+00 | 70' LT |
| B24-8 | 381+00 | 0' |
| B24-9 | 383+00 | 75' LT |
| B24-10 | 383+00 | 0' |

LEGEND

- EXISTING CONTOUR
- PROPOSED CONTOUR
- POINT OF EXISTING & PROPOSED MINIMUM VERTICAL CLEARANCE
- ⊕ RECENT BORING LOCATION
- ⊗ ORIGINAL BORING LOCATION
- TEMPORARY EXCAVATION SUPPORT AND PROTECTION SYSTEM
- LEGAL RIGHT-OF-WAY
- TYPE 1 SCUPPER

INDEX OF DRAWINGS

| | |
|---|-----------------------------|
| 1 | GENERAL PLAN & ELEVATION I |
| 2 | GENERAL PLAN & ELEVATION II |
| 3 | TYPICAL SECTION & RATINGS |
| 4 | CONSTRUCTION STAGING |

| Mark | Description | By | Chk'd | Recm'd | Date |
|-----------|-------------|----|-------|--------|------|
| REVISIONS | | | | | |

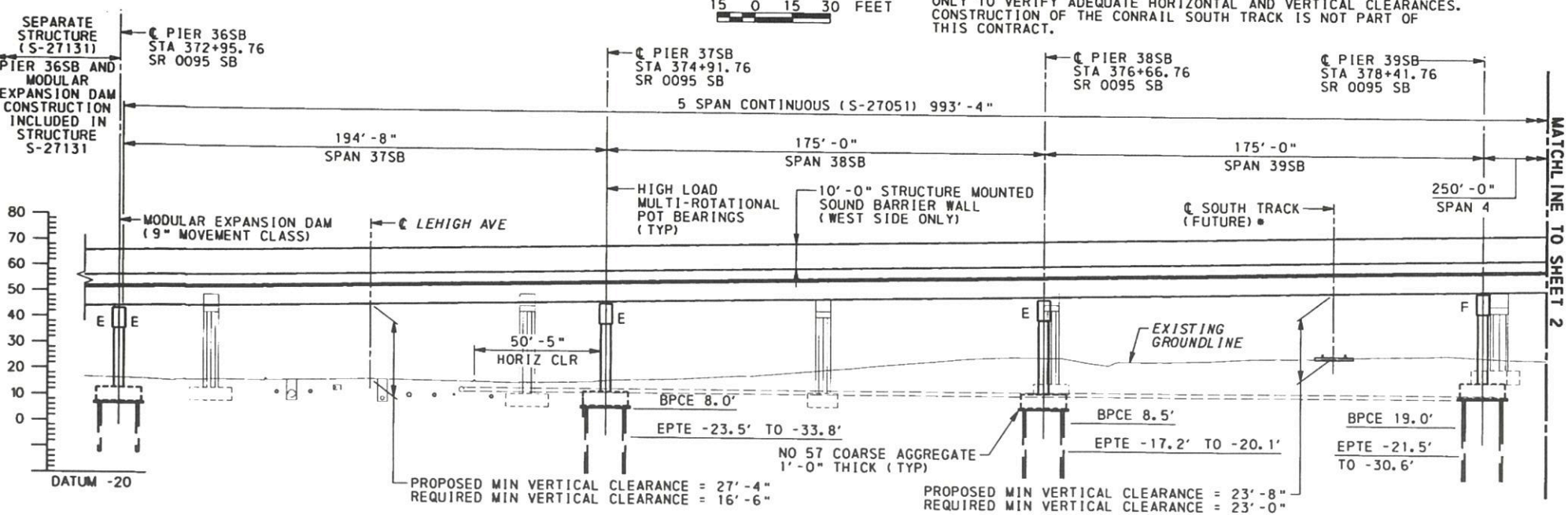

COMMONWEALTH OF PENNSYLVANIA
DEPARTMENT OF TRANSPORTATION
PHILADELPHIA COUNTY
S.R. 0095 SEC. GIR
 SEC 0234 OFFSET 1409 S.B.
 S.R. 095 STA. 377+10.33 S.B.
OVER CONRAIL, LEHIGH AVE & SOMERSET ST.
FIVE SPAN STEEL PLATE GIRDER BRIDGE
GENERAL PLAN & ELEVATION I

PREPARED BY:
AECOM
 CONSULTING ENGINEERS
 CONSHOHOCKEN, PA

RECOMMENDED _____

SHEET ____ OF XX

S-27051

EXHIBIT "B"
 9 to 10

