

October 30, 2018

Ms. Rosemary Chiavetta, Secretary  
Pennsylvania Public Utility Commission  
P.O. Box 3265  
Harrisburg, PA 17105-3265

Re: Application of the Department of Transportation of the Commonwealth of Pennsylvania for approval to replace the superstructure and repair the substructure of the public above grade crossing where SR 309 (Sellersville Bypass Expressway) crosses above two tracks owned by Southeastern Pennsylvania Transportation Authority and operated on by East Penn Railroad, LLC, DOT No. 592 617 N in West Rockhill Township, Bucks County.

Dear Secretary Chiavetta:

Enclosed for filing, please find the Application of the Department of Transportation.

A copy of this Application and Exhibits has been served upon the parties in the Certificate of Service to the Application.

Sincerely,

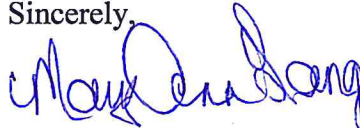

Mary Ann Lang, District Utility Manager  
Engineering District 6-0  
Department of Transportation

Attachments

cc: Parties of Record

Mark J. Chappell, P.E., Right-of-Way and Utilities Section, 7<sup>th</sup> Floor, CKB  
Gina M. D'Alfonso, Office of Chief Counsel, 9<sup>th</sup> Floor, CKB  
Ronald J. Hull, P.E. Rail Safety Engineering Section PUC, 3<sup>rd</sup> Floor, CKB

**BEFORE THE  
PENNSYLVANIA PUBLIC UTILITY COMMISSION**

Application of the Department of Transportation, of the Commonwealth of Pennsylvania, for approval to replace the superstructure and repair the substructure of the public above-grade crossing, where SR 0309 (Sellersville Bypass Expressway) crosses above two tracks owned by Southeastern Pennsylvania Transportation Authority, and operated on by East Penn Railroad, LLC, DOT No. 592 617 N in West Rockhill Township, Bucks County.

Application  
Docket No. \_\_\_\_\_

**Electronically Filed**

To the Pennsylvania Public Utility Commission:

1. The name and address of Applicant are Commonwealth of Pennsylvania, Department of Transportation by Charles Davies, P.E., Assistant District Executive, Engineering District 6-0, 7000 Geerdes Boulevard, King of Prussia, PA 19406.
2. The name and address of attorney for the Applicant are Jason D. Sharp, Chief Counsel, Commonwealth of Pennsylvania, Department of Transportation, Office of Chief Counsel, PO Box 8212, Harrisburg, PA 17105-8212.
3. The Applicant is an agency of Commonwealth of Pennsylvania, organized and existing under the Administrative Code of 1929, 71 P.S. § 511, et seq. and generally 36 P.S. § 670 - 401 et seq.
4. The names and addresses of the persons, parties and entities concerned in, or affected by the proposed construction, to the best of the Applicant's knowledge, are shown in the certificate of service. In addition to those served, the Applicant requests that the following also receive service of all documents in this matter:

Mark J. Chappel, P.E., Chief  
Utilities and Right of Way Section  
Pennsylvania Department of Transportation  
P.O. Box 3362  
Harrisburg, PA 17105-3362

Gina M. D'Alfonso, Senior Counsel-in-  
Charge  
Office of Chief Counsel  
Pennsylvania Department of Transportation  
P.O. Box 3265  
Harrisburg, PA 17105-3265

5. It is desirable to replace the superstructure and repair the substructure of the bridge carrying State Route 0309, Segment 0110, Offset 0000 to Segment 0110, Offset 126 and between Segment 0111, Offset 0000 to Segment 0111, Offset 0126. A Location Map is attached hereto and marked as Exhibit "A". The relevant preliminary Type, Size & Location plan sheets, and construction plan sheets are attached hereto and marked as Exhibit "B".

6. The Average Daily Traffic for State Route 0309 is 44,401 vehicles with 10% trucks.
7. The estimated total cost for the replacement of the bridge superstructure and repair of the substructure is \$2,225,000. The funding for the project will be 80% Federal Funds and 20% State Funds.
8. This project is necessary and proper for the safety and convenience of the public.
9. A conference of all parties of interest should be held to discuss the proposed improvement.

Wherefore, Applicant respectfully requests that the Public Utility Commission approve this application:

Respectfully Submitted:

Dated: \_\_\_\_\_

16 / 30 / 18



Charles H. Davies, P.E.  
Assistant District Executive  
Engineering District 6-0  
Department of Transportation  
7000 Geerdes Boulevard  
King of Prussia, PA 19406  
Phone 610-205-6671  
Fax 610-205-6903

**BEFORE THE  
PENNSYLVANIA PUBLIC UTILITY COMMISSION**

Application of the Department of Transportation of the Commonwealth of Pennsylvania for approval to replace the superstructure and repair the substructure of the public above-grade crossing where SR 0309 (Sellersville Bypass Expressway) crosses above two tracks owned by Southeastern Pennsylvania Transportation Authority and operated on by East Penn Railroad, LLC, DOT No. 592 617 N in West Rockhill Township, Bucks County.

Application  
Docket No. \_\_\_\_\_

**Electronically Filed**

VERIFICATION

I, Mary Ann Lang, District Utility Manager, hereby state that the facts above set forth are true and correct to the best of my knowledge, information and belief and that I expect to be able to prove the same at a hearing held in this matter. I understand that the statements herein are made subject to the penalties of 18 Pa.C.S. §4904 (relating to unsworn falsification to authorities).

Date: 12/30/18

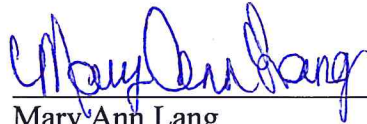
  
\_\_\_\_\_  
Mary Ann Lang  
District Utility Manager

**BEFORE THE  
PENNSYLVANIA PUBLIC UTILITY COMMISSION**

Application of the Department of Transportation, of the Commonwealth of Pennsylvania, for approval to replace the superstructure and repair the substructure the public above grade crossing where SR 309 (Sellersville Bypass Expressway) crosses above two tracks owned by Southeastern Pennsylvania Transportation Authority and operated on by East Penn Railroad, LLC, DOT No. 592 617 N in West Rockhill Township, Bucks County.

Application  
Docket No. \_\_\_\_\_

**Electronically Filed**

**CERTIFICATE OF SERVICE**

I hereby certify that I have this day served a true copy of the foregoing document upon the participants listed below, in accordance with the requirements of 52 Pa. Code § 1.54, by first class mail, postage prepaid:

Alfred Sauer, President  
East Penn Railroad, LLC  
505 S Broad Street  
Kennett Square, PA 19438

Robert L. Lund, Jr., Assistant General Manager  
Southeastern Pennsylvania Transportation Authority  
1234 Market Street, 12<sup>th</sup> Floor  
Philadelphia, PA 19107-3780

Mr. Brian Hessenthaler, Chief Operating Officer  
Bucks County Commissioners  
Administration Building  
55 East Court Street  
Doylestown, PA 18901

Greg Lippincott, Manager  
West Rockhill Township  
1028 Ridge Road  
Sellersville, PA 18960

Hugh Gallagher, President  
Amerigas Propane  
1000 Adams Ave.  
Norristown, PA 19403

Eric Meissner, Operations Manager  
CenturyLink  
2011 Hartel Street  
Levittown, PA 19057

John Dohalick, Regional Permit Coordinator  
Comcast Cable Communications  
2320 Trenton Road  
Levittown, PA 19056

Jared Kost, Asset Specialist  
Crown Castle  
2000 Corporate Drive  
Canonsburg, PA 15317

Patrick Galli  
Frontier Communications  
300 E Laird Steet  
Wilkes Barre, PA 18702

Aaron Bibro, Manager  
Hatfield Township  
1950 School Road  
Hatfield, PA 19440

Peter Dorney, Executive Director  
Hatfield Township Municipal Authority  
3200 Advance Lane  
Colmar, PA 18915

Karl Brenton, OSP Engineer  
Level (3) Communications, Inc.  
3020 Market Street – 3<sup>rd</sup> Floor  
Philadelphia, PA 19104

Dan Preston, Director of Operations & Eng  
North Penn Water Authority  
300 Forty Foot Road  
Lansdale, PA 19446

Nicholas Fretz, Manager  
Perkasie Regional Authority  
150 Ridge Road  
Sellersville, PA 18960

Charlotte Krupa, Agency Coordinator  
PPL Electric Utilities Corporation  
2 North 9th Street. - GENN-3  
Allentown, PA 18101-1179

Michael Hamilton, Damage Prevention Specialist  
PPL Interstate Energy Co.  
214 Shoemaker Road  
Pottstown, PA 19464

David J Rivet, Manager  
Sellersville Borough  
140 East Church Street  
Sellersville, PA 18960

Mark D Fournier, Manager  
Telford Borough  
122 Penn Ave  
Telford, PA 18969-1912

William Savage, Right-of-Way Agent  
Texas Eastern Transmission LP/Enbridge  
560 Pottstown Pike  
Chester Springs, PA 19425

William Karr, Sr Engineering Manager  
UGI Utilities, Inc  
2121 City Line Road  
Bethlehem, PA 18017

Laura M Lippincott, Section Manager  
Verizon Pennsylvania, LLC  
1050 Virginia Drive, Floor 4  
Fort Washington, PA 19034

Scott Dreiling, Implementation Engineer  
XO Communications  
1220 Broadcasting Road  
Wyomissing, PA 19610

Dated this 30<sup>th</sup> Day of October 2018

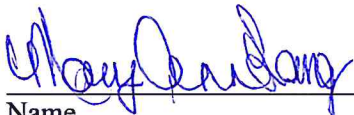
  
Name

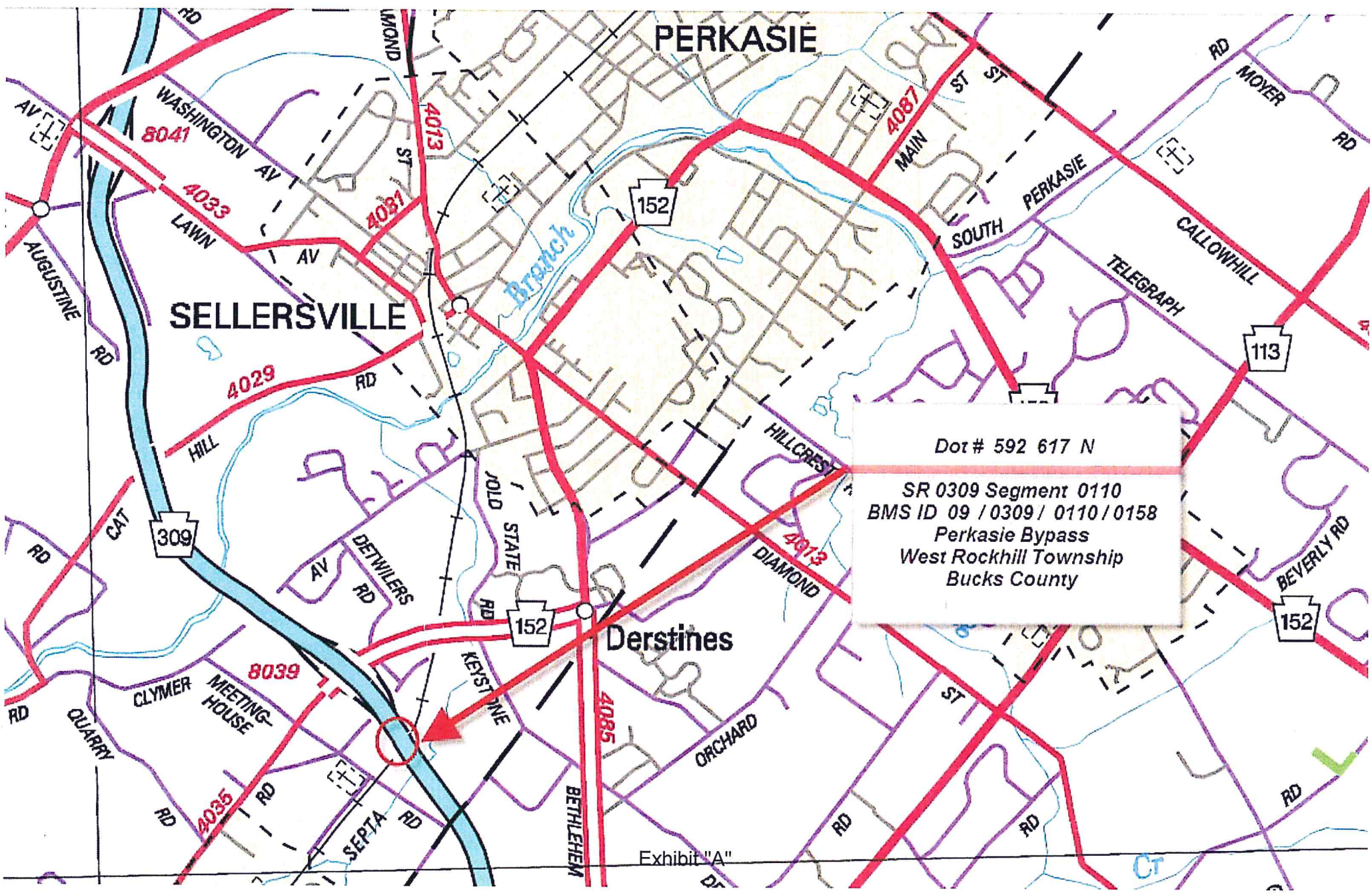

Dot # 592 617 N  
SR 0309 Segment 0110  
BMS ID 09 / 0309 / 0110 / 0158  
Perkasie Bypass  
West Rockhill Township  
Bucks County

Exhibit "A"

**CALL BEFORE YOU DIG**  
 PENNSYLVANIA LAW REQUIRES 3 WORKING DAYS  
 NOTICE FOR CONSTRUCTION PHASE AND 10  
 WORKING DAYS IN DESIGN STAGE - STOP  
 CALL 1-800-242-1776  
 PENNSYLVANIA ONE CALL



DESIGNER SERIAL NUMBERS: 20140561586 (HATFIELD TOWNSHIP)  
 DESIGNER SERIAL NUMBERS: 20140561627 (HILLTOWN TOWNSHIP)  
 DESIGNER SERIAL NUMBERS: 20140561615 (WEST ROCKHILL TOWNSHIP)  
 DESIGNER SERIAL NUMBERS: 20140561639 (WEST ROCKHILL TOWNSHIP)  
 DESIGNER SERIAL NUMBERS: 20140561653 (RICHLAND TOWNSHIP)

**TABULATION OF OVERALL LENGTH**

MONTGOMERY COUNTY  
 FROM STATION 100+00 TO 138+83 = 3,883 FT = 0.74 MI (SR 0309)  
 BUCKS COUNTY  
 FROM STATION 100+00 TO 581+10 = 44,227 FT = 8.37 MI (SR 0309)

**TABULATION OF CONSTRUCTION LENGTH**

MONTGOMERY COUNTY  
 FROM STATION 102+50 TO 138+83 = 3,633 FT = 0.68 MI (SR0309)  
 BUCKS COUNTY  
 FROM STATION 102+50 TO 580+60 = 44,177 FT = 9.05 MI (SR0309)

**LIST OF EQUALITIES**  
 NONE

THE INFORMATION ON ESTIMATED AMOUNTS OF EARTHWORK HAS BEEN USED IN THE PRELIMINARY ESTIMATE. DO NOT USE AS A WAIVER OF ANY PROVISIONS OF THE SPECIFICATIONS AND CONTRACTS

CUBIC YARDS OF EXCAVATION					CUBIC YARDS OF COMPLETED EMBANKMENT*	CUBIC YARDS OF BORROW EXCAVATION	CUBIC YARDS OF SELECT BORROW	CUBIC YARDS OF WASTE
CLASS 1	CLASS 1A	CLASS 1B	CLASS 2	CLASS 3**				

\* INCLUDES ALL BORROW ITEMS  
 \*\* CY PART OF LUMP SUM STRUCTURE ITEM

PUBLIC UTILITIES		
UTILITIES	ADDRESS	
HATFIELD TOWNSHIP MUNICIPAL AUTHORITY	3200 ADVANCE LANE COLMAR, PA 18915	ATTN. PETER DORNEY 215-822-9300
HATFIELD TOWNSHIP	1950 SCHOOL ROAD HATFIELD, PA 19440	ATTN. ANDREW HAINES 215-855-0900
TELFORD BOROUGH AUTHORITY	122 PENN AVENUE TELFORD, PA 18969	ATTN. MARK D. FOURNIER 215-723-5000
NORTH PENN WATER AUTHORITY	300 FORTY FOOT ROAD P.O. BOX 1659 LANSDALE, PA 19446	ATTN. DAN PRESTON 215-855-3617
XO COMMUNICATIONS INC	1220 BROADCASTING ROAD WYOMISSING, PA 19610	ATTN. SCOTT DREILING 610-288-5329
VERIZON PENNSYLVANIA LLC	180 SHEREE BLVD SUITE 2100 EXTON, PA 19341	ATTN. CINDY SWEPENHEISER 800-255-2355
UGI UTILITIES INC	2121 CITY LINE ROAD BETHLEHEM, PA 18017	ATTN. LINDA SOFRANEK 610-736-5508
PECO ENERGY	C/O USIC, UNIT B 400 S. HENDERSON ROAD KING OF PRUSSIA, PA 19405	ATTN. USIC REPRESENTATIVE
PPL ELECTRIC UTILITIES CORPORATION	TWO N 9TH STREET ALLENTOWN, PA 18101	ATTN. CHARLOTTE KRUPA 610-774-5151
PPL INTERSTATE ENERGY COMPANY	214 SHOEMAKER ROAD POTTSTOWN, PA 19464	ATTN. DON SAMALA 610-327-5325
SPECTRA ENERGY/TEXAS EASTERN	467 FORGEDALE ROAD BARTO, PA 19504	ATTN. MARK R. STOVER 610-334-9074
AMERIGAS PROPANE	1000 ADAMS AVENUE NORRISTOWN, PA 19403	ATTN. 484-831-2800

DISTRICT	COUNTY	ROUTE	SECTION	SHEET
6-0	BUCKS & MONTGOMERY	0309	PM1	2 OF 66

HILLTOWN, HATFIELD, WEST ROCKHILL, AND RICHLAND TOWNSHIPS

REVISION NUMBER	REVISIONS	DATE	BY

**GENERAL NOTES**

THE LEGAL RIGHT-OF-WAY ON SR 0309, FORMERLY LR 1027 FROM STATION 100+00 TO STATION 345+19.79 IS VARIABLE IN WIDTH AS SHOWN BASED ON DRAWINGS OF CONSTRUCTION FOR LEG. ROUTE NUMBERS 153 SECTION 21A AND 1027 SECTION 1, DATED JANUARY 1967.

THE LEGAL RIGHT-OF-WAY ON SR 0309, FORMERLY LR 1027 FROM STATION 224+35.00 TO STATION 324+34.00 IS VARIABLE IN WIDTH AS SHOWN BASED ON DRAWINGS AUTHORIZING CONDEMNATION OF RIGHT-OF-WAY FOR LEGISLATIVE ROUTE NUMBERS 153 SECTION 21A AND 1027 SECTION 1, APPROVED JULY 22, 1965.

THE LEGAL RIGHT-OF-WAY ON SR 0309, FORMERLY LR 1027 FROM STATION 324+34.00 TO STATION 552+10.00 IS VARIABLE IN WIDTH AS SHOWN BASED ON DRAWINGS AUTHORIZING CONDEMNATION OF RIGHT-OF-WAY FOR LEGISLATIVE ROUTE NUMBERS 153 SECTION 22A AND 1027 SECTION 2, APPROVED MARCH 12, 1965.

THE LEGAL RIGHT-OF-WAY ON SR 0309, FORMERLY LR 1027 FROM STATION 345+19.79 TO STATION 580+60.00 IS VARIABLE IN WIDTH AS SHOWN BASED ON DRAWINGS OF CONSTRUCTION FOR LEG. ROUTE NUMBERS 1027 SECTION 2 AND 153 SECTION 22A DATED MARCH 17, 1966.

THE DEPARTMENT RESERVES THE RIGHT TO ELIMINATE ANY OR ALL OF THIS WORK. DO NOT PERFORM WORK EXCEPT THAT WHICH IS WITHIN THE HIGHWAY RIGHT-OF-WAY UNTIL SO ORDERED IN WRITING BY THE ENGINEER.

CONSTRUCT PROJECT IN ACCORDANCE WITH PUBLICATION 408-SPECIFICATIONS, DATED 2016.

TEMPORARY CONSTRUCTION EASEMENT. AN EASEMENT TO USE THE LAND AS NECESSARY DURING CONSTRUCTION OF THE PROJECT. THE EASEMENT IS REQUIRED ONLY UNTIL THE CONSTRUCTION OF WORK INDICATED BY THE PLAN IS COMPLETED, UNLESS SOONER RELINQUISHED IN WRITING BY THE DEPARTMENT.

THE DEPARTMENT OF TRANSPORTATION DOES NOT GUARANTEE THE ACCURACY OF THE LOCATIONS OF THE EXISTING ABOVE GROUND AND SUBSURFACE UTILITY STRUCTURES SHOWN ON THE PLANS, NOR DOES THE DEPARTMENT OF TRANSPORTATION GUARANTEE THAT ALL ABOVE GROUND AND SUBSURFACE STRUCTURES ARE SHOWN.

EXISTING UTILITIES ARE SHOWN IN ACCORDANCE WITH THE BEST INFORMATION AVAILABLE AND ARE FOR THE CONVENIENCE OF THE CONTRACTOR ONLY. THE CORRECTNESS OF THE INFORMATION IS NOT GUARANTEED. THE CONTRACTOR SHALL VERIFY THE INFORMATION AND SHALL TAKE ALL PRECAUTIONS TO FULLY PROTECT THE UTILITY AND SERVICE.

EXISTING DRAINAGE FACILITY LOCATIONS HAVE NOT BEEN FIELD VERIFIED. LOCATIONS, AS SHOWN, ARE BASED ON AERIAL PHOTOGRAPHY AND THE ORIGINAL CONSTRUCTION PLANS.

THREE WORKING DAYS PRIOR TO EXCAVATION, THE CONTRACTOR MUST CONTACT THE PA ONE CALL SYSTEM, INC., PHONE 1-800-242-1776, SERIAL NO: 20140561586 (HATFIELD TOWNSHIP) 20140561627 (HILLTOWN TOWNSHIP) 20140561615 (WEST ROCKHILL TOWNSHIP) 20140561639 (WEST ROCKHILL TOWNSHIP) 20140561653 (RICHLAND TOWNSHIP)

THIS IS A FEDERAL AID PROJECT AND AS SUCH IS SUBJECT TO INSPECTION BY REPRESENTATIVES OF THE FEDERAL HIGHWAY ADMINISTRATION AND THE PENNSYLVANIA DEPARTMENT OF TRANSPORTATION.

THE VERTICAL DATUM FOR THIS PLAN IS BASED ON NAVD88.

THE HORIZONTAL CONTROL IS BASED ON PENNSYLVANIA STATE PLANE COORDINATE SYSTEM (SOUTH ZONE) AND NORTH AMERICAN DATUM (NAD) 83.

SR 0309 WAS PREVIOUSLY KNOWN AS LR 153 & LR 1027.

DRAINAGE EASEMENT. AN EASEMENT FOR THE CONSTRUCTION, INSPECTION, MAINTENANCE, REPAIR, RECONSTRUCTION AND ALTERATION OF HIGHWAY DRAINAGE FACILITIES. THE EASEMENT SHALL NOT PREVENT THE PROPERTY OWNER FROM MAKING ANY LEGAL USE OF THE AREA WHICH IS NOT DETRIMENTAL TO THE NECESSARY FLOW OF WATER. HOWEVER, NO STRUCTURE OF ANY KIND MAY BE ERECTED IN THE AREA, NOR MAY ANY PIPE OR DITCH BE CONNECTED TO THE DEPARTMENT'S PIPE OR DITCH WITHOUT ADVANCED WRITTEN APPROVAL BY THE DEPARTMENT OF TRANSPORTATION.

**DETAILS, OTHER THAN THOSE INDICATED,**

**ARE ON THE FOLLOWING STANDARD DRAWINGS:**

RC-10M (06/01/10)	RC-45M (09/15/16)	RC-65M (08/27/17)	RC-80M (06/01/10)
RC-11M (06/01/10)	RC-46M (09/15/16)	RC-67M (06/10/13)	RC-81M (06/01/10)
RC-22M (06/01/10)	RC-50M (08/04/17)	RC-72M (08/04/17)	RC-82M (06/01/10)
RC-25M (09/15/16)	RC-51M (08/04/17)	RC-70M (06/01/10)	RC-84M (06/01/10)
RC-28M (09/15/16)	RC-53M (08/04/17)	RC-72M (09/15/16)	RC-92M (06/01/10)
RC-31M (06/01/10)	RC-57M (06/01/10)	RC-73M (08/04/17)	BC-741M (8/04/17)
RC-39M (09/15/16)	RC-59M (06/01/10)	RC-75M (06/01/10)	TC-8804 (12/12/11)
RC-40M (06/01/10)	RC-60M (06/01/10)	RC-77M (06/01/10)	
RC-43M (06/01/10)	RC-64M (06/01/10)		

THE HALF CIRCLED NUMBER INDICATES A SCALED DIMENSION.

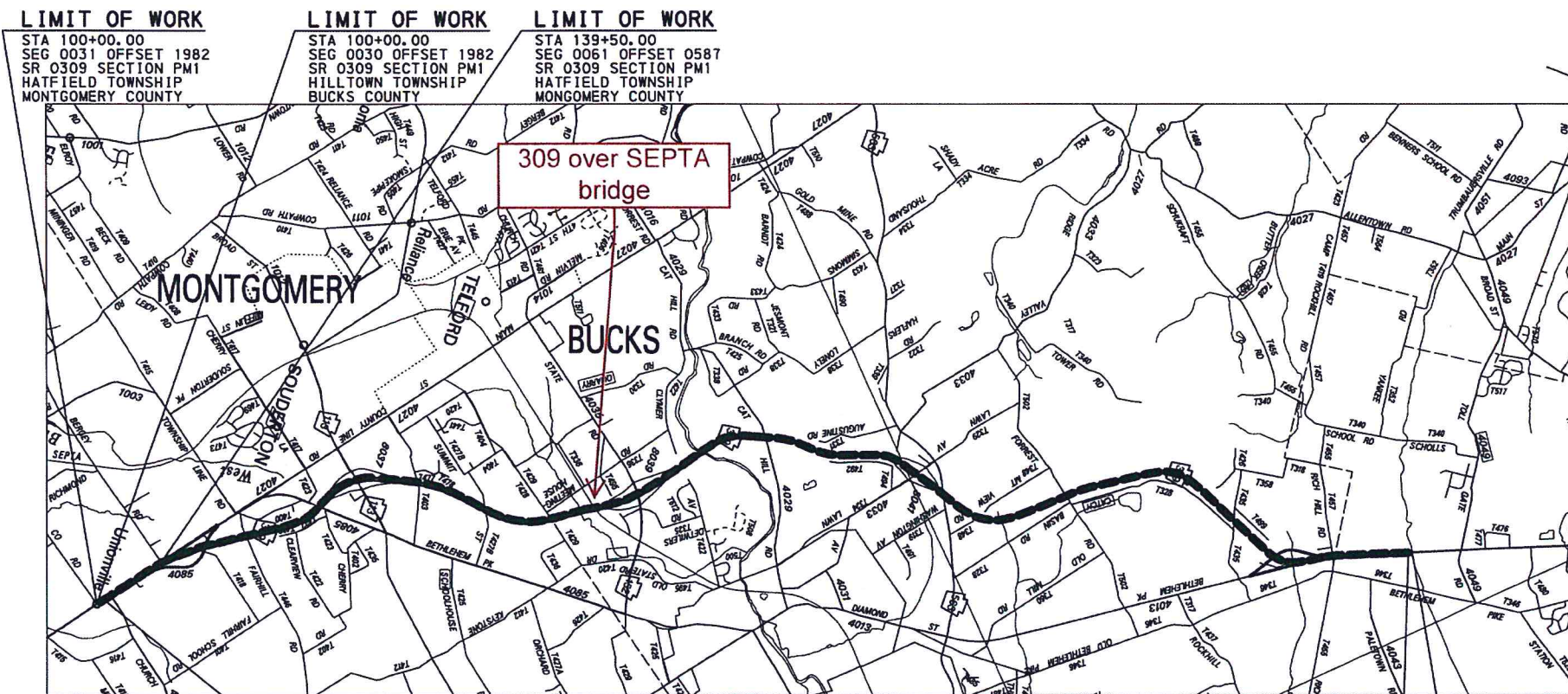

**LEGEND**

PROJECT  
 STATE HIGHWAY

**START WORK**  
 STA 100+50.00  
 SEG 0030 OFFSET 2032  
 SEG 0031 OFFSET 2032  
 SR 0309 SECTION PM1

**LOCATION MAP**

SCALE  
 0 0.5 1 MILE

**STOP WORK**

STA 580+60.00  
 SEG 0220 OFFSET 2587  
 SEG 0221 OFFSET 2178  
 SR 0309 SEC PM1

**LIMIT OF WORK**

STA 581+10.00  
 SEG 0220 OFFSET 2637  
 SEG 0221 OFFSET 2228  
 SR 0309 SEC PM1  
 RICHLAND TOWNSHIP  
 BUCKS COUNTY

P:\60236723 SR 309-PM1\000\_CAD\006\_Civil\Sheets\CP\_Plans\GN01.dgn  
 7/25/2018

Exhibit "B"

DISTRICT	COUNTY	ROUTE	SECTION	SHEET
6-0	BUCKS	0309	PM1	43 OF 66
WEST ROCKHILL TOWNSHIP				
REVISION NUMBER	REVISIONS	DATE	BY	

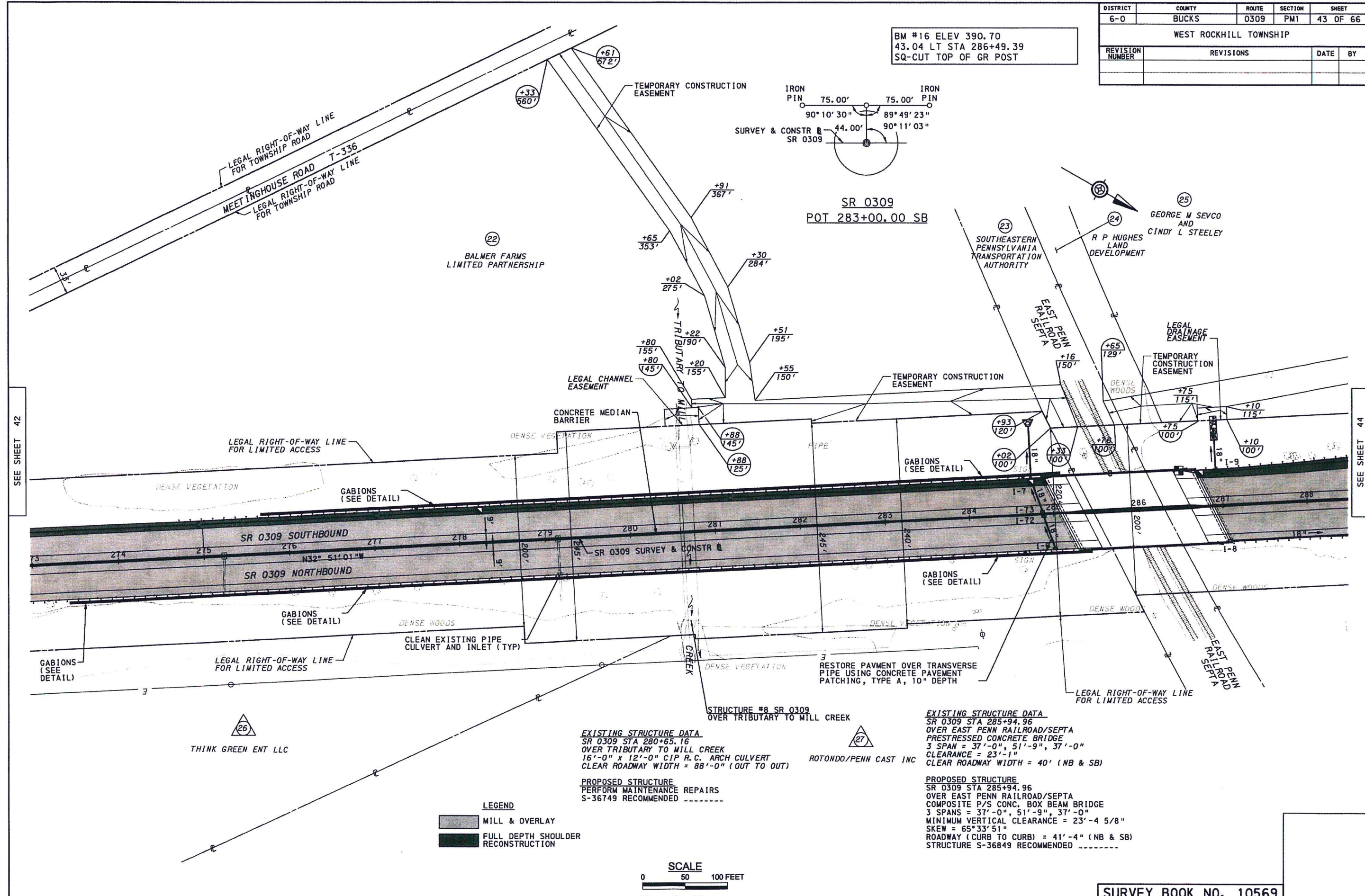

BM #16 ELEV 390.70  
43.04 LT STA 286+49.39  
SQ-CUT TOP OF GR POST

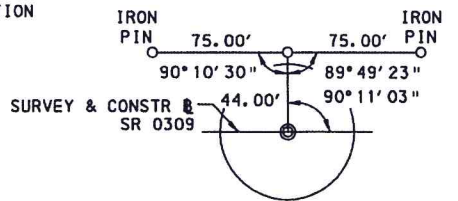

SR 0309  
POT 283+00.00 SB

SEE SHEET 42

SEE SHEET 44

**EXISTING STRUCTURE DATA**  
SR 0309 STA 280+65.16  
OVER TRIBUTARY TO MILL CREEK  
16'-0" x 12'-0" CIP R.C. ARCH CULVERT  
CLEAR ROADWAY WIDTH = 88'-0" (OUT TO OUT)

**PROPOSED STRUCTURE**  
PERFORM MAINTENANCE REPAIRS  
S-36749 RECOMMENDED

**EXISTING STRUCTURE DATA**  
SR 0309 STA 285+94.96  
OVER EAST PENN RAILROAD/SEPTA  
PRESTRESSED CONCRETE BRIDGE  
3 SPAN = 37'-0", 51'-9", 37'-0"  
CLEARANCE = 23'-1"  
CLEAR ROADWAY WIDTH = 40' (NB & SB)

**PROPOSED STRUCTURE**  
SR 0309 STA 285+94.96  
OVER EAST PENN RAILROAD/SEPTA  
COMPOSITE P/S CONC. BOX BEAM BRIDGE  
3 SPANS = 37'-0", 51'-9", 37'-0"  
MINIMUM VERTICAL CLEARANCE = 23'-4 5/8"  
SKEW = 65°33'51"  
ROADWAY (CURB TO CURB) = 41'-4" (NB & SB)  
STRUCTURE S-36849 RECOMMENDED

**LEGEND**  
[Pattern] MILL & OVERLAY  
[Pattern] FULL DEPTH SHOULDER RECONSTRUCTION



7/25/2018 P:\60236723 SR 309-PM1\000\_CAD\006\_Civil\Sheets\CP\_Plans\Plan13.dgn

Exhibit "B"

DISTRICT	COUNTY	ROUTE	SECTION	SHEET
6-0	BUCKS	0309	PM1	65 OF 66
WEST ROCKHILL TOWNSHIP				
REVISION NUMBER	REVISIONS			DATE BY

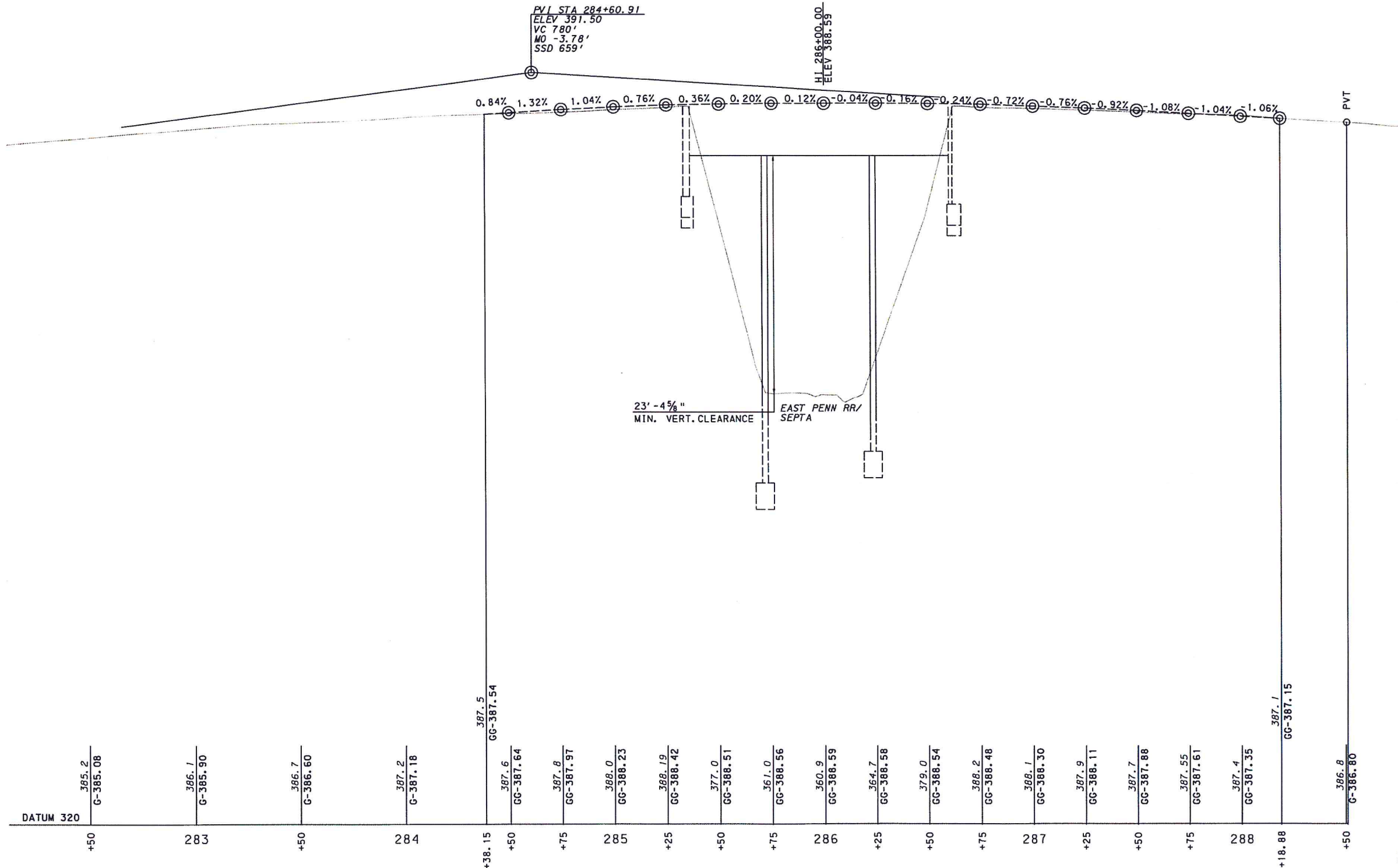

7/25/2018 P:\60236723 SR 309-PM1\000.CAD\006.Civil\Sheets\CP Plans\PRO1.dgn

SR 0309

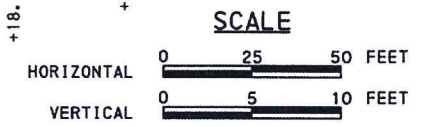

SURVEY BOOK NO. 10569 SEE SHEET 43

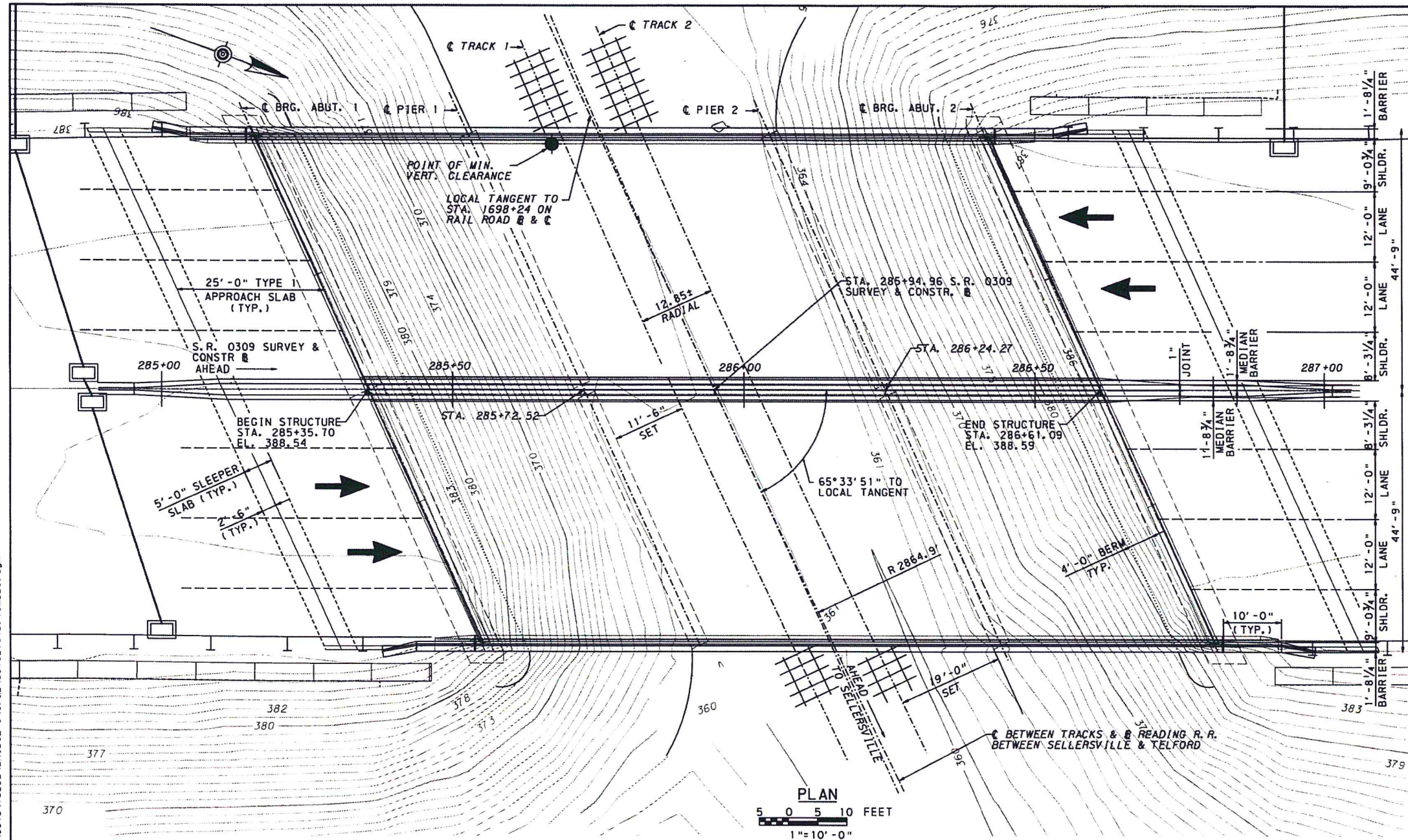

- ### SCOPE OF REHABILITATION
1. REMOVE EXISTING SUPERSTRUCTURE AND APPROACH SLABS.
  2. MODIFY PEDESTALS AND BEAM SEATS TO ACCOMMODATE NEW SUPERSTRUCTURE.
  3. REPAIR THE CONCRETE PIERS.
  4. CONSTRUCT NEW PRESTRESSED CONCRETE SPREAD BOX BEAM SUPERSTRUCTURE WITH COMPOSITE 8" DECK (INCLUDING 1/2" INTEGRAL WEARING SURFACE.) BARRIERS ON NEW SUPERSTRUCTURE WILL MEET CURRENT STANDARDS.
  5. CONSTRUCT NEW APPROACH SLABS.
  6. IMPROVE THE OFF-BRIDGE DRAINAGE. (ROADWAY ITEM)
  7. IMPROVE THE EXISTING APPROACH GUIDERAIL TO MEET THE CURRENT STANDARDS. (ROADWAY ITEM)

DESCRIPTION	DWG. NO.	DATE
TEMPORARY CONCRETE BARRIER, STRUCTURE MOUNTED	BC-719M	09-30-16
ELECTRICAL DETAILS	BC-721M	09-30-16
PERMANENT METAL DECK FORMS	BC-732M	09-30-16
ANCHOR SYSTEMS	BC-734M	08-04-17
WALL CONSTR. & EXP. JOINT DETAILS	BC-735M	09-30-16
REINFORCEMENT BAR FABRICATION DETAILS	BC-736M	09-30-16
BRIDGE BARRIER TO GUIDERAIL TRANSITION	BC-739M	08-04-17
CONCRETE DECK SLAB DETAILS	BC-752M	09-30-16
BEARINGS	BC-755M	09-30-16
PREFORMED NEOPRENE COMPRESSION SEAL JOINT FOR APPROACH SLABS	BC-766M	09-30-16
REINFORCED CONCRETE REPAIRS	BC-783M	09-30-16
TYPICAL WATERPROOFING AND EXPANSION DETAILS	BC-788M	09-30-16
GUIDE RAIL TRANSITION AT END OF STRUCTURE	RC-50M	08-04-17

### SUPPLEMENTAL DRAWINGS

### LEGEND

- DIRECTION OF TRAFFIC
- EXISTING MAJOR CONTOURS
- EXISTING MINOR CONTOURS
- POINT OF MINIMUM VERTICAL CLEARANCE
- EXPANSION BEARING
- FIXED BEARING

### NOTES

1. FOR TYPICAL SECTION AND STAGING SEQUENCE, SEE SHEET 7.
2. FOR GENERAL NOTES, SEE SHEET 2.

Mark	Description	By	Chk'd	Rec'd	Date
REVISIONS					

### VERTICAL CURVE DATA S.R. 0309

STATION	ELEVATION
284+75.00	388.05
285+00.00	388.31
285+25.00	388.50
285+50.00	388.59
285+75.00	388.64
286+00.00	388.67
286+25.00	388.66
286+50.00	388.62
286+75.00	388.56
287+00.00	388.38
287+25.00	388.19

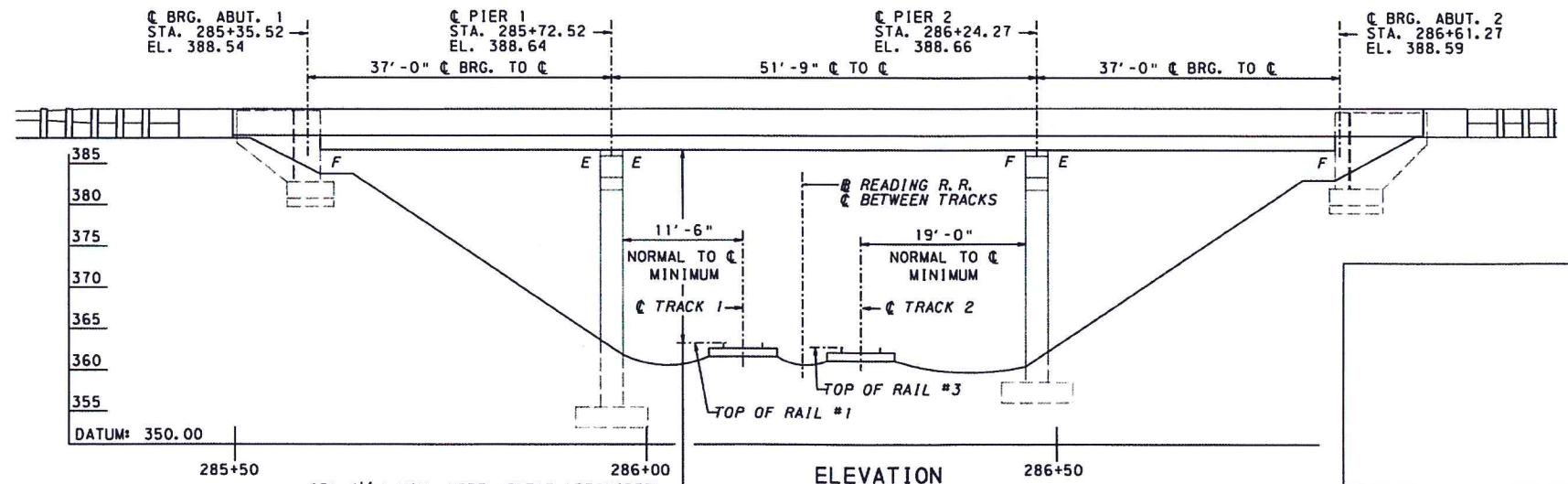

### ELEVATION

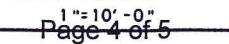

8/29/2018 P:\60236723 SR 309-PM1\000.CAD\008.Structure\1\Sheet\1\SL-2\BRIDGE 9\CPR\09102701D.10M.B9.dgn

DES: JJM CKD: GOB DWN: CMM CKD: TJM

**AECOM**  
1700 Market Street, Suite 1600  
Philadelphia, Pennsylvania 19103

**COMMONWEALTH OF PENNSYLVANIA**  
**DEPARTMENT OF TRANSPORTATION**  
**BUCKS COUNTY**  
**SR 0309 SECTION PM1**  
SEG. 0110 OFFSET 0000  
(SELLERSVILLE BYPASS), STA. 285+ 94.96  
OVER EAST PENN RAILROAD/SEPTA  
**3 SPAN COMPOSITE P/S CONC. BOX BEAM BRIDGE**  
**GENERAL PLAN & ELEVATION**

RECOMMENDED \_\_\_\_\_  
DISTRICT BRIDGE ENGINEER

SHEET 1 OF 41  
+ SUPPLEMENTAL DWGS.  
**S - 36849**

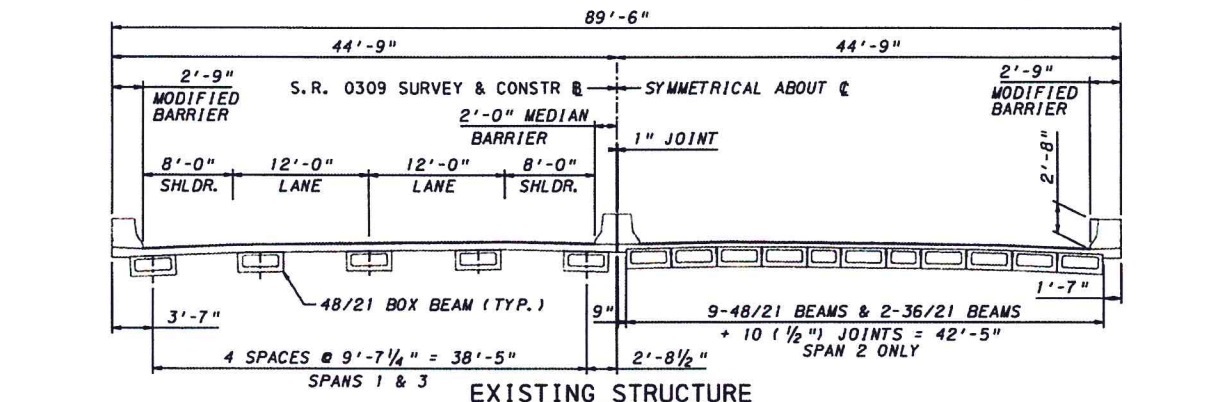

EXISTING STRUCTURE

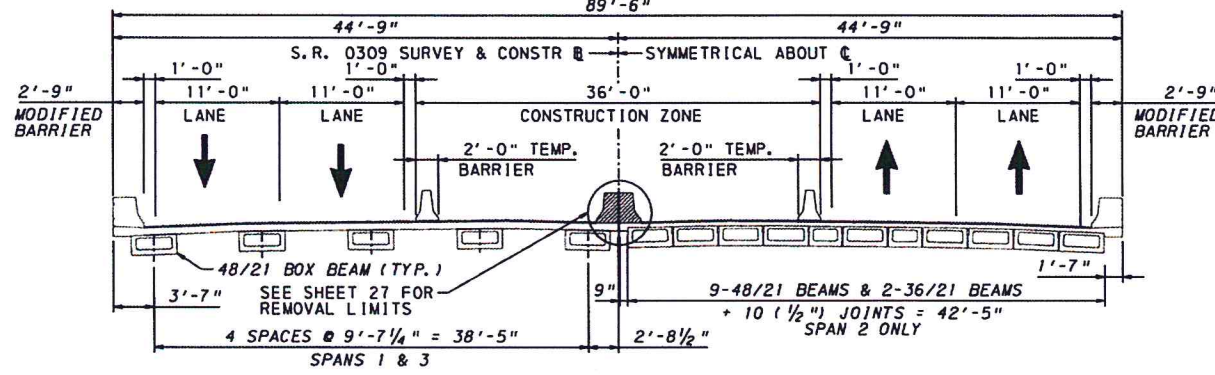
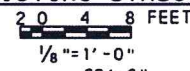

STAGE 2 PHASE 1B

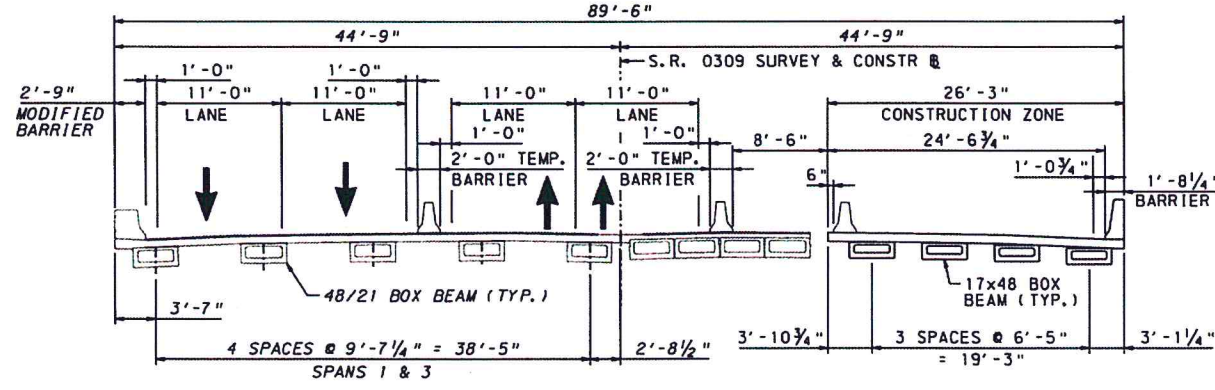
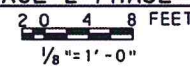

STAGE 2 PHASE 2

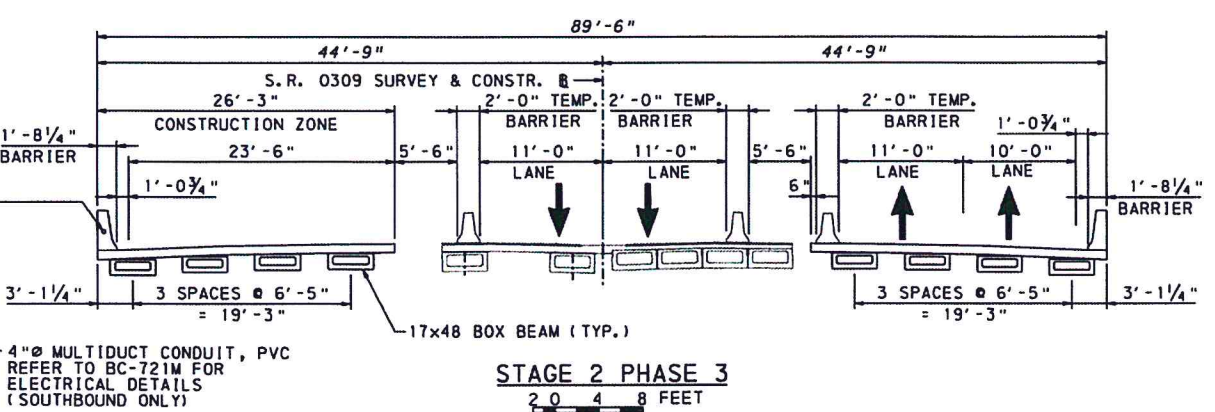
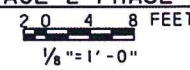

STAGE 2 PHASE 3

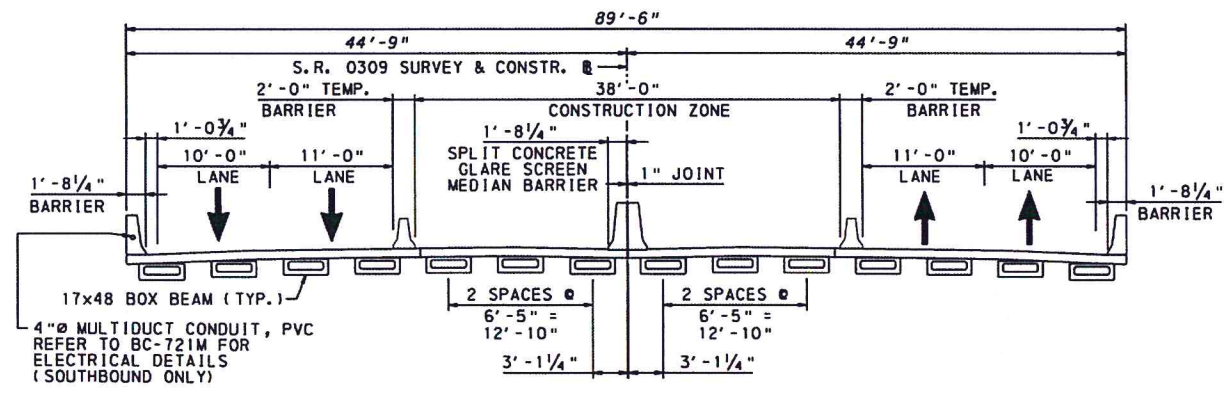
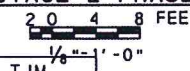

STAGE 2 PHASE 4

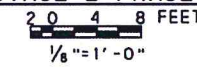

NOTES

1. DIMENSIONS ARE RADIAL, UNLESS OTHERWISE NOTED.
2. 2'-0" x 2'-8" TEMPORARY CONCRETE BARRIER, STRUCTURE MOUNTED, TO BE USED ON NEW AND EXISTING CONCRETE DECK. TEMPORARY BARRIER, STEEL, BARRIERSHIELD 800, MINIMUM DEFLECTION SYSTEM MAY ALSO BE USED ON EXISTING DECK, WHERE STAGED CONSTRUCTION WIDTH PERMITS. TEMPORARY CONCRETE BARRIER, STRUCTURE MOUNTED IS TO BE BOLTED TO EXISTING DECK FOR TYPE C INSTALLATION EXCEPT WHERE WIDTH OF DECK BEHIND BARRIER EXCEEDS 6'-0". REFER TO DRAWING BC-719M FOR ADDITIONAL TEMPORARY BARRIER DETAILS.
3. TEMPORARY STRUCTURE MOUNTED BARRIER IS A ROADWAY ITEM.

Mark	Description	By	Chk'd	Rec'd	Date
REVISIONS					

**COMMONWEALTH OF PENNSYLVANIA**  
**DEPARTMENT OF TRANSPORTATION**

**BUCKS COUNTY**  
**SR 0309 SECTION PM1**  
 SEG. 0110 OFFSET 0000  
 (SELLERSVILLE BYPASS), STA. 285+ 94.96  
 OVER EAST PENN RAILROAD/SEPTA  
**3 SPAN COMPOSITE P/S CONC. BOX BEAM BRIDGE**  
**STAGING SEQUENCE**

RECOMMENDED \_\_\_\_\_ SHEET 7 OF 41

**S - 36849**

**AECOM**  
 1700 Market Street, Suite 1600  
 Philadelphia, Pennsylvania 19103

8/29/2018 P:\60236723 SR 309-PM1\000\_CAD\008\_Structure\Sheets\SL-2\BRIDGE 9\GP&E\09102707D.10M.B9.dgn

DES: JJM CKD: GOB DWN: CMM CKD: TJM