

Susan Englehardt
PPL Electric Utilities
600 Larch Street
Scranton, PA 18509
sbenglehardt@pplweb.com

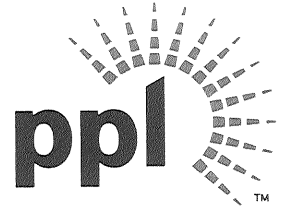

December 5, 2018

Ms. Rosemary Chiavetta, Secretary
Pennsylvania Public Utility Commission
PO Box 3265
Harrisburg, PA 17105

Dear Secretary Chiavetta:

Attached please find for filing under Section 507 of the Public Utility Code, Title 66, one scanned original of the right-of-way agreement, adopted October 29, 2018 by the Borough of Slatington and also accepted on October 29, 2018 by PPL Electric Utilities Corporation (PPL), wherein the Borough of Slatington grants PPL the right to construct, operate, and maintain its electric line facilities along property owned by the Borough of Slatington, located in the Borough of Slatington, County of Lehigh.

If you have any questions, please call Lee Birt, Right-of-Way Agent, at 484-634-3268.

Sincerely,

Susan B. Englehardt

Susan B. Englehardt

Enclosures

Prepared by: PPL Electric Utilities
Return to: PPL Electric Utilities
ROW Department
827 Hausman Road
Allentown, PA 18109-8838
Attn: Alfred L. Birt
484-634-3268

PARID: 556214240511 1

This instrument solely grants, vests
or confirms a public utility easement.

Form 4337 (8/2014)

W.O. Number:							
5	8	3	2	6	7	9	7



GRANT OF RIGHT-OF-WAY

KNOW ALL MEN BY THESE PRESENTS, That the **Borough of Slatington**, a corporation of Pennsylvania hereinafter called "GRANTOR", intending to be legally bound, does hereby for itself and its successors and assigns grant unto **PPL ELECTRIC UTILITIES CORPORATION ("PPL")**, its successors and assigns, the right to construct, reconstruct, operate and maintain its electric and communication facilities consisting of one (1) pole and overhead facilities as shown on the plan hereto attached and made a part hereof including such other wires, cables, fixtures and apparatus necessary for the convenient transaction of the business of PPL, upon, across, over, under and along the property identified as County Tax Parcel No. 556214240511 1 which the undersigned owns or has any interest located along Chestnut Street situate in the Borough of Slatington, County of Lehigh, Commonwealth of Pennsylvania; including the right of ingress and egress to and from the said lines for any of the aforesaid purposes; also the right to cut down any and all trees within twenty five (25) feet each side of centerline of the electric/communication line and the right to trim any and all trees within twenty five (25) feet each side of centerline of the electric/communication line and to remove brush along said lines which in the judgment of said PPL menace the said lines; and also the right to permit the attachment of wires and cables of any other person or company to said poles. Any poles or facilities erected hereunder along a highway, whether within or outside the highway limits, may be relocated to conform to new or relocated highway limits. PPL shall restore the property to substantially the same condition that the property was in prior to installation, maintenance or repair of the electric facilities.

A copy of this agreement and an acceptance hereof by PPL shall be filed by PPL with the Pennsylvania Public Utility Commission, and this agreement shall thereafter become effective in accordance with the provisions of the Public Utility Law.

IN WITNESS WHEREOF, Grantor has caused this agreement to be executed in its corporate name by its proper officers, this 29th day of October, 2018.

ATTEST:

Borough of Slatington
By:

[Signature]
Secretary

[Signature]
Name: Daniel L. Stevens
Title: President

COMMONWEALTH OF PENNSYLVANIA)
COUNTY OF Lehigh) : SS

On this 29 day of October, 2018 before me, the undersigned officer, personally appeared Daniel L. Stevens who acknowledged himself to be the President of the Borough of Slatington, a corporation, and that he as such President, being authorized to do so, executed the foregoing instrument for the purposes therein contained by signing the name of the corporation by himself as President.

IN WITNESS WHEREOF, I have hereunto set my hand and notarial seal.

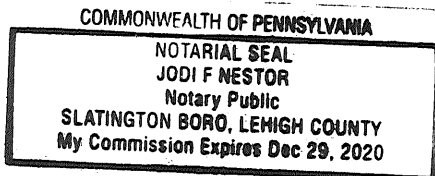

[Signature]
Notary Public

ACCEPTED AND CONDITIONS AGREED TO:

WITNESS:

PPL Electric Utilities Corporation
By:

[Signature]

[Signature]
Joseph George
Distribution ROW Supervisor

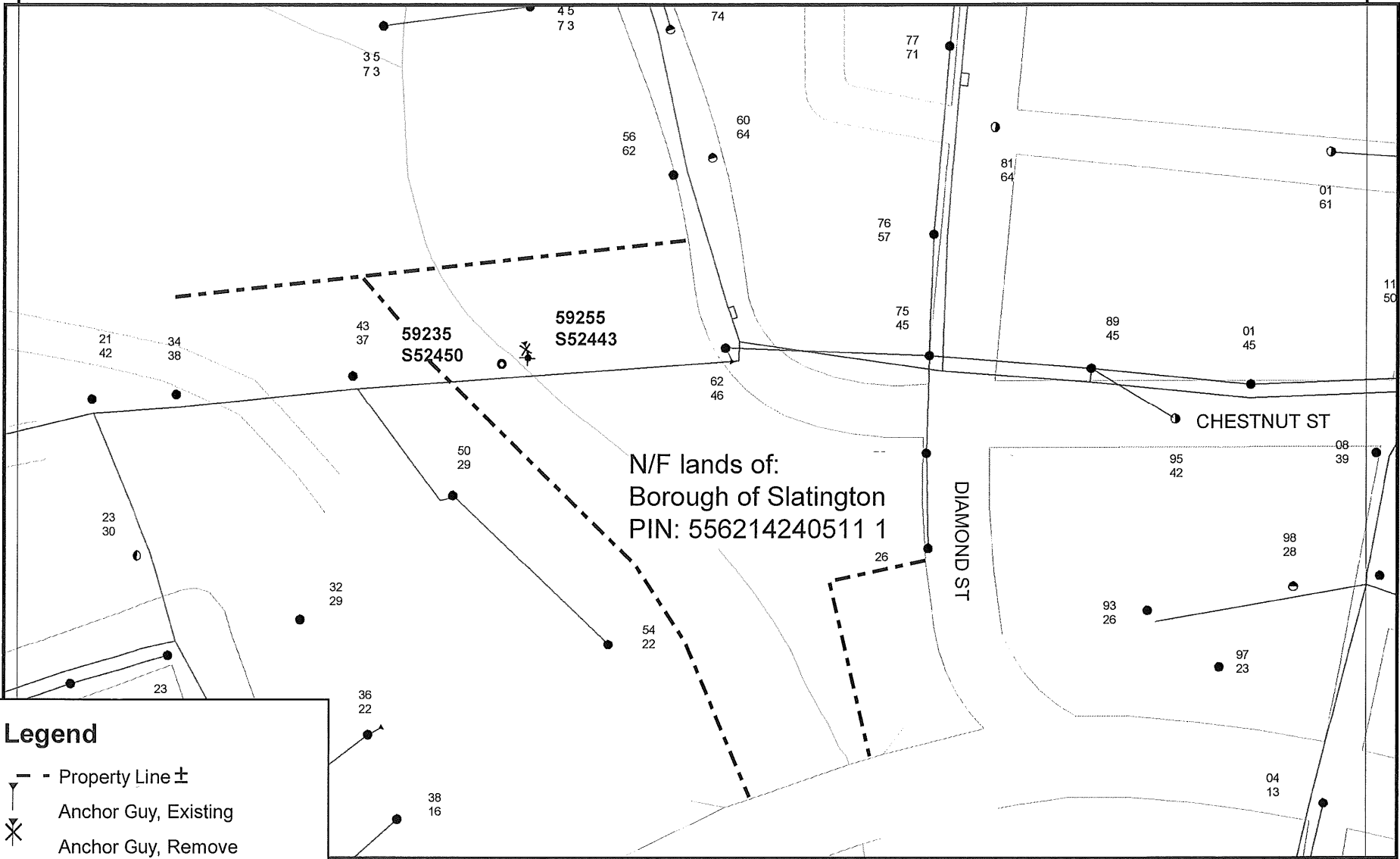

Legend

- Property Line ±
- Anchor Guy, Existing
- Anchor Guy, Remove
- Foreign Owned Pole, Existing
- Pole, Remove
- Pole, Proposed
- Pole, Existing
- Overhead Wires, Existing

Note:

For exact location of right-of-way and/or facilities within right-of-way, contact the local PPL Electric Utilities Corporation office.

Not for Construction

WO/Design: 58326797/98794	PLAN SHOWING FACILITIES ON PROPERTY OF:	
ER: 288112		
SR: N/A	SLATINGTON BORO	LEHIGH COUNTY
SCALE: None	PPL Electric Utilities Corporation ALLENTOWN, PENNA.	
DATE: 10/3/2018	APPROVAL:	DATE:
ENGR: Minahan, William H	SIGNATURE:	
	DWG. NO.:	59255S52443-R/W-00