



Emily M. Farah  
Counsel, Regulatory

411 Seventh Avenue  
Mail drop 15-7  
Pittsburgh, PA 15219

Tel: 412-393-6431  
efarah@duqlight.com

January 22, 2019

**VIA ELECTRONIC FILING**

Rosemary Chiavetta, Secretary  
Pennsylvania Public Utility Commission  
Commonwealth Keystone Building, 2<sup>nd</sup> Floor  
400 North Street  
Harrisburg, PA 17120

Re: Municipal Contract - Right of Way Agreement between Duquesne Light Company and  
the Municipal Authority of the Borough of Midland  
Docket No. U-2019-\_\_\_\_\_

Dear Secretary Chiavetta:

Enclosed for review and approval in accordance with Section 507 of the Public Utility Code, 66 Pa.C.S. § 507 and 52 Pa. Code § 3.101, is a Right of Way agreement dated January 14, 2019 between Duquesne Light Company and the Borough of Midland. The Borough of Midland granted to Duquesne Light Company a right of way on its property situated on Ohio Avenue in the Borough of Midland, Beaver County, which provides the right to erect, install, use, own, operate, maintain, repair, renew and remove an electrical line. Duquesne Light Company did not compensate Midland Borough for this easement.

Should you have any questions regarding the enclosed right of way, please contact Mark Hummel at 412-393-8622.

Respectfully Submitted,

A handwritten signature in blue ink, appearing to read "Emily M. Farah", is written over the typed name and attorney ID number.

Emily M. Farah  
Attorney ID#322559

Enclosures

ANCCORP. 2/01  
Job #

**RIGHT OF WAY AGREEMENT**

The undersigned Grantor, **Midland Borough**, a municipal corporation, for good and valuable consideration, the receipt of which is hereby acknowledged does hereby grant unto Duquesne Light Company, its successors and assigns, for providing, transmitting and/or distributing electric and/or communications services current for any and all purposes, the right, privilege and authority to install, use, own, operate, maintain, repair, renew and finally remove one (1) anchor, together with the guy wires and other apparatus thereto belonging, upon, over, under, along and across Grantors land, fronting on **Ohio Ave.**, situate in **Midland, Beaver County, Pennsylvania**, and shown on Duquesne Light Company Drawing No. **380654-T17**, a copy of which has been given to Grantor. Duquesne Light Company shall also have the following rights: to trim or remove any trees or shrubbery which, at any time or times, may interfere or threaten to interfere with the erection, installation, use, operation, maintenance, repair, renewal or removal of the electric line; to enter upon the land at any time for such purposes; to permit others to attach guys and related apparatus; and to sell, assign, lease or otherwise transfer any or all rights hereunder.

Utility shall file a copy of this Agreement with the Pennsylvania Public Utility Commission as required by Title 66, Section 507 of the Public Utility Code, and this Agreement shall become effective in accordance therewith.

Intending to be legally bound the Grantor has executed this agreement this 14 day of ~~September, 2018~~ January 2019

**Midland Borough**

ATTEST:

Peter J. Quinn, Esq.

By: Peter J. Quinn, Esq.

COMMONWEALTH OF PENNSYLVANIA

SS:

COUNTY OF Beaver

On this 14 day of January, ~~2018~~ <sup>2019</sup>, before me, a Notary Public in and for the Commonwealth and County, personally appeared Peter J. Quinn, Esq., Council President Midland Borough, a municipal corporation, and as such Peter Quinn, being authorized to do so, executed the foregoing instrument for the purposes therein contained.

WITNESS my hand and seal the day and year aforesaid.

Commonwealth of Pennsylvania  
County of Beaver

Lori A. Hudson  
Notary Public

Sworn to and subscribed before me  
this 14 day of January, 2019

COMMONWEALTH OF PENNSYLVANIA  
NOTARIAL SEAL  
Lori A. Hudson, Notary Public  
Midland Boro, Beaver County  
My Commission Expires Oct. 21, 2020  
MEMBER, PENNSYLVANIA ASSOCIATION OF NOTARIES

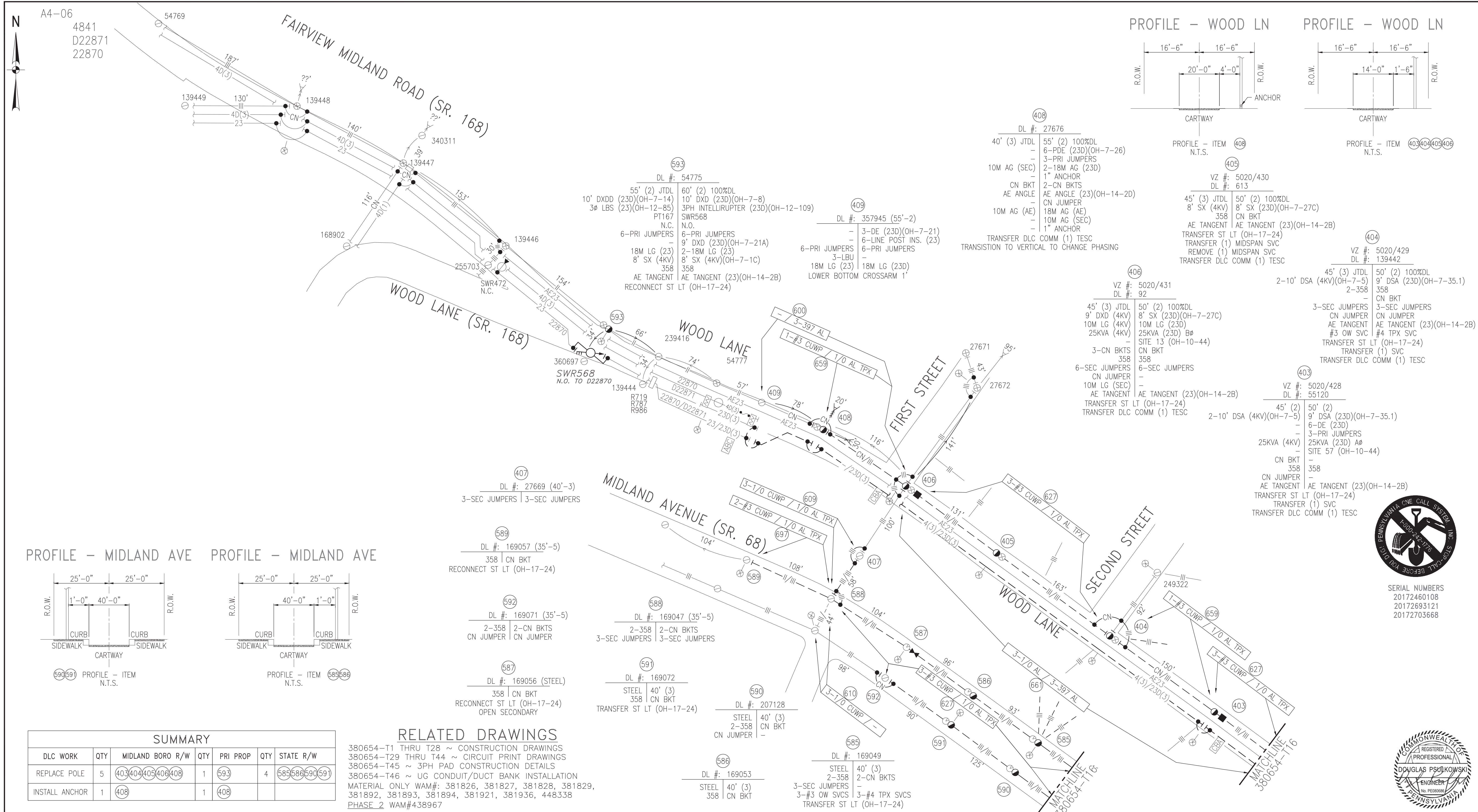

PROFILE - WOOD LN PROFILE - WOOD LN

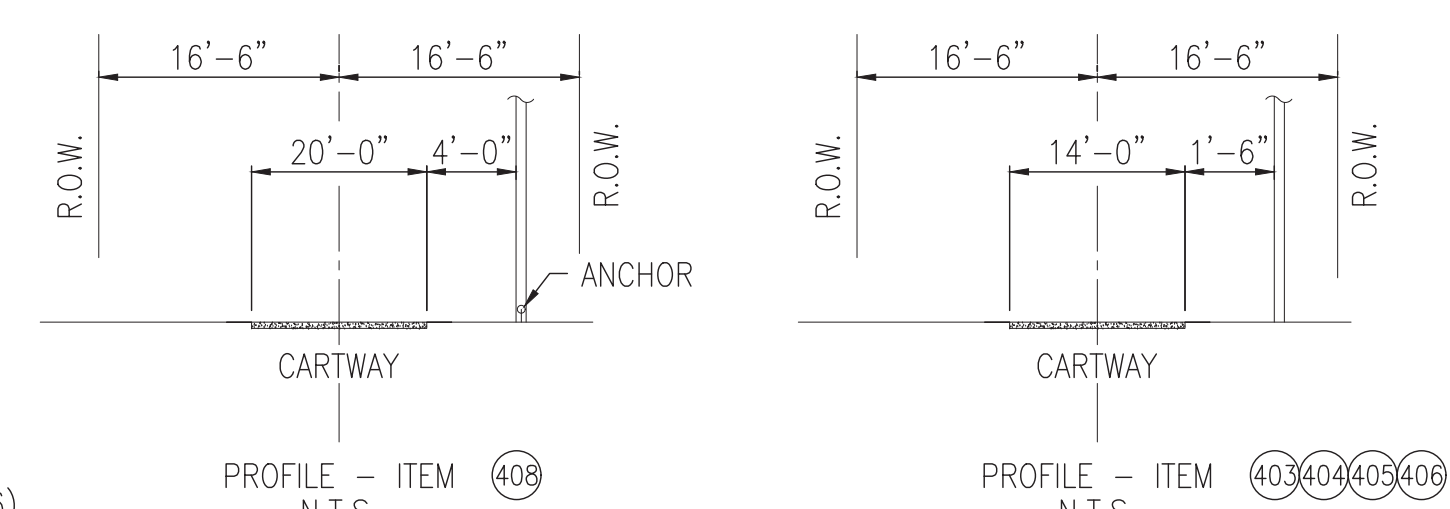

- DL #: 27676  
40' (3) JTDL 55' (2) 100%DL  
6-PDE (23D)(OH-7-26)  
3-PRI JUMPERS  
10M AG (SEC) 2-18M AG (23D)  
1" ANCHOR  
CN BKT 2-CN BKTS  
AE ANGLE AE ANGLE (23)(OH-14-2D)  
CN JUMPER  
10M AG (AE) 18M AG (AE)  
10M AG (SEC) 1" ANCHOR  
TRANSFER DLC COMM (1) TESC  
TRANSITION TO VERTICAL TO CHANGE PHASING
- VZ #: 5020/430  
DL #: 613  
45' (3) JTDL 50' (2) 100%DL  
8' SX (4KV) 8' SX (23D)(OH-7-27C)  
CN BKT 358 CN BKT  
AE TANGENT AE TANGENT (23)(OH-14-2B)  
TRANSFER ST LT (OH-17-24)  
TRANSFER (1) MIDSPAN SVC  
REMOVE (1) MIDSPAN SVC  
TRANSFER DLC COMM (1) TESC
- VZ #: 5020/429  
DL #: 139442  
45' (3) JTDL 50' (2) 100%DL  
2-10' DSA (4KV)(OH-7-5) 9' DSA (23D)(OH-7-35.1)  
358  
CN BKT  
3-SEC JUMPERS 3-SEC JUMPERS  
CN JUMPER CN JUMPER  
AE TANGENT AE TANGENT (23)(OH-14-2B)  
#3 OW SVC #4 TPX SVC  
TRANSFER ST LT (OH-17-24)  
TRANSFER (1) SVC  
TRANSFER DLC COMM (1) TESC
- VZ #: 5020/431  
DL #: 92  
45' (3) JTDL 50' (2) 100%DL  
9' DXD (4KV) 8' SX (23D)(OH-7-27C)  
10M LG (4KV) 10M LG (23D)  
25KVA (4KV) 25KVA (23D) B#  
SITE 13 (OH-10-44)  
CN BKT  
3-CN BKTS  
358  
6-SEC JUMPERS 6-SEC JUMPERS  
CN JUMPER  
10M LG (SEC) AE TANGENT (23)(OH-14-2B)  
TRANSFER ST LT (OH-17-24)  
TRANSFER DLC COMM (1) TESC
- VZ #: 5020/428  
DL #: 55120  
45' (2) 50' (2)  
9' DSA (4KV)(OH-7-5) 9' DSA (23D)(OH-7-35.1)  
6-DE (23D)  
3-PRI JUMPERS  
25KVA (4KV) 25KVA (23D) A#  
SITE 57 (OH-10-44)  
CN BKT  
358  
CN JUMPER  
AE TANGENT AE TANGENT (23)(OH-14-2B)  
TRANSFER ST LT (OH-17-24)  
TRANSFER (1) SVC  
TRANSFER DLC COMM (1) TESC

PROFILE - MIDLAND AVE PROFILE - MIDLAND AVE

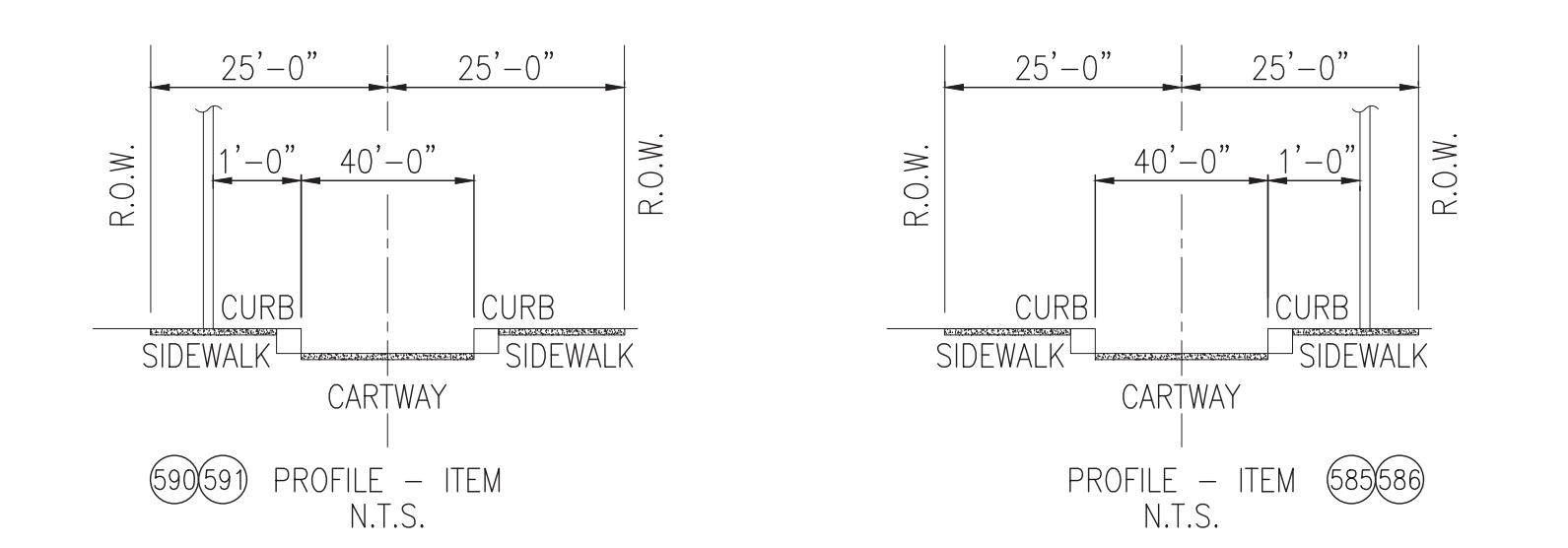

- DL #: 27669 (40'-3)  
3-SEC JUMPERS | 3-SEC JUMPERS
- DL #: 169057 (35'-5)  
358 | CN BKT  
RECONNECT ST LT (OH-17-24)
- DL #: 169071 (35'-5)  
2-358 2-CN BKTS  
CN JUMPER CN JUMPER
- DL #: 169056 (STEEL)  
358 | CN BKT  
RECONNECT ST LT (OH-17-24)  
OPEN SECONDARY
- DL #: 169047 (35'-5)  
2-358 2-CN BKTS  
3-SEC JUMPERS 3-SEC JUMPERS
- DL #: 169072  
STEEL 40' (3)  
358 | CN BKT  
TRANSFER ST LT (OH-17-24)
- DL #: 207128  
STEEL 40' (3)  
2-358 CN BKT  
CN JUMPER -
- DL #: 169049  
STEEL 40' (3)  
2-358  
3-SEC JUMPERS 3-#3 OW SVCS  
3-#4 TPX SVCS  
TRANSFER ST LT (OH-17-24)
- DL #: 169053  
STEEL 40' (3)  
358 | CN BKT

SUMMARY						
DLC WORK	QTY	MIDLAND BORO R/W	QTY	PRI PROP	QTY	STATE R/W
REPLACE POLE	5	403 404 405 406 408	1	593	4	585 586 590 591
INSTALL ANCHOR	1	408	1	408		

RELATED DRAWINGS

380654-T1 THRU T28 ~ CONSTRUCTION DRAWINGS  
 380654-T29 THRU T44 ~ CIRCUIT PRINT DRAWINGS  
 380654-T45 ~ 3PH PAD CONSTRUCTION DETAILS  
 380654-T46 ~ UG CONDUIT/DUCT BANK INSTALLATION  
 MATERIAL ONLY WAM#: 381826, 381827, 381828, 381829,  
 381892, 381893, 381894, 381921, 381936, 448338  
 PHASE 2 WAM#438967



SERIAL NUMBERS  
 20172460108  
 20172693121  
 20172703668



REVISIONS

1	2017 H&M DESIGN	DTJ	HMI
	REFRESH		
	CORRECTIONS		

DTJ	BMR	HMI	HMI	11/03/17
-----	-----	-----	-----	----------

AM SERVICES TECHNICAL SOLUTIONS  
 3 VALLEY SQUARE  
 512 TOWNSHIP LINE RD, SUITE 200  
 BLUE BELL, PA 19422

PROJECT#: DL2845-1001

SCALE: 1"=50'

DATE COMPILED: 7/8/11

DESIGNED BY: BMR  
 DRAWN BY: BMR  
 ENGR. CHECKED: DAF

ARCH. APP.  
 ELECT. APP.  
 MECH. APP.  
 CIVIL APP.

FINAL APPR FOR ISSUE

DLC DUQUESNE LIGHT CO.

SYSTEM IMPROVEMENT  
 MIDLAND SUBSTATION - 4KV CONVERSIONS  
 OVERHEAD CONSTRUCTION

WOOD MIDLAND BORO

OFF NO. STA NO. DWG. NO. A 380654-T17