



# CITY OF PITTSBURGH

## Department of Public Works

*Luke Ravenstahl, Mayor*

*Robert W. Kaczorowski, Director*

October 5, 2010

PA PUBLIC UTILITY COMMISSION

OCT 12 2010

BUREAU OF TRANSPORTATION & SAFETY  
RAIL SAFETY DIVISION

Pennsylvania Public Utility Commission  
P.O. Box 3265  
Harrisburg, PA 17105-3265

Attention: Mr. David Fischer  
Rail Safety Division

**RE: North Avenue/Brighton Road Bridge  
Application Docket No. A-00119379  
BTE Project No. 99205**

Dear Commissioners:

Per Paragraphs 4 and 5 of the Order, entered August 21, 2006, we are submitting Construction Plans and the Engineer's Estimate for the repairs of the above referenced bridge, for your review and approval. The plans are 95% complete but we do not anticipate any revisions. If approved, we will coordinate the work over the tracks with the Norfolk Southern Corporation and schedule the work for spring of 2011, pending availability of funds. The roadway work will be scheduled for the summer during school recess to minimize the impact on school buses. All repairs to the bridge will maintain the current vertical clearance over the tracks.

With a copy of this letter, we are transmitting via email the plans and estimate to Norfolk Southern Corporation and other utilities for their review, comments and approval.

If you have any question regarding this matter, please contact Mr. Chuck McClain, P.E., Project Manager, of the Bridges and Structures Division, at 412-255-2034, or email at [charles.mcclain@city.pittsburgh.pa.us](mailto:charles.mcclain@city.pittsburgh.pa.us).

Very truly yours,

Patrick Hassett  
Assistant Director

RWK/PH/CM/tltp

Attachment (all)

cc: Thomas M. Bracey, Norfolk Southern Corporation/William Armstrong, WEC Engineers Inc./  
Gary O'Melia, WEC Engineers, Inc./Utilities-Sean Koziak, Equitable Gas Co./  
Jim Runatz, Duquesne Light Co./Matt Hill, Level 3 Communications/Tony Brownlee, Verizon PA./  
Ford McLean, AT&T/Jerry Freeman/Comcast/Larry Odille, PWSA/Anthony Teti, PWSA/  
Bill Macaulay, Qwest Communications/Lorraine Mackler, Law Dept./Chuck McClain/  
Mark Stem/File

**HEADQUARTERS**  
Room 301 City-County Building  
414 Grant Street Pittsburgh, PA 15219  
412-255-8850 Fax: 412-255-8847

**BUREAU OF TRANSPORTATION AND  
ENGINEERING**  
Room 301 City-County Building  
414 Grant Street Pittsburgh, PA 15219  
412-255-8850 Fax: 412-255-8847

**BUREAU OF OPERATIONS**  
611 Second Avenue  
Pittsburgh, PA 15219  
412-255-2790 Fax: 412-255-8981

**BUREAU OF ENVIRONMENTAL  
SERVICES**  
3001 Railroad Street  
Pittsburgh, PA 15201  
412-255-2773 Fax: 412-255-2452  
[www.city.pittsburgh.pa.us](http://www.city.pittsburgh.pa.us)



**REHABILITATION OF NORTH AVENUE BRIDGE  
CITY OF PITTSBURGH, ALLEGHENY COUNTY**

**UTILITY COORDINATION MEETING  
Wednesday, October 7, 2009 at 10:00 am**

**MEETING MINUTES**

**ATTENDEES: YES**

<b><u>NAME &amp; E-MAIL</u></b>	<b><u>ATTENDED</u></b>	<b><u>AFFLIATION</u></b>	<b><u>ADDRESS &amp; TELEPHONE</u></b>
Bill Armstrong / Gary O'Melia warmstrong@ wecengineers.com	Yes	WEC Engineers, Inc	1370 Washington Pike Suite 304 Bridgeville, PA 15017 Tel. (412)-257-8774
Chuck McClain Charles.McClain@ city.pittsburgh.pa.us	Yes	City of Pittsburgh	Room 301, City-County Office Building 414 Grant St. Pittsburgh, PA 15219 Tel 412-255-2034
Sean Koziaklec / skoziaklec@eqt.com	Yes	Equitable Gas Co.	200 Allegheny Center Mall Pittsburgh, PA 15212-5352 Tel 412-395-3642
Jim Runatz jrunatz@duqlight.com	Yes	Duquesne Light Co.	2825 New Beaver Ave. & Woods Run, BLDG. N6-CS Pittsburgh, PA 15233 Tel 412-393-7813
Matt Hill Matt.hill@level3.com	Yes	Level 3 Communications	200 Technology Drive Pittsburgh, PA 15219 Tel 412-728-6495
Tony Brownlee j.a.brownlee.jr@verizon.com	No	Verizon Pennsylvania, Inc.	201 Stanwix St. 4 <sup>th</sup> Fl. Pittsburgh, PA 15222 Tel 412-633-8080
Ford McLean ←→ fmclean@att.com	Yes	AT&T	Michael Baker Jr., Inc. 4301 Dutch Ridge Road Beaver, PA 15009-0280 Tel 412-979-4455 / 724-495-4038
Dennis Morgan dmorgan@mbakercorp.com	No		
Jerry Freeman jerome_freeman@ cable.comcast.com	Yes	Comcast Cable Communications Inc.	300 Corliss Street. Pittsburgh, PA 15220 Tel 412-875-1327

Larry Odille /  
Anthony Teti  
ateti@pgh2o.com

Yes Pittsburgh Water & Sewer  
No Authority

Penn Liberty Plaza 1  
1200 PENN Avenue 2<sup>nd</sup> FL.  
Pittsburgh, PA 15222-4204  
Tel 412-255-8938 / or 8941

Bill Macaulay  
william.macaulay@qwest.com

Yes Qwest Communications

300 Leetsdale Industrial Drive  
Leetsdale, PA 15056  
Tel 412-999-0726

An initial utility coordination meeting at the site was conducted on Wednesday October 7, 2009 at 10:00 a.m. to discuss utility involvement of affected utilities to accommodate the bridge rehabilitation project. The following transpired at this meeting:

1. Mr. Armstrong provided a general overview of the project. It was reiterated that this project involves the replacement of the bridge sidewalks and replacement of the asphalt roadway carrying North Avenue and Brighton Road Over Norfolk and Southern railroad.
2. Jim Runatz of Duquesne light Co stated that the Duquesne light has overhead lines adjacent to bridge, and that any work near this line will require a minimum 10' clearance away from the line. Duquesne light also has a duct crossing between beams 29 and 30.
3. AT&T, Level 3 Communications and Verizon Pennsylvania, Inc. has lines which are underneath the sidewalk and road along in the abutment.
4. The Pittsburgh Water & Sewer Authority has lines, which are underneath the sidewalk and road. WEC has received plans, which show the location and approximate depth of the water lines. From the plans and the marked locations in the field the water lines appear to be unaffected by the project.
5. Equitable Gas Co. has lines underneath the bridge. WEC has received plans, which show the location and approximate depth of the gas line. The gas line valve box appears to be unaffected
6. Duquesne light Company, Qwest Communications, NRG Energy Center, Comcast, Elantic Networks, Inc. and Community College of Allegheny Co. are out of the construction zone and are not affected.

**Minutes Prepared By:** William A. Armstrong, P.E.  
Project Engineer  
WEC Engineers, Inc

Cc: Attendees

S. Koziaklec, Equitable Gas Co

C. McLain, City of Pittsburgh

J. Runatz, Duquesne Light Co.

F. McLean, AT&T

M. Hill, Level 3 Communications

J. Freman, Comcast Cable Communications Inc.

L. Odille, Pittsburgh Water & Sewer Authority

B. Macaulay, Qwest Communications

Estimate = \$731,688.00

# COST ESTIMATE

DISTRICT: 11-0 PROJECT NO:

COUNTY: ALLEGHENY

S.R.: T000

SEC: A01

SHEET 1 OF 1

Item No.	Alt Description	Quantities	Unit	Unit Cost	Total Cost
44090574	SUPERPAVE ASPHALT MIXTURE DESIGN, HMA WEARING COURSE, PG 64-22, 3 TO < 10 MILLION ESALS, 9.5 MM MIX, 1" DEPTH, SRL-M MODIFIED MODIFIED	1475	SY	\$8.00	\$11,800.00
44096540	SUPERPAVE ASPHALT MIXTURE DESIGN, HMA BINDER COURSE, PG 64-22, 3 TO < 10 MILLION ESALS, 19.0 MM MIX, 2" DEPTH MODIFIED MODIFIED	1475	SY	\$17.00	\$25,075.00
04600001	BITUMINOUS TACK COAT	2949	SY	\$1.50	\$4,423.50
04920030	PROFILE MILLING, MILLED MATERIAL RETAINED BY CONTRACTOR	2336	SY	\$13.00	\$30,368.00
06270001	TEMPORARY CONCRETE BARRIER	330	LF	\$30.00	\$9,900.00
06280001	RESET TEMPORARY CONCRETE BARRIER	260	LF	\$8.00	\$2,080.00
09010001	MAINTENANCE AND PROTECTION OF TRAFFIC DURING CONSTRUCTION	1	LS	\$10,000.00	\$10,000.00
09010042	REMOVE TUBULAR MARKERS	10	EACH	\$24.00	\$240.00
09010044	TUBULAR MARKERS	10	EACH	\$50.00	\$500.00
09010046	REPLACE TUBULAR MARKERS - POST ONLY	10	EACH	\$45.00	\$450.00
09010203	ARROW PANEL	2	EACH	\$3,000.00	\$6,000.00
09010231	ADDITIONAL WARNING LIGHTS, TYPE B	120	DAY	\$2.50	\$300.00
09010232	ADDITIONAL WARNING LIGHTS, TYPE C	290	DAY	\$1.75	\$507.50
09010240	ADDITIONAL TRAFFIC CONTROL SIGNS	50	SF	\$12.50	\$625.00
09621001	6" WHITE WATERBORNE PAVEMENT MARKINGS	50	LF	\$3.00	\$150.00
09621003	12" WHITE WATERBORNE PAVEMENT MARKINGS	570	LF	\$2.00	\$1,140.00
09621004	24" WHITE WATERBORNE PAVEMENT MARKINGS	88	LF	\$10.00	\$880.00
09621005	4" YELLOW WATERBORNE PAVEMENT MARKINGS	524	LF	\$1.50	\$786.00
09630001	PAVEMENT MARKING REMOVAL	1200	SF	\$2.00	\$2,400.00
09710001	REMOVE POST MOUNTED SIGNS, TYPE B	4	EACH	\$100.00	\$400.00
09750001	REMOVE POST MOUNTED SIGNS, TYPE F	8	EACH	\$50.00	\$400.00
10180050	REMOVAL OF PORTION OF EXISTING BRIDGE	1	LS	\$50,000.00	\$50,000.00
80200001	NORTH AVENUE BRIDGE REHABILITATION	1	LS	\$437,263.00	\$437,263.00
90000001	HEAT STRAIGHTEN NORTH GIRDER	1	LS	\$40,000.00	\$40,000.00
90000002	LATEX MODIFIED CONCRETE WEARING SURFACE	50	CY	\$1,200.00	\$60,000.00
90000003	RAILROAD FLAGMAN	20	DAYS	\$750.00	\$15,000.00
90000004	BARRIER	1	LS	\$5,000.00	\$5,000.00
95130001	JOINT REHABILITATION	1	PDA	\$5,000.00	\$5,000.00
96060150	GRADE ADJUSTMENT OF UTILITIES	10	EACH	\$1,100.00	\$11,000.00
<b>GRAND TOTAL =</b>					<b>\$731,688.00</b>

A-00114377

# RESURFACING & SIDEWALK REPLACEMENT OF THE NORTH AVENUE & BRIGHTON ROAD BRIDGE OVER THE NORFOLK & SOUTHERN RAILROAD DEC PROJECT No.

PA PUBLIC UTILITY COMMISSION

OCT 12 2010

BUREAU OF TRANSPORTATION & SAFETY  
 RAIL SAFETY DIVISION

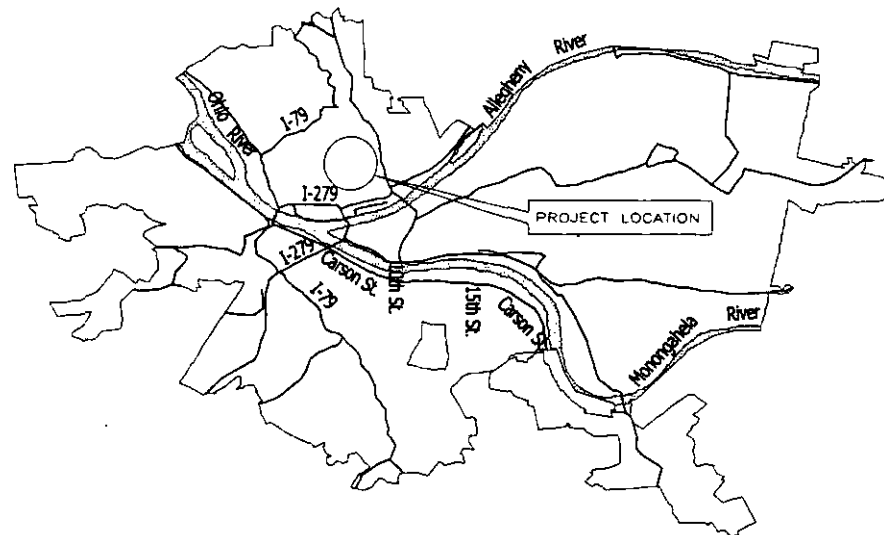

LOCATION PLAN

INDEX OF STRUCTURE DRAWINGS	
TITLE	SHEET NO.
TITLE SHEET	1
UTILITIES & STANDARD DRAWINGS	2
GENERAL NOTES & TYPICAL SECTION	3
SUMMARY SHEET	4
TABULATION SHEET	5
ROADWAY PLAN	6
ROADWAY PROFILE	7
DETOUR PLAN	8-13
SIGNING AND PAVEMENT MARKING PLAN	14
BRIDGE PLANS	15-24

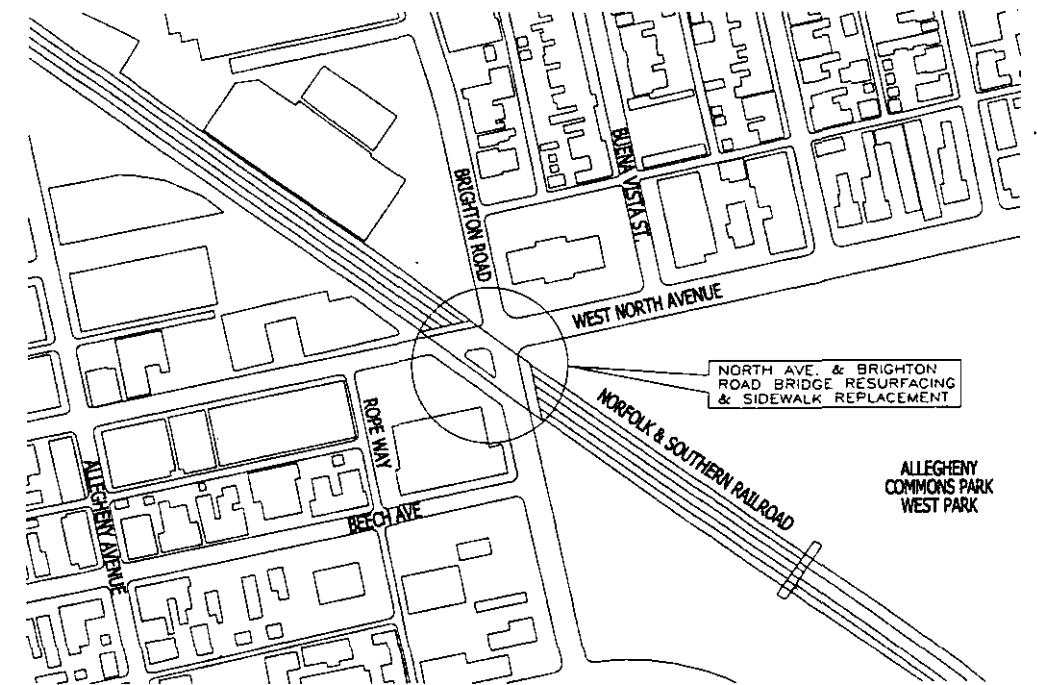

VICINITY MAP

L:\2009-Jobs\City of Pitt - North Ave\COVER.dgn

FIELD DATA	DRAWN	SUPERVISED
BY	MPS	WAA
CHECKED	INSPECTED	END-CONST.

REVISIONS

CHARACTER	DATE

C.A. \_\_\_\_\_ WORK

RES. NO. \_\_\_\_\_ APPROVED \_\_\_\_\_

APPROVAL \_\_\_\_\_ DATE \_\_\_\_\_

BRIDGE & MISC. STRUCTURES PLAN \_\_\_\_\_

STREETS & TRAFFIC DIVISION \_\_\_\_\_

APPROVAL \_\_\_\_\_ DATE \_\_\_\_\_

ASSISTANT DIRECTOR ENG. \_\_\_\_\_

DIRECTOR \_\_\_\_\_

SCALES AS NOTED SHEET NO. \_\_\_\_\_

DATE FEBRUARY 8, 2010 1 OF 22 CASE NO. \_\_\_\_\_



**UTILITIES:**

PA ONE CALL SERIAL NO. 20092101057  
PHONE: 1-800-242-1776

**AT&T**

MICHAEL BAKER JR. INC.  
4301 DUTCH RIDGE ROAD  
BEAVER, PA 15009-0280  
ATTENTION: DENNIS MORGAN/ FORD MCLEAN  
PHONE: 724-495-4038/412-979-4455  
EMAIL: dmorgan@mbakercorp.com/fmclean@att.com

**VERIZON OF PA**

201 STANWIX ST. 4th FLOOR  
PITTSBURGH, PA 15222  
ATTENTION: CHUCK BROWNING  
PHONE: 412-633-5005  
EMAIL: charles.r.browning@verizon.com

**PITTSBURGH WATER & SEWER AUTHORITY**

PENN LIBERTY PLAZA 1  
1200 PENN AVENUE 2nd FL.  
PITTSBURGH, PA 15222-4204  
ATTENTION: ANTHONY TETI (CONSTRUCTION) / LARRY ODILLE  
PHONE: 412-255-8800 X8941/ X 8938  
EMAIL: dwaldorf@ateti@pgh2a.com

**COMMUNITY COLLEGE OF ALLEGHENY COUNTY**

FACILITY MANAGEMENT DIV.  
800 ALLEGHENY AVE.  
PITTSBURGH, PA 15233-1895  
ATTENTION: ROBERT F. BRIECK  
PHONE: 412-237-3180  
EMAIL: rbriECK@cccac.edu

**DUQUESNE LIGHT COMPANY**

2825 NEW BEAVER AVENUE  
MAIL DROP N6-CS  
PITTSBURGH, PA 15233  
ATTENTION JIM RUNATZ  
PHONE: 412-393-7813 OR X1770  
EMAIL: jrunatz@duqlight.COM

**ELANTIC NETWORKS, INC. INTELLIFIBER**

SUITE 108  
ALLEGHENY CENTER MALL  
PITTSBURGH, PA 15212  
ATTENTION: ERIC PATTON  
PHONE: 412-370-6786  
EMAIL: epatton@intellifiber.com

**COMCAST CABLE COMMUNICATIONS INC.**

300 CORLISS STREET  
PITTSBURGH, PA 15220  
ATTENTION: JERRY FREEMAN  
PHONE: 412-875-1327  
EMAIL: jerome.freeman@cable.comcast.com

**EQUITABLE GAS COMPANY**

200 ALLEGHENY CENTER MALL  
PITTSBURGH, PA 15212-5352  
ATTENTION: SEAN KOZIEKLEC (CONSTRUCTION)  
PHONE: 412-395-3642  
EMAIL: skozieklec@eqt.com

**NRG ENERGY CENTER PITTSBURGH LLC**

111 S COMMONS  
PITTSBURGH, PA 15212  
ATTENTION: BRYAN SARTI  
PHONE: 412-320-2419  
MAIN NO.: 412-231-0409  
EMAIL: bryan.sarti@nrgenergy.com

**LEVEL 3 COMMUNICATIONS LLC**

200 TECHNOLOGY DRIVE  
PITTSBURGH, PA 15219  
ATTENTION: MATT HILL  
PHONE: 412-728-6495  
MAIN NO.: 1-800-441-0223  
EMAIL: matt.hill@level3.com

**QWEST COMMUNICATIONS**

300 LETTSDALE INDUSTRIAL DRIVE  
LETTSDALE, PA 15056  
ATTENTION: BILL MACAULAY  
PHONE: 412-999-0726  
EMAIL: william.macauly@qwest.com

**NORFOLK SOUTHERN RAIL ROAD**

425 HOLIDAY DRIVE  
PITTSBURGH, PA 15220  
ATTENTION: LARRY SOSNOWSKI  
PHONE: 412-893-7051  
EMAIL: LAWRENCE.SOSNOWSKI@NSCORP.COM  
BRIDGE NAME: PC1.60

DETAILS, OTHER THAN INDICATED, ARE ON THE FOLLOWING STANDARD DRAWINGS:

CONCRETE PAVEMENT JOINT	RC-20M	03-30-06
CONCRETE PAVEMENT RELIEF JOINT	RC-26M	03-30-06
OVERLAY TRANSITIONS AND PAVING NOTCHES	RC-28M	08-29-08
PAVEMENT MARKINGS (EXPRESSWAY/ FREEWAY, CONVENTIONAL, LEGENDS & SYMBOLS)	TC-8600	06-23-09
SPACING CHARTS, DIRECT APPLIED LETTERS, NUMERALS & ARROWS	TC-8700C	06-23-09
SIGN DETAILS/ FREEWAY & EXPRESSWAY GUIDE SIGNS	TC-8701D	03-18-07
SIGN DETAILS/ FREEWAY & EXPRESSWAY GUIDE SIGNS	TC-8716	06-23-09
SIGN DETAILS/ FREEWAY & EXPRESSWAY GUIDE SIGNS	TC-8717	06-23-09
DESCRIPTION	DWG. NO.	REC'D DATE

SUPPLEMENTAL DRAWINGS

Mark	Description	By	Chk'd	Rec'd	Date
REVISIONS					

**CITY OF PITTSBURGH**  
DEPARTMENT OF PUBLIC WORKS

**CONSTRUCTION DRAWING**  
**RETROFIT OF THE**  
**NORTH AVE BRIDGE**  
**over THE NORFOLK & SOUTHERN R.R.**  
**UTILITIES & STANDARD DRAWINGS**

SCALE AS NOTED	SHEET NO. 2 OF 24	ACCESSION NO. A-5689
DATE 2/8/10		CASE NO. -----

L:\2009-Jobs\City of Pitt - North Ave\sheet 2.dgn

**GENERAL NOTES**

MATERIAL AND WORKMANSHIP: IN ACCORDANCE WITH THE PENNSYLVANIA DEPARTMENT OF TRANSPORTATION PUBLICATION 408, DATED 2007, OR LATEST REVISIONS (INCLUDING CHANGES AND THE SPECIAL PROVISIONS).

UTILITIES, PIPES, CONDUITS AND OTHER UNDERGROUND STRUCTURES ARE PLOTTED ON PLANS FROM AVAILABLE RECORDS AND ARE NOT GUARANTEED BY THE CITY TO BE EITHER CORRECT OR COMPLETE. DETERMINE THE EXACT LOCATION BEFORE STARTING CONSTRUCTION.

PRIOR TO ANY EXCAVATION OR WORK ON THIS PROJECT THE CONTRACTOR MUST CONTACT PENNSYLVANIA ONE CALL (1-800-242-1776) AND COMPLY WITH THIS PROVISIONS OF ACT 38 OF 1991.

PROTECT EXISTING UTILITIES IN CONSTRUCTION AREA.

THE KNOWN UTILITIES LOCATED IN THE CONSTRUCTION AREA ARE LISTED ON THIS SHEET.

VERIFY IN THE FIELD ALL ELEVATIONS AND DIMENSIONS.

STATIONS SHOWN ON PLAN ARE CONSTRUCTION STATIONS UNLESS OTHERWISE NOTED. THE DIRECTOR RESERVES THE RIGHT TO ADD OR DELETE ITEMS IN WHOLE OR IN PART.

DO NOT INTERFERE WITH THE OPERATION OF ANY FIRE HYDRANT, FIRE CALL BOX, OR POLICE CALL BOX.

ALL CURVE DATA IS BASED ON THE ARC DEFINITION UNLESS OTHERWISE NOTED.

VERTICAL CONTROL IS BASED ON AN ASSUMED DATUM. HORIZONTAL CONTROL IS BASED ON AN ASSUMED COORDINATE SYSTEM.

ALL AGGREGATE SHALL BE NON-SLAG.

THE CONTRACTOR MUST MAINTAIN ACCESS TO ALL PROPERTIES AT ALL TIMES.

PRIVATE PROPERTY LINES ARE PLOTTED FROM THE DEED OF RECORD, RECORDED SUBDIVISION OR LOT PLANS, EXISTING TOPOGRAPHICAL FEATURES AND LIMITED FIELD DATA. PRIVATE PROPERTY LINES WERE NOT SURVEYED BY THE PROFESSIONAL LAND SURVEYOR RESPONSIBLE FOR THE PROJECT.

PROFILE MILLING OF BITUMINOUS PAVEMENT SURFACES SHALL BE PERFORMED PER SECTION 492 OF PENNDOT PUBLICATION 408. THE MILLING SHALL BE VARIABLE DEPTH CONFORMING TO THE PROFILES PROVIDED ON SHEET NO. 6. THE BITUMINOUS PAVEMENT SHALL BE REMOVED TO THE EXISTING CONCRETE SLABS.

SEALING OF PAVEMENT TO THE EXISTING CURBS AND STRUCTURE WITH PG 64-22 SHALL BE INCIDENTAL TO PAY ITEM NOS. 0409-0574 AND 0409-6540.

EXISTING CONCRETE PAVEMENT AND JOINTS THAT ARE DAMAGED OR IN NEED OF REPAIR SHALL BE REPAIRED AT THE DIRECTION OF THE CITY OR ITS REPRESENTATIVE.

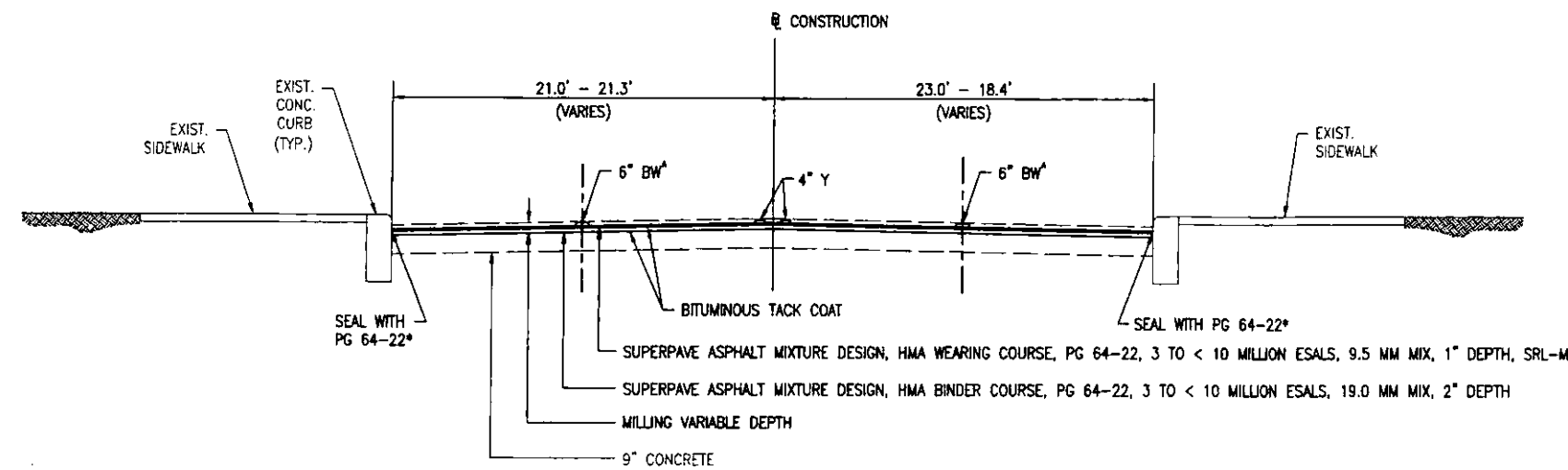

\* INCLUDES JOINT WITH STRUCTURE  
 \* IF EXISTING

**TYPICAL SECTION  
 BRIGHTON AVENUE**

STA. 10+25.00 TO STA. 11+15.87  
 STA. 12+15.02 TO STA. 13+25.00  
 N.T.S.

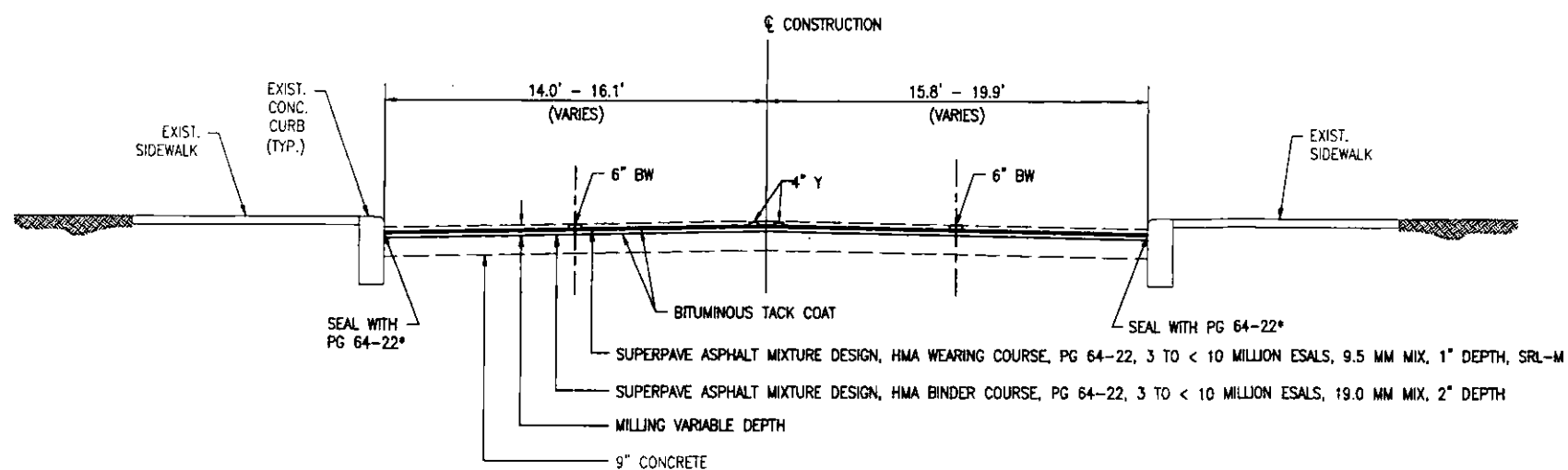

\* INCLUDES JOINT WITH STRUCTURE  
 \* IF EXISTING

**TYPICAL SECTION  
 NORTH AVENUE**

STA. 20+25.00 TO STA. 20+97.20  
 STA. 21+85.71 TO STA. 22+32.58  
 N.T.S.

CITY OF PITTSBURGH DEPARTMENT OF PUBLIC WORKS		
CONSTRUCTION DRAWING RETROFIT OF THE NORTH AVE BRIDGE over THE NORFOLK & SOUTHERN R.R. GENERAL NOTES & TYPICAL SECTION		
SCALE AS NOTED	SHEET NO.	ACCESSION NO. A-568
DATE 2/8/10	3 OF 24	CASE NO. -----

# SUMMARY

REVISION NO.	REVISIONS	DATE	BY	DISTRICT	COUNTY	ROUTE	SECTION	SHEET
				11-0	ALLEGHENY	T000	A01	4 OF 24
CITY OF PITTSBURGH								

◆ - SEE SPECIAL PROVISIONS

QUANTITY	ITEM NO	DESCRIPTION	DESIGN NO	FOR TAB SEE SHEET	QUANTITY	ITEM NO	DESCRIPTION	DESIGN NO	FOR TAB SEE SHEET	QUANTITY	ITEM NO	DESCRIPTION	DESIGN NO	FOR TAB SEE SHEET	QUANTITY	ITEM NO	DESCRIPTION	DESIGN NO	FOR TAB SEE SHEET
	UNIT					UNIT					UNIT					UNIT			
1475	4409 0574 SY	SUPERPAVE ASPHALT MIXTURE DESIGN, HMA WEARING COURSE, PG 64-22, 3 TO < 10 MILLION ESALS, 9.5 MM MIX, 1" DEPTH, SRL-M MODIFIED ◆		6,14	50	9000 0002 CY	LATEX MODIFIED CONCRETE WEARING SURFACE ◆		BRIDGE										
1475	4409 6540 SY	SUPERPAVE ASPHALT MIXTURE DESIGN, HMA BINDER COURSE, PG 64-22, 3 TO < 10 MILLION ESALS, 19.0 MM MIX, 2" DEPTH MODIFIED ◆		6,14	20	9000 0003 DAYS	RAILROAD FLAGMAN ◆		BRIDGE										
2949	0460 0001 SY	BITUMINOUS TACK COAT		6,14	X	9000 0004 LS	BARRIER ◆		TCP										
2336	0492 0030 SY	PROFILE MILLING, MILLED MATERIAL RETAINED BY CONTRACTOR		6,14	---	9513 0001 PDA	JOINT REHABILITATION ◆		6,14										
330	0627 0001 LF	TEMPORARY CONCRETE BARRIER		TCP	10	9606 0150 EACH	GRADE ADJUSTMENT OF UTILITIES ◆		6,14										
260	0628 0001 LF	RESET TEMPORARY CONCRETE BARRIER		TCP															
X	0901 0001 LS	MAINTENANCE AND PROTECTION OF TRAFFIC DURING CONSTRUCTION ◆		TCP															
10	0901 0042 EACH	REMOVE TUBULAR MARKERS		TCP															
10	0901 0044 EACH	TUBULAR MARKERS		TCP															
10	0901 0046 EACH	REPLACE TUBULAR MARKERS - POST ONLY		TCP															
2	0901 0203 EACH	ARROW PANEL		TCP															
120	0901 0231 DAY	ADDITIONAL WARNING LIGHTS, TYPE B		TCP															
290	0901 0232 DAY	ADDITIONAL WARNING LIGHTS, TYPE C		TCP															
50	0901 0240 SF	ADDITIONAL TRAFFIC CONTROL SIGNS		TCP															
50	0962 1001 LF	6" WHITE WATERBORNE PAVEMENT MARKINGS		6,14															
570	0962 1003 LF	12" WHITE WATERBORNE PAVEMENT MARKINGS		6,14															
88	0962 1004 LF	24" WHITE WATERBORNE PAVEMENT MARKINGS		6,14, TCP															
524	0962 1005 LF	4" YELLOW WATERBORNE PAVEMENT MARKINGS		6,14															
1200	0963 0001 SF	PAVEMENT MARKING REMOVAL		TCP															
4	0971 0001 EACH	REMOVE POST MOUNTED SIGNS, TYPE B		6,14															
8	0975 0001 EACH	REMOVE POST MOUNTED SIGNS, TYPE F		6,14															
X	1018 0050 LS	REMOVAL OF PORTION OF EXISTING BRIDGE		6,14															
X	8020 0001 LS	NORTH AVENUE BRIDGE REHABILITATION ◆		BRIDGE															
X	9000 0001 LS	HEAT STRAIGHTEN NORTH GIRDER ◆		BRIDGE															





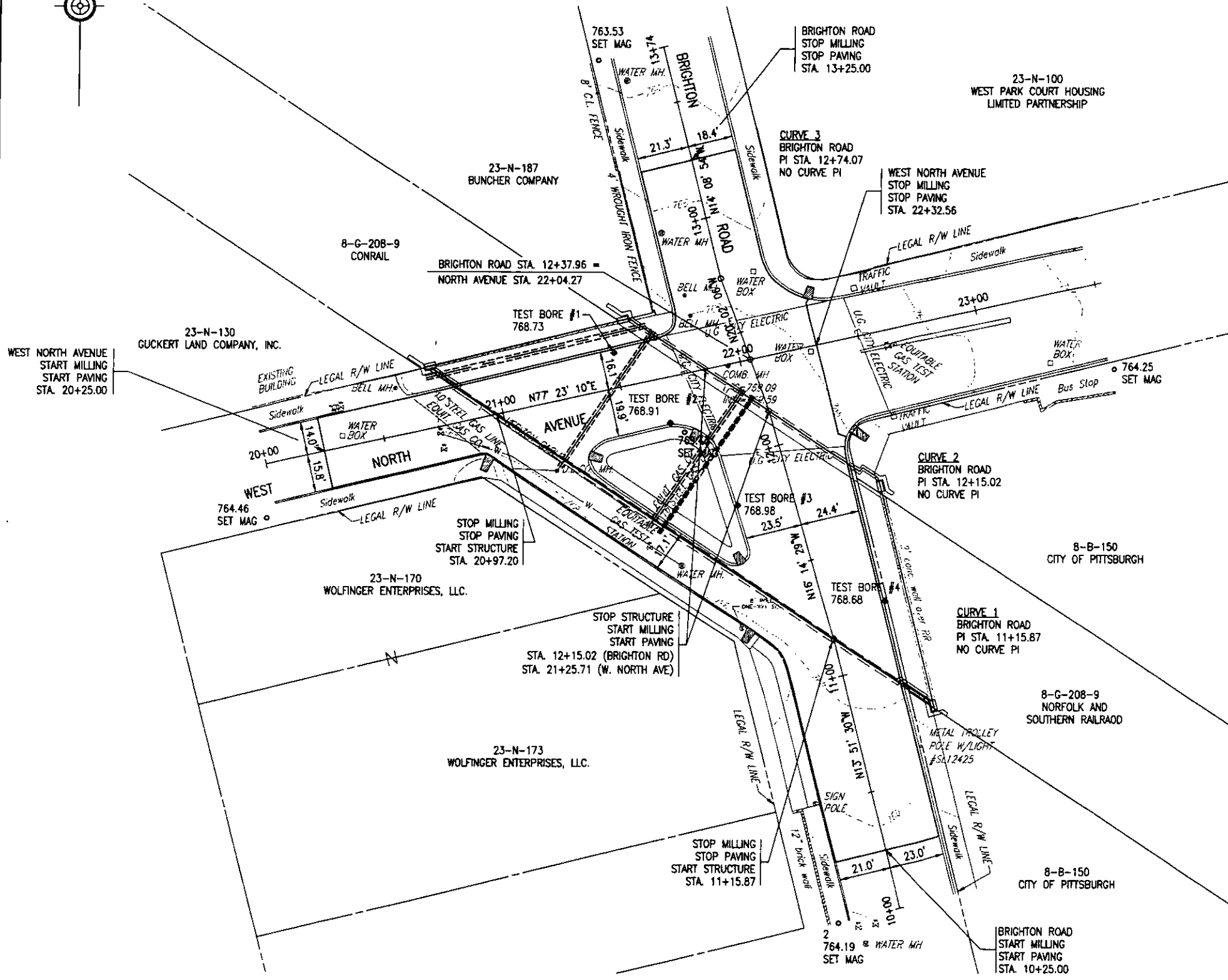

Mark	Description	By	Chk'd	Rec'd	Date
REVISIONS					

**CITY OF PITTSBURGH**  
**DEPARTMENT OF PUBLIC WORKS**

**CONSTRUCTION DRAWING**  
**RETROFIT OF THE**  
**NORTH AVE BRIDGE**  
**over THE NORFOLK & SOUTHERN R.R.**  
**ROADWAY PLAN**

SCALE 1"=25'	SHEET NO. 6 OF 24	ACCESSION NO. A-568
DATE 2/8/10	CASE NO. -----	

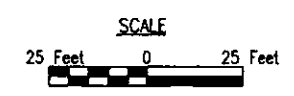

REFER TO SHEET NO. 7 FOR PROFILES

DES: JCW    DWG: ADP    CKD: RAN

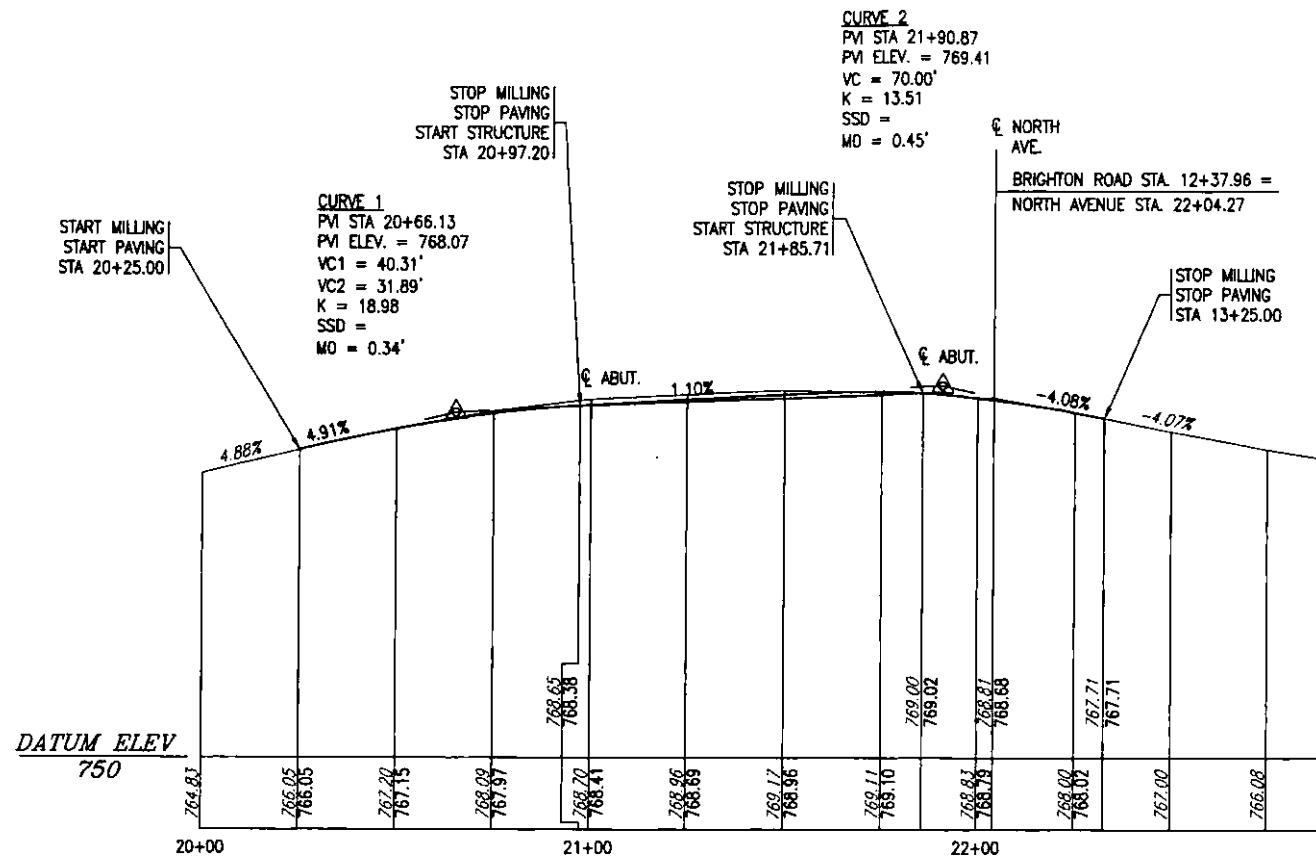

NORTH AVENUE PROFILE

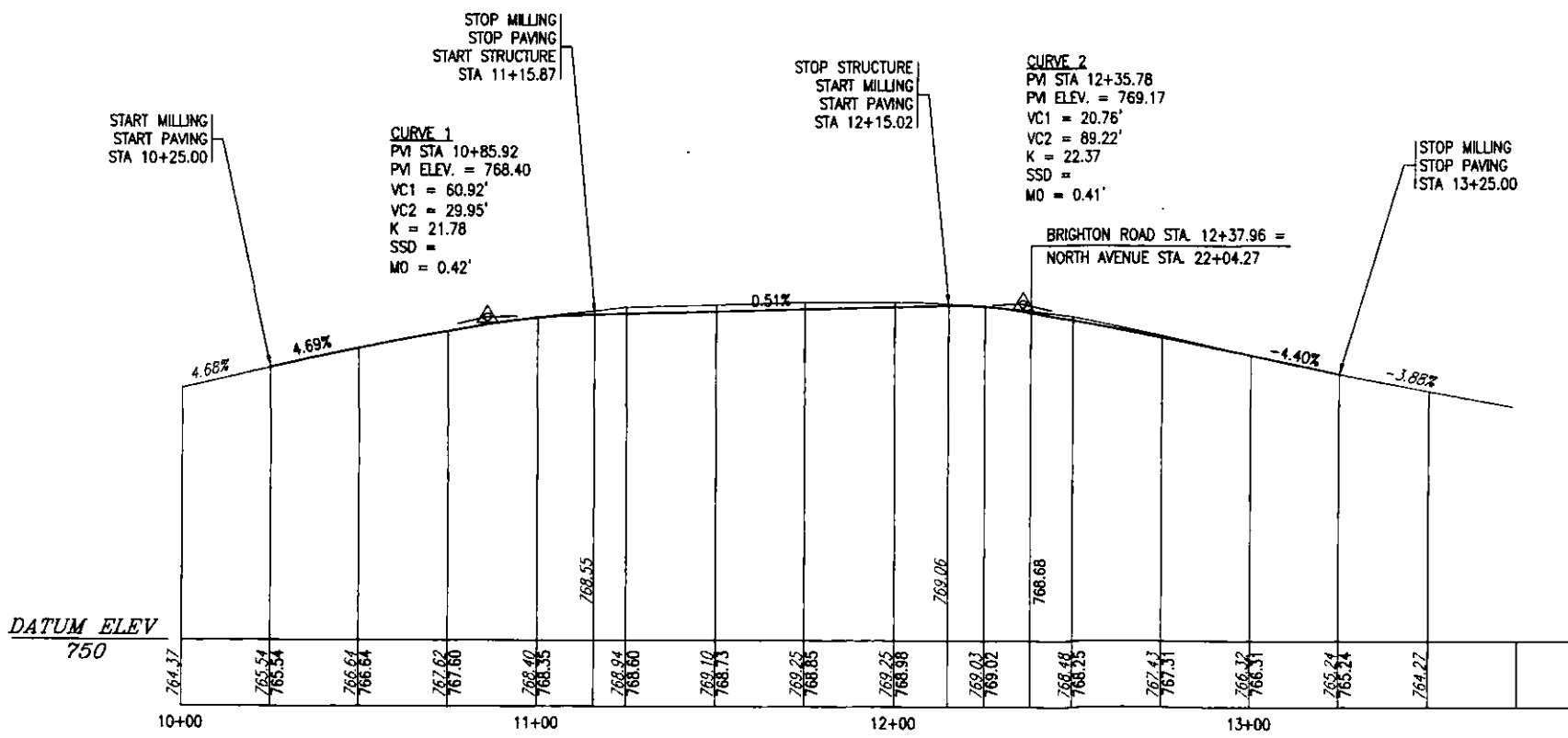

BRIGHTON ROAD PROFILE

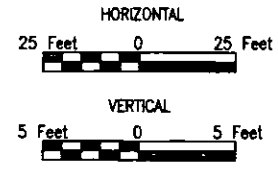

Mark	Description	By	Chk'd	Rec'd	Date
REVISIONS					

CITY OF PITTSBURGH  
 DEPARTMENT OF PUBLIC WORKS

CONSTRUCTION DRAWING  
 RETROFIT OF THE  
 NORTH AVE BRIDGE  
 over THE NORFOLK & SOUTHERN R. R.  
 ROADWAY PROFILE

SCALE AS NOTED	SHEET NO. 7 OF 24	ACCESSION NO. A-568
DATE 2/4/10	CASE NO. -----	

**TABULATION OF TRAFFIC CONTROL DEVICES  
FOR INFORMATION ONLY (LUMP SUM ITEM NO. 0901-0001)**

**STANDARD SIGNS**

DESCRIPTION	SIZE	SIGN ID	SHEET NO. 9	SHEET NO. 10	SHEET NO. 11	SHEET NO. 12	DEVICE TOTAL
END DETOUR	24"x18"	M4-8A	3				3
DETOUR SIGN, LEFT	30"x24"	M4-9L	3				3
DETOUR SIGN, RIGHT	30"x24"	M4-9R	4				4
DETOUR SIGN, STRAIGHT	30"x24"	M4-9S	2				2
LEFT ADVANCE DETOUR	30"x24"	M4-9SL	3				3
RIGHT ADVANCE DETOUR	30"x24"	M4-9SR	4				4
LANE USE CONTROL	30"x30"	R3-6LSR				6	6
LEFT LANE MUST TURN LEFT	30"x30"	R3-7L				1	1
LANE USE CONTROL	30"x30"	R3-8A-LSR				2	2
LANE USE CONTROL	30"x30"	R3-8ALR	2				2
SIDEWALK CLOSED	24"x12"	R9-9		4		3	4
SIDEWALK CLOSED CROSS HERE	24"x12"	R9-10	1				1
SIDEWALK CLOSED CROSS HERE	24"x12"	R9-11a	2		1	1	2
SIDEWALK CLOSED CROSS HERE (MODIFIED)	24"x12"	R9-11a MOD	2				2
STOP HERE ON RED	24"x30"	R10-6AL				2	2
ROAD CLOSED	48"x30"	R11-2	4				4
LEFT REVERSE CURVE	30"x30"	W1-4L		1			1
RIGHT REVERSE CURVE	30"x30"	W1-4R		1			1
PAVEMENT WIDTH TRANSITION, LEFT LANE ENDS	36"x36"	W4-2L			2		2
PAVEMENT WIDTH TRANSITION, RIGHT LANE ENDS	36"x36"	W4-2R	1		3	1	4
ROAD WORK	36"x36"	W20-1	6	1	6		7
DETOUR	48"x48"	W20-2	4				4
ROAD CLOSED	36"x36"	W20-3	6				6
LEFT LANE CLOSED	36"x36"	W20-5L	2		2		2
RIGHT LANE CLOSED	36"x36"	W20-5R	1			1	1
DISTANCE PANELS (500 FEET)		W30-1-1	6				6
DISTANCE PANELS (1000 FEET)		W30-1-2	3				3
DISTANCE PANELS (AHEAD)		W30-1-6	8				8
SIGN SUPPORT			44	7	15	20	51
CHANNELIZING DEVICES				62		72	72
TYPE B LIGHT YELLOW			13	3	13	4	17
TYPE C LIGHT YELLOW				41			41

**TABULATION OF TRAFFIC CONTROL DEVICES  
FOR INFORMATION ONLY (LUMP SUM ITEM NO. 0901-0001)**

**FABRICATED SIGNS**

SPECIAL SIGN NUMBER	DESCRIPTION	SIZE	AREA (SF)	SHEET NO. 9	SHEET NO. 10	SHEET NO. 11	SHEET NO. 12	DEVICE TOTAL
1	W. NORTH AVE.	24"x20"	3.33	6		4		6

**GENERAL NOTES**

- THE WORK CONSISTS OF MAINTAINING AND PROTECTING THE TRAVELING PUBLIC THROUGH THE AREA OF WORK. IN ADDITION, THE WORK SHALL ENSURE THE SAFETY OF THE WORK CREWS AND DEPARTMENT PERSONNEL.
- FURNISH, PLACE AND MAINTAIN TRAFFIC CONTROL DEVICES THROUGHOUT THE ENTIRE TERM OF THE PROJECT. THE DEVICES SHALL CONFORM TO:
  - THE SPECIAL PROVISIONS OF THE CONTRACT.
  - TITLE 67, PA CODE, CHAPTER 213, WORK ZONE TRAFFIC CONTROL, FEBRUARY 2008 OR AS AMENDED.
  - TITLE 67, PA CODE, CHAPTER 212, OFFICIAL TRAFFIC CONTROL DEVICES, MARCH 2006 OR AS AMENDED.
  - TITLE 67, PA CODE, P.D.T. PUBLICATION 236M, HANDBOOK OF APPROVED SIGNS, FEBRUARY 28, 2006 OR AS AMENDED.
  - P.D.T. PUBLICATION NO. 35, APPROVED CONSTRUCTION MATERIALS (BULLETIN 15).
  - P.D.T. PUBLICATION 408, SPECIFICATIONS, DATED 2007 OR AS AMENDED.
  - P.D.T. PUBLICATION 111M, TRAFFIC CONTROL SIGNING STANDARDS, TC-8700.
  - TRAFFIC CONTROL PAVEMENT MARKING STANDARD, TC-7600.
- IMMEDIATELY UPON COMPLETION OF THE WORK, REMOVE AND RETAIN THE DEVICES, UNLESS OTHERWISE SPECIFIED IN THE SPECIAL PROVISIONS. THE DEPARTMENT WILL REMOVE ANY TRAFFIC CONTROL DEVICES ERECTED BY DEPARTMENT PERSONNEL.
- THE ENGINEER WILL INSPECT ALL TRAFFIC CONTROL DEVICES PRIOR TO THE START OF WORK.
- PROVIDE NEW TRAFFIC CONTROL SIGNS AND DEVICES.
- REMOVE ALL CONFLICTING PAVEMENT MARKINGS.
- THIS TRAFFIC CONTROL PLAN DOES NOT RELIEVE THE CONTRACTOR OF HIS RESPONSIBILITY AS SPECIFIED IN SECTION 901.3 OF P.T.C. SPECIFICATIONS.
- ALL DISTANCES MAY BE SLIGHTLY ADJUSTED TO FIT FIELD CONDITIONS.
- THE TRAFFIC CONTROL DEVICES SHOWN DO NOT NECESSARILY DEPICT THE ACTUAL NUMBER OF DEVICES REQUIRED.
- THE CONTRACTOR IS RESPONSIBLE FOR MAINTAINING ACCESS TO ALL BUSINESSES, DWELLINGS, ACCESS ROADS AND LOCAL ACCESS ROADS DURING ALL PHASES OF CONSTRUCTION.
- ALL SPECIAL SIGNS TO BE FABRICATED AND ERECTED IN ACCORDANCE WITH P.D.T. PUBLICATION 111, CURRENT EDITION AND AMENDMENTS.
- TYPE "B" HIGH INTENSITY FLASHING WARNING LIGHTS ARE REQUIRED ON EACH ADVANCED WARNING SIGN.
- NIGHTTIME HOURS ARE DEFINED AS 10PM-6AM SUNDAY-THURSDAY AND 10PM-9AM FRIDAY AND SATURDAY.
- DAYTIME HOURS ARE DEFINED AS 6AM-10PM MONDAY-FRIDAY AND 9AM-10PM SATURDAY AND SUNDAY.
- COVER OR REMOVE ALL SIGNS NOT IN USE OR CONFLICTING TO THE OPERATION BEING PERFORMED.
- INVENTORY AND DOCUMENT ALL EXISTING SIGNS AND PAVEMENT MARKING PATTERNS PRIOR TO THE BEGINNING OF CONSTRUCTION WITH THE PROJECT ENGINEER.
- DO NOT LEAVE EQUIPMENT, VEHICLES OR MATERIAL ALONG ROADWAY. THEY ALL MUST BE OUTSIDE OF ROADWAY AREA IN A SUITABLE PROTECTED AREA.
- ALL POST MOUNTED SIGNS MUST BE MOUNTED ON BREAKAWAY STEEL POSTS AS SPECIFIED IN SECTION 1103.08 OF P.D.T. PUBLICATION 408/2007.

**TABULATION OF MISCELLANEOUS ITEMS  
INCLUDED IN TRAFFIC CONTROL  
SEPERATE PAY ITEMS**

QUANTITY	ITEM NO.	UNIT	DESCRIPTION	SHEET NO. 9	SHEET NO. 10	SHEET NO. 11	SHEET NO. 12
300	0627-0001	LF	TEMPORARY CONCRETE BARRIER	260			70
260	0628-0001	LF	RESET TEMPORARY CONCRETE BARRIER				260
1	0901-0001	LS	MAINTENANCE AND PROTECTION OF TRAFFIC DURING CONSTRUCTION				
10	0901-0042	EACH	REMOVE TUBULAR MARKERS		7		10
10	0901-0044	EACH	TUBULAR MARKERS		7		10
10	0901-0046	EACH	REPLACE TUBULAR MARKERS-POST ONLY		7		10
2	0901-0203	EACH	ARROW PANEL		2		1
120	0901-0231	DAY	ADDITIONAL WARNING LIGHTS, TYPE B				
290	0901-0232	DAY	ADDITIONAL WARNING LIGHTS, TYPE C				
50	0901-0240	SF	ADDITIONAL TRAFFIC CONTROL SIGNS				
24	0962-1004	LF	24" WHITE WATERBOURNE PAVEMENT MARKINGS				24
1200	0963-0001	LF	4" PAVEMENT MARKING REMOVAL		600		600
1	9000-0004	LS	BARRIER				1

Mark	Description	By	Chk'd	Rec'd	Date
REVISIONS					

**CITY OF PITTSBURGH  
DEPARTMENT OF PUBLIC WORKS**

**DETOUR PLAN  
RETROFIT OF THE  
NORTH AVE BRIDGE  
over THE NORFOLK & SOUTHERN R.R.  
GENERAL NOTES & QUANTITIES**

SCALE N.T.S.	SHEET NO.	ACCESSION NO. A-568
DATE 2/8/10	8 OF 24	CASE NO. -----

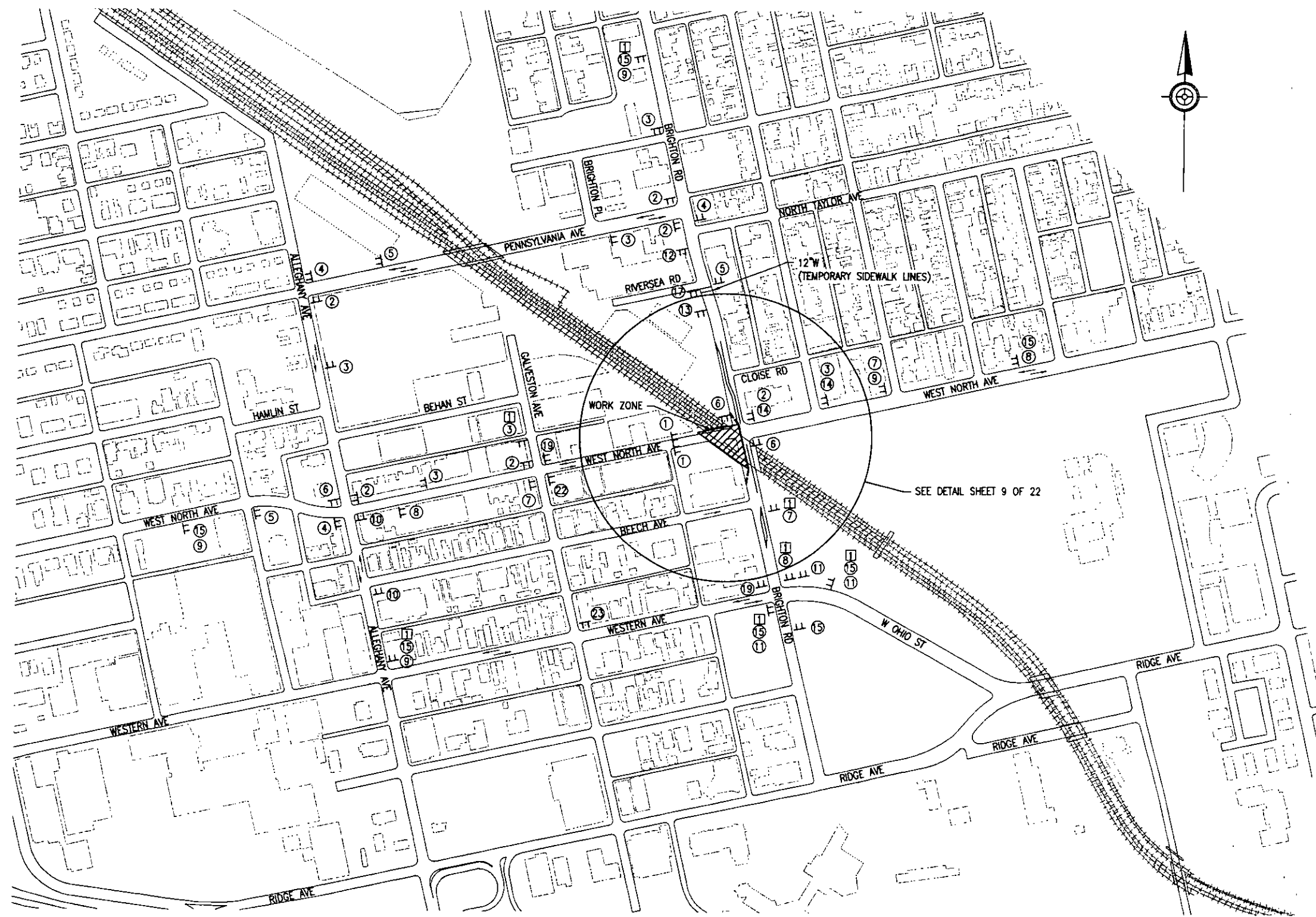

**LEGEND**

- TEMPORARY CONCRETE BARRIER
- DELINEATORS
- TEMPORARY IMPACT ATTENUATOR, TYPE VI
- SIGN SUPPORT
- ARROW PANEL
- EXIST. DIRECTION OF TRAFFIC FLOW
- PROP. DIRECTION OF TRAFFIC FLOW

Mark	Description	By	Chk'd	Recm'd	Date
REVISIONS					

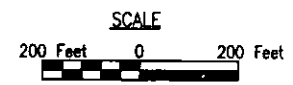

**CITY OF PITTSBURGH**  
**DEPARTMENT OF PUBLIC WORKS**

**DETOUR PLAN**  
**RETROFIT OF THE**  
**NORTH AVE BRIDGE**  
**over THE NORFOLK & SOUTHERN R.R**  
**PHASE 1**

SCALE 1"=200'	SHEET NO. 9 OF 24	ACCESSION NO. A-568
DATE 2/8/10		CASE NO. -----

DES: JCW | DWG: ADP | CKD: JCW

REFER TO SHEET NO. 12 FOR SIGNS.

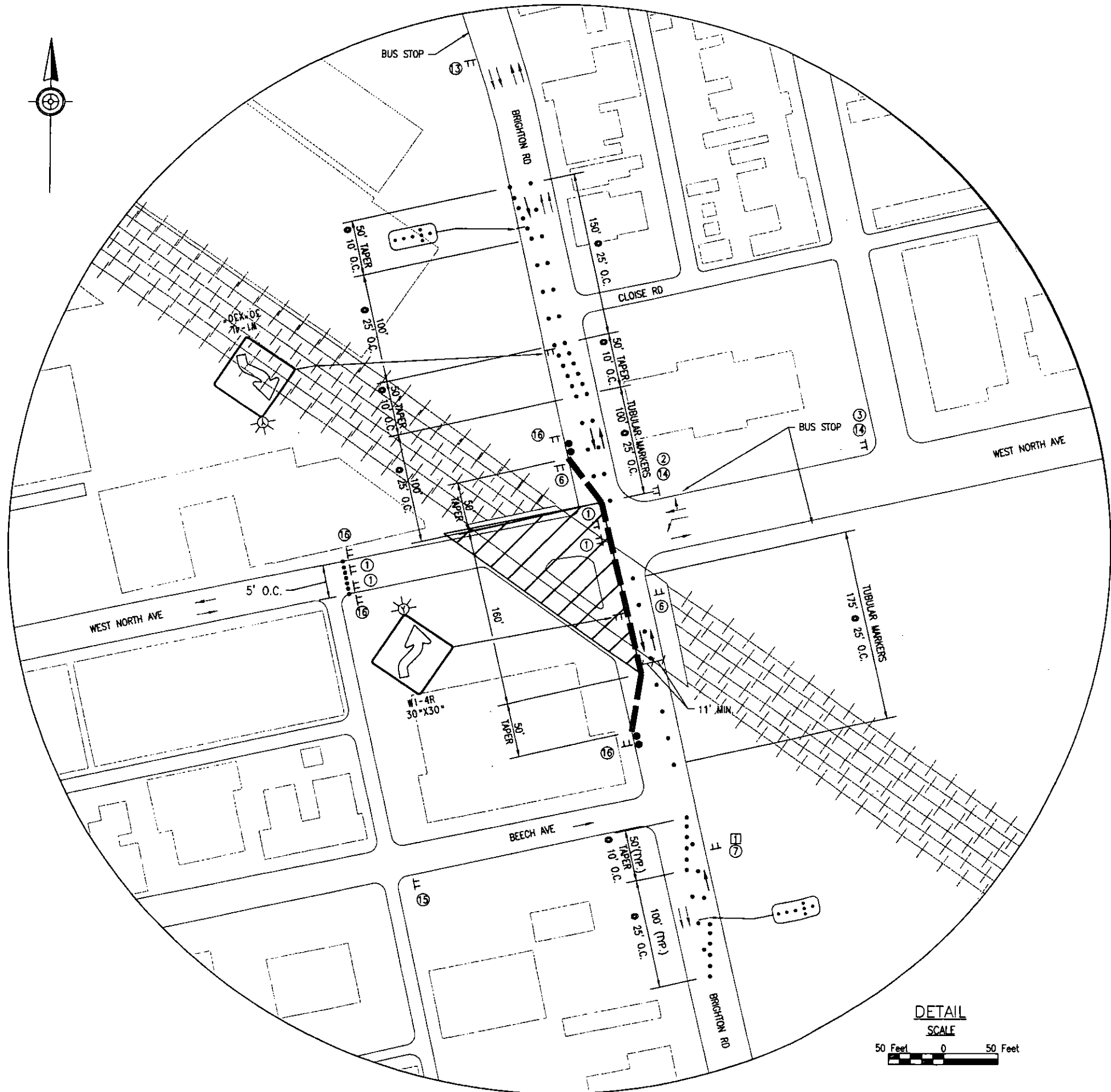
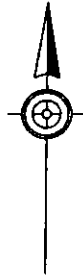

**LEGEND**

- — — — — TEMPORARY CONCRETE BARRIER
- • • • • DELINEATORS
- ● — ● — TEMPORARY IMPACT ATTENUATOR, TYPE VI
- ⊥ SIGN SUPPORT
- ⋯⋯⋯ ARROW PANEL
- EXIST. DIRECTION OF TRAFFIC FLOW
- PROP. DIRECTION OF TRAFFIC FLOW

Mark	Description	By	Chk'd	Recm'd	Date
REVISIONS					



REFER TO SHEET NO. 12 FOR SIGNS.

**CITY OF PITTSBURGH**  
**DEPARTMENT OF PUBLIC WORKS**

**DETOUR PLAN**  
**RETROFIT OF THE**  
**NORTH AVE BRIDGE**  
**over THE NORFOLK & SOUTHERN R.R.**  
**PHASE 1**

SCALE 1"=50'	SHEET NO.	ACCESSION NO. A-5686
DATE 2/8/10	10 OF 24	CASE NO. -----



**LEGEND**

- — — — — TEMPORARY CONCRETE BARRIER
- — — — — DELINEATORS
- ● ● ● ● TEMPORARY IMPACT ATTENUATOR, TYPE VI
- T SIGN SUPPORT
- ⊞ ARROW PANEL
- EXIST. DIRECTION OF TRAFFIC FLOW
- PROP. DIRECTION OF TRAFFIC FLOW

Mark	Description	By	Chk' d	Recm' d	Date
REVISIONS					

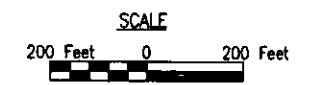

**CITY OF PITTSBURGH  
DEPARTMENT OF PUBLIC WORKS**

**DETOUR PLAN  
RETROFIT OF THE  
NORTH AVE BRIDGE  
over THE NORFOLK & SOUTHERN R. R.  
PHASE 2**

SCALE 1"=200'	SHEET NO. 11 OF 24	ACCESSION NO. A-5689
DATE 2/8/10	CASE NO. -----	

REFER TO SHEET NO. 12 FOR SIGNS.

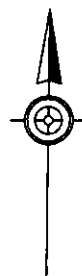

**NOTES:**

1. TEMPORARILY REPOSITION SIGNAL HEADS TO ALIGN WITH REVISED LANE LOCATIONS.
2. REPHASE SIGNALS TO NEW ALIGNMENTS.
3. RELOCATE BUS STOP APPROXIMATELY 250 FEET DOWN STREET FOR THIS PHASE. COORDINATE WITH THE PORT AUTHORITY.

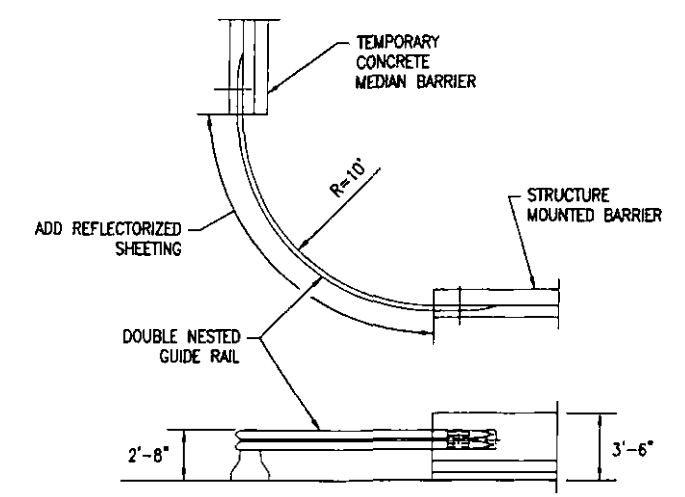

**BARRIER DETAIL**

**LEGEND**

- — — — — TEMPORARY CONCRETE BARRIER
- • • • • DELINEATORS
- TEMPORARY IMPACT ATTENUATOR, TYPE VI
- |— SIGN SUPPORT
- ARROW PANEL
- >— EXIST. DIRECTION OF TRAFFIC FLOW
- >— PROP. DIRECTION OF TRAFFIC FLOW
- x — x — CONSTRUCTION SAFETY FENCE

Mark	Description	By	Chk'd	Recm'd	Date
REVISIONS					

**CITY OF PITTSBURGH  
DEPARTMENT OF PUBLIC WORKS**

**DETOUR PLAN  
RETROFIT OF THE  
NORTH AVE BRIDGE  
over THE NORFOLK & SOUTHERN R. R.  
PHASE 2**

SCALE 1"=50'	SHEET NO. 12 OF 24	ACCESSION NO. A-5689
DATE 2/8/10		CASE NO. -----

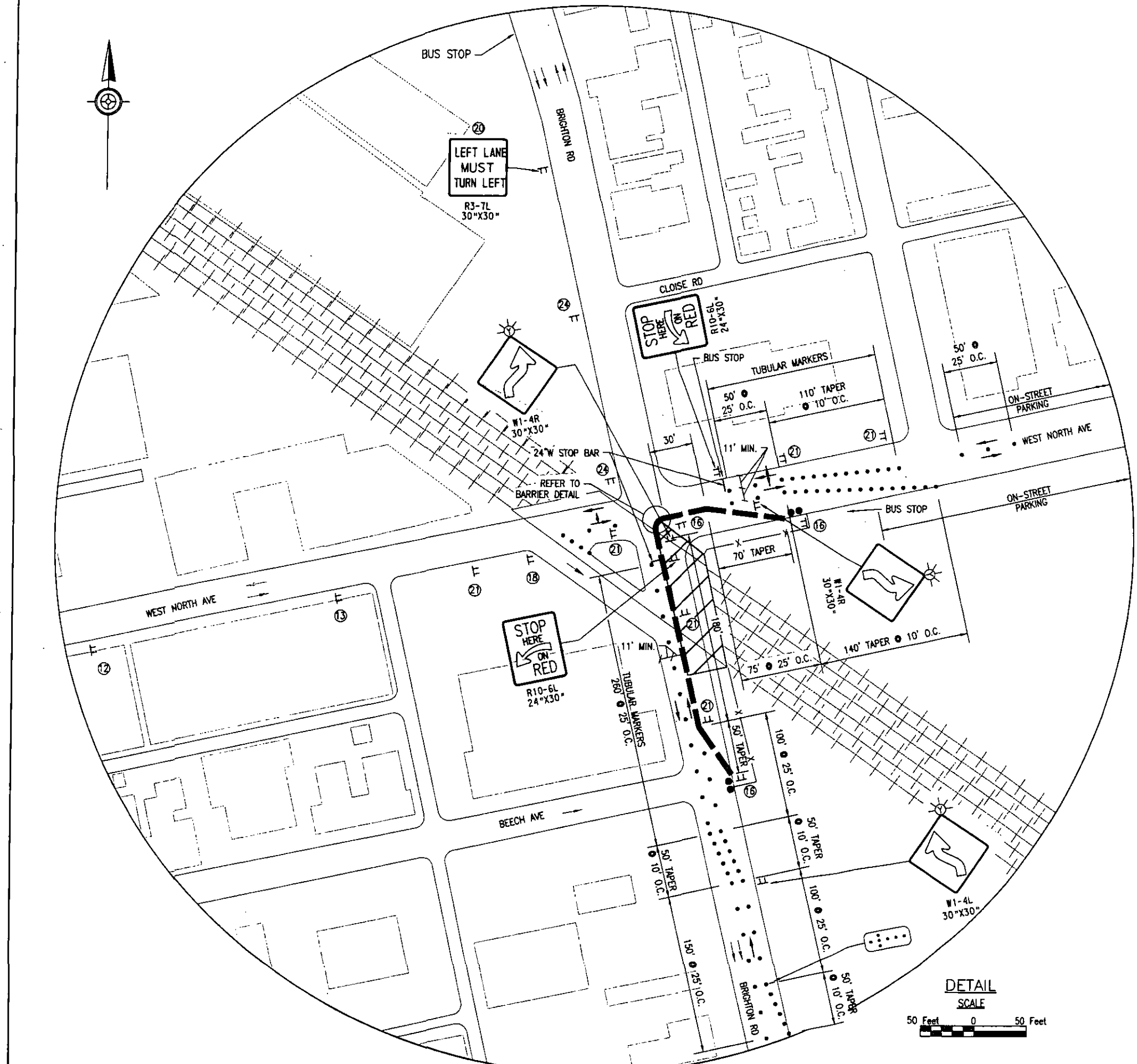

REFER TO SHEET NO. 12 FOR SIGNS.



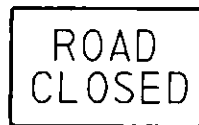

R11-2  
48"x30"

①



M4-9R  
30"x24"

②



M4-9SR  
30"x24"

③



M4-9L  
30"x24"

④



M4-9SL  
30"x24"

⑤



R4-8A  
24"x18"

⑥



W20-3  
36"x36"  
W30-1-1

⑦

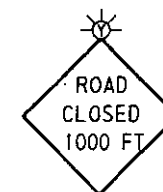

W20-3  
36"x36"  
W30-1-2

⑧

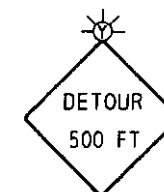

W20-2  
36"x36"  
W30-1-1

⑨



M4-9S  
30"x24"

⑩



W20-5L  
36"x36"  
W30-1-6

⑪



W20-5R  
36"x36"  
W30-1-1

⑫

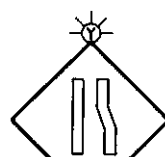

W4-2R  
36"x36"

⑬

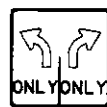

R3-8A-LR  
30"x30"

⑭



W20-1  
36"x36"  
W30-1-6

⑮



R9-9  
24"x12"

⑯



R9-10  
24"x12"

⑰



R9-11A  
24"x12"

⑱



R9-11A  
24"x12"

⑲

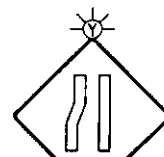

W4-2L  
36"x36"

⑳



R3-6LSR  
30"x36"

㉑



R9-11A MOD  
24"x12"

㉒



R9-11A MOD  
24"x12"

㉓



R3-8A-LSR  
30"x30"

㉔



SS-1  
24"x20"

㉕

Mark	Description	By	Chk'd	Rec'd	Date
REVISIONS					

**CITY OF PITTSBURGH**  
**DEPARTMENT OF PUBLIC WORKS**

**DETOUR PLAN**  
**RETROFIT OF THE**  
**NORTH AVE BRIDGE**  
**over THE NORFOLK & SOUTHERN R.R.**  
**SIGNS**

SCALE N.T.S.	SHEET NO.	ACCESSION NO. A-5689
DATE 2/8/10	13 OF 24	CASE NO. -----

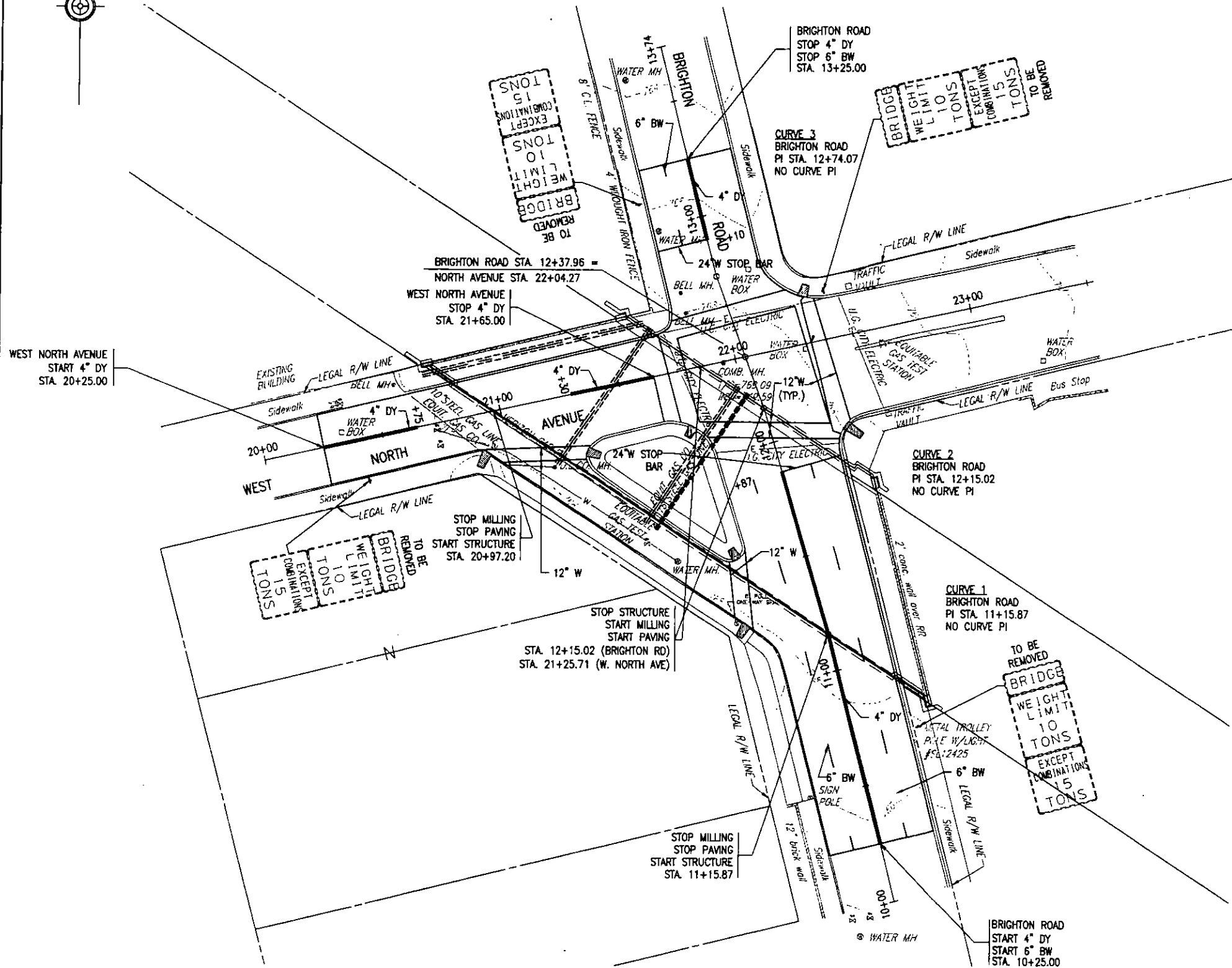

- NOTES:**
1. LOCATIONS OF STOP BARS AND CROSSWALK LINES ARE APPROXIMATE, MATCH EXISTING.
  2. TIE ALL LONGITUDINAL LINES INTO EXISTING MARKINGS AT LIMITS OF WORK.

Mark	Description	By	Chk'd.	Recm'd	Date
REVISIONS					

**CITY OF PITTSBURGH**  
**DEPARTMENT OF PUBLIC WORKS**  
**CONSTRUCTION DRAWING**  
**RETROFIT OF THE**  
**NORTH AVE BRIDGE**  
**over THE NORFOLK & SOUTHERN R.R.**  
**SIGNING AND PAVING MARKING**

SCALE 1"=25'	SHEET NO. 14 OF 24	ACCESSION NO. A-568
DATE 2/8/10	CASE NO. -----	

DES: JCW DWG: ADP CKD: RAN

REFER TO SHEET NO. 6 FOR ROADWAY PLAN

INDEX OF DRAWINGS	
TITLE	SHEET NO.
GENERAL PLAN & ELEVATION	15
GENERAL NOTES & QUANTITIES	16
REMOVAL LIMITS	17
FRAMING PLAN	18
FLOORBEAM 29 RETROFIT	19
HEAT STRAIGHTEN NORTH AVE. GIRDER (G1)	20
DECK PLAN	21
NORTH AVE. SIDEWALK (G1)	22
BRIGHTON ROAD SIDEWALK (G2)	23
SUPERSTRUCTURE REBAR SCHEDULE	24

**LEGEND**

MILL, HYDRODEMOLITION & INSTALL LATEX MODIFIED CONCRETE (PHASE 1)



REMOVE & REPLACE SIDEWALK



MILL, HYDRODEMOLITION & INSTALL LATEX MODIFIED CONCRETE (PHASE 2)

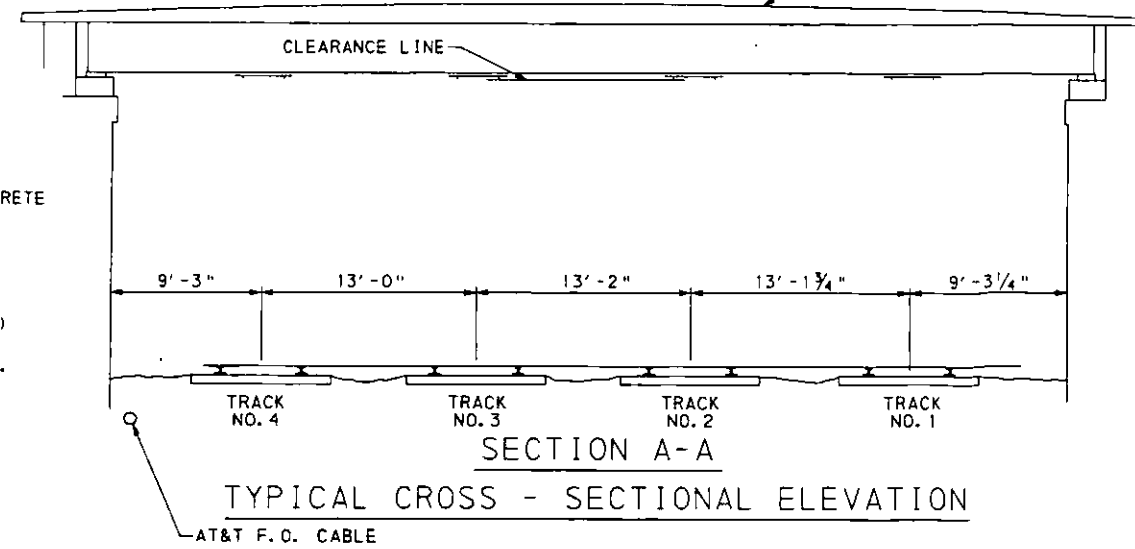
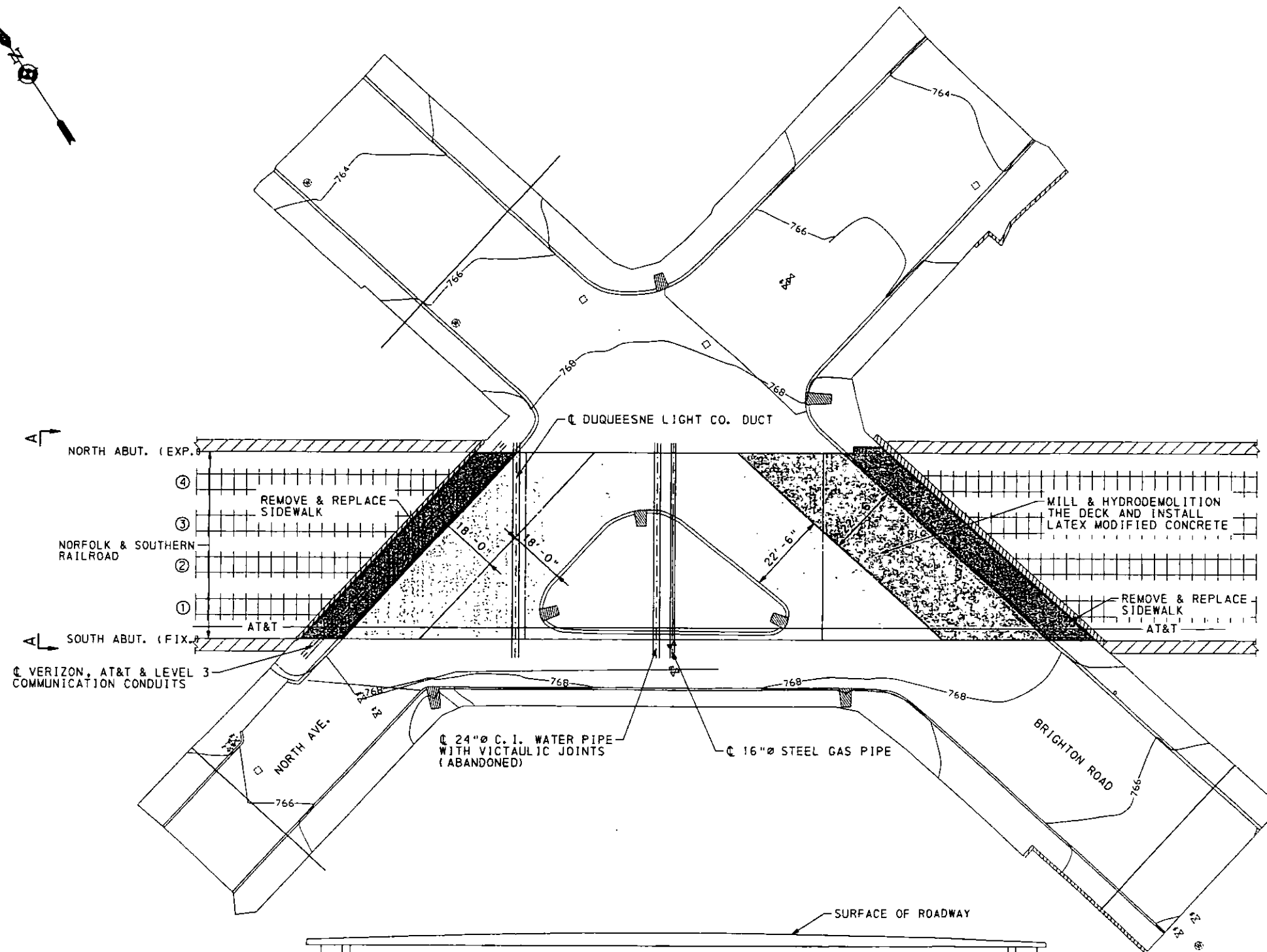

TRACK VERTICAL CLEARANCE			
TRACK	NORTH AVE. BRIDGE (PCT. 60)	SURVEYED BEAM NO. 29	PROPOSED BEAM NO. 29
4	18'-0"	18'-5"	18'-5"
3	17'-10"	18'-2"	18'-2"
2	18'-3"	18'-8"	18'-7"
1	18'-2"	18'-8"	18'-7"

- SCOPE OF WORK**
- RESURFACE DECK WITH LATEX MODIFIED CONCRETE
  - REPLACE SIDEWALKS
  - ADD A COVER PLATE TO BEAM NO. 29
  - HEAT STRAIGHTEN NORTH AVENUE GIRDER (G1)
  - SPOT/ZONE PAINT SELECTED BEAMS & GIRDER.

Mark	Description	By	Chk'd.	Rec'd	Date
REVISIONS					

**CITY OF PITTSBURGH**  
DEPARTMENT OF PUBLIC WORKS

**CONSTRUCTION DRAWING**  
RETROFIT OF THE  
NORTH AVE BRIDGE  
over THE NORFOLK & SOUTHERN R.R.  
GENERAL PLAN & ELEVATION

SCALE AS NOTED	SHEET NO. 15 OF 24	ACCESSION NO. A-5689
DATE 2/8/10		CASE NO. -----

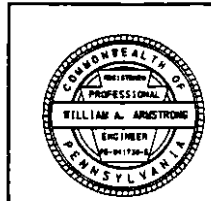

L:\2009-Jobs\City of Pitt - North Ave\sheet 15.DGN 9/10/2009 11:27:01 PM

### GENERAL NOTES

- PROVIDE MATERIALS AND PERFORM WORK IN ACCORDANCE WITH PENNSYLVANIA DEPARTMENT OF TRANSPORTATION SPECIFICATIONS, PUBLICATION 408, 2007 AND CONTRACT SPECIAL PROVISIONS.
- COORDINATE, LOCATE AND CONDUCT ALL WORK RELATED TO PUBLIC AND PRIVATE UTILITIES IN ACCORDANCE WITH PUBLICATION 408, SECTIONS 105.06 AND SECTION 107.12.
- COORDINATE THE REQUIREMENTS FOR PROTECTION AND/OR RELOCATION OF UTILITIES WITH THE UTILITY OWNER PRIOR TO STARTING THE WORK.
- VERIFY AND LOCATE ALL EXISTING UTILITIES PRIOR TO STARTING WORK: CONDUCT OPERATIONS IN A MANNER WHICH ENSURES THAT THE UTILITIES WILL NOT BE DISTURBED OR DAMAGED, AND ASSUME FULL RESPONSIBILITY FOR ANY DAMAGE TO UTILITIES DURING CONSTRUCTION. THE DEPARTMENT DOES NOT ASSUME RESPONSIBILITY FOR REIMBURSEMENT, PARTICIPATION IN DESIGN AND/OR REVISIONS OR LIABILITY FOR ACCURACY OF TYPE, SIZE AND LOCATION OF ANY UTILITY.
- DO NOT CONSIDER ANY OF THE DATA ON THE EXISTING STRUCTURE SUPPLIED IN THE ORIGINAL DESIGN DRAWINGS OR MADE AVAILABLE TO YOU BY THE DEPARTMENT OR ITS AUTHORIZED AGENTS AS POSITIVE REPRESENTATIONS OF ANY OF THE CONDITIONS THAT YOU WILL ENCOUNTER IN THE FIELD.
- THE INFORMATION SHOWN ON THE PLANS FOR THE EXISTING BRIDGE IS NOT PART OF THE PLANS, PROPOSAL, OR CONTRACT AND IS NOT TO BE CONSIDERED A BASIS FOR COMPUTATION OF THE UNIT PRICES USED FOR BIDDING PURPOSES. THERE IS NO EXPRESSED OR IMPLIED AGREEMENT THAT INFORMATION IS CORRECTLY SHOWN. THE BIDDER IS NOT TO RELY ON THIS INFORMATION, BUT IS TO ASSUME THE POSSIBILITY THAT CONDITIONS AFFECTING THE COST AND/OR QUANTITIES OF WORK TO BE PERFORMED MAY DIFFER FROM THOSE INDICATED.
- ALL DIMENSIONS SHOWN ARE HORIZONTAL, EXCEPT AS NOTED.
- ALL FASTENERS ARE 7/8" \* A325 HIGH STRENGTH BOLTS EXCEPT AS NOTED. USE DIRECT TENSION INDICATOR WASHERS FOR ALL A325 HIGH STRENGTH BOLTS.
- ALL STRUCTURAL STEEL TO CONFORM TO ASTM A709 GRADE 50.
- ALL HOLES TO BE 15/16 \* . FIELD HOLES MAY BE DRILLED AND REAMED IN THE FIELD OR UNDERSIZED HOLES MAY BE DRILLED AND REAMED TO FULL SIZE IN THE FIELD. USE CONNECTING PIECE AS A TEMPLATE.
- FABRICATION OF NEW STRUCTURAL STEEL SHALL BE IN ACCORDANCE WITH PENNDOT SPECIFICATIONS PUBLICATION 408/2007 SECTION 1105. PAINT ALL STEEL WITH A PENNDOT APPROVED ORGANIC ZINC-RICH SYSTEM. FINISH COAT COLOR TO MATCH EXISTING STEEL.
- THE CONTRACTOR SHALL PROVIDE OR CONSTRUCT A SAFE ACCESS AND WORK PLATFORM TO PERFORM THE REQUIRED REPAIR WORK. SUBMIT A WORK PLAN TWO WEEKS PRIOR TO WORK FOR APPROVAL.
- THE EXISTING STEEL HAS NOT BEEN REVIEWED FOR THE EXISTANCE OF LEAD PAINT AND OTHER TOXIC MATERIAL (SUCH AS: CADMIUM, CHROMIUM, ARSENIC, ETC.) HOWEVER, THE CONTRACTOR SHOULD ASSUME THAT LEAD BASED PAINT WITH OTHER TOXIC MATERIAL IS ON THE STRUCTURE. THE PORTIONS OF THE EXISTING BRIDGE DESIGNATED TO BE REMOVED BECOME THE PROPERTY OF THE CONTRACTOR AND MUST BE REMOVED FROM THE SITE AND DISPOSED OF PROPERLY.
- REMOVAL OF PORTION OF EXISTING STRUCTURE INCLUDES THE FOLLOWING:
  1. REMOVAL OF GUNNITE & GUNNITE REINFORCING STEEL FROM SELECTED GIRDERS & BEAMS
  2. REMOVAL OF EXISTING SIDEWALK AS SHOWN ON SHEET 3 INCLUDING THE CLEANING, STRAIGHTENING AND APPLICATION OF EPOXY BONDING COMPOUND TO THE SIDEWALK REINFORCEMENT THAT IS TO REMAIN.
  3. REMOVAL OF PORTION OF COVER PLATE ON GIRDER 1.
  4. REMOVAL OF 1/2" CONCRETE DECK BY MILLING.

- PROVIDE 2" CONCRETE COVER ON REINFORCEMENT BARS, EXCEPT AS NOTED.
- USE CLASS AAA CEMENT CONCRETE IN: SIDEWALK
- PROVIDE GRADE 60 REINFORCEMENT STEEL BARS THAT MEET THE REQUIREMENTS OF ASTM A 615/A 615M, A 996/A 996M, AND A 706/A 706M. DO NOT WELD GRADE 60 REINFORCING STEEL BARS UNLESS SPECIFIED. GRADE 40 REINFORCING STEEL BARS MAY BE SUBSTITUTED WITH A PROPORTIONAL INCREASE IN CROSS-SECTIONAL AREA, IF APPROVED BY THE CHIEF BRIDGE ENGINEER. DO NOT USE RAIL STEEL A 996/A 996M REINFORCEMENT BARS IN BRIDGE ABUTMENTS, BEAMS, FOOTINGS, CAISSONS, BARRIERS OR WHERE BENDING OR WELDING OF THE REINFORCEMENT BARS IS INDICATED.
- USE EPOXY-COATED REINFORCEMENT BARS.
- WELDING OF REINFORCEMENT BARS DURING FABRICATION OR CONSTRUCTION IS NOT PERMITTED UNLESS SPECIFIED.
- RAKE-FINISH ALL HORIZONTAL CONSTRUCTION JOINTS, EXCEPT AS INDICATED.

TABULATION OF BID ITEMS AND APPROXIMATE QUANTITIES			
ITEM NUMBER	DESCRIPTION	(4) UNIT	TOTAL
8020-0001	NORTH AVE. BRIDGE REPAIR (S.P.)	L.S.	1
(1)	RAILROAD RIGHT OF ENTRY PERMIT & RAILROAD INSURANCE (S.P.)	L.S.	1
(1)	ACCESS (S.P.)	L.S.	1
(1)	REINFORCEMENT BARS, EPOXY COATED	LBS.	8740
(1)	CLASS AAA CEMENT CONCRETE	C.Y.	55
(1)	PROTECTIVE COATING FOR REINFORCED CONCRETE SURFACES (PENETRATING SEALER)	S.Y.	1085
(1)	UNDER DECK SHIELDING	S.F.	2300
(1)	CONDUIT SHIELDING (NORTH AVE. SIDEWALK) (S.P.)	L.S.	1
(1)	SPOT/ZONE MAINTENANCE PAINTING OF EXISTING STRUCTURAL STEEL (2)	L.S.	1
(1)	DISPOSAL OF BRIDGE WASTE (S.P.)	L.S.	1
(1)	CONTAINMENT (S.P.)	L.S.	1
(1)	WORKER HEALTH AND SAFETY (S.P.)	L.S.	1
(1)	STEEL REPAIR (TYPE 1) (FLOORBEAM 29)(3)	EA.	1
(1)	HYDRO-DEMOLITION (S.P.)	S.Y.	861
(1)	LATEX MODIFIED CONCRETE WEARING SURFACE, 3/4" DEPTH	S.Y.	861
(1)	4x4 STEEL WIRE FABRIC W4.5XW4.5, EPOXY COATED	S.Y.	861
9000-0001	HEAT STRAIGHTEN NORTH GIRDER (S.P.)	L.S.	1
9000-0002	LATEX MODIFIED CONCRETE WEARING SURFACE (S.P.)	C.Y.	50
9000-0003	RAILROAD FLAGMEN (S.P.)	DAYS	20

(S.P.) SPECIAL PROVISION

(1) QUANTITY IN ITEM 8020-0001 GIVEN FOR INFORMATION.

(2) APPROXIMATELY 991 S.F. PAINTING

(3) APPROXIMATELY 565 LBS OF STEEL

(4) UNIT DESIGNATIONS ARE AS PER PUBLICATION 408.

Mark	Description	By	Chk'd	Rec'd	Date
REVISIONS					

**CITY OF PITTSBURGH**  
DEPARTMENT OF PUBLIC WORKS

**CONSTRUCTION DRAWING**  
**RETROFIT OF THE**  
**NORTH AVE BRIDGE**  
**over THE NORFOLK & SOUTHERN R. R.**  
**GENERAL NOTES & QUANTITIES**

SCALE AS NOTED	SHEET NO.	ACCESSION NO. A-5689
DATE 2/8/10	16 OF 24	CASE NO. -----

L:\2009-Jobs\City of Pitt - North Ave\sheet 16.dgn

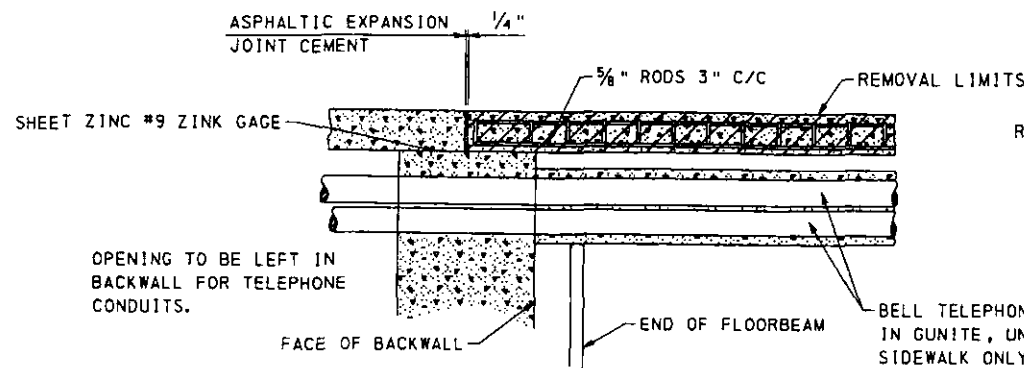

SECTION THRU SIDEWALK  
NORTH ABUTMENT

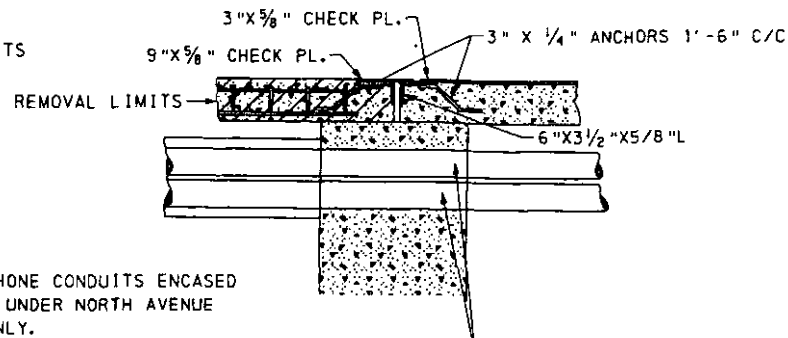

SECTION THRU SIDEWALK  
SOUTH ABUTMENT

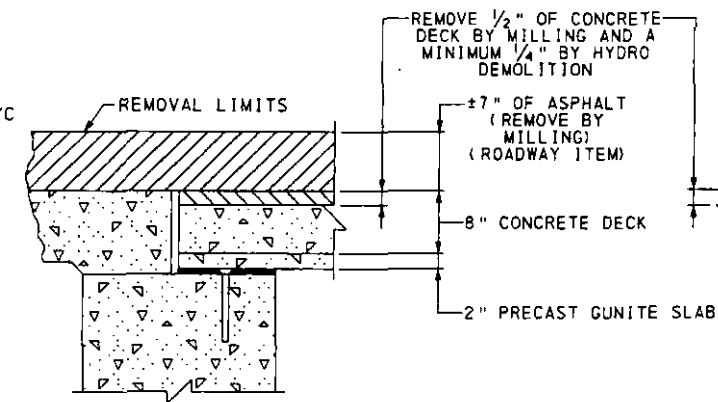

TYPICAL SECTION @ NORTH ABUT.

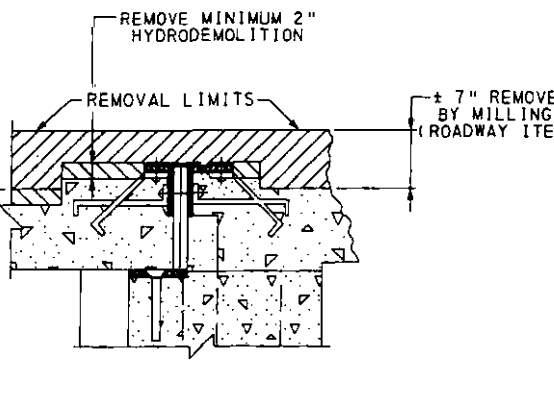

TYPICAL SECTION @ NORTH ABUT.

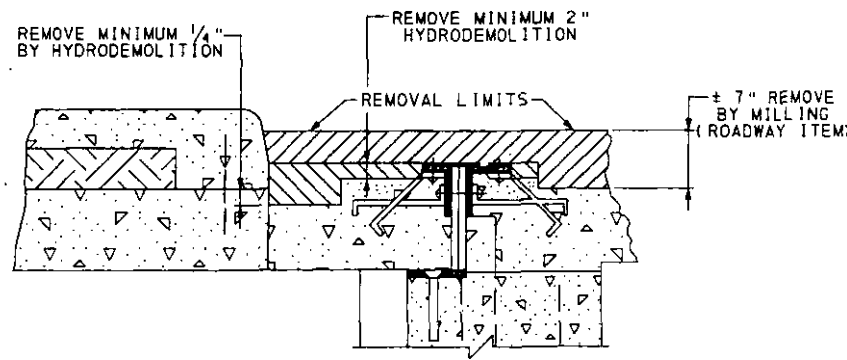

TYPICAL SECTION ADJACENT  
TO ISLAND & SOUTH ABUT.

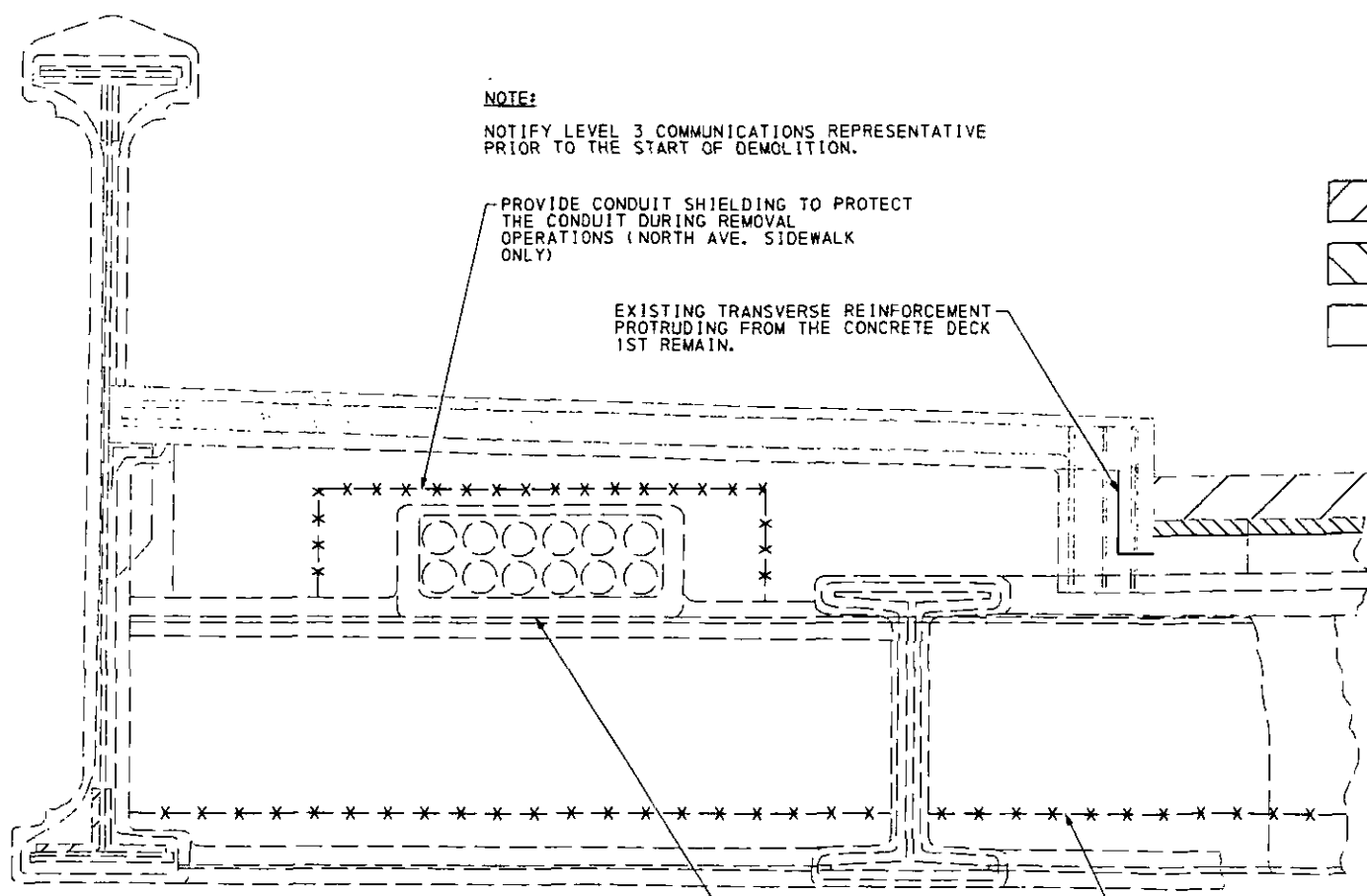

NOTE:  
NOTIFY LEVEL 3 COMMUNICATIONS REPRESENTATIVE  
PRIOR TO THE START OF DEMOLITION.

PROVIDE CONDUIT SHIELDING TO PROTECT  
THE CONDUIT DURING REMOVAL  
OPERATIONS (NORTH AVE. SIDEWALK  
ONLY)

EXISTING TRANSVERSE REINFORCEMENT  
PROTRUDING FROM THE CONCRETE DECK  
1ST REMAIN.

CONDUITS ARE UNDER THE  
NORTH AVE SIDEWALK ONLY

PROVIDE UNDERDECK SHIELDING TO  
PREVENT DEBRIS FROM REMOVAL  
OPERATIONS FROM FALLING ON THE  
RAILROAD PROPERTY BELOW.

LEGEND

- REMOVAL LIMITS (MILLING)
- REMOVAL LIMITS (HYDRO DEMOLITION & MILLING)
- REMOVAL LIMITS

- REMOVE 1/2" OF CONCRETE DECK BY MILLING
- REMOVE 1/4" OF CONCRETE DECK BY HYDRODEMOLITION
- ±7" OF ASPHALT
- 8" CONCRETE DECK
- 2" PRECAST GUNITE SLAB

Mark	Description	By	Chk'd.	Recm'd	Date
REVISIONS					

- NOTES:
- CLEAN ALL EXISTING REINFORCEMENT BARS TO BE RETAINED WITH A WIRE BRUSH OR SAND BLAST. STRAIGHTEN AND COAT WITH AN APPROVED EPOXY PAINT FOR EPOXY COATED EXISTING REINFORCEMENT STEEL OR NEAT CEMENT FOR (NON EPOXY COATED) EXISTING REINFORCEMENT STEEL.
  - REMOVE ALL LOOSE AND DELAMINATED CONCRETE AND ASPHALT TO PROVIDE A SOUND BOND BETWEEN EXISTING CONCRETE AND NEW CONCRETE.
  - APPLY AND EPOXY BONDING COMPOUND BETWEEN THE EXISTING AND THE NEW CONCRETE.

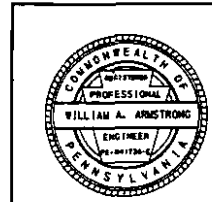

CITY OF PITTSBURGH  
DEPARTMENT OF PUBLIC WORKS

**CONSTRUCTION DRAWING**  
RETROFIT OF THE  
NORTH AVE BRIDGE  
over THE NORFOLK & SOUTHERN R. R.  
REMOVAL LIMITS

SCALE AS NOTED	SHEET NO. 17 OF 24	ACCESSION NO. A-568
DATE 2/8/10	CASE NO. -----	

L:\2009-Jobs\City of Pitt - North Ave\sheet 17.dgn  
9/17/2009 2:28:58 PM

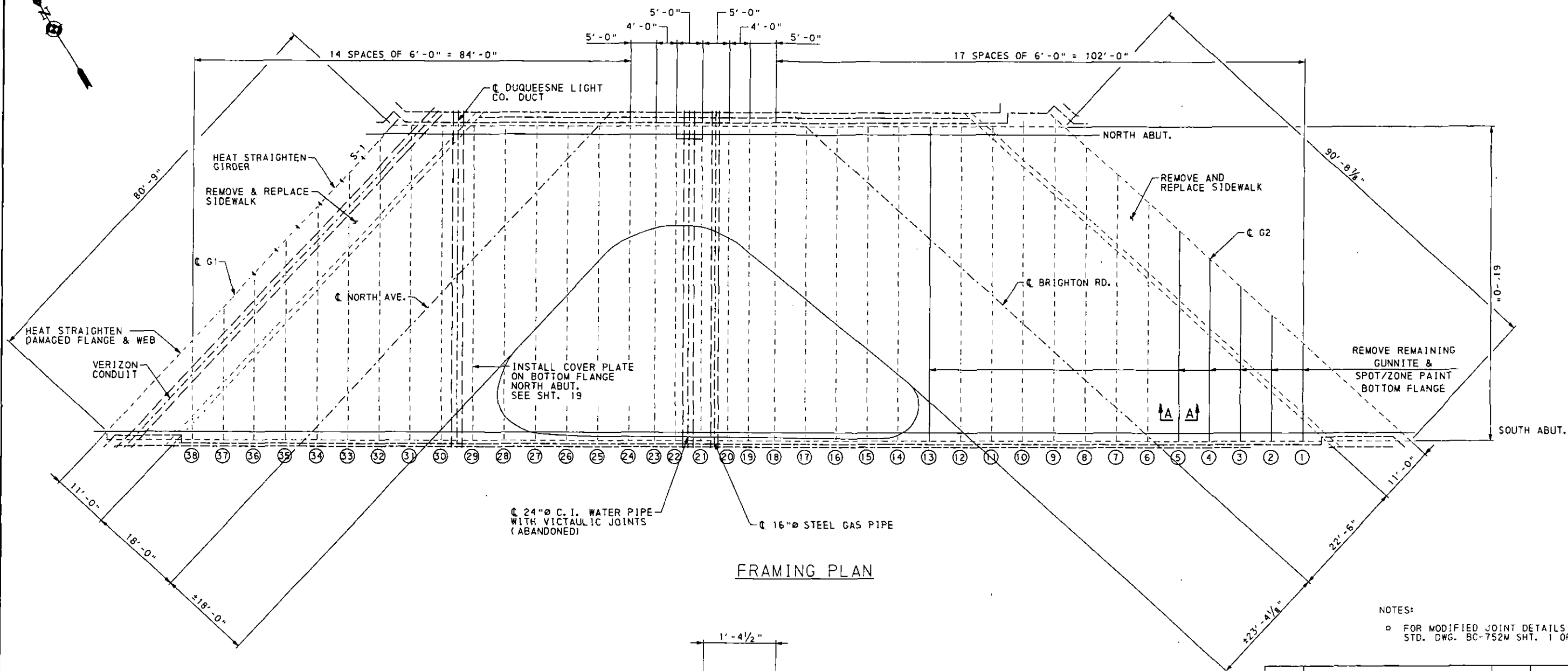

FRAMING PLAN

NOTES:  
 □ FOR MODIFIED JOINT DETAILS SEE PENNDOT STD. DWG. BC-752M SHT. 1 OF 2.

Mark	Description	By	Chk'd.	Rec'd	Date
REVISIONS					

BEAM	AREA (S.F.)
1	72 S.F.
2	94 S.F.
3	112 S.F.
4	135 S.F.
5	154 S.F.
13	229 S.F.
29	75 S.F.
G1	120 S.F.
TOTAL	991 S.F.

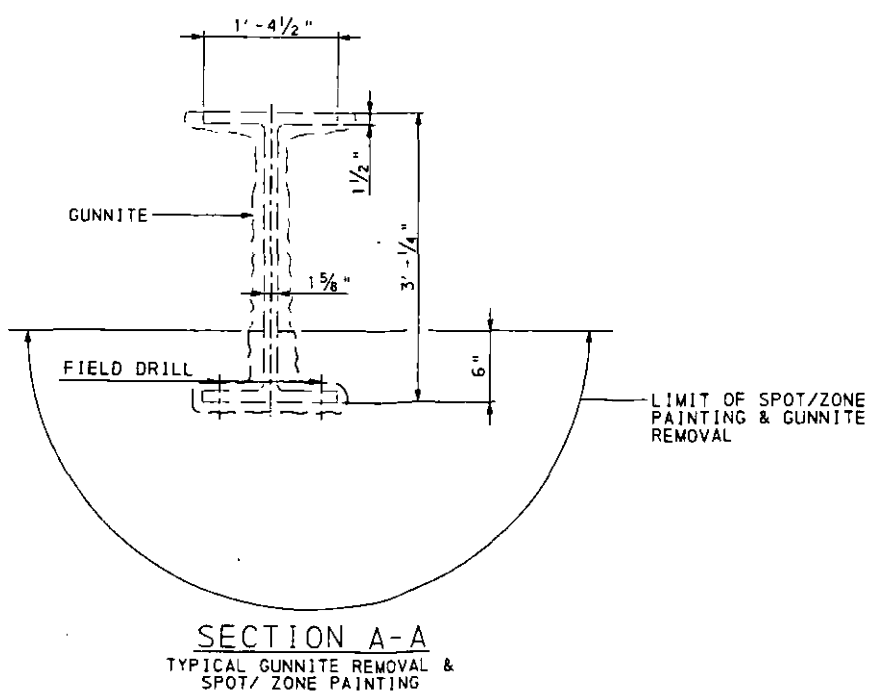

SECTION A-A  
 TYPICAL GUNNITE REMOVAL & SPOT/ZONE PAINTING

**CITY OF PITTSBURGH**  
 DEPARTMENT OF PUBLIC WORKS

**CONSTRUCTION DRAWING**  
 RETROFIT OF THE  
 NORTH AVE BRIDGE  
 over THE NORFOLK & SOUTHERN R.R.  
 FRAMING PLAN

SCALE AS NOTED	SHEET NO. 18 OF 24	ACCESSION NO. A-5689
DATE 2/8/10		CASE NO. -----

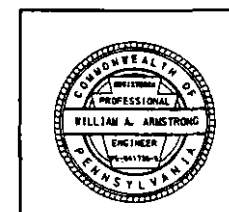

L:\2009-Jobs\City of Pitt - North Ave\Sheet 18.DGN  
 9/11/2009 9:04:24 AM

SOUTH ABUT.

NORTH ABUT.

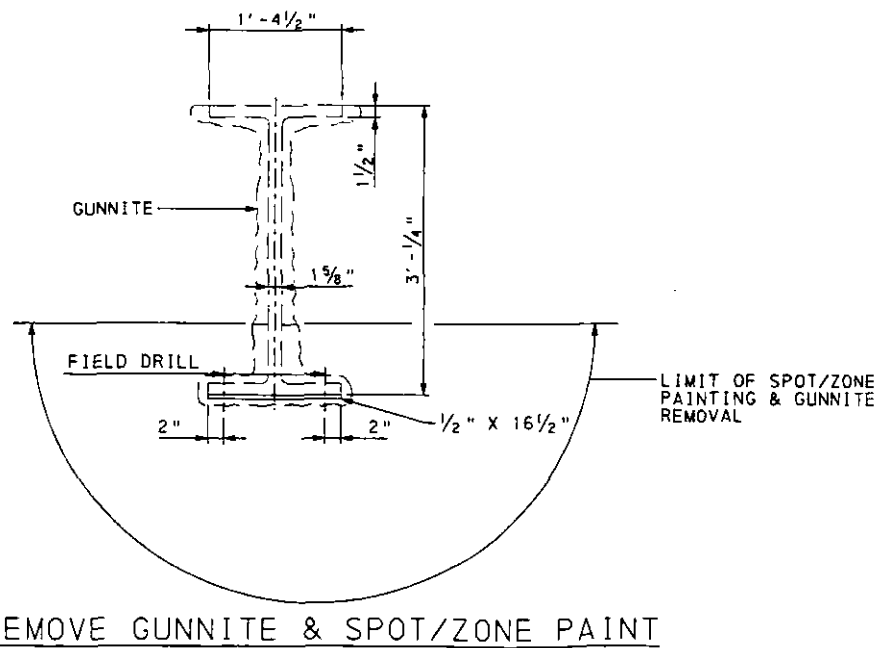
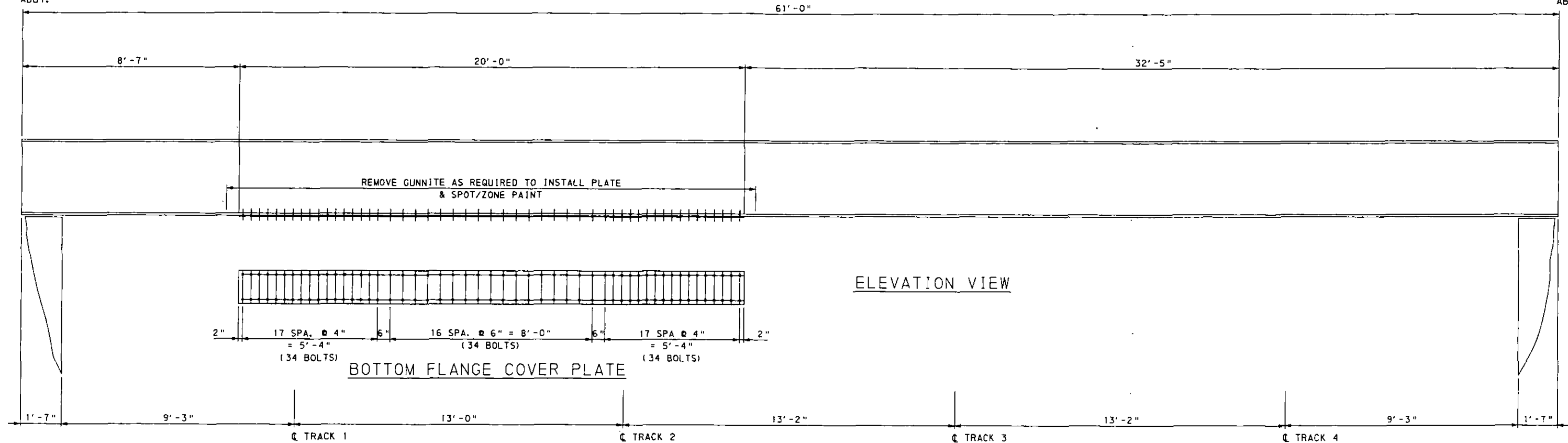

NOTES:

- COORDINATE REPAIRS WITH THE NORFOLK & SOUTHERN RAILROAD
- REMOVE GUNNITE, CLEAN BOTTOM FLANGE & PAINT PRIOR TO INSTALLATION OF THE COVER PLATE
- USE 7/8" DIA. A325 HIGH STRENGTH BOLTS

Mark	Description	By	Chk'd.	Recm'd	Date
REVISIONS					

CITY OF PITTSBURGH  
DEPARTMENT OF PUBLIC WORKS

CONSTRUCTION DRAWING  
RETROFIT OF THE  
NORTH AVE BRIDGE  
over THE NORFOLK & SOUTHERN R.R.  
FLOOR BEAM NO. 29 RETROFIT

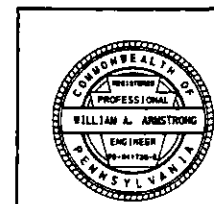

SCALE AS NOTED	SHEET NO. 19 OF 24	ACCESSION NO. A-568
DATE 2/8/10		CASE NO. -----

L:\2009-Jobs\City of Pitt - North Ave\sheet 19.DGN  
9/8/2009 3:49:04 PM

L:\2009-Jobs\City of Pitt - North Ave\sheet 20.DGN  
9/14/2009 10:02:52 AM

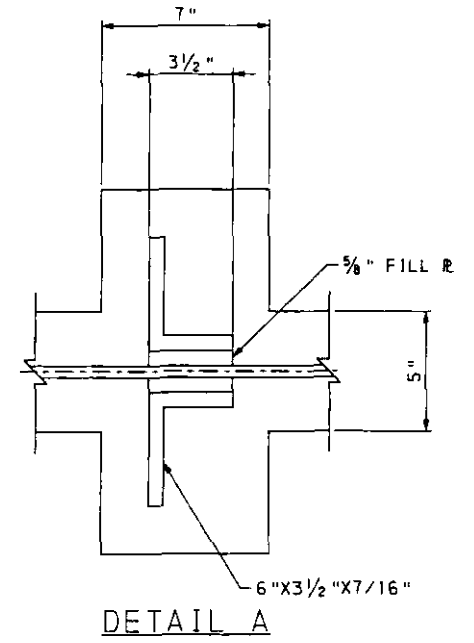
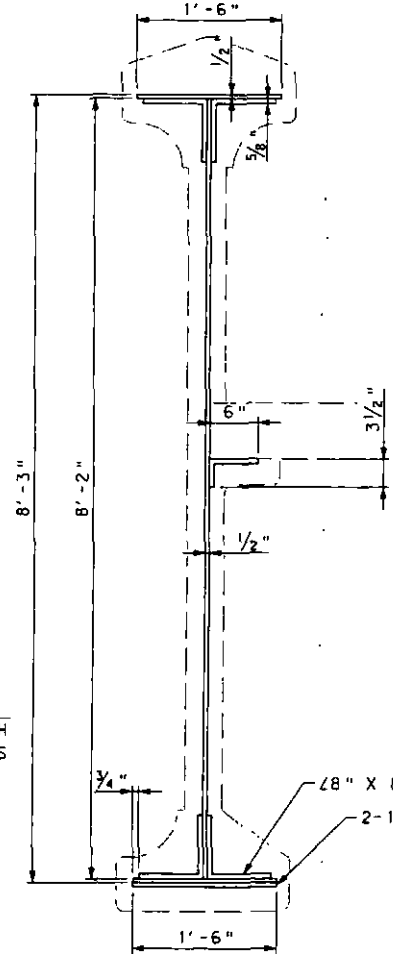
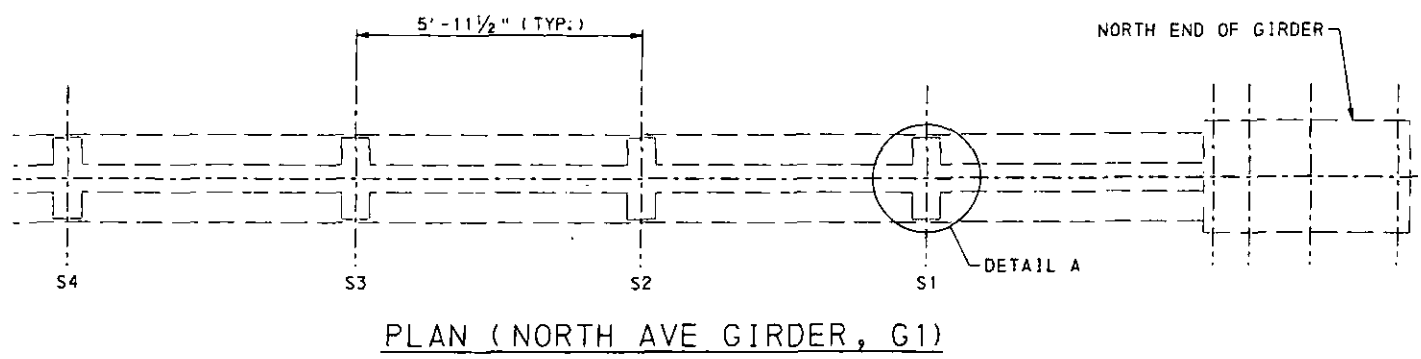
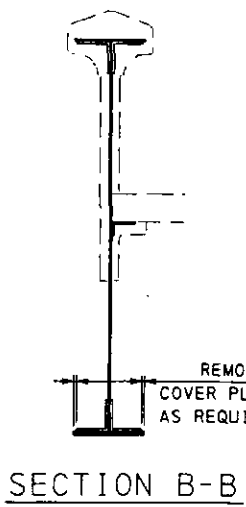
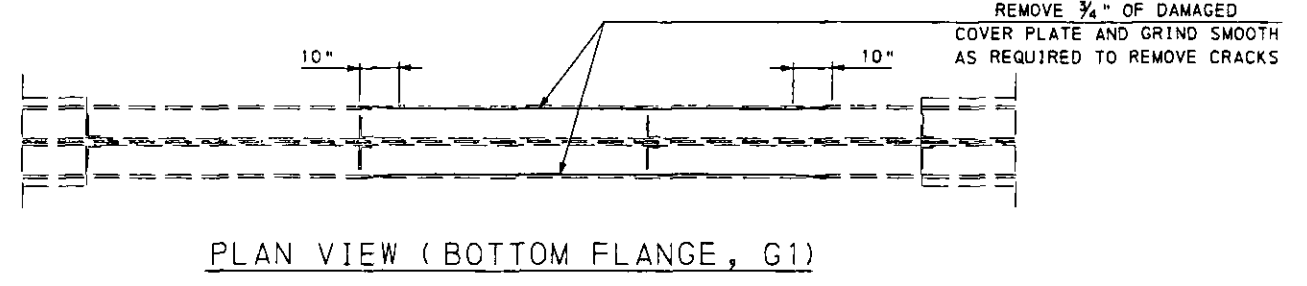
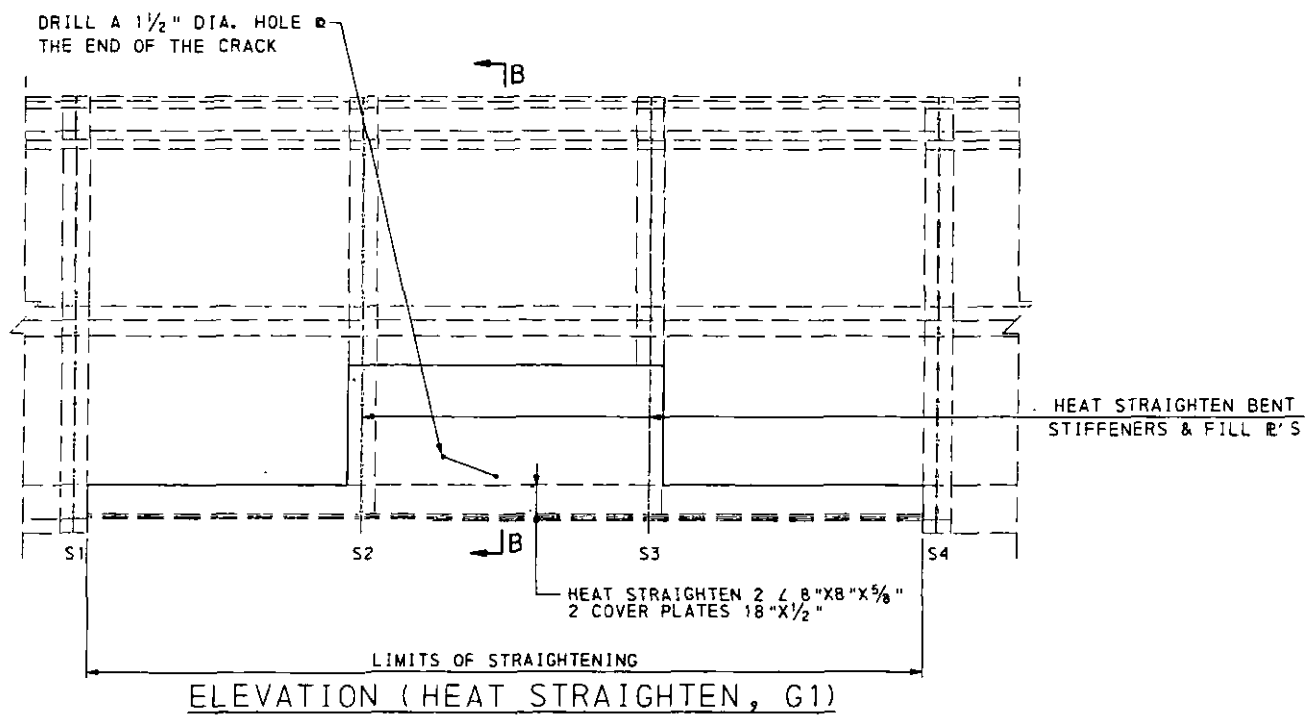
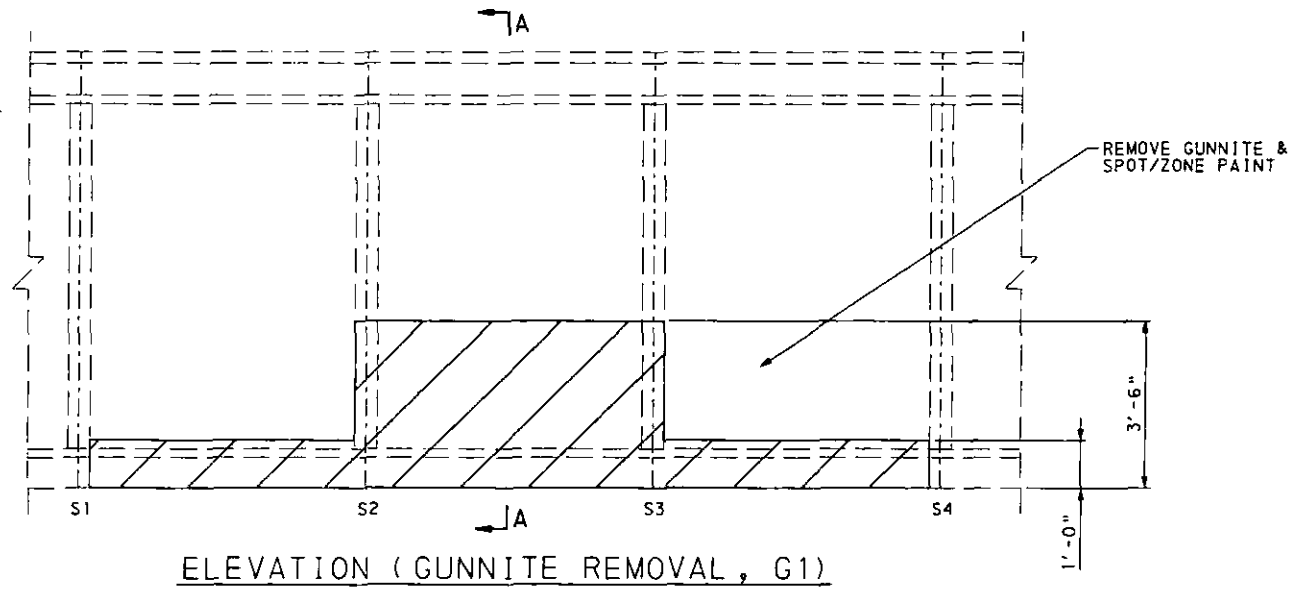

Mark	Description	By	Chk'd.	Rec'd	Date
REVISIONS					

- NOTES:**
- FOR PHOTOS OF DAMAGED GIRDER SEE SPECIAL PROVISION.
  - REPLACE DAMAGED RIVETS WITH HIGH STRENGTH BOLTS.



**CITY OF PITTSBURGH**  
DEPARTMENT OF PUBLIC WORKS

**CONSTRUCTION DRAWING**  
**RETROFIT OF THE**  
**NORTH AVE BRIDGE**  
**over THE NORFOLK & SOUTHERN R.R.**  
**HEAT STRAIGHTEN NORTH AVE.**  
**GIRDER (G1)**

SCALE AS NOTED	SHEET NO. 20 OF 24	ACCESSION NO. A-568
DATE 2/8/10		CASE NO. -----



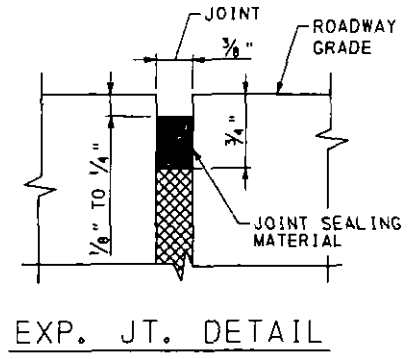
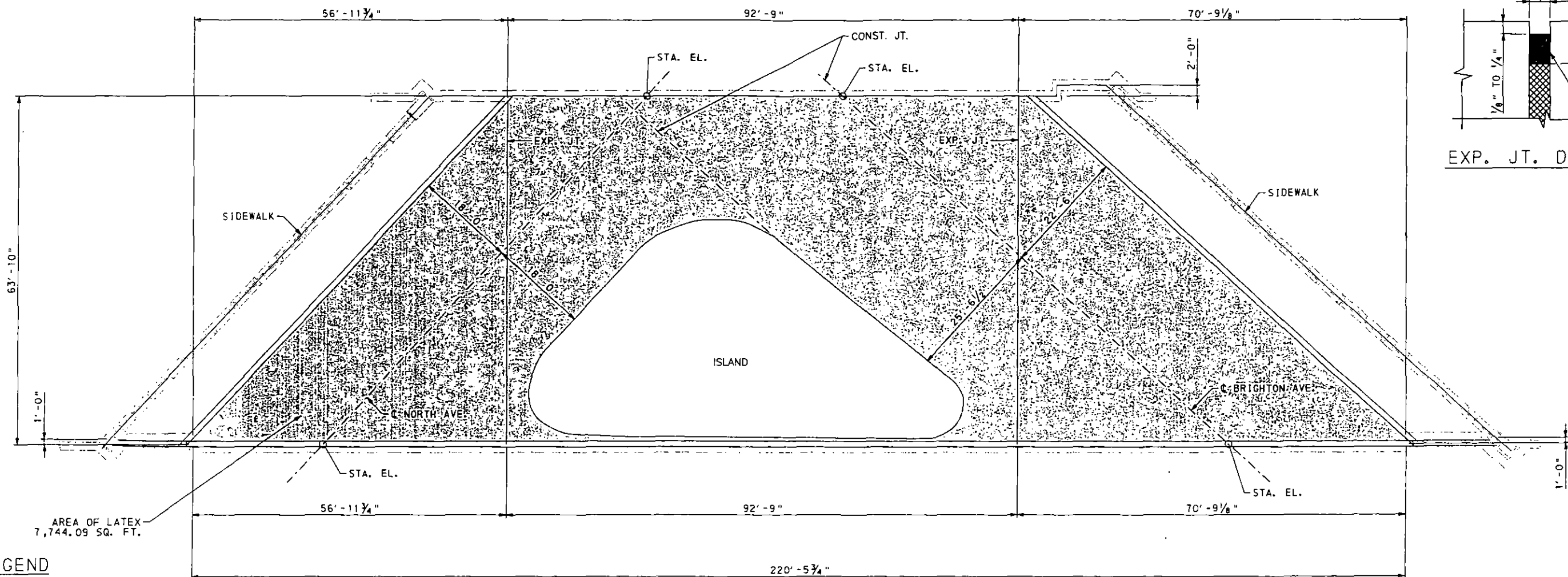

**LEGEND**

- LATEX MODIFIED CONCRETE
- ASPHALT
- 4"x4" STEEL WIRE FABRIC, EPOXY COATED

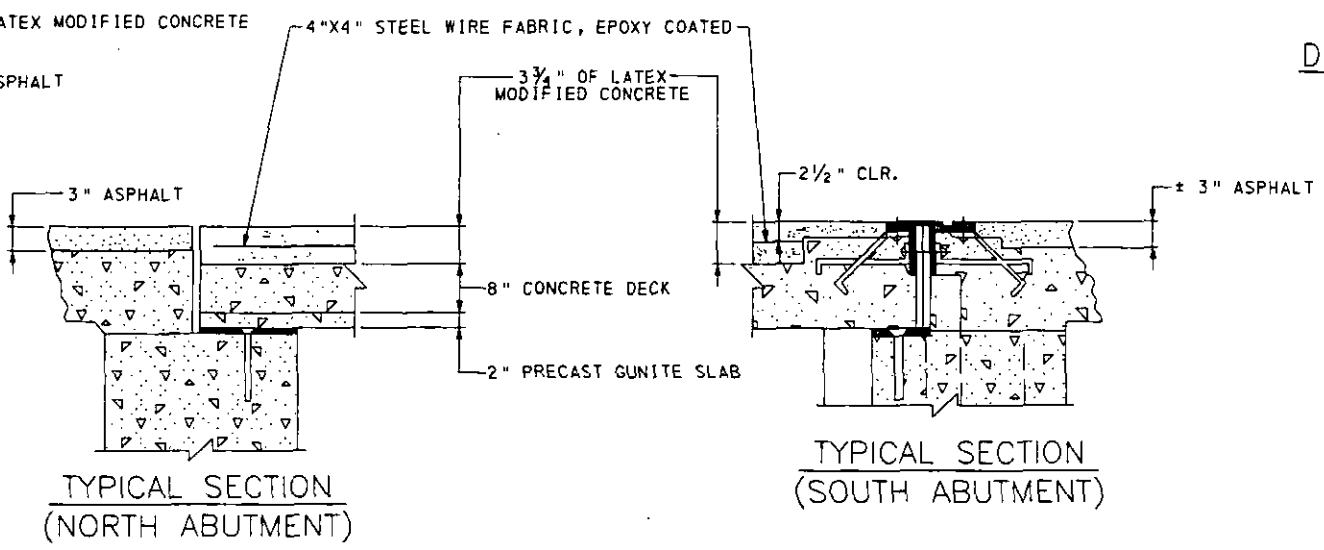

TYPICAL SECTION (NORTH ABUTMENT)

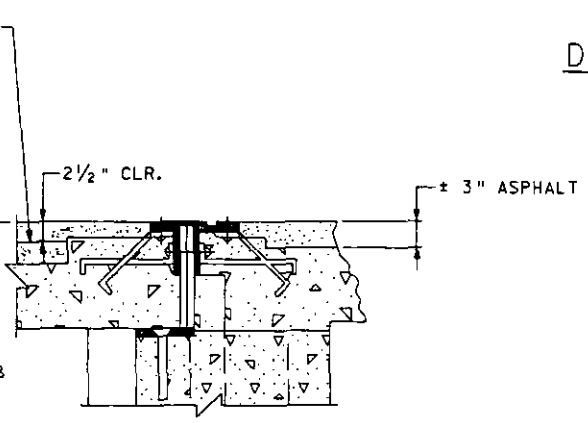

TYPICAL SECTION (SOUTH ABUTMENT)

**DECK PLAN**

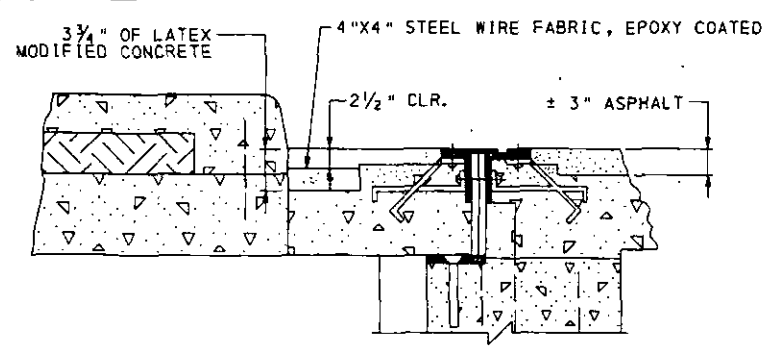

TYPICAL SECTION (SOUTH ABUTMENT) ADJACENT TO ISLAND

- NOTES:**
- LAP LENGTH = 2'-0" FOR STEEL WIRE FABRIC

Mark	Description	By	Chk'd.	Rec'd	Date
REVISIONS					

**CITY OF PITTSBURGH**  
DEPARTMENT OF PUBLIC WORKS

**CONSTRUCTION DRAWING**  
**RETROFIT OF THE**  
**NORTH AVE BRIDGE**  
**over THE NORFOLK & SOUTHERN R. R.**  
**DECK PLAN**

SCALE AS NOTED	SHEET NO. 21 OF 24	ACCESSION NO. A-568
DATE 2/8/10		CASE NO. -----



L:\2009-Jobs\City of Pitt - North Ave\sheet 21.dgn 9/10/2009 11:27:01 PM

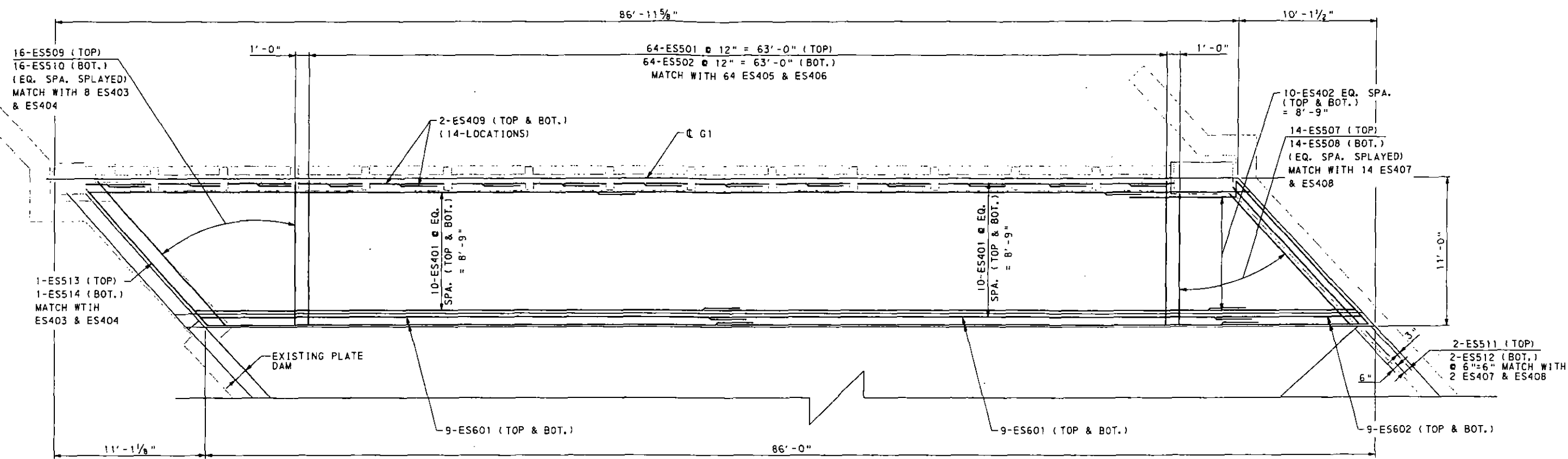

SIDWALK PLAN VIEW (NORTH AVE.)

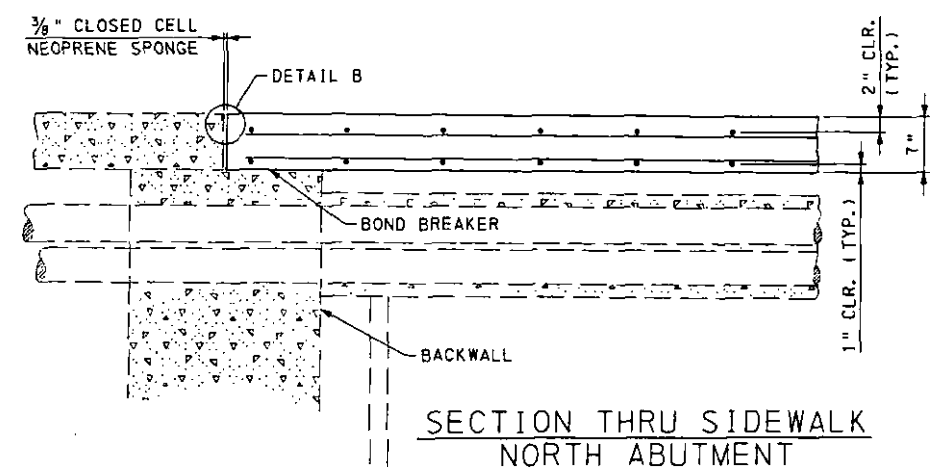

SECTION THRU SIDWALK NORTH ABUTMENT

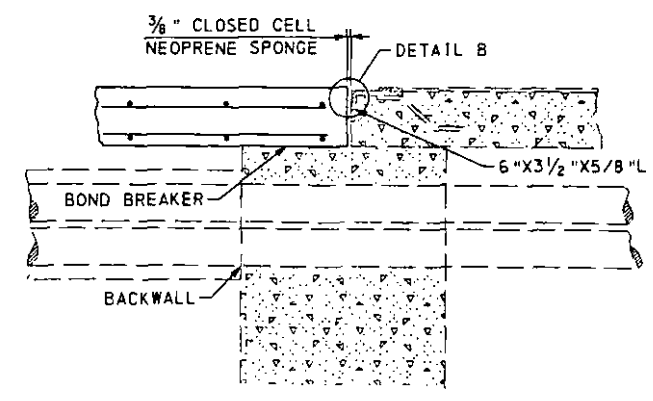

SECTION THRU SIDWALK SOUTH ABUTMENT

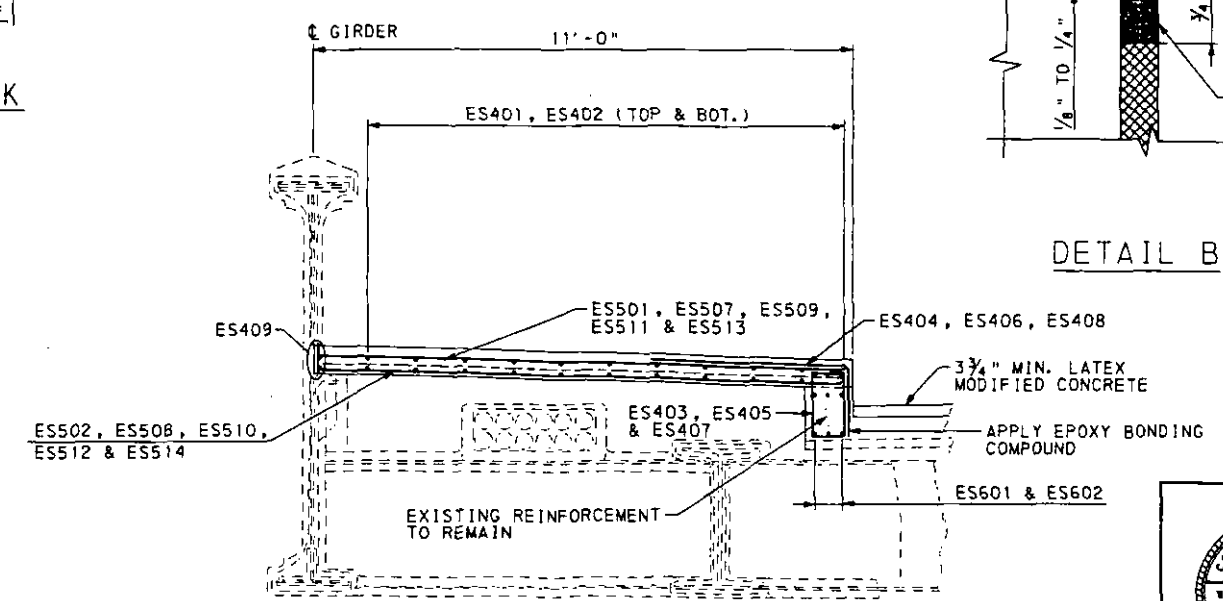

SIDWALK TYP. SECTION NORTH AVE

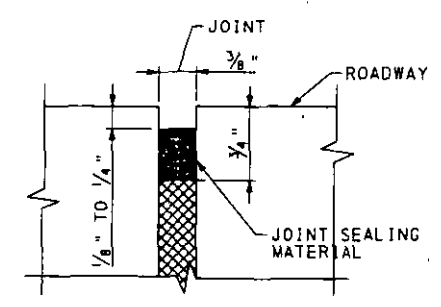

DETAIL B

NOTES:

- APPLY EPOXY COMPOUND CONFORMING TO THE REQUIREMENTS OF SECTION 1040.2 (c) 5 OF THE PUBLICATION 408.
- APPLY AN EPOXY BONDING COMPOUND BETWEEN THE EXISTING AND THE NEW CONCRETE.

Mark	Description	By	Chk'd	Recm'd	Date
REVISIONS					

**CITY OF PITTSBURGH**  
DEPARTMENT OF PUBLIC WORKS

**CONSTRUCTION DRAWING**  
**SIDWALK REPAIR NORTH AVE**  
**NORTH AVE BRIDGE**  
**over THE NORFOLK & SOUTHERN R.R.**  
**NORTH AVE. SIDEWALK (G1)**

SCALE AS NOTED	SHEET NO. 22 OF 24	ACCESSION NO. A-5689
DATE 2/8/10	CASE NO. -----	

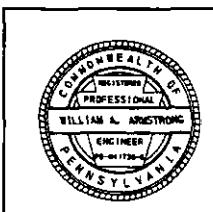

L:\2009-Jobs\City of Pitt - North Ave\sheet 22.dgn 9/10/2009 11:27:01 PM

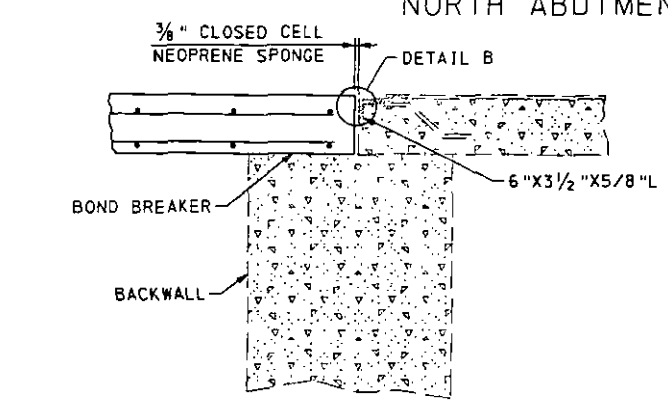
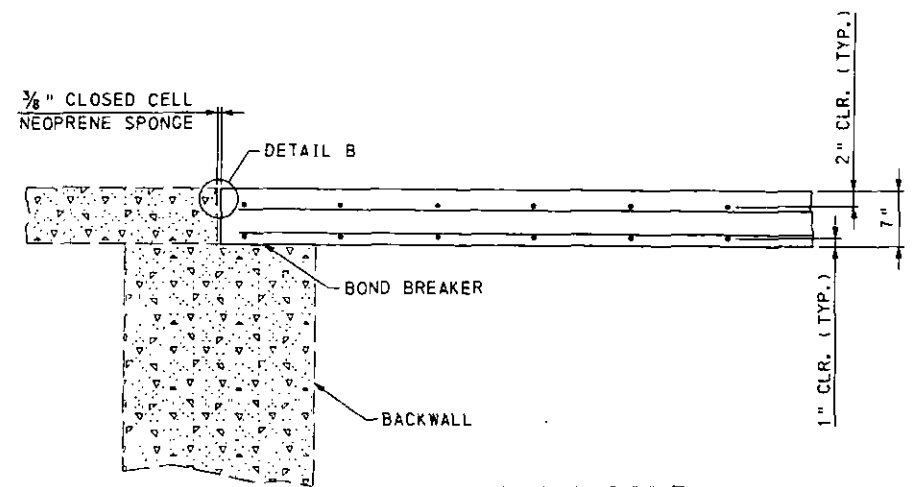
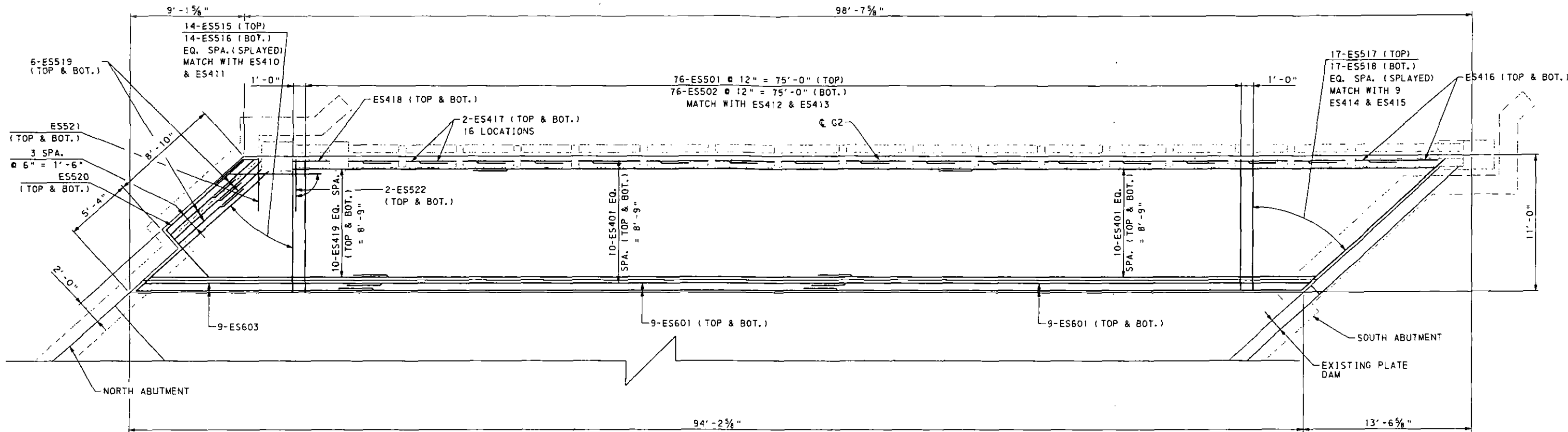

SIDEWALK PLAN VIEW (BRIGHTON AVE.)

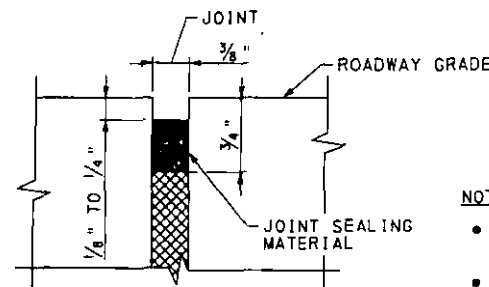

DETAIL B

- NOTES:**
- APPLY EPOXY COMPOUND CONFORMING TO THE REQUIREMENTS OF SECTION 1040.2 (c) 5 OF THE PUBLICATION 40B.
  - APPLY AN EPOXY BONDING COMPOUND BETWEEN THE EXISTING AND THE NEW CONCRETE.

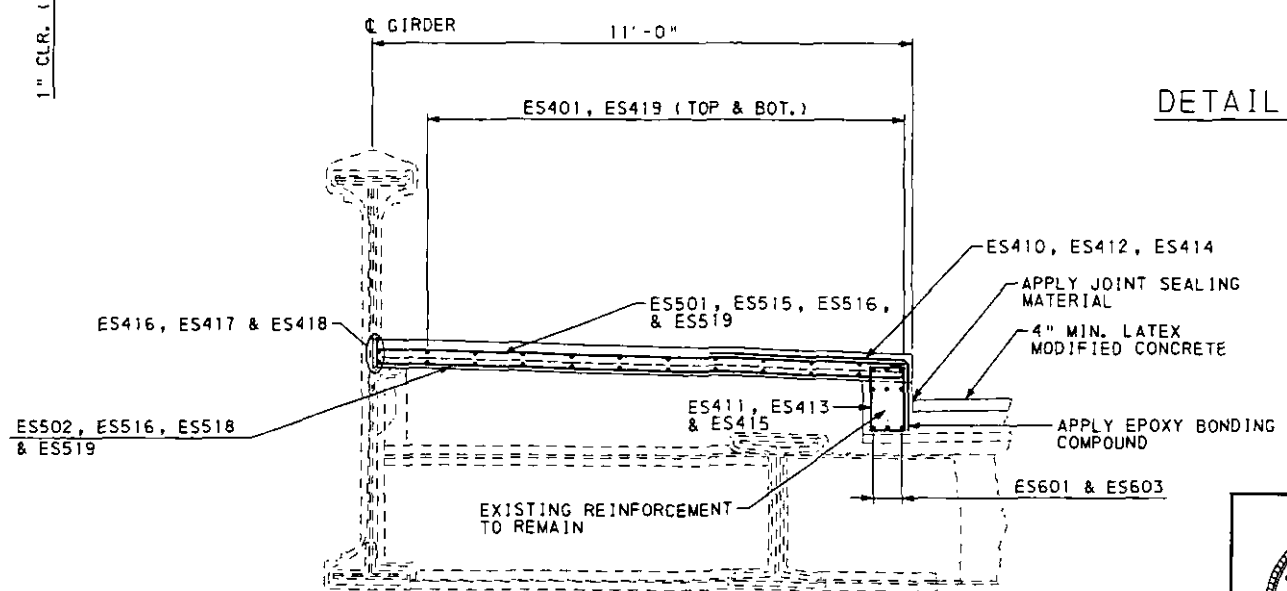

SIDEWALK TYP. SECTION BRIGHTON AVE.

Mark	Description	By	Chk'd	Recm'd	Date
REVISIONS					

**CITY OF PITTSBURGH**  
DEPARTMENT OF PUBLIC WORKS

**CONSTRUCTION DRAWING**  
RETROFIT OF THE  
NORTH AVE BRIDGE  
over THE NORFOLK & SOUTHERN R.R.  
BRIGHTON ROAD SIDEWALK (G2)

SCALE AS NOTED	SHEET NO. 23 OF 24	ACCESSION NO. A-5689
DATE 2/8/10	CASE NO. -----	



L:\2009-Jobs\City of Pitt - North Ave\sheet 23.dgn 9/10/2009 1:27:01 PM

L:\2009-Jobs\City of Pitt - North Ave\sheet 24.dcn  
9/14/2009 10:02:52 AM

MARK	SIZE	BRIGHTON AVE.	NORTH AVE.	LENGTH	TYPE	A	B	C	D	E	REMARKS
ES401	4		40	40'-0"	STR						
ES402	4		20	11'-9"	STR						
ES403	4		8	5'-2"	①	8"	1'-5"				
ES404	4		8	4'-5"	②	3'-0"	1'-5"				
ES405	4		64	4'-4" TO 5'-2"	①	8"	1'-0" TO 1'-5"				
ES406	4		64	4'-0" TO 4'-5"	②	3'-0"	1'-0" TO 1'-5"				
ES407	4		14	4'-4"	①	8"	1'-0"				
ES408	4		14	4'-0"	②	3'-0"	1'-0"				
ES409	4		56	4'-3"	STR						
ES410	4	14		4'-6"	②	3'-0"	1'-6"				
ES411	4	14		5'-4"	①	8"	1'-6"				
ES412	4	76		4'-0" TO 4'-6"	②	3'-0"	1'-0" TO 1'-6"				
ES413	4	76		4'-4" TO 5'-4"	①	8"	1'-0" TO 1'-6"				
ES414	4	9		4'-0"	②	3'-0"	1'-0"				
ES415	4	9		4'-4"	①	8"	1'-0"				
ES416	4	4		4'-9"	STR						
ES417	4	60		3'-9"	STR						
ES418	4	4		2'-10"	STR						
ES419	4	20		13'-0"	STR						
ES501	5		64	10'-6"	STR						
ES502	5		64	11'-1"	③	7"	10'-6"				
ES507	5		14	9'-6" TO 13'-0"	STR						
ES508	5		14	10'-1" TO 13'-7"	③	7"	9'-6" TO 13'-0"				
ES509	5		16	10'-6" TO 14'-0"	STR						
ES510	5		16	11'-1" TO 14'-7"	③	7"	10'-6" TO 14'-0"				
ES511	5		2	13'-8" TO 14'-3"	STR						
ES512	5		2	14'-3" TO 14'-10"	③	7"					
ES513	5		1	13'-3"	STR						
ES514	5		1	13'-10"	③	7"	13'-3"				
ES515	5	14		9'-8" TO 14'-4"	STR						
ES516	5	14		10'-3" TO 14'-11"	③	7"	9'-8" TO 14'-4"				
ES517	5	17		10'-6" TO 15'-8"	STR						
ES518	5	17		11'-1" TO 16'-3"	③	7"	10'-6" TO 15'-8"				
ES519	5	12		6'-8"	STR						
ES520	5	2		13'-4"	②	8'-4"	5'-0"				
ES521	5	2		8'-1"	④	3'-6"	1'-1"	3'-6"	2'-4"		
ES522	5	4		4'-3"	STR						
ES601	6	18	18	40'-0"	STR						
ES602	6		9	13'-0"	STR						
ES603	6	9		21'-0"	STR						

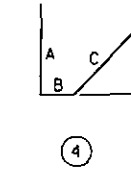
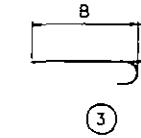
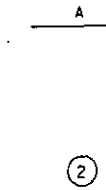
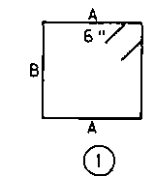

**NOTES**

- ALL REINFORCEMENT BARS ARE GRADE 60.
- ALL REINFORCEMENT BARS DESIGNATED WITH AN "E" ARE EPOXY COATED
- "J" DIMENSIONS ON 180° HOOKS TO BE SHOWN ONLY WHERE NECESSARY TO RESTRICT HOOK SIZE. OTHERWISE STANDARD HOOKS ARE TO BE USED.
- FOR REINFORCEMENT BAR FABRICATION DETAILS, REFER TO STANDARD DRAWING BC-736M.
- FIGURES IN CIRCLES SHOW TYPES.
- REINFORCEMENT BAR SCHEDULE IS FOR INFORMATION ONLY. VERIFY REINFORCEMENT BAR SCHEDULE PRIOR TO FABRICATION.
- FOR ALL BAR TYPES SHOWN, DIMENSIONS AND LENGTH ARE MEASURED ALONG THE OUTSIDE OF THE BAR.
- FOR GENERAL NOTES SEE SHEET 16

Mark	Description	By	Chk'd	Rec'd	Date
REVISIONS					

**CITY OF PITTSBURGH**  
DEPARTMENT OF PUBLIC WORKS

**CONSTRUCTION DRAWING**  
**RETROFIT OF THE**  
**NORTH AVE BRIDGE**  
**over THE NORFOLK & SOUTHERN R.R.**  
**SUPERSTRUCTURE REBAR SCHEDULE**

SCALE AS NOTED	SHEET NO. 24 OF 24	ACCESSION NO. A-568
DATE 2/8/10	CASE NO. -----	

