



May 9, 2019

Ms. Rosemary Chiavetta, Secretary  
Pennsylvania Public Utility Commission  
P.O. Box 3265  
Harrisburg, PA 17105-3265

Re: Application of the Department of Transportation of the Commonwealth of Pennsylvania for approval to alter the public below grade crossing by widening State Route 0051 which crosses under the track of Wheeling & Lake Erie Railway Company (DOT Number 472 722 J) in Rostraver Township, Westmoreland County and the allocation of costs incident thereto.

Dear Secretary, Chiavetta:

Enclosed for filing, please find the Application of the Department of Transportation.

A copy of this Application and Exhibits has been served upon the parties in the Certificate of Service to the Application.

Sincerely,

A handwritten signature in blue ink that reads "Thomas A. Ryzek Jr." The signature is written in a cursive style with a large, prominent initial 'T'.

Thomas A. Ryzek Jr.  
District Grade Crossing Administrator  
Engineering District 12-0  
Department of Transportation

Attachments

cc: Parties of Record  
Michelle L. Adolini, P.E., Right-of-Way and Utilities Section, 7<sup>th</sup> Floor, CKB  
Gina M. D'Alfonso, Office of Chief Counsel, 9<sup>th</sup> Floor, CKB  
Ron Hull, P.E., Rail Safety Engineering Section PUC, 3<sup>rd</sup> Floor, CKB

**BEFORE THE  
PENNSYLVANIA PUBLIC UTILITY COMMISSION**

Application of the Department of Transportation of the Commonwealth of Pennsylvania for approval to alter the public below grade crossing by widening State Route 0051 which crosses under the track of Wheeling & Lake Erie Railway Company (DOT Number 472 722 J) in Rostraver Township, Westmoreland County and the allocation of costs incident thereto.

Application  
Docket No. \_\_\_\_\_

**Electronically Filed**

To the Pennsylvania Public Utility Commission:

1. The name and address of Applicant Commonwealth of Pennsylvania, Department of Transportation, Rachel D. Duda, P.E., Assistant District Executive, Engineering District 12-0, P.O. Box 459, 825 North Gallatin Avenue, Uniontown, PA 15401.
2. The name and address of attorney for the Applicant are Jason D. Sharp, Chief Counsel, Commonwealth of Pennsylvania, Department of Transportation, Office of Chief Counsel, PO Box 8212, Harrisburg, PA 17105-8212.
3. The Applicant is an agency of Commonwealth of Pennsylvania, organized and existing under the Administrative Code of 1929, 71 P.S. § 511, et seq. and generally 36 P.S. § 670 - 401 et seq.
4. The names and addresses of the persons, parties and entities concerned in, or affected by the proposed construction, to the best of the Applicant's knowledge, are shown in the certificate of service. In addition to those served, the Applicant requests that the following also receive service of all documents in this matter:

Michelle L. Adolini P.E., Acting Chief  
Utilities and Right of Way Section  
Pennsylvania Department of Transportation  
P.O. Box 3362  
Harrisburg, PA 17105-3362

Gina M. D'Alfonso Senior Counsel in Charge  
Office of Chief Counsel  
Pennsylvania Department of Transportation  
P.O. Box 8212  
Harrisburg, PA 17105-8212

5. As part of the Department's interchange improvement project for State Route 0070, Section E10 and State Route 0051 it is desirable to reconstruct and widen the existing State Route 0051 where it crosses below the tracks of the Wheeling & Lake Erie Railway Company. State Route 0051 currently has a total width of 47 feet with two 12-foot travel lanes, two 11-foot passing lanes and a one-foot median and will be widened to a width of 84 feet to accommodate four twelve-foot travel lanes, 16-foot median/turn lanes and two 10-foot outside shoulders. State Route 0051 crosses under the single track of Wheeling & Lake Erie Railway Company at Segment 0040 Offset 1688 North Bound, Segment 0041 Offset 1655 South Bound. The existing Wheeling & Lake Erie Railway Company structure, a steel riveted I-beam bridge with a length of 54.5 feet and a width of 10 feet will be replaced on new alignment (approximately 50 feet north of the current crossing)

with a steel thru-girder structure with a length of 111 feet and a width of 26.6 feet. A Location Map is attached hereto and is marked as Exhibit "A". A copy of the Preliminary Roadway Plans has been attached hereto and is marked as Exhibit "B".

6. The average daily traffic for State Route 0051 is 19,320 vehicles with 11% trucks.
7. The estimated total cost for the project is \$125 million and estimated cost for the new railroad bridge is \$7.2 million. The funding for the project will be 100% federal funds.
8. This project is necessary and proper for the safety and convenience of the public.
9. A conference of all parties of interest should be held to discuss the proposed improvement.

Wherefore, Applicant respectfully requests that the Public Utility Commission approve this application:

Respectfully Submitted:

Dated: 05/09/2019

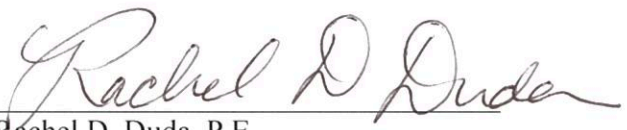
  
Rachel D. Duda, P.E.  
Assistant District Executive – Design  
Engineering District 12-0  
Department of Transportation  
825 N. Gallatin Ave.  
Uniontown, PA 15401  
Phone (724) 429-7259  
Fax (724) 430-4401

**BEFORE THE  
PENNSYLVANIA PUBLIC UTILITY COMMISSION**

Application of the Department of Transportation of the Commonwealth of Pennsylvania for approval to alter the public below grade crossing by widening the State Route 0051 which crosses under the track of Wheeling & Lake Erie Railway Company (DOT Number 472 722 J) in Rostraver Township, Westmoreland County and the allocation of costs incident thereto.

Application  
Docket No. \_\_\_\_\_

**Electronically Filed**

CERTIFICATE OF SERVICE

I hereby certify that I have this day served a true copy of the foregoing document upon the participants listed below, in accordance with the requirements of 52 Pa. Code § 1.54, by first class mail, postage prepaid:

Mr. Kasey O'Connor  
Vice President Engineering  
Wheeling & Lake Erie Railway  
100 East First Street  
Brewster, Ohio 44613

Ms. Ann C. Scott  
Rostraver Township Sewage Authority  
1744 Rostraver Road  
Belle Vernon, PA 15012

Ms. Vera Spina  
Westmoreland County Commissioners  
101 Courthouse Square  
2 North Main Street  
Greensburg, PA 15601

Ms. Christine Smith  
West Penn Power  
401 Coyle Curtain Road  
Monongahela, PA 15063

Ms. Pamela S. Beard  
Rostraver Township  
201 Municipal Drive  
Belle Vernon, PA 15012

Mr. Keith Fowler  
Verizon PA, LLC  
41 East Beau Street  
Washington, PA 15301

Mr. Curt Fontaine  
Municipal Authority of  
Westmoreland County  
P. O. Box 730  
Greensburg, PA 15601

Mr. Joseph (Joby) Lapkowicz  
Columbia Gas of PA  
1452 Gun Club Road  
Uniontown, PA 15401

Mr. Eric Teeter  
Atlantic Broadband  
320 Bailey Ave  
Uniontown, PA 15401

Dated this 9 Day of May, 2019

  
Thomas A. Ryczek Jr.  
District Grade Crossing Administrator

**BEFORE THE  
PENNSYLVANIA PUBLIC UTILITY COMMISSION**

Application of the Department of Transportation of the Commonwealth of Pennsylvania for approval to alter the public below grade crossing by widening State Route 0051 which crosses under the track of Wheeling & Lake Erie Railway Company (DOT Number 472 722 J) in Rostraver Township, Westmoreland County and the allocation of costs incident thereto.

Application  
Docket No. \_\_\_\_\_

**Electronically Filed**

VERIFICATION

I, Thomas A. Ryczek Jr., hereby state that the facts above set forth are true and correct to the best of my knowledge, information and belief and that I expect to be able to prove the same at a hearing held in this matter. I understand that the statements herein are made subject to the penalties of 18 Pa.C.S. §4904 (relating to unsworn falsification to authorities).

Date: 9/5/19

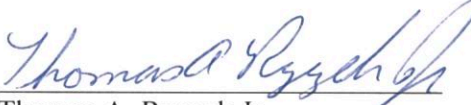
  
Thomas A. Ryczek Jr.  
District Grade Crossing Administrator

**WESTMORELAND COUNTY  
ROSTRAVER TOWNSHIP  
STATE ROUTE 70, SECTION E10  
DOT # 472 722 J**

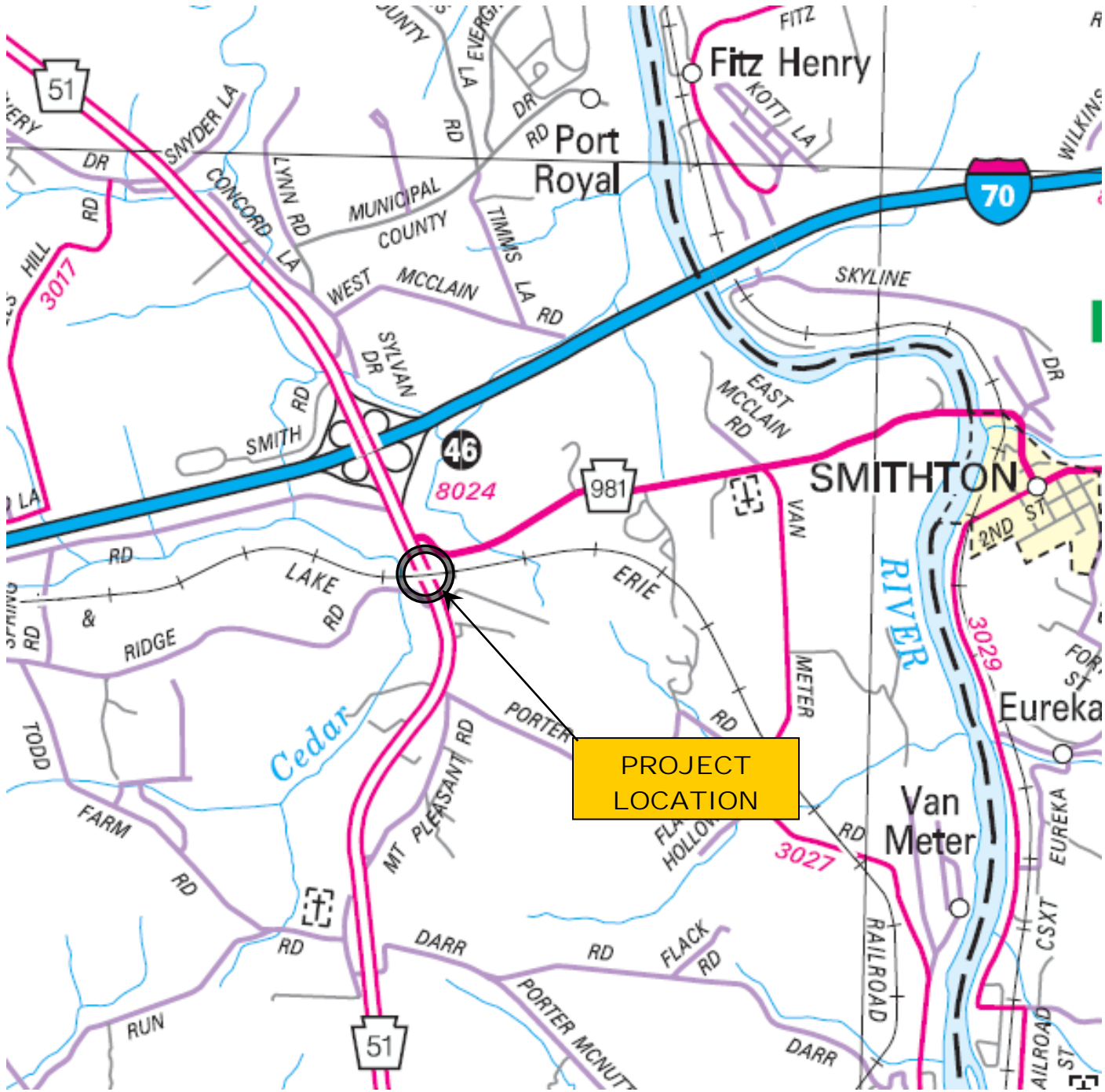

**LOCATION MAP - EXHIBIT "A"  
Sheet 1 of 1**

DISTRICT	COUNTY	ROUTE	SECTION	SHEET
12-0	WESTMORELAND	0070	E10	1 OF 7
ROSTRAVER TOWNSHIP				
REVISION NUMBER	REVISIONS	DATE	BY	

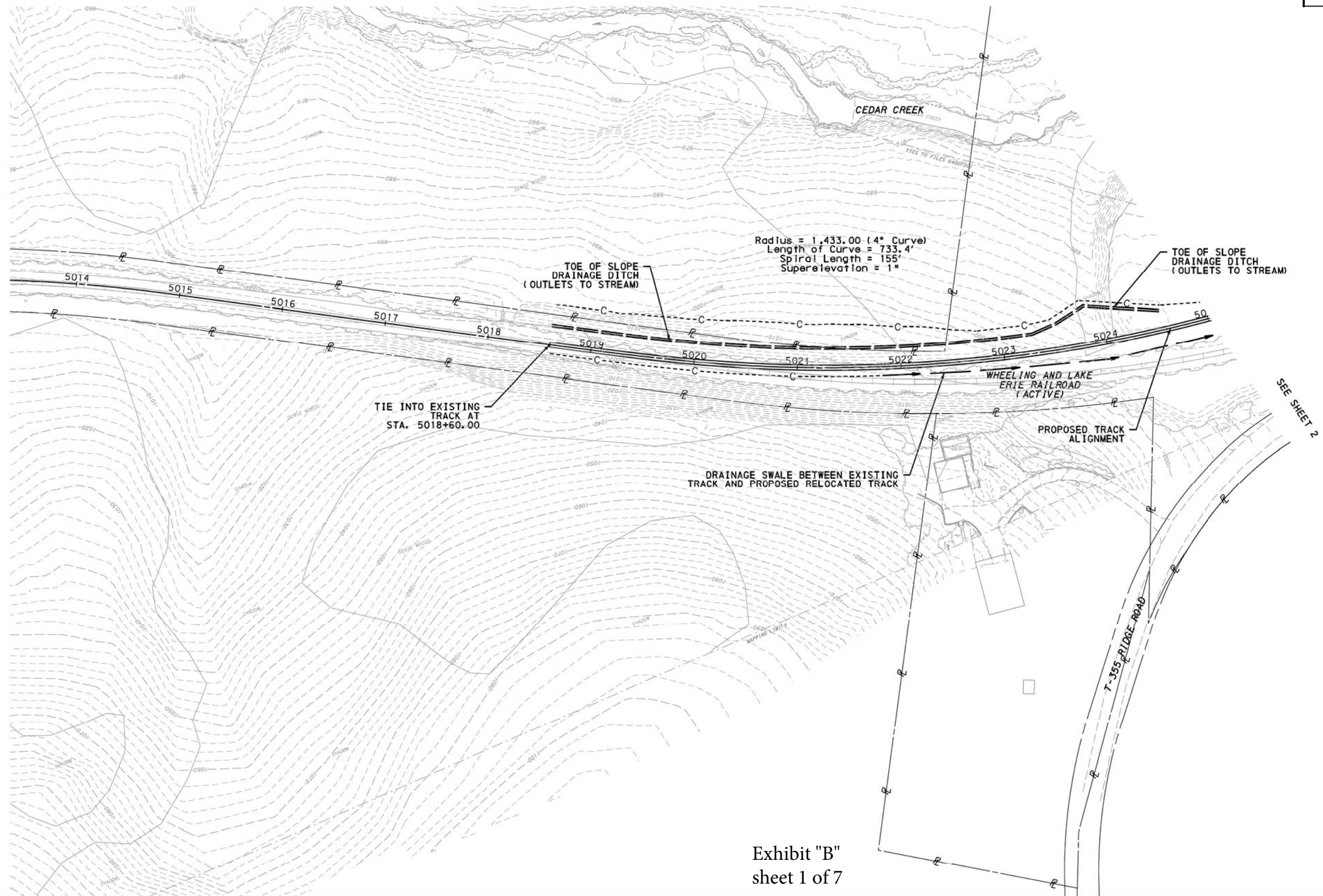

FILE: P:\1919\191902\corporate\gannett\leming.com\GFM02\Documents\Project\636\OUTPUT\COMP\_01\CIVIL\ROAD\1-70 E10 50sc RR Northern Shift\01 Bk.dgn  
 DATE: 3/19/2019 TIME: 2:53:34 PM

Exhibit "B"  
sheet 1 of 7

PRELIMINARY  
FEB. 6, 2019

**LEGEND**

	PROPERTY LINE
	LEGAL RIGHT-OF-WAY LINE
	CONCEPTUAL FILL LIMIT
	CONCEPTUAL CUT LIMIT

S.R. 0070, SECTION E10  
I-70 / S.R. 51 INTERCHANGE



WHEELING AND LAKE ERIE RAILROAD  
NORTHERN SHIFT (40 MPH)



DISTRICT	COUNTY	ROUTE	SECTION	SHEET
12-0	WESTMORELAND	0070	E10	2 OF 7
ROSTRAVER TOWNSHIP				
REVISION NUMBER	REVISIONS	DATE	BY	

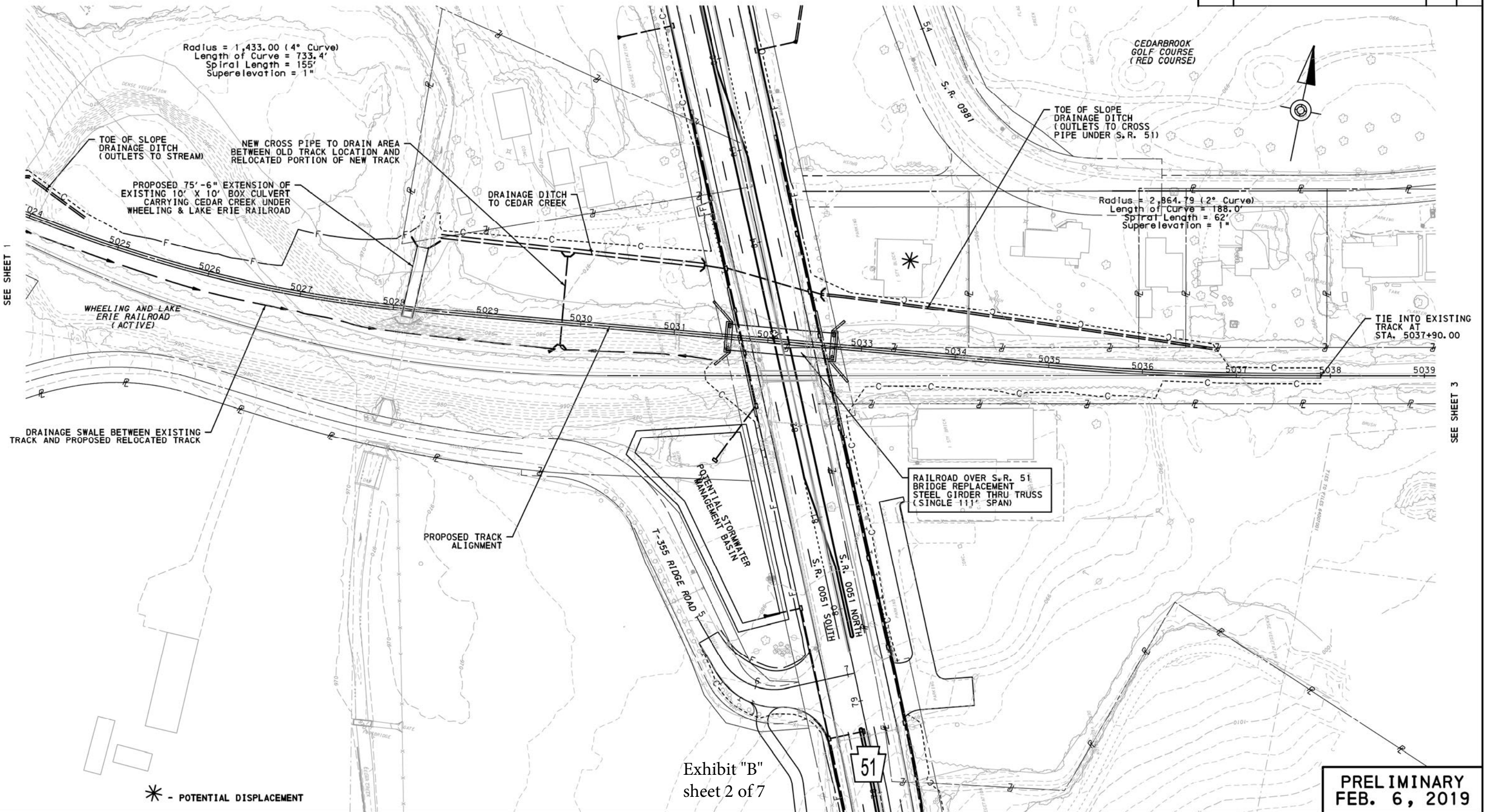

SEE SHEET 1

SEE SHEET 3

\* - POTENTIAL DISPLACEMENT

**LEGEND**

— P —	PROPERTY LINE
---	LEGAL RIGHT-OF-WAY LINE
-F-	CONCEPTUAL FILL LIMIT
-C-	CONCEPTUAL CUT LIMIT

Exhibit "B"  
sheet 2 of 7

**PRELIMINARY**  
FEB. 6, 2019

**S.R. 0070, SECTION E10**  
**I-70 / S.R. 51 INTERCHANGE**



**WHEELING AND LAKE ERIE RAILROAD**  
**NORTHERN SHIFT (40 MPH)**







Dist.	County	Route	Sect.	Prelim. Bk. No.	Final Bk. No.	Sheet No.
12-0	WESTMORELAND	0070	E10			5 OF 7

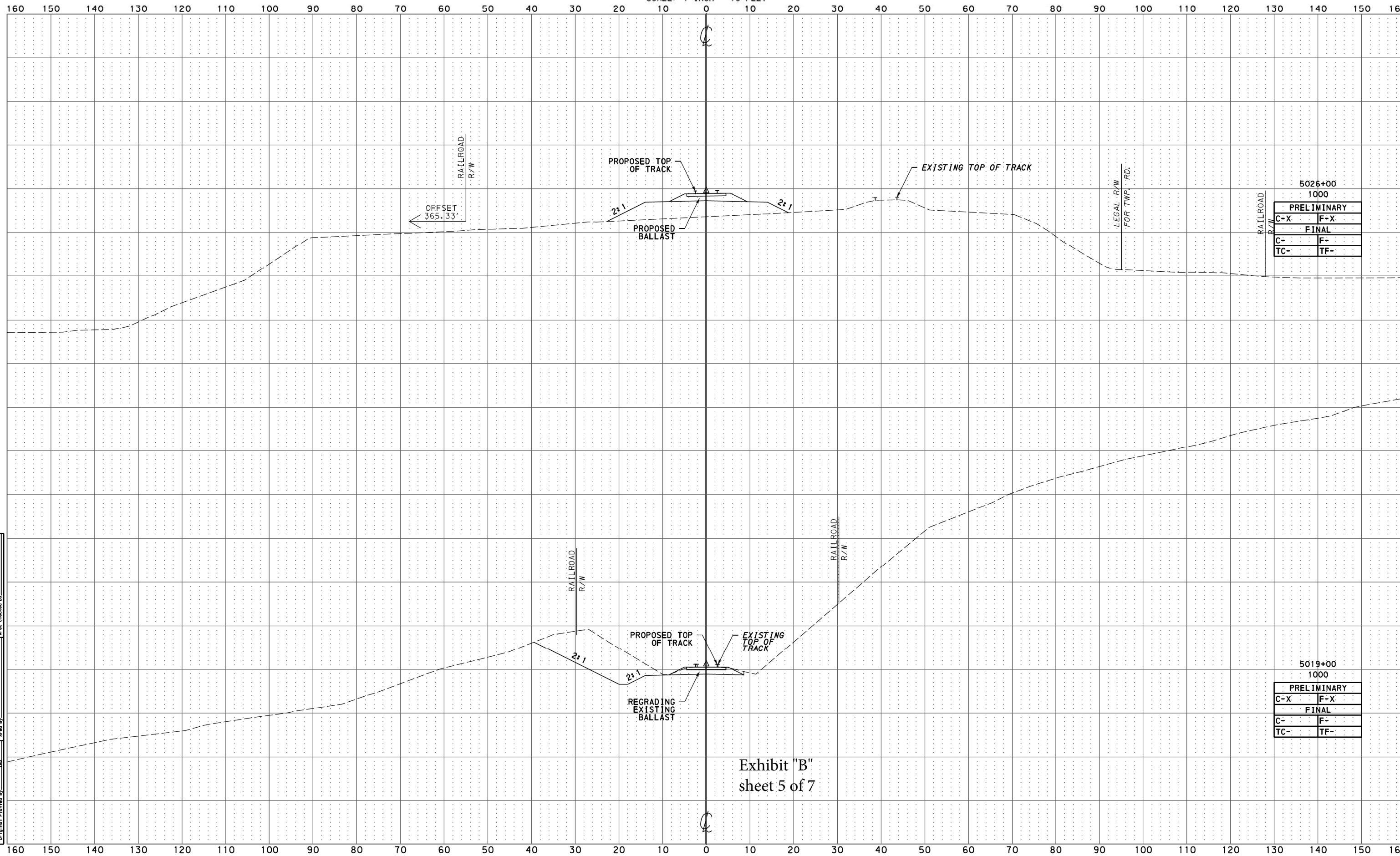

Application No. \_\_\_\_\_  
 Route No. SB-000  
 Original Plotted By: JTB  
 Original Checked By: JTB  
 Final Plotted By: JTB  
 Final Checked By: JTB  
 Area By: \_\_\_\_\_  
 Area Checked By: \_\_\_\_\_  
 FILE: D:\GDP\reg02\_corporate\_gm\trf\em\ing.com\GPM02\Documents\Proj\ects\1636\OUTPUT\_COMP\_01\CIVIL\ROAD\SR70-E10\_Railroad\_XS\_Sheets.dgn  
 DATE: 2/6/2019 11:24:13 AM

Application No. \_\_\_\_\_  
 Route No. SB-000  
 Original Plotted By: JTB  
 Original Checked By: JTB  
 Final Plotted By: JTB  
 Final Checked By: JTB  
 Area By: \_\_\_\_\_  
 Area Checked By: \_\_\_\_\_

Dist.	County	Route	Sect.	Prelim. Bk. No.	Final Bk. No.	Sheet No.
12-0	WESTMORELAND	0070	E10			6 OF 7

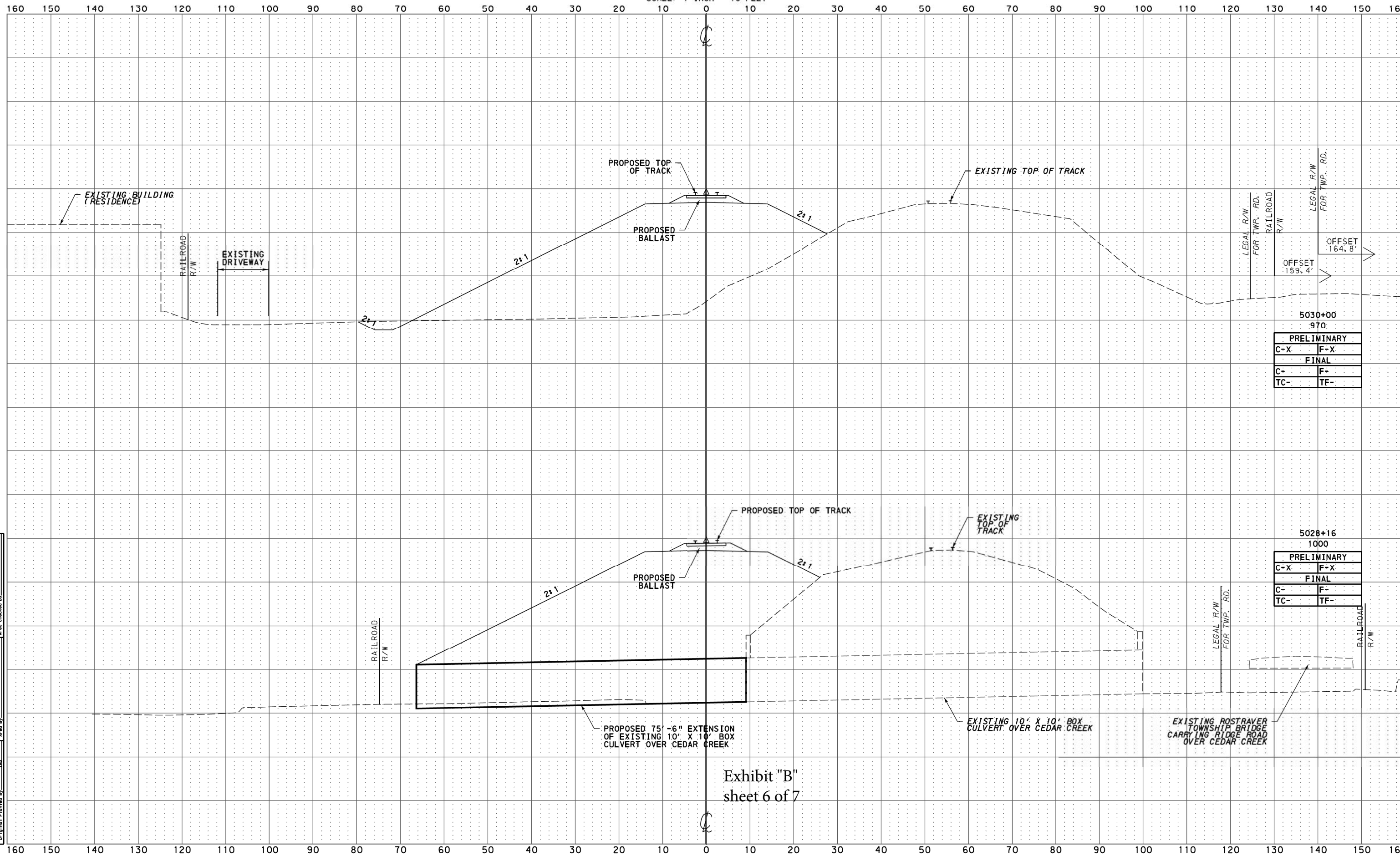

5030+00	
970	
PRELIMINARY	
C-X	F-X
FINAL	
C-	F-
TC-	TF-

5028+16	
1000	
PRELIMINARY	
C-X	F-X
FINAL	
C-	F-
TC-	TF-

Exhibit "B"  
sheet 6 of 7

Application No. \_\_\_\_\_  
 Route No. SB-000  
 Original Checked By: JAB  
 Template By: JAB  
 Area Checked By: JAB  
 Final Plotted By: JAB  
 Final Checked By: JAB  
 Area By: JAB  
 Area Checked By: JAB  
 FILE: D:\VGP\reg02\_corporate\gms\trf\em\ing.com\GPM02\Documents\Proj\1636\OUTPUT\_COMP\_01\CIVIL\ROAD\SR70-E10\_Railroad\_XS\_Sheets.dgn  
 DATE: 2/6/2019 11:24:15 AM

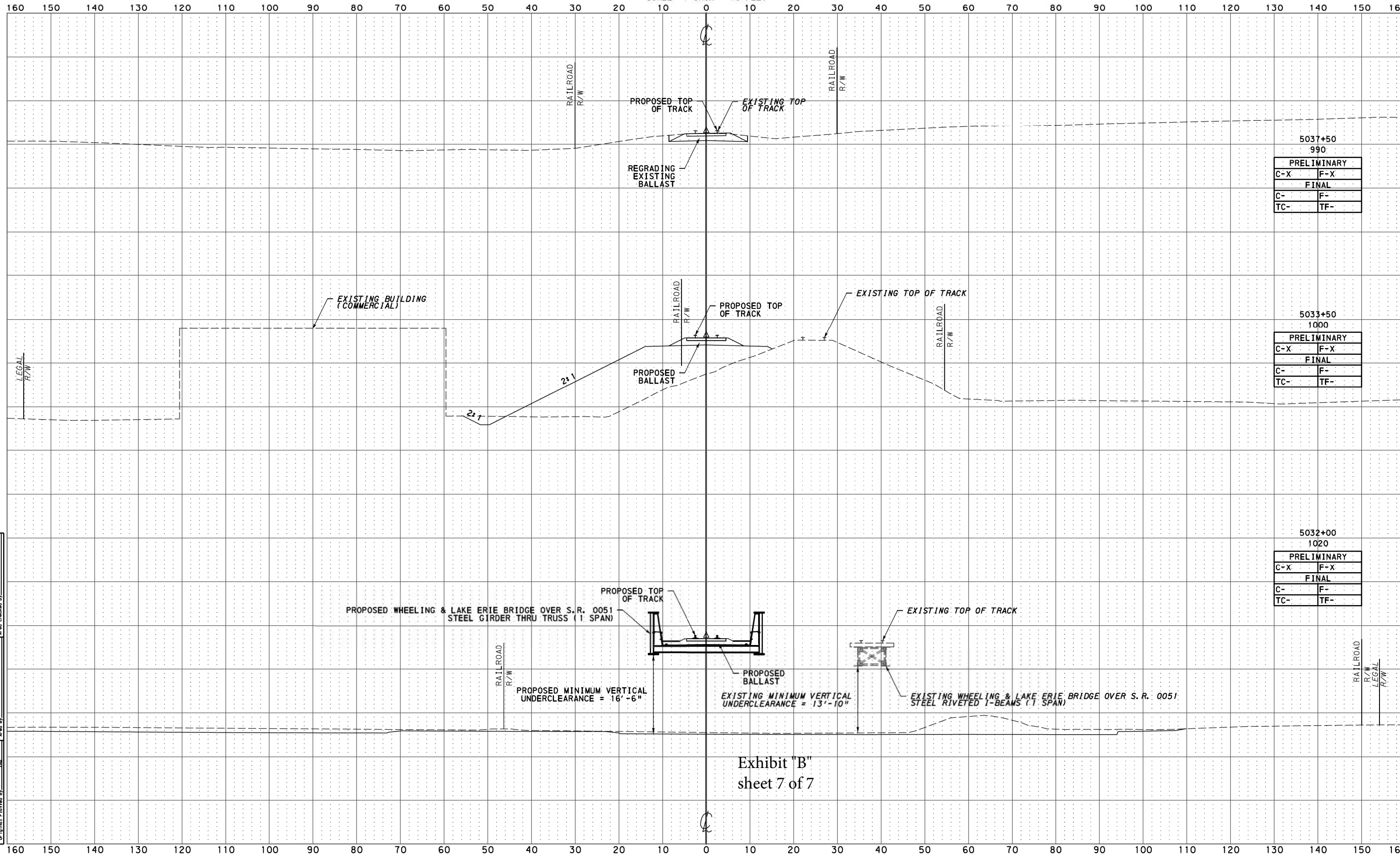

5037+50	
990	
PRELIMINARY	
C-X	F-X
FINAL	
C-	F-
TC-	TF-

5033+50	
1000	
PRELIMINARY	
C-X	F-X
FINAL	
C-	F-
TC-	TF-

5032+00	
1020	
PRELIMINARY	
C-X	F-X
FINAL	
C-	F-
TC-	TF-

Exhibit "B"  
sheet 7 of 7

Application No. \_\_\_\_\_  
 Route No. S.B. 0000 \_\_\_\_\_  
 Original Checked By: JTB \_\_\_\_\_  
 Template By: JTB \_\_\_\_\_  
 Area Checked By: \_\_\_\_\_  
 Final Checked By: \_\_\_\_\_  
 Area By: \_\_\_\_\_  
 Date: 2/6/2019 11:24:16 AM  
 FILE: D:\GDP\reg02\_corporate\_gm\trf\em\ing.com\GPM02\Documents\Proj\ects\1639\OUTPUT\_COMP\_01\CIVIL\ROAD\SR70-E10\_Railroad\_XS\_Sheets.dgn