

**Application of Pennsylvania-American Water Company for Acquisition of
the Wastewater Assets of the Borough of Kane Authority
66 Pa. C.S. § 1329
Application Filing Checklist – Water/Wastewater
Docket No. A-2019-3014248**

16. Map of Service Area - provide a scalable map or plan of suitable scale highlighting the boundaries of the proposed service area that includes:
- a. The extent of the proposed service area with any existing adjoining service areas identified.
 - b. A north arrow depicting map orientation.
 - c. A written description of the boundaries for the service territory utilizing bearing angles and distances.
 - d. Size of the service territory area in terms of acres or square miles.
 - e. Identification and depiction of all municipal boundaries relative to the service area.
 - f. Depiction of the location or route of the waterworks or wastewater collection, treatment or disposal facilities.

RESPONSE: For subparts a. through b. and d. through e, see enclosed maps attached as **Appendix A-16-a through b and d through e.**

For the descriptions called for in subpart c., see enclosed written descriptions of the boundaries of the service territory utilizing bearing angles and distances marked as **Appendix A-16-c.**

For **Appendix A-16-f** the map has been marked **CONFIDENTIAL.**

APPENDIX A-16-a-b

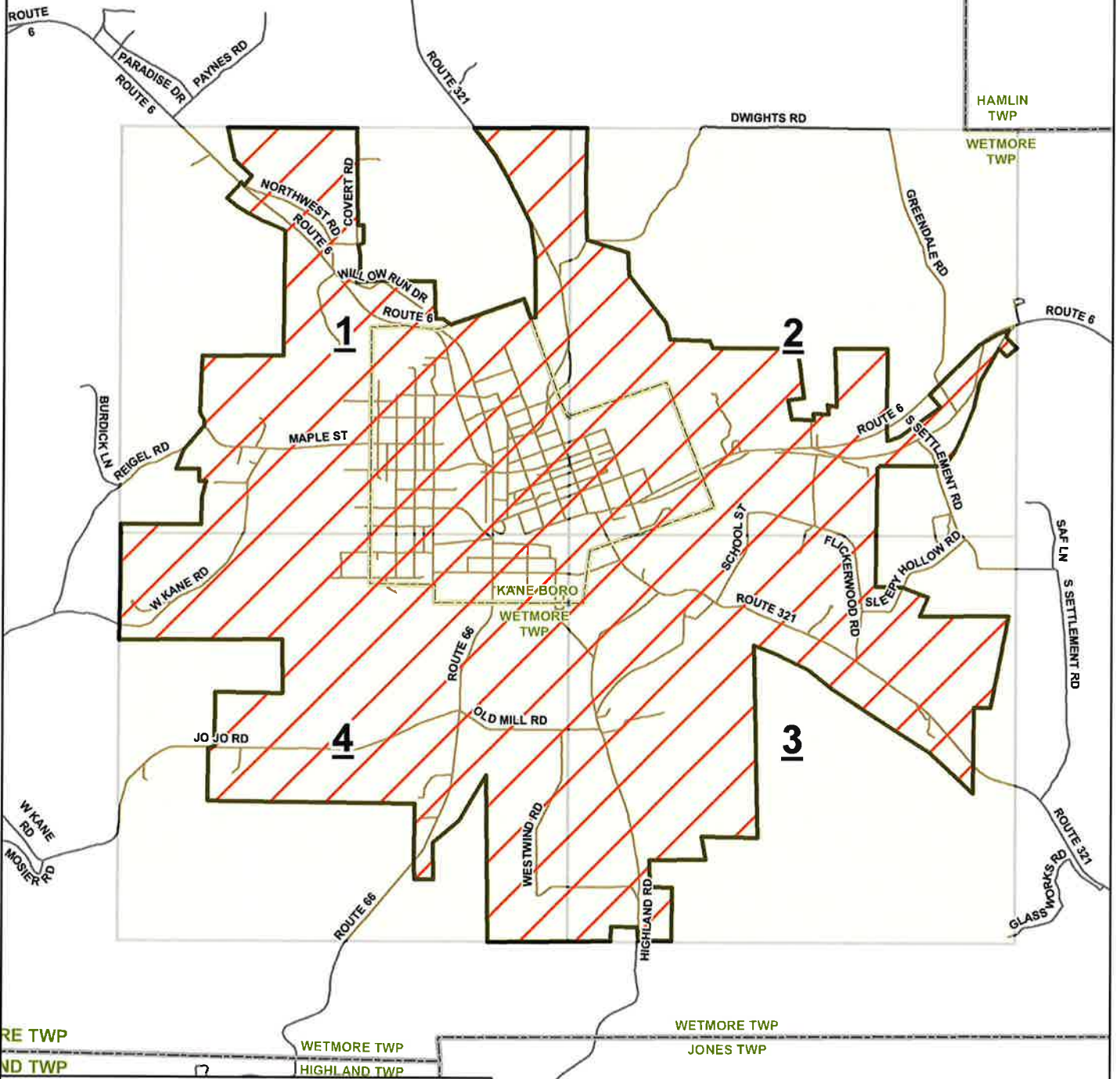

Pennsylvania-American Water Company
 Kane Operating Area
 Proposed Kane Wastewater Certified Service Territory
 Approximately 5,609 Acres
 Kane Borough & Wetmore Township, McKean County

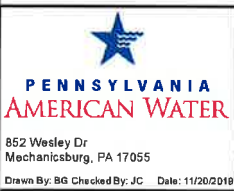

- Bearings and Distances Points
- ▨ Applied For Service Territory
- ▭ Municipality

APPENDIX A-16-A THROUGH 16-F

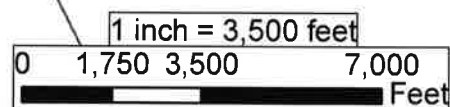

Disclaimer: Bearings and distances (attached separately) were not developed as result of physical survey completed by a Professional Licensed Surveyor, but instead completed through employment of ESRI's ArcGIS CDGO tool.

APPENDIX A-16-c

Starting Point: At the point on Route 6, McKean County where Kane Borough and Wetmore Township intersect, travel approximately 366 ft in a northeasterly direction along the municipal boundaries.

From	To	Bearing	Distance(Ft)
1	2	N70°28'54"E	1913.39
2	3	S20°10'17"E	487.56
3	4	S89°20'44"E	127.42
4	5	N0°33'37"W	1477.85
5	6	N7°44'38"W	844.83
6	7	N27°14'22"W	1258.99
7	8	N29°30'17"W	670.36
8	9	N37°59'38"W	835.68
9	10	N89°50'59"E	2808.12
10	11	S0°18'35"E	2769.16
11	12	S73°19'38"E	1071.42
12	13	S1°53'28"E	552.38
13	14	S38°40'31"E	1509.95
14	15	S13°36'35"E	424.24
15	16	S88°28'40"E	994.95
16	17	S17°58'57"E	195.41
17	18	N89°56'49"E	2113.89
18	19	S7°28'37"E	1230.75
19	20	S82°18'42"W	389.70
20	21	S10°03'58"E	486.38
21	22	S88°42'53"E	552.15
22	23	N5°42'38"W	157.55
23	24	S87°46'53"E	387.30
24	25	N7°46'30"W	242.92
25	26	S77°33'01"E	244.41
26	27	N2°06'31"W	1435.77
27	28	N89°56'49"E	1309.15
28	29	S0°10'21"W	2272.88
29	30	N73°23'00"E	323.81
30	31	N54°11'02"E	1267.19
31	32	N41°33'59"W	416.54
32	33	N45°29'37"E	1753.25
33	34	N58°07'44"E	525.97
34	35	N70°56'23"E	302.11
35	36	S26°56'22"W	199.77
36	37	S47°02'06"E	390.88
37	38	S50°32'05"W	332.17
38	39	N46°01'30"W	282.75
39	40	S29°07'55"W	959.22

From	To	Bearing	Distance(Ft)
40	41	S13°26'20"W	665.99
41	42	S23°38'14"W	1228.70
42	43	S39°14'45"W	230.81
43	44	S65°09'28"W	285.35
44	45	S89°58'21"W	1431.10
45	46	S50°13'48"W	86.97
46	47	S0°41'45"W	2935.27
47	48	S88°58'45"E	663.08
48	49	S69°28'49"E	692.72
49	50	S23°35'43"W	509.14
50	51	N89°41'54"E	2212.62
51	52	S11°02'15"W	2303.88
52	53	S89°43'55"W	405.04
53	54	S0°43'26"W	2120.07
54	55	N47°29'49"W	1490.59
55	56	N57°23'31"W	1952.91
56	57	N56°46'51"W	821.23
57	58	N52°48'22"W	871.62
58	59	N64°22'26"W	892.31
59	60	N67°52'56"W	579.46
60	61	S1°11'32"E	4747.84
61	62	N89°22'01"W	1382.39
62	63	S10°18'18"E	582.51
63	64	S89°46'57"W	1398.38
64	65	S0°28'04"E	666.72
65	66	S89°12'38"E	558.62
66	67	S0°23'25"W	1311.52
67	68	N89°42'54"W	844.63
68	69	N4°21'48"W	324.70
69	70	N89°01'24"W	651.99
70	71	S1°22'29"W	350.38
71	72	S89°20'06"W	3059.65
72	73	N0°40'24"W	4102.49
73	74	S30°40'47"W	1299.80
74	75	S50°02'20"W	845.20
75	76	S0°51'17"E	912.04
76	77	S89°34'38"W	474.64
77	78	N0°12'57"E	1871.18
78	79	N89°23'44"W	5145.49
79	80	N0°27'11"E	1302.52
80	81	N73°12'10"E	156.27
81	82	N0°43'10"E	1333.27
82	83	S89°20'07"E	1665.37
83	84	N0°25'31"W	1331.13
84	85	S89°41'25"W	4051.03
85	86	N0°42'07"E	2852.09

From	To	Bearing	Distance(Ft)
86	87	N89°59'32"E	1987.63
87	88	N1°35'25"E	689.78
88	89	N15°15'56"E	389.57
89	90	S89°58'18"W	176.08
90	91	N0°49'06"E	303.46
91	92	N89°42'17"W	571.08
92	93	N20°43'29"E	511.30
93	94	N40°31'57"E	660.17
94	95	N48°52'21"E	103.42
95	96	N1°04'53"W	158.92
96	97	N28°52'09"W	224.04
97	98	N2°26'29"E	1401.02
98	99	N89°55'51"E	2009.58
99	100	N0°29'30"E	3099.21
100	101	N66°12'35"W	863.89
101	102	N56°07'29"W	799.53
102	103	N41°41'50"E	534.41
103	104	S43°32'41"E	120.97
104	105	N38°33'43"E	294.09
105	106	N47°21'59"W	594.67
106	107	N12°24'46"W	814.28
107	108	N89°58'22"E	3219.64
108	109	S0°48'57"E	2398.13
109	110	S89°39'26"E	132.65
110	111	S0°42'38"E	442.79
111	112	S73°05'25"W	142.01
112	113	S11°55'53"E	249.41
113	114	S0°37'47"E	334.46
114	115	S14°32'28"W	358.70
115	116	N89°17'27"E	1954.89
116	117	S1°19'44"E	924.79
117	118	S89°33'46"E	188.49
118	1	S56°03'14"E	239.71

APPENDIX A-16-d-e

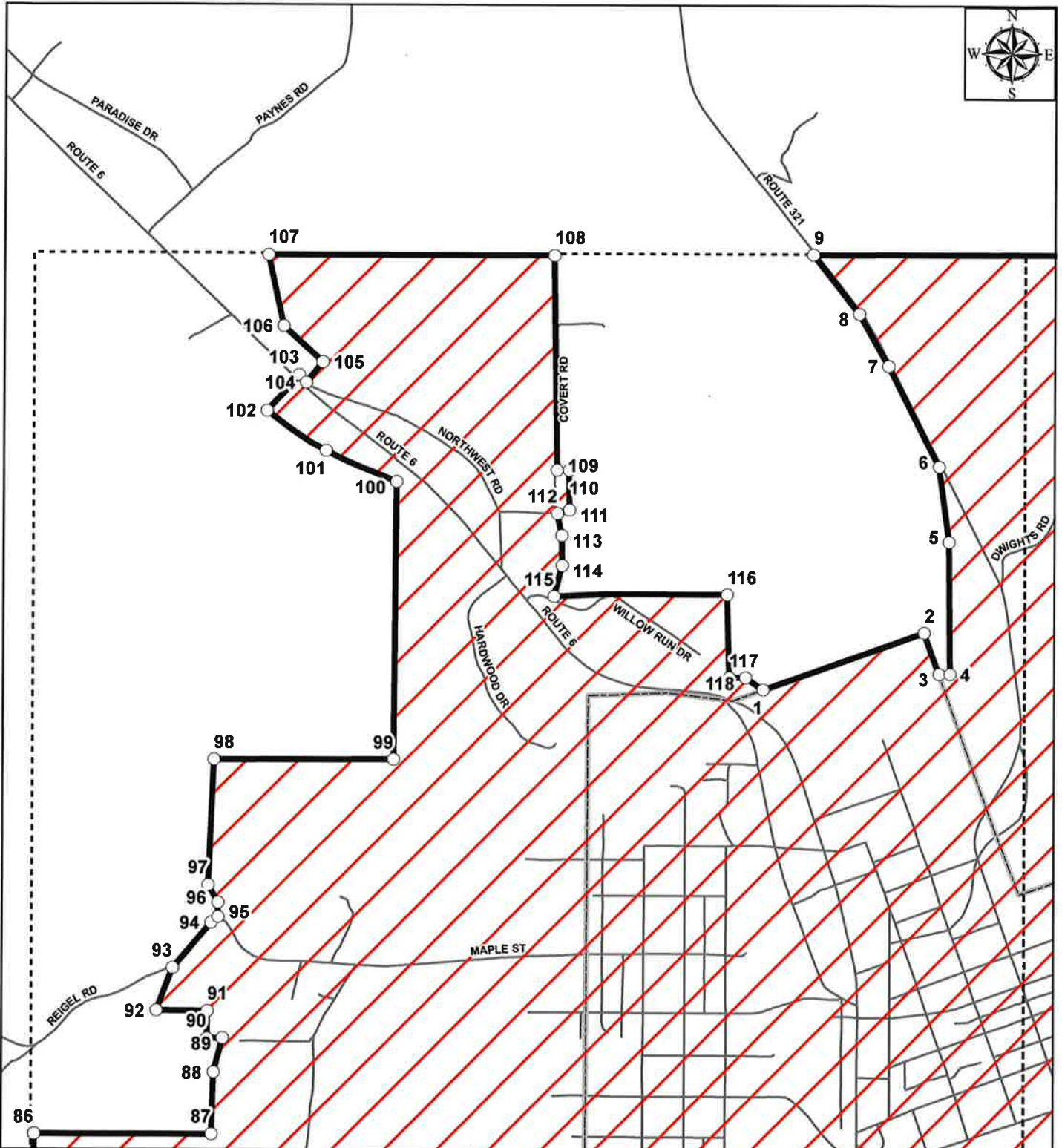

Pennsylvania-American Water Company
 Kane Operating Area
 Proposed Kane Wastewater Certificated Service Territory
 Approximately 5,609 Acres
 Kane Borough & Wetmore Township, McKean County



852 Wesley Dr
 Mechanicsburg, PA 17055
 Drawn By: BG Checked By: JC Date: 11/20/2019

- Bearings and Distances Points
- ▨ Applied For Service Territory
- ▭ Municipality

Page 1 of 4

Although every effort has been made to ensure the accuracy of the information, errors and omissions originating from physical sources to develop the Certificated Service Territory may be reflected in this map.

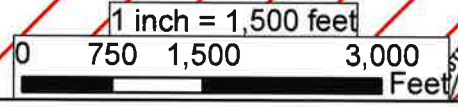

KANE BORO
WETMORE

Disclaimer: Bearings and distances (attached separately) were not developed as result of physical survey completed by a Professional Licensed Surveyor, but instead completed through employment of ESRI's ArcGIS GDGO tool.



HAMLIN TWP

WETMORE TWP

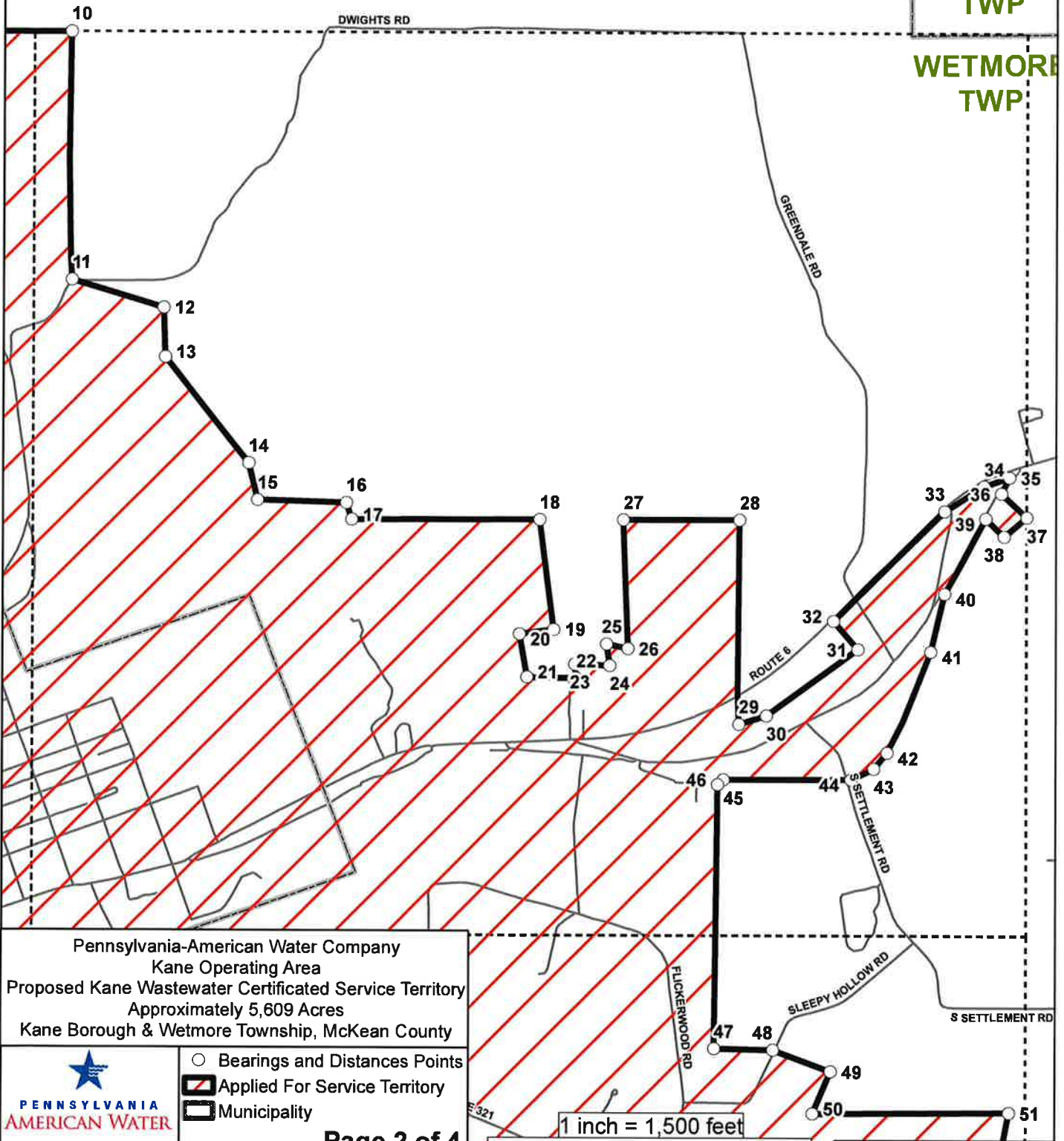

Pennsylvania-American Water Company
 Kane Operating Area
 Proposed Kane Wastewater Certificated Service Territory
 Approximately 5,609 Acres
 Kane Borough & Wetmore Township, McKean County



852 Wesley Dr
 Mechanicsburg, PA 17055
 Drawn By: BG Checked By: JC Date: 11/20/2019

- Bearings and Distances Points
- ▨ Applied For Service Territory
- ▭ Municipality

Page 2 of 4

Although every effort has been made to ensure the accuracy of this information, errors and omissions originating from physical sources to describe the geographical service territory may be reflected in the final product.



Disclaimer: Bearings and distances (attached separately) were not developed as result of physical survey completed by a Professional Licensed Surveyor, but instead completed through employment of ESRI's ArcGIS, CADD tool.

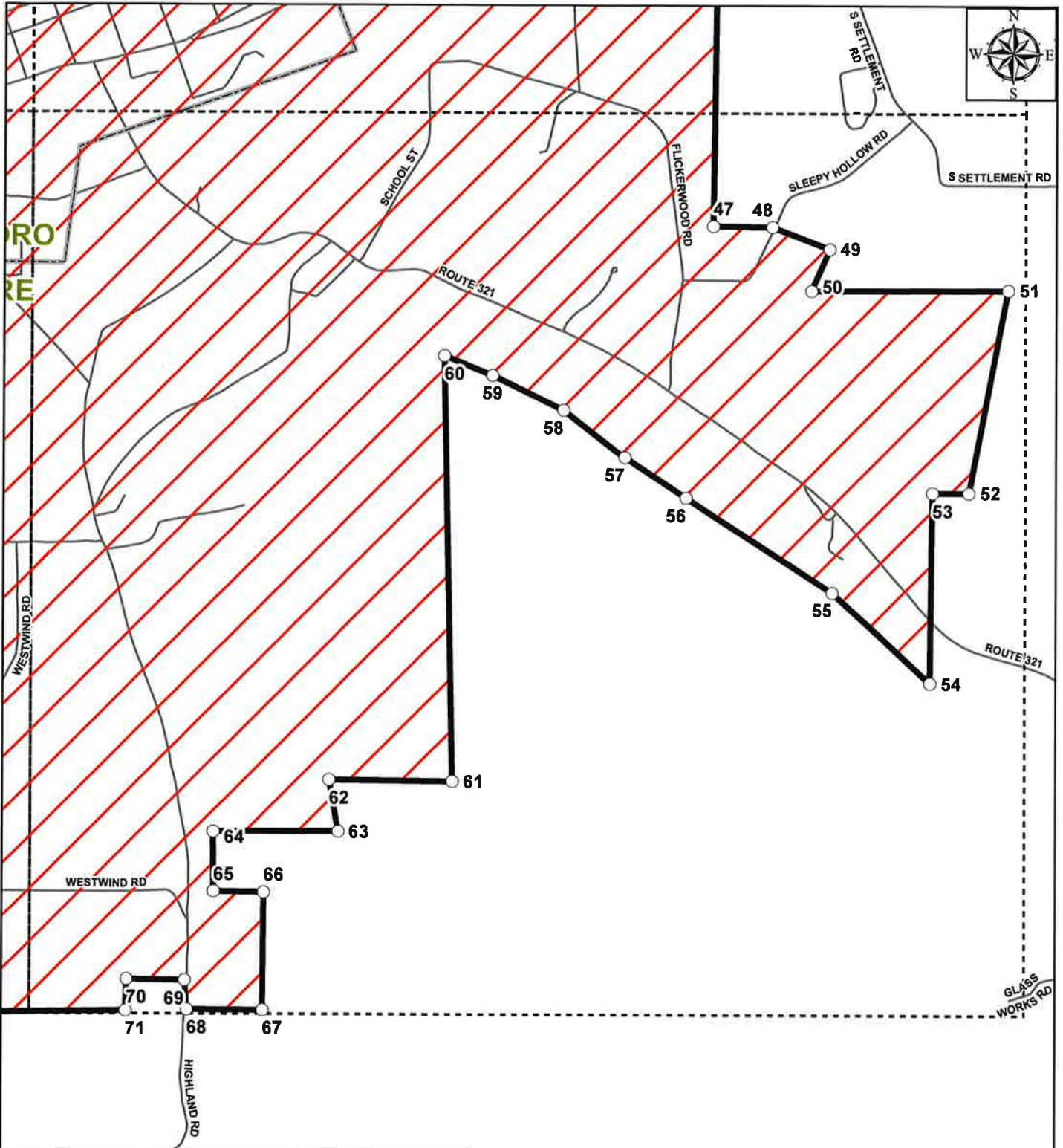

Pennsylvania-American Water Company
 Kane Operating Area
 Proposed Kane Wastewater Certificated Service Territory
 Approximately 5,609 Acres
 Kane Borough & Wetmore Township, McKean County



852 Wesley Dr
 Mechanicsburg, PA 17055
 Drawn By: BQ Checked By: JC Date: 11/20/2019

- Bearings and Distances Points
- ▨ Applied For Service Territory
- ▭ Municipality

Page 3 of 4

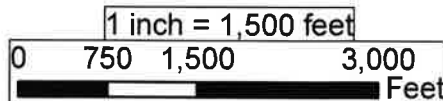

Disclaimer: Bearings and distances (attached separately) were not developed as result of physical survey completed by a Professional Licensed Surveyor, but instead completed through employment of ESR's ArcGIS CDDO tool.

TO BE USED FOR REFERENCE ONLY

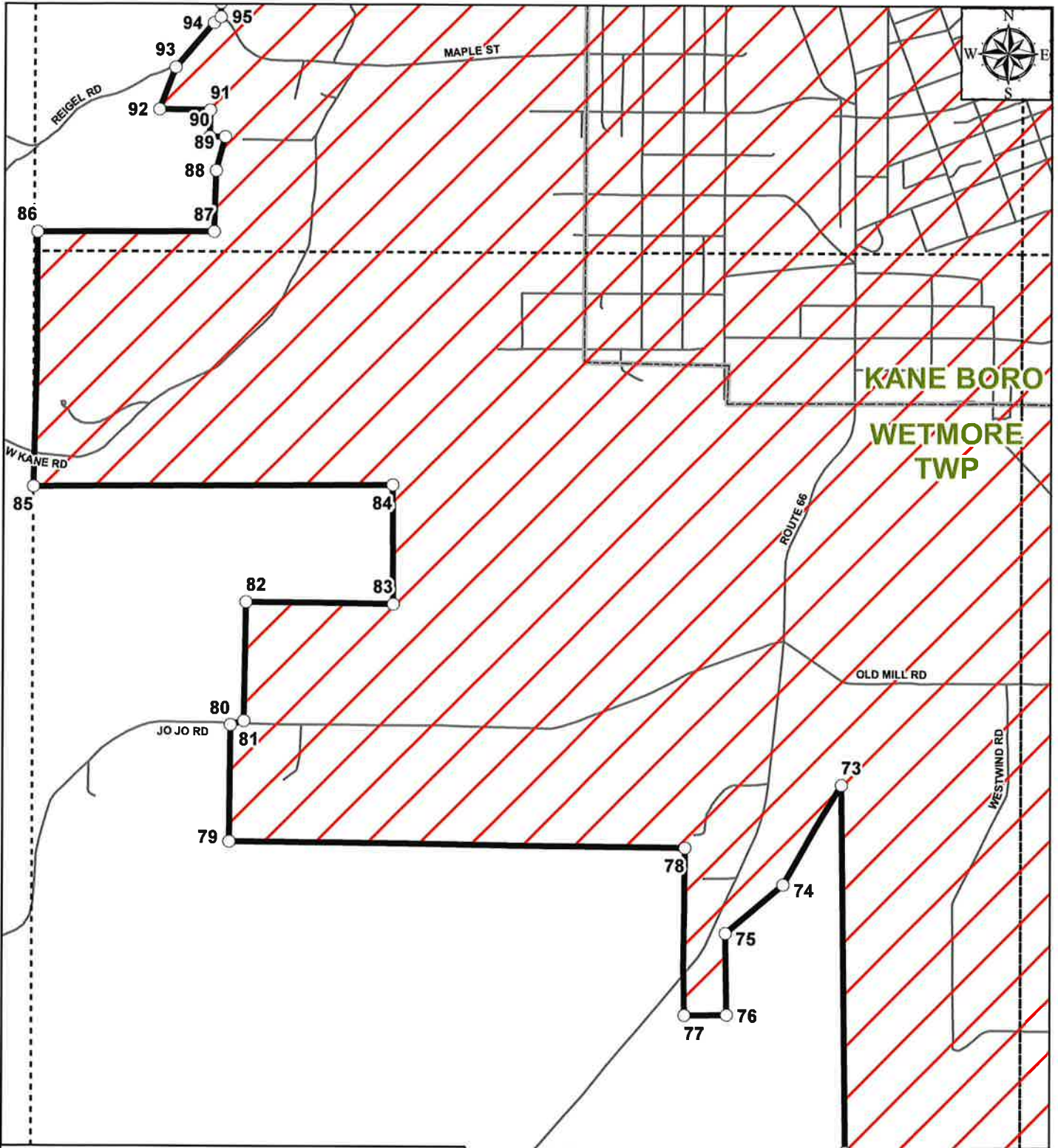

Pennsylvania-American Water Company
 Kane Operating Area
 Proposed Kane Wastewater Certified Service Territory
 Approximately 5,609 Acres
 Kane Borough & Wetmore Township, McKean County

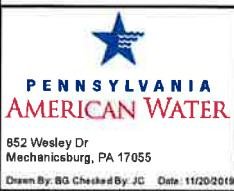

- Bearings and Distances Points
- ▨ Applied For Service Territory
- ▭ Municipality

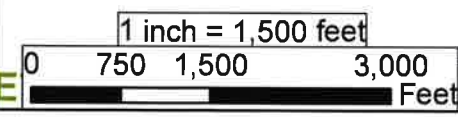

Disclaimer: Bearings and distances (attached separately) were not developed as result of physical survey completed by a Professional Licensed Surveyor, but instead completed through employment of ERI's ArcGIS CADD tool.

APPENDIX A-16-f

CONFIDENTIAL