

**MONTGOMERY COUNTY
BOARD OF COMMISSIONERS**

VALERIE A. ARKOOSH, MD, MPH, CHAIR
KENNETH E. LAWRENCE, JR., VICE CHAIR
JOSEPH C. GALE, COMMISSIONER



OFFICE OF THE SOLICITOR
MONTGOMERY COUNTY COURTHOUSE • PO BOX 311
NORRISTOWN, PA 19404-0311

610-278-3033
FAX: 610-278-3069
WWW.MONTCOPA.ORG

JOSHUA M. STEIN
SOLICITOR

March 4, 2020

Ms. Rosemary Chiavetta, Secretary
Pennsylvania Public Utility Commission
P.O. Box 3265
Harrisburg, Pa 17105-3265

Re: Application of County of Montgomery for approval of the alternation of the crossing Butler Pike (AAR# 532-100-Y) and Norfolk Southern Railroad (NS), by the reconstruction of Butler Pike and installation of a concrete culvert in Whitemarsh and Plymouth Townships, in Montgomery County

Dear Secretary Chiavetta:

Enclosed for filing please find the original and three (3) copies of the Application of Montgomery County. In accordance with Public Utility Commission regulations, the parties that are being served with this application have twenty (20) days to respond.

A copy of this application has been served upon the parties as indicated in the Certificate of Service attached to the application.

Sincerely,

Joshua M. Stein

JMS/srh
Enclosure
cc: Parties of Record

PA PUC
SECRETARY'S BUREAU
FRONT DESK

2019 MAR -6 PM 1:24

RECEIVED

**BEFORE
PENNSYLVANIA PUBLIC UTILITY COMMISSION**

In re: Application of County of
Montgomery for approval of the
alteration of the crossing Butler Pike
(AAR# 532-100-Y) Norfolk Southern
Railroad (NS), by the reconstruction of
Butler Pike and installation of a concrete
culvert in Whitemarsh and Plymouth
Townships, in Montgomery County.

Application
Docket No.

To Pennsylvania Public Utility Commission:

1. The name and address of applicant is:

County of Montgomery
P.O. Box 311
Norristown, PA 19404-0311

2. The name and address of applicant's attorney are:

Joshua Stein, Esq,
First Deputy, Montgomery County Solicitor Montgomery
County
P.O. Box 311
Norristown, PA 19404-0311

3. The work is proposed as part of the Butler Pike Sinkhole Remediation Project which is headed by the Montgomery County Roads and Bridges in collaboration with Montgomery County Transportation Authority. Montgomery County Roads and Bridges, a County of the Second Class A, is the applicant with granted power to construct and maintain highways within the County of Montgomery under the provisions of the Second Class County Code. The Montgomery County Transportation Authority is organized under the Municipality Authorities Act and has the power to acquire right-of-way needed for highway construction and to convey property acquired thereunder to a municipality.
4. By this application, approval is sought to construct sinkhole prevention measures and reconstruct the road and various utilities in the area of the Norfolk Southern (NS) Butler Pike overpass AAR#532-100-Y (location map attached). The existing crossing includes two separate tracks owned and operated by NS that cross Butler Pike on a stone and concrete span bridge owned by NS. The project will include the following work by the County on Butler Pike in the County Right of way adjacent to the crossing:

- Low mobility grouting (10'-50' below top of road) to fill in any voids and harden

RECEIVED
2019 MAR -6 PM 1:24
PA PUC
SECRETARY'S BUREAU
FRONT DESK

- underlying subgrade
- Reconstruction of Butler Pike underneath the bridge.
- Installation of drainage pipe in Butler Pike to carry stormwater.
- The installation of a new concrete box culvert just south of the crossing. The box culvert carries offsite and NS runoff that flows in a drainage swale within the NS right of way.

In order to best protect the road from further undermining the County would like to complete the following work within NS right of way:

- Low mobility grouting (10'-50' below top of road) to fill in any voids and harden underlying subgrade in the channel 35' upstream and downstream of the culvert.
- Stream hardening in the channel 35' upstream and downstream of the culvert.

There are several utilities under Butler Pike within the County right of way. The following utilities will replace their underground facilities during this construction contract:

- Texas Eastern – 8" and 12" Main
- Whitmarsh Sewer Authority – 12" Main
- Verizon – drop existing duct bank to go under proposed culvert
- Aqua PA – replace existing 12" Main

As-built plans to be provided at the conclusion of construction. Currently, Butler Pike is closed at this bridge crossing. The project proposes to maintain the two-way traffic through the crossing and improve the surrounding subgrade conditions. Vertical clearance of this crossing will not be altered in the reconstruction of the drainage culvert and roadway.

5. The names and addresses of person, parties, and entities concerned in, or affected by the traffic signal and train preemption installation, to the best of the Applicant's knowledge, are:

Matthew Edmond, AICP
 Montgomery County Planning
 Commission
 P.O. Box 3 11
 Norristown, PA 19404-0311

William Graham
 Norfolk Southern Corporation
 1200 Peachtree Street
 Atlanta, GA 30309

Tom O'Brien
 Montgomery County Roads and Bridges
 P.O. Box 31 1
 Norristown, PA.19404-0311

Joshua Stein, Esq,
 First Deputy,
 Montgomery County Solicitor
 Montgomery County
 P.O. Box 311
 Norristown, PA 19404-0311

Frank Eells, PE
 Gannett Fleming, Inc.
 Valley Forge Corporate Center
 1010 Adams Avenue
 Audubon, PA 19403

Daniel On
PECO Electric
1 050 W Swedesford Road
Berwyn, PA 19312

Joe Steinheiser
Pennsylvania American Water Company 4
Wellington Blvd, Suite 2,
Wyomissing, PA 19610

David Stinson
Verizon Communications Inc.
15 E. Montgomery Ave Floor 2,
Pittsburgh, PA 15212

Irena Kennedy
Enbridge Inc.
200, Fifth Avenue Place
425 – 1st Street S.W.
Calgary, Alberta
Canada T2P 3L8

Karen Weiss
Plymouth Township
700 Belvoir Road,
Plymouth Meeting, PA 19462

Richard L. Mellor, Jr.
Whitemarsh Township
616 Germantown Pike
Lafayette Hill, PA 19444

Tom Bonjo
Whitemarsh Township Authority
P.O. Box 447
Lafayette Hill, PA 19444

6. A traffic count of the highway crossing is not possible as the road is currently closed. Projecting volumes based on a PennDOT traffic count from 2018, results in an estimated 30,000 vehicles using the highway at the crossing over a three day period.
7. The anticipated cost for the overall Butler Pike Sinkhole Remediation project is \$1,800,000. The project is being funded by Montgomery County.
8. Sinkholes cause the road to buckle and lose support putting the travelling public at risk. Pressure of the roadway coming down on the utilities or the removal of the support soil can cause utilities to bend and potentially break, exacerbating the already tenuous situation. This project is necessary to create a stable base for both Butler Pike to safely carry vehicular and pedestrian traffic and the underlying utilities to have minimal underground movement.
9. Multiple field meetings and office meetings have occurred to discuss this situation with all parties.

Wherefore, applicant prays your Honorable Commission to approve the application:



(Signature of Applicant)
Joshua Stein, Esq,
Montgomery County Solicitor
Montgomery County

RECEIVED

MAR - 6 2020

USGS U.S. DEPARTMENT OF THE INTERIOR
U.S. GEOLOGICAL SURVEY

US Topo PA PUBLIC UTILITY COMMISSION
SECRETARY'S BUREAU

MOORESTOWN QUADRANGLE
7.5-MINUTE SERIES

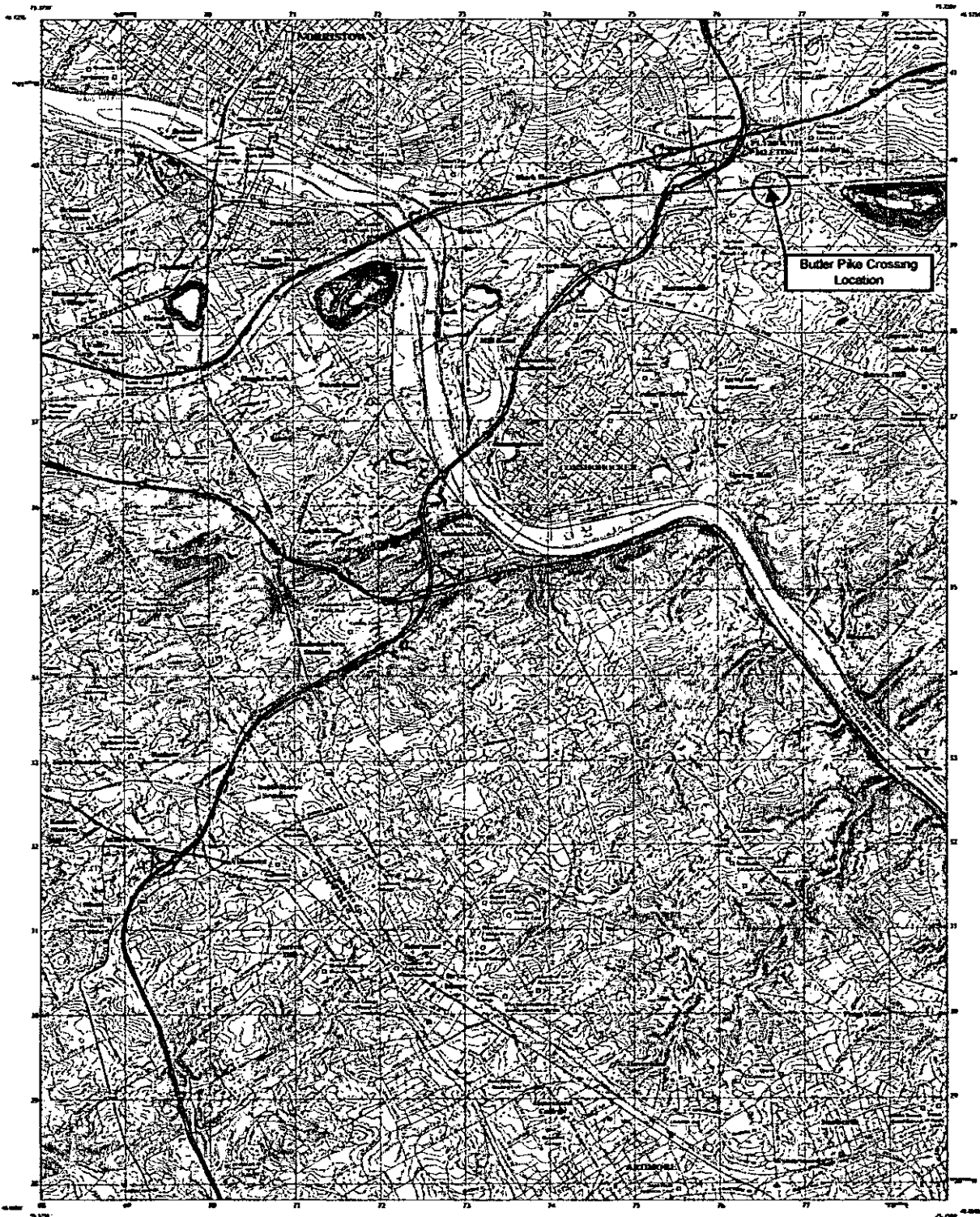

Produced by the United States Geological Survey
from aerial photography and other data
Topographic Survey of the United States
The accuracy of the horizontal and vertical control
is guaranteed by the National Geodetic Survey
under the National Geodetic Survey
Horizontal Control System
Vertical Control System
Datum: North American Datum of 1983
Projection: Universal Transverse Mercator
Zone: 18N
Scale: 1:25,000
Edition: 2010
Date: 2010

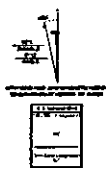

ROAD CLASSIFIER

1	Interstate
2	State Route
3	County Route
4	Local Road
5	Unimproved Road
6	Other



Contains nothing more
than information shown on map
Reproduction of this map
is prohibited by the National Geodetic Survey, USGS

MOORESTOWN, PA
2010

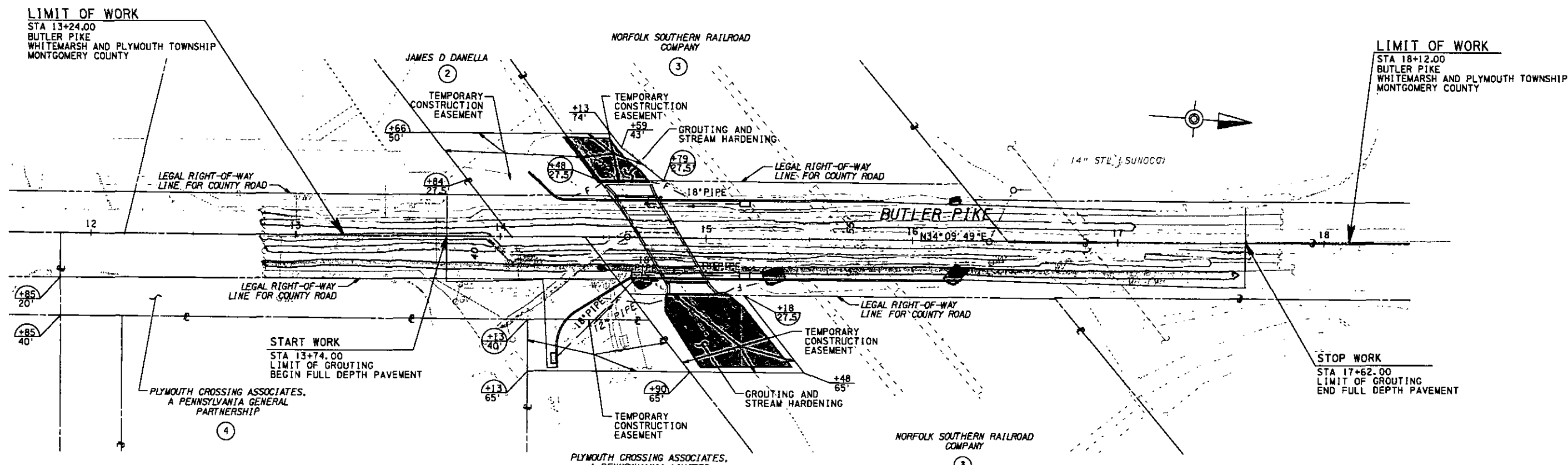

COUNTY	ROUTE	SHEET
MONTGOMERY	BUTLER PIKE	1 OF 1
WHITEMARSH AND PLYMOUTH TOWNSHIP		
REVISIONS	DATE	BY

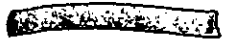
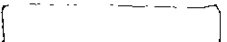
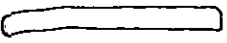
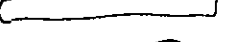

-  VERIZON
-  PECO (GAS) - ABANDONED
-  TEXAS EASTERN
-  AQUA PA
-  PECO (ELECTRIC)

RECEIVED

MAR - 6 2020

PA PUBLIC UTILITY COMMISSION
SECRETARY'S BUREAU

LEGEND

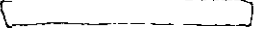
-  GROUTING AND STREAM HARDENING
-  SANITARY

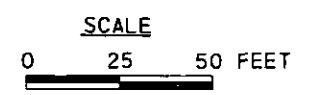

PREPARED BY:
GANNETT FLEMING, INC.
VALLEY FORGE, PA

FILE: G:\66106 Butler Pike\HighwayPlan\Butler Pike_rpo1.dgn
DATE: 21-Jan-2020 14:21

1.36. Verification.

(a) Applications, petitions, formal complaints, motions and answers thereto containing an averment of fact not appearing of record in the action or containing a denial of fact shall be personally verified by a party thereto or by an authorized officer of the party if a corporation or association. Verification means a signed written statement of fact supported by oath or affirmation or made subject to the penalties of 18 Pa. C.S. §4904 (relating to unsworn falsification to authorities). If verification is required, notarization is not necessary.

(b) The Verification form should comply substantially with the following:

VERIFICATION

I, Jed Stern, hereby state that the facts above set forth are true and correct (or are true and correct to the best of my knowledge, information and belief) and that I expect to be able to prove the same at a hearing held in this matter. I understand that the statements herein are made subject to the penalties of 18 Pa. C.S. § 4904 (relating to unsworn falsification to authorities).

Date: 3/6/2020

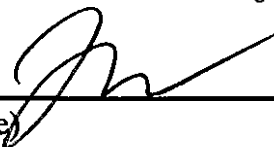
(Signature)

RECEIVED

MAR - 6 2020

PA PUBLIC UTILITY COMMISSION
SECRETARY'S BUREAU

CERTIFICATE OF SERVICE

I hereby certify that I have this day served a true copy of the foregoing document upon the participants listed below, in accordance with the requirements of § 1.54, by first class mail, postage prepaid:

Matthew Edmond, AICP Montgomery
County Planning Commission
P.O. Box 3 11
Norristown, PA 19404-031 1

Joe Steinheiser
Aqua America
762 W. Lancaster Ave
Bryn Mawr, PA 19010

William Graham
Norfolk Southern Corporation
1200 Peachtree Street
Atlanta, GA 30309

David Stinson
Verizon Communications Inc.
15 E. Montgomery Ave Floor 2,
Pittsburgh, PA 15212

Crystal Gilchrist
Montgomery County Planning Commission
P.O. Box 31 1
Norristown, PA.19404-0311

Irena Kennedy
Enbridge Inc.
200, Fifth Avenue Place
425 – 1st Street S.W.
Calgary, Alberta
Canada T2P 3L8

Joshua Stein, Esq, First Deputy,
Montgomery County Solicitor Montgomery
County
P.O. Box 311
Norristown, PA 19404-0311

Karen Weiss
Plymouth Township
700 Belvoir Road,
Plymouth Meeting, PA 19462

Frank Eells, PE
Gannett Fleming, Inc.
Valley Forge Corporate Center
1010 Adams Avenue
Audubon, PA 19403

Richard L. Mellor, Jr.
Whitemarsh Township
616 Germantown Pike
Lafayette Hill, PA 19444

Maryann Lang
PA Department of Transportation,
Engineering District 6-0
7000 Geerdes Boulevard
King of Prussia, PA. 19406

Tom Bonjo
Whitemarsh Township Authority
P.O. Box 447
Lafayette Hill, PA 19444

Daniel Oh
PECO Electric
1 050 W Swedesford Road
Berwyn, PA 19312

Dated this 4th day of March, 2020.



Signature
Joshua Stein, Esq.
Montgomery County Solicitor

RECEIVED
2019 MAR -6 PM 1:24
PA PUC
SECRETARY'S BUREAU
FRONT DESK

PUC @ Harrisburg Complex
400 North Street
Harrisburg, PA 17105

Attn: Rosemary Chiavetta, Secretary
2ND Floor - Secretary Bureau

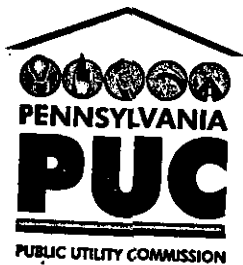

Daniel R. Helfrich, P.E.

Civil Engineer Consultant

Commonwealth of Pennsylvania
Public Utility Commission
Bureau of Technical Utility Services
Transportation Division-Rail Section

Commonwealth Keystone Building
P.O. Box 3265
Harrisburg, PA 17105-3265
Phone: (717) 787-5189
Fax: (717) 772-1931
E-mail: dhelfrich@pa.gov

Note: Call Dan Helfrich
phone # 717-787-5189