

Michael J. Shafer
Senior Counsel

PPL
Two North Ninth Street
Allentown, PA 18101-1179
Tel. 610.774.2599 Fax 610.774.4102
MJShafer@pplweb.com



E-File

June 9, 2020

Rosemary Chiavetta, Secretary
Pennsylvania Public Utility Commission
Commonwealth Keystone Building
400 North Street, 2nd Floor North
Harrisburg, PA 17120-3265

**Re: PPL Electric Utilities Corporation Temporary Workspace Agreement;
City of Allentown, Lehigh County, Pennsylvania**

Dear Secretary Chiavetta:

Enclosed for filing on behalf of PPL Electric Utilities Corporation ("PPL Electric") is a Temporary Workspace Agreement between PPL Electric and the City of Allentown, Lehigh County, Pennsylvania. Temporary rights are needed in order to complete work on the Allentown substation security fence upgrade project. This agreement is being filed pursuant to 66 Pa. C.S.A. § 507.

Due to the age of the deed, neither PPL Electric or the City of Allentown have been able to obtain or locate the deed information for the subject parcel. In lieu of the deed information, attached please find property details from the Lehigh County Tax Assessment Office.

Pursuant to 52 Pa. Code § 1.11, the enclosed documents are to be deemed filed on June 9, 2020, which is the date they were filed electronically using the Commission's E-filing system.

If you have any questions, please do not hesitate to contact me.

Respectfully submitted,

A handwritten signature in blue ink, appearing to read "Michael J. Shafer", is written over a light blue horizontal line.

Michael J. Shafer

Enclosures

Parcel ID#: 640753265912

TEMPORARY WORKSPACE AGREEMENT

KNOW ALL MEN BY THESE PRESENTS, That City of Allentown, having an address of 435 W. Hamilton Street, Allentown, Pennsylvania 18101, herein after referred to as (Grantor) in consideration of Five Hundred Dollars and 00/100 (\$500.00), paid at the date hereof by PPL Electric Utilities Corporation, hereinafter referred to as (PPL), the receipt whereof is hereby acknowledged, do hereby, irrevocably grant and convey unto the said PPL its successors, assigns, lessees or licensees, the right, liberty and privilege of utilizing a temporary workspace as shown on the attached plan through the property located in the City of Allentown, County of Lehigh, Commonwealth of Pennsylvania, in Deed Book X, Page X, ^{Information Not Available} together with the rights of free ingress, egress and regress to and for PPL, its successors, assigns, lessees, licensees, tenants, agents, workmen, employees and contractors, with necessary motor vehicles and other apparatus at all times within the period from the start of the project to the end of the project or two years from the beginning of construction, whichever is later, for any and all purposes, into, along, upon and out of said temporary workspace; also the right to cut down and trim any trees, brush or other undergrowth upon, along or adjacent to said temporary workspace which in the judgment of said company, its successors, assigns, lessees and licensees, may at any time interfere with the construction, maintenance or use of said temporary workspace.

Changes to the grade may be necessary to prepare the site. The site will remain at this grade after construction. PPL will leave any stone in place, and topsoil and seed the area during restoration of the site, per the specifications of the approved permitting plans. PPL will not replant any trees that were removed on this site. All trees removed will remain on site.

This Agreement is between a public utility and a municipal corporation and is therefore subject to Pennsylvania Public Utility Commission ("PUC") review pursuant to 66 Pa.C.S.A. § 507. The Effective Date of this Agreement shall be the later of i) thirty (30) days from the date that PPL submits the Agreement to the PUC; or ii) if the PUC opens an investigation of the Agreement, on the date the PUC approves the Agreement.

WITNESS his hand and seal this 26th day of May, 2020.

Witness:

City of Allentown

Jessica Berachot

By: Royo' Connelly

Title: Mayor

Temporary Workspace Agreement Map

City of Allentown, PIN 640753265912



This is not a survey product. Distances in this map are approximations only and should not be used for authoritative definition of legal boundary or property title.

Search Result Print View - Public

Street View



Property Overview

2020

Owner Name	CITY OF ALLENTOWN
Owner Address	435 W HAMILTON ST ALLENTOWN PA 18101-1603
Property Address	2 W PINE ST ALLENTOWN PA 18102
Parcel Viewer	View in Parcel Viewer
Low Number	0002
High Number	0002
Unit/Lot	
Sub Division	
Tax Authority	CITY OF ALLENTOWN
School District	ALLENTOWN SCHOOL DISTRICT
Parcel Id	640753265912 1
Old Parcel Id	02 01 G10SW1D 003 003
Tile	476011C
Acres/Dimension	8.501 ACRES
Lot Sq Ft	0
Utilities	PUBLIC WATER/SEWER
Class	COMMERCIAL
Land Use	PARK/RECREATIONAL FAC/POOL (PUBLIC/PRIVATE)
Living Units	0
Zoning	P
Homestead Act 72	Rejected on 01/03/2017. OWNER NOT QUALIFIED AS DEFINED BY ACT 1 OF 2006
Preferential Land Act	NO
Agricultural Easement	NO
Assessment Base Year	2013

Total Assessment	Exempt Land	510,100
	Exempt Building	652,500
	Taxable Land	0
	Taxable Building	0
	Total	1,162,600
	Taxable Total	0

	Mills (Land)	Mills (Building)	Mills	Taxes
Taxes	County		3.780000	\$ 0.00
	School		20.074300	\$ 0.00

	2020
	Municipality 23.537600 4.452800 \$ 0.00 Total \$ 0.00
Bill Number	020100520
LC_PropertyAddress	2 W PINE ST ALLENTOWN PA 18102

Basic Commercial Profile

	2020
Type of Building	SHOWER BUILDING
Floor Area	2030
Number of Stories	1
Year Built	OLD
Type of Heating/Cooling	
Elevator	NO
Sprinklers	NO
Basement Area	0
Assessment Base Year	2013
Additional Information	PAVING, CONCRETE PAVING, PAVILION, DUGOUTS, , , , ,

Basic Commercial Profile

	2020
Type of Building	LIGHT COMM EQUIP SHED
Floor Area	468
Number of Stories	1
Year Built	OLD
Type of Heating/Cooling	
Elevator	NO
Sprinklers	NO
Basement Area	0
Assessment Base Year	2013
Additional Information	CANOPIES, , , , , , , , , ,

Basic Commercial Profile

	2020
Type of Building	SHOWER BUILDING
Floor Area	4005
Number of Stories	1
Year Built	1972

	2020
Type of Heating/Cooling	
Elevator	NO
Sprinklers	NO
Basement Area	0
Assessment Base Year	2013
Additional Information	PAVING, POOL, STAND, FENCE, , , , ,

Basic Commercial Profile

	2020
Type of Building	LIGHT COMM UTILITY BLDG
Floor Area	1680
Number of Stories	1
Year Built	1997
Type of Heating/Cooling	
Elevator	NO
Sprinklers	NO
Basement Area	0
Assessment Base Year	2013
Additional Information	MEZZANINE, , , , , , , , , ,

Sales History

Sale Date	Owner Name	Document Id	Sale Price
00/0000	CITY OF ALLENTOWN	0000000	\$ 0

Footprint**Footprint**

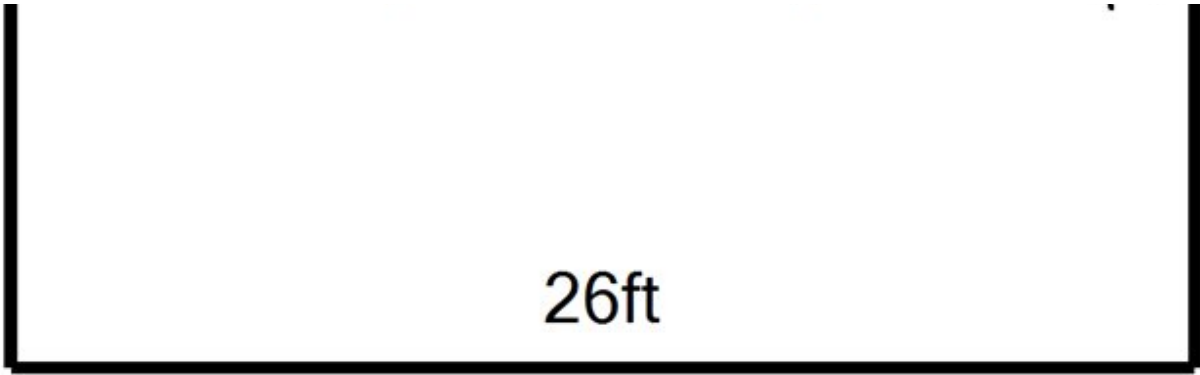

Footprint

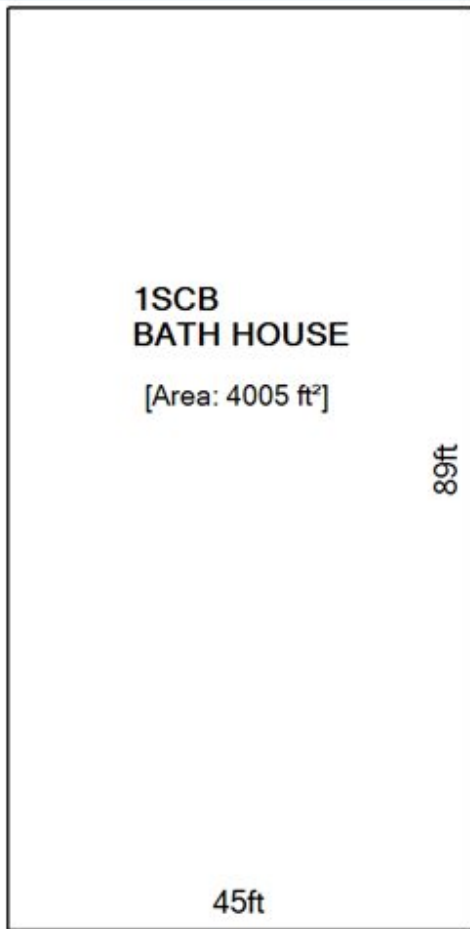

Footprint

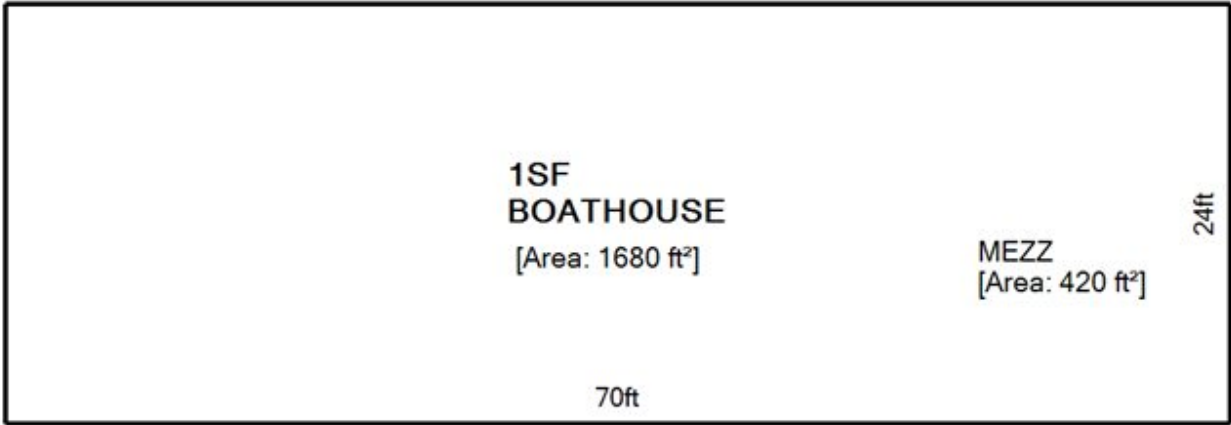

Printed 6/3/2020 9:10:45 AM

The building sketch represents the actual exterior measurement of the structure as measured from the outside. The sketch will show any attached areas and will be labeled with a descriptive code. Measurements are rounded to the nearest foot. Certain sketch dimensions and angles are drawn in approximation to their actual measurements.

The total square-foot area includes only the assessed living area of a residential structure, generally areas that are heated and/or cooled. Living area does not include porches, decks, patios, or garages.

Some of the common abbreviations are listed below for reference:

BUILDING STYLE	
CODE	DESCRIPTION
1S	1 STORY
1.5S	1½ STORY
2S	2 STORY
2.5S	2½ STORY
3S	3 STORY
3.5S	3½ STORY
B-L	BI-LEVEL
S-L	SPLIT-LEVEL

EXTERIOR	
CODE	DESCRIPTION
AV, A, V	ALUMINUM OR VINYL
B	BRICK
B&F	BRICK & FRAME
BFR	BRICK FRONT
BTR	BRICK TRIM
C	CONCRETE
CB	CONCRETE BLOCK
F, FR	FRAME
ST	STONE
SD	STUCCO OR DRYVIT
MTL	METAL
GL	GLASS

CODE	DESCRIPTION	CODE	DESCRIPTION
A	ATTIC	IGP	INGROUND POOL
BAL	BALCONY	LD	LOADING DOCK
B	BASEMENT	MP	MASONRY PATIO
BAY	BAY	MS	MASONRY SLAB
BSG	BASEMENT GARAGE	NB	NO BASEMENT
BW	BREEZEWAY	NA	NOT ADDED
BLT	BUILT	NI	NOT INCLUDED
CP	CARPORT	OFP	OPEN FRAME PORCH
CPY	CANOPY	OMP	OPEN MASONRY PORCH
CC	CATHEDRAL CEILING	OH	OVERHANG
CRLS	CRAWL SPACE	PB	PART BASEMENT
DECK	DECK	PW	PARTY WALL
EFP	ENCLOSED FRAME PORCH	RECRM	RECREATION ROOM
EMP	ENCLOSED MASONRY PORCH	S	SHED
FB	FINISHED BASEMENT	SQFT	SQUARE FOOT
FDN	FOUNDATION	STRG	STORAGE
G	GARAGE	UFB	UNFINISHED BASEMENT
GH	GREENHOUSE	WD	DECK

EXAMPLE SKETCH

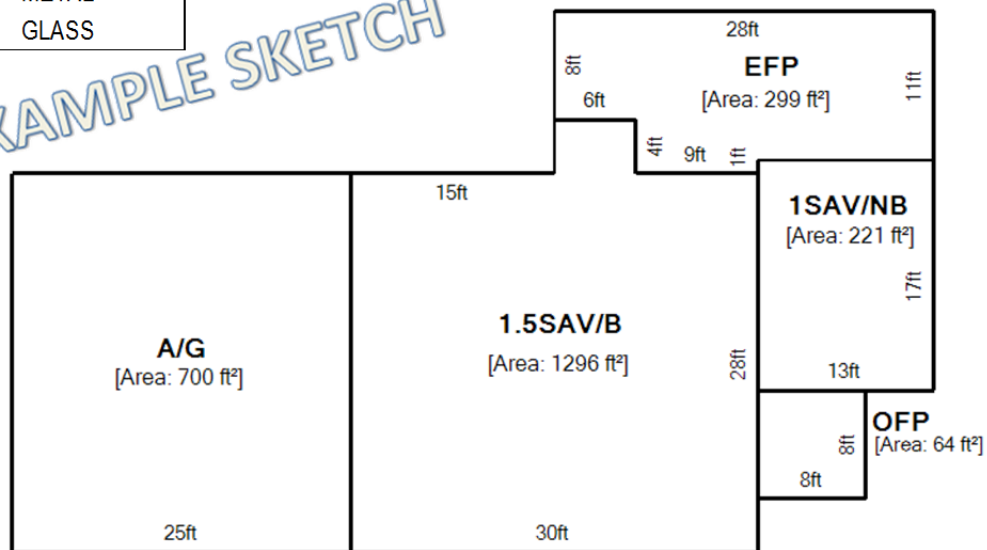

Information on this site is used for tax assessment purposes only and is subject to change without prior notice. The County of Lehigh Assessment Office assumes no responsibility for the use of the information for any other purpose. The use of information for any other purpose other than for tax assessment purposes is the sole and exclusive responsibility of the individual or entity using the information.