

APPENDIX A-16-d-e

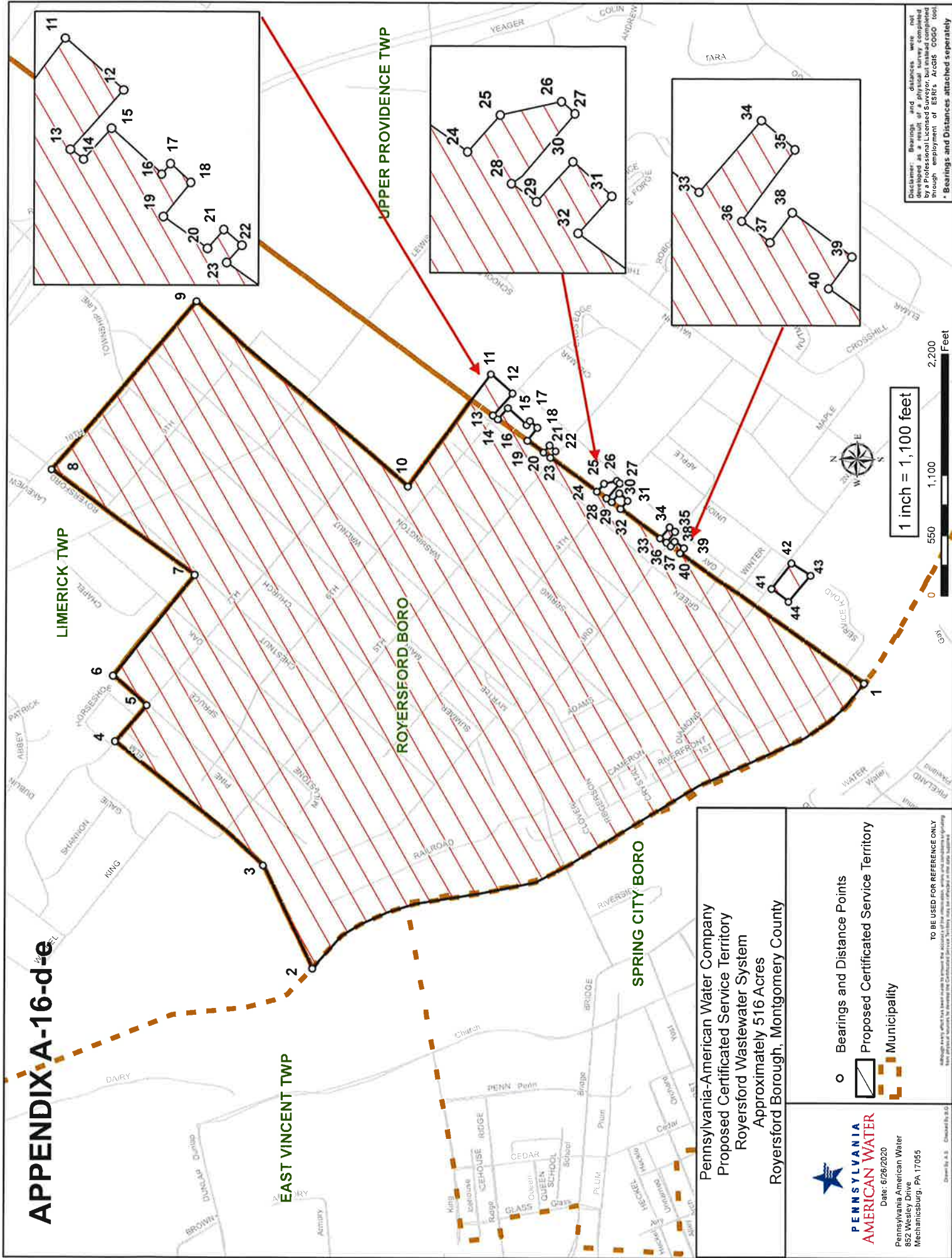

Disclaimer: Bearings and distances were not developed as a result of a physical survey completed by a Professional Licensed Surveyor, but instead completed through employment of ESRI's ArcGIS "COGO" tool.
 • Bearings and Distances attached separately

Pennsylvania-American Water Company
 Proposed Certified Service Territory
 Royersford Wastewater System
 Approximately 516 Acres
 Royersford Borough, Montgomery County

○ Bearings and Distance Points
 Proposed Certified Service Territory
 Municipality

TO BE USED FOR REFERENCE ONLY
 Although every effort has been made to ensure the accuracy of the information shown on this map, the user assumes all responsibility for its use. Bearings and Distances attached separately.

Drawn by: A.E. Checked by: S.C.