



165 Beach Lake Highway

Honesdale, Pennsylvania 18431

PPL Electric Utilities
Dustin Stockholm
Right of Way Agent
(610) 417-6697

August 6, 2020

Ms. Rosemary Chiavetta, Secretary
Pennsylvania Public Utility Commission
P.O. Box 3265
Harrisburg, PA 17105-3265

**RE: APPLICATION FOR PUBLIC CROSSING
STATE ROUTE 590
DELAWARE LACKAWAXEN AND STOURBRIDGE RAILROAD COMPANY
TOWNSHIP OF LACKAWAXEN
COUNTY OF PIKE**

Dear Secretary Chiavetta,

In accordance with Public Utility Code, Title 66, Chapter 2702, enclosed please find an application requesting permission to alter crossing of **Delaware Lackawaxen and Stourbridge Railroad Company**. Said crossing will be within the public right of way confines of State Route 590. It is located in the Township of Lackawaxen, Pike County.

Said crossing will consist of installation of PPL's overhead facilities as they cross the tracks of **Delaware Lackawaxen and Stourbridge Railroad Company** tracks and right of way. The **overhead cables and conductors** will be located within Public Right of Way. This is an existing crossing **263844M**.

PPL Electric Utilities will provide copies of same to all parties listed under its Certificate of Service.

Please review and provide the appropriate authorization to this office. Should you have any questions please contact this office.

Sincerely,

A handwritten signature in black ink, appearing to read "Dustin Stockholm".

Dustin Stockholm
Right of Way Agent

Enclosures

cc: Rodney D. Binder, P.E.
Chief-Bureau of Rail Safety
PA Public Utility Commission
P.O. Box 3265
Harrisburg, PA 17105-3265

RECEIVED

AUG 13 2020

PA PUBLIC UTILITY COMMISSION
SECRETARY'S BUREAU

**BEFORE
PENNSYLVANIA PUBLIC UTILITY COMMISSION**

In re: Application of **PPL Electric Utilities Corporation** for approval of the alteration of the crossing **263844M** by the installation of **7.2Kv overhead conductors** where **State Route 590** crosses at grade the tracks of the **Delaware Lackawaxen and Stourbridge Railroad Company** in the **Township of Lackawaxen** in **Pike County**.

Application
Docket No

RECEIVED

AUG 13 2020

PA PUBLIC UTILITY COMMISSION
SECRETARY'S BUREAU

To Pennsylvania Public Utility Commission:

1. The name and address of applicant are PPL Electric Utilities Corporation, 2 North Ninth Street, Allentown, PA 18101-1179.
2. The name and address of applicant's attorney are Mallory Jane Sweeney, Associate General Counsel, PPL Electric Utilities Corporation, 2 North Ninth Street, Allentown, PA 18101-1179.
3. PPL Electric Utilities Corporation (PPL), a Pennsylvania Public Utility offers electric utility service. PPL maintains a corporate charter in Pennsylvania, wherein the by-laws permit public utility companies to occupy public spaces, including said crossing.
4. PPL proposes to install and cross **State Route 590** with three (3) 477 Aluminum XLP 7.2 Kv open wire primary, 1 4/0 ACSR neutral. See attached plan for specifications.
5. Affected parties: (See attached exhibit "A")
6. **State Route 590** is a two-lane bituminous asphalt roadway. Scope of proposed work is relatively minor in scope and construction time frame will be short in duration, a formal traffic study was not conducted. Appropriate traffic control will be employed in accordance with PennDOT highway requirements. Operating Railroad will be contacted to arrange for appropriate flagging/protection services.
7. The construction costs associated with this proposal would be approximately \$20,000.00.
8. The construction of said crossing, of the tracks of the **Delaware Lackawaxen and Stourbridge Railroad Company**, is necessary to install PPL Electric Utilities Corporation's overhead electrical system.

Wherefore, applicant prays your Honorable Commission to approve the application:

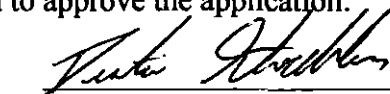

Dustin Stockholm
Right of Way Agent

§ 1.36. Verification.

(a) Applications, petitions, formal complaints, motions and answers thereto containing an averment of fact not appearing of record in the action or containing a denial of fact shall be personally verified by a party thereto or by an authorized officer of the party if a corporation or association. Verification means a signed written statement of fact supported by oath or affirmation or made subject to the penalties of 18 Pa. C.S. §4904 (relating to unsworn falsification to authorities). If verification is required, notarization is not necessary.

(b) The Verification form should comply substantially with the following:

VERIFICATION

I, **Dustin Stockholm**, hereby state that the facts above set forth are true and correct (or are true and correct to the best of my knowledge, information and belief) and that I expect to be able to prove the same at a hearing held in this matter. I understand that the statements herein are made subject to the penalties of 18 Pa. C.S. § 4904 (relating to unsworn falsification to authorities).

Date: 8/6/2020

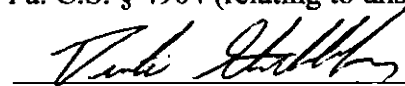
(Signature)

RECEIVED

AUG 13 2020

PA PUBLIC UTILITY COMMISSION
SECRETARY'S BUREAU

EXHIBIT "A"

The public utilities, municipalities, counties, corporations, and property owners concerned in, or affected by, the proposed crossing alterations are:

Mr. Mark Chappell, Chief
ROW and Utility Division PennDOT Bureau of Design
PO Box 3362
Harrisburg, PA 17105-3362

Ms. Gina M. D'Alfonso
Assistant Counsel in Charge
Department of Transportation
Office of Chief Counsel
9th Floor
P.O. Box 8212
Harrisburg, PA 17105-8212

Ms. Sarah J. Fenton
Grade Crossing Technician
PennDOT, District 4-0
55 Keystone Industrial Park
Dunmore, PA 18512

Stourbridge Railroad Company
100 4th Street #23
Honesdale, PA 18431

Reltek, LLC
For Delaware Lackawaxen & Stourbridge
Railroad Company
5 Terri Lane
Suite 300
Burlington, NJ 08016

Mr. Harry Hall
LHTC Broadband
P.O. Box 8
Rowland, PA 18457

Ms. Alice Muniz
Blue Ridge Communications
112 Bennett Avenue
Milford, PA 18337

Lackawaxen Township
169 Urban Road
Hawley, PA 18428

Mr. Matthew M. Osterberg
Chairman
Pike County Commissioners
506 Broad Street
Milford, PA 18337

RECEIVED

AUG 13 2020

PA PUBLIC UTILITY COMMISSION
SECRETARY'S BUREAU

THIS DRAWING IS THE PROPERTY OF PPL ELECTRIC UTILITIES AND CONTAINS PROPRIETARY AND CONFIDENTIAL INFORMATION WHICH MUST NOT BE DUPLICATED, USED OR DISCLOSED WITHOUT WRITTEN AUTHORIZATION FROM PPL ELECTRIC UTILITIES.

3-477, 37 STRD. H.D. AL., BOMILS XLP CONDR'S. (42KV)

1-4/0,6/1 STRD. ACSR. NEUTRAL

MAX. SAG TEMP.
CONDR'S. = 193° F (89° C)
OHGW = 227° F (108° C)

1-50'-CL.-3, WOOD POLE
75630/N49141

1-50'-CL.-3, WOOD POLE
75631/N49168

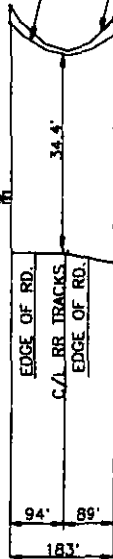

PROFILE:
SCALE: 1" = 200' HORZ.
1" = 20' VERT.

PLAN:
SCALE: 1" = 100'

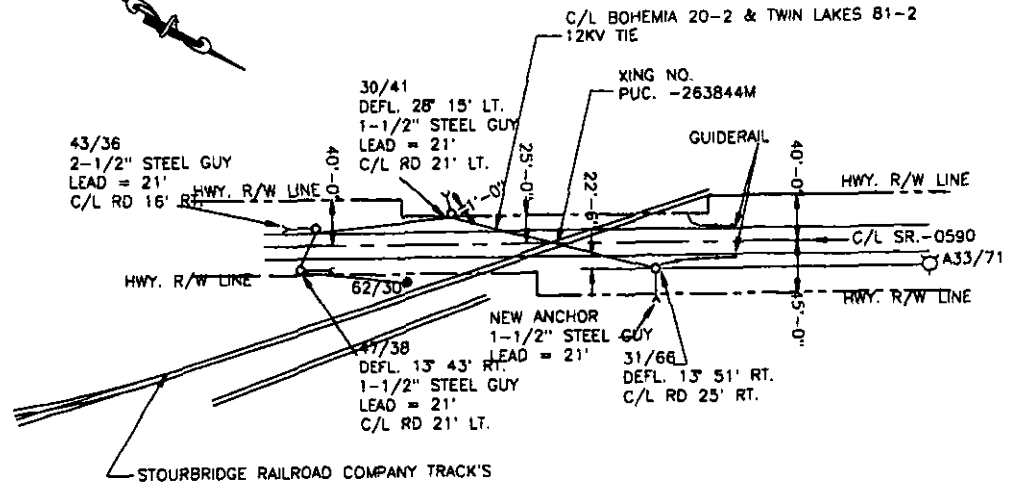

RECEIVED

AUG 13

PA PUBLIC
SECRET



ACCT- 200192	BOHEMIA 20-2 AND TWIN LAKES 81-2 12KV TIE		
SCALE- AS SHOWN	PLAN SHOWING ELECTRIC UTILITIES OVER		
BY- CDW	DELAWARE LACKAWAXEN & STOURBRIDGE RAILROAD COMPANY		
REVIEWED	MJS	AT PUC. CROSSING NO. 263844M	
JMD	LACKAWAXEN TWP.		PIKE CO., PA.
APPROVED		DATE	PPL ELECTRIC UTILITIES
Justin Davis		9/27/13	
AC	PPL DRAWING NO.	SHEET NO.	REV.
	EU00503859	1	1

REV D = ECN 1388

NO.	DATE	ACCT.	NUMBERS	REVISION	BY	REVIEWED	APPROVED
1	5/20/2013	2050737		REVISED TO SHOW ADDITION OF POLE 43/36, AND CHANGES TO GUYING AND POLE	JJA	RRH	BDM

PISS	756-491-N1	C
LOCATION CODES	PLAN & PROFILE	FACILITY MAP
SORTS		

PPL ELECTRIC UTILITIES (09/01)

LINES
PC CAD

Lackawaxen Fire Department

Delaware Lackawaxen & Stourbridge Railroad →

Crossing area →



1870 Roebling Inn on the Delaware

Veteran's Memorial Park

United States Postal Service

The New at Lacka Takeout

Scenic Dr

Scenic Dr

Delaware Dr

Delaware River

PENNSYLVANIA NEW YORK

590

590

Google

CERTIFICATE OF SERVICE

I, Dustin Stockholm, Right of Way Agent of PPL Electric Utilities Corporation hereby certify that I have this day served a true copy of the foregoing document upon the participants, listed below, in accordance with the requirements of § 1.54

Mr. Mark Chappell, Chief
ROW and Utility Division PennDOT Bureau of Design
PO Box 3362
Harrisburg, PA 17105-3362

Ms. Gina M. D'Alfonso
Assistant Counsel in Charge
Department of Transportation
Office of Chief Counsel
9th Floor
P.O. Box 8212
Harrisburg, PA 17105-8212

Ms. Sarah J. Fenton
Grade Crossing Technician
PennDOT, District 4-0
55 Keystone Industrial Park
Dunmore, PA 18512

Stourbridge Railroad Company
100 4th Street #23
Honesdale, PA 18431

Reltek, LLC
For Delaware Lackawaxen & Stourbridge
Railroad Company
5 Terri Lane
Suite 300
Burlington, NJ 08016

Mr. Harry Hall
LHTC Broadband
P.O. Box 8
Rowland, PA 18457

Ms. Alice Muniz
Blue Ridge Communications
112 Bennett Avenue
Milford, PA 18337

Lackawaxen Township
169 Urban Road
Hawley, PA 18428

Mr. Matthew M. Osterberg
Chairman
Pike County Commissioners
506 Broad Street
Milford, PA 18337

RECEIVED

AUG 13 2020

PA PUBLIC UTILITY COMMISSION
SECRETARY'S BUREAU

Dated this 6 day of August, 2020.





165 Beach Lake Hwy
Honesdale PA 18431

FIRST CLASS MAIL

RECEIVED

AUG 13 2020

PA PUBLIC UTILITY COMMISSION
SECRETARY'S BUREAU

Ms. Rosemary Chiavetta
Secretary

PA PUC

PO Box 3265

HARRISBURG PA

17105-3265