

Nov 10, 2020

Mr. George DiCarlantonio
Pennsylvania Public Utility Commission
P.O. Box 3265
400 North Street
Harrisburg, PA 17105

Reference: Rossmoyne Road At-Grade Crossing at NS, LG 6.16 (AAR-DOT# 592207P) in Lower Allen Township, Cumberland County, PA

Subject: PUC Application

Dear Mr. DiCarlantonio:

On behalf of applicant Lower Allen Township (Township), a municipality of Cumberland County, PA, enclosed is the PUC application for proposed modifications to the existing Norfolk Southern at-grade crossing (AAR-DOT# 592207P) with Rossmoyne Road (PennDOT State Route # 2021). The existing conditions at this crossing include Rossmoyne Road which has 11-foot lanes with negligible shoulders and carries approximately 6,000 vehicles per day in the area of the crossing. The at-grade crossing is controlled by automatic gates with flashing-light signals.

Coinciding with the Township's desire to provide improved pedestrian access routes along Rossmoyne Road, and considering the immediate lands are in the midst of being developed by Charter Homes at Highpoint, Inc. (Charter Homes), the Township is proposing improvements to the at-grade crossing to provide safer and controlled pedestrian accommodations. Residential homes are currently constructed and occupied in the southeastern quadrant of the crossing and the next phase of residential development is proposed in the southwestern quadrant of the crossing. Charter Homes' Master Plan entails connecting its parcels with a shared use path that crosses the Norfolk Southern rails at the at-grade crossing location. This way it can both serve the needs of the pedestrian generators and the ultimate vision the Township has to make Rossmoyne Road a pedestrian/bicycle friendly corridor. The initial phase of the crossing is to construct the crossing and its path alignments which will tie into Charter Homes' internal path network. Once lands are acquired, the intent is to then construct additional path alignments parallel to Rossmoyne Road in each direction.

Enclosed with this letter is a location map along with conceptual design plans depicting the proposed improvements. The extent of the improvements within Norfolk Southern right-of-way include constructing an 8-foot wide shared use bituminous path, 5-foot buffer (minimum) separated from the southern edge of roadway pavement. The crossing and approaches will be ADA compliant.

The Township has an executed Preliminary Engineering Services agreement with Norfolk Southern for this project and a separate reimbursement agreement executed with Charter Homes. Since the extents of the proposed improvements are also within PennDOT right-of-way, a highway occupancy permit will be required of the State. It is our intentions to provide an acceptable design to both owners.

The Township, together with Charter Homes, anticipates starting construction on the path in spring of 2021 once permits are obtained. Please contact me at 717-254-0544 or todd.trautz@mbakerintl.com if you have any questions regarding this project or this submission.

Sincerely,

MICHAEL BAKER INTERNATIONAL, INC.

A handwritten signature in black ink, appearing to read 'Todd Trautz', written over a horizontal line.

Todd Trautz, P.E., PTOE

Project Manager

cc. D. Flint (Lower Allen Twp), A. Faranda-Diedrich (Charter Homes), C. Stanford (Michael Baker)

CERTIFICATE OF SERVICE

I hereby certify that I have this day served a true copy of the foregoing document upon the participants, listed below, in accordance with the requirements of § 1.54.

COMPANY: WINDSTREAM
ADDRESS: 1450 CENTER POINT RD
HIAWATHA, IA. 52233
CONTACT: LOCATE DESK PERSONNEL
EMAIL: locate.desk@windstream.com

COMPANY: PENNSYLVANIA
AMERICAN WATER
ADDRESS: 852 WESLEY DR
MECHANICSBURG, PA. 17055
CONTACT: JEFF HORTON
EMAIL: jeff.horton@amwater.com

COMPANY: VERIZON PENNSYLVANIA
LLC
ADDRESS: 1026 HAY ST
PITTSBURGH, PA. 15221
CONTACT: DEBORAH BARUM
EMAIL: deborah.d.delia@verizon.com

COMPANY: BUCKEYE PARTNERS
ADDRESS: FIVE TEK PARK
9999 HAMILTON BLVD
BREINIGSVILLE, PA. 18031
CONTACT: DAVE JONES
EMAIL: DAJONES@BUCKEYE.COM

COMPANY: LOWER ALLEN TOWNSHIP
AUTHORITY
ADDRESS: 120 LIMEKILN RD
NEW CUMBERLAND, PA. 17070
CONTACT: BRIAN KAUFFMAN
EMAIL: BKAUFFMAN@LATWP.ORG

COMPANY: LOWER ALLEN TOWNSHIP
ADDRESS: 2233 GETTYSBURG RD
CAMP HILL, PA. 17011
CONTACT: DANIEL FLINT
EMAIL: DFLINT@LATWP.ORG

COMPANY: CENTURY LINK
ADDRESS: 1025 ELDORADO BLVD
BROOMFIELD, CO. 80021

CONTACT: CENTURY LINK OPERATOR
PERSONNEL EMAIL:
nationalrelo@centurylink.com

COMPANY: SUEZ WATER
PENNSYLVANIA INC.
ADDRESS: 4211 E PARK CIR
HARRISBURG, PA. 17111
CONTACT: NAT SHEFFER
EMAIL: nathaniel.sheffer@suez.com

COMPANY: PPL ELECTRIC UTILITIES
CORPORATION
ADDRESS: 503 NEW MARKET ST
WILKES BARRE, PA. 18702
CONTACT: MARK SANTAYANA
EMAIL: mcsantayana@pplweb.com

COMPANY: COMCAST
ADDRESS: 4601 SMITH STREET
HARRISBURG, PA. 17109
CONTACT: MICHAEL SWEIGARD
EMAIL: mike_sweigard@cable.comcast.com

COMPANY: UPPER ALLEN TOWNSHIP
ADDRESS: 100 GETTYSBURG PIKE
MECHANICSBURG, PA. 17055
CONTACT: KODI HOCKENBERRY
EMAIL: khockenberry@uatwp.org

COMPANY: UGI UTL LANCASTER
ADDRESS: 1301 AIP DRIVE
MIDDLETOWN, PA. 17057
CONTACT: STEPHEN BATEMAN
EMAIL: sbateman@ugi.com

COMPANY: SPRINT
ADDRESS: 484 WILLIAMSPORT PIKE
BOX 113
MARTINSBURG, WV. 25404
CONTACT: WESLEY CARPENTER
EMAIL: WESLEY.A.CARPENTER@SPRINT.COM

Dated this 10th day of November, 2020.

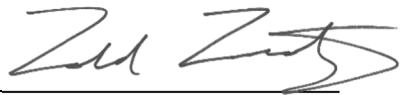
Todd Trautz, P.E., PTOE
On behalf of Lower Allen Township

**BEFORE PENNSYLVANIA PUBLIC UTILITY
COMMISSION**

In re: Application of Lower Allen
Township for approval of the alteration
of the crossing (AAR-DOT# 592207P)
where SR 2021 (Rossmoyne Rd.)
crosses at grade the tracks of Norfolk
Southern (NS), located in Lower Allen
Township, in Cumberland County

Application Docket No.

To Pennsylvania Public Utility
Commission:

1. The name and address of applicant is:

Daniel J. Flint
Township Engineer / Public Works Director
Lower Allen Township, Cumberland County, PA
2233 Gettysburg Road
Camp Hill, PA 17011

2. The name and address of applicant's attorney are

Steven P. Miner
Township Solicitor
Daley Zucker Meilton and Miner
635 N. Twelfth Street, No. 101
Lemoyne, PA. 17043

3. Lower Allen Township is a municipal government and is responsible for the safe operations of township facilities.

4. Coinciding with the Township's desire to provide improved pedestrian access routes along Rossmoyne Road, and considering the immediate lands are in the midst of being developed by Charter Homes at Highpoint, Inc. (Charter Homes), the Township is proposing improvements to the at-grade crossing to provide safer and controlled pedestrian accommodations. Residential homes are currently constructed and occupied in the southeastern quadrant of the crossing and the next phase of residential development is proposed in the southwestern quadrant of the crossing. Charter Homes' Master Plan entails connecting its parcels with a shared use path that crosses the Norfolk Southern rails at the at-grade crossing location. This way it can both serve the needs of the pedestrian generators and the ultimate vision the Township has to make Rossmoyne Road a pedestrian/bicycle friendly corridor.

The initial phase of the crossing is to construct the crossing and its path alignments which will tie into Charter Homes' internal path network. Once lands are acquired, the intent is to then construct additional path alignments parallel to Rossmoyne Road in each direction. The existing conditions at this crossing include Rossmoyne Road which has 11-foot lanes with negligible shoulders and carries approximately 6,000 vehicles per day in the area of the crossing. The at-grade crossing is controlled by automatic gates with flashing-light signals.

5. The trail project involves the following agencies: Lower Allen Township, Cumberland County, PennDOT, and Norfolk Southern. The following utilities are present within the project limits: Windstream, Pennsylvania American Water, Verizon, Buckeye Partners, Lower Allen Township Authority, Century Link, Suez Water, PPL Electrical Utilities, Comcast, Upper Allen Township, UGI, and Sprint.

6. Per historical PennDOT traffic count data from June 25th, 2015, the average daily traffic (ADT) of SR 2021 (Rossmoyne Road) in the vicinity of the railroad crossing is 6,020 vehicles per day. No bicycle count information is available for these locations.

7. The construction cost of the project is estimated at \$45,000. The design and construction are being privately funded by Charter Homes within their Arcona Development Project. Lower Allen Township will be responsible for the maintenance of the trail proposed by this project.

8. The alteration is necessary or proper for the following reasons:

- To improve the connectivity of the pedestrian and bicycle facilities in the area including residents to and from the proposed housing development by Charter Homes.
- To improve pedestrian/bicycle safety in the area. The proposed zig zag gates, signage, and pavement markings will allow for pedestrians and bicyclists to safely cross the railroad with ADA compliant ramps.

Wherefore, applicant prays your Honorable Commission to approve the application:



Todd Trautz, P.E., PTOE

On behalf of Lower Allen Township

§ 1.36. Verification.

(a) Applications, petitions, formal complaints, motions and answers thereto containing an averment of fact not appearing of record in the action or containing a denial of fact shall be personally verified by a party thereto or by an authorized officer of the party if a corporation or association. Verification means a signed written statement of fact supported by oath or affirmation or made subject to the penalties of 18 Pa. C.S.

§4904 (relating to unsworn falsification to authorities). If verification is required, notarization is not necessary.

(b) The Verification form should comply substantially with the following:

VERIFICATION

I, Todd Trautz, P.E., PTOE, hereby state that the facts above set forth are true and correct (or are true and correct to the best of my knowledge, information and belief) and that I expect to be able to prove the same at a hearing held in this matter. I understand that the statements herein are made subject to the penalties of 18 Pa. C.S. § 4904 (relating to unsworn falsification to authorities).

Date: 11/10/2020

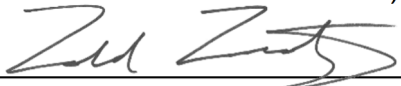

(Signature)

Proposed Rossmoyne Road (SR 2021) – Norfolk Southern RR Grade Crossing



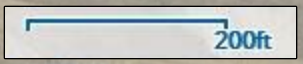

Town, County, State:	Lower Allen Township, Cumberland County, PA
AAR-DOT#:	592207P
Street /Bridge Name:	Rossmoyne Road (SR 2021)
Description:	Proposed Modifications to the Rossmoyne Road At-Grade Crossing at NS, LG-6.16

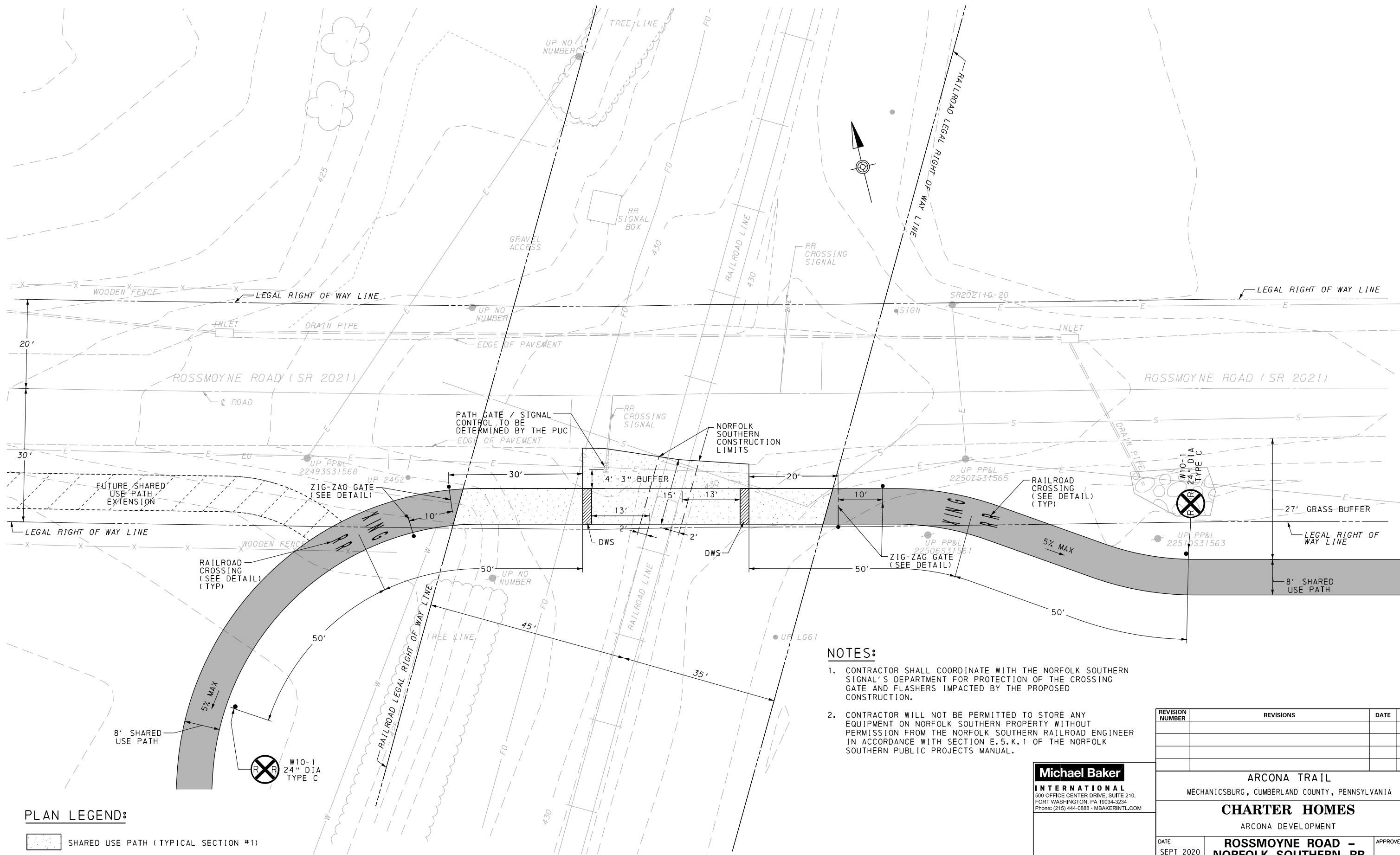



PLAN LEGEND:

-  SHARED USE PATH (TYPICAL SECTION #1)
-  SHARED USE PATH (TYPICAL SECTION #2)
-  FUTURE SHARED USE PATH EXTENSION

NOTES:

1. CONTRACTOR SHALL COORDINATE WITH THE NORFOLK SOUTHERN SIGNAL'S DEPARTMENT FOR PROTECTION OF THE CROSSING GATE AND FLASHERS IMPACTED BY THE PROPOSED CONSTRUCTION.
2. CONTRACTOR WILL NOT BE PERMITTED TO STORE ANY EQUIPMENT ON NORFOLK SOUTHERN PROPERTY WITHOUT PERMISSION FROM THE NORFOLK SOUTHERN RAILROAD ENGINEER IN ACCORDANCE WITH SECTION E.5.K.1 OF THE NORFOLK SOUTHERN PUBLIC PROJECTS MANUAL.



Michael Baker INTERNATIONAL
 500 OFFICE CENTER DRIVE, SUITE 210,
 FORT WASHINGTON, PA 19034-3234
 Phone: (215) 444-0888 • MBAKERINTL.COM

REVISION NUMBER	REVISIONS	DATE	BY

ARCONA TRAIL
 MECHANICSBURG, CUMBERLAND COUNTY, PENNSYLVANIA

CHARTER HOMES
 ARCONA DEVELOPMENT

DATE SEPT 2020	ROSSMOYNE ROAD - NORFOLK SOUTHERN RR GRADE CROSSING PLAN	APPROVED
DRAWN BY SRD		SHEET 1 OF 2

ALL DIMENSIONS MUST BE VERIFIED BY CONTRACTOR AND OWNER MUST BE NOTIFIED OF ANY DISCREPANCIES BEFORE PROCEEDING WITH THE WORK.

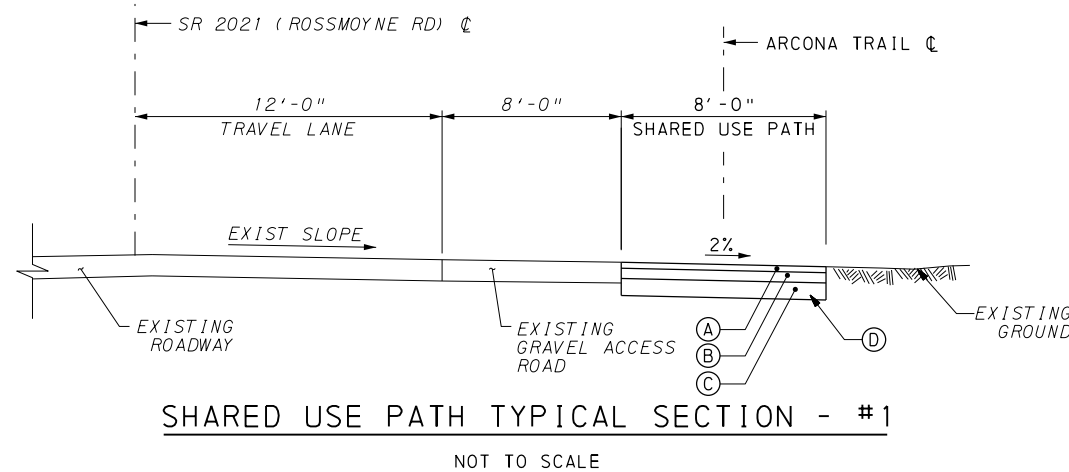

TYPICAL SECTION LEGEND:

- (A) SUPERPAVE ASPHALT MIXTURE DESIGN, WEARING COURSE, PG 64S-22, < 0.3 MILLION ESALS, 9.5 MM MIX, 1 1/2" DEPTH, SRL-E
- (B) SUPERPAVE ASPHALT MIXTURE DESIGN, BASE COURSE, PG 64S-22, < 0.3 MILLION ESALS, 25.0 MM MIX, 3" DEPTH
- (C) SUBBASE 6" DEPTH (NO. 2A)
- (D) GEOTEXTILE, CLASS 4, TYPE A

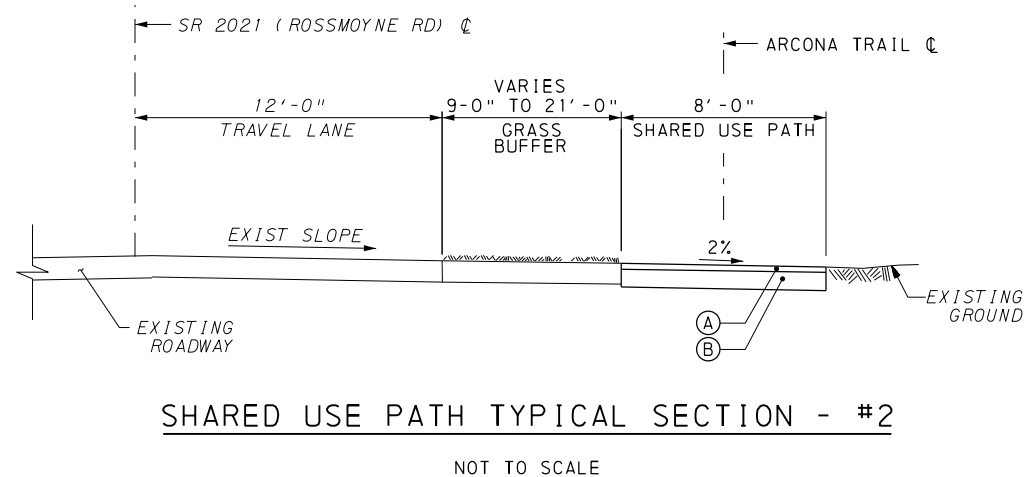

TYPICAL SECTION LEGEND:

- (A) 1.5" ID-2 WEARING COURSE OR APPROVED ALTERNATIVE
- (B) 6" MODIFIED STONE BASE COURSE

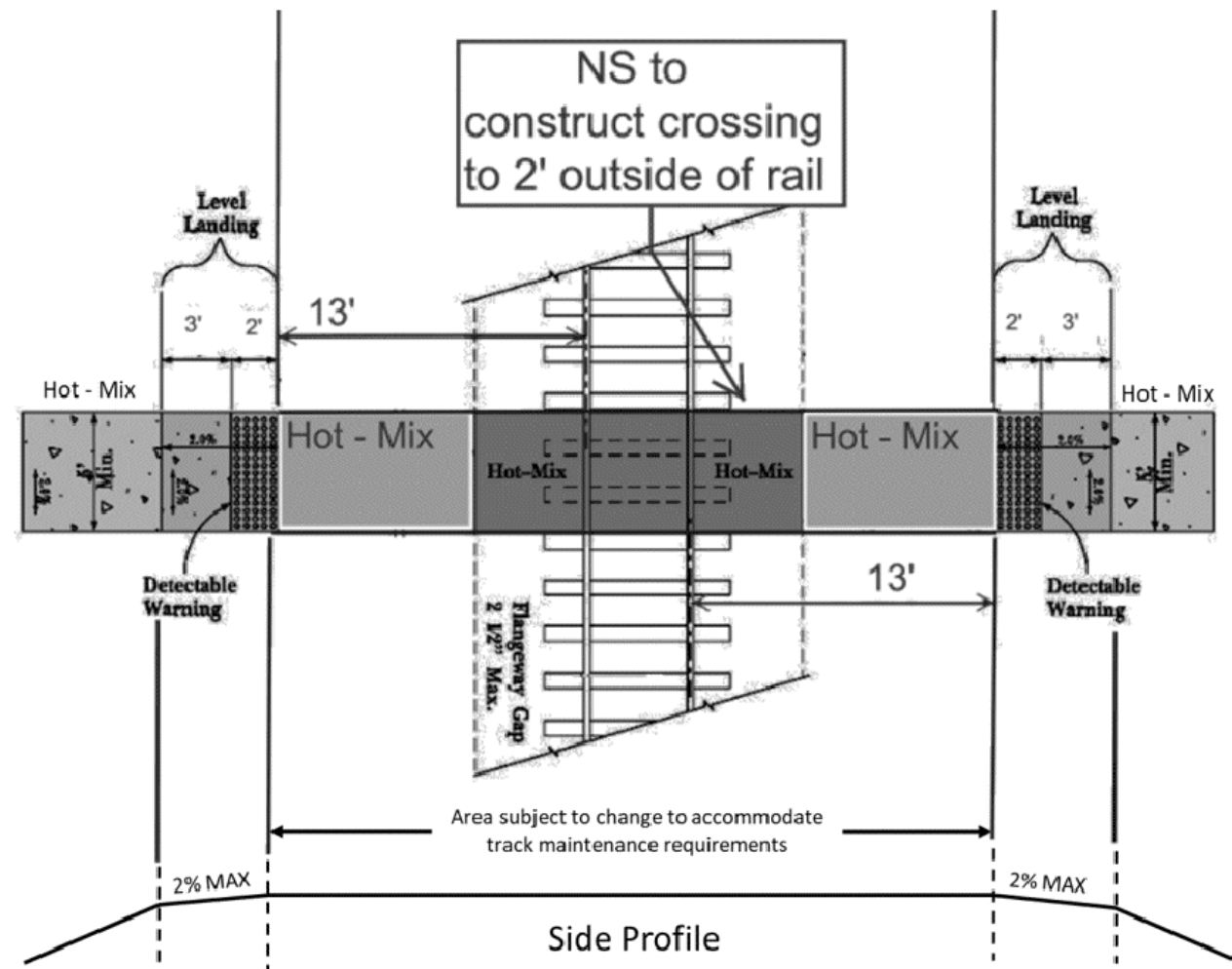

**NORFOLK SOUTHERN SHARED USE PATH
CROSSING DETAIL**

NOT TO SCALE

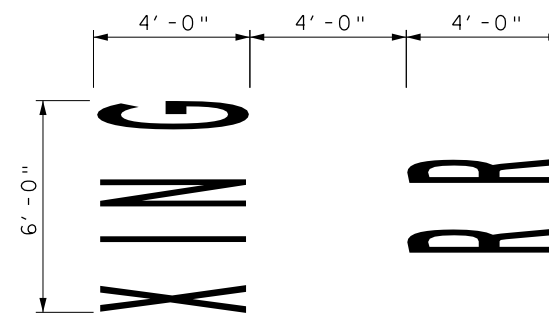
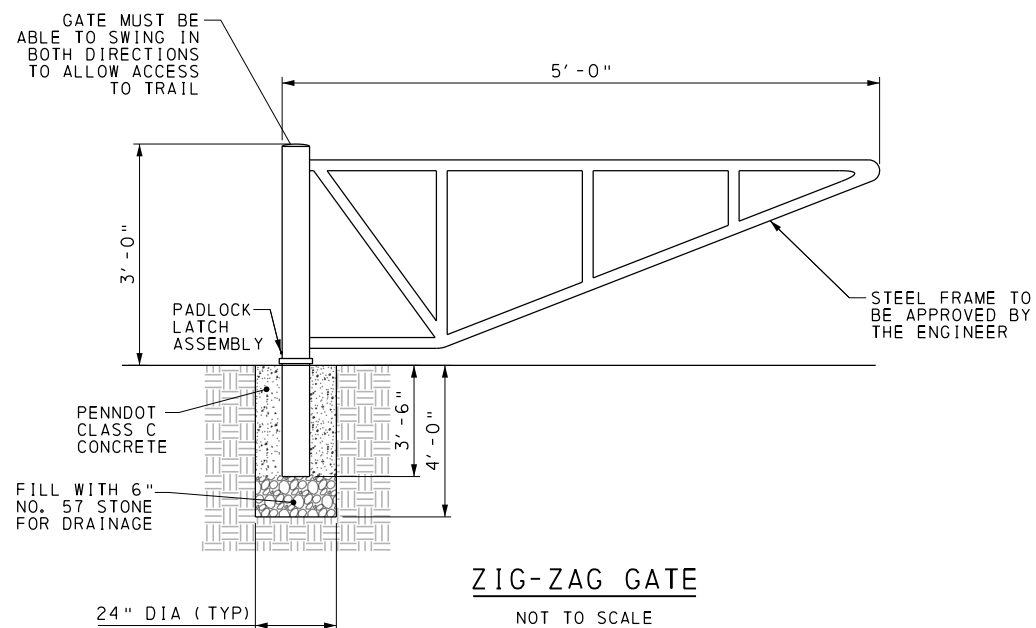

Michael Baker INTERNATIONAL
500 OFFICE CENTER DRIVE, SUITE 210,
FORT WASHINGTON, PA 19034-3234
Phone: (215) 444-0888 • MBAKERINTL.COM

REVISION NUMBER	REVISIONS	DATE	BY

ARCONA TRAIL
MECHANICSBURG, CUMBERLAND COUNTY, PENNSYLVANIA

CHARTER HOMES
ARCONA DEVELOPMENT

DATE SEPT 2020	ROSSMOYNE ROAD - NORFOLK SOUTHERN RR GRADE CROSSING DETAILS	APPROVED
DRAWN BY SRD		SHEET 2 OF 2

ALL DIMENSIONS MUST BE VERIFIED BY CONTRACTOR AND OWNER MUST BE NOTIFIED OF ANY DISCREPANCIES BEFORE PROCEEDING WITH THE WORK.