



Emily M. Farah
Counsel, Regulatory

411 Seventh Avenue
Mail drop 15-7
Pittsburgh, PA 15219

Tel: 412-393-6431
efarah@duqlight.com

December 2, 2020

VIA ELECTRONIC FILING

Rosemary Chiavetta, Secretary
Pennsylvania Public Utility Commission
Commonwealth Keystone Building, 2nd Floor
400 North Street
Harrisburg, PA 17120

**Re: Municipal Contract –Right of Way Agreement between Duquesne Light Company
and Findlay Township
Docket No. U-2020-_____**

Dear Secretary Chiavetta:

Enclosed for review and approval in accordance with Section 507 of the Public Utility Code, 66 Pa.C.S. § 507 and 52 Pa. Code § 3.101, is a Right of Way agreement dated November 24, 2020 between Duquesne Light Company and Findlay Township. Findlay Township granted to Duquesne Light Company a Right of Way on its property situated in the Township of Findlay at Wilson Road, which provides the right to install, use, own, operate, maintain, repair, renew and remove an electrical line.

Should you have any questions regarding the enclosed right of way, please contact Dan Antosik at 412-393-8628.

Respectfully Submitted,

A handwritten signature in blue ink, appearing to read "Emily M. Farah", is written over a printed name and ID number.

Emily M. Farah
Attorney ID#322559

Enclosures

DUQUESNE LIGHT CO. COPY

RIGHT OF WAY AGREEMENT

The undersigned Grantor, **TOWNSHIP OF FINDLAY**, for good and valuable consideration, the receipt of which is hereby acknowledged does hereby grant unto Duquesne Light Company, its successors and assigns, for providing, transmitting and/or distributing electric and/or communications services current for any and all purposes, the right, privilege and authority to install, use, own, operate, maintain, repair, renew and finally remove two (21) anchor, attached to pole #252708, together with the guy wires and other apparatus thereto belonging, upon, over, under, along and across Grantors land, fronting on **Wilson Rd.**, situate in **Township of Findlay, Allegheny County, Pennsylvania**, and shown on Duquesne Light Company Drawing No. **758468-T6 it. 146**, a copy of which has been attached to and made part hereof. Duquesne Light Company shall also have the following rights: to trim or remove any trees or shrubbery which, at any time or times, may interfere or threaten to interfere with the erection, installation, use, operation, maintenance, repair, renewal or removal of the electric line; to enter upon the land at any time for such purposes; to permit others to attach guys and related apparatus; and to sell, assign, lease or otherwise transfer any or all rights hereunder.

Utility shall file a copy of this Agreement with the Pennsylvania Public Utility Commission as required by Title 66, Section 507 of the Public Utility Code, and this Agreement shall become effective in accordance therewith.

Intending to be legally bound the Grantor has executed this agreement this 24th day of November, 2020.

ATTEST:

TOWNSHIP OF FINDLAY

Cheryl A. Knecht
Secretary

By: Janet L. Craig
Chairman, Board of Supervisors

COMMONWEALTH OF PENNSYLVANIA

SS:

COUNTY OF ALLEGHENY

On this 24th day of November, 2020, before me, a Notary Public in and for the Commonwealth and County, personally appeared Janet L. Craig, Chairman of the Findlay Township Board of Supervisors a corporation, and as such Chairman, being authorized to do so, executed the foregoing instrument for the purposes therein contained.

WITNESS my hand and seal the day and year aforesaid.

Commonwealth of Pennsylvania - Notary Seal
Cynthia D. Harris, Notary Public
Allegheny County
commission expires March 21, 2023
Commission number 1348839
P.A. Pennsylvania Association of Notaries

Cynthia D. Harris
Notary Public

No. 758468-T6

MAP:
B7-13
CIRCUIT:
22906
D22906
D23602

DLCO #27982 (55')
10' SX (22D) (OH-7-6-A) 9' DXDD (23D) (OH-7-20)
9' SX (22D) (OH-7-28-B)

DLCO #27981 (65')
10' SX (22D) (OH-7-6-A) 8' SX (23D) (OH-7-27-C)
9' SX (22D) (OH-7-28-B) PDE (23D) (OH-7-33-A)
80E FUSE CUTOUT (OH-12-101)
10M (23D) LINE GUY

VZ #5050-137
DLCO #25727
60' (2) 65' (2)
10' SX (23T) (OH-7-6-A) 10' SX (23T) (OH-7-6-A)
8' SX (4KV) (OH-7-1-C) 9' SX (23D) (OH-7-28-C)
25KVA 2.4KV
TRANSFORMER
SITE 37 (120/240V)
(OH-10-4)
358 BKT
INTELLIURTER (OH-12-109)
WR1179
N.O. 22906 TO D23602
TPX CL

VZ #138-14
DLCO #25726
55' (2) 60' (2)
10' DXDD (23T) (OH-7-7) 10' DXDD (23T) (OH-7-7)
8' SX (4KV) (OH-7-1-C) 9' SX (23D) (OH-7-28-C)
CAPACITOR BANK (OH-13-11) 25KVA 13.2KV
3 - 4KV SWITCHES
18M (23T) ANCHOR GUY SITE 37 (120/240V C#)
(OH-10-44)
(2) 10M (23T) LINE GUY 18M (23T) ANCHOR GUY
(2) 358 BKT (2) TPX DE

PROFILE- WILSON RD

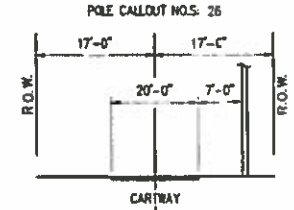

PROFILE - ITEM
N.T.S.

TRANSFER 2 SERVICES
TRANSFER 1 STREETLIGHT PER OH-17-24
REUSE ANCHOR
TRANSFER DL COMM
FOREIGN TPX TRANSFER BY OTHERS

DLCO #447376 (50')
18M (23D) ANCHOR GUY (10' GL)
1" DBL HLX ANCHOR

PROFILE- LINCOLN HWY/RTE 30

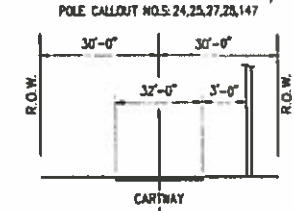

PROFILE - ITEM
N.T.S.

DLCO #25704
45' (3) 50' (2)
PTP (4KV) (OH-7-1-A) PTP (23D) (OH-7-27-A)
15KVA 2.4KV 9' DXD (4KV) (OH-7-3-B)
TRANSFORMER 167KVA 2.4KV
SITE 52 STEPDOWN TRANSFORMER
(OH-10-1) SITE 52
358 BKT (OH-10-39)
65K FUSE CUTOUT (4KV)
TPX DE
CN BKT
TRANSFER UG SVC

VZ #5050-134
DLCO #25730
55' (2) 55' (2)
10' DXDD (22T) (OH-7-7) 10' DXDD (22T) (OH-7-14)
8' SX (4KV) (OH-7-1-C) 9' DXD (23C) (OH-7-21-A)
50KVA 2.4KV 50KVA 2.4KV
TRANSFORMER TRANSFORMER
SITE 45 (OH-10-6) SITE 45 (120/240V B#)
(OH-12-22.1) (OH-10-3)
SWITCHES (22T) (OH-12-22.1) SWITCHES (22T) (OH-12-22.1)
10M (4KV) LINE GUY D181
(4) 358 BKT N.C.
18M (22T) LINE GUY
18M (23D) LINE GUY
10M (4KV) LINE GUY
(2) TPX CL
(2) 358 BKT

DLCO #25708
45' (3) 50' (2)
PTP (4KV) (OH-7-1-A) PDE (23D) (OH-5-2-B)
PDE (4KV) (OH-5-2-E) 4' DX (4KV) (OH-7-1-B)
10M (4KV) ANCHOR GUY PDE (4KV) (OH-7-22)
CN BKT 10M (4KV) ANCHOR GUY
18M (23D) ANCHOR GUY (10' GL)
1" DBL HLX ANCHOR
CN BKT
DPX DE
REUSE ANCHOR

THIRD PARTY ATTACHMENTS
VERIZON 724-656-5211
COMCAST 412-875-1327

RELATED DRAWINGS
758468-T1 THRU T5 CIRCUIT DESIGN
758468-T7 THRU T27 CIRCUIT DESIGN
758468-T28 THRU T39 REVISED CIRCUIT MAPS
NJUNS PROJECT# 99063



DESIGN PA ONECALL
20181572812
2020 492361

VICINITY MAP

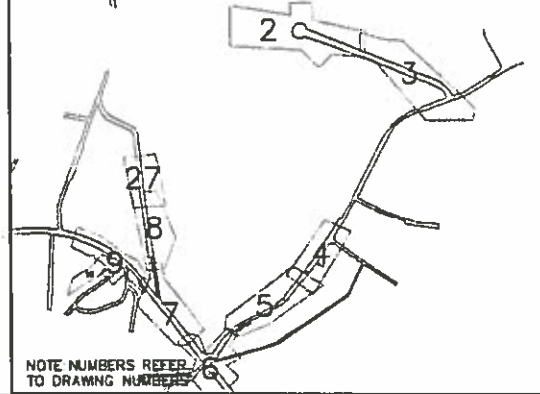

NOTE NUMBERS REFER
TO DRAWING NUMBERS

CLINTON D23602
FINDLAY TWP, PA
PERMIT AND CONSTRUCTION PLAN

TRANSFER 1 MIDSPAN SERVICE
TRANSFER DL COMM
TRANSFER STREETLIGHT PER OH-17-24

VZ #58-1
DLCO #25706

45' (3) 50' (2)
PTP (4KV) (OH-7-1-A) PTP (23D) (OH-7-27-A)
(2) PDE (4KV) (OH-7-3-A) (2) PDE (23D) (OH-5-2-B)
15KVA 2.4KV TRANSFORMER
SITE 38 (120/240V) (OH-10-4) (OH-10-44)
10M (4KV) ANCHOR GUY 10M (23D) ANCHOR GUY
358 BKT (2) TPX DE
CN BKT

TRANSFER 2 SERVICES
TRANSFER 1 STREETLIGHT PER OH-17-24
REUSE ANCHOR

FINDLAY TOWNSHIP
1179-E-38

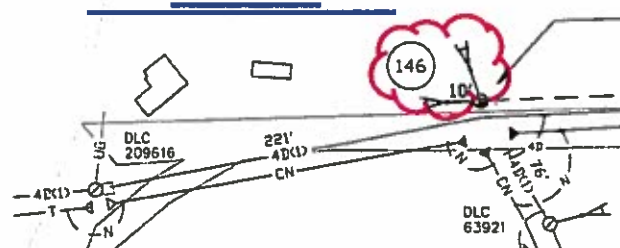

VZ #5050-35
40' (3) JOINT VZ | 70' (2) 100% VZ OWNED

DLCO #25729
8' SX (4KV) (OH-7-1-C) 10' SX (23T) (OH-7-6-A)
9' SX (23D) (OH-7-28-C)
9' DXD (4KV) (OH-7-3-D)
(3) 167KVA 13.2KV
STEPDOWN TRANSFORMER
SITE 77 (OH-10-53)
(3) 100R (23D) RECLOSERS
10M (23D) LINE GUY
18M (4KV) ANCHOR GUY (10' GL)
1" DBL HLX ANCHOR
TPX CL
OPX DE

TRANSFER 1 MIDSPAN SERVICE
TRANSFER DL COMM
REMOVE TOP 8' OF POLE PER OH-10-73.1

SUMMARY

DLC WORK	QTY	PRIVATE PROPERTY	QTY	STATE	QTY	FINDLAY TWP
REPLACE POLE	2	(19) (44)	4	(24) (27) (28) (10)	1	(2)
REPLACE ANCHOR	2	(8) (2)				
INSTALL ANCHOR	1	(16)	2	(25) (14)		
VZ WORK	QTY	STATE	QTY	FINDLAY TWP		
REPLACE POLE	1	(2)				

REVISIONS
1) PARCEL LINES
ADDED
JUN 10-5-20

APPROVED
By jscheff at 3:38 pm, Oct 09, 2020

ISSUED FOR
CONSTRUCTION
08/27/20

Booth & Associates, LLC



DLC DUQUESNE LIGHT CO.

SCALE	DRY	CHK	DATE	DRY	CHK	DATE
1"=50'	JEH		08/27/20	MJS		08/27/20
	JBW		08/27/20	JBW		08/27/20

A 19-0018 758468-T6 1