



3/12/2021

Public Utilities Commission
P.O. Box 3265
Harrisburg, PA 17105-3265

RE: Notification of Occupation

To Whom It May Concern,

On behalf of Comcast Cable Communications Management, LLC, we submit the enclosed notification for your review. This is in reference to a proposed underground wire occupation of SEPTA Railroad and Pennsylvania public right-of-way property. Enclosed you will find one (1) application, one (1) verification, one (1) set of engineered plan and profile diagrams, one (1) exhibit ("Exhibit B"), and one (1) certificate of service.

The proposed Comcast facility will be at the following location:

- Reference Address: 1145 Edgewood Road, Morrisville, PA 19067
- AAR DOT/Milepost: 589737B / QA 29.7
- Railroad Branch/Line: Neshaminy
- Coordinates: 40.22490, -74.84650

Please send all responses to AmeriComm, LLC at the below contact information.

Sincerely,

Tabatha Smith
Engineering Coordinator
AmeriComm, LLC
21 State Avenue, Suite 1
Carlisle, PA 17013
(717) 408 – 9112
tabatha@americomm-llc.com

**BEFORE
THE PENNSYLVANIA PUBLIC UTILITIES COMMISSION**

In Re: Application of Comcast Cable Communications Management, LLC for approval of the installation of an underground communication facility where Edgewood Road crosses at grade with tracks of SEPTA Railroad. Located in Lower Makefield Township, Bucks County.
AAR DOT: 589737B.
Comcast Identifier: F-JB500854 (Edgewood Road)

TO THE PENNSYLVANIA PUBLIC UTILITIES COMMISSION

1) Applicant:

Comcast Cable Communications Management, LLC
15 Summit Park Drive
Pittsburgh, PA 15275
tabatha@americomm-llc.com

2) Applicant's Attorney:

Comcast Cable Communications Management, LLC
1701 John F Kennedy Boulevard
Philadelphia, PA 19103
ATTN: General Counsel
legal_notices@comcast.com

- 3.** Comcast wishes to install an underground communication facility in Lower Makefield Township, Bucks County. To complete the system, Comcast must work within the private right-of-way of SEPTA Railroad and the public right-of-way of Edgewood Road. The facility will be placed from existing utility riser pole #53381 to existing utility riser pole #53380.
- 4.** The proposed installation will be an underground communication facility placed between utility poles on the north side of the railroad crossing. The railroad intersects Edgewood Road at grade. See attached engineered plan and profile diagrams for further detail. The approximate start and completion date for this project is April 12th, 2021. This date is subject to change depending on when the required approvals/permitting are received from the PUC and SEPTA.
- 5.** The public utilities, municipalities, corporations, and property owners concerned in, or affected by, this installation are identified in Exhibit "B" attached hereto.

6. Because the underground communication line will have no impact on rail traffic or the motoring public, no vehicle use data has been developed in connection with this application. Comcast will follow its normal procedure for the installation of a communication facility within a public right-of-way along a public roadway. Comcast uses construction procedures including the use of warning devices and flagmen to maintain, as nearly as possible, the normal flow of vehicular traffic.

7. The expected cost for the installation procedure is \$1000.00. Comcast will pay all costs of construction of the aerial communication line and are responsible for installing, maintaining, and inspecting the facilities.

8. The alteration is necessary or proper for the following reasons: to provide adequate, efficient, and reasonable communication facilities to the public in Bucks County and surrounding areas.

Wherefore, applicant prays your Honorable Commission to approve the application:

Respectfully Submitted,

A handwritten signature in blue ink, appearing to read "Tabella J. Miller", is written over a horizontal line.

(Signature of Applicant)

1.36. Verification.

(a) Applications, petitions, formal complaints, motions and answers thereto containing an averment of fact not appearing of record in the action or containing a denial of fact shall be personally verified by a party thereto or by an authorized officer of the party if a corporation or association. Verification means a signed written statement of fact supported by oath or affirmation or made subject to the penalties of 18 Pa. C.S. §4904 (relating to unsworn falsification to authorities). If verification is required, notarization is not necessary.

(b) The Verification form should comply substantially with the following:

VERIFICATION

I, Tabatha Smiler, hereby state that the facts above set forth are true and correct (or are true and correct to the best of my knowledge, information and belief) and that I expect to be able to prove the same at a hearing held in this matter. I understand that the statements herein are made subject to the penalties of 18 Pa. C.S. § 4904 (relating to unsworn falsification to authorities).

Date: **March 12th, 2021**

Tabatha Smiler
(Signature)

EXHIBIT "B"

The public utilities, municipalities, corporations, and property owners concerned in, or affected by, the installation are:

SEPTA
PO BOX 7780-4044
Philadelphia, PA 19182-4044
glawrence@septa.org

Lower Makefield Township
1100 Edgewood Road
Yardley, PA 19067
admin@lmt.org

Franklin County Planning Commission
The Almshouse, Neshaminy Manor Cantor
1260 Almshouse Road
Doylestown, PA 18901
bcpc@buckscounty.org

PECO Customer Solution Center
2301 Market Street
Philadelphia, PA 19103
1-800-494-4000
No email address provided for PECO.

PennDOT Engineering District 6
7000 Geerdes Boulevard
King of Prussia, PA 19406
No email address provided for district.

PennDOT Office of Chief Counsel
ATTN: Gina D'Alfonso, Esquire and Jason Sharp, Esquire
PO BOX 8212
Harrisburg, PA 17105-8212
gdalfonso@pa.gov
jsharp@pa.gov

PennDOT
ATTN: Daniel Leonard, Engineer
PO BOX 3362
Harrisburg, PA 17015-3362
danleonard@pa.gov

CERTIFICATE OF SERVICE

I, Tabatha Smith, of Comcast hereby certify that I have this day, 03-12-2021, served a true copy of the foregoing document upon the participants, listed below, in accordance with the requirements of § 1.54 (relating to service by participant).

Signature: _____

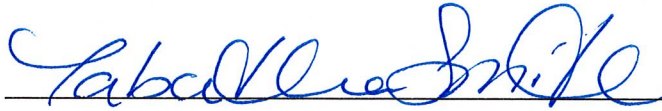

SEPTA
PO BOX 7780-4044
Philadelphia, PA 19182-4044
glawrence@septa.org

Lower Makefield Township
1100 Edgewood Road
Yardley, PA 19067
admin@lmt.org

Franklin County Planning Commission
The Almshouse, Neshaminy Manor Cantor
1260 Almshouse Road
Doylestown, PA 18901
bcpc@buckscounty.org

PECO Customer Solution Center
2301 Market Street
Philadelphia, PA 19103
1-800-494-4000
No email address provided for PECO.

PennDOT Engineering District 6
7000 Geerdes Boulevard
King of Prussia, PA 19406
No email address provided for district.

PennDOT Office of Chief Counsel
ATTN: Gina D'Alfonso, Esquire and Jason Sharp, Esquire
PO BOX 8212
Harrisburg, PA 17105-8212
gdalfonso@pa.gov
jsharp@pa.gov

PennDOT
ATTN: Daniel Leonard, Engineer
PO BOX 3362
Harrisburg, PA 17015-3362
danleonard@pa.gov

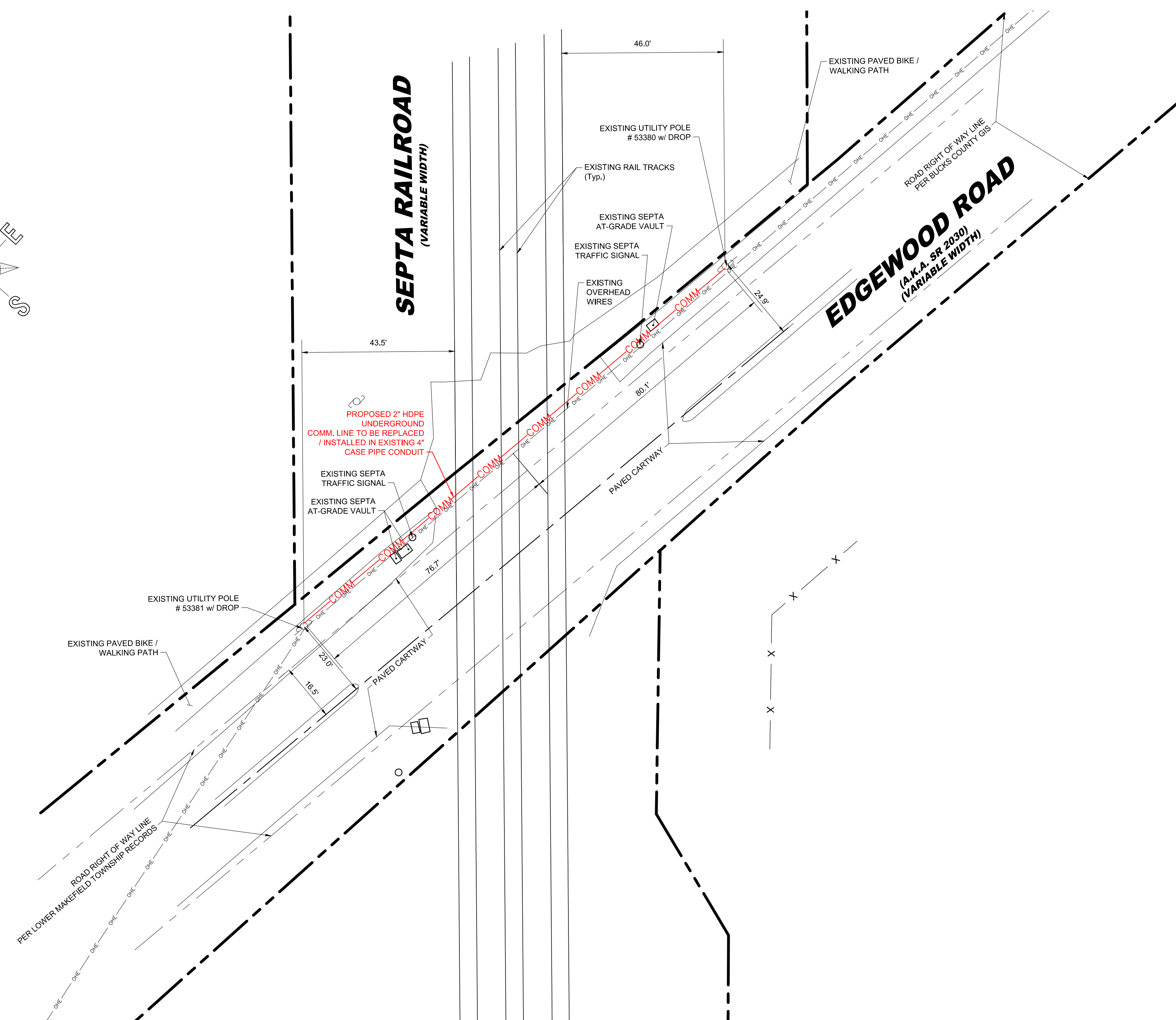
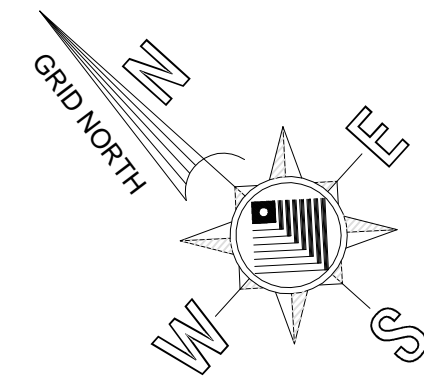

LEGEND	
RIGHT OF WAY LINE	---
CENTER-LINE	---
FENCE LINE	---
OVERHEAD LINE	OHE
PROPOSED COMM LINE	--- COMM ---
UTILITY POLE	⊕

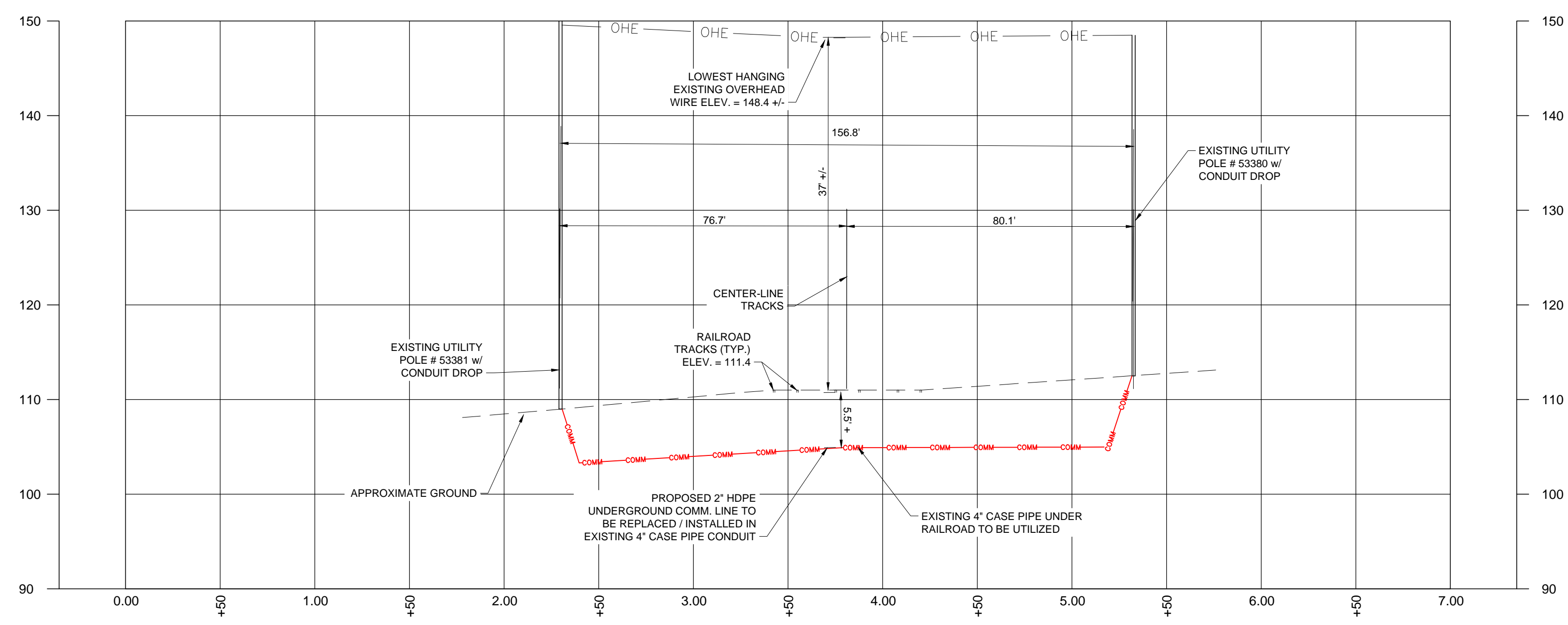
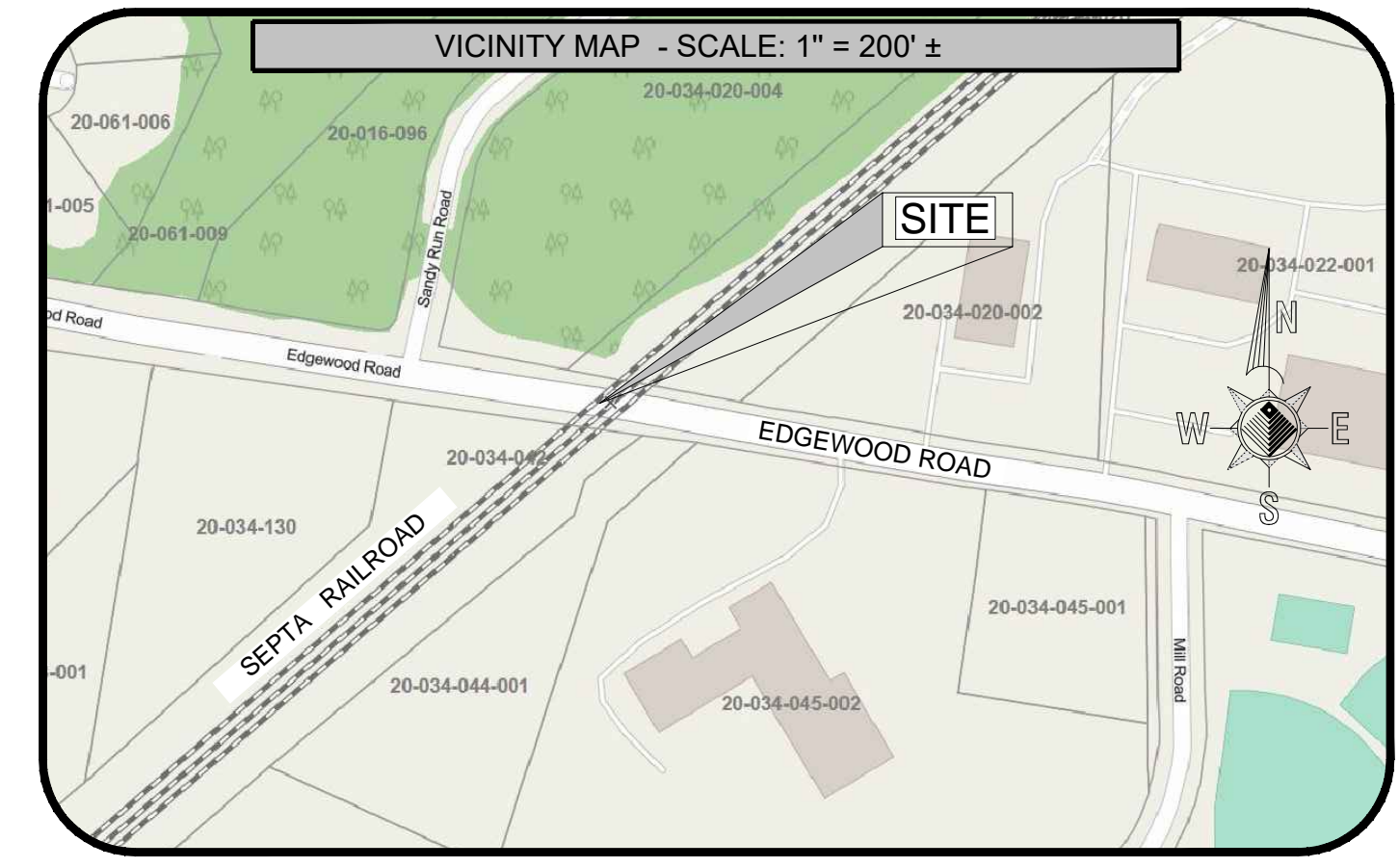

UNDERGROUND COMM. LINE UNDER RAILROAD - PROFILE LOOKING NORTHEAST
 SCALE: 1" = 20' HORIZONTAL
 1" = 10' VERTICAL

- CONSTRUCTION NOTES**
- ALL UNDERGROUND UTILITIES, CABLE, AND FACILITIES MUST BE LOCATED AND PROTECTED BEFORE ANY EXCAVATING, DRILLING, BORING/DIRECTIONAL DRILLING, GROUND PENETRATING ACTIVITIES, OR CONSTRUCTION TAKES PLACE. THIS INCLUDES RAILROAD AND COMMERCIAL UTILITIES, CABLES, DUCT LINES, AND FACILITIES. THESE ACTIVITIES WILL NOT BE PERFORMED IN CLOSE PROXIMITY TO THE RAILROAD DUCT LINES UNLESS MONITORED BY ON-SITE RAILROAD COMMUNICATIONS AND SIGNAL (C&S) DEPARTMENT PERSONNEL. HAND DIGGING MAY BE REQUIRED, AS DIRECTED BY THE RAILROAD THROUGH THE ON-SITE RAILROAD C&S SUPPORT PERSONNEL. THE RAILROAD MAINTAINS THE RIGHT TO ACCESS ALL EXISTING CABLES AND CONDUITS THROUGHOUT CONSTRUCTION. THE RAILROAD ALSO RESERVES THE RIGHT TO UPGRADE AND INSTALL NEW CABLES AND CONDUITS IN THE AFFECTED AREA. THE "ONE-CALL" PROCESS MUST BE FOLLOWED. BE AWARE THAT THE RAILROAD IS NOT PART OF THE ONE-CALL PROCESS. CONTACT THE RAILROAD ENGINEERING TO HAVE ALL RAILROAD UNDERGROUND UTILITIES AND ASSETS LOCATED. IF REQUESTED BY THE RAILROAD, EXISTING DEPTHS OF UTILITIES BEING CROSSED MUST BE VERIFIED THROUGH TEST PITS PERFORMED BY THE CONTRACTOR AS DIRECTED BY AND UNDER THE DIRECT SUPERVISION OF THE RAILROAD C&S SUPPORT PERSONNEL. PRECAUTIONS MUST BE TAKEN TO PREVENT ANY INTERRUPTION TO RAILROAD OPERATION.
 - SIGNAL PREVIEW MUST NOT BE OBSTRUCTED. CONSULTANTS PERFORMING WORK FOR THE RAILROAD OR ON RAILROAD PROPERTY MUST SHOW THAT THERE IS ADEQUATE SIGNAL PREVIEW. IN ADDITION, ALL TEMPORARY STRUCTURES, FORMWORK, EQUIPMENT, ETC. MUST COMPLY DURING CONSTRUCTION.
 - THE RAILROAD C&S PERSONNEL MUST FIELD-VERIFY THAT THERE IS NO SIGNAL EQUIPMENT IN THE WAY OF THE PROJECT AND THAT SIGNAL PREVIEW IS NOT BEING OBSTRUCTED.
 - IF WORK SHALL BE PERFORMED ON RAILROAD PROPERTY THAT INVOLVES HEAVY TRUCKS, EQUIPMENT, OR MACHINERY ALONG THE RIGHT-OF-WAY, DUCT LINES AND PULL BOXES SHALL BE INSPECTED BY ON-SITE RAILROAD PERSONNEL AND THE EQUIPMENT OPERATOR TO INSURE THEY CAN WITHHOLD THE APPROPRIATE WEIGHT. REFER TO TIERS & STATIC WHEEL LOAD RATINGS DOCUMENT.
 - ALL PERSONS THAT ARE ON OR ADJACENT TO RAILROAD PROPERTY MUST SUCCESSFULLY COMPLETE THE CONTRACTOR ORIENTATION TRAINING. ALL CONTRACTORS MUST CARRY THEIR "RAILROAD CONTRACTOR ROADWAY WORKER PROTECTION" CARD WITH THEM AT ALL TIMES WHILE ON OR ADJACENT TO RAILROAD PROPERTY.
 - ALL WORK ON OR ADJACENT RAILROAD PROPERTY MUST COMPLY WITH THE ENGINEERING PRACTICES EP3014 - MAINTENANCE AND PROTECTION OF RAILROAD TRAFFIC DURING CONTRACTOR OPERATIONS.
 - RAILS MUST BE PROTECTED AGAINST DEBRIS, RUST, SAND, METAL SHAVINGS OR OTHER MATERIAL CAN INTERFERE WITH THE PROPER SHUNTING SENSITIVITY OF THE TRACK CIRCUIT.
 - ANY DEBRIS OR DAMAGE RESULTING FROM WORK SHALL BE IMMEDIATELY REPORTED TO THE RAILROAD. RAILROAD SHALL BE REPAIRED BY RAILROAD FORCES AT PROJECT EXPENSE.

PLAN DATA

DATUM: NAVD88

TOPOGRAPHIC INFORMATION USED FOR THIS PLAN WAS BASED ON A FIELD SURVEY PERFORMED BY MERESTONE CONSULTANTS, INC., IN DECEMBER 2020. TOPO INFORMATION WAS ONLY COLLECTED FOR UTILITY POLES, GROUND ELEVATION AND RAIL TRACK ELEVATIONS. A FULL TOPOGRAPHIC SURVEY WAS NOT PERFORMED.

REFERENCES:

- BUCKS COUNTY PA GIS
- LOWER MAKEFIELD TOWNSHIP - PUBLIC WORKS DEPARTMENT

- GENERAL NOTES**
- LOCATION OF ALL UNDERGROUND UTILITIES IS APPROXIMATE. ALL LOCATIONS AND SIZES ARE BASED ON ABOVE GROUND STRUCTURES THAT WERE VISIBLE & ACCESSIBLE IN THE FIELD, AND THE MAPS LISTED IN THE REFERENCES AVAILABLE AT THE TIME OF THE SURVEY. AVAILABLE ASBUILT PLANS AND UTILITY MARKOUT DOES NOT ENSURE MAPPING OF ALL UNDERGROUND UTILITIES AND STRUCTURES. BEFORE ANY EXCAVATION IS TO BEGIN, ALL UNDERGROUND UTILITIES SHOULD BE VERIFIED AS TO THEIR LOCATION, SIZE AND TYPE BY THE PROPER UTILITY COMPANIES.
 - THIS PLAN IS BASED ON INFORMATION PROVIDED BY A SURVEY PREPARED IN THE FIELD BY MERESTONE CONSULTANTS, INC. AND OTHER REFERENCE MATERIAL AS LISTED HEREON.
 - THIS PROPERTY MAY BE SUBJECT TO RESTRICTIONS, COVENANTS AND/OR EASEMENTS, WRITTEN OR IMPLIED.
 - THE EXISTENCE OF UNDERGROUND STORAGE TANKS, IF ANY, WAS NOT KNOWN AT THE TIME OF THIS SURVEY.
 - PLANIMETRIC INFORMATION SHOWN HEREON DERIVED FROM A FIELD SURVEY USING LEICA GS18 GPS AND TS16 ELECTRONIC TOTAL STATION FOR RADIAL METHOD LOCATION. ALL MEASUREMENTS HAVE BEEN ADJUSTED FOR TEMPERATURE AND BAROMETRIC PRESSURE.
 - HORIZONTAL DATUM = PA SOUTH COORDINATE SYSTEM - NAD83(NA2011) EPOCH 2010.00
 - VERTICAL DATUM = NAVD88 - GEOID 12B
 - ANGULAR UNITS AND BEARINGS SHOWN ON THIS PLAN ARE ANNOTATED IN DEGREES MINUTES AND SECONDS.
 - DISTANCE UNITS SHOWN ON THIS PLAN ARE ANNOTATED IN U.S. SURVEY FEET.
 - RIGHT OF WAY LINES OF EDGEWOOD ROAD IS SHOWN PER TOWNSHIP RECORDS AND FIELD EVIDENCE

PURPOSE NOTE

THE PURPOSE OF THIS PLAN IS TO SHOW A PROPOSED UNDERGROUND WIRE REPLACEMENT CONNECTION UNDER THE SEPTA RAILROAD TRACKS IN AN EXISTING UNDERGROUND 4" CASE PIPE CONDUIT FOR A CONNECTION BETWEEN EXISTING UTILITY POLES.

UTILITY CROSSING - UNDERGROUND

FOR A PROPOSED FIBER OPTIC REPLACEMENT LINE

PREPARED FOR
AMERICOMM
 LOCATED AT
**EDGEWOOD ROAD &
 SEPTA RAILROAD**
 RR CROSSING # 589 737 B
 RR MILEPOST: QA 0029.70
 SITUATE IN
 LOWER MAKEFIELD TOWNSHIP
 BUCKS COUNTY - COMMONWEALTH OF PENNSYLVANIA
 SCALE: 1" = 20'
 DATE: 8 DECEMBER 2020

GRAPHIC SCALE

(IN FEET)
 1 inch = 20' ft.

APPROVED: *Michael J. Early*
 Date: 14 Dec 2020

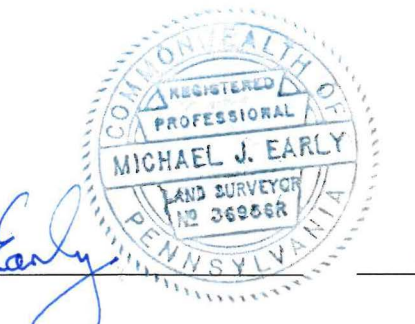

DATE			REVISION			CHKD			DRAWN BY: mdl			DATE: 8 DECEMBER 2020			SHEET#: 1 OF 1		
COMCAST CABLE																	
PLAN #: 25063 - 330323																	