

PLAN VIEW

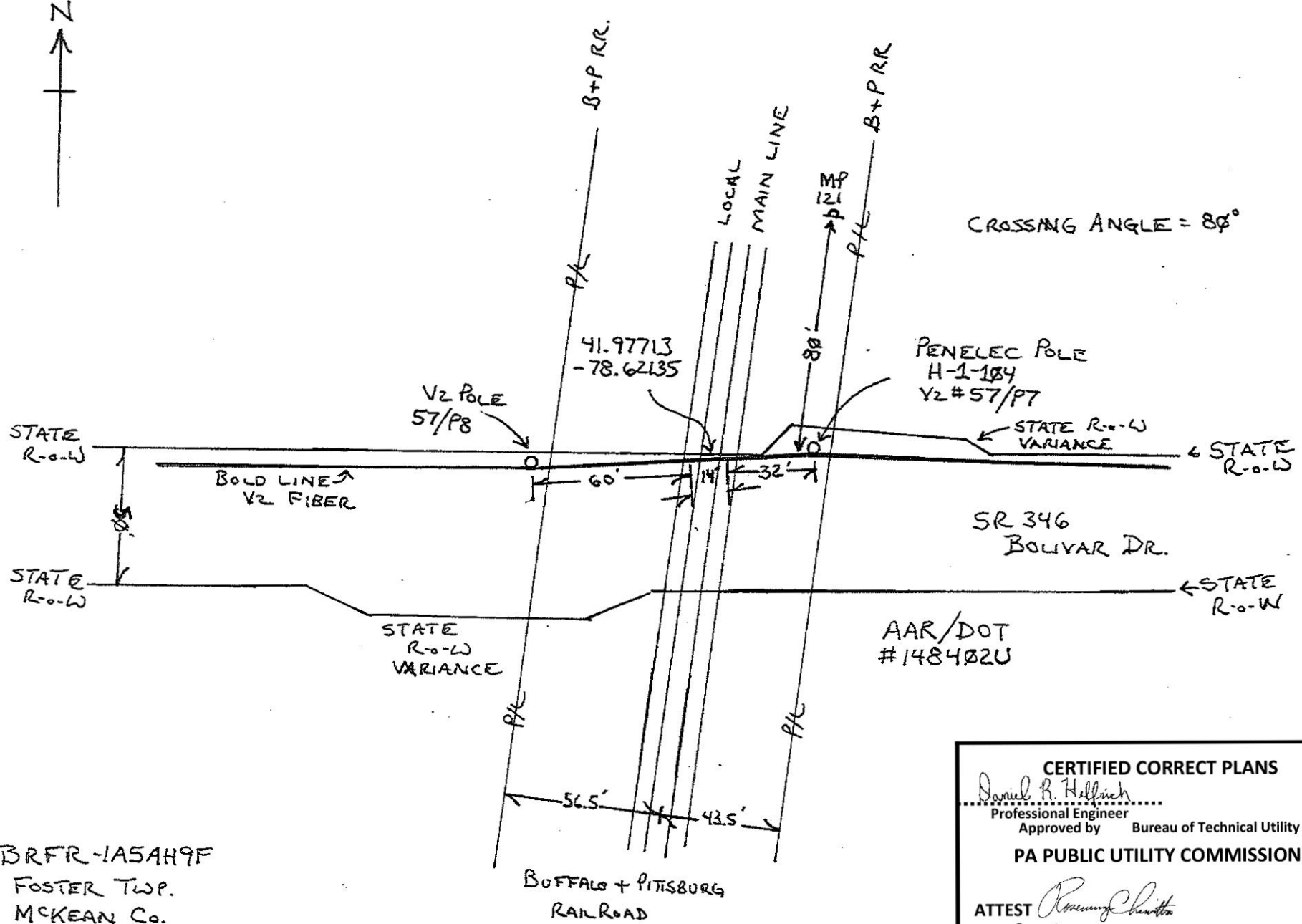

BRFR-1A5AH9F  
 FOSTER TWP.  
 MCKEAN Co.  
 PENNSYLVANIA

**CERTIFIED CORRECT PLANS**  
*Daniel R. Hellrich*  
 Professional Engineer  
 Approved by Bureau of Technical Utility Services  
**PA PUBLIC UTILITY COMMISSION**  
 ATTEST *Rosamund Chittick*  
 Secretary

Docket A-2021-3029059

**CERTIFIED CORRECT PLANS**  
*Daniel R. Hollrich*  
 Professional Engineer  
 Approved by Bureau of Technical Utility Services  
**PA PUBLIC UTILITY COMMISSION**  
 ATTEST *Rosemary Chiverton*  
 Secretary

Docket A-2021-3029059

PROFILE VIEW  
 LOOKING NORTH  
 FROM CENTER  
 OF ROAD

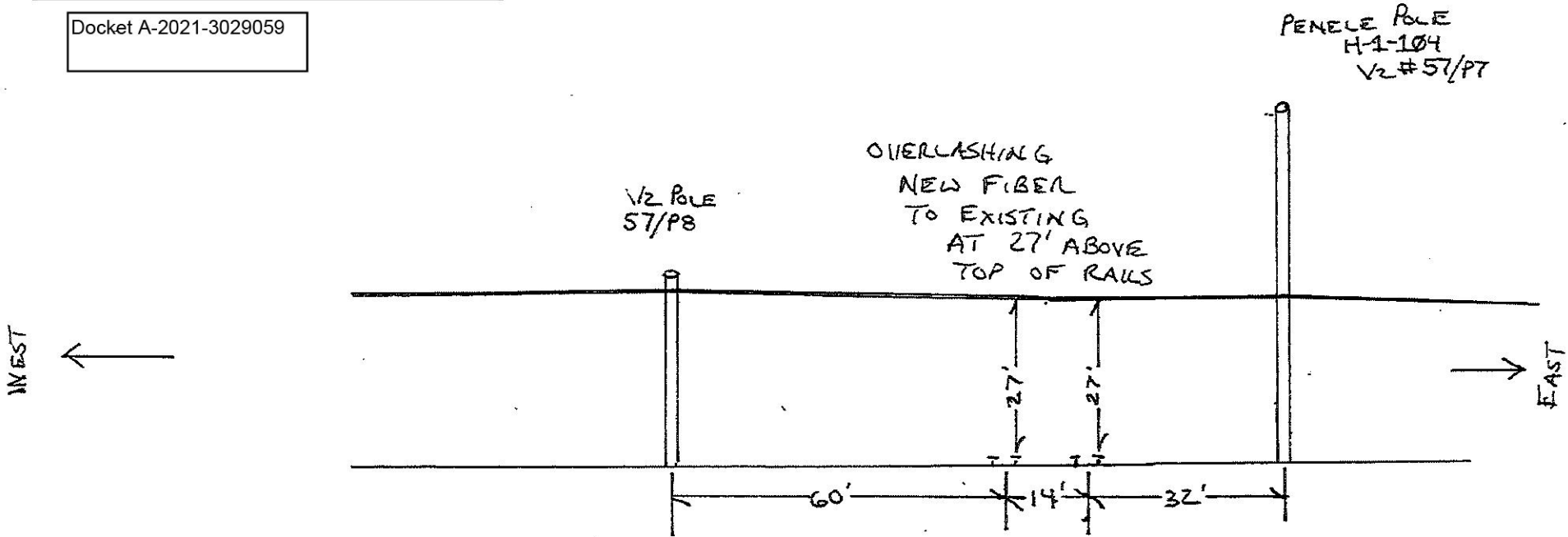

OVERLASHING  
 NEW FIBER  
 TO EXISTING  
 AT 27' ABOVE  
 TOP OF RAILS

1/2 LINE  
 CROSSES  
 IN STATE  
 R-O-W  
 88' SOUTH  
 OF  
 MILE POST 121

41.97713  
 -78.62135

AAR/DOT# 148402U

BRFR-1A5AH9F  
 FOSTER TWP.  
 MSKEAN Co.  
 PENNSYLVANIA

BUFFALO + PITTSBURG  
 RAIL ROAD