

1
2
3
4
5
6
7
8
9
10
11
12
13
14
15
16
17
18
19
20
21
22
23
24
25
26
27
28
29
30
31
32
33
34

Andrea Berardi
v.
PECO Energy Company
Further Call-In
Telephonic Hearing

Docket No.: C-2021-3028230

Pages 125 - 300

Judge's Chambers
State Office Building
801 Market Street
Philadelphia, PA

Tuesday, December 14, 2021
Commencing at 10:00 a.m.

INDEX TO EXHIBITS

Docket No. C-2021-3028230

Hearing Date: December 14, 2021

<u>NUMBER</u>	<u>FOR IDENTIFICATION</u>	<u>IN EVIDENCE</u>
Berardi Exhibit 1	274	279
Screenshot		
Berardi Exhibit 2	275	279
Screenshot		
Berardi Exhibit 3	275	279
Photograph		
Berardi Exhibit 4	276	279
Fire Report		
Berardi Exhibit 5	277	279
Photograph		

1 -----
 2 Andrea Berardi
 3 v. Docket No.: C-2021-3028230
 4 PECO Energy Company
 5
 6 Further Call-In
 7 Telephonic Hearing
 8 -----
 9 Pages 125 - 300

10 Judge's Chambers
 11 State Office Building
 12 801 Market Street
 13 Philadelphia, PA
 14

15 Tuesday, December 14, 2021
 16 Commencing at 10:00 a.m.
 17
 18

19 INDEX TO EXHIBITS (CON'T)

20 Docket No. C-2021-3028230

21 Hearing Date: December 14, 2021
 22

23	<u>NUMBER</u>	<u>FOR IDENTIFICATION</u>	<u>IN EVIDENCE</u>
24	PECO's Exhibit 1	--	287
25	06/25/21 Email to Complainant		
26	PECO's Exhibit 2	--	287
27	Decision Report		
28	PECO's Exhibit 3	--	287
29	Submitted PECO Electric		
30	Service and Meters		
31	Application		
32	PECO's Exhibit 4	--	287
33	Section 3.6 and 10.7		
34	of PECO Electric Tariff		

1
2
3
4
5
6
7
8
9
10
11
12
13
14
15
16
17
18
19
20
21
22
23
24
25
26
27
28
29
30
31
32
33
34

Andrea Berardi
v.
PECO Energy Company
Further Call-In
Telephonic Hearing

Docket No.: C-2021-3028230

Pages 125 - 300

Judge's Chambers
State Office Building
801 Market Street
Philadelphia, PA

Tuesday, December 14, 2021
Commencing at 10:00 a.m.

INDEX TO EXHIBIT (CON'T)

Docket No. C-2021-3028230

Hearing Date: December 14, 2021

PECO's Exhibit 5	179	286
Service Reliability		
Report		
PECO's Exhibit 6	161	287
Map		
PECO's Exhibit 7	163	287
E-2527		
PECO's Exhibit 8	185	287
OMS Report		

For Docket Number: **C-2021-3028230 - ANDREA BERARDI v. PECO ENERGY COMPANY**

E-Filing#2254586

Description: Andrea Berardi v. PECO Energy Company

I am providing my property deed screenshot (Exhibit 1) from the Lower Moreland Township database & the

Screen shot from the Montgomery County Township database that shows there are

No easements on my property (Exhibit 2)

128 Red Lion Road

Huntingdon Valley, PA 19006

Lower Moreland Township

Montgomery County, PA

I am also including a picture (Exhibit 3) taken from my home of the electrical fire in the backyard of the unsafe conditions.

Sincerely,

Mrs. Andrea Berardi

Exhibit 1

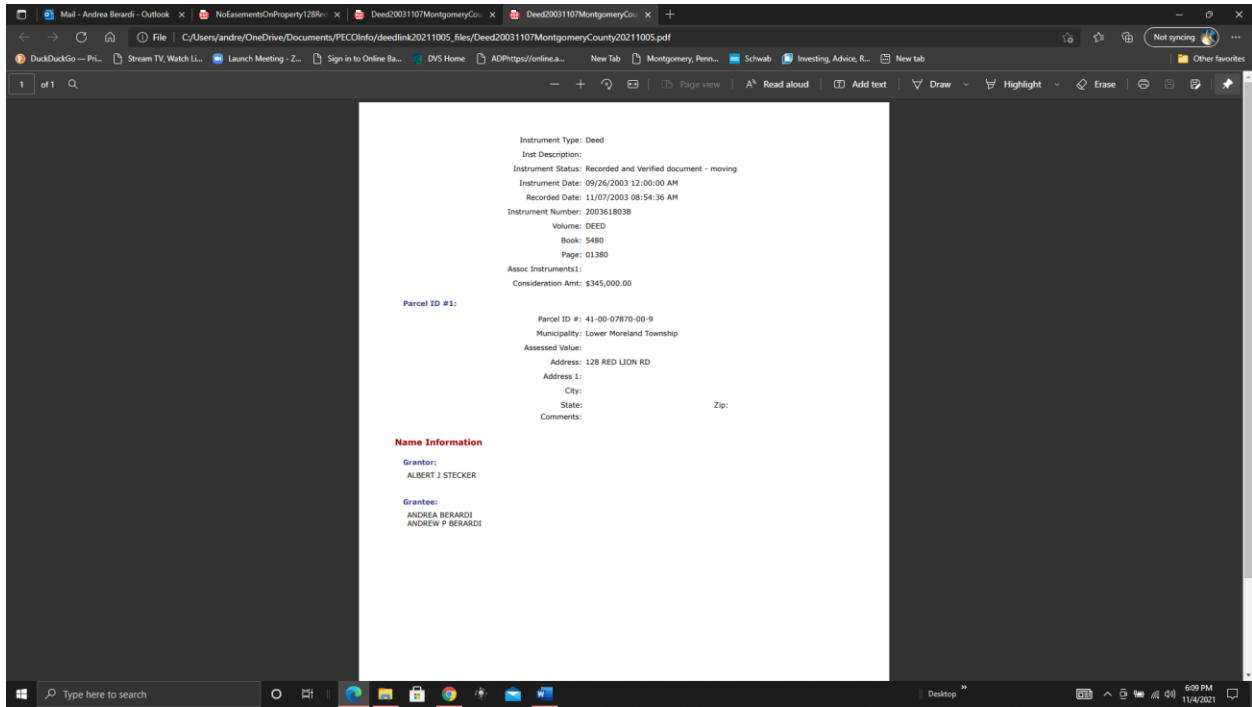

Exhibit 2

The screenshot shows a web browser window with the URL <https://rodviewer.montcopa.org/countyweb/disclaimer.do>. The page title is "Montgomery County Online Services" and the user is logged in as "Jeanne Sorg ~ Recorder of Deeds".

The main content area is titled "Search Criteria" and includes a "Display: 10" dropdown and "Records per page" set to "Recent". Below this is a "Search Types" sidebar with options like Individual, Corporation, All Names, Document Number, Book / Page, Parcel Id (selected), Address, UCC File Number, Charter Index, Commission Index, Limited Partnership Index, General POA Index, and GTR/GTE Power of Attorney In....

The "Specific Criteria" section shows a search for "128 Red Lion" with the following details:
Parcel Id: [input field]
Property Address: 128 Red Lion
Recorded Date From: 01/01/1920 To: 12/31/2021 User Defined

A red message states: "No documents were found that match the specified criteria." Below this is a detailed instruction: "Enter the street name in the Property Address field. You may include the house number but it is not required. It is better to not include the type of street. (Bypass, Road, Lane, etc.) since these are sometimes abbreviated. All words entered in this search will be found in their entirety and can be found in any order within the street address. Sometimes the addresses are not recorded as specifically as they are commonly known, so it is usually better to try a more general search first. For example, if you are looking for 100 North Main St, it is better to start with a search for '100 Main' or even 'Main' to make sure that you find all of the different ways it might have been used. Do not enter city names since this search only looks at the street address."

The "Document Types" sidebar on the right lists various document categories with checkboxes, including COIN, DEED, Deed Miscellaneous, Deed Miscellaneous Taxable, Re-determination, Re-determination - Act 40, Termination of Leases and Rents, Foreclosure Deed, Sheriff's Deed, Act 219 Preferential Assessment, Court Order Deed, Deed of Confirmation, Deed of Consolidation, Deed of Dedication, Easement, Ejection to Title, Leases, Right of Way, Proprietary Lease, HEHC, HEIG, HLN, POA, SAT, and MCC.

At the bottom of the page, there is a "LIVE CHAT" button and a "Powered By KOFIL" logo. The Windows taskbar at the very bottom shows the time as 10:40 AM on 10/5/2021.

Exhibit 3 Electrical Fire in Backyard



HUNTINGDON VALLEY FIRE COMPANY No. 1

REPORT #
71

Total Time
25 MINS

Public Service Report

Date	County Incident Number	Weather	Temp.	Report Prepared By;
3/2/18	FD 05764	Snow	33.3°	Valesky 73

Time Dispatched	Time Available	Station Restored	ADDRESS or SPECIAL NOTES
14:22	14:30	14:50	Red Ln. Rd & Hwy 1 Rd

CTY Call Code	STA. #	ASSISTED STATION	DRILL / TRAINING	MONTHLY MEETING
FEO		N/A		

SQ-8	E-8	TW-8	TR-8	MIAR-8	UTY-8	NO TRUCKS	OTHER
	X						AC-8

PLATOON CALL #	ATTENDANCE	TOTAL MEMBERS
		2

11	31	51	Wellaw, A.J.	71	Gil, F.	91	Lichtfentein, I.
12	Campbell, T. (S.O.-8)	32	Synnestvedt, E.	52	O'Brien, T.	72	Molda, M.
13		33	Kim, R.	53	Wailand, W. Sr. (AC-ENG)	73	Valesky, K. (Capt.-8)
14	Herwig, R.	34		54	Walker, F.	74	Lavenbein, M.
15	Stiteler, R.	35	Randolph, P.	55	Molly, K. (LT-8)	75	RAD (Gulf Exp.)
16		36	Thomas, R.	56	Campbell, I.	76	Gulnik, M.
17		37	McC (Who Jack)	57	Roggio, M.	77	Lavenbein, R.
18	Scholly, R. (FM-26)	38	Blair, J.	58	Roggio, G.	78	Kaufmann, A.
19	Maier, E. Jr.	39	DeRenzis, N. (CAPT.)	59	Beardel, B.	79	
20	Schadegg, R. (CH-8)	40	Valesky, S.	60	Dix, E.	80	Riemold, G.
21	Goold, A.	41	Satterthwaite, M.	61	Campbell, T. Jr. (LT-8)	81	
22	Daniel, K. (DG-8)	42	Summers, P.	62	Weinstein, J.	82	Dibelius, G.
23	Middleman, T.	43	Stewart, W.	63	Bucley, A.	83	Gazerna, C.
24		44	Gestroni, R.	64	Bucley, J.	84	Convery, R.J.
25	Golembiski, M.	45	Weir, T.	65	Nocella, R. Sr.	85	Peoples, K.
26		46		66	Ramsden, J.	86	Saul, S.
27	Wood, D. (LIEUT.)	47	Bannon, J. (LT-8-3)	67	Maier, E. Sr.	87	Amato, G. (CH-ENG)
28	Gordon, Evan	48	Khoshdel, R.	68	Wood, R. Sr. (LIEUT.)	88	Karlof, I.
29	Laudenslager, Troy	49	Quinn, M.	69	Beardel, C. (AC-8)	89	Appelbaum, R. (LT-8-2)
30	Abramson, Matt	50	Abramson, M.	70	Back, E.	90	Lavenbein, T.
	FIRE CO. OFFICERS		FIRE POLICE OFFICERS		FIREFIGHTERS		JUNIORS
	Balaban, M.		Goldsmith, C.				Schadegg, K.
			Goldsmith, R.				Schenk, M.
			Goold, C.		Murtha, D.		
	Burke, D.		Goold, S.		Nedl, F.		Willard, M.
	Burns, K.		Garwood, J.		Nocella, B. Jr.		Wilkinson, N.
	Burns, M.				Polyakov, A.		Winkler, E.
	Cairns, G.		Hogan, P.		Ramsden, D.		Wood, R. Jr.
	Clayton, D.		Kasitz, G.		Randolph, A.		Wood, S. (Jones)
	Clough, J.		Magni, C.		Roziner, A.		Verkes, R.
	Daniel, H.				McNulty, A.		
			Herwig, B.				

ADDITIONAL MEMBERS:	Additional information on reverse side	TOTAL MEMBERS
		13



CHECK BOX - PLATOON CALL ONLY " X "

OFFICER IN CHARGE

NAME *Beaudet*

69

APPARATUS

Squad #8		Engine #8-1		Tower #8		Traffic #8		
X	CREW	#	X	CREW	#	X	CREW	#
	OFF.			OFF. <i>Wemsten</i>	<i>62</i>		DR.	
	DR.			DR. <i>Molde</i>	<i>72</i>		1-	
X	CREW	#	X	CREW	#	X	CREW	#
	1-			1- <i>Weiland Jr.</i>	<i>93</i>		2-	
	2-			2- <i>Xhoxhij</i>	<i>48</i>		3-	
	3-			3- <i>Weiland, A</i>	<i>51</i>		4-	
	4-						5-	
	5-						6-	
	6-						7-	
	7-						8-	
	8-						9-	
	9-							
X	PLATOON MEMBER	#	X	PLATOON MEMBER	#	X	PLATOON MEMBER	#
							Utility - 8 / Marine - 8	
							1	
							2	
							3	
							4	
							5	
							6	

EQUIPMENT USED

AIR PACKS USED (MEMBERS NAME AND #)		WATER SUPPLY:		EXTINGUISHERS & EQUIPMENT USED:	
1-		6-		<input type="checkbox"/> Hydrant	<input type="checkbox"/> ABSORBENT PADS <input type="checkbox"/> CLASS "D"
2-		7-		<input type="checkbox"/> Draft	<input type="checkbox"/> OIL DRY <input type="checkbox"/> CLASS "K"
3-		8-		<input type="checkbox"/> Relay	<input type="checkbox"/> CO ₂ <input type="checkbox"/> Dry Chemical
4-		9-		<input type="checkbox"/> Tank	<input type="checkbox"/> Pressurized Water <input type="checkbox"/> Dry Powder
5-		10-			

NARRATIVE AND SPECIAL EQUIPMENT USED

2424 High Rd

Behind 128 Col unit ft

Special Notes:

Accident Fire

Other Special Notes:

Type of Vehicle _____

Type of House _____

Incident Commander's Signature

* MUST BE SIGNED *

PENNSYLVANIA PUBLIC UTILITY COMMISSION

Formal Complaint

*Filing this form begins a legal proceeding and you will be a party to the case.
If you do not wish to be a party to the case, consider filing an informal complaint.*

To complete this form, please type or print legibly in ink.

1. **Customer (Complainant) Information**

Provide your name, mailing address, county, telephone number(s), e-mail address and utility account number. It is your responsibility to update the Commission with any changes to your address and to where you want documents mailed to you.

Name Andrea Berardi

Street/P.O. Box 128 Red Lion Road

City/State Huntingdon Valley, PA Zip 19006

County Montgomery

Telephone Number(s) Where We Can Contact You During the Day (required):

(215) 938-7033 (home) _____ (mobile)

E-mail Address (required): andrea_berardi@hotmail.com

Utility Account Number (from your bill): 1747800604

If your complaint involves utility service provided to a different address or in a different name than your mailing address, please list this information below.

Name _____

Street/P.O. Box _____

City _____ State _____ Zip _____

2. **Name of Utility or Company (Respondent)**

Provide the full name of the utility or company about which you are complaining. The name of your utility or company is on your bill.

1. PECO

3. Type of Utility Service

Check the box listing the type of utility service that is the subject of your complaint (check only one):

- | | |
|--|---|
| <input checked="" type="checkbox"/> ELECTRIC | <input type="checkbox"/> STORM WATER |
| <input type="checkbox"/> GAS | <input type="checkbox"/> WASTEWATER/SEWER |
| <input type="checkbox"/> WATER | <input type="checkbox"/> TELEPHONE/TELECOMMUNICATIONS (local, long distance) |
| <input type="checkbox"/> STEAM HEAT | <input type="checkbox"/> MOTOR CARRIER (e.g. taxi, moving company, limousine) |

4. Reason for Complaint

What kind of problem are you having with the utility or company? Check all boxes below that apply and state the reason for your complaint. Explain specifically what you believe the utility or company has done wrong. Provide relevant details including dates, times and places and any other information that may be important. If the complaint is about billing, tell us the amount you believe is not correct. Use additional paper if you need more space. **Your complaint may be dismissed without a hearing if you do not provide specific information.**

- The utility is threatening to shut off my service or has already shut off my service.

- I would like a payment agreement.

- Incorrect charges are on my bill. Provide dates that are important and an explanation about any amounts or charges that you believe are not correct. Attach a copy of the bill(s) in question if you have it/them.

- I am having a reliability, safety or quality problem with my utility service. Explain the problem, including dates, times or places and any other relevant details that may be important.

We have preventable power outages whenever there is a storm or wind, which is frequent & the one PECO utility pole is being held up by three wires connected down to the ground in my backyard. It is a defective design. Unsuspecting innocent people (children playing in the backyard, adults, guests), pets and wild animals are at risk for electrocution, and/or shock injury, and tripping over the wires on the ground causing other bodily injuries.

Property damage is also at risk if the shrubs and trees catch fire again. We have had a fire in the backyard from down wires from a previous storm.

Both Verizon Communications & Comcast Corporation have added numerous wires below the two PECO wires. The Verizon Communications & Comcast Corporation communication wires are not needed at all. I never had Comcast and my Verizon service wires are from the poles in front of my house which are fed from the street underground to my house. I never gave Verizon nor Comcast permission to go on my property and place these dangerous and unsightly wires. The Verizon and Comcast wires are weighing down the electric wires on the pole as well.

Not only are they a safety concern, but they also devalue the price of my home.

My mortgage company, Chase Mortgage, confirmed that there is no easement on my property.

Note: If your complaint is only about removing or modifying a municipal lien filed by the City of Philadelphia, the Public Utility Commission (PUC) cannot address it. Only local courts in Philadelphia County can address this type of complaint. The PUC can address a complaint about service or incorrect billing even if that amount is subject to a lien.

In addition, the PUC generally does not handle complaints about cell phone or Internet service, but may be able to resolve a dispute regarding voice communications over the Internet (including the inability to make voice 911/E911 emergency calls) or concerns about high-speed access to Internet service.

5. **Requested Relief**

How do you want your complaint to be resolved? Explain what you want the PUC to order the utility or company to do. Use additional paper if you need more space.

1. PECO move electric wires from backyard underground at their expense.
2. Remove Verizon Communication wires from my backyard at their expense, since I never used them and did not give permission to place them in my backyard. They are not for my home.

Note:

I have Verizon Communication wires from the from the poles in front of my house underground to my house for phone, TV, & intranet, so the wires in my backyard should never have been placed.

3. Remove Comcast Corporation wires from my backyard at their expense, since I never requested nor used them & did not give permission to place them in my backyard.

Note: The PUC can decide that a customer was not billed correctly and can order billing refunds. The PUC can also fine a utility or company for not following rules and can order a utility or company to correct a problem with your service. Under state law, the PUC cannot decide whether a utility or company should pay customers for loss or damages. Damage claims may be sought in an appropriate civil court.

6. **Protection From Abuse (PFA)/ Domestic Violence**

Has a court granted you a “Protection From Abuse” order or any other order which provides clear evidence of domestic violence against you that is currently in effect for your personal safety or welfare? The PUC needs this information to properly process your complaint so that your identity is not made public.

Note: You must answer this question if your complaint is against a natural gas distribution utility, an electric distribution utility or a water distribution utility AND your complaint is about a problem involving billing, a request to receive service, a security deposit request, termination of service or a request for a payment agreement.

Has a court granted a “Protection From Abuse” order or any other order for your personal safety or welfare?

YES
NO X

If your answer to the above question is “yes,” attach a copy of the current Protection From Abuse order to this Formal Complaint form.

7. **Prior Utility Contact**

a. Is this an appeal from a decision of the PUC’s Bureau of Consumer Services (BCS)?

YES
NO X

Note: If you answered yes, move to Section 8. No further contact with the utility or company is required. If you answered no, answer the question in Section 7 b. and answer the question in Section 7 c. if relevant.

b. If this is not an appeal from a BCS decision, have you spoken to a utility or company representative about this complaint?

YES
NO X

Note: You must contact the utility first if (1) you are a residential customer, (2) your complaint is against a natural gas distribution utility, an electric distribution utility or a water utility AND (3) your complaint is about a billing problem, a service problem, a termination of service problem, or a request for a payment agreement.

- c. If you tried to speak to a utility company representative about your complaint but were not able to do so, please explain why.

Note: Even if you are not required to contact the utility or company, you should always try to speak to a utility or company representative about your problem before you file a Formal Complaint with the PUC.

8. Legal Representation

If you are filing a Formal Complaint as an individual on your own behalf, you are **not** required to have a lawyer. You may represent yourself at the hearing.

If you are already represented by a lawyer **in this matter**, provide your lawyer's name, address, telephone number, and e-mail address, (all required contact information). Please make sure your lawyer is aware of your complaint. If represented by a lawyer, both you and your lawyer must be present at your hearing.

Lawyer's Name _____

Street/P.O. Box _____

City _____ State _____ Zip _____

Area Code/Phone Number _____

E-mail Address _____

Note: Corporations, associations, partnerships, limited liability companies and political subdivisions are **required** to have a lawyer represent them at a hearing **and** to file any motions, answers, briefs or other legal pleadings.





Khadijah Scott, Esquire
Assistant General Counsel
2301 Market Street / S23-1
Philadelphia, PA 19103

Direct Dial: 215-841-6841

December 3, 2021

VIA E-MAIL

Honorable Eranda Vero
Pennsylvania Public Utility Commission
Office of Administrative Law Judge
801 Market Street, Suite 4063
Philadelphia, PA 19107

RE: Andrea Berardi v. PECO Energy Company
Docket No. C-2021-3028230
Date of Hearing: December 14th at 10:00 am

Dear Judge Vero:

Enclosed please find a copy of PECO Energy Company Exhibits 1 through 8, which it intends to use in the above referenced hearing. By copy of this letter, I am sending a copy of same to the Complainant.

Please call my direct dial number if you have any questions regarding this case.

Respectfully submitted,



Khadijah Scott

KS/ab
Enclosure

Cc: Andrea Berardi (via email)

EXHIBIT 1

Botak, Amy:(PECO)

From: Breziner, Diana:(PECO)
Sent: Friday, June 25, 2021 3:16 PM
To: andrea_berardi@hotmail.com
Subject: PECO Service Application

Good afternoon Andrea,

Our team received the S&M application yesterday and processed it, per your comments in the S&M:

1. You are requesting to move all electric (Primary, Secondary) wires underground, if that's the case, it is the customer who would bear the expense per PECO Tariff (I pasted the two portions of Tariff below and I can provide a link to the whole document if you prefer). We will provide a high level estimate of what would be the cost for PECO to relocate the wires underground
2. We also recommend that you contact communication companies to have their wires relocated underground

This is a 1-phase primary spur which is running through poles installed in customers backyards (including neighbors).

3.6 UNDERGROUND SERVICE. Customers desiring an underground service from overhead wires must bear the excess cost in there to. Specifications and terms for such construction will be furnished by the Company on request.

10.7 POLE REMOVAL OR RELOCATION REQUESTED BY RESIDENTIAL PROPERTY OWNERS. The cost for removal or relocation of distribution line poles and their associated attachments made pursuant to the request of a residential property owner who is not entitled to receive condemnation damages to cover the cost of such work shall be borne by the property owner and shall be limited to contractor, direct labor, and direct material costs incurred less maintenance expenses avoided as a result of the pole removal or relocation. The calculation of such cost for removal or relocation shall be in accordance with the Public Utility Commission Regulations - Title 52, Section 57.27.

Let me know if you have any question.

Thanks,

Diana Breziner
New Business Engineer
PECO New Business - BucksMont Region
(C) 484-467-9098

EXHIBIT 2



October 26, 2021

BCS Decision Report

BCS Case #: 003790737 **Open Date:** 2021-06-04
Customer Name: ANDREA BERARDI
Service Address: 128 RED LION ROAD

HUNTINGDON VALLEY, PA 19006
BCS Bill Account #: 8888888888 **Previous Case #:** 3790731
Violation Type: NO **Chapter Type:**
Decision Type: O **Section / Rule:**
Investigator Name: NATHAN PROUGH

Decision Issued Date:
Case Closed Date: 2021-08-04

Letter Description:

Total Balance:	\$145.78	Balance Date:	2021-06-29
Amount to Restore Service:	\$0.00	Amount to Continue Service:	\$0.00
Date Payment Due:		Regular Budget Amount:	\$0.00
Special Budget Payment:	\$0.00	Final Bill Monthly Payment:	\$0.00
Plus Arrears Payment:	\$0.00	End of Month Payment:	\$0.00
Current Monthly Payment:	\$0.00		
Payment Terms:			

PAR Description:

Resolution Description:

CASE CLOSING: THE PUC CANNOT FORCE THE COMPANY TO MOVE THE WIRES AT THE INFORMAL LEVEL IF THEY WERE NOT A SAFETY CONCERN AND THAT THE PUC DOES NOT REGULATE WIRE HEIGHT REQUIREMENTS; REFERRED CUSTOMER TO THE FORMAL COMPLAINT PROCESS AND INFORMED CASE WILL BE CLOSED.

EXHIBIT 3

INSTRUCTIONS:

Please complete this request and return to the PECO Regional Office (*listed below*) in the area service is required. Incomplete information may result in a delay in processing.

All work must comply with [PECO Electric Service Requirements manual](#) and be inspected by an [approved inspection agency](#). (City of Philadelphia requests may be shared with Licenses & Inspections). Not all service voltages are available in all areas. **Before purchasing electrical equipment or proceeding with any wiring, information regarding service availability and meter location should be obtained from the company.**

A credit application and agreement must be completed **if the customer has not had PECO service within the last 60 days**. The company reserves the right to **cancel** this request if no further communication is received from the customer **within 90 days** of PECO's response date.

NOTE: If demolishing a building and need PECO to remove electric or gas facilities, Please call 8-1-1 (PA One Call) for Demolition Requests

NEW BUSINESS SERVICES (1-800-454-4100)

PHILADELPHIA COUNTY
830 S. Schuylkill Ave.
Philadelphia, PA 19146 Fax #
(215) 731-2327
[Email](mailto:PhilaNewBusiness@exeloncorp.com)
PhilaNewBusiness@exeloncorp.com

DELAWARE, CHESTER & YORK COUNTIES
1050 W. Swedesford Rd. Berwyn, PA 19312
Fax # (610) 725-1416
[Email](mailto:DelChesterServiceApplications@exeloncorp.com)
DelChesterServiceApplications@exeloncorp.com

BUCKS & MONTGOMERY COUNTIES
400 Park Ave.
Warminster, PA 18974
Fax # (215) 956-3240
[Email](mailto:BucksMontServiceApplications@Exeloncorp.com)
BucksMontServiceApplications@Exeloncorp.com
** Lower Merion is served by DelChester Region

NEW RESIDENTIAL CONSTRUCTION (All Counties)
400 Park Ave.
Warminster, PA 18974
Fax # (215) 956-3380
[Email](mailto:NRCGMETERORDERS@Peco-Energy.com)
NRCGMETERORDERS@Peco-Energy.com

CUSTOMER NAME Andrea Berardi	Tax ID # or SSN 7633
** ADDRESS TO BE SERVED 128 Red Lion Road	APARTMENT / LOT # 410007870009
CITY, STATE Huntingdon Valley	ZIP CODE 19006
* UTILITY POLE #	* SUBDIVISION / DEVELOPMENT
TOWNSHIP/MUNICIPALITY/WARD #	

TYPE OF REQUEST		
<input type="checkbox"/> New Service	<input type="checkbox"/> Load Increase / Decrease	<input type="checkbox"/> Reintroduction of Service
<input type="checkbox"/> Temporary Service	<input type="checkbox"/> Upgrade / Changes	<input type="checkbox"/> Demo/ Remove Service
<input type="checkbox"/> Separation of Wiring	<input type="checkbox"/> Service Relocation	<input type="checkbox"/> Make-Safe (De-energize/Cover)

TYPE OF SERVICE: Please include site plan.		
<input type="checkbox"/> RESIDENTIAL		<input type="checkbox"/> COMMERCIAL
<input type="checkbox"/> Single House	<input type="checkbox"/> Mobile Home	<input type="checkbox"/> Store
<input type="checkbox"/> Apartment	<input type="checkbox"/> Modular Home	<input type="checkbox"/> Industrial
<input type="checkbox"/> Duplex	<input type="checkbox"/> Town House	<input type="checkbox"/> Restaurant
<input type="checkbox"/> Other		<input type="checkbox"/> Warehouse
<input type="checkbox"/> Other		<input type="checkbox"/> Other
Area of Building _____ Sq. Ft.		

* If Applicable
** Please use this address when applying for underwriter's inspection

CUSTOMER'S BILLING ADDRESS	PECO ENERGY ACCOUNT #
-OR-	
CITY, STATE	ZIP CODE
TELE. #	

SERVICE CHARACTERISTICS:		
<input type="checkbox"/> Underground	<input type="checkbox"/> Aerial	
PHASE	VOLTS	WIRES
<input type="checkbox"/> 1	120	2
<input type="checkbox"/> 1	120/240	3
<input type="checkbox"/> 2	120/240	5
<input type="checkbox"/> 3	240	3
<input type="checkbox"/> 3	120/240	4
<input type="checkbox"/> 3	120/208	4
<input type="checkbox"/> 3	277/480	4
<input type="checkbox"/> 3	13200	3 or 4
<input type="checkbox"/> 3	33000	3 or 4
AMPS _____		

SEND REPLY TO:

ELECTRICIAN'S OR BUILDER'S NAME	Reply Requested by:
ADDRESS	
CITY, STATE	ZIP CODE
TELE. #	E-mail Address

METER INFO: Single Meter Required Multiple Meters Total No. _____

Location: Outside Inside

HEATING / AIR CONDITIONING:

Heat Pump _____ Tons Resistance Natural Gas Other _____

Central Air _____ Tons Propane Type Backup _____

CURRENT CONSTRUCTION STATUS:

Not Started - Date Customer Will Start Work: _____ In Progress Completed

Approximate Date Service Requested: _____

TYPE	CONNECTED LOAD (kW)	PECO ENERGY USE ONLY (DEMAND)	
		SUMMER (KW)	WINTER (KW)
LIGHTING			
HEATING			
AIR/COND.			
TANKLESS WATER HTR			
MISC.			
TOTAL			

CUSTOMER COMMENTS / DESCRIPTION OF WORK:

1. Move all electric wires underground, due to a fire in backyard, power outages every storm, & children throwing objects on the wires.

2. Comcast & Verizon will not move their low hanging wires until PECO moves their wires firstly.

Note:
All expenses should be paid by the utility companies.
I never asked those wires to be placed in the back yard, when the neighbors have poles in the street in front of their homes.

Include single line diagram and substation arrangement if appropriate.

LARGEST MOTOR SPECIFICATIONS

QUANTITY	
SIZE (HP)	
LOCKED ROTOR CURRENT	
MOTOR CODE LETTER	
PHASE	
VOLTAGE	
FREQ. OF STARTING (per hr.)	
PURPOSE	

GENERAL LOAD

KW	
----	--

SUBMITTED BY: **Andrea Berardi** DATE: **06/24/2021**

Enclosures: Site Plans Single Line Diagram Substation Arrangement

EXHIBIT 4

PECO Energy Company - Electric Service Tariff

3. CUSTOMER INSTALLATION

PECO Energy Company

Tariff Electric Pa. P.U.C. No. 5
Original Page No. 12

RULES AND REGULATIONS (continued)

(including attorney's fees), whether known or unknown, present or future, that arise from such conditions. This indemnification provision shall survive the termination or expiration of said agreement and the termination of the business relationship of the parties thereto.

3.4 SERVICE ENTRANCE EQUIPMENT. All equipment beyond the point of delivery, except the meter, shall be installed by the customer. Installation shall be in conformity with the National Electrical Code and the Company's published "Electric Service Requirements", and shall include, where necessary, an approved sealable device for mounting a meter. The meter will be supplied, owned and sealed by the Company or another AMSP.

3.5 SECONDARY SERVICE CONNECTION. (a) Wiring of any premises for connection to overhead lines must be brought outside of the building wall to a location designated or approved by the Company, at which point the house wiring must extend at least 3 feet for attachment to the Company's service-supply lines. (b) Service connections to the Company's underground facilities shall terminate on the customer's premises in an approved connection box from which customer's wiring shall extend to the other service entrance equipment.

3.6 UNDERGROUND SERVICE. Customers desiring an underground service from overhead wires must bear the excess cost incident thereto. Specifications and terms for such construction will be furnished by the Company on request.

10. COMPANY EQUIPMENT

10.1 COMPANY MAINTENANCE. The Company shall keep in repair and maintain its own property installed on the premises of the customer.

10.2 CUSTOMER'S RESPONSIBILITY. The customer shall be responsible for safekeeping of the Company's property while on the customer's premises. In the event of injury or destruction of any such property the customer shall pay the costs of repairs and replacement. Any changes made to the Customer's premises after the Company completes its service and meter installation that, in the opinion of the Company, creates an unsafe condition, shall be the Customer's responsibility to pay any costs associated with remedying the unsafe condition including, but not limited to, any required protective measures and/or relocations of Company property.

10.3 PROTECTION BY CUSTOMER. The customer shall protect the equipment of the Company on the premises, and shall not permit any person, except a Company employee having standard badge of the Company or other Company identification, to break any seals upon, or do any work on, any meter or other apparatus of the Company located on the customer's premises.

10.4 TAMPERING. In the event of the Company's meters or other property being tampered or interfered with, the customer being supplied through such equipment shall pay the amount which the Company may estimate is due for service used but not registered on the Company's meter, and for any repairs or replacements required, as well as for costs of inspections, investigations, and protective installations.

10.5 RIGHT OF ACCESS. The Company's identified employees shall have access to the premises of the customer at all reasonable times for the purpose of reading meters, and for installing, testing, inspecting, repairing, removing or changing any or all equipment belonging to the Company. In the event of an emergency, the Company shall have the right to access customer owned facilities and equipment for the purpose of restoring electric service, for the purpose of rendering the electric facilities safe and reliable, or for the purpose of reducing the likelihood of damage to the Company's facilities and equipment.

10.6 OWNERSHIP AND REMOVAL. All equipment supplied by the Company shall remain its exclusive property, and the Company shall have the right to remove the same from the premises of the customer at any time after the termination of service from whatever cause.

10.7 POLE REMOVAL OR RELOCATION REQUESTED BY RESIDENTIAL PROPERTY OWNERS. The cost for removal or relocation of distribution line poles and their associated attachments made pursuant to the request of a residential property owner who is not entitled to receive condemnation damages to cover the cost of such work shall be borne by the property owner and shall be limited to contractor, direct labor, and direct material costs incurred less maintenance expenses avoided as a result of the pole removal or relocation. The calculation of such cost for removal or relocation shall be in accordance with the Public Utility Commission Regulations - Title 52, Section 57.27.

EXHIBIT 5

Service Reliability Report For
Andrea Berardi
128 Red Lion Rd., Huntingdon Valley, PA 19006
11/4/2017 to 11/4/2021

Account Number: 1747800604

Transformer: 33D4F6D

SERVICE CHARACTERISTICS			
<input type="checkbox"/> Single HT	<input type="checkbox"/> Dual HT	<input type="checkbox"/> GS	<input checked="" type="checkbox"/> Residential
Supply:	BETHAYRES_135	Source Substation:	HEATON
Circuit Miles Aerial:	7.8	Circuit Miles UG:	5.2

OUTAGE HISTORY			
(Only outages > 5 minutes affecting this customer are listed)			
Date/Time	Storm (Y=Yes, N=No)	Cause	Interruption Duration (Minutes)
3/4/2018 5:17 AM	Y	Weather – Downed Wire	2057
3/7/2018 8:17 AM	Y	Equipment – Fuse	18
3/7/2018 10:57 AM	Y	Weather – Tree	497
6/3/2018 12:24 PM	Y	Other – Recloser opened during storm	10
8/3/2018 1:44 PM	N	Equipment – Downed Wire	295
5/29/2019 6:12 PM	Y	Vegetation – Tree limb	110
7/6/2019 1:44 PM	N	Vegetation – Vines on secondary wires	114
8/7/2019 3:50 PM	Y	Vegetation – Tree limb	69
8/4/2020 11:04 AM	Y	Vegetation – Tree limb	530
10/30/2021 2:40 AM	N	Vegetation – Tree limb	855

RECENT RELIABILITY ENHANCEMENTS	
Date	Description
Completed 02/26/2021	WO 16900342 Large scale tree trimming and equipment upgrades
Completed 07/21/2020	WO 16535467 Replaced rotted pole
Completed 10/10/2018	WO 14511340 Installed 1300 feet of tree resistant cable

PREVENTATIVE MAINTENANCE WORK			
Last routine tree trimming:	02/02/2018	Next scheduled tree trimming:	2022
Last circuit patrol / thermography:	02/13/2020	Next scheduled circuit patrol / thermo:	2022

EXHIBIT 6

128 Red Lion Rd, Huntingd X

Show search results for 128 ...

(1 of 3)

BLOCK_GRP	
NUMBER	
NAME	BERARDI, ANDREW P; BERARDI, ANDREA
NAME_1	BERARDI, ANDREW P
NAME_2	BERARDI, ANDREA
_1_FIRST	ANDREW P
_1_LAST	BERARDI
_1_MID	
_2_FIRST	ANDREA
_2_LAST	BERARDI
_2_MID	
DDR	128 RED LION RD
HOUSE_NUM	128
HOUSE_SUFFIX	

[Zoom to](#) ...

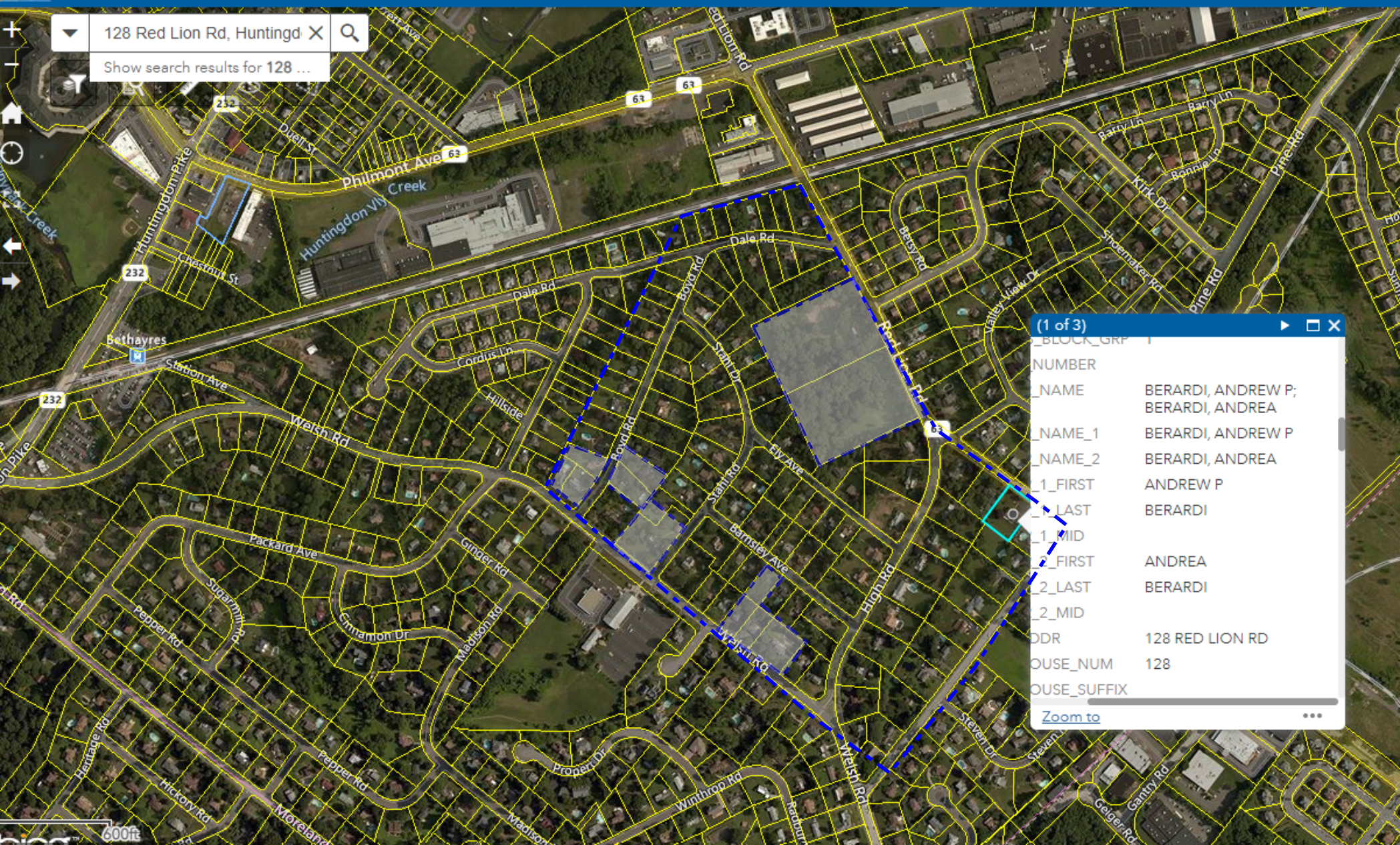

EXHIBIT 7

44/46

E-2527

BE IT KNOWN that for and in consideration of the payment by PHILADELPHIA ELECTRIC COMPANY and THE BELL TELEPHONE COMPANY OF PENNSYLVANIA to the undersigned of the sum of One Dollar (\$1.00) and other valuable considerations, the receipt whereof is hereby acknowledged, the said Companies, and each of them, their respective successors and assigns, are hereby granted by the undersigned the uninterrupted right, privilege and authority to place, renew, relocate, operate and maintain on and under ALL THOSE TWO CERTAIN tracts of ground situate in the Township of LOWER MORELAND, County of MONTGOMERY and State of PENNSYLVANIA, described as follows, to wit:

THE FIRST THEREOF BEGINNING at a corner of land of James C. Briggs in the middle of Pine Road; thence along the middle thereof by land of Israel E. Ely North 42 1/4 degrees East 93.33 perches to a corner in the middle of Red Lion Road; thence along the middle thereof by land of the Estate of George Shoemaker North 48 degrees West 22.24 perches; thence by land of the Estate of Thomas Barnsby South 42 1/4 degrees West 92.97 perches to a corner in the middle of Welsh Road; thence partly by land of John Tomlinson and land of James C. Briggs South 47 degrees 5 minutes East 22.24 perches to beginning;

AND THE OTHER THEREOF BEGINNING at a corner in Welsh Road also a corner of land of Charles Ayres, thence along the middle of Welsh Road South 51 degrees 35 minutes East 114.08 perches to land of Geo. Ely; thence by same North 37 3/4 degrees East 92.96 perches to a corner in the middle of Red Lion Road; thence partly by land of Geo. Shoemaker Estate North 52 1/4 degrees West 65.32 perches; thence still by said Shoemaker North 61 1/8 degrees East 14.08 perches to said Red Lion Road; thence along said Red Lion Road North 26 1/2 degrees West 52.31 perches to the side of Delaware River Branch of North Pennsylvania Railroad and 50 feet from the center line thereof; thence along said side of Railroad South 73 3/4 degrees West 40.04 perches to a line in land of Chas. Ayres; thence along the same South 28 degrees West 92.88 perches to the middle of Welsh Road and place of beginning;

EXCEPTING, THEREOUT, HOWEVER, ALL THAT CERTAIN lot or piece of ground described as follows:

BEGINNING at a point of intersection of the Northeast line of Welsh Road 30 feet from the center line thereof and Northwest line of a proposed 50 ft. street; the Northwest line being at right angles to the line of Welsh Road and at a distance of 1587.25 feet Northwest along the center line of Welsh Road and the line of Emil P. Stahl's land from the center line of Pine Road (33 ft. wide); thence along the said line of Welsh Road 30 feet from the center line thereof and parallel thereto North 49 degrees 8 minutes West 220 feet to a corner; thence North 40 degrees 52 minutes East 290 feet to a corner; thence South 49 degrees 8 minutes East 250.17 feet to a point in the Northwest line of aforesaid mentioned proposed street; thence along the same Southwest along a curve to the left having a radius of 600 feet a distance of 110.62 feet to a point of tangent; thence South 40 degrees 52 minutes West 180 feet to the place of beginning;

ALSO EXCEPTING THEREOUT, HOWEVER, nine tracts of ground more particularly described in the following conveyances:

- 1 - Deed from Emil P. Stahl et ux to Adam Friedrich et ux, dated December 22, 1930, recorded in Montgomery County Deed Book No. 1118, page 210;
- 2 - Deed from Emil P. Stahl et ux to Alexander J. Bletz et ux, recorded June 16, 1937, in Montgomery County Deed Book No. 1235, page 471;
- 3 - Deed from Emil P. Stahl et ux to Carl S. Anderson, dated August 10, 1937, recorded in Montgomery County Deed Book No. 1244, page 518;
- 4 - Deed from Emil P. Stahl et ux to Nicholas A. Krutach dated October 8, 1937, recorded in Montgomery County Deed Book No. 1250, page 204;
- 5 - Deed from Emil P. Stahl et ux to Thomas M. O'Brien, dated January 11, 1938, recorded in Montgomery County Deed Book No. 1255, page 164;
- 6 - Deed from Emil P. Stahl et ux to Edward A. Jacobi et ux, dated November 29, 1938, recorded in Montgomery County Deed Book No. 1274, page 9;
- 7 - Deed from Barbara E. Stahl, singlewoman, to Roy A. Schott et ux, dated October 3, 1939, recorded in Montgomery County Deed Book No. 1310, page 220;
- 8 - Deed from Barbara E. Stahl, singlewoman, to Lloyd W. Covert et ux, dated October 28, 1939, recorded in Montgomery County Deed Book No. 1291, page 21; and
- 9 - Deed from Barbara E. Stahl, singlewoman, to Louis H. Beck et ux, dated October 28, 1939, recorded in Montgomery County Deed Book No. 1291, page 23;

and on the buildings erected or to be erected thereon from time to time; as well as on, under and along the various highways as now existing or as may be subsequently established, intersecting and abutting the above described premises, such facilities as shall be necessary for the purpose of transmitting and distributing adequate and continuous electric light, heat, power, gas and telephone service to the various residences,

premises and other users in the vicinity; including the right of ingress and egress to inspect, renew, repair, add thereto and remove the aforesaid facilities, and the right to trim and keep trimmed in a workmanlike manner, all trees in order to provide proper clearance for the safety of operation of the above mentioned facilities, as from time to time the said Electric and Telephone Companies, their respective successors and assigns, shall deem requisite or proper for the purposes herein set forth.

EXECUTED this 9th day of August A.D.1940.

Witnesses:

Paul J. Stahl Barbara E. Stahl (SEAL)
W. Allen Roney _____ (SEAL)

STATE OF PENNSYLVANIA :
COUNTY OF Montgomery :SS

W. Allen Roney

On this 9th day of August A.D.1940, before me, the subscriber, a Notary Public in and for the Commonwealth of Pennsylvania, residing in Jen. City personally appeared Barbara E. Stahl (single woman) and in due form of law acknowledged the foregoing Grant to be her act and deed and desired the same might be recorded as such.

WITNESS my hand and Notarial Seal the day and year first aforesaid.

W. Allen Roney
Notary Public,

My Commission expires: W. ALLEN RONEY
NOTARY PUBLIC
My Commission Expires March 9th, 1942

2527 Harry B. Whitlock

EXHIBIT 8

OMS East Reports



AMOS | ARCOS | BGE | CAIDI | ED DASHBOARD | EP | MD LIVE | NETVIEWER
SRP Web

System Reports | Regional Status | Productivity | OMS Reports | Storm Information | PragmaCAD Reports | Reliability Reports | Help

EVENT NUMBER: M18030400135

[Return to Previous Page](#)

ITEM	VALUE	
EVENT'S DISPATCH GROUP	WMR	
TIME OFF	03/04/18 05:17	
TIME ON	03/05/18 15:35	
FIRST MANUAL ETR	NO ETR	
LAST ETR	03/08/18 23:49	
OUTAGE DURATION (MIN)	2058	
EVENT STATUS	CLOSED	
CIRCUIT	BETHAYRES_135	
EVENT TYPE	FUS	
DEVICE NAME	721_33D4F74848	
NUMBER OF CUSTOMERS	0	
DISPATCH TIME	03/05/18 12:00	
CIS REMARKS	REPAIRS COMPLETED 3/5 15:35	
CHRONOLOGY	** Event Priority changed from 0 to 3 at: 03/04/18 09:09:14 ** >>>> by: THOMAS F. AUGUST on terminal: ply-omsprod-11	3/4/2018 9:09:14 AM
	Outage update request for event M18030400135 sent to Trouble Analysis	3/4/2018 9:09:15 AM
	** Job updated by Trouble Analysis. Device:RM1_33D4D1 Feeder:BETHAYRES_135 Substation:BETHAYRES	3/4/2018 9:09:16 AM
	Step restoration - 415 customers Fuse 721_33D4F74848 location 33D4F7 Feeder BETHAYRES_135 Substation BETHAYRES, Phases A ** Job updated by Trouble Analysis. Device:721_33D4F74848 Feeder:BETHAYRES_135 Substation:BETHAYRES	3/4/2018 9:16:34 AM
	** Cross Referenced to Event # M18030203892 at: 03/04/18 15:02:39 End of Duplicate Event data Primary down- runs along rear of High Rd- not actively arching or sparking Duplicate Event: :128 RED LION RD HUNTINGDON VALLEY PA 19006, Type = PF3 POLICE/FIRE PRIORITY 3, Caller Name = ANDREA BERARDI, Caller Ph Number = 2159387033, Alarm Level = 0 ** >>>> by: CRAIG S. SIDEBOTTOM on terminal: ply-omsprod-04 POLICE/FIRE 3 - NON-EMERG ROUTINE CALL LIGHTS OK/UNKNOWN WIRE DOWN (POLE TO POLE) RECD FR:MORALA CIRCUIT:BETHAY_135 TQUAD:33D4F6D ** Job updated by BatchCall on terminal: omsmbl-mob-p2 at 03/02/18 23:43:34	3/4/2018 3:02:39 PM
	** Event M18030400135 transferred from MON/WRMM to MON/WMR as M18030400135 at 03/05/18 08:00:01	3/5/2018 8:00:01 AM
	@ POLE# 721 FUSE BLOWN - AT REAR OF 2414 PINE RD 150' OF 1/O PRIMARY DOWN	3/5/2018 11:44:16 AM
	WILL NEED SLEEVE AND APPROX 130 - 150' OF 1/O WIRE	3/5/2018 11:44:40 AM
	WIRE DOWN BTWN POLES # 717 - #718 - 3 MAN CREW	3/5/2018 11:45:05 AM
	ALL LOAD ON 3/5 15:35	3/5/2018 3:45:07 PM
	Final restoration - 17 customers	3/5/2018 3:46:06 PM

Crew Information

Dispatcher	Name	Agency	DGroup	Crew ID	Name	Status	Status Time	Location
110282	RANDI	MARTIN	BKS	WMR	B_MUTUL_15	B_MUTUL_15	AM	03 / 05 / 2018 15 : 45 (272298792,29582839):33D4F7:721_33D4F74848
110282	RANDI	MARTIN	BKS	WMR	B_MUTUL_15	B_MUTUL_15	ARRIV	03 / 05 / 2018 15 : 45 (272298792,29582839):33D4F7:721_33D4F74848
105235	MAUREEN	FISHEL	BKS	WMR	B_MUTUL_15	B_MUTUL_15	AM	03 / 05 / 2018 12 : 00 (272298792,29582839):33D4F7:721_33D4F74848
105235	MAUREEN	FISHEL	BKS	WMR	B_MUTUL_15	B_MUTUL_15	DISP ASSGN	03 / 05 / 2018 12 : 00 (272298792,29582839):33D4F7:721_33D4F74848
105235	MAUREEN	FISHEL	BKS	WMR	B_MUTUL_15	B_MUTUL_15	UC	03 / 05 / 2018 12 : 00 (272298792,29582839):33D4F7:721_33D4F74848

105235	MAUREEN	FISHEL	BKS	WMR	B_MUTUL_15	B_MUTUL_15	DISP	03 / 05 / 2018 11 : 56	XY (272298792,29582839):33D4F7:721_33D4F74848
54424	THOMAS	AUGUST	MON	EDR	MCKEEVER	MCKEEVER	AM	03 / 04 / 2018 09 : 16	XY(271931682,29638127):33D4D1:RM1_33D4D1
54424	THOMAS	AUGUST	MON	EDR	MCKEEVER	MCKEEVER	UC	03 / 04 / 2018 09 : 16	XY(271931682,29638127):33D4D1:RM1_33D4D1
54424	THOMAS	AUGUST	MON	EDR	MCKEEVER	MCKEEVER	DISP	03 / 04 / 2018 07 : 17	XY(271931682,29638127):33D4D1:RM1_33D4D1