



165 Beach Lake Highway

Honesdale, Pennsylvania 18431

August 26, 2022

Ms. Rosemary Chiavetta, Secretary
Pennsylvania Public Utility Commission
P.O. Box 3265
Harrisburg, PA 17105-3265

**RE: APPLICATION FOR PUBLIC CROSSING
At 517808X, HORTON STREET
LUZERNE AND SUSQUEHANNA RAILROAD
CITY OF WILKES-BARRE
COUNTY OF LUZERNE**

Dear Secretary Chiavetta,

In accordance with Public Utility Code, Title 66, Chapter 2702, enclosed please find an application requesting permission to alter crossing of **Luzerne and Susquehanna Railroad**. Said crossing will be within the public right of way confines of Horton Street. It is located in the City of Wilkes-Barre, Luzerne County.

Said crossing will consist of the placement an anchor guy at a PPL pole and the alteration of the overhead wires over the track of the **Luzerne and Susquehanna Railroad** tracks and right of way. The **poles and overhead cables and conductors** are located within Public Right of Way. This is an existing crossing **517808X**.

PPL Electric Utilities will provide copies of same to all parties listed under its Certificate of Service.

Please review and provide the appropriate authorization to this office. Should you have any questions please contact this office.

Sincerely,

A handwritten signature in blue ink that reads "Joseph George". The signature is written in a cursive, flowing style.

Joseph George
Supervisor - Right of Way

Enclosures

cc: Rodney D. Binder, P.E.
Chief-Bureau of Rail Safety
PA Public Utility Commission
P.O. Box 3265
Harrisburg, PA 17105-3265

BEFORE
PENNSYLVANIA PUBLIC UTILITY COMMISSION

In re: Application of PPL Electric Utilities for approval of the alteration of the crossing 517808X by the replacement of utility pole structure where Horton St crosses at grade the tracks of Luzerne and Susquehanna Railway, located in Wilkes-Barre in Luzerne County.

Application
Docket No.

To Pennsylvania Public Utility Commission:

1. The name and address of applicant are:

PPL Electric Utilities Corporation
Two North Ninth Street
GENN3
Allentown, PA 18101

2. The name and address of the applicant's attorney are Mallory Jane Sweeney, Associate General Counsel, PPL Electric Utilities Corporation, Two North Ninth Street, Allentown, PA 18101-1179

3. PPL Electric Utilities wishes to install a new anchor at pole 50624N39470 near the tracks of Luzerne and Susquehanna Railway Company in Wilkes-Barre, Luzerne County, PA to support existing and future loading conditions. The above ground communication facilities of utility pole PPL#50624N39470 will be altered.

4. The proposed change is to install down guy anchor at pole to the Northwest side of the railroad crossing. Horton St intersects the railroad at grade. See attached Exhibit "A". The proposed completion date for this project is December 7, 2022.

5. The public utilities, municipalities, corporations and property owners concerned in, or affected by, the crossing alteration are identified in Exhibit "B" attached hereto

6. The expected cost for the construction procedure is \$5,000. PPL Electric Utilities will pay all costs of construction or alteration of the facility, as well as be responsible for installing, maintaining and inspecting the facilities.

7. The alteration is necessary or proper for the following reasons: to provide adequate, efficient, and reasonable communication facilities and power to the public in Luzerne County and surrounding areas.

Wherefore, applicant prays your Honorable Commission to approve the application:

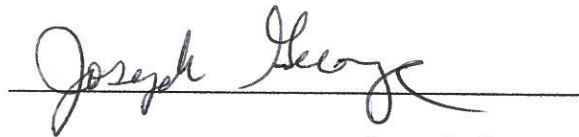
A handwritten signature in cursive script, reading "Joseph George", is written over a horizontal line.

Joseph George

Supervisor – Right of Way

§ 1.36. Verification.

(a) Applications, petitions, formal complaints, motions and answers thereto containing an averment of fact not appearing of record in the action or containing a denial of fact shall be personally verified by a party thereto or by an authorized officer of the party if a corporation or association. Verification means a signed written statement of fact supported by oath or affirmation or made subject to the penalties of 18 Pa. C.S. §4904 (relating to unsworn falsification to authorities). If verification is required, notarization is not necessary.

(b) The Verification form should comply substantially with the following:

VERIFICATION

I, Joseph George, hereby state that the facts above set forth are true and correct (or are true and correct to the best of my knowledge, information and belief) and that I expect to be able to prove the same at a hearing held in this matter. I understand that the statements herein are made subject to the penalties of 18 Pa. C.S. § 4904 (relating to unsworn falsification to authorities).

Date:

8/26/22

Joseph George

(Signature)

CERTIFICATE OF SERVICE

I hereby certify that I have this day served a true copy of the foregoing document upon the participants, listed below, in accordance with the requirements of § 1.54 (relating to service by participant).

Mark Chappell, P.E. - Chief
Bureau of Project Delivery
P.O. Box 3362
Harrisburg, PA 17105-3362
marchappel@pa.gov

ION Holdco LLC (First Light)
Attn: Engineering/Permitting
7890 Lehigh Crossing
Victor, NY 14564
scharney@firstlight.net

Karen Cummings - PennDOT
P.O. Box 8212
Harrisburg, PA 17105-8212
kcummings@pa.gov

Comcast Duryea
Attn: Engineering/Permits
1 Comcast Way
Duryea, PA 18642
We_can_help@cable.comcast.com
Attn: Engineering/Permits

PennDOT Engineering District 4
Jeremiah Gonzalo
55 Keystone Industrial Park
Dunmore, PA 18512
jgonzalo@pa.gov

Zito
Attn: Engineering
PO Box 665 - 102 South Main Street
Coudersport, PA 16915
kelly.ragosta@zitomedia.com

Luzerne County Courthouse
Attn: Permits/Public works
200 N River Street
Wilkes-Barre, PA 18711
larry.plesh@luzernecounty.org

Service Electric Company - Wilkes-Barre
Attn: Engineering
15 J. Campbell Collins Drive
Wilkes-Barre, PA 18702
labudam@sectv.com

The City of Wilkes-Barre
40 East Market Street
Wilkes-Barre PA 18711
jrodano@wilkes-barre.pa.us

Verizon Pennsylvania Inc.
1026 Hay St.
Wilkesburg, PA 15221
poleconduitadmin1@verizon.com

Luzerne and Susquehanna Railway
Attn: Engineering/Permitting
25 Delphine St
Owego, NY 13827
margie.thomas@lcredauth.org

CTSI, LLC, dba Frontier Communications
ATTN: Engineering
100 CTE Drive
Dallas, PA 18612
PA.Structure.Access@ftr.com

Dated this 26th day of AUGUST, 2022

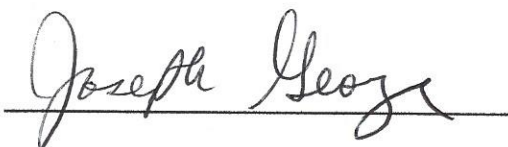

(Signature)

EXHIBIT "B"

The public utilities, municipalities, corporations, and property owners concerned in, or affected by, the crossing alteration are:

Mark Chappell, P.E. - Chief
Bureau of Project Delivery
P.O. Box 3362
Harrisburg, PA 17105-3362
marchappel@pa.gov

Karen Cummings -
PennDOT
P.O. Box 8212
Harrisburg, PA 17105-8212
kcummings@pa.gov

PennDOT Engineering District 4
Jeremiah Gonzalo
55 Keystone Industrial Park
Dunmore, PA 18512
jgonzalo@pa.gov

Luzerne County Courthouse
Attn: Permits/Public works
200 N River Street
Wilkes-Barre, PA 18711
larry.plesh@luzernecounty.org

Luzerne and Susquehanna Railway
Attn: Engineering/Permitting
25 Delphine St
Owego, NY 13827
margie.thomas@lcredauth.org

The City of Wilkes-Barre
40 East Market Street
Wilkes-Barre PA 18711
jrodano@wilkes-barre.pa.us

ION Holdco LLC (First Light)
Attn: Engineering/Permitting
7890 Lehigh Crossing
Victor, NY 14564
scharney@firstlight.net

Comcast Duryea
Attn: Engineering/Permits
1 Comcast Way
Duryea, PA 18642
We_can_help@cable.comcast.com
Attn: Engineering/Permits

Zito
Attn: Engineering
PO Box 665 - 102 South Main Street
Coudersport, PA 16915
kelly.ragosta@zitomedia.com

Service Electric Company - Wilkes-Barre
Attn: Engineering
15 J. Campbell Collins Drive
Wilkes-Barre, PA 18702
labudam@sectv.com

Verizon Pennsylvania Inc.
1026 Hay St.
Wilkinsburg, PA 15221
poleconduitadmin1@verizon.com

CTSI, LLC, dba Frontier Communications
ATTN: Engineering
100 CTE Drive
Dallas, PA 18612
PA.Structure.Access@ftr.com

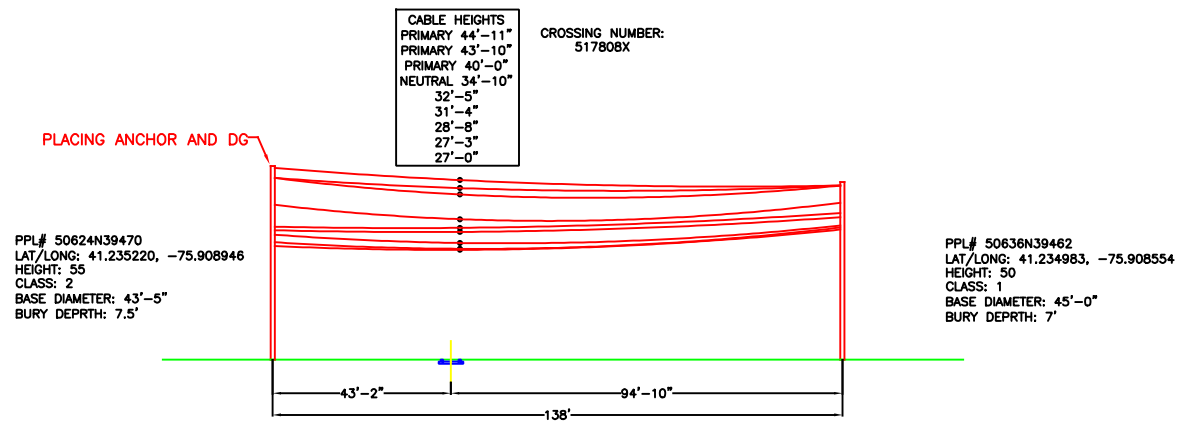
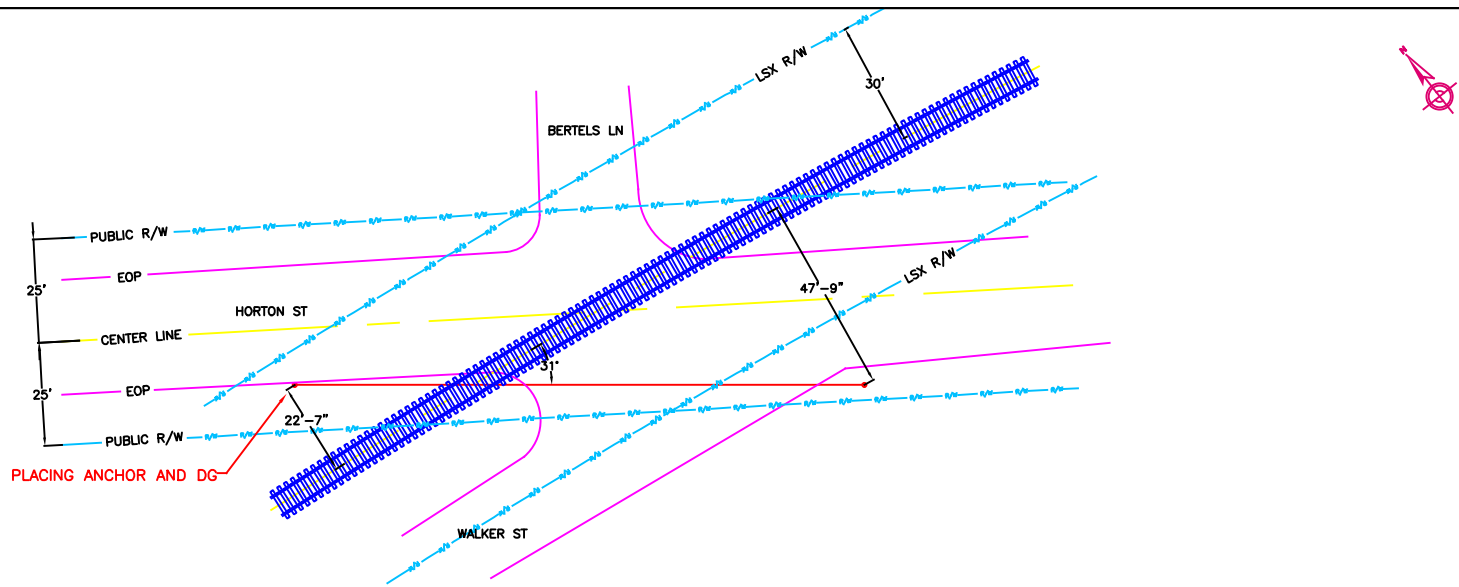

CITY: WILKES-BARRE	PROJECT NO: 30301
COUNTY: LUZERNE	PRINT NO: 1
STATE: PENNSYLVANIA	NO. OF PRINTS: 1
DATE: 8/19/2022	ENGINEERED BY: KATAPULT
DRAWN BY: NHYS	



FILENAME:
EXHIBIT A

U. S. DOT CROSSING INVENTORY FORM

DEPARTMENT OF TRANSPORTATION
FEDERAL RAILROAD ADMINISTRATION

OMB No. 2130-0017

Instructions for the initial reporting of the following types of new or previously unreported crossings: For public highway-rail grade crossings, complete the entire inventory Form. For private highway-rail grade crossings, complete the Header, Parts I and II, and the Submission Information section. For public pathway grade crossings (including pedestrian station grade crossings), complete the Header, Parts I and II, and the Submission Information section. For Private pathway grade crossings, complete the Header, Parts I and II, and the Submission Information section. For grade-separated highway-rail or pathway crossings (including pedestrian station crossings), complete the Header, Part I, and the Submission Information section. For changes to existing data, complete the Header, Part I Items 1-3, and the Submission Information section, in addition to the updated data fields. Note: For private crossings only, Part I Item 20 and Part III Item 2.K. are required unless otherwise noted. An asterisk * denotes an optional field.

A. Revision Date (MM/DD/YYYY) 07 / 03 / 2022	B. Reporting Agency <input type="checkbox"/> Railroad <input type="checkbox"/> Transit <input checked="" type="checkbox"/> State <input type="checkbox"/> Other	C. Reason for Update (Select only one) <input checked="" type="checkbox"/> Change in Data <input type="checkbox"/> Re-Open <input type="checkbox"/> New Crossing <input type="checkbox"/> Date Change Only <input type="checkbox"/> Closed <input type="checkbox"/> Change in Primary Operating RR <input type="checkbox"/> No Train Traffic <input type="checkbox"/> Quiet Zone Update <input type="checkbox"/> Admin. Correction	D. DOT Crossing Inventory Number 517808X
---	--	--	--

Part I: Location and Classification Information

1. Primary Operating Railroad LUZERNE & SUSQUEHANNA RAILWAY [LSX]		2. State PENNSYLVANIA		3. County LUZERNE	
4. City / Municipality <input checked="" type="checkbox"/> In <input type="checkbox"/> Near WILKES BARRE		5. Street/Road Name & Block Number HORTON (Street/Road Name) * (Block Number)		6. Highway Type & No. LRJ0090	
7. Do Other Railroads Operate a Separate Track at Crossing? <input type="checkbox"/> Yes <input checked="" type="checkbox"/> No If Yes, Specify RR			8. Do Other Railroads Operate Over Your Track at Crossing? <input type="checkbox"/> Yes <input checked="" type="checkbox"/> No If Yes, Specify RR		
9. Railroad Division or Region <input type="checkbox"/> None EASTERN		10. Railroad Subdivision or District <input type="checkbox"/> None HARRISBURG		11. Branch or Line Name <input type="checkbox"/> None WILKES BARRE	
12. RR Milepost 0061.20 (prefix) (nnnn.nnn) (suffix)		13. Line Segment *		14. Nearest RR Timetable Station * BUTTONWOOD	
15. Parent RR (if applicable) <input type="checkbox"/> N/A		16. Crossing Owner (if applicable) <input type="checkbox"/> N/A		17. Crossing Type <input checked="" type="checkbox"/> Public <input type="checkbox"/> Private	
18. Crossing Purpose <input checked="" type="checkbox"/> Highway <input type="checkbox"/> Pathway, Ped. <input type="checkbox"/> Station, Ped.		19. Crossing Position <input checked="" type="checkbox"/> At Grade <input type="checkbox"/> RR Under <input type="checkbox"/> RR Over		20. Public Access (if Private Crossing) <input type="checkbox"/> Yes <input checked="" type="checkbox"/> No	
21. Type of Train <input type="checkbox"/> Freight <input type="checkbox"/> Intercity Passenger <input type="checkbox"/> Commuter		<input type="checkbox"/> Transit <input type="checkbox"/> Shared Use Transit <input type="checkbox"/> Tourist/Other		22. Average Passenger Train Count Per Day <input type="checkbox"/> Less Than One Per Day <input type="checkbox"/> Number Per Day 0	
23. Type of Land Use <input type="checkbox"/> Open Space <input type="checkbox"/> Farm <input checked="" type="checkbox"/> Residential <input type="checkbox"/> Commercial <input type="checkbox"/> Industrial <input type="checkbox"/> Institutional <input type="checkbox"/> Recreational <input type="checkbox"/> RR Yard					
24. Is there an Adjacent Crossing with a Separate Number? <input type="checkbox"/> Yes <input checked="" type="checkbox"/> No If Yes, Provide Crossing Number			25. Quiet Zone (FRA provided) <input checked="" type="checkbox"/> No <input type="checkbox"/> 24 Hr <input type="checkbox"/> Partial <input type="checkbox"/> Chicago Excused Date Established		
26. HSR Corridor ID <input type="checkbox"/> N/A		27. Latitude in decimal degrees (WGS84 std: nn.nnnnnnn) 41.2351600		28. Longitude in decimal degrees (WGS84 std: -nnn.nnnnnnn) -75.9088000	
29. Lat/Long Source <input checked="" type="checkbox"/> Actual <input type="checkbox"/> Estimated		30.A. Railroad Use *			
30.B. Railroad Use *		31.A. State Use *			
30.C. Railroad Use *		31.B. State Use * LSX			
30.D. Railroad Use *		31.C. State Use *			
30.E. Railroad Use *		31.D. State Use *			
32.A. Narrative (Railroad Use) *			32.B. Narrative (State Use) *		
33. Emergency Notification Telephone No. (posted)		34. Railroad Contact (Telephone No.)		35. State Contact (Telephone No.) 717-772-3079	

Part II: Railroad Information

1. Estimated Number of Daily Train Movements				
1.A. Total Day Thru Trains (6 AM to 6 PM) 0	1.B. Total Night Thru Trains (6 PM to 6 AM) 0	1.C. Total Switching Trains 0	1.D. Total Transit Trains	1.E. Check if Less Than One Movement Per Day <input type="checkbox"/> How many trains per week? _____
2. Year of Train Count Data (YYYY)		3. Speed of Train at Crossing 3.A. Maximum Timetable Speed (mph) 15 3.B. Typical Speed Range Over Crossing (mph) From 5 to 15		
4. Type and Count of Tracks Main 1 Siding _____ Yard _____ Transit _____ Industry _____				
5. Train Detection (Main Track only) <input type="checkbox"/> Constant Warning Time <input type="checkbox"/> Motion Detection <input type="checkbox"/> AFO <input type="checkbox"/> PTC <input checked="" type="checkbox"/> DC <input type="checkbox"/> Other <input type="checkbox"/> None				
6. Is Track Signaled? <input type="checkbox"/> Yes <input checked="" type="checkbox"/> No		7.A. Event Recorder <input type="checkbox"/> Yes <input type="checkbox"/> No		7.B. Remote Health Monitoring <input type="checkbox"/> Yes <input type="checkbox"/> No

U. S. DOT CROSSING INVENTORY FORM

A. Revision Date (MM/DD/YYYY) 07/03/2022		PAGE 2		D. Crossing Inventory Number (7 char.) 517808X	
Part III: Highway or Pathway Traffic Control Device Information					
1. Are there Signs or Signals? <input type="checkbox"/> Yes <input checked="" type="checkbox"/> No		2. Types of Passive Traffic Control Devices associated with the Crossing			
2.A. Crossbuck Assemblies (count) 1		2.B. STOP Signs (R1-1) (count) 0	2.C. YIELD Signs (R1-2) (count)	2.D. Advance Warning Signs (Check all that apply; include count) <input type="checkbox"/> None <input type="checkbox"/> W10-1 _____ <input type="checkbox"/> W10-3 _____ <input type="checkbox"/> W10-11 _____ <input type="checkbox"/> W10-2 _____ <input type="checkbox"/> W10-4 _____ <input type="checkbox"/> W10-12 _____	
2.E. Low Ground Clearance Sign (W10-5) <input type="checkbox"/> Yes (count _____) <input type="checkbox"/> No		2.F. Pavement Markings <input checked="" type="checkbox"/> Stop Lines <input type="checkbox"/> Dynamic Envelope <input type="checkbox"/> RR Xing Symbols <input type="checkbox"/> None		2.G. Channelization Devices/Medians <input type="checkbox"/> All Approaches <input type="checkbox"/> Median <input type="checkbox"/> One Approach <input type="checkbox"/> None	2.H. EXEMPT Sign (R15-3) <input type="checkbox"/> Yes <input type="checkbox"/> No
2.I. ENS Sign (I-13) Displayed <input type="checkbox"/> Yes <input type="checkbox"/> No		2.J. Other MUTCD Signs <input type="checkbox"/> Yes <input type="checkbox"/> No Specify Type _____ Count 0 Specify Type _____ Count 0 Specify Type _____ Count _____	2.K. Private Crossing Signs (if private) <input type="checkbox"/> Yes <input type="checkbox"/> No	2.L. LED Enhanced Signs (List types)	
3. Types of Train Activated Warning Devices at the Grade Crossing (specify count of each device for all that apply)					
3.A. Gate Arms (count) Roadway 0 Pedestrian _____	3.B. Gate Configuration <input type="checkbox"/> 2 Quad <input type="checkbox"/> Full (Barrier) Resistance <input type="checkbox"/> 3 Quad <input type="checkbox"/> Median Gates	3.C. Cantilevered (or Bridged) Flashing Light Structures (count) Over Traffic Lane 0 <input type="checkbox"/> Incandescent Not Over Traffic Lane 2 <input type="checkbox"/> LED		3.D. Mast Mounted Flashing Lights (count of masts) 0 <input type="checkbox"/> Incandescent <input type="checkbox"/> LED <input type="checkbox"/> Back Lights Included <input type="checkbox"/> Side Lights Included	3.E. Total Count of Flashing Light Pairs 0
3.F. Installation Date of Current Active Warning Devices: (MM/YYYY) ____/____/____ <input type="checkbox"/> Not Required		3.G. Wayside Horn <input type="checkbox"/> Yes Installed on (MM/YYYY) ____/____/____ <input type="checkbox"/> No		3.H. Highway Traffic Signals Controlling Crossing <input type="checkbox"/> Yes <input checked="" type="checkbox"/> No	3.I. Bells (count) 0
3.J. Non-Train Active Warning <input type="checkbox"/> Flagging/Flagman <input type="checkbox"/> Manually Operated Signals <input type="checkbox"/> Watchman <input type="checkbox"/> Floodlighting <input type="checkbox"/> None				3.K. Other Flashing Lights or Warning Devices Count 0 Specify type _____	
4.A. Does nearby Hwy Intersection have Traffic Signals? <input type="checkbox"/> Yes <input checked="" type="checkbox"/> No	4.B. Hwy Traffic Signal Interconnection <input checked="" type="checkbox"/> Not Interconnected <input type="checkbox"/> For Traffic Signals <input type="checkbox"/> For Warning Signs	4.C. Hwy Traffic Signal Preemption <input type="checkbox"/> Simultaneous <input type="checkbox"/> Advance	5. Highway Traffic Pre-Signals <input type="checkbox"/> Yes <input type="checkbox"/> No Storage Distance * _____ Stop Line Distance * _____	6. Highway Monitoring Devices (Check all that apply) <input type="checkbox"/> Yes - Photo/Video Recording <input type="checkbox"/> Yes - Vehicle Presence Detection <input type="checkbox"/> None	
Part IV: Physical Characteristics					
1. Traffic Lanes Crossing Railroad Number of Lanes 2 <input type="checkbox"/> One-way Traffic <input type="checkbox"/> Two-way Traffic <input type="checkbox"/> Divided Traffic		2. Is Roadway/Pathway Paved? <input checked="" type="checkbox"/> Yes <input type="checkbox"/> No	3. Does Track Run Down a Street? <input type="checkbox"/> Yes <input checked="" type="checkbox"/> No	4. Is Crossing Illuminated? (Street lights within approx. 50 feet from nearest rail) <input checked="" type="checkbox"/> Yes <input type="checkbox"/> No	
5. Crossing Surface (on Main Track, multiple types allowed) Installation Date * (MM/YYYY) ____/____/____ Width * _____ Length * _____ <input type="checkbox"/> 1 Timber <input checked="" type="checkbox"/> 2 Asphalt <input type="checkbox"/> 3 Asphalt and Timber <input type="checkbox"/> 4 Concrete <input type="checkbox"/> 5 Concrete and Rubber <input type="checkbox"/> 6 Rubber <input type="checkbox"/> 7 Metal <input type="checkbox"/> 8 Unconsolidated <input type="checkbox"/> 9 Composite <input type="checkbox"/> 10 Other (specify) _____					
6. Intersecting Roadway within 500 feet? <input checked="" type="checkbox"/> Yes <input type="checkbox"/> No If Yes, Approximate Distance (feet) _____			7. Smallest Crossing Angle <input type="checkbox"/> 0° - 29° <input checked="" type="checkbox"/> 30° - 59° <input type="checkbox"/> 60° - 90°	8. Is Commercial Power Available? * <input checked="" type="checkbox"/> Yes <input type="checkbox"/> No	
Part V: Public Highway Information					
1. Highway System <input type="checkbox"/> (01) Interstate Highway System <input type="checkbox"/> (02) Other Nat Hwy System (NHS) <input checked="" type="checkbox"/> (03) Federal AID, Not NHS <input type="checkbox"/> (08) Non-Federal Aid		2. Functional Classification of Road at Crossing <input type="checkbox"/> (0) Rural <input checked="" type="checkbox"/> (1) Urban <input type="checkbox"/> (1) Interstate <input type="checkbox"/> (5) Major Collector <input type="checkbox"/> (2) Other Freeways and Expressways <input type="checkbox"/> (3) Other Principal Arterial <input type="checkbox"/> (6) Minor Collector <input checked="" type="checkbox"/> (4) Minor Arterial <input type="checkbox"/> (7) Local		3. Is Crossing on State Highway System? <input checked="" type="checkbox"/> Yes <input type="checkbox"/> No	4. Highway Speed Limit 25 _____ MPH <input type="checkbox"/> Posted <input type="checkbox"/> Statutory
5. Linear Referencing System (LRS Route ID) *					
6. LRS Milepost *					
7. Annual Average Daily Traffic (AADT) Year 2020 AADT 9205		8. Estimated Percent Trucks 3 _____ %	9. Regularly Used by School Buses? <input type="checkbox"/> Yes <input type="checkbox"/> No Average Number per Day 0 _____		10. Emergency Services Route <input type="checkbox"/> Yes <input type="checkbox"/> No
Submission Information - This information is used for administrative purposes and is not available on the public website.					
Submitted by _____ Organization _____ Phone _____ Date _____					
Public reporting burden for this information collection is estimated to average 30 minutes per response, including the time for reviewing instructions, searching existing data sources, gathering and maintaining the data needed and completing and reviewing the collection of information. According to the Paperwork Reduction Act of 1995, a federal agency may not conduct or sponsor, and a person is not required to, nor shall a person be subject to a penalty for failure to comply with, a collection of information unless it displays a currently valid OMB control number. The valid OMB control number for information collection is 2130-0017. Send comments regarding this burden estimate or any other aspect of this collection, including for reducing this burden to: Information Collection Officer, Federal Railroad Administration, 1200 New Jersey Ave. SE, MS-25 Washington, DC 20590.					