



165 Beach Lake Highway

Honesdale, Pennsylvania 18431

January 20, 2023

Ms. Rosemary Chiavetta, Secretary  
Pennsylvania Public Utility Commission  
P.O. Box 3265  
Harrisburg, PA 17105-3265

**RE: DOCKET A-2023-3037717  
APPLICATION FOR PUBLIC CROSSING  
At 361437D, PHOENIX STREET  
READING BLUE MOUNTAIN AND NORTHERN RAILROAD  
BOROUGH OF DURYEA  
COUNTY OF LUZERNE**

Dear Secretary Chiavetta,

Enclosed please find corrections to the Certificate of Insurance and Exhibit B – Interested Parties documents. We had to correct the contact information for RCN and Comcast.

Should you have any questions please contact this office.

Sincerely,

A handwritten signature in blue ink that reads "Dustin Stockholm". The signature is written in a cursive, flowing style.

Dustin Stockholm  
Supervisor - Right of Way

Enclosures

cc: Rodney D. Bender, P.E.  
Chief-Bureau of Rail Safety  
PA Public Utility Commission  
P.O. Box 3265  
Harrisburg, PA 17105-3265

**BEFORE**  
**PENNSYLVANIA PUBLIC UTILITY COMMISSION**

---

In re: Application of PPL Electric Utilities for approval of the alteration of crossing 361437D by the replacement of utility pole structure where Phoenix St (State Road 2027) crosses at grade the tracks of Reading Blue Mountain and Northern Railroad, located in Duryea Borough in Luzerne County.

Application

Docket No.

To Pennsylvania Public Utility Commission:

1. The name and address of applicant are:

PPL Electric Utilities Corporation

Two North Ninth Street

GENN3

Allentown, PA 18101

2. The name and address of the applicant's attorney are  
Mallory Jane Sweeney - Associate General Counsel

---

PPL Electric Utilities Corporation,

---

Two North Ninth Street, Allentown, PA 18101-1179

---

3. PPL Electric Utilities wishes to replace existing PPL pole #54330N43613 to support existing and future loading conditions and clearance requirements. This above ground communication facility is located at crossing 361437D in Duryea Borough, Luzerne County, PA.
  
4. The proposed construction will be a replacement of the existing utility pole on the south side of the railroad crossing. Phoenix St intersects the railroad at grade. See attached Exhibit "A". The estimated completion date for this project is March 21, 2023.
  
5. The public utilities, municipalities, corporations and property owners concerned in, or affected by, the crossing alteration are identified in Exhibit "B" attached hereto
  
6. The expected cost for the construction procedure is \$10,000. PPL Electric Utilities will pay all costs of construction of the utility pole replacements, in addition to being responsible for installing, maintaining and inspecting the facilities.
  
7. The alteration is necessary or proper for the following reasons: to provide adequate, efficient, and reasonable communication facilities and power to the public in Luzerne County and surrounding areas.

Wherefore, applicant prays your Honorable Commission to approve the application:

  
(Signature of Applicant)

**§ 1.36. Verification.**

(a) Applications, petitions, formal complaints, motions and answers thereto containing an averment of fact not appearing of record in the action or containing a denial of fact shall be personally verified by a party thereto or by an authorized officer of the party if a corporation or association. Verification means a signed written statement of fact supported by oath or affirmation or made subject to the penalties of 18 Pa. C.S. §4904 (relating to unsworn falsification to authorities). If verification is required, notarization is not necessary.

(b) The Verification form should comply substantially with the following:

**VERIFICATION**

I, DUSTIN STOCKHOLM, hereby state that the facts above set forth are true and correct (or are true and correct to the best of my knowledge, information and belief) and that I expect to be able to prove the same at a hearing held in this matter. I understand that the statements herein are made subject to the penalties of 18 Pa. C.S. § 4904 (relating to unsworn falsification to authorities).

Date: 1-17-23

Dustin Stockholm

(Signature)

CERTIFICATE OF SERVICE

I hereby certify that I have this day served a true copy of the foregoing document upon the participants, listed below, in accordance with the requirements of § 1.54 (relating to service by participant) .

Mark Chappel, P.E. - Chief  
Bureau of Project Delivery  
P.O. Box 3362  
Harrisburg, PA 17105-3362  
marchappel@pa.gov

Duryea Borough  
Attn: Engineering/Permitting  
315 Main St  
Duryea, PA 18642  
carolyn.santee@duryeaborough.com

Karen Cummings - Office of Chief Counsel  
PennDOT  
P.O. Box 8212  
Harrisburg, PA 17105-8212  
kcummings@pa.gov

Reading Blue Mountain & Northern Railroad  
Attn: Engineering/Permitting  
P.O. Box 218  
Port Clinton, PA 19549  
JBusher@readingnorthern.com

PennDOT Engineering District 4  
Jeremiah Gonzalo  
55 Keystone Industrial Park  
Dunmore, PA 18512  
jgonzalo@pa.gov

Verizon  
Attn: Engineering/Permitting  
15 E. Montgomery Avenue  
Pittsburgh, PA 15212  
poleconduitadmin@verizon.com

Luzerne County Courthouse  
Attn: Permits/Public works  
200 N River Street  
Wilkes-Barre, PA 18711  
larry.plesh@luzernecounty.org

RCN  
ATTN: Machael Mathers  
5508 Norbath Blvd.  
Northampton, PA 18067  
michael.mathers@astound.com

Dustin Stockholm  
Supervisor - Right of Way  
PPL Electric Utilities  
165 Beach Lake Highway  
Honesdale, PA 18431  
Dstockholm@pplweb.com

Comcast Duryea  
Attn: Jim Hall  
1 Comcast Way  
Duryea, PA 18642  
james\_hall3@cable.comcast.com

Dated this 20<sup>th</sup> day of JANUARY, 2023.

  
\_\_\_\_\_

(Signature)

## EXHIBIT "B"

The public utilities, municipalities, corporations, and property owners concerned in, or affected by, the crossing alteration are:

Mark Chappel, P.E. - Chief  
Bureau of Project Delivery  
P.O. Box 3362  
Harrisburg, PA 17105-3362  
marchappel@pa.gov

Duryea Borough  
Attn: Engineering/Permitting  
315 Main St  
Duryea, PA 18642  
carolyn.santee@duryeaborough.com

Karen Cummings - Office of Chief Counsel  
PennDOT  
P.O. Box 8212  
Harrisburg, PA 17105-8212  
kcummings@pa.gov

Reading Blue Mountain & Northern Railroad  
Attn: Engineering/Permitting  
P.O. Box 218  
Port Clinton, PA 19549  
JBusher@readingnorthern.com

PennDOT Engineering District 4  
Jeremiah Gonzalo  
55 Keystone Industrial Park  
Dunmore, PA 18512  
jgonzalo@pa.gov

Verizon  
Attn: Engineering/Permitting  
15 E. Montgomery Avenue  
Pittsburgh, PA 15212  
poleconduitadmin@verizon.com

Luzerne County Courthouse  
Attn: Permits/Public works  
200 N River Street  
Wilkes-Barre, PA 18711  
larry.plesh@luzernecounty.org

RCN  
ATTN: Michael Mathers  
5508 Norbath Blvd.  
Northampton, PA 18067  
michael.mathers@astound.com

Dustin Stockholm  
Supervisor - Right of Way  
PPL Electric Utilities  
165 Beach Lake Highway  
Honesdale, PA 18431  
dstockholm@pplweb.com

Comcast Duryea  
Attn: Jim Hall  
1 Comcast Way  
Duryea, PA 18642  
james\_hall3@cable.comcast.com



PPL Electric Utilities

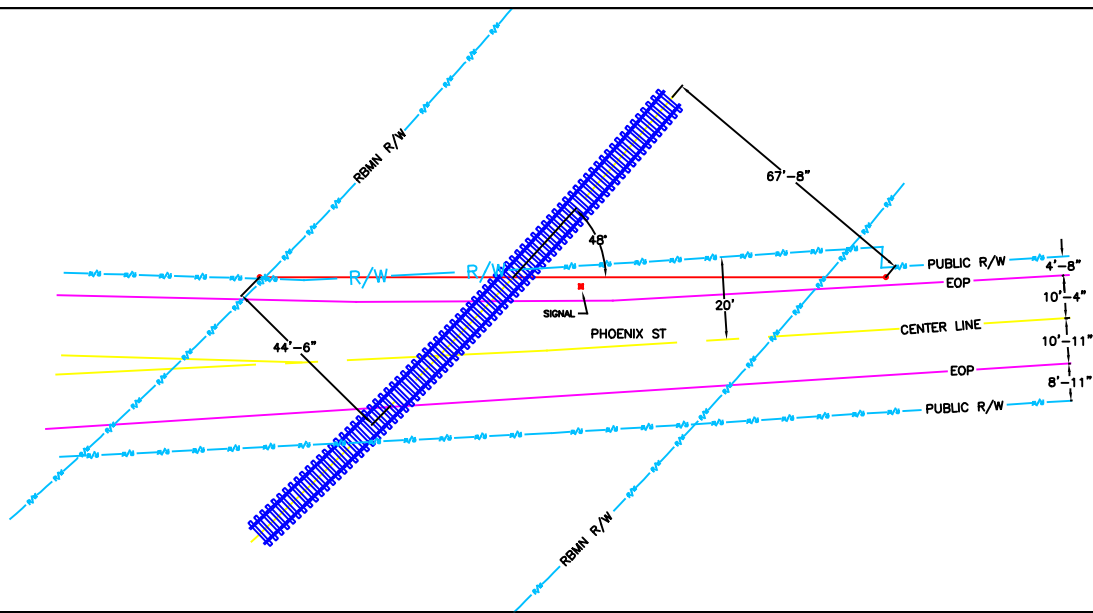

PLAN VIEW

CROSSING NUMBER:  
361437D

CABLE HEIGHTS
PRIMARY 39'-8"
ADSS 35'-2"
NEUTRAL 32'-11"
PROPOSED 30'-5"
29'-5"
27'-10"
27'-7"

PPL# 54321N43620  
LAT/LONG: 41.346972, -75.771221

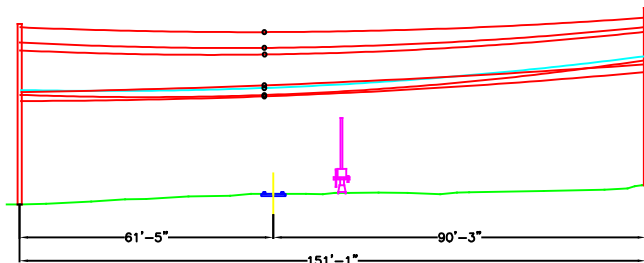

PROFILE VIEW

PPL# 54330N43613  
LAT/LONG: 41.346707, -75.770795  
HEIGHT: 50  
CLASS: 1  
BASE CIRCUMFERENCE: 45'-0"  
BURY DEPTH: 7'

PREPARED BY:



CITY: DURYEA

COUNTY: LUZERNE

STATE: PENNSYLVANIA

DATE: 11/11/2022

DRAWN BY: NIYS

TITLE: RCN DURYEA SCID 33

PROJECT NO:

PRINT NO: 1

NO. OF PRINTS: 1

ENGINEERED BY: KATAPULT



FILENAME:  
EXHIBIT A



# U. S. DOT CROSSING INVENTORY FORM

A. Revision Date (MM/DD/YYYY) 09/16/2022		PAGE 2			D. Crossing Inventory Number (7 char.) 361437D	
<b>Part III: Highway or Pathway Traffic Control Device Information</b>						
1. Are there Signs or Signals? <input type="checkbox"/> Yes <input checked="" type="checkbox"/> No		2. Types of Passive Traffic Control Devices associated with the Crossing				
2.A. Crossbuck Assemblies (count) 2		2.B. STOP Signs (R1-1) (count) 0	2.C. YIELD Signs (R1-2) (count) 0	2.D. Advance Warning Signs (Check all that apply; include count) <input type="checkbox"/> None <input checked="" type="checkbox"/> W10-1 2 <input type="checkbox"/> W10-3 _____ <input type="checkbox"/> W10-11 _____ <input type="checkbox"/> W10-2 _____ <input type="checkbox"/> W10-4 _____ <input type="checkbox"/> W10-12 _____		
2.E. Low Ground Clearance Sign (W10-5) <input type="checkbox"/> Yes (count _____) <input checked="" type="checkbox"/> No		2.F. Pavement Markings <input checked="" type="checkbox"/> Stop Lines <input type="checkbox"/> Dynamic Envelope <input checked="" type="checkbox"/> RR Xing Symbols <input type="checkbox"/> None		2.G. Channelization Devices/Medians <input type="checkbox"/> All Approaches <input type="checkbox"/> Median <input type="checkbox"/> One Approach <input checked="" type="checkbox"/> None		2.H. EXEMPT Sign (R15-3) <input type="checkbox"/> Yes <input checked="" type="checkbox"/> No
2.I. ENS Sign (I-13) Displayed <input checked="" type="checkbox"/> Yes <input type="checkbox"/> No		2.J. Other MUTCD Signs <input type="checkbox"/> Yes <input checked="" type="checkbox"/> No Specify Type _____ Count _____ Specify Type _____ Count _____ Specify Type _____ Count _____		2.K. Private Crossing Signs (if private) <input type="checkbox"/> Yes <input type="checkbox"/> No	2.L. LED Enhanced Signs (List types)	
3. Types of Train Activated Warning Devices at the Grade Crossing (specify count of each device for all that apply)						
3.A. Gate Arms (count) Roadway 2 Pedestrian 0	3.B. Gate Configuration <input type="checkbox"/> 2 Quad <input type="checkbox"/> Full (Barrier) Resistance <input type="checkbox"/> 3 Quad <input type="checkbox"/> Median Gates <input type="checkbox"/> 4 Quad		3.C. Cantilevered (or Bridged) Flashing Light Structures (count) Over Traffic Lane 0 <input type="checkbox"/> Incandescent Not Over Traffic Lane 0 <input type="checkbox"/> LED		3.D. Mast Mounted Flashing Lights (count of masts) 2 <input type="checkbox"/> Incandescent <input checked="" type="checkbox"/> LED <input checked="" type="checkbox"/> Back Lights Included <input type="checkbox"/> Side Lights Included	3.E. Total Count of Flashing Light Pairs 4
3.F. Installation Date of Current Active Warning Devices: (MM/YYYY) ____/____/____ <input type="checkbox"/> Not Required		3.G. Wayside Horn <input type="checkbox"/> Yes      Installed on (MM/YYYY) ____/____/____ <input checked="" type="checkbox"/> No		3.H. Highway Traffic Signals Controlling Crossing <input type="checkbox"/> Yes <input checked="" type="checkbox"/> No	3.I. Bells (count) 2	
3.J. Non-Train Active Warning <input type="checkbox"/> Flagging/Flagman <input type="checkbox"/> Manually Operated Signals <input type="checkbox"/> Watchman <input type="checkbox"/> Floodlighting <input checked="" type="checkbox"/> None				3.K. Other Flashing Lights or Warning Devices Count 0      Specify type _____		
4.A. Does nearby Hwy Intersection have Traffic Signals? <input type="checkbox"/> Yes <input checked="" type="checkbox"/> No	4.B. Hwy Traffic Signal Interconnection <input checked="" type="checkbox"/> Not Interconnected <input type="checkbox"/> For Traffic Signals <input type="checkbox"/> For Warning Signs	4.C. Hwy Traffic Signal Preemption <input type="checkbox"/> Simultaneous <input type="checkbox"/> Advance	5. Highway Traffic Pre-Signals <input type="checkbox"/> Yes <input type="checkbox"/> No Storage Distance * _____ Stop Line Distance * _____		6. Highway Monitoring Devices (Check all that apply) <input type="checkbox"/> Yes - Photo/Video Recording <input type="checkbox"/> Yes - Vehicle Presence Detection <input type="checkbox"/> None	
<b>Part IV: Physical Characteristics</b>						
1. Traffic Lanes Crossing Railroad Number of Lanes 2 <input type="checkbox"/> One-way Traffic <input type="checkbox"/> Two-way Traffic <input type="checkbox"/> Divided Traffic		2. Is Roadway/Pathway Paved? <input checked="" type="checkbox"/> Yes <input type="checkbox"/> No	3. Does Track Run Down a Street? <input type="checkbox"/> Yes <input checked="" type="checkbox"/> No	4. Is Crossing Illuminated? (Street lights within approx. 50 feet from nearest rail) <input checked="" type="checkbox"/> Yes <input type="checkbox"/> No		
5. Crossing Surface (on Main Track, multiple types allowed) Installation Date * (MM/YYYY) ____/____/____ Width * 20 Length * 54 <input type="checkbox"/> 1 Timber <input checked="" type="checkbox"/> 2 Asphalt <input type="checkbox"/> 3 Asphalt and Timber <input type="checkbox"/> 4 Concrete <input type="checkbox"/> 5 Concrete and Rubber <input type="checkbox"/> 6 Rubber <input type="checkbox"/> 7 Metal <input type="checkbox"/> 8 Unconsolidated <input type="checkbox"/> 9 Composite <input type="checkbox"/> 10 Other (specify) _____						
6. Intersecting Roadway within 500 feet? <input checked="" type="checkbox"/> Yes <input type="checkbox"/> No      If Yes, Approximate Distance (feet) 60			7. Smallest Crossing Angle <input type="checkbox"/> 0° - 29° <input checked="" type="checkbox"/> 30° - 59° <input type="checkbox"/> 60° - 90°		8. Is Commercial Power Available? * <input checked="" type="checkbox"/> Yes <input type="checkbox"/> No	
<b>Part V: Public Highway Information</b>						
1. Highway System <input type="checkbox"/> (01) Interstate Highway System <input type="checkbox"/> (02) Other Nat Hwy System (NHS) <input checked="" type="checkbox"/> (03) Federal AID, Not NHS <input type="checkbox"/> (08) Non-Federal Aid		2. Functional Classification of Road at Crossing <input type="checkbox"/> (0) Rural <input checked="" type="checkbox"/> (1) Urban <input type="checkbox"/> (1) Interstate <input type="checkbox"/> (5) Major Collector <input type="checkbox"/> (2) Other Freeways and Expressways <input type="checkbox"/> (3) Other Principal Arterial <input type="checkbox"/> (6) Minor Collector <input checked="" type="checkbox"/> (4) Minor Arterial <input type="checkbox"/> (7) Local		3. Is Crossing on State Highway System? <input checked="" type="checkbox"/> Yes <input type="checkbox"/> No	4. Highway Speed Limit 35 MPH <input type="checkbox"/> Posted <input type="checkbox"/> Statutory	
5. Linear Referencing System (LRS Route ID) *						
6. LRS Milepost *						
7. Annual Average Daily Traffic (AADT) Year 2018 AADT 3045		8. Estimated Percent Trucks 6 %	9. Regularly Used by School Buses? <input type="checkbox"/> Yes <input type="checkbox"/> No      Average Number per Day 0		10. Emergency Services Route <input type="checkbox"/> Yes <input type="checkbox"/> No	
<b>Submission Information - This information is used for administrative purposes and is not available on the public website.</b>						
Submitted by _____ Organization _____ Phone _____ Date _____						
Public reporting burden for this information collection is estimated to average 30 minutes per response, including the time for reviewing instructions, searching existing data sources, gathering and maintaining the data needed and completing and reviewing the collection of information. According to the Paperwork Reduction Act of 1995, a federal agency may not conduct or sponsor, and a person is not required to, nor shall a person be subject to a penalty for failure to comply with, a collection of information unless it displays a currently valid OMB control number. The valid OMB control number for information collection is 2130-0017. Send comments regarding this burden estimate or any other aspect of this collection, including for reducing this burden to: Information Collection Officer, Federal Railroad Administration, 1200 New Jersey Ave. SE, MS-25 Washington, DC 20590.						