

DETAILS / SCOPE OF WORK
 VERIZON WILL OVERLASH A NEW 1 25" DUCT TO EXISTING COPPER CABLE ACROSS CSX RR TRACKS 28 75" ABOVE RAIL VERIZON WILL THEN PULL A SINGLE 48 FIBER SHEATH THROUGH THE 1 25" DUCT APPROXIMATE TIME TO PULL DUCT ACROSS RR TRACKS = 0 5 HOURS APPROXIMATE TIME TO PULL 48 FIBER IN DUCT ACROSS RR TRACKS = 2 HOURS OPERATION OF PLACING DUCT OVER CSX RR TRACKS COULD AFFECT RAIL TRAFFIC OPERATION OF PULLING 48 FIBER IN DUCT SHOULD NOT AFFECT RAIL TRAFFIC

NAME OF RAILROAD BUFFALO & PITTSBURGH RAILROAD / CSX
 BUFFALO & PITTSBURGH RR CROSSING NUMBER 148-739-X
 STATE PA
 COUNTY JEFFERSON
 TOWNSHIP BELL
 LOCAL ROAD NAME SMYERSTOWNS ROAD
 STATE ROUTE 2011 SEGMENT 1D
 CROSSING LAT / LONG 40 911075 / -78 942484

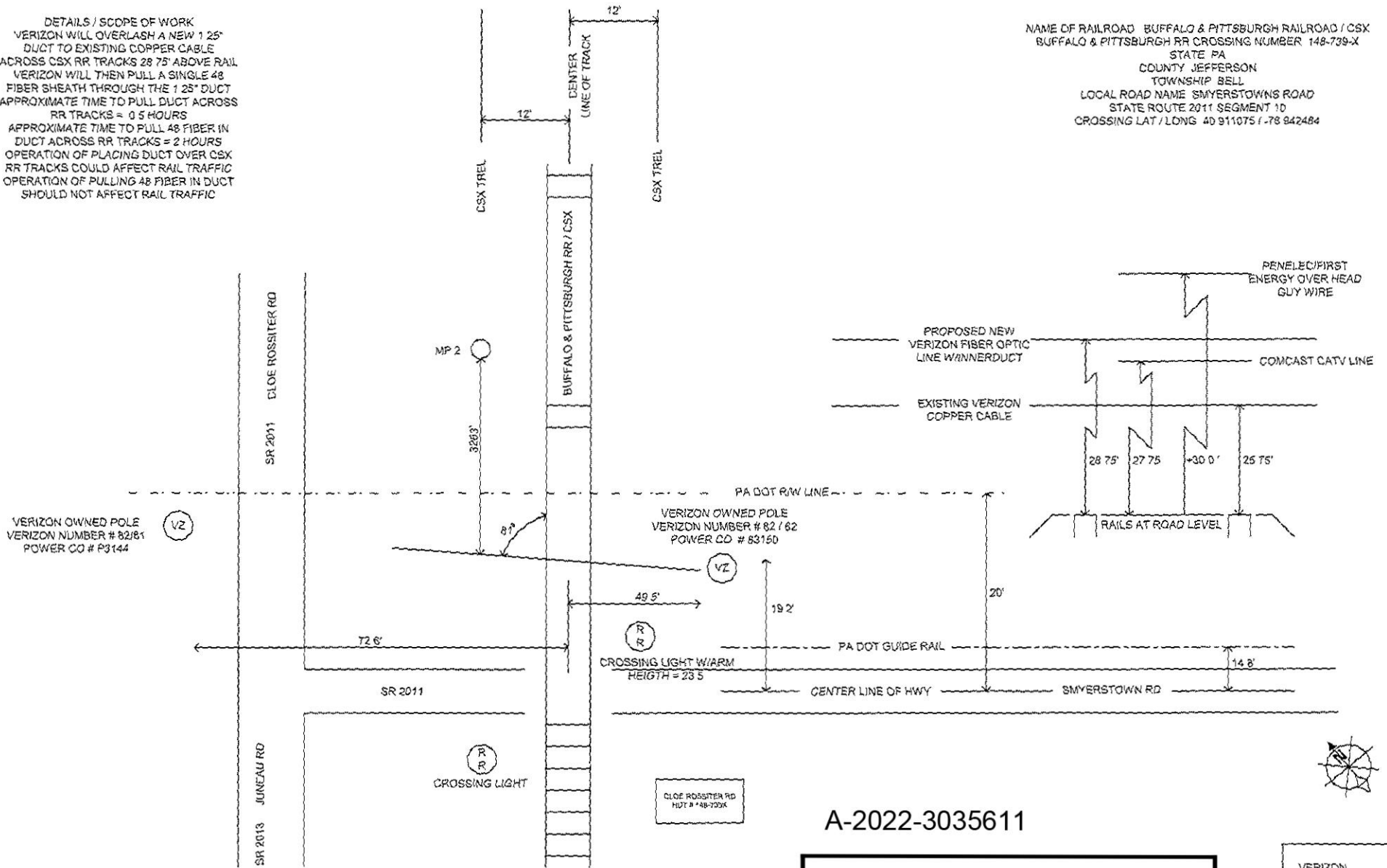

A-2022-3035611

CERTIFIED CORRECT PLANS
Paul Deering
 Professional Engineer
 Approved by Bureau of Technical Utility Services
PA PUBLIC UTILITY COMMISSION
 ATTEST *Rosemary Chittenden*
 Secretary

VERIZON PENNSYLVANIA LLC
 PAUL DEERING
 814-404-2135