

POLE REPLACEMENT WITH 70' CLASS 1 POLE.
CUT POLE TOP TO 49'-0" (56'-6" TOTAL POLE LENGTH)

LAT/LONG RR CENTERLINE:
41.274299, -75.829848

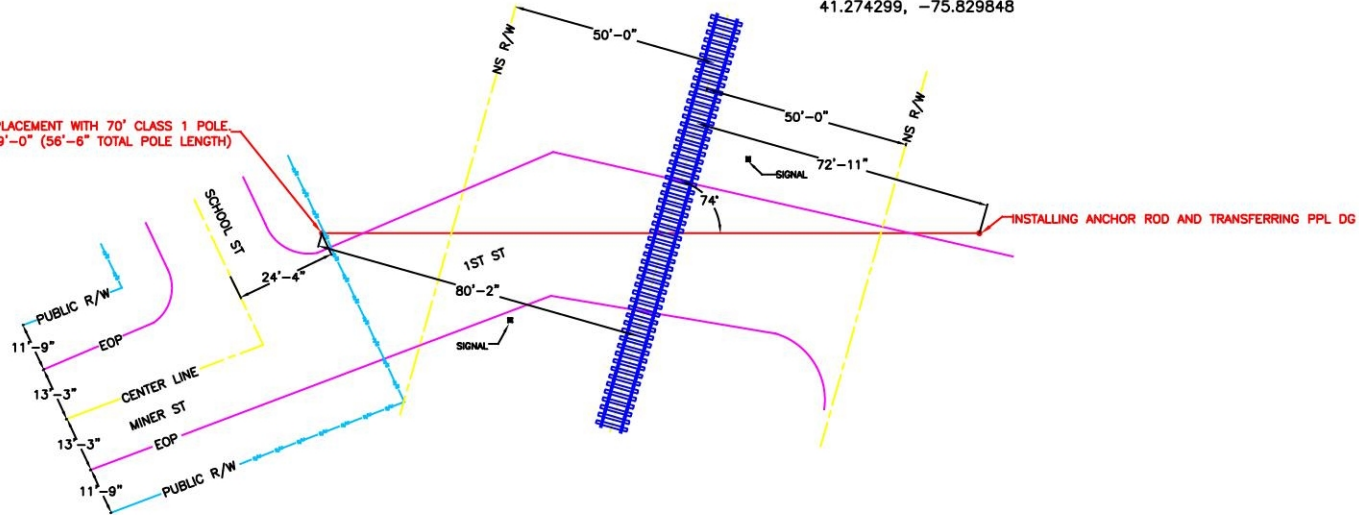

PLAN VIEW

CROSSING NUMBER:
249686F

POLE REPLACEMENT WITH 70' CLASS 1 POLE.
CUT POLE TOP TO 49'-0" (56'-6" TOTAL POLE LENGTH)

INSTALLING ANCHOR ROD AND TRANSFERRING PPL DG

PPL# 52763N40943
LAT/LONG: 41.274473, -75.830057
BASE DIAMETER = 51"
HEIGHT = 70'
CLASS = 1
BURIED DEPTH = 7'-6"

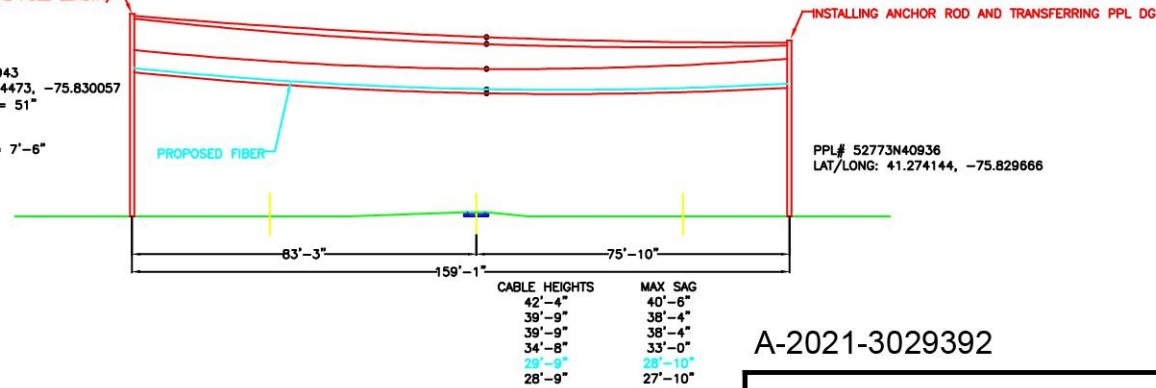

PPL# 52773N40936
LAT/LONG: 41.274144, -75.829666

PROFILE VIEW

A-2021-3029392

CERTIFIED CORRECT PLANS

George DiCandiano

Professional Engineer
Approved by Bureau of Technical Utility Services

PA PUBLIC UTILITY COMMISSION

ATTEST *Robert J. Chittin*
Secretary



PPL Electric Utilities



PREPARED BY:

TITLE: APP-300831	CITY: PLAINS TOWNSHIP
PROJECT NO: 1	COUNTY: LUZERNE COUNTY
PRINT NO: 1	STATE: PENNSYLVANIA
NO. OF PRINTS: 1	DATE: 10-13-2021
ENGINEERED BY: KATAPULT	DRAWN BY: NHYS



FILENAME:
EXHIBIT A

