

Michael J. Shafer
Senior Counsel

PPL
Two North Ninth Street
Allentown, PA 18101-1179
Tel. 610.774.2599 Fax 610.774.4102
MJShafer@pplweb.com



E-File

August 23, 2023

Rosemary Chiavetta, Secretary
Pennsylvania Public Utility Commission
Commonwealth Keystone Building
400 North Street, 2nd Floor North
Harrisburg, PA 17120-3265

**Re: PPL Electric Utilities Corporation Access Road Easement containing an Additional Consideration Agreement; Ashland Area Municipal Authority, Borough of Ashland, Townships of Butler and Newcastle, Schuylkill County, Pennsylvania – Parcel ID #04-07-0002.000
Docket No. U-2023-3042173**

Dear Secretary Chiavetta:

Enclosed for filing on behalf of PPL Electric Utilities Corporation (“PPL Electric”) is an updated Access Road Easement between PPL Electric and the Ashland Area Municipal Authority, Borough of Ashland, Schuylkill County, Pennsylvania. This easement was previously filed on August 11, 2023 and assigned Docket No. U-2023-3042173. The instant document, however, now contains the Additional Consideration Agreement missing from the original filing.

This Access Road Easement for parcel ID #04-07-0002.000 is part of the Frackville-Mowry 69kV transmission line project. This agreement is being filed pursuant to 66 Pa. C.S.A. § 507.

Pursuant to 52 Pa. Code § 1.11, the enclosed document is to be deemed filed on August 23, 2023, which is the date it was filed electronically using the Commission’s E-filing system.

If you have any questions, please do not hesitate to contact me.

Respectfully submitted,

A handwritten signature in blue ink, appearing to read "Michael J. Shafer", is written over a light blue, stylized graphic that resembles a signature or a set of initials.

Michael J. Shafer

Enclosure

Prepared by and return to:
PPL Electric Utilities Corporation

Attn: Ian Van Halem

Phone: 610-774-4523

Address: 2 North 9th Street GENN4
Allentown, PA 18101

Parcel ID#: 04-07-0002.000

ACCESS ROAD EASEMENT

KNOW ALL MEN BY THESE PRESENTS, That Ashland Area Municipal Authority, with an address of 401 South 18th Street, Ashland, Pennsylvania 17921, hereinafter referred to as (**GRANTOR**), in consideration of the sum of Ten Dollars (\$10.00) and other consideration, paid at the date hereof by PPL Electric Utilities Corporation, hereinafter referred to as (**PPL**), the receipt whereof is hereby acknowledged, do hereby for **GRANTOR** and **GRANTOR**'s heirs, executors, administrators and assigns, irrevocably grant and convey unto **PPL**, its successors, assigns, lessees or licensees, the right, liberty and privilege of constructing and maintaining, at **PPL**'s convenience, together with the free and uninterrupted use of and passage in and along a permanent access road as shown on the plan dated February 17th, 2022, Titled as Property Line Exhibit, hereto attached and made a part hereof; generally twenty-five feet in width, in addition to a temporary width of zero feet for construction purposes, extending in a Easterly direction from Pennsylvania Power and Light Co. through the property which **GRANTOR** owns or in which **GRANTOR** has an interest situate in the Borough of Ashland and the Townships of Butler and New Castle, County of Schuylkill, Commonwealth of Pennsylvania, in Deed Book 1514, Page 164, for a distance of approximately twenty-five feet to the property line of lands now or formerly of Pennsylvania Power and Light Co., together with free ingress, egress and regress to and for **PPL**, its successors, assigns, lessees, licensees, tenants, agents, workmen, employees and contractors, with necessary motor vehicles and other apparatus at all times for any and all purposes, into, along, upon and out of said access road; also the right to cut down and trim any trees, brush or other undergrowth upon, along or adjacent to said access road which in the judgment of **PPL**, its successors, assigns, lessees and licensees, may at any time interfere with the construction, maintenance or use of said access road.

This Agreement is between a public utility and a municipal corporation and is therefore subject to Pennsylvania Public Utility Commission ("PUC") review pursuant to 66 Pa.C.S.A. § 507. The Effective Date of this Agreement shall be the later of i) thirty (30) days from the date that PPL submits the Agreement to the PUC; or ii) if the PUC opens an investigation of the Agreement, on the date the PUC approves the Agreement.

WITNESS his/her/their/its hand and seal this 10th day of July, 2023.

Witness:

Adventist

Asland Area Municipal Authority
By: 

Title: Chairman

Commonwealth of Pennsylvania)

:SS

County of Schuylkill)

On this 19 day of July, 2023, before me, the undersigned officer, personally appeared Francis J. Mene who acknowledged himself/herself to be the Chairman of Ashland Area Municipal Authority and that he/she as such Chairman, being authorized to do so, executed the foregoing instrument for the purposes stated therein.

In Witness Whereof, I have hereunto set my hand and notarial seal.

Colleen Mahmood

Commonwealth of Pennsylvania - Notary Seal
Colleen Mahmood, Notary Public
Schuylkill County
My commission expires March 17, 2025
Commission number 1308303
Member, Pennsylvania Association of Notaries



- EXISTING MAP DISTORTIONS**
- MAJOR CORNER
 - MINOR CORNER
 - STREETS/WATERWAYS
 - TOPOGRAPHY
 - WETLANDS
 - PLANT
 - RIGHT OF WAY
 - PROPOSED ADJACENT
 - STRUCTURE TO BE DEMOLISHED
 - DEVELOPER EASEMENT
 - BOUNDARY ESTABLISHMENT
 - EXISTING STONE
- EXISTING COMPACTED ROADWAY TO BE MAINTAINED WITH STONE PAVEMENT SURFACE TO BE IMPROVED**

NOTE: SHOWN ARE EXISTING CONDITIONS, NOT ALL TYPICAL UNIT PER INDICATED ON STATE SHEET.

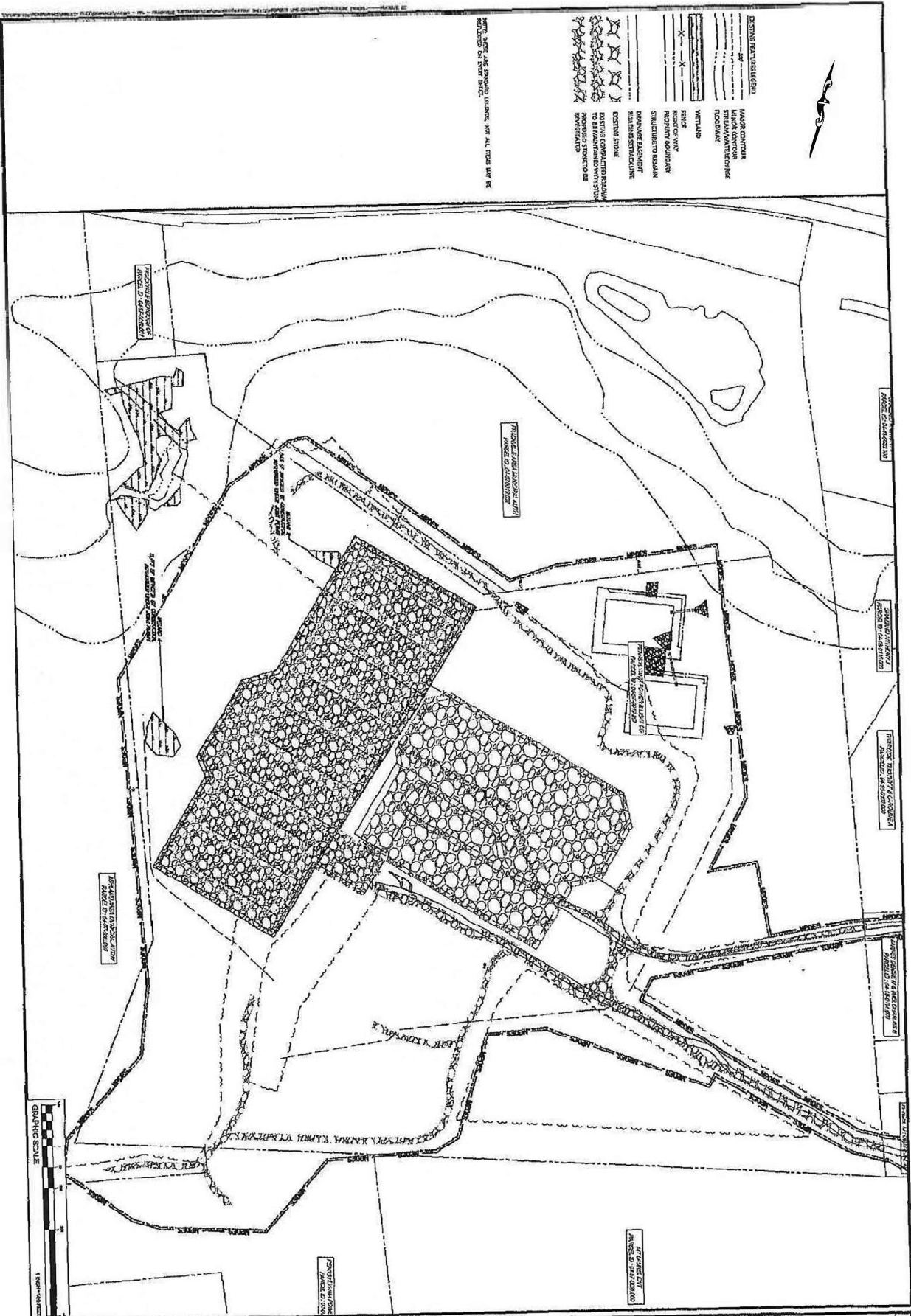

PROJECT: PROJECT NAME TOWNSEND, GEORGE W. & SONS	PROJECT: PROJECT NAME TOWNSEND, GEORGE W. & SONS	PROJECT: PROJECT NAME TOWNSEND, GEORGE W. & SONS	PROJECT: PROJECT NAME TOWNSEND, GEORGE W. & SONS	PROJECT: PROJECT NAME TOWNSEND, GEORGE W. & SONS	PROJECT: PROJECT NAME TOWNSEND, GEORGE W. & SONS
PROJECT: PROJECT NAME TOWNSEND, GEORGE W. & SONS	PROJECT: PROJECT NAME TOWNSEND, GEORGE W. & SONS	PROJECT: PROJECT NAME TOWNSEND, GEORGE W. & SONS	PROJECT: PROJECT NAME TOWNSEND, GEORGE W. & SONS	PROJECT: PROJECT NAME TOWNSEND, GEORGE W. & SONS	PROJECT: PROJECT NAME TOWNSEND, GEORGE W. & SONS

DRAFT



ADDITIONAL CONSIDERATION AGREEMENT

TO BE RECEIVED BY Ashland Area Municipal Authority, whose address is 401 South 18th Street, Ashland, Pennsylvania 17921, Parcel ID 04-07-0002.000, from PPL ELECTRIC UTILITIES CORPORATION for the sum of Two Thousand Dollars and 00/100 (\$2,000.00) being additional consideration for electric and communication line, and facilities upon and over property which they own or in which they have an interest in Ashland Borough and Butler and New Castle Townships, Schuylkill County, Pennsylvania, the original privileges for which were granted to said Company in an agreement executed by Ashland Area Municipal Authority, under the date of July 10, 2023.

WITNESS their hand and seal the day and date first above written.

Signed, sealed and delivered In the presence of:

[Signature]

Solicitor

Ashland Area Municipal Authority

By: [Signature]

Title: Chairman

RECEIVED _____, 2023 from PPL Electric Utilities for the sum of Two Thousand Dollars and 00/100 (\$2,000.00) in full payment for the further consideration above mentioned.

Ashland Area Municipal Authority

By: _____

Title: _____