

Docket Number: A 2024-3045393

In re: Application of Level 3 Communications, LLC for approval of the alteration of the crossing DOT # 515857M by the installation of fiber cable where Swarthmore Avenue crosses above-grade the tracks of National Railroad Passenger Corporation (Amtrak), located in Ridley Park, Delaware County, Pennsylvania.

To Pennsylvania Public Utility Commission:

1. The name and address of applicant is Level 3 Communications, LLC 1025 Eldorado Blvd Broomfield, CO 80021
2. The attached drawing is a revised drawing removing the confidential labels which was initially submitted on 1/3/2024.

AMTRAK - SR 2031 NORTH SWARTHMORE AVE, RIDLEY PARK, PA 19078 (RELO)

CONTACTS

LUMEN / LEVEL 3

RICHARD WILLIAMS (PROGRAM MGR)

(m) 717 - 917 - 6434

richard.l.williams@lumen.com

PRECISION FIBER DESIGN

MATT HANES (PROJECT ENGINEER)

(p) 484 - 571 - 7751

mhanes@precisionfd.com

SITE INDEX

- 1 - COVER SHEET / SITE LOCATION
- 2 - AMTRAK NOTES
- 3 - LEGEND
- 4 - N SWARTHMORE BRIDGE PLAN
- 5 - N SWARTHMORE BRIDGE PROFILE (1)
- 6 - N SWARTHMORE BRIDGE PROFILE (2)
- 7 - ENLARGED N SWARTHMORE BRIDGE PROFILE (1)
- 8 - ENLARGED N SWARTHMORE BRIDGE PROFILE (2)
- 9 - E WARD AVE / E SELLERS AVE BRIDGE PLAN
- 10 - E WARD AVE / E SELLERS AVE BRIDGE PROFILE
- 11 - ENLARGED E WARD AVE / E SELLERS AVE BRIDGE PROFILE

SCOPE OF WORK:

THIS PROJECT SHALL PROVIDE A RELOCATION FOR AN EXISTING 48ct AERIAL BACKBONE CABLE CROSSING THE EAST WARD AVENUE / EAST SELLERS AVENUE BRIDGE (OVER AMTRAK) DUE TO FUTURE BRIDGE CONSTRUCTION

(1) PROPOSED 48ct OSP FOC SHALL BE PULLED THROUGH PROPOSED CONDUIT ((1) 4.00" RIGID PIPE w/ (3) 1.25" HDPE INNER-DUCTS) TO BE FURNISHED & INSTALLED ALONG THE EAST CONCRETE PARAPET OF THE NORTH SWARTHMORE AVENUE BRIDGE (CROSSING AMTRAK)

(1) EXISTING AERIAL 48ct OSP ALONG WITH EXISTING STRAND & ASSOCIATED HARDWARE SHALL BE REMOVED & DISPOSED OF CROSSING THE EAST WARD AVE / EAST SELLERS AVE BRIDGE (OVER AMTRAK)

SEAL



RAMIN ABBASZADEH, P.E.

PA LICENSE NO. 38434-E

NO.	DATE	ENG DESIGN	DRAFTING	COMMENT
3				AS-BUILT
2	02.05.24	BHH	MSH	REVISION # 2
1	09.11.23	BHH	MSH	ORIGINAL

Level(3)
COMMUNICATIONS

LEVEL 3 ENGINEER:	Richard Williams (717) 917 - 6434
ENGINEERING FIRM:	Precision Fiber Design, LLC
PROJECT NUMBER:	P.009109
LOCATION:	SR 2031 NORTH SWARTHMORE AVENUE RIDLEY PARK, PA 19078
DRAWING NAME:	SR 2031 N Swarthmore Ave, Ridley Park, PA 19078 Amtrak_Rev 1_10.10.23.dwg



INFORMATION SHOWN IN THIS DRAWING PERTAINING TO EXISTING CONDITIONS HAS BEEN OBTAINED FROM AVAILABLE BUILDING DRAWINGS, ENGINEERING RECORDS, OR GENERAL FIELD OBSERVATIONS AND MAY NOT INDICATE ACTUAL EXISTING CONDITIONS IN DETAIL OR DIMENSION. THE CONTRACTOR IS RESPONSIBLE FOR DETERMINING THE ACTUAL EXISTING CONDITIONS PRIOR TO FABRICATION OR PERFORMANCE OF ANY WORK. SHOULD CONDITIONS BE DISCOVERED THAT PREVENT EXECUTION OF THE WORK AS INDICATED, THE CONTRACTOR SHALL IMMEDIATELY NOTIFY EACH GOVERNING ENTITY IN WRITING AND AWAIT DIRECTION BEFORE PROCEEDING WITH THE WORK.

AMTRAK NOTES

ALL UNDERGROUND UTILITIES, CABLE, AND FACILITIES MUST BE LOCATED AND PROTECTED BEFORE ANY EXCAVATING, DRILLING, BORING/DIRECTIONAL DRILLING, GROUND PENETRATING ACTIVITIES, OR CONSTRUCTION TAKES PLACE. THIS INCLUDES RAILROAD AND COMMERCIAL UTILITIES, CABLES, DUCT LINES, AND FACILITIES. THESE ACTIVITIES WILL NOT BE PERFORMED IN CLOSE PROXIMITY TO THE RAILROAD DUCT LINES UNLESS MONITORED BY ON-SITE AMTRAK COMMUNICATIONS AND SIGNAL (C&S) DEPARTMENT PERSONNEL. HAND DIGGING MAY BE REQUIRED, AS DIRECTED BY AMTRAK THROUGH THE ON-SITE AMTRAK C&S SUPPORT PERSONNEL. AMTRAK MAINTAINS THE RIGHT TO ACCESS ALL EXISTING CABLES AND CONDUITS THROUGHOUT CONSTRUCTION. AMTRAK ALSO RESERVES THE RIGHT TO UPGRADE AND INSTALL NEW CABLES AND CONDUITS IN THE AFFECTED AREA. THE "ONE-CALL" PROCESS MUST BE FOLLOWED. BE AWARE THAT AMTRAK IS NOT PART OF THE ONE-CALL PROCESS; CONTACT AMTRAK ENGINEERING TO HAVE ALL RAILROAD UNDERGROUND UTILITIES AND ASSETS LOCATED. IF REQUESTED BY AMTRAK, EXISTING DEPTHS OF UTILITIES BEING CROSSED MUST BE VERIFIED THROUGH TEST PITS PERFORMED BY THE CONTRACTOR AS DIRECTED BY AND UNDER THE DIRECT SUPERVISION OF AMTRAK C&S SUPPORT PERSONNEL. PRECAUTIONS MUST BE TAKEN TO PREVENT ANY INTERRUPTION TO RAILROAD OPERATION.

SIGNAL PREVIEW MUST NOT BE OBSTRUCTED. CONSULTANTS PERFORMING WORK FOR AMTRAK OR ON AMTRAK PROPERTY MUST SHOW THAT THERE IS ADEQUATE SIGNAL PREVIEW. IN ADDITION, ALL TEMPORARY STRUCTURES, FORMWORK, EQUIPMENT, ETC. MUST COMPLY DURING CONSTRUCTION.

AMTRAK C&S PERSONNEL MUST FIELD-VERIFY THAT THERE IS NO SIGNAL EQUIPMENT IN THE WAY OF THE PROJECT AND THAT SIGNAL PREVIEW IS NOT BEING OBSTRUCTED.

IF WORK SHALL BE PERFORMED ON RAILROAD PROPERTY THAT INVOLVES HEAVY TRUCKS, EQUIPMENT, OR MACHINERY ALONG THE RIGHT-OF-WAY, DUCT LINES AND PULL BOXES SHALL BE INSPECTED BY ONSITE AMTRAK PERSONNEL AND THE EQUIPMENT OPERATOR TO INSURE THEY CAN WITHHOLD THE APPROPRIATE WEIGHT. REFER TO TIERS & STATIC WHEEL LOAD RATINGS DOCUMENT.

ANY WORK (OR EQUIPMENT BEING STAGED ONSITE DURING CONSTRUCTION) PERFORMED AT OR NEAR A RAILROAD CROSSING MUST NOT OBSTRUCT THE VIEW OF FLASHING LIGHT UNITS OR GATES TO ONCOMING TRAFFIC.

ALL PERSONS THAT ARE ON OR ADJACENT TO RAILROAD PROPERTY MUST SUCCESSFULLY COMPLETE THE CONTRACTOR ORIENTATION TRAINING. ALL CONTRACTORS MUST CARRY THEIR "AMTRAK CONTRACTOR ROADWAY WORKER PROTECTION" CARD WITH THEM AT ALL TIMES WHILE ON OR ADJACENT TO RAILROAD PROPERTY.

ALL WORK ON OR ADJACENT RAILROAD PROPERTY MUST COMPLY WITH AMTRAK ENGINEERING PRACTICES EP3014 – MAINTENANCE AND PROTECTION OF RAILROAD TRAFFIC DURING CONTRACTOR OPERATIONS.

THE TRACKS MUST BE PROTECTED DURING EXCAVATION FOR NEW POLE INSTALLATION IN ACCORDANCE WITH AMTRAK EP3014 SPEC 02261. SEE SKETCH 1 IN AMTRAK EP3014 SPEC 02261 FOR GUIDANCE.

RAILS MUST BE PROTECTED AGAINST DEBRIS. RUST, SAND, METAL SHAVINGS OR OTHER MATERIAL CAN INTERFERE WITH THE PROPER SHUNTING SENSITIVITY OF THE TRACK CIRCUIT.

PRIOR TO ENTERING AMTRAK'S PROPERTY FOR ANY WORK, THE CONTRACTOR MUST EXECUTE AMTRAK'S STANDARD TEMPORARY PERMIT TO ENTER UPON PROPERTY (PTE). THE FULLY EXECUTED PTE, WRITTEN NOTICE TO PROCEED FROM AMTRAK THAT ALL REQUIREMENTS OF THE PTE HAVE BEEN MET AND PROOF OF SAFETY TRAINING MUST, AT ALL TIMES, BE FURNISHED BY THE CONTRACTOR AT THE PROJECT SITE.

ALL PERSONS THAT ARE ON OR ADJACENT TO THE RAILROAD PROPERTY MUST SUCCESSFULLY COMPLETE THE CONTRACTOR ORIENTATION TRAINING. ALL CONTRACTORS MUST CARRY THEIR "AMTRAK CONTRACTOR ROADWAY WORKER PROTECTION" CARD WITH THEM AT ALL TIMES WHILE ON OR ADJACENT TO RAILROAD PROPERTY.

ANY DEBRIS OR DAMAGE RESULTING FROM WORK SHALL BE IMMEDIATELY REPORTED TO THE RAILROAD. RAILROAD SHALL BE REPAIRED BY RAILROAD FORCES AT PROJECT EXPENSE.

NEW CARRIER PIPE WILL NEED TO BE BONDED TO AMTRAK'S RETURN CONDUCTOR. PLEASE PROVIDE SAMPLE DETAILS FOR BONDING. COORDINATE WITH AMTRAK ET IF NEEDED.

EXISTING BONDING AND GROUNDING IS NOT TO BE DISTURBED DURING ANY POINTS OF INSTALLATION. ANY GROUNDING THAT HAS THE POTENTIAL TO BE DISTURBED WILL NEED TO BE REPLACED IN KIND AT THE CONTRACTORS EXPENSE.

ALL WORK SHALL BE CONSISTENT WITH AMTRAK EP3005 SPEC 02081.

BONDING AND GROUNDING OF PIPELINES ON BRIDGES IN ELECTRIFIED TERRITORY

CARRIER PIPE SHALL BE ENCLOSED IN A METAL CASING THAT IS ISOLATED FROM CARRIER PIPE BY APPROVED INSULATORS HAVING A DIELECTRIC VALUE OF NOT LESS THAN 25 KV THAT PROVIDE AN AIR GAP BETWEEN CARRIER PIPE AND CASING OF NOT LESS THAN 2 INCHES, IN ACCORDANCE WITH ANSI OR NESC STANDARDS.

CARRIER PIPE SUPPORTING HANGERS, MOUNTINGS OR CRADLES SHALL PROVIDE AN INSULATION VALUE OF NOT LESS THAN 25 KV AND PROVIDE AN AIR GAP OF NOT LESS THAN 2 INCHES BETWEEN CASING AND ANY PORTION OF MOUNTING ASSEMBLY. CASING SHALL BE BONDED TO AMTRAK'S RETURN CONDUCTOR AT EACH END THROUGH BRIDGE STEEL OR DIRECT WHEN BRIDGE MEMBERS ARE OF NON CONDUCTIVE MATERIAL CONFORMING TO AMTRAK STANDARDS.

THE CASING AND INSTALLATION EQUIPMENT SHALL BE BONDED AND GROUNDED TO AN EARTH GROUND OF NOT MORE THAN 25 OHMS RESISTANCE TO GROUND FOR CONSTRUCTION. THE APPLICANT SHALL MONITOR ADEQUACY OF THE GROUND.

SEAL



RAMIN ABBASZADEH, P.E.
PA LICENSE NO. 38434-E

***** NOTE *****
LUMEN SHALL MAINTAIN
CONDUIT AND FIBER CABLES

3				AS-BUILT
2	02.05.24	BHH	MSH	REVISION # 2
1	09.11.23	BHH	MSH	ORIGINAL
NO.	DATE	ENG DESIGN	DRAFTING	COMMENT

Level(3)
COMMUNICATIONS

LEVEL 3 ENGINEER:	Richard Williams (717) 917 - 6434
ENGINEERING FIRM:	Precision Fiber Design, LLC
PROJECT NUMBER:	P.009109
LOCATION:	SR 2031 NORTH SWARTHMORE AVENUE RIDLEY PARK, PA 19078
DRAWING NAME:	SR 2031 N Swarthmore Ave, Ridley Park, PA 19078 Amtrak_Rev 1_10.10.23.dwg

LEGEND

LINETYPES

	RIGID PIPE – PROPOSED w/ (3) PROPOSED CORR. ID & OSP FOC
	FENCE
	RIGHT OF WAY
	PROPERTY LINE
	EDGE OF PAVEMENT
	GUARDRAIL
	HANDRAIL
	EXISTING AERIAL NETWORK

ABBR.	DESCRIPTION
CORR	CORRUGATED
CSW	CONCRETE SIDEWALK
EOP	EDGE OF PAVEMENT
FOC	FIBER OPTIC CABLE
HDPE	HIGH DENSITY POLYETHYLENE
ID	INNER-DUCT
R/W	RIGHT OF WAY
STA.	STATION

	FIRE HYDRANT
	STREET LIGHT
	TRAFFIC LIGHT
	UTILITY POLE
	DOWN GUY – EXISTING
	SIGN (NO POWER)
	SIGN (POWER)
	SIGNS w/ POSTS
	TREE / BUSHES

	CABLE FIBERS: FIBERS CABLE OWNER: LEVEL3 CABLE LENGTH: LENGTH NOTES:	CABLE SPAN CALLOUT – EXISTING FOR USE ON PAPER SPACE (SHOWN AT 50X)
	CONDUIT OWNER: LEVEL3 CONDUIT LENGTH: LENGTH CONDUIT QTY: CONDUITS CONDUIT SIZE: SIZE CONDUIT TYPE: TYPE INNER DUCT QTY: INNERDUCTS INNER DUCT SIZE: SIZE INNER DUCT TYPE: TYPE NOTES:	CONDUIT CALLOUT – PROPOSED FOR USE ON PAPER SPACE (SHOWN AT 50X) WITH OR WITHOUT INNER DUCT INFO

***** NOTE *****
LUMEN SHALL MAINTAIN
CONDUIT AND FIBER CABLES



RAMIN ABBASZADEH, P.E.
PA LICENSE NO. 38434-E

NO.	DATE	ENG DESIGN	DRAFTING	COMMENT
3				AS-BUILT
2	02.05.24	BHH	MSH	REVISION # 2
1	09.11.23	BHH	MSH	ORIGINAL



LEVEL 3 ENGINEER:	Richard Williams (717) 917 - 6434
ENGINEERING FIRM:	Precision Fiber Design, LLC
PROJECT NUMBER:	P.009109
LOCATION:	SR 2031 NORTH SWARTHMORE AVENUE RIDLEY PARK, PA 19078
DRAWING NAME:	SR 2031 N Swarthmore Ave, Ridley Park, PA 19078_Amtrak_Rev 1_10.10.23.dwg



N SWARTHMORE BRIDGE PLAN

CONSTRUCTION NOTES

- 1 CONDUIT OWNER: LEVEL 3
- CONDUIT LENGTH: ±170 FT
- CONDUIT QTY: (1)
- CONDUIT SIZE: 4.00"
- CONDUIT TYPE: RIGID PIPE
- INNER DUCT QTY: (3)
- INNER DUCT SIZE: 1.25"
- INNER DUCT TYPE: CORRUGATED HDPE
- NOTES: FURNISH & INSTALL ±170 FT PROPOSED RIGID PIPE & CORRUGATED ID ALONG BRIDGE PARAPET

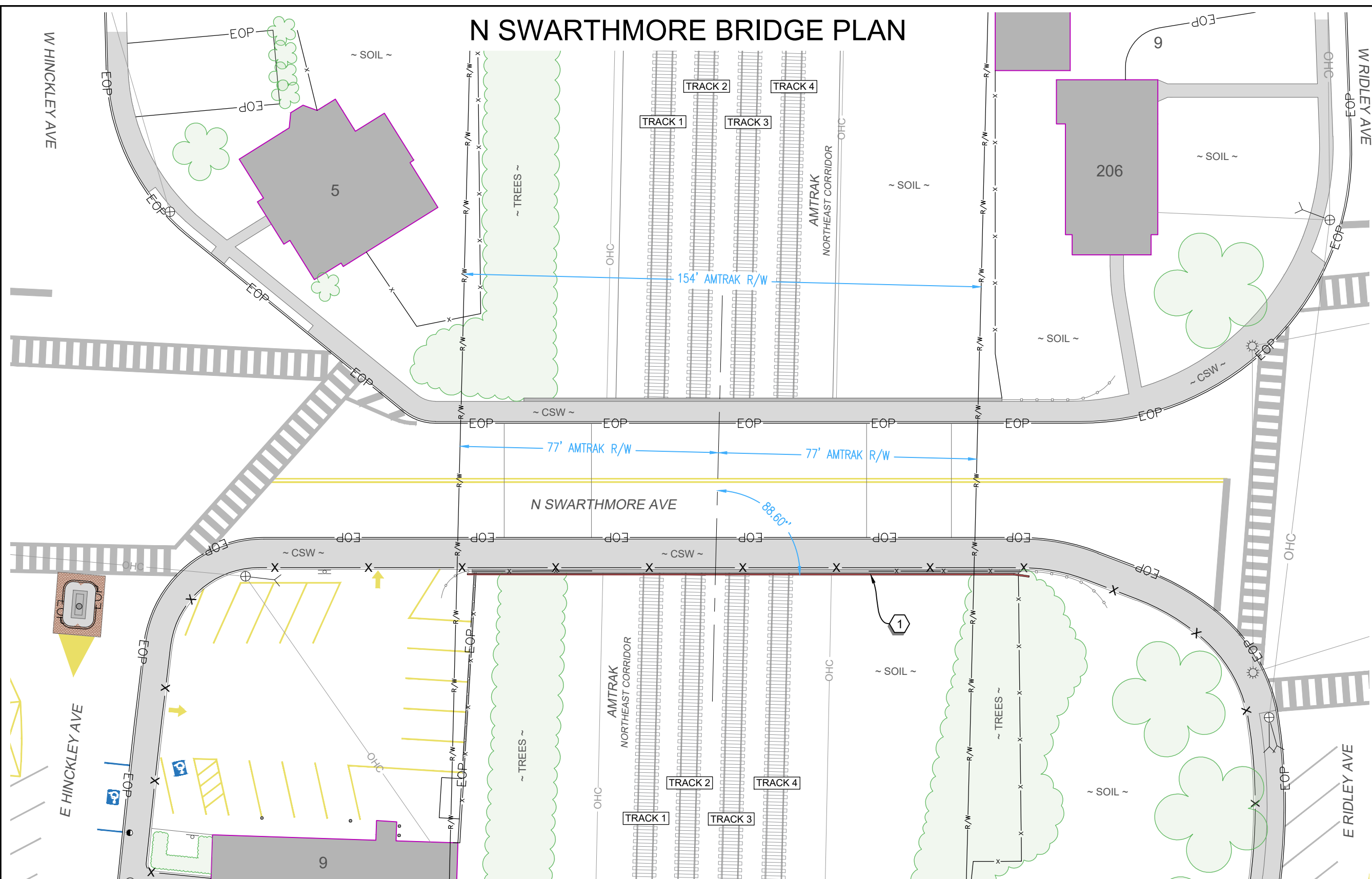

RAMIN ABBASZADEH, P.E.
PA LICENSE NO. 38434-E

***** NOTE *****
LUMEN SHALL MAINTAIN
CONDUIT AND FIBER CABLES

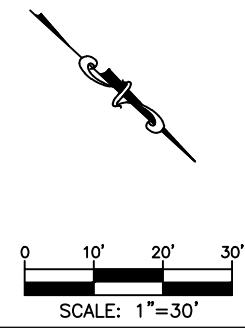

3				AS-BUILT
2	02.05.24	BHH	MSH	REVISION # 2
1	09.11.23	BHH	MSH	ORIGINAL
NO.	DATE	ENG DESIGN	DRAFTING	COMMENT

Level(3)
COMMUNICATIONS

LEVEL 3 ENGINEER: Richard Williams (717) 917 - 6434
 ENGINEERING FIRM: Precision Fiber Design, LLC
 PROJECT NUMBER: P.009109
 LOCATION: SR 2031 NORTH SWARTHMORE AVENUE
 RIDLEY PARK, PA 19078
 DRAWING NAME: SR 2031 N Swarthmore Ave, Ridley Park, PA
 19078 Amtrak_Rev 1_10.10.23.dwg

N SWARTHMORE BRIDGE PROFILE (1)

CONSTRUCTION NOTES

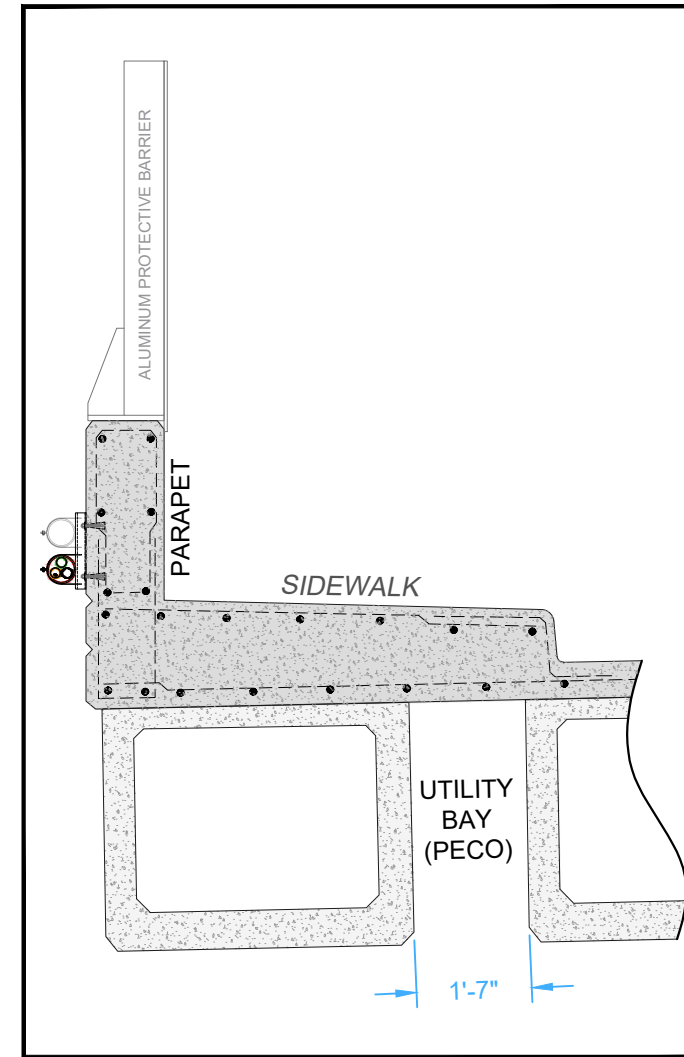
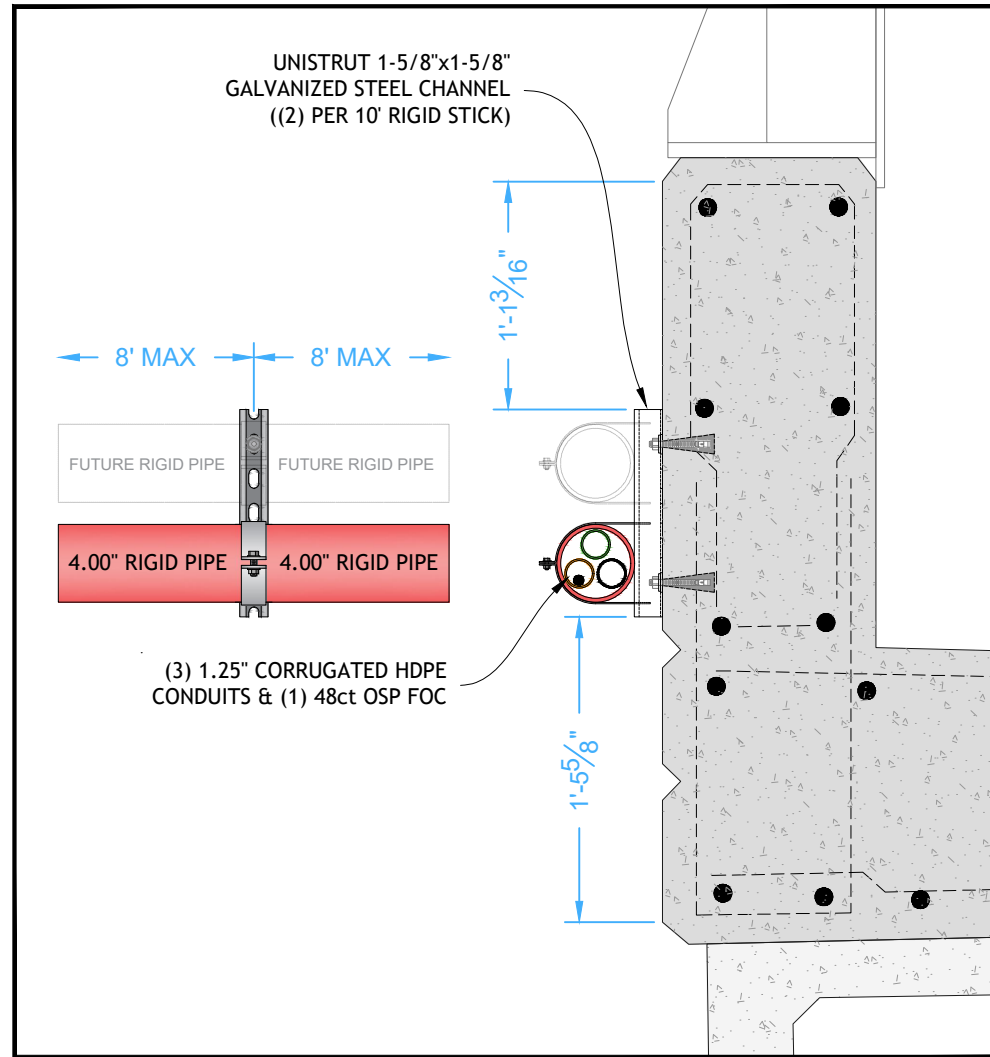
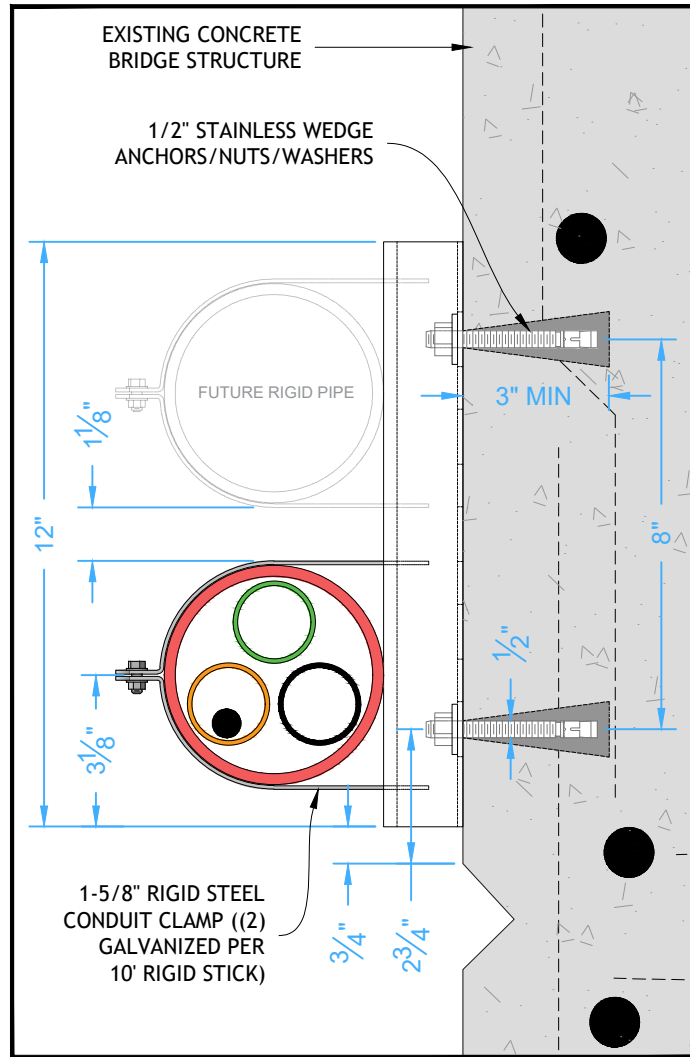

- 1 CONDUIT OWNER: LEVEL 3
- CONDUIT LENGTH: ±170 FT
- CONDUIT QTY: (1)
- CONDUIT SIZE: 4.00"
- CONDUIT TYPE: RIGID PIPE
- INNER DUCT QTY: (3)
- INNER DUCT SIZE: 1.25"
- INNER DUCT TYPE: CORRUGATED HDPE
- NOTES: FURNISH & INSTALL ±170 FT PROPOSED RIGID PIPE & CORRUGATED ID ALONG BRIDGE PARAPET

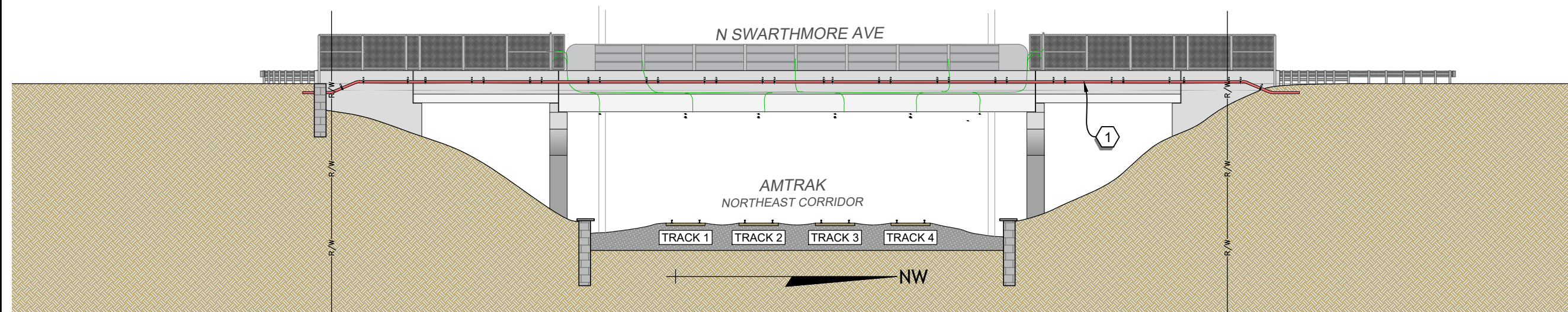

SEAL

RAMIN ABBASZADEH, P.E.
PA LICENSE NO. 38434-E

***** NOTE *****
LUMEN SHALL MAINTAIN
CONDUIT AND FIBER CABLES

3				AS-BUILT
2	02.05.24	BHH	MSH	REVISION # 2
1	09.11.23	BHH	MSH	ORIGINAL
NO.	DATE	ENG DESIGN	DRAFTING	COMMENT



LEVEL 3 ENGINEER: Richard Williams (717) 917 - 6434
ENGINEERING FIRM: Precision Fiber Design, LLC
PROJECT NUMBER: P.009109
LOCATION: SR 2031 NORTH SWARTHMORE AVENUE
RIDLEY PARK, PA 19078
DRAWING NAME: SR 2031 N Swarthmore Ave, Ridley Park, PA
19078 Amtrak_Rev 1_10.10.23.dwg

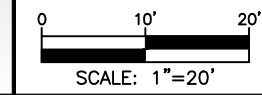

N SWARTHMORE BRIDGE PROFILE (2)

CONSTRUCTION NOTES

- 1 CONDUIT OWNER: LEVEL 3
- CONDUIT LENGTH: ±170 FT
- CONDUIT QTY: (1)
- CONDUIT SIZE: 4.00"
- CONDUIT TYPE: RIGID PIPE
- INNER DUCT QTY: (3)
- INNER DUCT SIZE: 1.25"
- INNER DUCT TYPE: CORRUGATED HDPE
- NOTES: FURNISH & INSTALL ±170 FT PROPOSED RIGID PIPE & CORRUGATED ID ALONG BRIDGE PARAPET

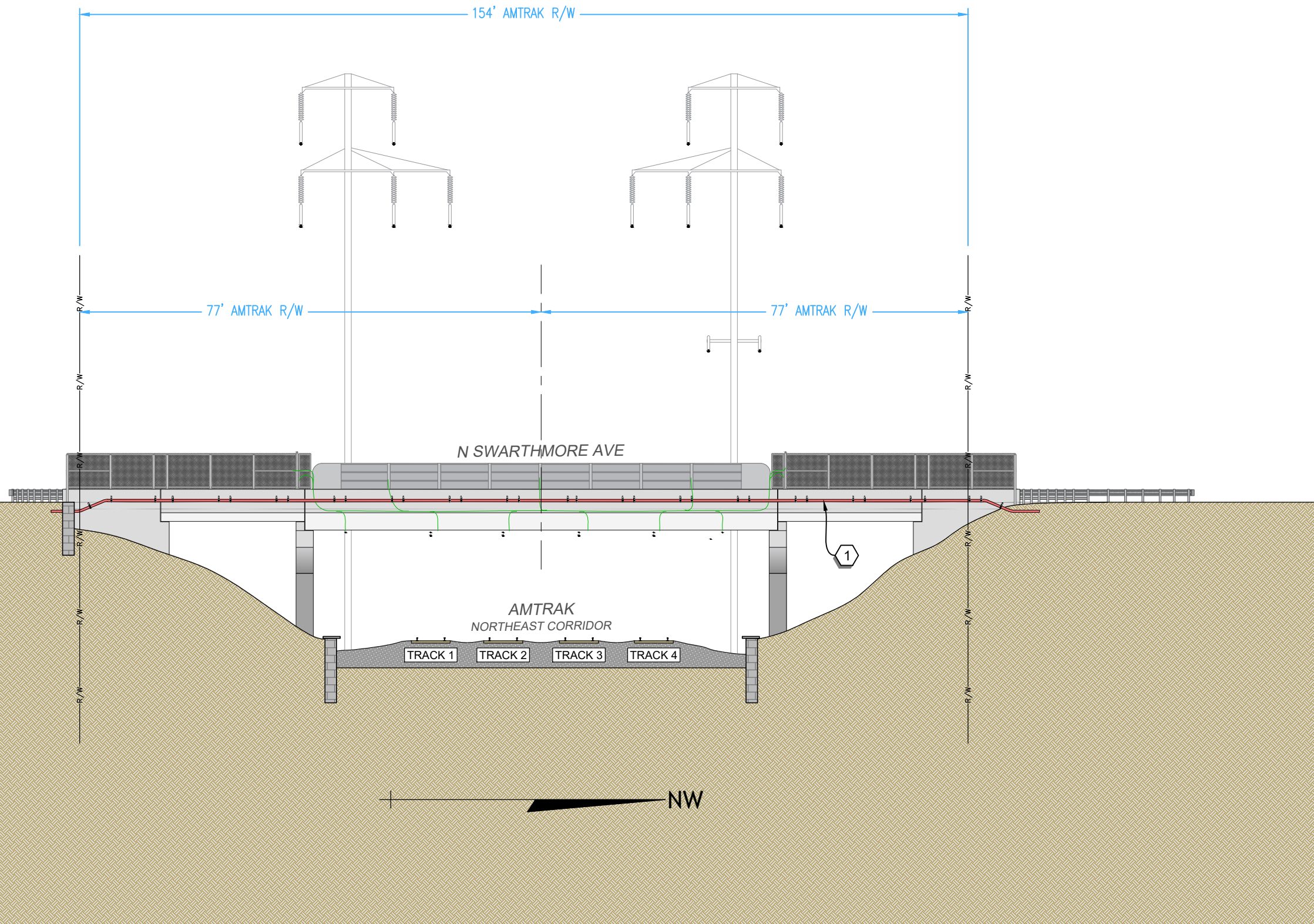

SEAL



RAMIN ABBASZADEH, P.E.
PA LICENSE NO. 38434-E

***** NOTE *****
LUMEN SHALL MAINTAIN
CONDUIT AND FIBER CABLES

3				AS-BUILT
2	02.05.24	BHH	MSH	REVISION # 2
1	09.11.23	BHH	MSH	ORIGINAL
NO.	DATE	ENG DESIGN	DRAFTING	COMMENT



LEVEL 3 ENGINEER: Richard Williams (717) 917 - 6434
 ENGINEERING FIRM: Precision Fiber Design, LLC
 PROJECT NUMBER: P.009109
 LOCATION: SR 2031 NORTH SWARTHMORE AVENUE
 RIDLEY PARK, PA 19078
 DRAWING NAME: SR 2031 N Swarthmore Ave, Ridley Park, PA
 19078 Amtrak_Rev 1_10.10.23.dwg

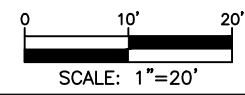

ENLARGED N SWARTHMORE BRIDGE PROFILE (1)

CONSTRUCTION NOTES

- 1 CONDUIT OWNER: LEVEL 3
- CONDUIT LENGTH: ±170 FT
- CONDUIT QTY: (1)
- CONDUIT SIZE: 4.00"
- CONDUIT TYPE: RIGID PIPE
- INNER DUCT QTY: (3)
- INNER DUCT SIZE: 1.25"
- INNER DUCT TYPE: CORRUGATED HDPE
- NOTES: FURNISH & INSTALL ±170 FT PROPOSED RIGID PIPE & CORRUGATED ID ALONG BRIDGE PARAPET

MATCH TO SHEET 8

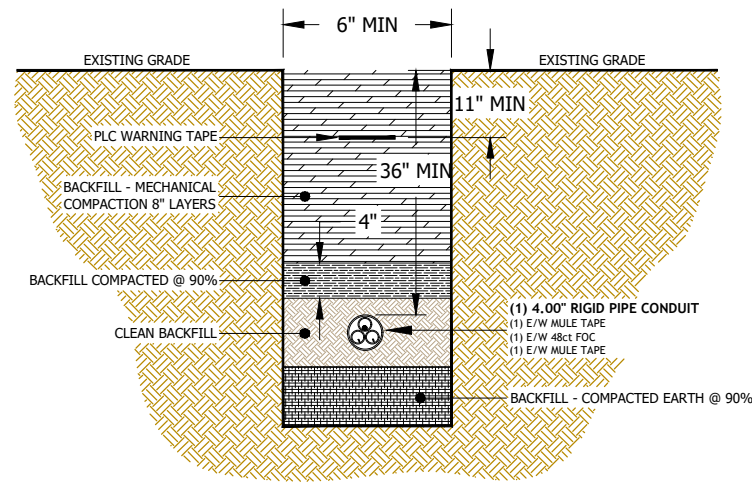
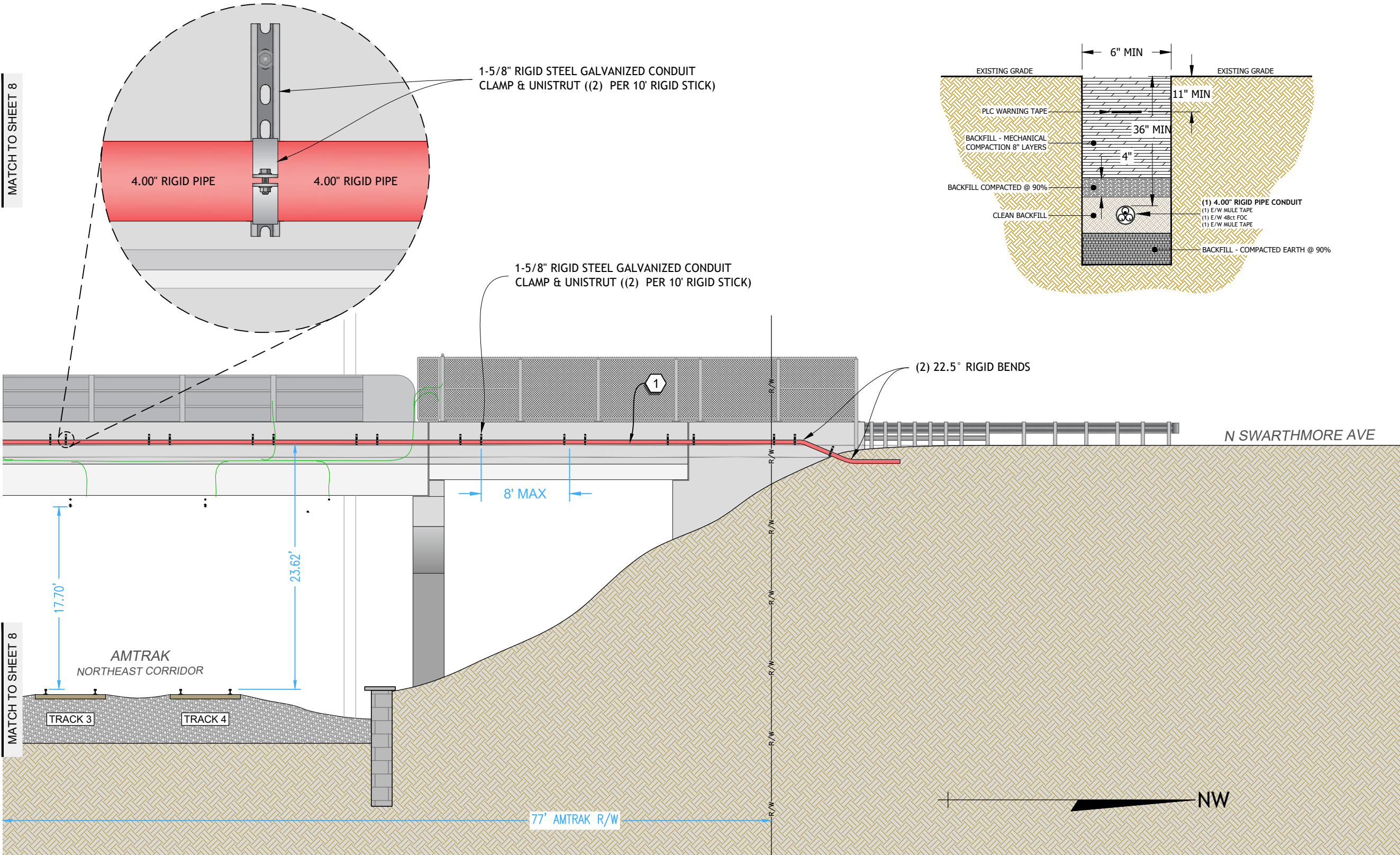

MATCH TO SHEET 8

SEAL



RAMIN ABBASZADEH, P.E.
PA LICENSE NO. 38434-E

***** NOTE *****
LUMEN SHALL MAINTAIN
CONDUIT AND FIBER CABLES

3				AS-BUILT
2	02.05.24	BHH	MSH	REVISION # 2
1	09.11.23	BHH	MSH	ORIGINAL
NO.	DATE	ENG DESIGN	DRAFTING	COMMENT



LEVEL 3 ENGINEER: Richard Williams (717) 917 - 6434
 ENGINEERING FIRM: Precision Fiber Design, LLC
 PROJECT NUMBER: P.009109
 LOCATION: SR 2031 NORTH SWARTHMORE AVENUE
 RIDLEY PARK, PA 19078
 DRAWING NAME: SR 2031 N Swarthmore Ave, Ridley Park, PA
 19078_Amtrak_Rev 1_10.10.23.dwg

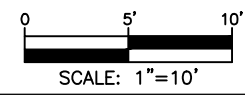

ENLARGED N SWARTHMORE BRIDGE PROFILE (2)

CONSTRUCTION NOTES

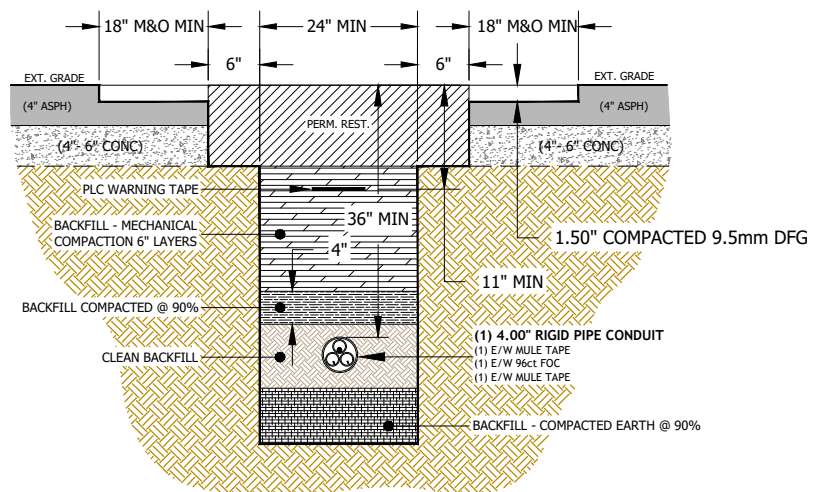

1-5/8" RIGID STEEL GALVANIZED CONDUIT CLAMP & UNISTRUT ((2) PER 10' RIGID STICK)

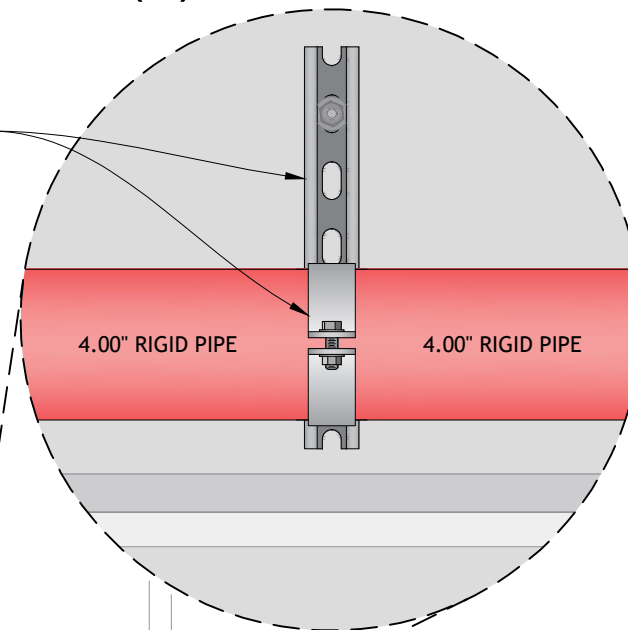

MATCH TO SHEET 7

- 1 CONDUIT OWNER: LEVEL 3
- CONDUIT LENGTH: ±170 FT
- CONDUIT QTY: (1)
- CONDUIT SIZE: 4.00"
- CONDUIT TYPE: RIGID PIPE
- INNER DUCT QTY: (3)
- INNER DUCT SIZE: 1.25"
- INNER DUCT TYPE: CORRUGATED HDPE
- NOTES: FURNISH & INSTALL ±170 FT PROPOSED RIGID PIPE & CORRUGATED ID ALONG BRIDGE PARAPET

1-5/8" RIGID STEEL GALVANIZED CONDUIT CLAMP & UNISTRUT ((2) PER 10' RIGID STICK)

(2) 22.5° RIGID BENDS

N SWARTHMORE AVE

8' MAX

23.62'

17.60'

AMTRAK
NORTHEAST CORRIDOR

TRACK 1

TRACK 2

MATCH TO SHEET 7

77' AMTRAK R/W



SEAL



RAMIN ABBASZADEH, P.E.
PA LICENSE NO. 38434-E

***** NOTE *****
LUMEN SHALL MAINTAIN
CONDUIT AND FIBER CABLES

3				AS-BUILT
2	02.05.24	BHH	MSH	REVISION # 2
1	09.11.23	BHH	MSH	ORIGINAL
NO.	DATE	ENG DESIGN	DRAFTING	COMMENT



LEVEL 3 ENGINEER: Richard Williams (717) 917 - 6434
 ENGINEERING FIRM: Precision Fiber Design, LLC
 PROJECT NUMBER: P.009109
 LOCATION: SR 2031 NORTH SWARTHMORE AVENUE
 RIDLEY PARK, PA 19078
 DRAWING NAME: SR 2031 N Swarthmore Ave, Ridley Park, PA
 19078_Amtrak_Rev 1_10.10.23.dwg

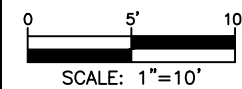

E WARD AVE / E SELLERS AVE BRIDGE PLAN

CONSTRUCTION NOTES

- 2 EXISTING AERIAL NETWORK (48ct BACKBONE):
 DELASH ±152 FT EXISTING 48ct AERIAL FOC (BETWEEN PECO POLE 96 & PECO POLE 277) UPON CUTTING THE EXISTING CABLE NEAR BOTH PROPOSED SPLICE LOCATIONS
 - REMOVE / DISPOSE OF EXISTING AERIAL STRAND & POLE HARDWARE

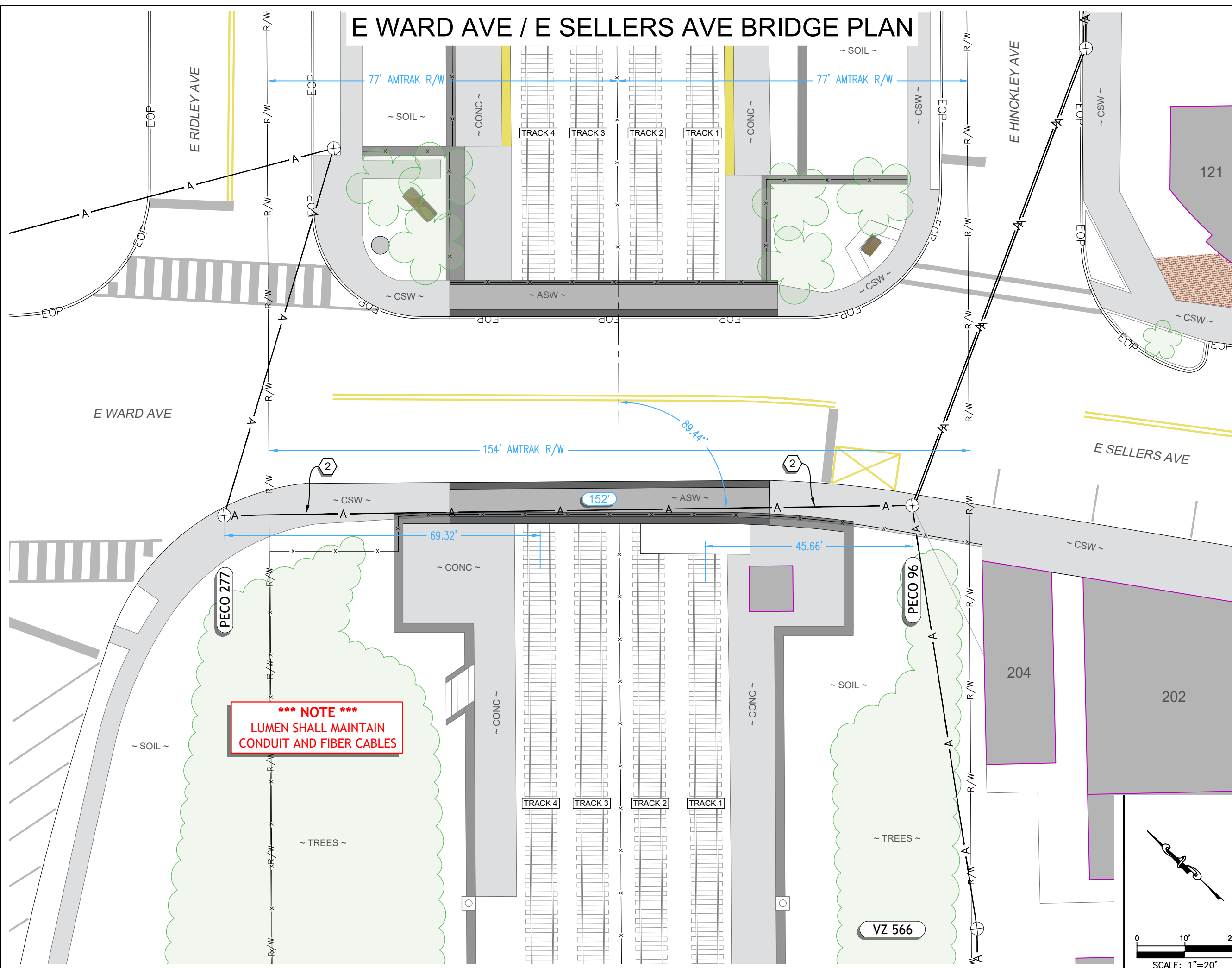

***** NOTE *****
 LUMEN SHALL MAINTAIN
 CONDUIT AND FIBER CABLES

SEAL



RAMIN ABBASZADEH, P.E.
 PA LICENSE NO. 38434-E

3				AS-BUILT
2	02.05.24	BHH	MSH	REVISION # 2
1	09.11.23	BHH	MSH	ORIGINAL
NO.	DATE	ENG DESIGN	DRAFTING	COMMENT



LEVEL 3 ENGINEER: Richard Williams (717) 917 - 6434
 ENGINEERING FIRM: Precision Fiber Design, LLC
 PROJECT NUMBER: P.009109
 LOCATION: SR 2031 NORTH SWARTHMORE AVENUE
 RIDLEY PARK, PA 19078
 DRAWING NAME: SR 2031 N Swarthmore Ave, Ridley Park, PA
 19078 Amtrak_Rev 1_10.10.23.dwg

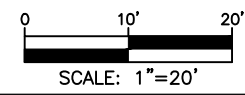

E WARD AVE / E SELLERS AVE BRIDGE PROFILE

CONSTRUCTION NOTES

- 2 EXISTING AERIAL NETWORK (48ct BACKBONE):
 DELASH ±152 FT EXISTING 48ct AERIAL FOC (BETWEEN PECO POLE 96 & PECO POLE 277) UPON CUTTING THE EXISTING CABLE NEAR BOTH PROPOSED SPLICE LOCATIONS
 - REMOVE / DISPOSE OF EXISTING AERIAL STRAND & POLE HARDWARE

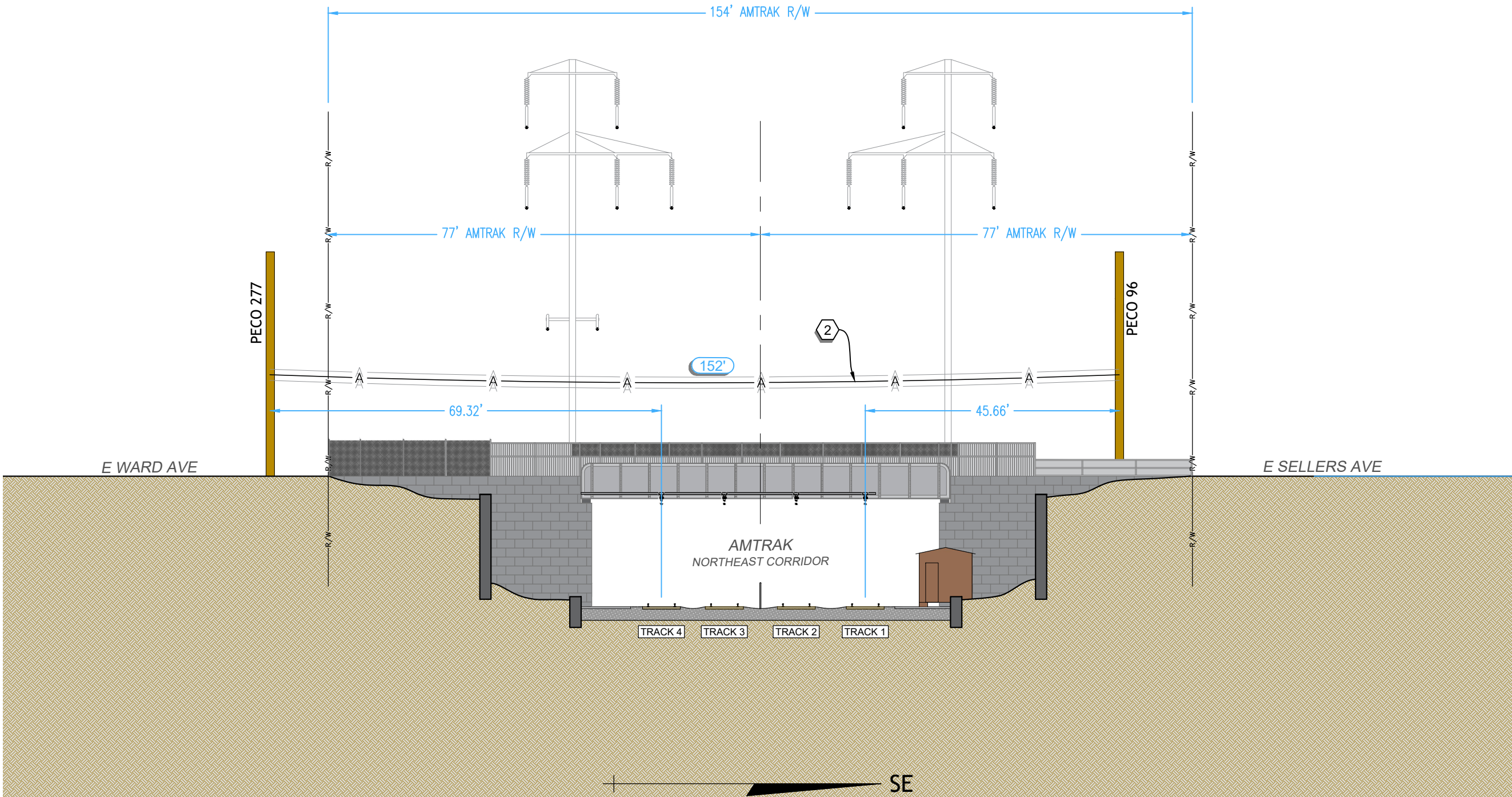

SEAL

Professional Engineer Seal for Ramin Abbaszadeh, P.E., License No. 38434-E. The seal includes the text 'COMMONWEALTH OF PENNSYLVANIA', 'REGISTERED PROFESSIONAL ENGINEER', and '3044E'.

RAMIN ABBASZADEH, P.E.
 PA LICENSE NO. 38434-E

***** NOTE *****
 LUMEN SHALL MAINTAIN
 CONDUIT AND FIBER CABLES

3				AS-BUILT
2	02.05.24	BHH	MSH	REVISION # 2
1	09.11.23	BHH	MSH	ORIGINAL
NO.	DATE	ENG DESIGN	DRAFTING	COMMENT



LEVEL 3 ENGINEER: Richard Williams (717) 917 - 6434
 ENGINEERING FIRM: Precision Fiber Design, LLC
 PROJECT NUMBER: P.009109
 LOCATION: SR 2031 NORTH SWARTHMORE AVENUE
 RIDLEY PARK, PA 19078
 DRAWING NAME: SR 2031 N Swarthmore Ave, Ridley Park, PA
 19078_Amtrak_Rev 1_10.10.23.dwg

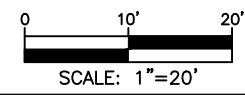

ENLARGED E WARD AVE / E SELLERS AVE BRIDGE PROFILE

CONSTRUCTION NOTES

- 2 EXISTING AERIAL NETWORK (48ct BACKBONE):
 DELASH ±152 FT EXISTING 48ct AERIAL FOC (BETWEEN PECO POLE 96 & PECO POLE 277) UPON CUTTING THE EXISTING CABLE NEAR BOTH PROPOSED SPLICE LOCATIONS
 - REMOVE / DISPOSE OF EXISTING AERIAL STRAND & POLE HARDWARE

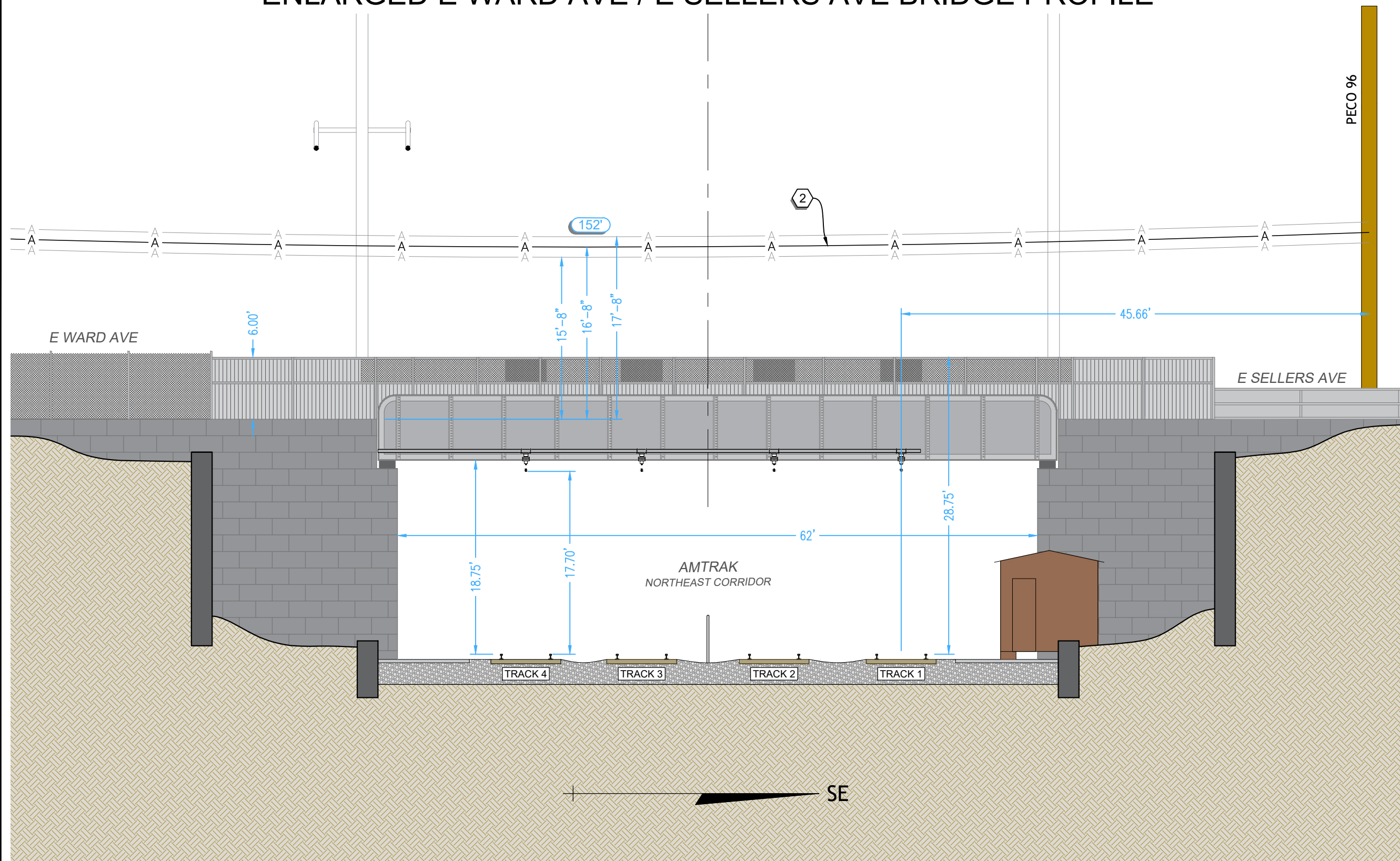

SEAL

RAMIN ABBASZADEH, P.E.
 PA LICENSE NO. 38434-E

***** NOTE *****
 LUMEN SHALL MAINTAIN
 CONDUIT AND FIBER CABLES

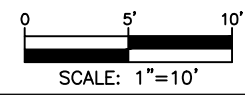

3				AS-BUILT
2	02.05.24	BHH	MSH	REVISION # 2
1	09.11.23	BHH	MSH	ORIGINAL
NO.	DATE	ENG DESIGN	DRAFTING	COMMENT

Level 3
 COMMUNICATIONS

LEVEL 3 ENGINEER: Richard Williams (717) 917 - 6434
 ENGINEERING FIRM: Precision Fiber Design, LLC
 PROJECT NUMBER: P.009109
 LOCATION: SR 2031 NORTH SWARTHMORE AVENUE
 RIDLEY PARK, PA 19078
 DRAWING NAME: SR 2031 N Swarthmore Ave, Ridley Park, PA
 19078_Amtrak_Rev 1_10.10.23.dwg

SHEET: 11 OF 11