

**BEFORE**

**PENNSYLVANIA PUBLIC UTILITY COMMISSION**

---

In re: Application of PPL Electric Utilities for approval of the alteration of utility facilities in the area of the crossing between 249652L and 249654A where Poplar St crosses at grade the tracks of Delaware Lackawanna Railroad, located in Scranton City in Lackawanna County.

Application

Docket No.

To Pennsylvania Public Utility Commission:

1. The name and address of applicant are: PPL Electric Utilities Corporation  
650 Hamilton St - Suite 601  
Allentown, PA 18101
2. The name and address of the applicant's attorney are Mallory Jane Sweeney, Associate General Counsel, PPL Electric Utilities Corporation, Two North Ninth Street, Allentown, PA 18101-1179.

3. PPL Electric Utilities wishes to replace one existing pole in Scranton City, Lackawanna County, PA. To support existing and future loading conditions. Aerial cables that cross Delaware Lackawanna Railroad rails within the public right-of-way of Poplar St are to be raised to meet clearance requirements. The above ground communication facilities to be altered are on PPL pole #57388N46432.
  
4. The proposed construction will be the raising of existing power facilities across the railroad crossing and the replacement of an existing anchor. The communication facility will be aerial. Poplar St intersects the railroad at grade. See attached Exhibit "A". The estimated completion date for this project is August 20th, 2024.
  
5. The public utilities, municipalities, corporations and property owners concerned in, or affected by, the crossing alteration are identified in Exhibit "B" attached hereto
  
6. The expected cost for the construction procedure is \$10,000. PPL Electric Utilities will pay all costs of construction of the utility pole replacements, In addition to being responsible for installing, maintaining and inspecting the facilities.
  
7. The alteration is necessary or proper for the following reasons: to provide adequate, efficient, and reasonable communication facilities and power to the public in Lackawanna County and surrounding areas.

Wherefore, applicant prays your Honorable Commission to approve the application:

*Dustin Stockholm*  
(Signature of Applicant)

**§ 1.36. Verification.**

(a) Applications, petitions, formal complaints, motions and answers thereto containing an averment of fact not appearing of record in the action or containing a denial of fact shall be personally verified by a party thereto or by an authorized officer of the party if a corporation or association. Verification means a signed written statement of fact supported by oath or affirmation or made subject to the penalties of 18 Pa. C.S. §4904 (relating to unsworn falsification to authorities). If verification is required, notarization is not necessary.

(b) The Verification form should comply substantially with the following:

**VERIFICATION**

I, Dustin Stockholm, hereby state that the facts above set forth are true and correct (or are true and correct to the best of my knowledge, information and belief) and that I expect to be able to prove the same at a hearing held in this matter. I understand that the statements herein are made subject to the penalties of 18 Pa. C.S. § 4904 (relating to unsworn falsification to authorities).

Date: May 28, 2024

Dustin Stockholm

(Signature)

CERTIFICATE OF SERVICE

I hereby certify that I have this day served a true copy of the foregoing document upon the participants, listed below, in accordance with the requirements of § 1.54 (relating to service by participant) .

Mark Chappel, P.E. - Chief  
Bureau of Project Delivery  
P.O. Box 3362  
Harrisburg, PA 17105-3362  
marchappel@pa.gov

Karen Cummings - Office of Chief Counsel  
PennDOT  
P.O. Box 8212  
Harrisburg, PA 17105-8212  
kcummings@pa.gov

PennDOT Engineering District 4  
Sue Fenton  
55 Keystone Industrial Park Rd  
Dunmore, PA 18512  
sfenton@pa.gov

Lackawanna County  
Attn: Permits/Public works  
123 Wyoming Avenue  
Scranton PA, 18503  
lukasikl@lackawannacounty.org

CTSI-Frontier  
Mary Rodman  
100 CTE Drive  
Dallas, PA 18612

North Penn Long Distance Corporation  
ATTN:Empire/North Penn Telephone  
34 Main Street  
Plattsburgh, NY 14873  
ospeng@etcnpt

Teleport Communications America LLC (formerly TCG  
Delaware)  
900 Old Marple Rd  
Springfield, PA 19064

Delaware and Lackawanna Railroad  
280 Cliff St  
Scranton, PA 18503  
cdoyle@pnrra.org

Comcast  
Jim Hall  
1 Comcast Way  
Duryea, PA 18642  
James\_Hall3@cable.comcast.com

Verizon  
Attn: Engineering/Permitting  
1026 Hay St  
Wilkinsburg, PA 15221  
poleconduitadmin1@verizon.com

Gigapower LLC  
4200 Corning Place  
Charlotte, NC 28216  
NinemireDL@corning.com,  
Michael.Annunziata @gigapower.com,  
rich.rehak@gigapower.com

Clty of Scranton  
ATTN: Department of Public Works Director  
101 W Poplar St  
Scranton, PA 18509  
(spietreface@scrantonpa.gov, mfetsock@scrantonpa.gov)

Dustin Stockholm  
PPL Electric Utilities Corp  
165 Beach Lake Highway  
Honesdale, PA 18431  
Dstockholm@pplweb.com

Dated this 28th day of

*Dustin Stockholm*

(Signature)

May, 2024.

## EXHIBIT "B"

The public utilities, municipalities, corporations, and property owners concerned in, or affected by, the crossing alteration are:

Mark Chappel, P.E. - Chief  
Bureau of Project Delivery  
P.O. Box 3362  
Harrisburg, PA 17105-3362  
marchappel@pa.gov

Karen Cummings - Office of Chief Counsel  
PennDOT  
P.O. Box 8212  
Harrisburg, PA 17105-8212  
kcummings@pa.gov

PennDOT Engineering District 4  
Sue Fenton  
55 Keystone Industrial Park Rd  
Dunmore, PA 18512  
sfenton@pa.gov

Lackawanna County  
Attn: Permits/Public works  
123 Wyoming Avenue  
Scranton PA, 18503  
lukasikl@lackawannacounty.org

CTSI-Frontier  
Mary Rodman  
100 CTE Drive  
Dallas, PA 18612

North Penn Long Distance Corporation  
ATTN:Empire/North Penn Telephone  
34 Main Street  
Plattsburgh, NY 14873  
ospeng@etcnpt

Dustin Stockholm  
PPL Electric Utilities Corp.  
165 Beach Lake Highway  
Honesdale, PA 18431

Dstockholm@pplweb.com

Teleport Communications America LLC (formerly TCG  
Delaware)  
900 Old Marple Rd  
Springfield, PA 19064

Delaware and Lackawanna Railroad  
Attn: Engineering/Permitting  
280 Cliff St  
Scranton, PA 18503  
cdoyle@pnrra.org

Comcast  
Jim Hall  
1 Comcast Way  
Duryea, PA 18642  
James\_Hall3@cable.comcast.com

Verizon  
Attn: Engineering/Permitting  
1026 Hay St  
Wilkesburg, PA 15221  
poleconduitadmin1@verizon.com

Gigapower LLC  
4200 Corning Place  
Charlotte, NC 28216  
[NinemireDL@corning.com](mailto:NinemireDL@corning.com),  
Michael.Annunziata@gigapower.com,  
rich.rehak@gigapower.com

City of Scranton  
ATTN: Department of Public Works Director  
101 W Poplar St  
Scranton, PA 18509  
(spietreface@scrantonpa.gov, mfetsock@scrantonpa.gov)

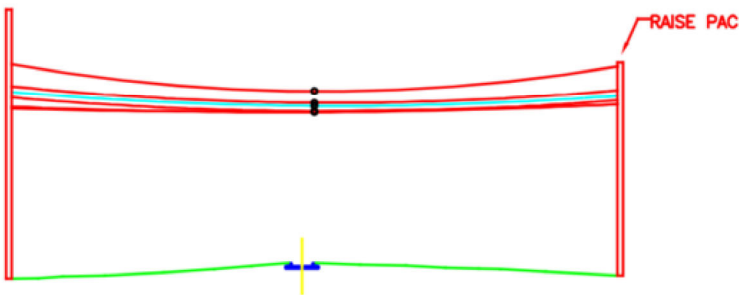
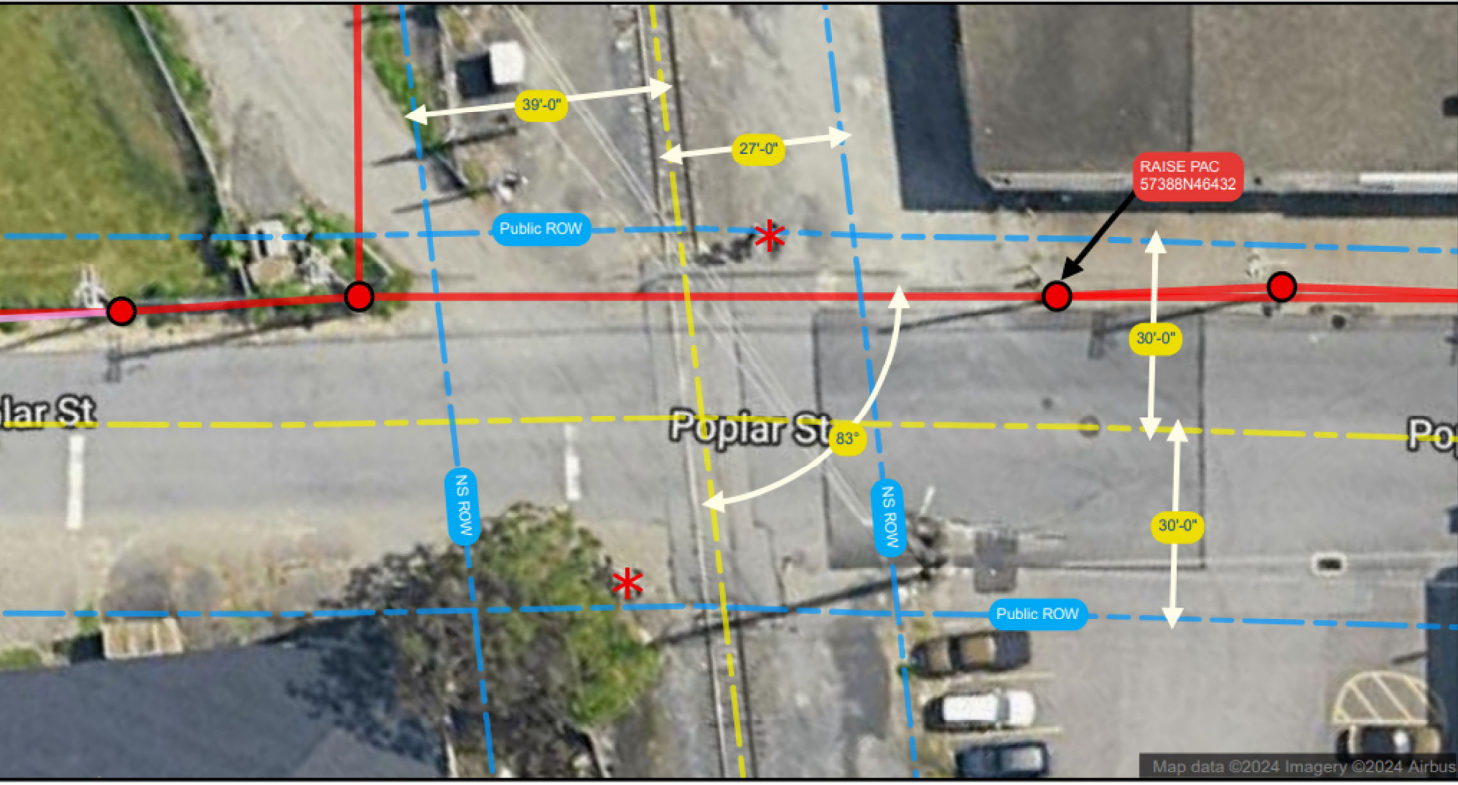

EXISTING HEIGHTS	PROPOSED HEIGHTS
BUNDLED PRIMARY 31'-2"	30'-8"
COM 29'-0"	28'-6"
PROPOSED COM	28'-5"
COM 27'-5"	27'-5"
COM 27'-5"	27'-5"
COM 27'-3"	27'-3"

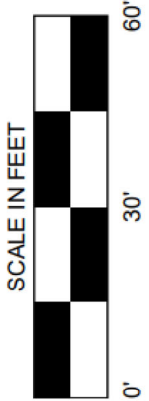

- Right of way line
- Center line
- Aerial
- RxR Signal
- Anchor
- Pole



**ppil**  
PPL Electric Utilities

REPAIRED BY:



TITLE: 306479	CITY: Scranton
PROJECT NO:	COUNTY: Lackawanna
PRINT NO: 1	STATE: Pennsylvania
NO. OF PRINTS: 1	DATE: 08-May-2024
ENGINEERED BY: KATAPULT	DRAWN BY: STEM
FILENAME: EXHIBIT A	

# U. S. DOT CROSSING INVENTORY FORM

**DEPARTMENT OF TRANSPORTATION**  
FEDERAL RAILROAD ADMINISTRATION

OMB No. 2130-0017

Instructions for the initial reporting of the following types of new or previously unreported crossings: For public highway-rail grade crossings, complete the entire inventory Form. For private highway-rail grade crossings, complete the Header, Parts I and II, and the Submission Information section. For public pathway grade crossings (including pedestrian station grade crossings), complete the Header, Parts I and II, and the Submission Information section. For Private pathway grade crossings, complete the Header, Parts I and II, and the Submission Information section. For grade-separated highway-rail or pathway crossings (including pedestrian station crossings), complete the Header, Part I, and the Submission Information section. For changes to existing data, complete the Header, Part I Items 1-3, and the Submission Information section, in addition to the updated data fields. Note: For private crossings only, Part I Item 20 and Part III Item 2.K. are required unless otherwise noted. An asterisk \* denotes an optional field.

<b>A. Revision Date</b> (MM/DD/YYYY) 03 / 10 / 2020	<b>B. Reporting Agency</b> <input checked="" type="checkbox"/> Railroad <input type="checkbox"/> Transit <input type="checkbox"/> State <input type="checkbox"/> Other	<b>C. Reason for Update (Select only one)</b> <input checked="" type="checkbox"/> Change in Data <input type="checkbox"/> Re-Open <input type="checkbox"/> New Crossing <input type="checkbox"/> Date Change Only <input type="checkbox"/> Closed <input type="checkbox"/> Change in Primary Operating RR <input type="checkbox"/> No Train Traffic <input type="checkbox"/> Quiet Zone Update <input type="checkbox"/> Admin. Correction	<b>D. DOT Crossing Inventory Number</b> 249652L
---	--	--	--

## Part I: Location and Classification Information

<b>1. Primary Operating Railroad</b> DELAWARE LACKAWANNA RAILROAD [DL]		<b>2. State</b> PENNSYLVANIA		<b>3. County</b> LACKAWANNA	
<b>4. City / Municipality</b> <input checked="" type="checkbox"/> In <input type="checkbox"/> Near SCRANTON		<b>5. Street/Road Name &amp; Block Number</b> GLENN ST (Street/Road Name)   * (Block Number)		<b>6. Highway Type &amp; No.</b> City	
<b>7. Do Other Railroads Operate a Separate Track at Crossing?</b> <input type="checkbox"/> Yes <input checked="" type="checkbox"/> No If Yes, Specify RR			<b>8. Do Other Railroads Operate Over Your Track at Crossing?</b> <input checked="" type="checkbox"/> Yes <input type="checkbox"/> No If Yes, Specify RR SNCX		
<b>9. Railroad Division or Region</b> <input checked="" type="checkbox"/> None		<b>10. Railroad Subdivision or District</b> <input checked="" type="checkbox"/> None		<b>11. Branch or Line Name</b> <input type="checkbox"/> None CARBONDALE MAIN	
<b>12. RR Milepost</b> 0004.50 (prefix)   (nnnn.nnn)   (suffix)		<b>13. Line Segment</b> *		<b>14. Nearest RR Timetable Station</b> * GREEN RIDGE	
<b>15. Parent RR (if applicable)</b> <input type="checkbox"/> N/A DL		<b>16. Crossing Owner (if applicable)</b> <input type="checkbox"/> N/A LCRA		<b>17. Crossing Type</b> <input checked="" type="checkbox"/> Public <input type="checkbox"/> Private	
<b>18. Crossing Purpose</b> <input checked="" type="checkbox"/> Highway <input type="checkbox"/> Pathway, Ped. <input type="checkbox"/> Station, Ped.		<b>19. Crossing Position</b> <input checked="" type="checkbox"/> At Grade <input type="checkbox"/> RR Under <input type="checkbox"/> RR Over		<b>20. Public Access (if Private Crossing)</b> <input type="checkbox"/> Yes <input checked="" type="checkbox"/> No	
<b>21. Type of Train</b> <input checked="" type="checkbox"/> Freight <input type="checkbox"/> Intercity Passenger <input type="checkbox"/> Commuter		<input type="checkbox"/> Transit <input type="checkbox"/> Shared Use Transit <input checked="" type="checkbox"/> Tourist/Other		<b>22. Average Passenger Train Count Per Day</b> <input type="checkbox"/> Less Than One Per Day <input checked="" type="checkbox"/> Number Per Day 2	
<b>23. Type of Land Use</b> <input type="checkbox"/> Open Space <input type="checkbox"/> Farm <input type="checkbox"/> Residential <input checked="" type="checkbox"/> Commercial <input type="checkbox"/> Industrial <input type="checkbox"/> Institutional <input type="checkbox"/> Recreational <input type="checkbox"/> RR Yard					
<b>24. Is there an Adjacent Crossing with a Separate Number?</b> <input type="checkbox"/> Yes <input checked="" type="checkbox"/> No If Yes, Provide Crossing Number			<b>25. Quiet Zone (FRA provided)</b> <input checked="" type="checkbox"/> No <input type="checkbox"/> 24 Hr <input type="checkbox"/> Partial <input type="checkbox"/> Chicago Excused Date Established		
<b>26. HSR Corridor ID</b> <input checked="" type="checkbox"/> N/A		<b>27. Latitude in decimal degrees</b> (WGS84 std: nn.nnnnnnn) 41.4259480		<b>28. Longitude in decimal degrees</b> (WGS84 std: -nnn.nnnnnnn) -75.6550790	
<b>29. Lat/Long Source</b> <input type="checkbox"/> Actual <input checked="" type="checkbox"/> Estimated		<b>30.A. Railroad Use *</b>		<b>31.A. State Use *</b>	
<b>30.B. Railroad Use *</b>		<b>30.C. Railroad Use *</b>		<b>30.D. Railroad Use *</b>	
<b>31.B. State Use *</b> DL		<b>31.C. State Use *</b>		<b>31.D. State Use *</b>	
<b>32.A. Narrative (Railroad Use) *</b>			<b>32.B. Narrative (State Use) *</b>		
<b>33. Emergency Notification Telephone No. (posted)</b> 844-695-3172		<b>34. Railroad Contact (Telephone No.)</b> 570-347-5232		<b>35. State Contact (Telephone No.)</b> 717-787-6935	

## Part II: Railroad Information

<b>1. Estimated Number of Daily Train Movements</b>				
<b>1.A. Total Day Thru Trains (6 AM to 6 PM)</b> 2	<b>1.B. Total Night Thru Trains (6 PM to 6 AM)</b> 2	<b>1.C. Total Switching Trains</b> 6	<b>1.D. Total Transit Trains</b> 0	<b>1.E. Check if Less Than One Movement Per Day</b> <input type="checkbox"/> How many trains per week? _____
<b>2. Year of Train Count Data (YYYY)</b> 2020		<b>3. Speed of Train at Crossing</b> 3.A. Maximum Timetable Speed (mph) 10 3.B. Typical Speed Range Over Crossing (mph) From 5 to 10		
<b>4. Type and Count of Tracks</b> Main 1 Siding 1 Yard 1 Transit 0 Industry 0				
<b>5. Train Detection (Main Track only)</b> <input type="checkbox"/> Constant Warning Time <input type="checkbox"/> Motion Detection <input type="checkbox"/> AFO <input type="checkbox"/> PTC <input type="checkbox"/> DC <input checked="" type="checkbox"/> Other <input type="checkbox"/> None				
<b>6. Is Track Signaled?</b> <input type="checkbox"/> Yes <input checked="" type="checkbox"/> No		<b>7.A. Event Recorder</b> <input type="checkbox"/> Yes <input checked="" type="checkbox"/> No		<b>7.B. Remote Health Monitoring</b> <input type="checkbox"/> Yes <input checked="" type="checkbox"/> No



# U. S. DOT CROSSING INVENTORY FORM

**DEPARTMENT OF TRANSPORTATION**  
FEDERAL RAILROAD ADMINISTRATION

OMB No. 2130-0017

Instructions for the initial reporting of the following types of new or previously unreported crossings: For public highway-rail grade crossings, complete the entire inventory Form. For private highway-rail grade crossings, complete the Header, Parts I and II, and the Submission Information section. For public pathway grade crossings (including pedestrian station grade crossings), complete the Header, Parts I and II, and the Submission Information section. For Private pathway grade crossings, complete the Header, Parts I and II, and the Submission Information section. For grade-separated highway-rail or pathway crossings (including pedestrian station crossings), complete the Header, Part I, and the Submission Information section. For changes to existing data, complete the Header, Part I Items 1-3, and the Submission Information section, in addition to the updated data fields. Note: For private crossings only, Part I Item 20 and Part III Item 2.K. are required unless otherwise noted. An asterisk \* denotes an optional field.

<b>A. Revision Date</b> (MM/DD/YYYY) 03 / 01 / 2012	<b>B. Reporting Agency</b> <input checked="" type="checkbox"/> Railroad <input type="checkbox"/> Transit <input type="checkbox"/> State <input type="checkbox"/> Other	<b>C. Reason for Update</b> (Select only one) <input checked="" type="checkbox"/> Change in Data <input type="checkbox"/> New <input type="checkbox"/> Closed <input type="checkbox"/> Re-Open <input type="checkbox"/> Date <input type="checkbox"/> Change in Primary Operating RR <input type="checkbox"/> No Train Traffic <input type="checkbox"/> Quiet Zone Update <input type="checkbox"/> Admin. Correction	<b>D. DOT Crossing Inventory Number</b> 249654A
---	--	--	--

## Part I: Location and Classification Information

<b>1. Primary Operating Railroad</b> DELAWARE LACKAWANNA RAILROAD [DL]		<b>2. State</b> PENNSYLVANIA		<b>3. County</b> LACKAWANNA	
<b>4. City / Municipality</b> <input checked="" type="checkbox"/> In <input type="checkbox"/> Near SCRANTON		<b>5. Street/Road Name &amp; Block Number</b> GREEN STREET (Street/Road Name)    * (Block Number)		<b>6. Highway Type &amp; No.</b> CITY	
<b>7. Do Other Railroads Operate a Separate Track at Crossing?</b> <input type="checkbox"/> Yes <input type="checkbox"/> No If Yes, Specify RR _____			<b>8. Do Other Railroads Operate Over Your Track at Crossing?</b> <input type="checkbox"/> Yes <input type="checkbox"/> No If Yes, Specify RR _____		
<b>9. Railroad Division or Region</b> <input type="checkbox"/> None		<b>10. Railroad Subdivision or District</b> <input type="checkbox"/> None		<b>11. Branch or Line Name</b> <input type="checkbox"/> None    CARBONDALE MAIN	
<b>12. RR Milepost</b> 0004.19 (prefix)   (nnnn.nnn)   (suffix)		<b>13. Line Segment</b> *		<b>14. Nearest RR Timetable Station</b> SCRANTON	
<b>15. Parent RR</b> (if applicable) <input type="checkbox"/> N/A		<b>16. Crossing Owner</b> (if applicable) <input type="checkbox"/> N/A		<b>17. Crossing Type</b> <input checked="" type="checkbox"/> Public <input type="checkbox"/> Private	
<b>18. Crossing Purpose</b> <input checked="" type="checkbox"/> Highway <input type="checkbox"/> Pathway, Ped. <input type="checkbox"/> Station, Ped.		<b>19. Crossing Position</b> <input type="checkbox"/> At Grade <input checked="" type="checkbox"/> RR Under <input type="checkbox"/> RR Over		<b>20. Public Access</b> (if Private Crossing) <input type="checkbox"/> Yes <input type="checkbox"/> No	
<b>21. Type of Train</b> <input type="checkbox"/> Freight <input type="checkbox"/> Transit <input type="checkbox"/> Intercity Passenger <input type="checkbox"/> Shared Use Transit <input type="checkbox"/> Commuter <input type="checkbox"/> Tourist/Other		<b>22. Average Passenger Train Count Per Day</b> <input type="checkbox"/> Less Than One Per Day <input type="checkbox"/> Number Per Day 0		<b>23. Type of Land Use</b> <input type="checkbox"/> Open Space <input type="checkbox"/> Farm <input type="checkbox"/> Residential <input type="checkbox"/> Commercial <input type="checkbox"/> Industrial <input type="checkbox"/> Institutional <input type="checkbox"/> Recreational <input type="checkbox"/> RR Yard	
<b>24. Is there an Adjacent Crossing with a Separate Number?</b> <input type="checkbox"/> Yes <input checked="" type="checkbox"/> No    If Yes, Provide Crossing Number _____			<b>25. Quiet Zone</b> (FRA provided) <input checked="" type="checkbox"/> No <input type="checkbox"/> 24 Hr <input type="checkbox"/> Partial <input type="checkbox"/> Chicago Excused    Date Established _____		
<b>26. HSR Corridor ID</b> <input type="checkbox"/> N/A		<b>27. Latitude in decimal degrees</b> (WGS84 std: nn.nnnnnnn) 41.4195600		<b>28. Longitude in decimal degrees</b> (WGS84 std: -nnn.nnnnnnn) -75.6595880	
<b>29. Lat/Long Source</b> <input checked="" type="checkbox"/> Actual <input type="checkbox"/> Estimated		<b>30.A. Railroad Use</b> *		<b>31.A. State Use</b> *	
<b>30.B. Railroad Use</b> *		<b>30.C. Railroad Use</b> *		<b>31.B. State Use</b> *    DL	
<b>30.D. Railroad Use</b> *		<b>31.C. State Use</b> *		<b>31.D. State Use</b> *	
<b>32.A. Narrative (Railroad Use)</b> *		<b>32.B. Narrative (State Use)</b> *			
<b>33. Emergency Notification Telephone No. (posted)</b> 570-343-6944		<b>34. Railroad Contact (Telephone No.)</b> 570-343-4580		<b>35. State Contact (Telephone No.)</b> 717-787-6935	

## Part II: Railroad Information

<b>1. Estimated Number of Daily Train Movements</b>				
<b>1.A. Total Day Thru Trains</b> (6 AM to 6 PM) 0	<b>1.B. Total Night Thru Trains</b> (6 PM to 6 AM) 0	<b>1.C. Total Switching Trains</b> 0	<b>1.D. Total Transit Trains</b>	<b>1.E. Check if Less Than One Movement Per Day</b> <input type="checkbox"/> How many trains per week? _____
<b>2. Year of Train Count Data (YYYY)</b>		<b>3. Speed of Train at Crossing</b> 3.A. Maximum Timetable Speed (mph) 10 3.B. Typical Speed Range Over Crossing (mph) From 5 to 10		
<b>4. Type and Count of Tracks</b> Main 1    Siding _____    Yard _____    Transit _____    Industry _____				
<b>5. Train Detection (Main Track only)</b> <input type="checkbox"/> Constant Warning Time <input type="checkbox"/> Motion Detection <input type="checkbox"/> AFO <input type="checkbox"/> PTC <input type="checkbox"/> DC <input type="checkbox"/> Other <input type="checkbox"/> None				
<b>6. Is Track Signaled?</b> <input type="checkbox"/> Yes <input type="checkbox"/> No		<b>7.A. Event Recorder</b> <input type="checkbox"/> Yes <input type="checkbox"/> No		<b>7.B. Remote Health Monitoring</b> <input type="checkbox"/> Yes <input type="checkbox"/> No

# U. S. DOT CROSSING INVENTORY FORM

A. Revision Date (MM/DD/YYYY) 03/01/2012		PAGE 2		D. Crossing Inventory Number (7 char.) 249654A	
<b>Part III: Highway or Pathway Traffic Control Device Information</b>					
1. Are there Signs or Signals? <input type="checkbox"/> Yes <input checked="" type="checkbox"/> No		2. Types of Passive Traffic Control Devices associated with the Crossing			
2.A. Crossbuck Assemblies (count) 0		2.B. STOP Signs (R1-1) (count) 0	2.C. YIELD Signs (R1-2) (count)	2.D. Advance Warning Signs (Check all that apply; include count) <input checked="" type="checkbox"/> None <input type="checkbox"/> W10-1 _____ <input type="checkbox"/> W10-3 _____ <input type="checkbox"/> W10-11 _____ <input type="checkbox"/> W10-2 _____ <input type="checkbox"/> W10-4 _____ <input type="checkbox"/> W10-12 _____	
2.E. Low Ground Clearance Sign (W10-5) <input type="checkbox"/> Yes (count _____) <input type="checkbox"/> No		2.F. Pavement Markings <input type="checkbox"/> Stop Lines <input type="checkbox"/> Dynamic Envelope <input type="checkbox"/> RR Xing Symbols <input type="checkbox"/> None		2.G. Channelization Devices/Medians <input type="checkbox"/> All Approaches <input type="checkbox"/> Median <input type="checkbox"/> One Approach <input type="checkbox"/> None	2.H. EXEMPT Sign (R15-3) <input type="checkbox"/> Yes <input type="checkbox"/> No
2.I. ENS Sign (I-13) Displayed <input type="checkbox"/> Yes <input checked="" type="checkbox"/> No		2.J. Other MUTCD Signs <input type="checkbox"/> Yes <input checked="" type="checkbox"/> No Specify Type _____ Count _____ Specify Type _____ Count _____ Specify Type _____ Count _____		2.K. Private Crossing Signs (if private) <input type="checkbox"/> Yes <input type="checkbox"/> No	2.L. LED Enhanced Signs (List types)
<b>3. Types of Train Activated Warning Devices at the Grade Crossing (specify count of each device for all that apply)</b>					
3.A. Gate Arms (count) Roadway 0 Pedestrian _____	3.B. Gate Configuration <input type="checkbox"/> 2 Quad <input type="checkbox"/> Full (Barrier) Resistance <input type="checkbox"/> 3 Quad <input type="checkbox"/> Median Gates	3.C. Cantilevered (or Bridged) Flashing Light Structures (count) Over Traffic Lane 0 <input type="checkbox"/> Incandescent Not Over Traffic Lane 0 <input type="checkbox"/> LED		3.D. Mast Mounted Flashing Lights (count of masts) 0 <input type="checkbox"/> Incandescent <input type="checkbox"/> LED <input type="checkbox"/> Back Lights Included <input type="checkbox"/> Side Lights Included	3.E. Total Count of Flashing Light Pairs 0
3.F. Installation Date of Current Active Warning Devices: (MM/YYYY) ____/____/____ <input type="checkbox"/> Not Required		3.G. Wayside Horn <input type="checkbox"/> Yes Installed on (MM/YYYY) ____/____/____ <input type="checkbox"/> No		3.H. Highway Traffic Signals Controlling Crossing <input type="checkbox"/> Yes <input checked="" type="checkbox"/> No	3.I. Bells (count) 0
3.J. Non-Train Active Warning <input type="checkbox"/> Flagging/Flagman <input type="checkbox"/> Manually Operated Signals <input type="checkbox"/> Watchman <input type="checkbox"/> Floodlighting <input type="checkbox"/> None				3.K. Other Flashing Lights or Warning Devices Count 0 Specify type _____	
4.A. Does nearby Hwy Intersection have Traffic Signals? <input type="checkbox"/> Yes <input type="checkbox"/> No	4.B. Hwy Traffic Signal Interconnection <input type="checkbox"/> Not Interconnected <input type="checkbox"/> For Traffic Signals <input type="checkbox"/> For Warning Signs	4.C. Hwy Traffic Signal Preemption <input type="checkbox"/> Simultaneous <input type="checkbox"/> Advance	5. Highway Traffic Pre-Signals <input type="checkbox"/> Yes <input type="checkbox"/> No Storage Distance * _____ Stop Line Distance * _____	6. Highway Monitoring Devices (Check all that apply) <input type="checkbox"/> Yes - Photo/Video Recording <input type="checkbox"/> Yes - Vehicle Presence Detection <input type="checkbox"/> None	
<b>Part IV: Physical Characteristics</b>					
1. Traffic Lanes Crossing Railroad Number of Lanes _____ <input type="checkbox"/> One-way Traffic <input type="checkbox"/> Two-way Traffic <input type="checkbox"/> Divided Traffic		2. Is Roadway/Pathway Paved? <input type="checkbox"/> Yes <input type="checkbox"/> No	3. Does Track Run Down a Street? <input type="checkbox"/> Yes <input type="checkbox"/> No	4. Is Crossing Illuminated? (Street lights within approx. 50 feet from nearest rail) <input type="checkbox"/> Yes <input type="checkbox"/> No	
5. Crossing Surface (on Main Track, multiple types allowed) Installation Date * (MM/YYYY) ____/____/____ Width * _____ Length * _____ <input type="checkbox"/> 1 Timber <input type="checkbox"/> 2 Asphalt <input type="checkbox"/> 3 Asphalt and Timber <input type="checkbox"/> 4 Concrete <input type="checkbox"/> 5 Concrete and Rubber <input type="checkbox"/> 6 Rubber <input type="checkbox"/> 7 Metal <input type="checkbox"/> 8 Unconsolidated <input type="checkbox"/> 9 Composite <input type="checkbox"/> 10 Other (specify) _____					
6. Intersecting Roadway within 500 feet? <input type="checkbox"/> Yes <input type="checkbox"/> No If Yes, Approximate Distance (feet) _____			7. Smallest Crossing Angle <input type="checkbox"/> 0° - 29° <input type="checkbox"/> 30° - 59° <input type="checkbox"/> 60° - 90°	8. Is Commercial Power Available? * <input type="checkbox"/> Yes <input type="checkbox"/> No	
<b>Part V: Public Highway Information</b>					
1. Highway System <input type="checkbox"/> (01) Interstate Highway System <input type="checkbox"/> (02) Other Nat Hwy System (NHS) <input type="checkbox"/> (03) Federal AID, Not NHS <input type="checkbox"/> (08) Non-Federal Aid		2. Functional Classification of Road at Crossing <input type="checkbox"/> (0) Rural <input type="checkbox"/> (1) Urban <input type="checkbox"/> (1) Interstate <input type="checkbox"/> (5) Major Collector <input type="checkbox"/> (2) Other Freeways and Expressways <input type="checkbox"/> (3) Other Principal Arterial <input type="checkbox"/> (6) Minor Collector <input type="checkbox"/> (4) Minor Arterial <input type="checkbox"/> (7) Local		3. Is Crossing on State Highway System? <input type="checkbox"/> Yes <input type="checkbox"/> No	4. Highway Speed Limit _____ MPH <input type="checkbox"/> Posted <input type="checkbox"/> Statutory
5. Linear Referencing System (LRS Route ID) *					
6. LRS Milepost *					
7. Annual Average Daily Traffic (AADT) Year 1970 AADT _____		8. Estimated Percent Trucks _____ %	9. Regularly Used by School Buses? <input type="checkbox"/> Yes <input checked="" type="checkbox"/> No Average Number per Day 0		10. Emergency Services Route <input type="checkbox"/> Yes <input type="checkbox"/> No
<b>Submission Information - This information is used for administrative purposes and is not available on the public website.</b>					
Submitted by _____ Organization _____ Phone _____ Date _____					
Public reporting burden for this information collection is estimated to average 30 minutes per response, including the time for reviewing instructions, searching existing data sources, gathering and maintaining the data needed and completing and reviewing the collection of information. According to the Paperwork Reduction Act of 1995, a federal agency may not conduct or sponsor, and a person is not required to, nor shall a person be subject to a penalty for failure to comply with, a collection of information unless it displays a currently valid OMB control number. The valid OMB control number for information collection is 2130-0017. Send comments regarding this burden estimate or any other aspect of this collection, including for reducing this burden to: Information Collection Officer, Federal Railroad Administration, 1200 New Jersey Ave. SE, MS-25 Washington, DC 20590.					