

Borough of Green Tree

10 W. Manilla Avenue
Green Tree, PA 15220-3310
www.greentreeboro.com

412-921-1110
FAX 921-5997

July 10, 2024

Secretary's Bureau
Pennsylvania Public Utility Commission
Commonwealth Keystone Building
2nd Floor, Room-N201
Harrisburg, PA 17120

Application of the Borough of Green Tree for approval to alter the public above-grade crossing by reconstruction of the bridge where Trumbull Drive crosses the tracks of Wheeling & Lake Erie Railroad Company, DOT Number 472 812 H in Green Tree Borough, Allegheny County.

Dear PUC Secretary:

Enclosed for filing please find the Application of the Borough of Green Tree.

A copy of this Application and Exhibits has been served upon the parties in the Certificate of Service to the Application.

Sincerely,

Judith Miller, Borough Manager
Borough of Green Tree

Enclosure

BEFORE
PENNSYLVANIA PUBLIC UTILITY COMMISSION

Rail Safety Division Application Type (check all that apply):

- E-Installation, removal or substitution of warning devices at a public crossing
- G-Construction, alteration, relocation, abolition or suspension of a public crossing
- P-Installation of traffic signals with preemption on the approach to a public crossing
- W-Installation of a fixed utility company's facilities at a public crossing (Pipe & Wire)
- X-Exemption from the Commission's railroad clearance requirement

Application Docket No.
To Be Assigned

For Applications E/G/P/W use caption 1, for X use caption 2 (delete unused caption):

In re: (1) Application of the Borough of Green Tree for approval to alter the public crossing DOT # 472 812 H by the construction of a new bridge where Trumbull Drive crosses above grade the track(s) of Wheeling & Lake Erie Railroad Company, located in Green Tree Borough in Allegheny County.

To Pennsylvania Public Utility Commission:

1. The name, address, telephone number, and e-mail address of the applicant are:
Green Tree Borough, 10 West Manilla Avenue, Pittsburgh, PA 15220.
2. The name, address, telephone number, and e-mail address of the applicant's attorney are:
Kate M. Diersen, GRB Law, kdiersen@grblaw.com
525 William Penn Place, Suite 3110, Pittsburgh, PA 15219 (t) 412.281.0587 (f) 412.281.2971
3. The existing and proposed Trumbull Drive bridges are owned and maintained by Green Tree Borough.
4. The applicant is seeking approval to construct a new bridge that will carry Trumbull Drive over the Wheeling & Lake Erie railroad tracks. The new bridge will be located immediately west of the existing bridge. The existing bridge will be removed once the new one is open. The new bridge will be open to vehicles and pedestrians--a sidewalk will be included on the west side of the bridge. A location map is attached hereto for reference and marked Exhibit A. Also attached hereto and marked Exhibit B is the preliminary Line, Grade, and Typical Section plan for the project.
5. The parties that may be affected by the proposed alteration are as follows (see attached Certificate of Service): Green Tree Borough, Wheeling and Lake Erie Railroad, Verizon Pennsylvania LLC, Comcast, Peoples Natural Gas Company, DQE Communications, Duquesne Light Company, American Waterworks Company Inc, and the Municipal Authority of Green Tree Borough.
6. The average daily traffic for Trumbull Drive is 1,895 with 3% trucks.
7. The estimated total cost for construction activities is \$6,600,000. The construction funding for the project is anticipated to be 80% federal funds, 15% State and 5% local funds. Green Tree Borough will be responsible for bridge maintenance, sidewalk maintenance, street lighting maintenance, and Trumbull Drive drainage facility maintenance.
8. The application is necessary or proper for the following reason(s): safety and convenience of the public.

Wherefore, Judith Miller prays your Honorable Commission to approve the application:

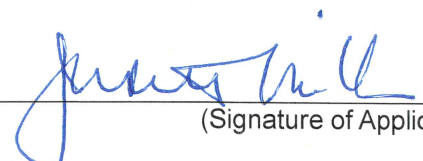

(Signature of Applicant)

VERIFICATION

I, Judith Miller, hereby state that the facts above set forth are true and correct (or are true and correct to the best of my knowledge, information and belief) and that I expect to be able to prove the same at a hearing held in this matter. I understand that the statements herein are made subject to the penalties of 18 Pa. C.S. § 4904 (relating to unsworn falsification to authorities).

7/10/2024

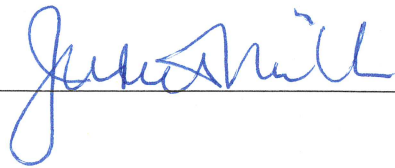
Date



(Signature)

CERTIFICATE OF SERVICE

I hereby certify that I have this day served a true copy of the foregoing document upon the participants, listed below, in accordance with the requirements of § 1.54 (*relating to service by participant*).

Arin Biondi
Verizon Pennsylvania LLC
3121 Pioneer Avenue
Pittsburgh, PA 15226
Arin.p.biondi@verizon.com

Kristyn Stankiewicz
Comcast
1530 Chartiers Avenue
Pittsburgh, PA 15204
KristynStankiewicz@usicllc.com

Gary Baird
Peoples Natural Gas Company
4536 Route 136, Suite 1
Greensburg, PA 15601
Gbaird@lsse.com

Adam Nulph
DQE Communications
424 South 27th St, Suite 220
Pittsburgh, PA 15203
ACNulph@dqe.com

James Runatz
Duquesne Light Company
1901 Edison St
Pittsburgh, PA 15116
jrunatz@duqlight.com

Dan Leonard
PennDOT ROW & Utilities and Grade Crossing Div
PO Box 3362
Harrisburg, PA 17105
Danleonard@pa.gov

Michael Evanson
American Water Works Company
500 Nobelstown Road
Carnegie, PA 15106
Michael.evanson@amwater.com

Abigail Gardner
Allegheny County
101 County Courthouse, 436 Grant St
Pittsburgh, PA 15219
Abigail.gardner@AlleghenyCounty.US

Judy Miller
Green Tree Borough
10 West Manilla Avenue
Pittsburgh, PA 15220
jmiller@greentreeboro.com

Michael C. Grace
PennDOT Engineering District 11-0
45 Thoms Run Road
Bridgeville, PA 15017
micgrace@pa.gov

Jeffery A. Davis Jr.
Wheeling & Lake Erie Railway
00 East First Street
Brewster, OH 44613
jdavisjr@wlerwy.com

Karen Cummings
PennDOT Office of Chief Counsel
PO Box 8212
Harrisburg, PA 17105
kcummings@pa.gov

Dated this 16th day of August, 2024

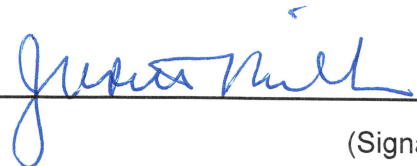

(Signature)

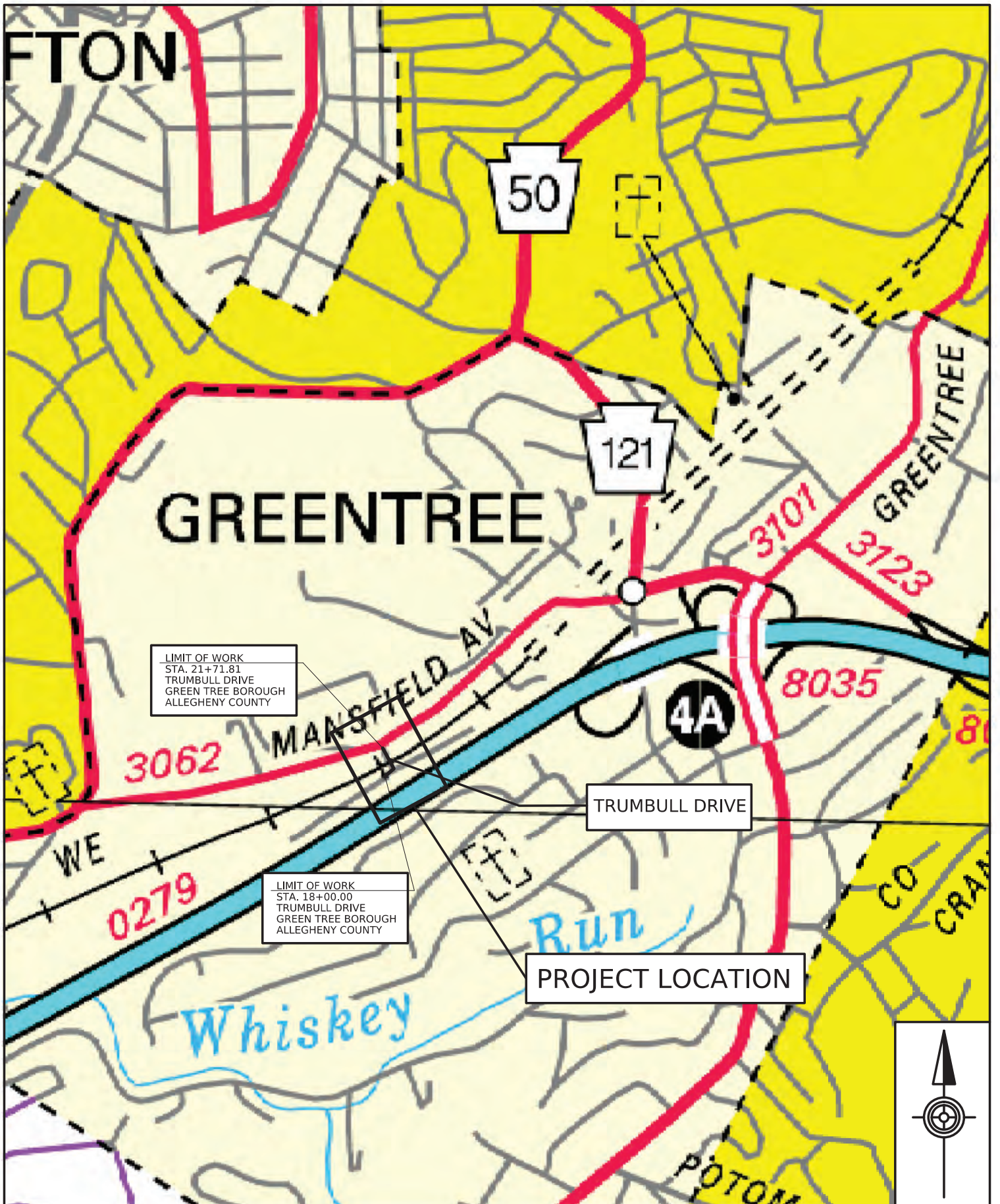

DISTRICT	COUNTY	TOWNSHIP	BOROUGH	ROUTE	SECTION	TOTAL SHEETS
11-0	ALLEGHENY		GREEN TREE	*	*	9

* TRUMBULL DRIVE

COMMONWEALTH OF PENNSYLVANIA



DEPARTMENT OF TRANSPORTATION

DRAWINGS

FOR
LINE, GRADE

AND
TYPICAL SECTION SUBMISSION

OF
TRUMBULL DRIVE

IN ALLEGHENY COUNTY

FROM STA. 18+00.00 TO STA. 21+71.81 LENGTH 276.76 FT. 0.052 MI.

SCALE

HORIZONTAL 0 25 50 FEET

VERTICAL 0 5 10 FEET

Exhibit "B"
Line, Grade and Typical Section Plan
Page 1 of 9

DESIGN DESIGNATION

HIGHWAY CLASSIFICATION — URBAN, LOCAL ROADS
ROADWAY TYPOLOGY — LOCAL ROAD/STREET, SUBURBAN NEIGHBORHOOD
DESIGN SPEED — 25 MPH
LANE WIDTH — 2 - 11' (MIN.) LANES
SHOULDER WIDTH — 2'-0" LT
2'-0" RT

OPENING YEAR A.D.T. — 1,895 (2024)
DESIGN YEAR A.D.T. — 2,080 (2044)
D.H.V. — 190
D — 54%
T — 3%

PREPARED BY
GANNETT FLEMING
PITTSBURGH, PA

REG. PROF. ENGINEER

DATE

RECOMMENDED _____ 20 _____

DISTRICT EXECUTIVE

RECOMMENDED _____ 20 _____

DEPUTY SECRETARY

APPROVED _____ 20 _____

SECRETARY OF TRANSPORTATION

(ON BEHALF OF THE GOVERNOR
AS WELL AS THE SECRETARY))

SHEET INDEX BLOCK

DESCRIPTION	SHEET NO.
TITLE SHEET	1
INDEX SHEET	2
LOCATION MAP AND GENERAL NOTES	3
TYPICAL SECTIONS	4-5
SPECIAL DETAILS - CURB RAMPS	6
PLAN SHEET	7
PROFILE	8-9

DISTRICT	COUNTY	ROUTE	SECTION	SHEET
11-0	ALLEGHENY	*	*	2 OF 9

GREEN TREE BOROUGH				
REV NO	REVISIONS	DATE	BY	APPD

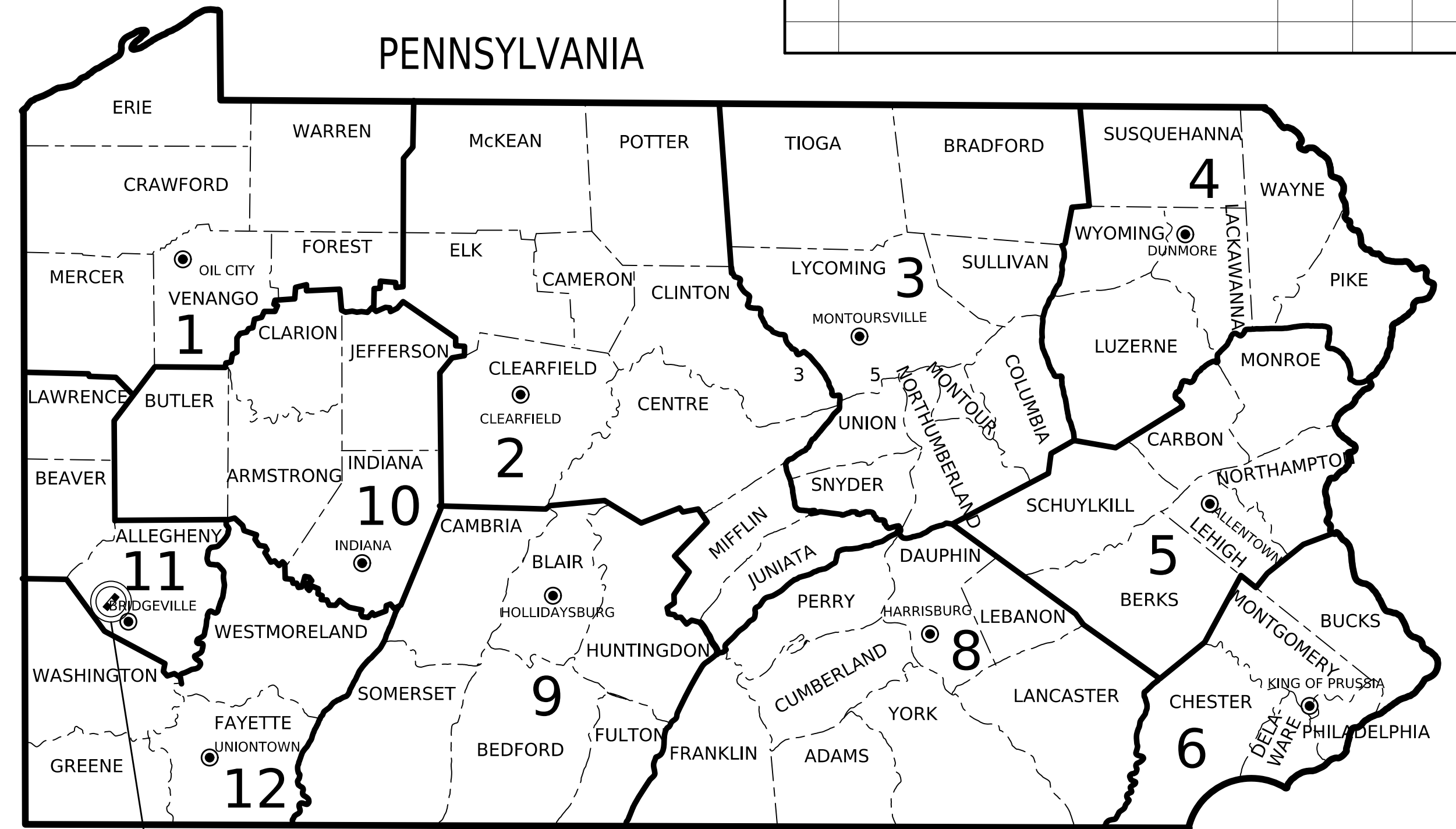

- 11** DISTRICT
- DISTRICT OFFICE
 - ⊙ PROJECT

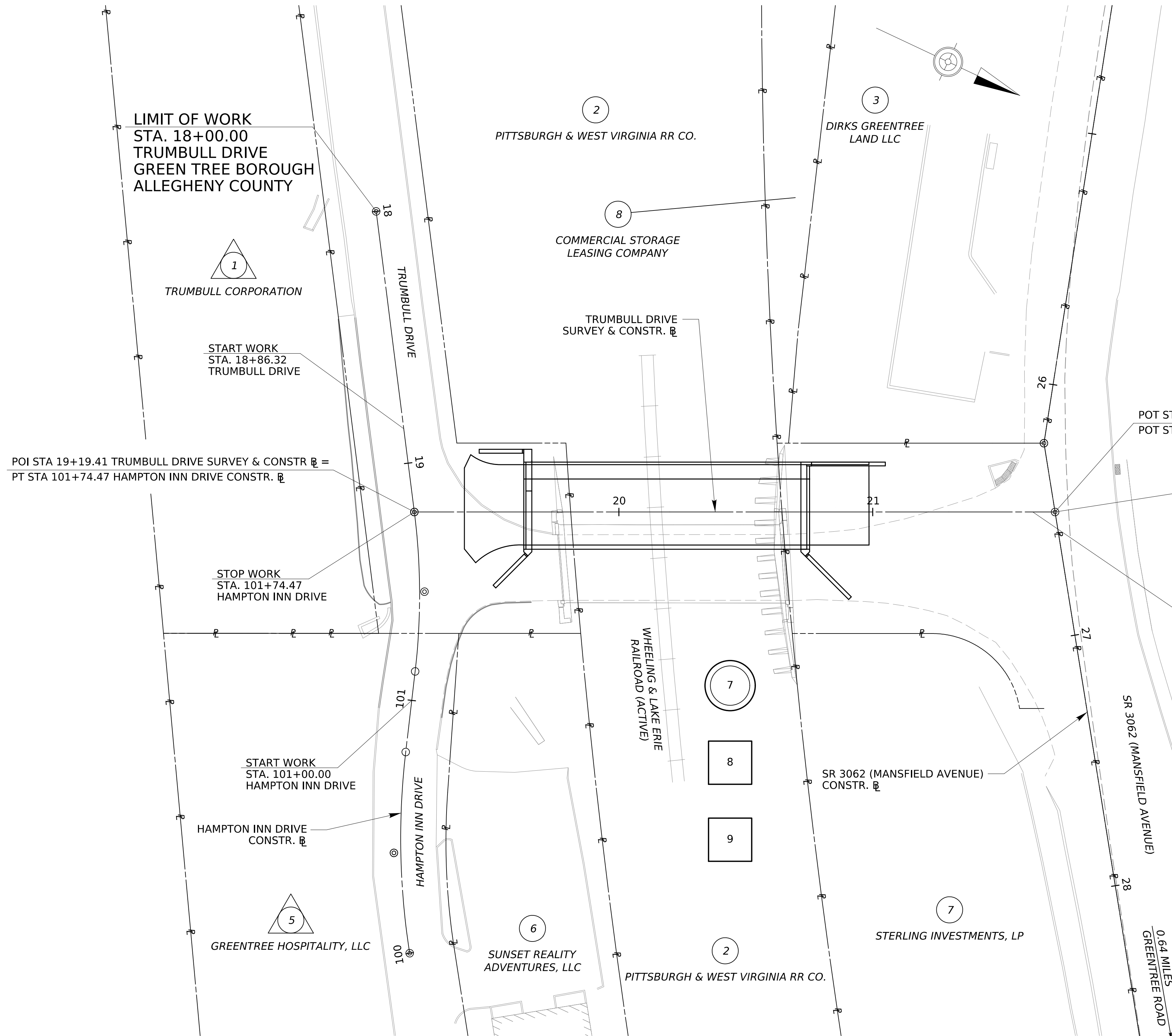

0.46 MILES TO NOBLESTOWN ROAD

SR 3062 (MANSFIELD AVENUE)

0.64 MILES GREEN TREE ROAD

POI STA 19+19.41 TRUMBULL DRIVE SURVEY & CONSTR. = PT STA 101+74.47 HAMPTON INN DRIVE CONSTR.

POT STA 21+71.81 TRUMBULL DRIVE SURVEY & CONSTR. = POT STA 26+50.84 SR 3062 (MANSFIELD AVENUE) CONSTR.

LIMIT OF WORK STA. 21+71.81 TRUMBULL DRIVE GREEN TREE BOROUGH ALLEGHENY COUNTY

Exhibit "B"
Line, Grade and Typical Section Plan
Page 2 of 9

- LIST OF PROPERTY OWNERS
- 1 TRUMBULL CORPORATION
 - 2 PITTSBURGH AND WEST VIRGINIA RR CO.
 - 3 DIRKS GREENTREE LAND LLC
 - 4 500 MANSFIELD AVENUE OWNER LLC
 - 5 GREENTREE HOSPITALITY, LLC
 - 6 SUNSET REALTY ADVENTURES, LLC
 - 7 STERLING INVESTMENTS, LP
 - 8 COMMERCIAL STORAGE LEASING COMPANY

- LEGEND
- PLAN
 - PROFILE
 - PARCEL IDENTIFICATION NUMBER - TAKE
 - △ PARCEL IDENTIFICATION NUMBER - NO TAKE

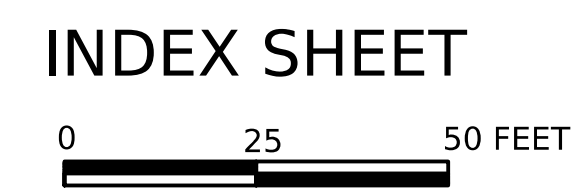

DISTRICT	COUNTY	ROUTE	SECTION	SHEET
11-0	ALLEGHENY	*	*	3 OF 9
GREEN TREE BOROUGH				
REV NO	REVISIONS	DATE	BY	APPD

LIST OF PUBLIC UTILITIES

LIST OF EQUALITIES

NONE

OVERALL LENGTH OF PROJECT

STA. 18+00.00 TO 21+71.81 = 371.81 FT = 0.070 MILES

CONSTRUCTION LENGTH OF PROJECT

STA. 18+86.32 TO 21+63.08 = 276.76 FT = 0.052 MILES

* TRUMBULL DRIVE

GENERAL NOTES

THE LEGAL RIGHT-OF-WAY ON TRUMBULL DRIVE FROM STATION 18+00.00 TO STATION 19+19.41 IS 40 FEET. THE LEGAL RIGHT-OF-WAY ON TRUMBULL DRIVE FROM STATION 19+19.41 TO STATION 21+78.71 IS 75 FEET.

THE LEGAL RIGHT-OF-WAY ON SR 3062 (MANSFIELD AVENUE) FROM STATION 25+00.00 TO STATION 27+75.00 IS 50 FEET.

DO NOT INTERFERE WITH THE OPERATION OF ANY FIRE HYDRANT, FIRE CALL BOX OR POLICE CALL BOX.

THIS IS A FEDERAL AID PROJECT AND AS SUCH IS SUBJECT TO INSPECTION BY REPRESENTATIVES OF THE FEDERAL HIGHWAY ADMINISTRATION AND THE PENNSYLVANIA DEPARTMENT OF TRANSPORTATION.

THREE TO TEN WORKING DAYS PRIOR TO EXCAVATION BASED ON THE COMPLEXITY OF THE PROJECT, THE CONTRACTOR MUST CONTACT THE PA ONE CALL SYSTEM, INC., PHONE 1-800-242-1776, SERIAL NO. _____ FOR GREEN TREE BOROUGH. ADDITIONAL INFORMATION IS AVAILABLE AT <https://www.pa1call.org/PA811/Public/>.

THE CONTRACTOR IS REQUIRED TO NOTIFY THE DEPARTMENT AND SUBMIT AN ALLEGED VIOLATION REPORT (AVR) TO THE PA PUBLIC UTILITY COMMISSION THROUGH THE PA ONE CALL SYSTEM, WWW.PA1CALL.ORG, WITHIN TEN (10) BUSINESS DAYS AFTER A UTILITY LINE IS STRUCK, DAMAGED, OR PREVIOUS DAMAGE IS DISCOVERED AS REQUIRED BY PENNSYLVANIA'S UNDERGROUND UTILITY LINE PROTECTION LAW ACT 50 (P.L.852, NO. 287 AMENDED OCT. 30, 2017).

THE DEPARTMENT OF TRANSPORTATION DOES NOT GUARANTEE THE ACCURACY OF THE LOCATIONS OF EXISTING SUBSURFACE UTILITY STRUCTURES SHOWN ON THE PLANS. NOR DOES THE DEPARTMENT GUARANTEE THAT ALL SUBSURFACE STRUCTURES ARE SHOWN.

SLOPE EASEMENT. AN EASEMENT FOR THE SUPPORT AND PROTECTION OF THE HIGHWAY, INCLUDING THE RIGHT TO CONSTRUCT, INSPECT, MAINTAIN, REPAIR, RECONSTRUCT AND ALTER DRAINAGE FACILITIES AND THE CONTOUR OF THE LAND. THE EASEMENT SHALL NOT PREVENT THE PROPERTY OWNER FROM MAKING ANY LEGAL USE OF THE AREA WHICH IS NOT DETRIMENTAL TO THE NECESSARY SUPPORT AND PROTECTION OF THE HIGHWAY RIGHT-OF-WAY AND THE SAFETY OF THE TRAVELING PUBLIC.

TEMPORARY CONSTRUCTION EASEMENT. AN EASEMENT TO USE THE LAND AS NECESSARY DURING CONSTRUCTION OF THE PROJECT. THE EASEMENT IS REQUIRED ONLY UNTIL THE CONSTRUCTION OR WORK INDICATED BY THE PLAN IS COMPLETED, UNLESS SOONER RELINQUISHED IN WRITING BY THE DEPARTMENT.

HORIZONTAL CONTROL FOR THIS PROJECT IS BASED ON THE PENNSYLVANIA STATE COORDINATE SYSTEM (SOUTH ZONE) NAD 83.

VERTICAL CONTROL IS BASED ON THE NORTH AMERICAN VERTICAL DATUM OF 1988 (NAVD 88).

ALL CURVE DATA IS BASED ON ARC DEFINITION UNLESS OTHERWISE NOTED.

SLOPE LIMITS ON THIS PLAN ARE INDICATED AS FOLLOWS:

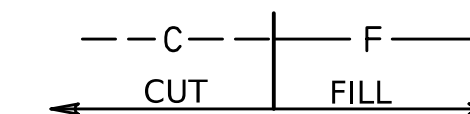

THERE ARE NO NAVIGABLE STREAMS LOCATED WITHIN THE PROJECT.

SUMMARY OF PROJECT COORDINATES

RTE	STATION	POINT	COORDINATES		BEARING
			NORTH	EAST	
TRUMBULL DRIVE SURVEY & CONSTR	18+00.00	POB	403329.1875	1326138.9916	N57°35'32"E
	19+19.41	PI	403393.1820	1326239.8002	N25°09'54"W
	21+71.81	POE	403621.6286	1326132.4721	
SR 3062 (MANSFIELD AVENUE) CONSTR	24+00.00	POB	403543.3727	1325895.4174	N73°40'47"E
	26+23.37	PI	403606.1410	1326109.7855	N55°40'47"E
	30+00.00	POE	403818.4930	1326420.8447	
HAMPTON INN DRIVE CONSTR	100+00.00	POB/PC	403465.4326	1326397.9187	S55°54'17"W
	100+40.01	PI	403443.0057	1326364.7886	S71°30'29"W
	100+79.52	PT	403430.3167	1326326.8471	
	101+11.50	PC	403420.1720	1326296.5135	
	101+43.14	PI	403410.1377	1326266.5099	S57°35'32"W
	101+74.47	POE/PT	403393.1820	1326239.8002	

NOTE: FOUR (4) PLACE COORDINATES ARE USED FOR COMPUTATIONAL PURPOSES ONLY AND DO NOT IMPLY PRECISION BEYOND TWO (2) PLACES.

LIMIT OF WORK
 STA. 21+71.81
 TRUMBULL DRIVE
 GREEN TREE BOROUGH
 ALLEGHENY COUNTY

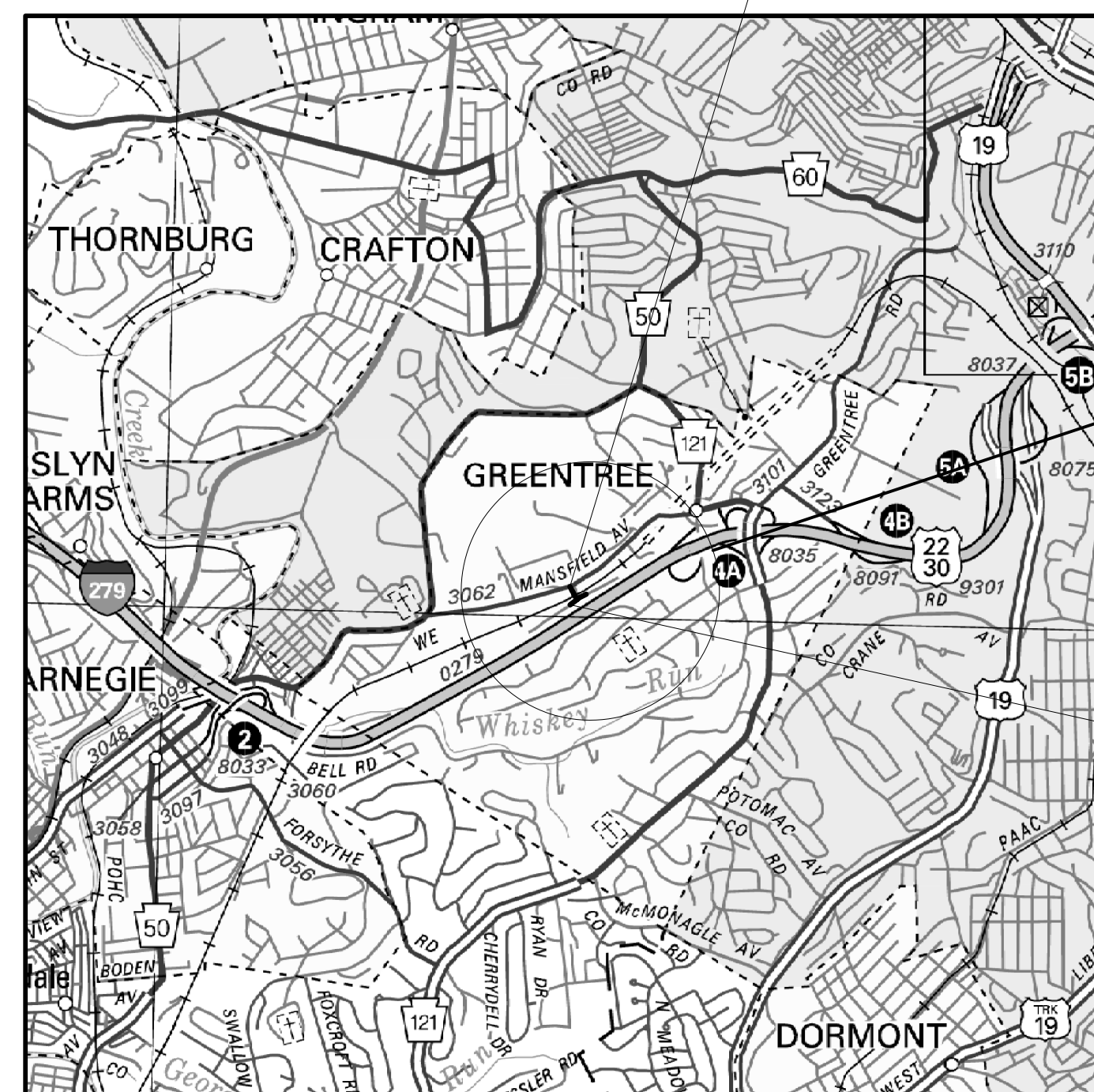

PROJECT LOCATION

LIMIT OF WORK
 STA. 18+00.00
 TRUMBULL DRIVE
 GREEN TREE BOROUGH
 ALLEGHENY COUNTY

DETAILS OTHER THAN THOSE INDICATED, ARE ON THE FOLLOWING STANDARD DRAWINGS:

NO.	DATE:	NO.	DATE:
RC-10M	JUNE 1, 2010	BC-732M	NOV. 23, 2022
RC-11M	JUNE 1, 2010	BC-734M	FEB. 19, 2021
RC-12M	NOV. 1, 2022	BC-735M	SEPT. 30, 2016
RC-13M	JUNE 1, 2010	BC-736M	NOV. 23, 2022
RC-23M	FEB. 8, 2019	BC-751M	JAN. 31, 2019
RC-28M	SEPT. 1, 2023	BC-752M	NOV. 23, 2022
RC-30M	FEB. 27, 2023	BC-755M	JAN. 31, 2019
RC-39M	NOV. 30, 2021	BC-757M	SEPT. 30, 2016
RC-45M	FEB. 19, 2021	BC-766M	NOV. 23, 2022
RC-46M	FEB. 19, 2021	BC-770M	JAN. 31, 2019
RC-50M	FEB. 27, 2023	BC-772M	NOV. 23, 2022
RC-51M	SEPT. 1, 2023	BC-775M	NOV. 23, 2022
RC-54M	SEPT. 1, 2023	BC-788M	NOV. 23, 2022
RC-64M	FEB. 19, 2021		
RC-67M	FEB. 19, 2021		
RC-70M	FEB. 8, 2019		
RC-72M	FEB. 8, 2019		
RC-75M	JUNE 1, 2010		
RC-77M	DEC. 17, 2019		
TC-8600	JUNE 13, 2013		
TC-8604	AUG. 17, 2021		
TC-8716	JUNE 13, 2013		
TC-8717	JUNE 13, 2013		
TC-8801	JUNE 20, 2023		
TC-8802	JUNE 20, 2023		
TC-8803	JUNE 20, 2023		
TC-8804	JUNE 20, 2023		
TC-8805	JUNE 20, 2023		
TC-8806	JUNE 20, 2023		

Exhibit "B"
Line, Grade and Typical Section Plan
 Page 3 of 9

LOCATION MAP AND GENERAL NOTES

DISTRICT	COUNTY	ROUTE	SECTION	SHEET
11-0	ALLEGHENY	*	*	4 OF 9
GREEN TREE BOROUGH				
REV NO	REVISIONS		DATE	BY APPD

***SUPERELEVATION TRANSITION CROSS SLOPES:**

- STA. 18+86.32 TO STA. 18+90.32
 - LEFT SHOULDER VARIES 0.78% TO 0.35%
 - LEFT LANE VARIES 0.78% TO 0.53%
 - RIGHT LANE VARIES -2.24% TO -2.00%
 - RIGHT SHOULDER VARIES -2.24% TO -4.00%
- STA. 18+90.32 TO STA. 19+30.32
 - LEFT SHOULDER VARIES 0.35% TO -4.00%
 - LEFT LANE VARIES 0.53% TO -2.00%
 - RIGHT LANE -2.00%
 - RIGHT SHOULDER -4.00%
- STA. 19+30.32 TO STA. 20+98.51
 - LEFT SHOULDER -4.00%
 - LEFT LANE -2.00%
 - RIGHT LANE -2.00%
 - RIGHT SHOULDER -4.00%
- STA. 20+98.51 TO STA. 21+50.08
 - LEFT SHOULDER VARIES -4.00% TO 1.76%
 - LEFT LANE VARIES -2.00% TO 2.15%
 - RIGHT LANE -2.00%
 - RIGHT SHOULDER -4.00%
- STA. 21+50.08 TO STA. 21+62.48
 - LEFT SHOULDER VARIES 1.76% TO 3.15%
 - LEFT LANE VARIES 2.15% TO 3.15%
 - RIGHT LANE VARIES -2.00% TO -2.79%
 - RIGHT SHOULDER VARIES -4.00% TO -2.79%

****WIDTH VARIES:**

- STA. 18+86.18 TO STA. 21+25.71
 - LEFT LANE 11'-0"
 - RIGHT LANE 11'-0"
- STA. 21+25.71 TO STA. 21+34.78
 - LEFT LANE 11'-0"
 - RIGHT LANE VARIES 11'-0" TO 12'-8"
- STA. 21+34.78 TO STA. 21+63.08
 - LEFT LANE VARIES 11'-0" TO 35'-8"
 - RIGHT LANE VARIES 12'-8" TO 92'-3"

* TRUMBULL DRIVE

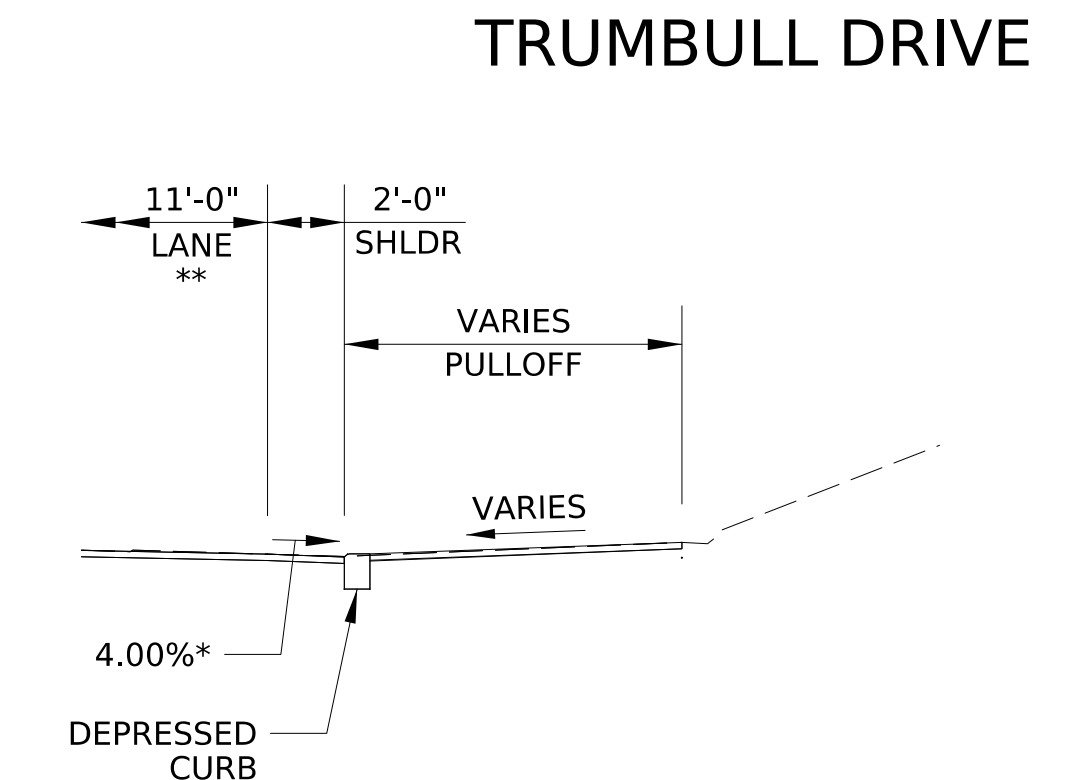
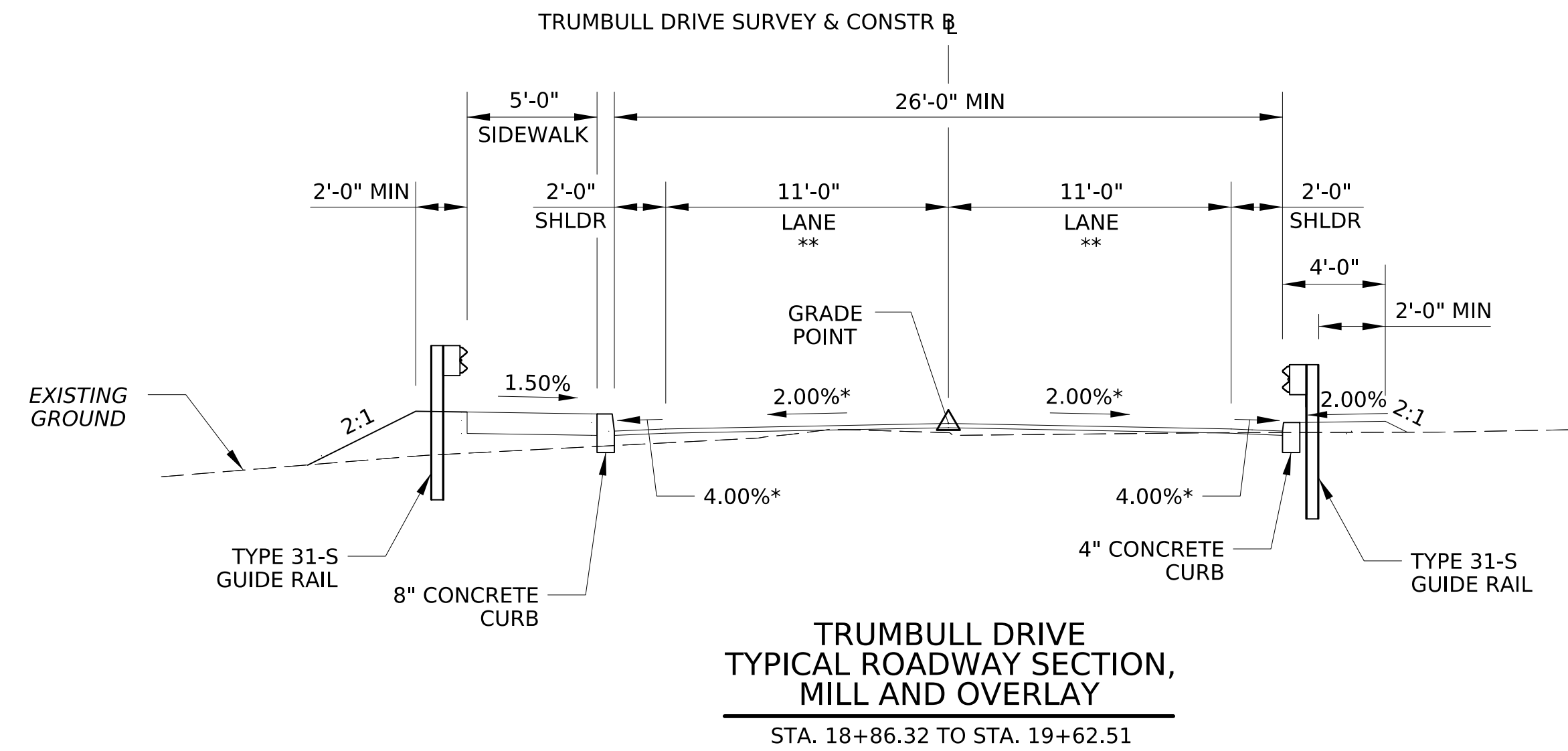

TRUMBULL DRIVE PARTIAL SECTION PULLOFF, RT
STA. 18+86.32 TO STA. 19+19.41

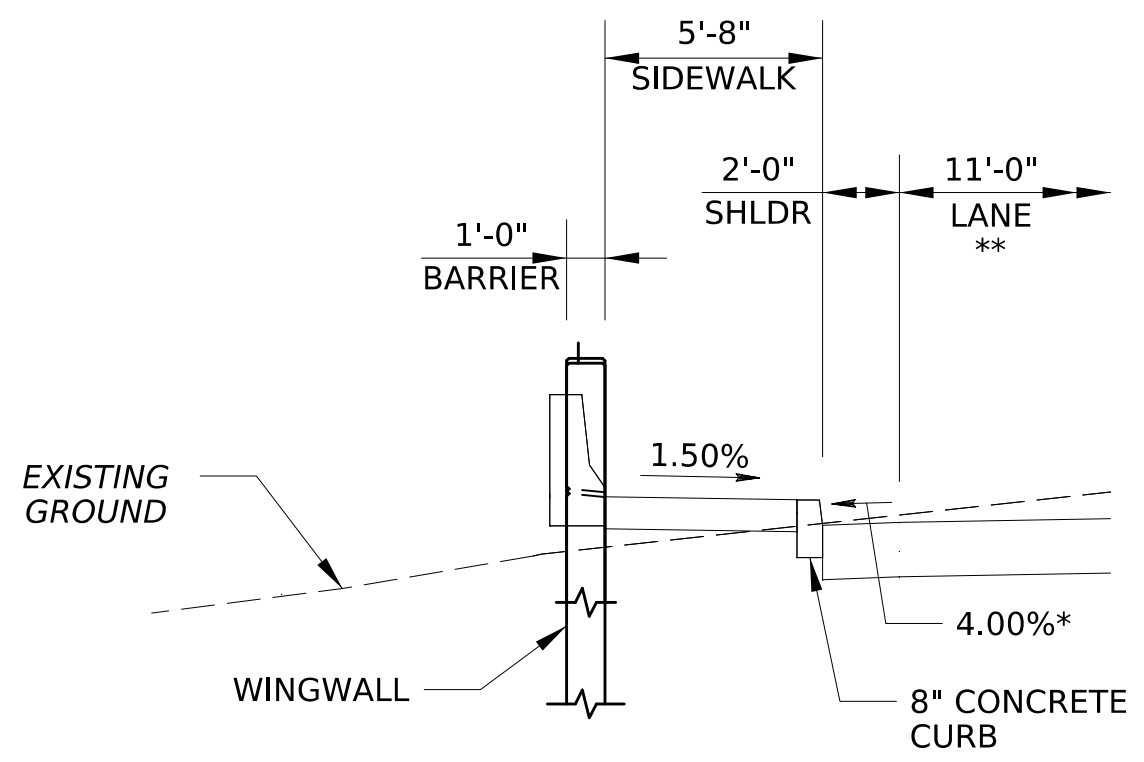

TRUMBULL DRIVE PARTIAL SECTION CONCRETE BARRIER, LT
STA. 20+75.11 TO STA. 21+04.96

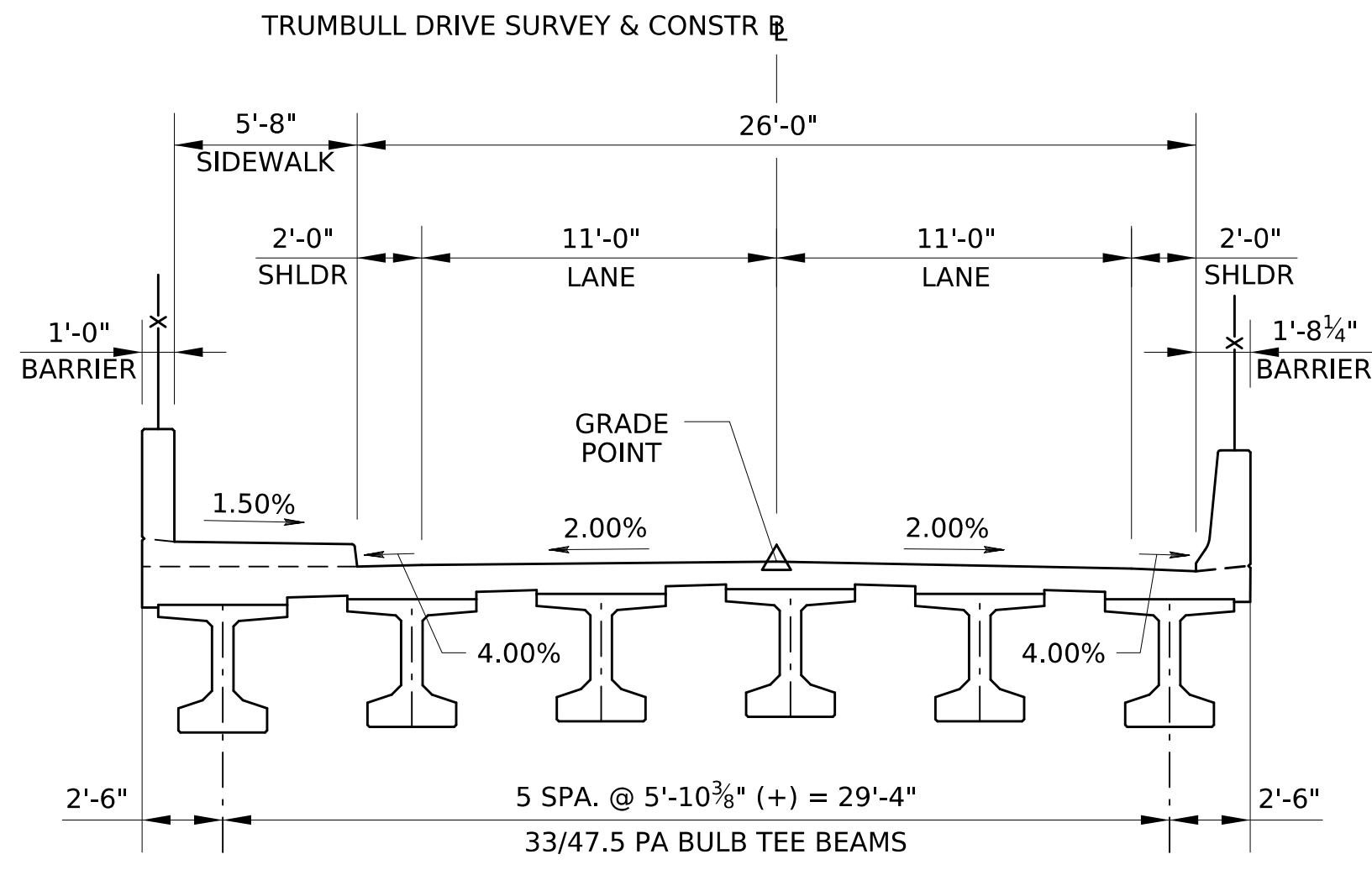

TRUMBULL DRIVE TYPICAL BRIDGE SECTION
STA. 19+62.51 TO STA. 20+75.11

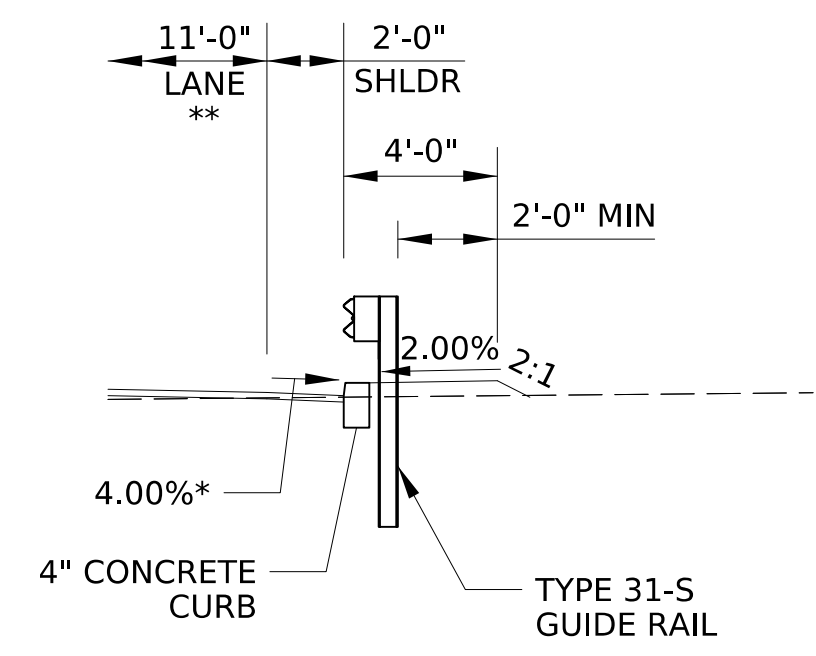

TRUMBULL DRIVE PARTIAL SECTION 2:1 FILL SLOPE WITH 4\"/>

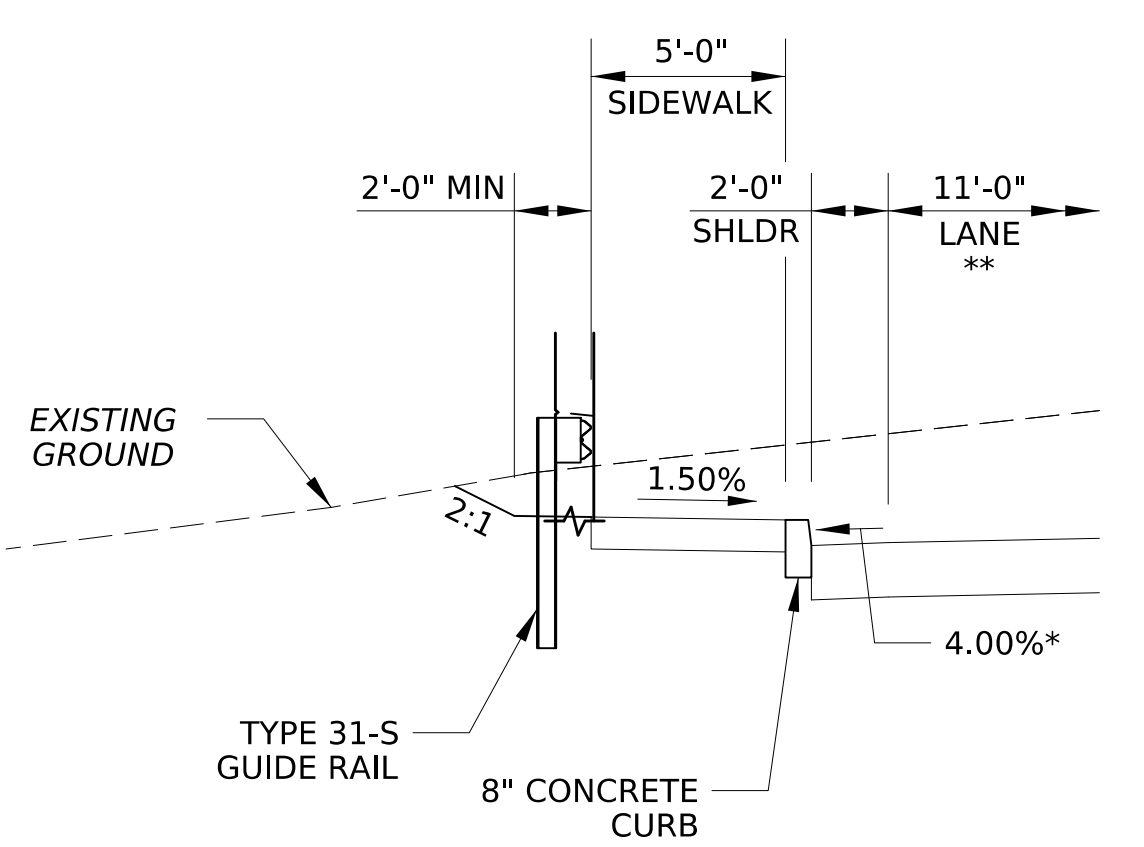

TRUMBULL DRIVE PARTIAL SECTION 2:1 CUT SLOPE WITH CONCRETE SIDEWALK, LT
STA. 21+18.00 TO STA. 21+38.00

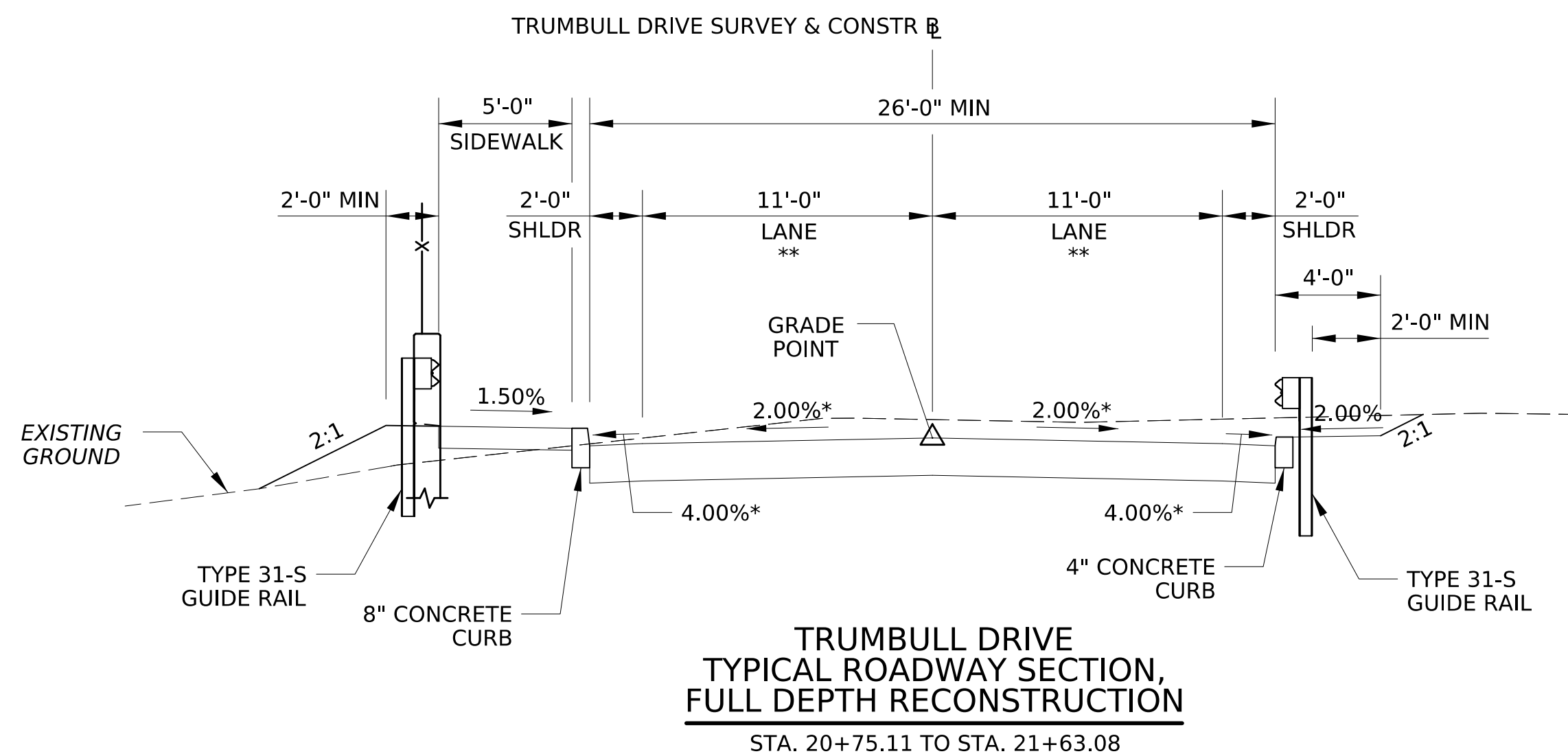

TRUMBULL DRIVE TYPICAL ROADWAY SECTION, FULL DEPTH RECONSTRUCTION
STA. 20+75.11 TO STA. 21+63.08



p:\gfiles\pw_bentley.com\gfiles\pw_01\Documents\Projects\75699\96HEETS\RDWY\ROAD\TRUMBULL\Typical Sections
 12/14/2023
 9:26:44 AM

DISTRICT	COUNTY	ROUTE	SECTION	SHEET
11-0	ALLEGHENY	*	*	5 OF 9
GREEN TREE BOROUGH				
REV NO	REVISIONS	DATE	BY	APPD

* TRUMBULL DRIVE

HAMPTON INN DRIVE

*SUPERELEVATION TRANSITION CROSS SLOPES:
 STA. 101+00.00 TO STA. 101+11.00
 -LEFT SHOULDER VARIES -0.37% TO -1.91%
 -LEFT LANE VARIES -0.37% TO -1.06%
 -RIGHT LANE VARIES 1.30% TO 2.00% (RC)
 -RIGHT SHOULDER VARIES 1.30% TO 2.00%

STA. 101+11.00 TO STA. 101+26.00
 -LEFT SHOULDER VARIES -1.91% TO -4.00%
 -LEFT LANE VARIES -1.06% TO -2.00%
 -RIGHT LANE 2.00%
 -RIGHT SHOULDER 2.00%

STA. 101+26.00 TO STA. 101+74.47
 -LEFT SHOULDER -4.00%
 -LEFT LANE -2.00%
 -RIGHT LANE 2.00%
 -RIGHT SHOULDER 2.00%

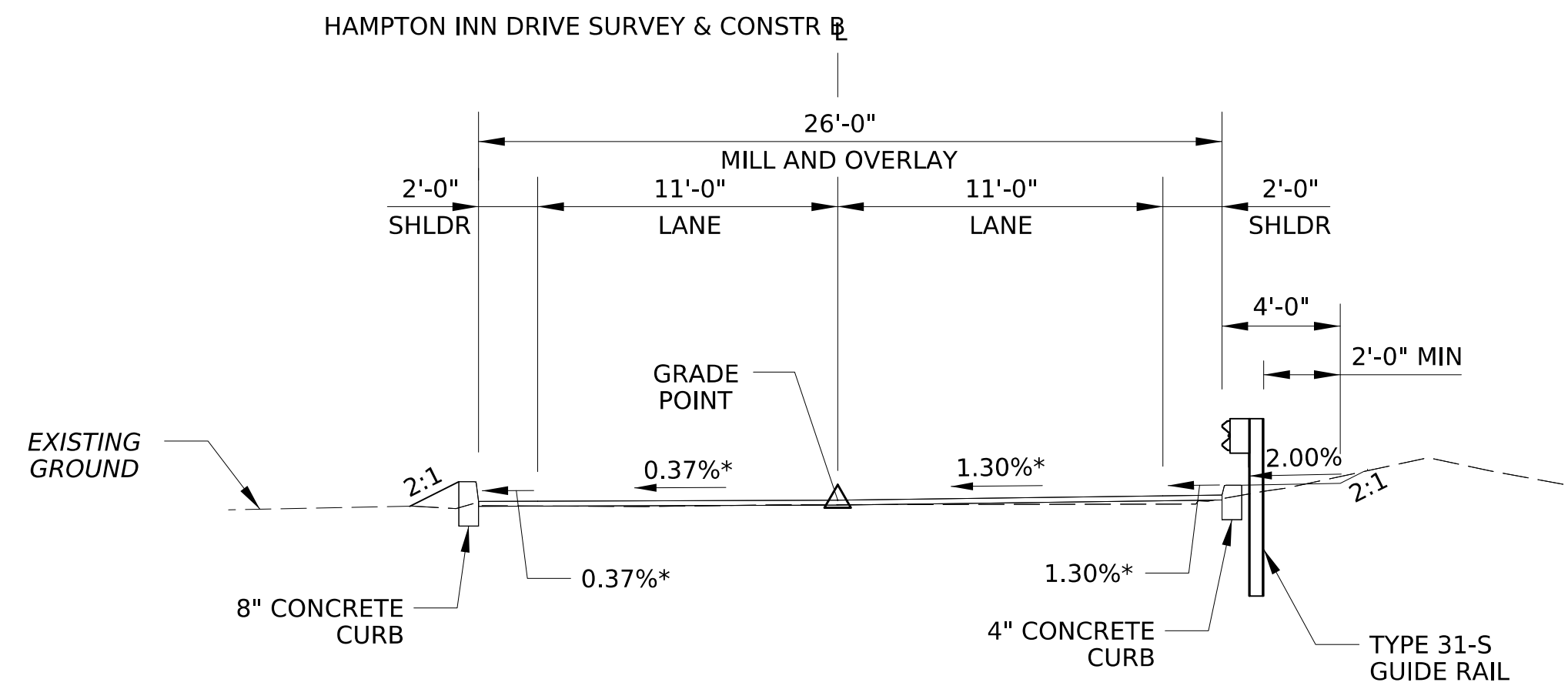

HAMPTON INN DRIVE
 TYPICAL ROADWAY SECTION,
 MILL AND OVERLAY
 STA. 101+00.00 TO STA. 101+74.47

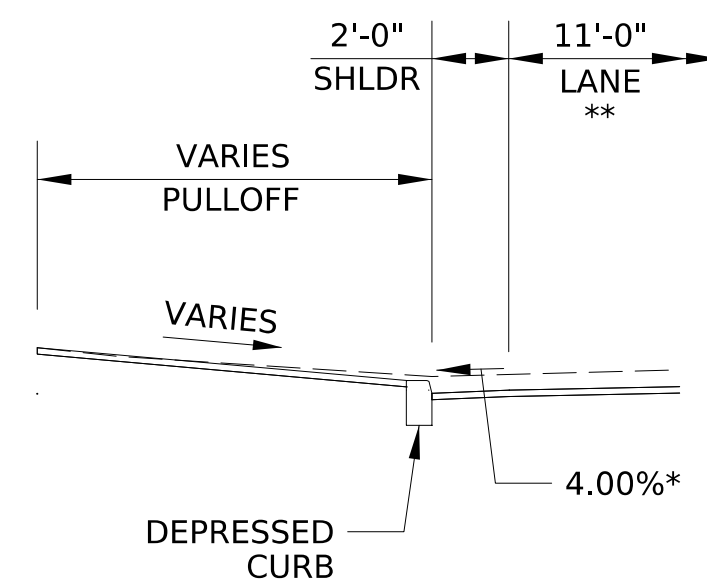

HAMPTON INN DRIVE
 PARTIAL SECTION
 PULLOFF, LT
 STA. 101+38.79 TO STA. 101+74.47

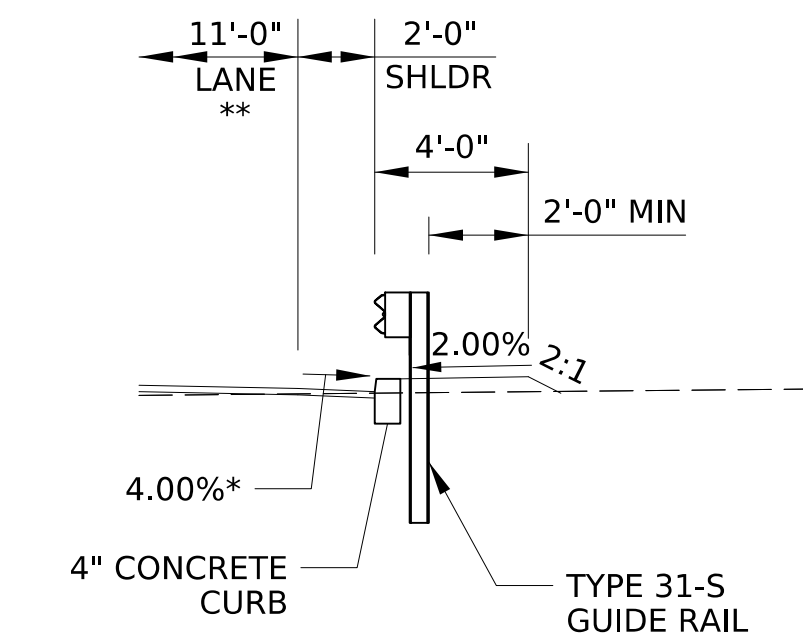

HAMPTON INN DRIVE
 PARTIAL SECTION
 2:1 FILL SLOPE WITH 4" CONCRETE
 CURB AND GUIDE RAIL, RT
 STA. 101+27.83 TO STA. 101+35.84

Exhibit "B"
 Line, Grade and Typical Section Plan
 Page 5 of 9

TYPICAL SECTIONS

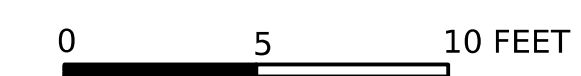

DISTRICT	COUNTY	ROUTE	SECTION	SHEET
11-0	ALLEGHENY	*	*	6 OF 9
GREEN TREE BOROUGH				
REV NO	REVISIONS	DATE	BY	APPD

* TRUMBULL DRIVE

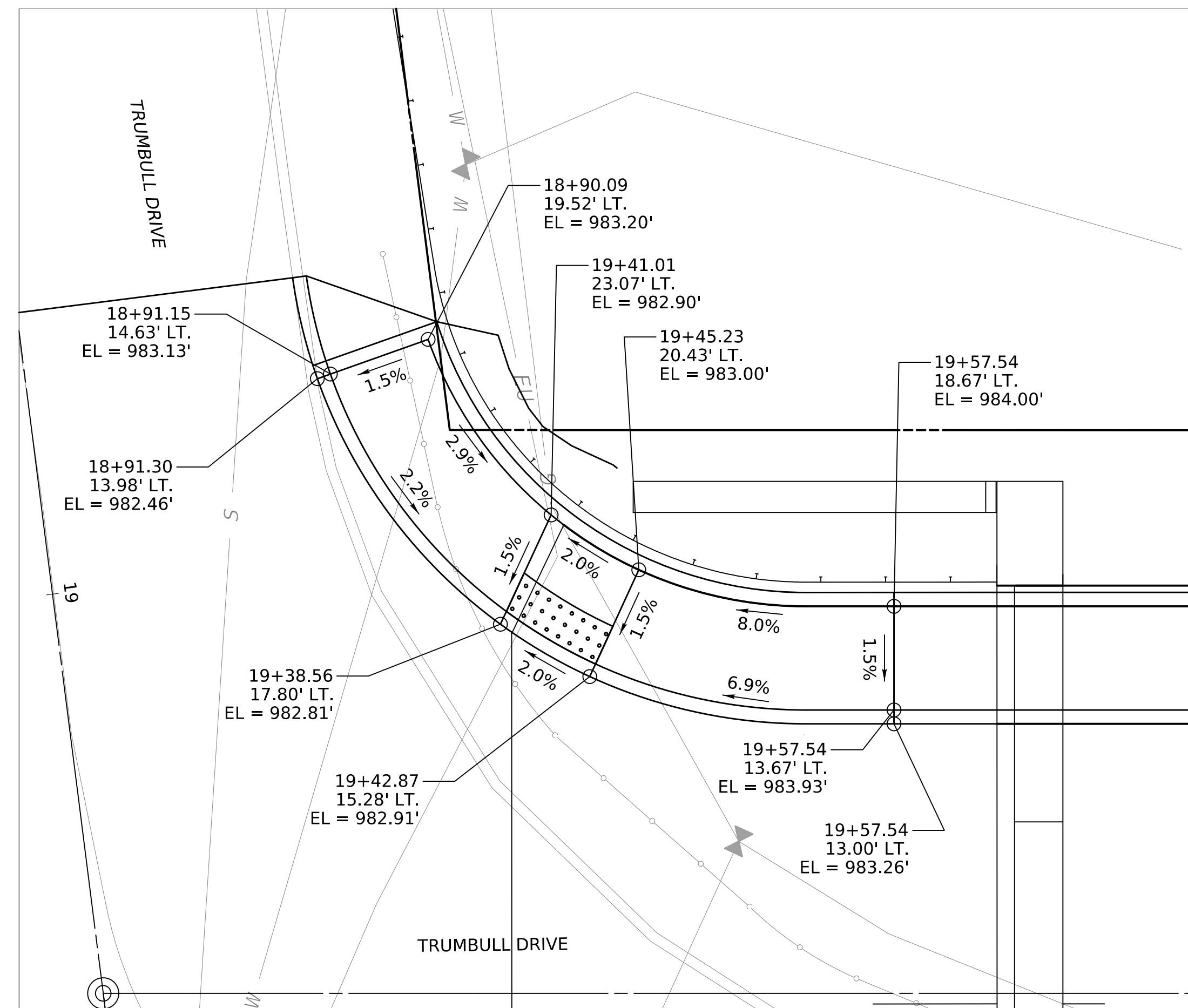
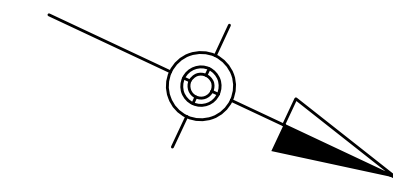
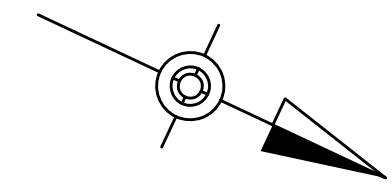

TRUMBULL DRIVE / HAMPTON INN DRIVE
ADA RAMP DESIGN
NORTHWEST QUADRANT

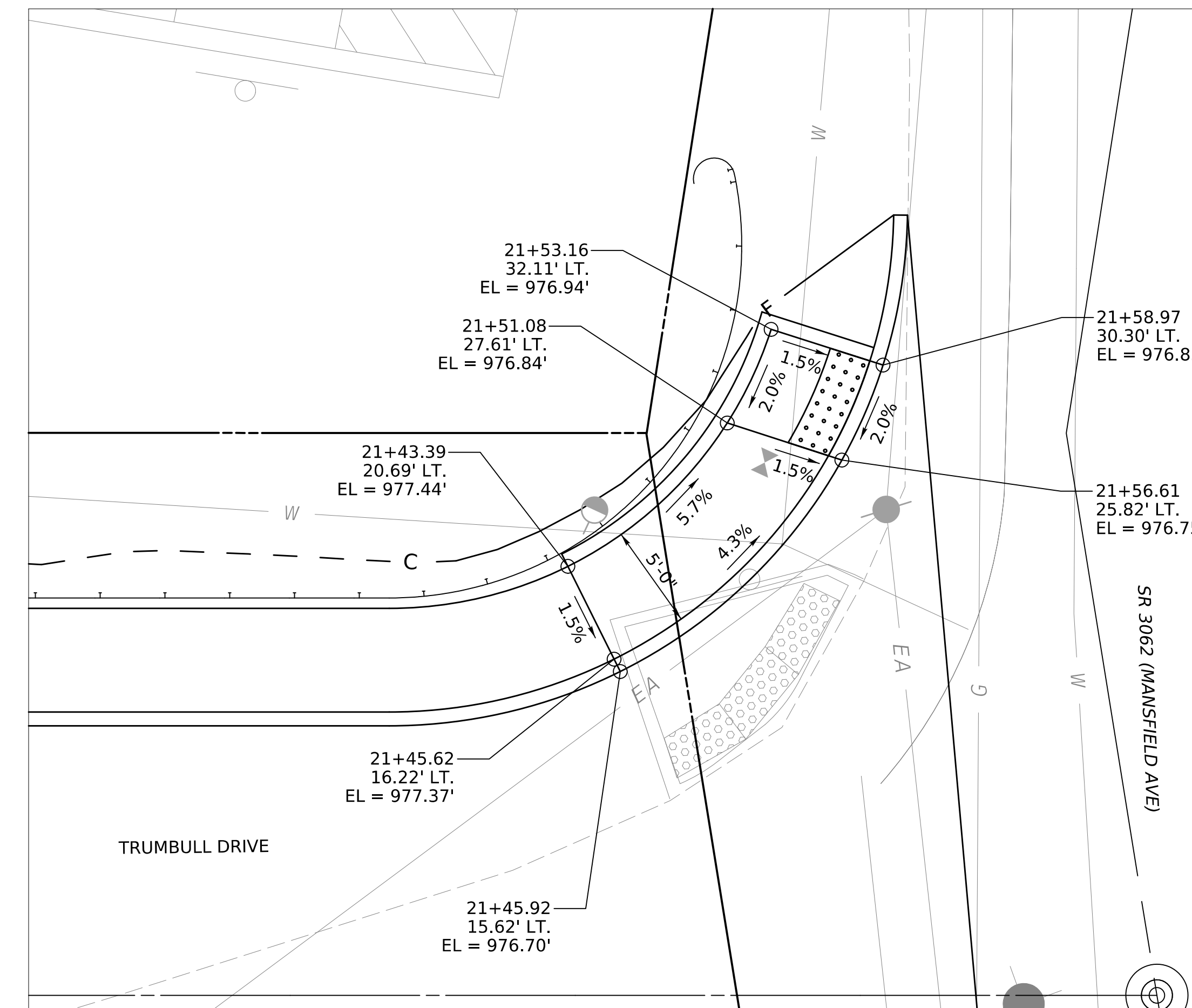

TRUMBULL DRIVE / SR 3062 (MANSFIELD AVENUE)
ADA RAMP DESIGN
SOUTHWEST QUADRANT

Exhibit "B"
Line, Grade and Typical Section Plan
Page 6 of 9

LEGEND

 DETECTABLE WARNING SURFACE

**SPECIAL DETAILS -
CURB RAMPS**

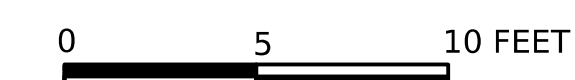

Exhibit "B"

Line, Grade and Typical Section Plan

Page 8 of 9

* TRUMBULL DRIVE

DISTRICT	COUNTY	ROUTE	SECTION	SHEET		
11-0	ALLEGHENY	*	*	8 OF 9		
GREEN TREE BOROUGH						
REV NO	REVISIONS			DATE	BY	APPD

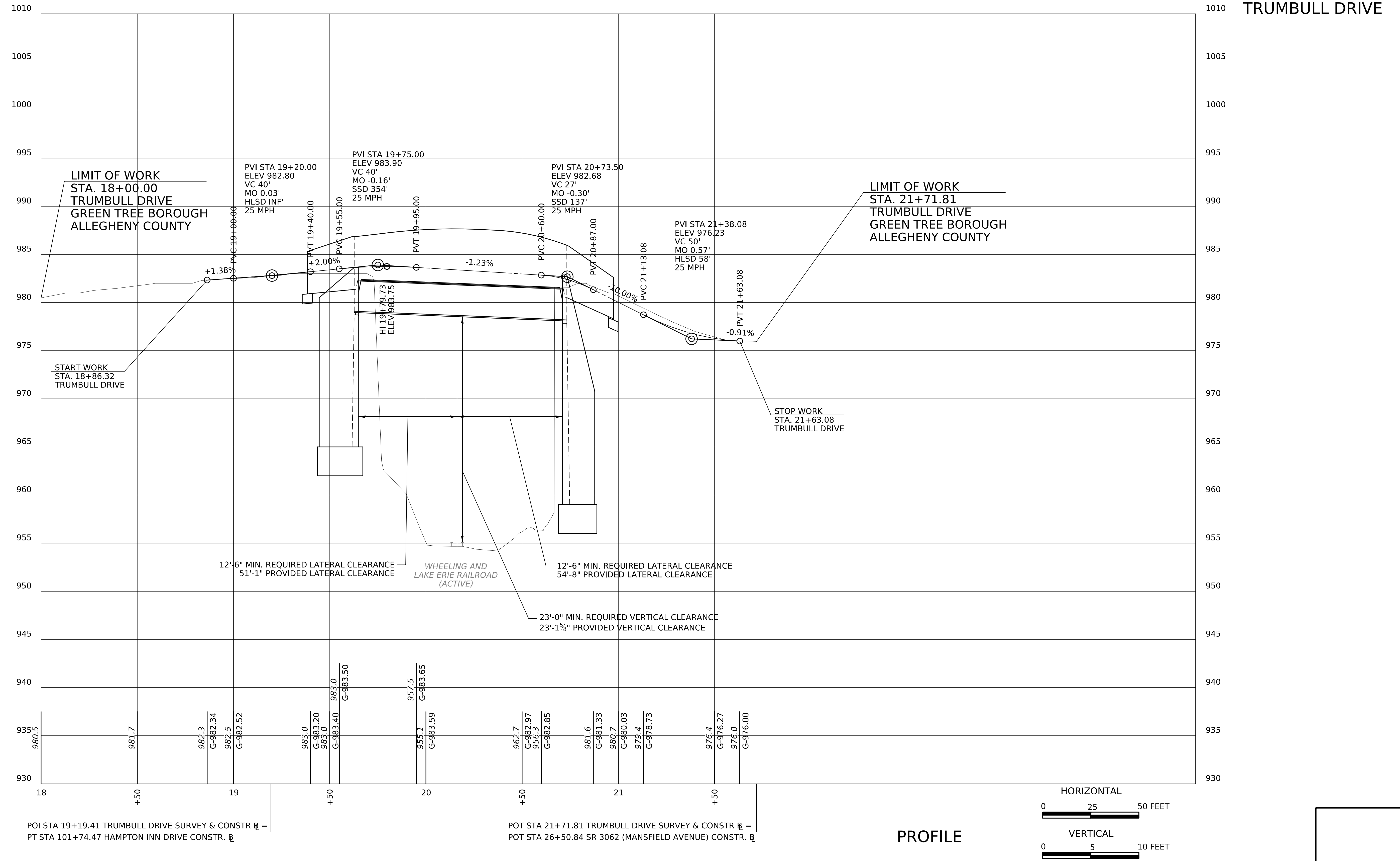

FOR TRUMBULL DRIVE PLAN SEE SHEET 7

p:\gfiles\aw_bentley.com\gfiles\pww-01\Documents\Projects\75699\96SHEETS\RD\WY\ROAD\TRUMBULL Profile Sheet
 12/14/2023
 9:27:16 AM

Exhibit "B"
Line, Grade and Typical Section Plan
 Page 9 of 9

* TRUMBULL DRIVE

DISTRICT	COUNTY	ROUTE	SECTION	SHEET
11-0	ALLEGHENY	*	*	9 OF 9
GREEN TREE BOROUGH				
REV NO	REVISIONS	DATE	BY	APPD

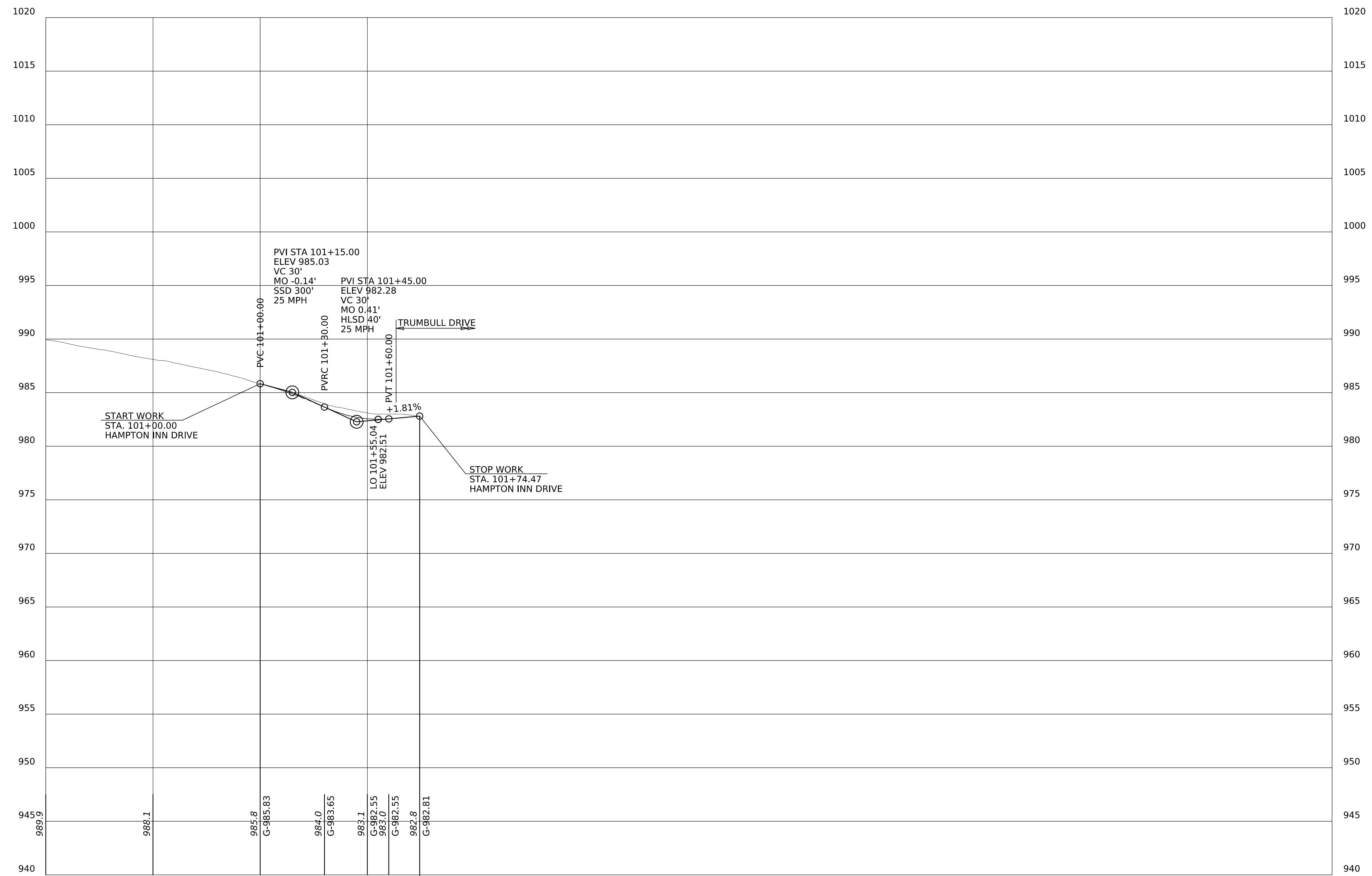

HAMPTON INN DRIVE

POI STA 19+19.41 TRUMBULL DRIVE SURVEY & CONSTR. =
 PT STA 101+74.47 HAMPTON INN DRIVE CONSTR. =

PROFILE

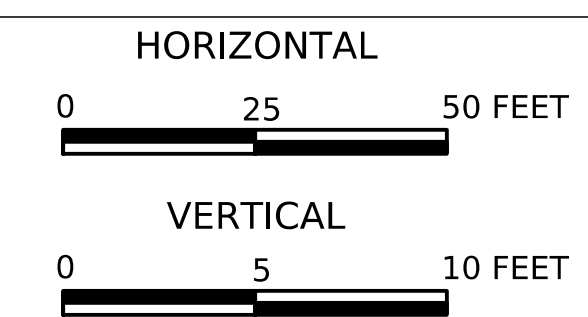

p:\gfiles\aw_bentley.com\gfiles\pww-01\Documents\Projects\75699\6SHEETS\RDWY\ROAD\Trumbull Profile Sheet
 12/14/2023
 9:27:17 AM

FOR HAMPTON INN DRIVE PROFILE SEE SHEET 7