



**Tamara Kelly, Esq.**

UGI Corporation  
500 North Gulph Road  
King of Prussia, PA 19406

Telephone: (610) 768-3628  
Email: [kellyt@ugicorp.com](mailto:kellyt@ugicorp.com)

November 13, 2024

**VIA E-FILING**

Rosemary Chiavetta, Secretary  
Pennsylvania Public Utility Commission  
Commonwealth Keystone Building  
400 North Street  
Harrisburg, PA 17120

**Re:** Application of UGI Utilities, Inc. - Gas Division for Approval to Retire in Place 100 Feet of 4-Inch Cast Iron Gas Main at DOT Rail Crossing No. 589535D Under the Tracks of Norfolk Southern Railway Company where the Tracks Cross Sixth Street Adjacent to Jubilee Street in the Borough of Emmaus, Lehigh County, Pennsylvania, **Docket No. A-**

Dear Secretary Chiavetta:

Enclosed for filing, please find the above-captioned application of UGI Utilities, Inc. - Gas Division. In accordance with Commission policy concerning rail highway crossings, there is no filing fee required for this application. Copies of this application have been filed upon the persons indicated on the attached Certificate of Service.

Should you have any questions concerning this application, please feel free to contact me.

Very truly yours,

  
\_\_\_\_\_  
Tamara Kelly  
Counsel for UGI Utilities, Inc. –  
Gas Division

Enclosures: Certificate of Service  
Cc via email: Alex Myers, UGI Utilities, Inc. – Gas Division

**BEFORE THE  
PENNSYLVANIA PUBLIC UTILITY COMMISSION**

Application of UGI Utilities, Inc. - Gas :  
Division for Approval to Retire in Place 100 :  
Feet of 4-Inch Cast Iron Gas Main at DOT :  
Rail Crossing No. 589535D Under the Tracks :  
of Norfolk Southern Railway Company where :  
the Tracks Cross Sixth Street Adjacent to : Docket No. A -  
Jubilee Street in the Borough of Emmaus, :  
Lehigh County, Pennsylvania :

**To the Pennsylvania Public Utility Commission:**

1. The name and address of applicant are:

UGI Utilities, Inc. - Gas Division  
2121 City Line Rd  
Bethlehem, PA 18017

2. The name and address of applicant's attorney is:

Tamara Kelly  
(Attorney I.D. 316360)  
500 North Gulph Road  
King of Prussia, PA 19406  
kellyt@ugicorp.com  
Office: (610) 768-3628

3. UGI Utilities, Inc. - Gas Division ("UGI" or "Applicant") is a public utility that provides gas service to approximately 684,000 retail customers located in portions of 46 eastern and central Pennsylvania counties.

4. UGI desires approval to retire in place one hundred feet (100') of four inch (4") cast iron gas main buried under the tracks of Norfolk Southern Railway Company where the tracks cross Sixth Street, adjacent to Jubilee Street, in the Borough of Emmaus, Lehigh County, Pennsylvania, as shown on Exhibit A hereto.

5. This removal will not require surface excavation within the Norfolk Southern right-of-way because the gas main will be retired in place. UGI will perform cuts to introduce air and vent the gas outside the bounds of the Norfolk Southern right-of-way.

6. Emmaus Borough currently has underground facilities in the vicinity of the crossing. Governmental entities, corporations or property owners potentially concerned in or affected by the proposed crossing are:

Norfolk Southern Railway Company Kyle Adams Property Manager (Lehigh County) <a href="mailto:kyle.adams@nscorp.com">kyle.adams@nscorp.com</a>	Lumen Lumen Operator Personnel <a href="mailto:relocations@lumen.com">relocations@lumen.com</a>
Service Electric Cable TV Rich Perich <a href="mailto:rperich@sectv.com">rperich@sectv.com</a>	Emmaus Borough Water and Sewer Lawrence Carl <a href="mailto:LCARL@EEMAUSPA.GOV">LCARL@EEMAUSPA.GOV</a>
PennDOT Engineering District 05 – Lehigh County 1712 Lehigh St. Allentown, PA 18103	Emmaus Borough Mayor Lee Ann Gilbert 28 S 4 <sup>th</sup> St Emmaus, PA 18049 <a href="mailto:gilbert@emmauspa.gov">gilbert@emmauspa.gov</a>
PPL Electric Utilities Corporation Dough Haupt <a href="mailto:dlhaupt@pplweb.com">dlhaupt@pplweb.com</a>	County of Lehigh Rick Molchany Director of General Services Lehigh County Government Center 17 South Seventh Street Allentown PA 18101 610-782-3613 <a href="mailto:RickMolchany@lehighcounty.org">RickMolchany@lehighcounty.org</a>
Pennsylvania Department of Transportation Karen Cummings Senior Counsel Pennsylvania Department of Transportation Office of Chief Counsel 9th Floor P.O. Box 8212 Harrisburg, PA 17105-8212 <a href="mailto:kcummings@pa.gov">kcummings@pa.gov</a>	Dan Leonard Chief ROW Utility Division Pennsylvania Department of Transportation P.O. Box 3362 Harrisburg, PA 17105-3362 <a href="mailto:danleonard@pa.gov">danleonard@pa.gov</a>
Pennsylvania Public Utility Commission Rodney D. Bender, P.E. Manager, Rail Safety Division Bureau of Transportation & Safety Pennsylvania Public Utility Commission P.O. Box 3265 Harrisburg, PA 17120 <a href="mailto:rodbender@pa.gov">rodbender@pa.gov</a>	

7. Applicant has not had to acquire property to retire the existing gas line.

8. Applicant agrees to bear all the costs incurred in furnishing material and performing the work necessary to retire in place the proposed gas line. The proposed cost of this project is \$800,000.00.

9. Applicant avers that this crossing alteration is necessary and proper since the retirement of existing cast iron pipeline is part of UGI's efforts to replace aging infrastructure.

10. Applicant intends that this work will begin by December 15, 2024 with an anticipated end date of March 30, 2025.

WHEREFORE, UGI Utilities, Inc. - Gas Division requests respectfully that the Commission approve this application.

Respectfully submitted,

  
\_\_\_\_\_  
Tamara Kelly

Counsel for UGI Utilities, Inc. –  
Gas Division

Dated: November 13, 2024

**BEFORE THE  
PENNSYLVANIA PUBLIC UTILITY COMMISSION**

Application of UGI Utilities, Inc. - Gas :  
Division for Approval to Retire in Place 100 :  
Feet of 4-Inch Cast Iron Gas Main at DOT :  
Rail Crossing No. 589535D Under the Tracks :  
of Norfolk Southern Railway Company where :  
the Tracks Cross Sixth Street Adjacent to : Docket No. A -  
Jubilee Street in the Borough of Emmaus, :  
Lehigh County, Pennsylvania :

**VERIFICATION**

I, Alex Myers, Engineer I for UGI Utilities, Inc. - Gas Division hereby state that the facts above set forth are true and correct to the best of my knowledge, information and belief and that I expect to be able to prove the same at a hearing held in this matter. I understand that the statements herein are made subject to the penalties of 18 Pa.C.S. §4904 (relating to unsworn falsification to authorities).



Name: Alex Myers

Date: November 13, 2024

# **EXHIBIT A**

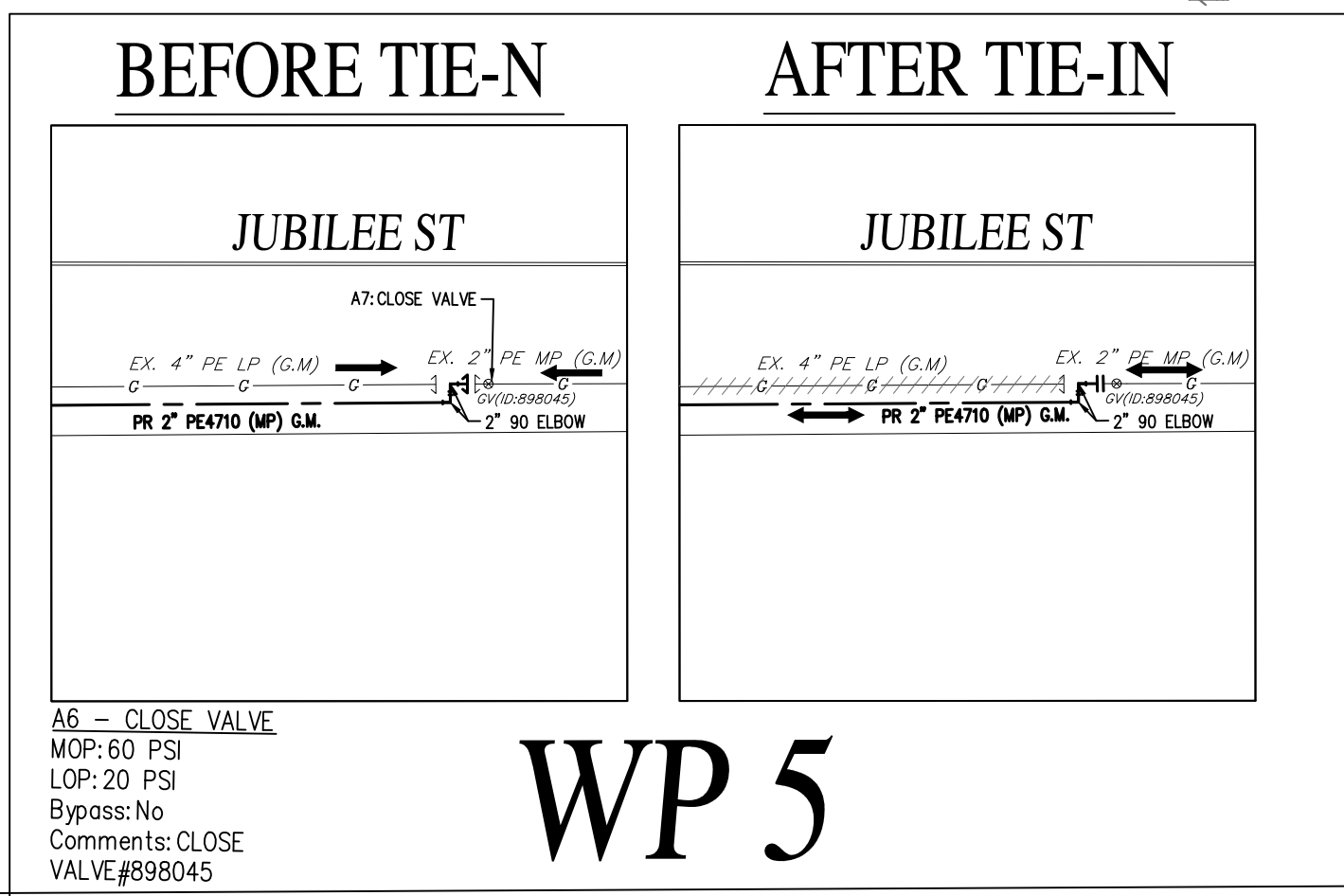
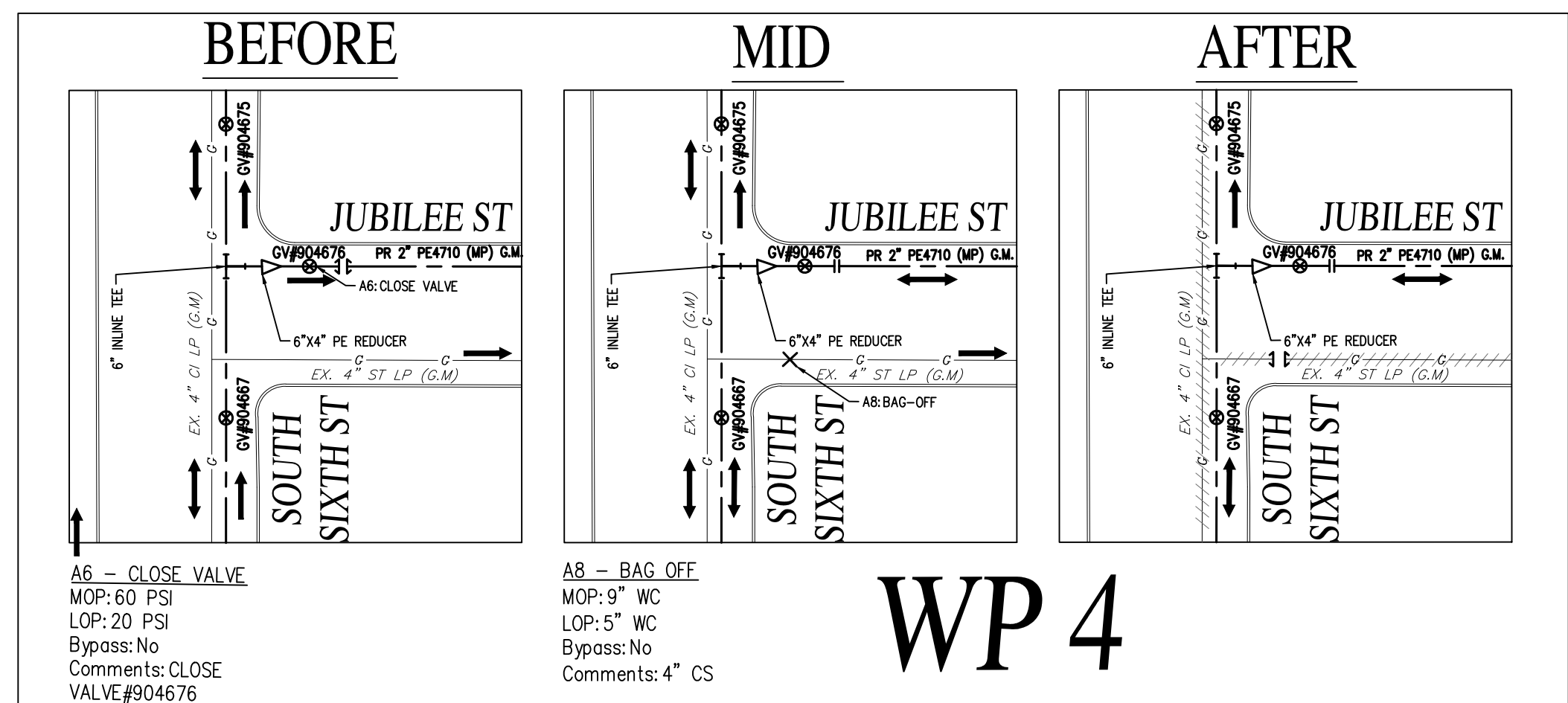
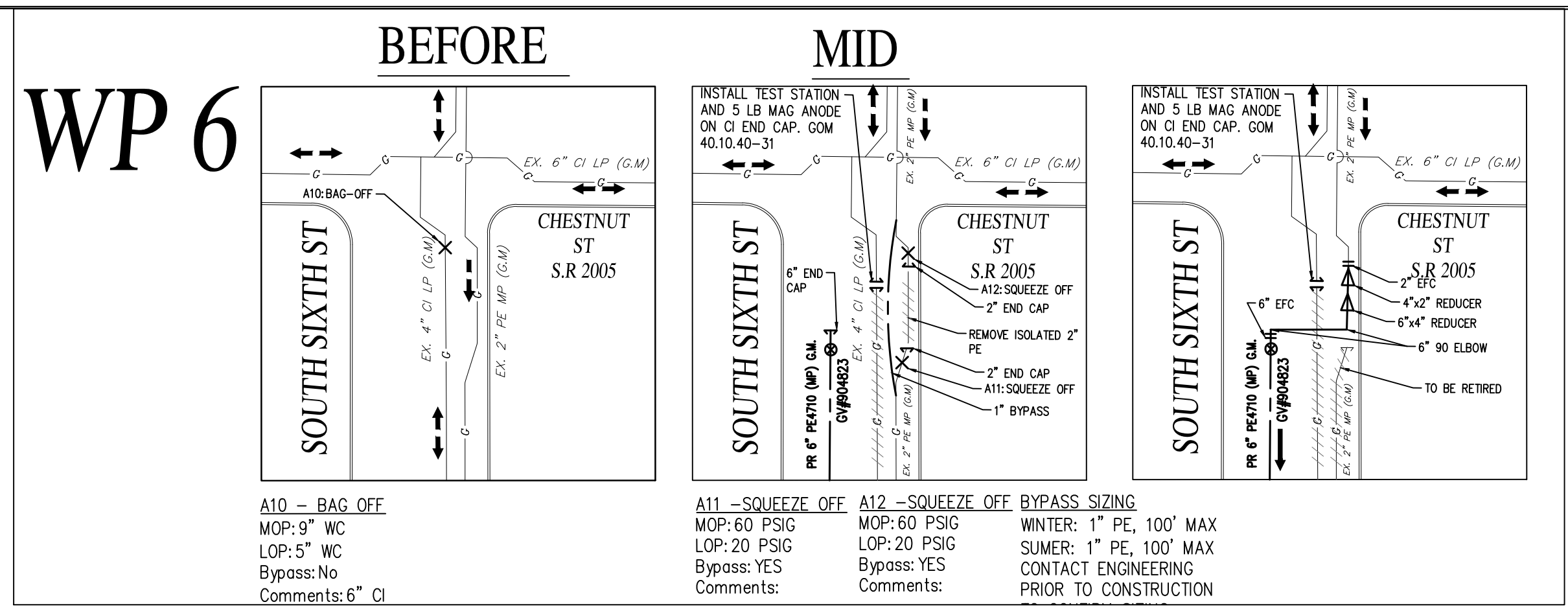
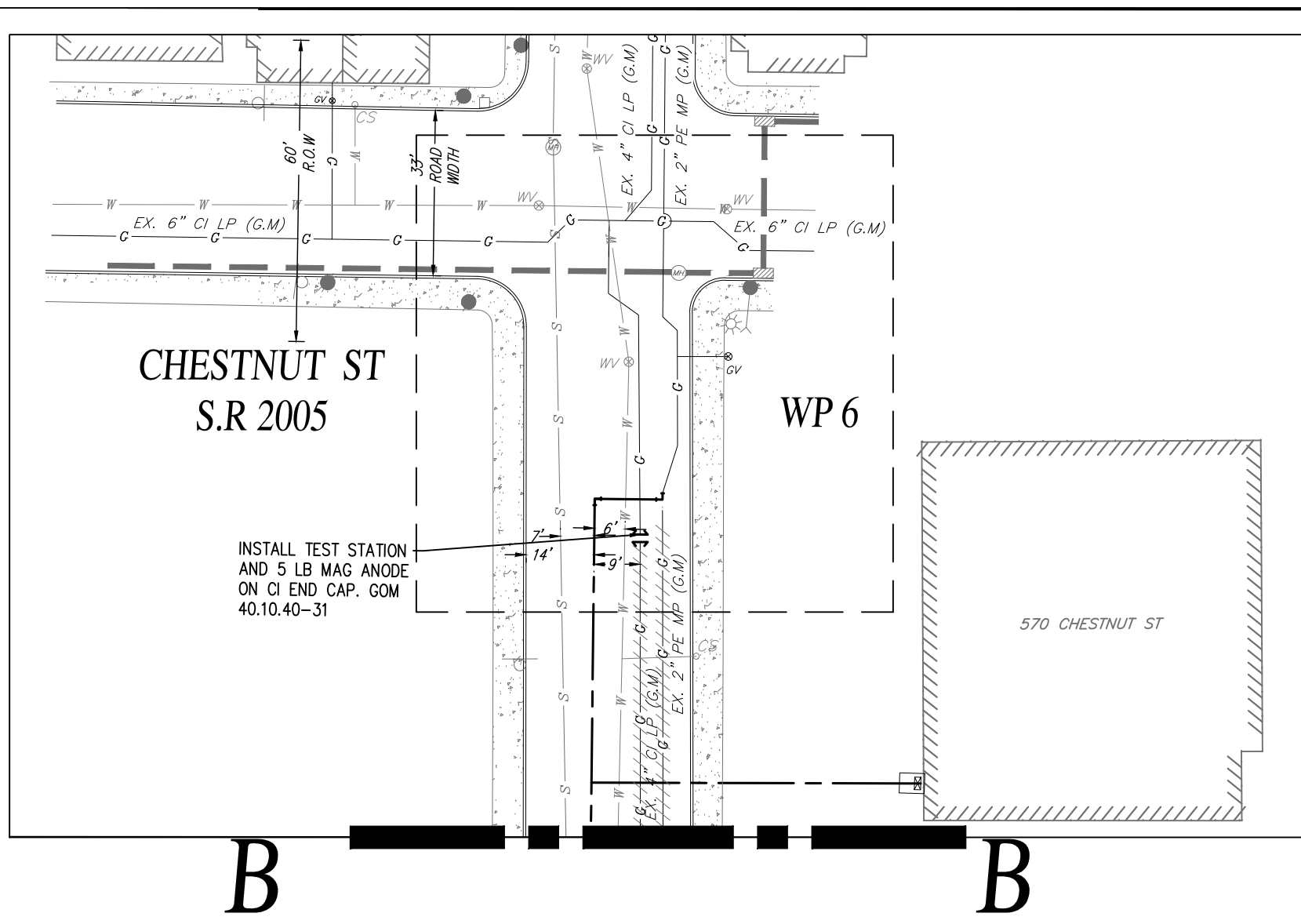
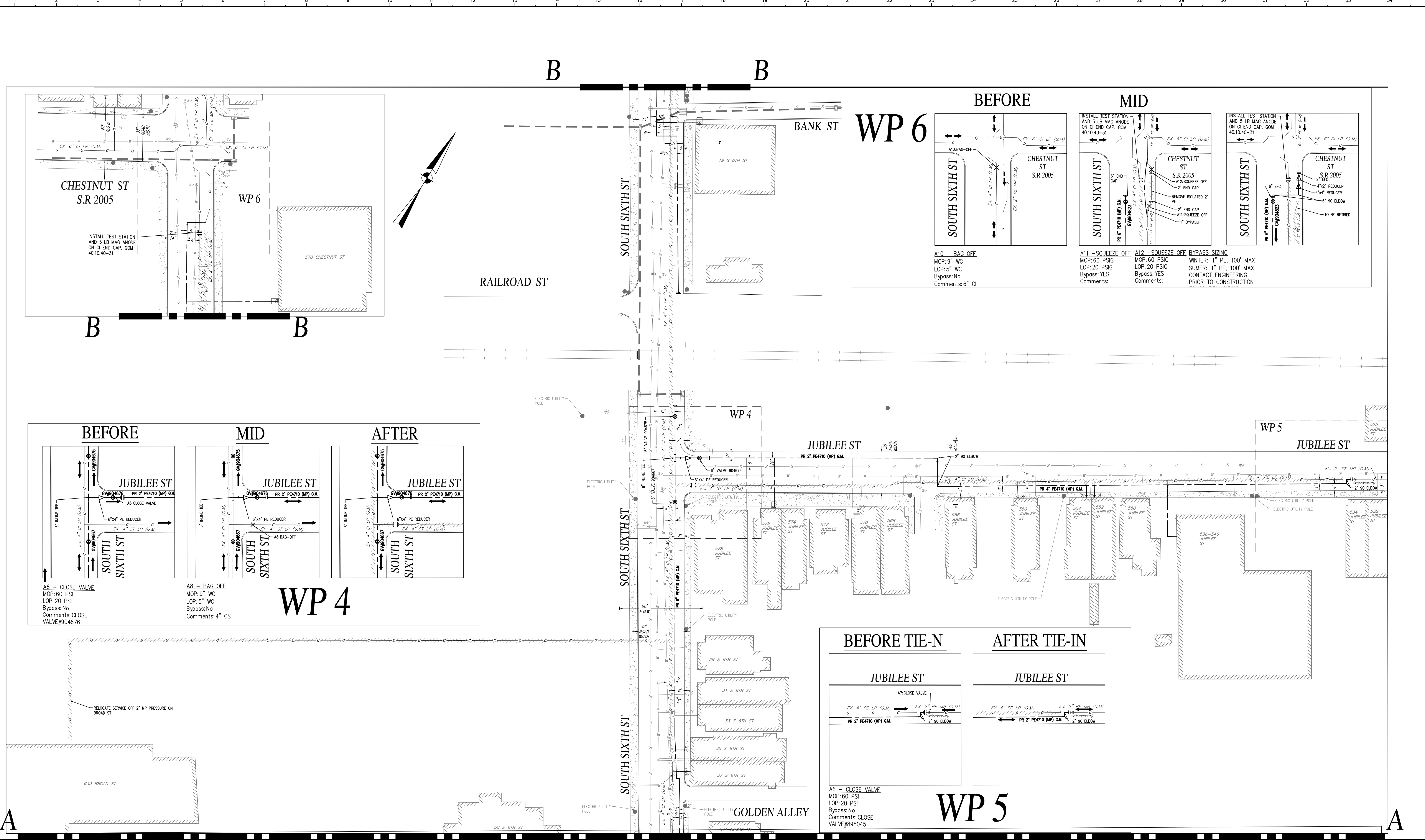

**100 BLK 6TH ST  
GAS MAIN REPLACEMENT  
EMMAUS BOROUGH  
LEHIGH COUNTY, PA**

BUDGET LINE #: B018390  
SO #: 9000017186

SIZE	MATERIAL	METHOD	WORK REQUEST NO.	SAP
2"	PE4710	DB	315846	1003253479
4"	PE4710	DB	302264	1003253482
6"	PE4710	DB	315609	1003253481
		SERVICES	315941	1003263962

CD-01

SECTION 1

SHEET 7 OF 11

Nov 05, 2024 1:05pm G:\ALL\HIGH ENGINEERING\Sameer\_Mir\100 Blk 6th St Emmaus\100 Blk 6th St.dwg

**BEFORE THE  
PENNSYLVANIA PUBLIC UTILITY COMMISSION**

Application of UGI Utilities, Inc. - Gas :  
 Division for Approval to Retire in Place 100 :  
 Feet of 4-Inch Cast Iron Gas Main at DOT :  
 Rail Crossing No. 589535D Under the Tracks :  
 of Norfolk Southern Railway Company where :  
 the Tracks Cross Sixth Street Adjacent to : Docket No. A -  
 Jubilee Street in the Borough of Emmaus, :  
 Lehigh County, Pennsylvania :

**CERTIFICATE OF SERVICE**

I hereby certify that I have, this 13<sup>th</sup> day of November, 2024, served a true and correct copy of the foregoing document in the manner and upon the persons listed below in accordance with requirements of 52 Pa. Code §1.54 (relating to service by a participant):

**VIA E-MAIL AND FIRST CLASS MAIL:**

Norfolk Southern Railway Company Kyle Adams Property Manager (Lehigh County) <a href="mailto:kyle.adams@nscorp.com">kyle.adams@nscorp.com</a>	Lumen Lumen Operator Personnel <a href="mailto:relocations@lumen.com">relocations@lumen.com</a>
Service Electric Cable TV Rich Perich <a href="mailto:rperich@sectv.com">rperich@sectv.com</a>	Emmaus Borough Water and Sewer Lawrence Carl <a href="mailto:LCARL@EEMAUSPA.GOV">LCARL@EEMAUSPA.GOV</a>
PennDOT Engineering District 05 – Lehigh County 1712 Lehigh St. Allentown, PA 18103	Emmaus Borough Mayor Lee Ann Gilbert 28 S 4 <sup>th</sup> St Emmaus, PA 18049 <a href="mailto:gilbert@emmauspa.gov">gilbert@emmauspa.gov</a>
PPL Electric Utilities Corporation Dough Haupt <a href="mailto:dlhaupt@pplweb.com">dlhaupt@pplweb.com</a>	County of Lehigh Rick Molchany Director of General Services Lehigh County Government Center 17 South Seventh Street Allentown PA 18101 610-782-3613 <a href="mailto:RickMolchany@lehighcounty.org">RickMolchany@lehighcounty.org</a>

<p>Pennsylvania Department of Transportation Karen Cummings Senior Counsel Pennsylvania Department of Transportation Office of Chief Counsel 9th Floor P.O. Box 8212 Harrisburg, PA 17105-8212 <a href="mailto:kcummings@pa.gov">kcummings@pa.gov</a></p>	<p>Dan Leonard Chief ROW Utility Division Pennsylvania Department of Transportation P.O. Box 3362 Harrisburg, PA 17105-3362 <a href="mailto:danleonard@pa.gov">danleonard@pa.gov</a></p>
<p>Pennsylvania Public Utility Commission Rodney D. Bender, P.E. Manager, Rail Safety Division Bureau of Transportation &amp; Safety Pennsylvania Public Utility Commission P.O. Box 3265 Harrisburg, PA 17120 <a href="mailto:rodbender@pa.gov">rodbender@pa.gov</a></p>	

*Tamara Kelly*  
\_\_\_\_\_  
Tamara Kelly