



165 Beach Lake Highway

Honesdale, Pennsylvania 18431

November 19, 2024

Ms. Rosemary Chiavetta, Secretary
Pennsylvania Public Utility Commission
P.O. Box 3265
Harrisburg, PA 17105-3265

**RE: APPLICATION FOR PUBLIC CROSSING
At 264157K, FERRY STREET,
NORTH SHORE RAILROAD COMPANY
BOROUGH OF DANVILLE
COUNTY OF MONTOUR**

Dear Secretary Chiavetta,

In accordance with Public Utility Code, Title 66, Chapter 2702, enclosed please find an application requesting permission to alter crossing of **North Shore Railroad Company**. Said crossing will be within the public right of way confines of **Ferry Street**. It is located in the Borough of Danville, Montour County.

Said crossing will consist of the alteration of the overhead wires over the track of the **North Shore Railroad Company** tracks and right of way. The **poles and overhead cables and conductors** are located within Public Right of Way. This is an existing crossing **264157K**.

PPL Electric Utilities will provide copies of same to all parties listed under its Certificate of Service.

Please review and provide the appropriate authorization to this office. Should you have any questions please contact this office.

Should you have any questions please contact this office.

Sincerely,

Dustin Stockholm

Dustin Stockholm
Supervisor - Right of Way

Enclosures

cc: Rodney D. Bender, P.E.
Chief-Bureau of Rail Safety
PA Public Utility Commission
P.O. Box 3265
Harrisburg, PA 17105-3265

BEFORE

PENNSYLVANIA PUBLIC UTILITY COMMISSION

In re: Application of PPL Electric Utilities for approval of the alteration of the crossing # 264157K by the raising of overhead secondary wires where Ferry Street crosses at grade the tracks of North Shore Railroad Company, located in Danville Borough in Montour County.

Application

Docket No.

To Pennsylvania Public Utility Commission:

1. The name and address of applicant are:

PPL Electric Utilities Corporation

Two North Ninth Street

GENN3

Allentown, PA 18101

2. The name and address of the applicant's attorney are Mallory Jane Sweeney, Associate General Counsel, PPL Electric Utilities Corporation, Two North Ninth Street, Allentown, PA 18101-1179

3. PPL Electric Utilities wishes to raise power facilities over the North Shore Railroad Company track in Danville Borough, Montour County to County, PA to support existing and future loading conditions. Aerial cables that cross North Shore Railroad Company track within the public right of way of Ferry Street are to be raised to meet clearance requirements. The above ground facilities to be replaced are at PPL pole number 31325N29205.

4. The proposed construction will be the raising of a power conductor at an existing utility pole on the northeastern side of the railroad crossing. The facility will be aerial. Ferry Street intersects the railroad at grade. See attached Exhibit "A". The proposed completion date for this project is February 26, 2025.

5. The public utilities, municipalities, corporations and property owners concerned in, or affected by, the crossing alteration are identified in Exhibit "B" attached hereto

6. The expected cost for the construction procedure is \$10,000. PPL Electric Utilities will pay all costs of construction or alteration of the facility, as well as be responsible for installing, maintaining and inspecting the facilities.

7. The alteration is necessary or proper for the following reasons: to provide adequate, efficient, and reasonable communication facilities and power to the public in Montour County and surrounding areas.

Wherefore, applicant prays your Honorable Commission to approve the application:

Dustin Stockholm

Dustin Stockholm

Supervisor – Right of Way

§ 1.36. Verification.

(a) Applications, petitions, formal complaints, motions and answers thereto containing an averment of fact not appearing of record in the action or containing a denial of fact shall be personally verified by a party thereto or by an authorized officer of the party if a corporation or association. Verification means a signed written statement of fact supported by oath or affirmation or made subject to the penalties of 18 Pa. C.S. §4904 (relating to unsworn falsification to authorities). If verification is required, notarization is not necessary.

(b) The Verification form should comply substantially with the following:

VERIFICATION

I, Dustin Stockholm, hereby state that the facts above set forth are true and correct (or are true and correct to the best of my knowledge, information and belief) and that I expect to be able to prove the same at a hearing held in this matter. I understand that the statements herein are made subject to the penalties of 18 Pa. C.S. § 4904 (relating to unsworn falsification to authorities).

Date: November 19, 2024

Dustin Stockholm

(Signature)

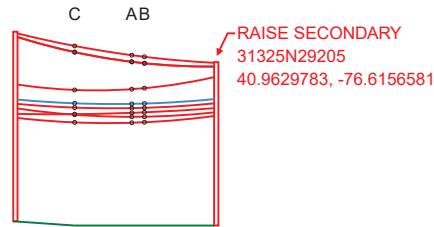
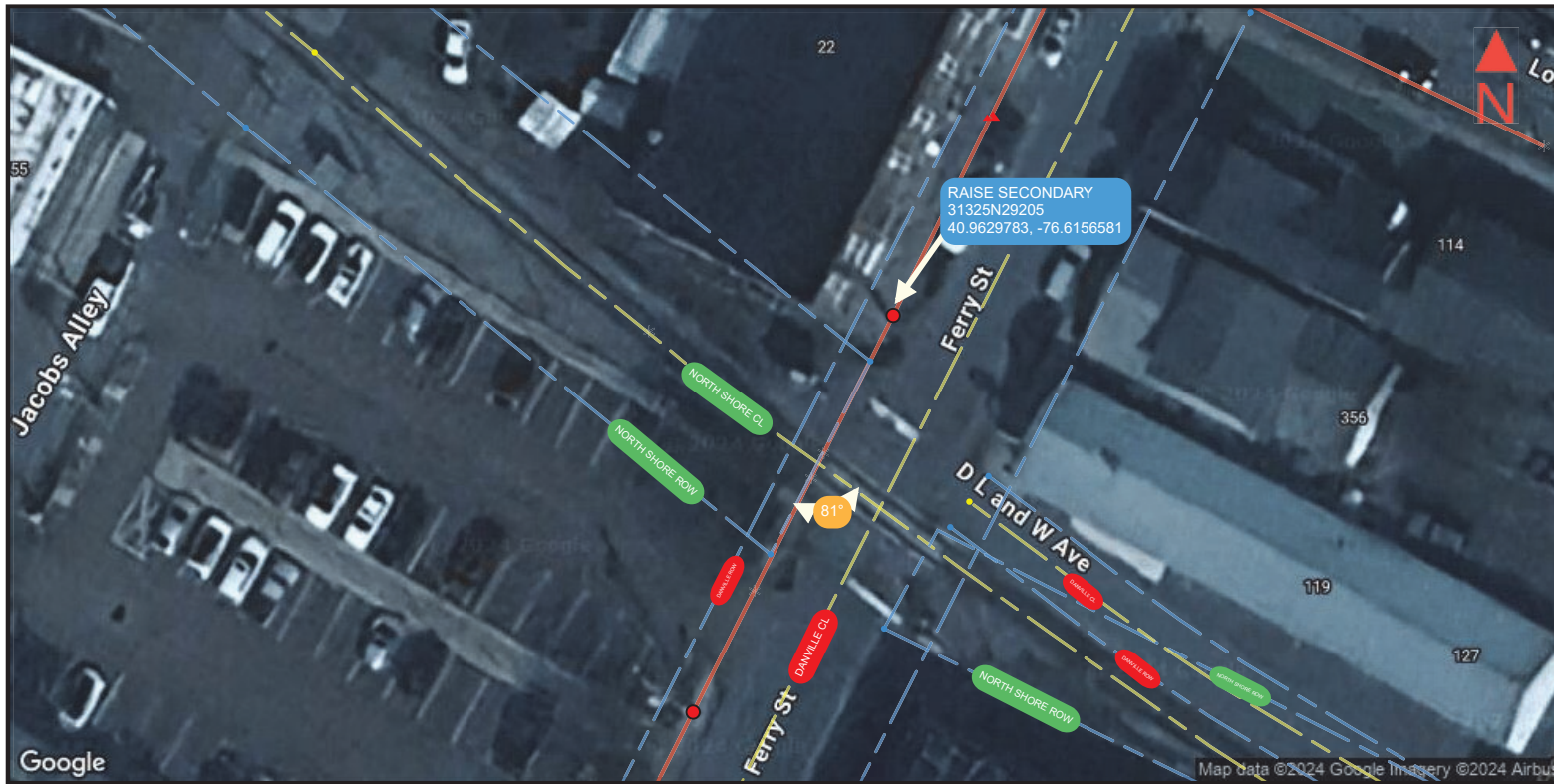

CABLES	WIRE SPEC	A			B			C		
		EXISTING	PROPOSED	MAX SAG	EXISTING	PROPOSED	MAX SAG	EXISTING	PROPOSED	MAX SAG
Primary	336 AAC 60 MIL XLP (19/0)	38'-7"	38'-7"	35'-11"	40'-10"	40'-10"	38'-2"	42'-3"	42'-3"	39'-7"
Primary (2)	336 AAC 60 MIL XLP (19/0)	37'-4"	37'-4"	34'-8"	39'-2"	39'-2"	36'-7"	40'-7"	40'-7"	38'-0"
Secondary	4/0 TPLX SECD (6/1)	30'-1"	31'-3"	28'-5"	31'-6"	32'-10"	30'-1"	31'-3"	31'-10"	29'-0"
Proposed Fiber Optic Com		--	28'-0"	26'-1"	--	29'-1"	27'-1"	--	28'-9"	26'-9"
Fiber Optic Com		27'-0"	27'-0"	25'-2"	28'-1"	28'-1"	26'-3"	27'-9"	27'-9"	25'-11"
CATV Com		25'-11"	25'-11"	24'-0"	26'-11"	26'-11"	25'-0"	26'-2"	26'-2"	24'-3"
Telco Com		25'-0"	25'-0"	23'-3"	25'-10"	25'-10"	24'-0"	26'-2"	26'-2"	24'-4"
Telco Com		23'-9"	23'-9"	22'-7"	24'-6"	24'-6"	23'-5"	24'-3"	24'-3"	23'-2"



PREPARED BY:				
	COUNTY: Montour County	STATE: Pennsylvania	DATE: 14-11-2024	DRAWN BY:
TITLE: 307543	PROJECT NO:	PRINT NO: 1	NO. OF PRINTS: 1	ENGINEERED BY: KATAPULT
FILENAME: EXHIBIT A				

CERTIFICATE OF SERVICE

I hereby certify that I have this day served a true copy of the foregoing document upon the participants, listed below, in accordance with the requirements of § 1.54 (relating to service by participant).

Mark Chappel, P.E. - Chief
Bureau Project Delivery
P.O. Box 3362
Harrisburg, PA 17105-3362
marchappel@pa.gov

Verizon
Engineering/Permitting
1026 Hay Street
Wilkinsburg, PA 15221
Matthew.w.kehr@verizon.com

Karen Cummings - Office of Chief Counsel
PennDOT
P.O. Box 8212
Harrisburg, PA 17105-8212
kcummings@pa.gov

CTSI – Frontier
Mary Rodman
100 CTE Drive
Dallas, PA 18612
PA.Structure.Access@ftr.com

PennDOT Engineering District 3-0
Cory Kodish
715 Jordan Avenue
P.O. Box 218
Montoursville, PA 17754
ckodish@pa.gov

Service Electric Cablevision
Mike LuBuda
15 J. Campbell Collins Drive
Wilkes-Barre, PA 18702
labudam@sect.com

Montour County
Attn: Heather Brandon – Chief Clerk
435 East Front Street
Danville, PA 17821
Hbrandon@montourcounty.gov

Level 3 Fiber Optic Communications
1025 Eldorado Boulevard
Broomfield, Colorado 80021
Paul.erickson@lumen.com

Danville Borough
Brindy Mordan
463 Mill Street
Danville, PA 17821
bmordan@danvilleboro.org

Dustin Stockholm
Supervisor – Right of Way
PPL Electric Utilities Corp.
165 Beach Lake Highway
Honesdale, PA 18431
Dstockholm@pplweb.com

North Shore Railroad Company
356 Priestly Avenue
Northumberland, PA 17857
kpostupack@seda-cog.org

Dated this 19th day of November 2024.

Dustin Stockholm

(Signature)

EXHIBIT "B"

The public utilities, municipalities, corporations, and property owners concerned in, or affected by, the crossing alteration are:

Mark Chappel, P.E. - Chief
Bureau Project Delivery
P.O. Box 3362
Harrisburg, PA 17105-3362
marchappel@pa.gov

Karen Cummings - Office of Chief Counsel
PennDOT
P.O. Box 8212
Harrisburg, PA 17105-8212
kcummings@pa.gov

PennDOT Engineering District 3-0
Cory Kodish
715 Jordan Avenue
P.O. Box 218
Montoursville, PA 17754
ckodish@pa.gov

Montour County
Attn: Heather Brandon – Chief Clerk
435 East Front Street
Danville, PA 17821
Hbrandon@montourcounty.gov

Danville Borough
Brindy Mordan
463 Mill Street
Danville, PA 17821
bmordan@danvilleboro.org

North Shore Railroad Company
356 Priestly Avenue
Northumberland, PA 17857
kpostupack@seda-cog.org

Verizon
Engineering/Permitting
1026 Hay Street
Wilkinsburg, PA 15221
Matthew.w.kehr@verizon.com

CTSI – Frontier
Mary Rodman
100 CTE Drive
Dallas, PA 18612
PA.Structure.Access@ftr.com

Service Electric Cablevision
Mike LuBuda
15 J. Campbell Collins Drive
Wilkes-Barre, PA 18702
labudam@sect.com

Level 3 Fiber Optic Communications
1025 Eldorado Boulevard
Broomfield, Colorado 80021
Paul.erickson@lumen.com

Dustin Stockholm
Supervisor – Right of Way
PPL Electric Utilities Corp.
165 Beach Lake Highway
Honesdale, PA 18431
Dstockholm@pplweb.com

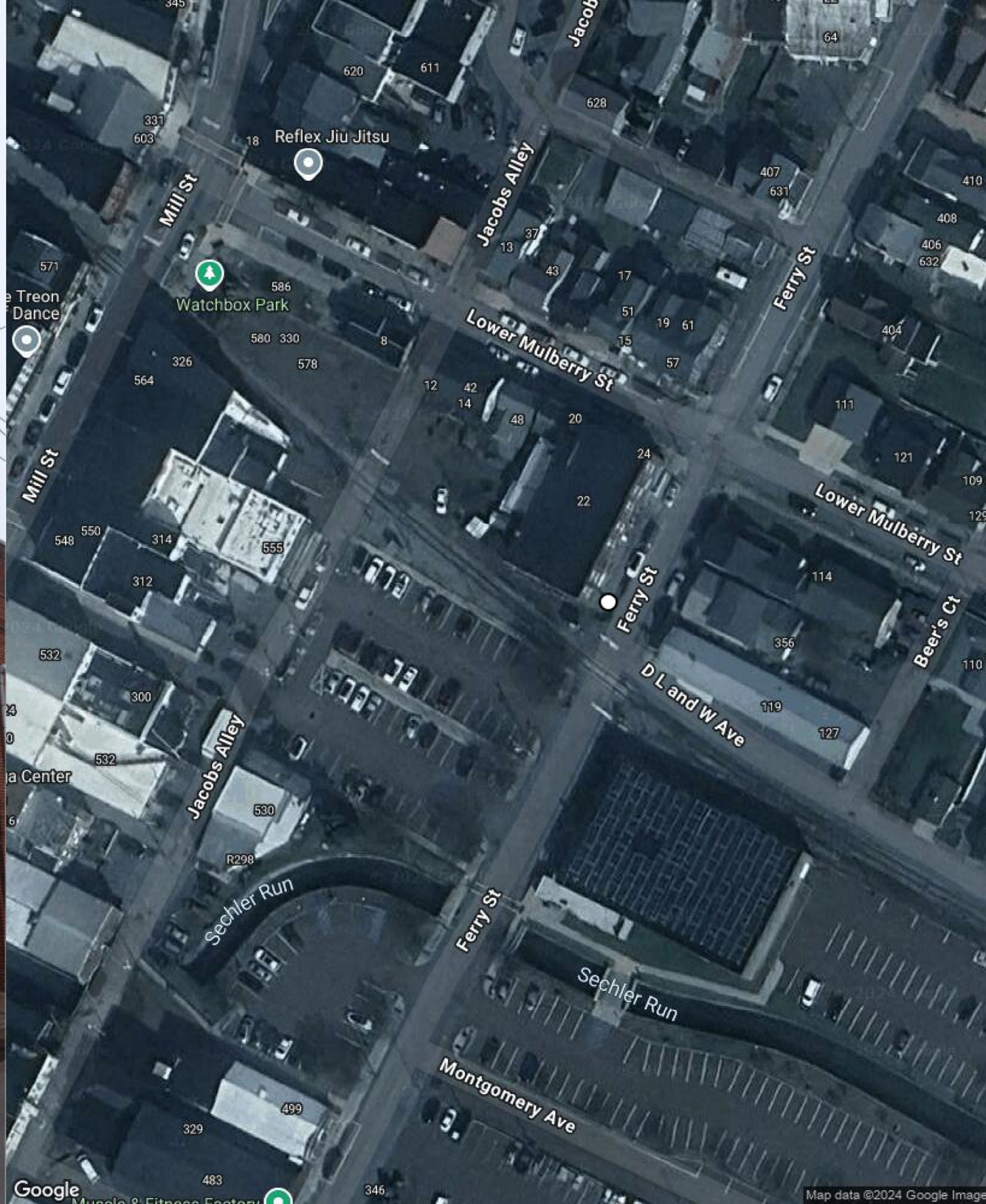

U. S. DOT CROSSING INVENTORY FORM

DEPARTMENT OF TRANSPORTATION
FEDERAL RAILROAD ADMINISTRATION

OMB No. 2130-0017

Instructions for the initial reporting of the following types of new or previously unreported crossings: For public highway-rail grade crossings, complete the entire inventory Form. For private highway-rail grade crossings, complete the Header, Parts I and II, and the Submission Information section. For public pathway grade crossings (including pedestrian station grade crossings), complete the Header, Parts I and II, and the Submission Information section. For Private pathway grade crossings, complete the Header, Parts I and II, and the Submission Information section. For grade-separated highway-rail or pathway crossings (including pedestrian station crossings), complete the Header, Part I, and the Submission Information section. For changes to existing data, complete the Header, Part I Items 1-3, and the Submission Information section, in addition to the updated data fields. Note: For private crossings only, Part I Item 20 and Part III Item 2.K. are required unless otherwise noted. An asterisk * denotes an optional field.

A. Revision Date (MM/DD/YYYY) 01 / 08 / 2024	B. Reporting Agency <input checked="" type="checkbox"/> Railroad <input type="checkbox"/> Transit <input type="checkbox"/> State <input type="checkbox"/> Other	C. Reason for Update (Select only one) <input type="checkbox"/> Change in Data <input type="checkbox"/> Re-Open <input type="checkbox"/> New Crossing <input checked="" type="checkbox"/> Date Change Only <input type="checkbox"/> Closed <input type="checkbox"/> Change in Primary Operating RR <input type="checkbox"/> No Train Traffic <input type="checkbox"/> Quiet Zone Update <input type="checkbox"/> Admin. Correction	D. DOT Crossing Inventory Number 264157K
---	--	--	--

Part I: Location and Classification Information

1. Primary Operating Railroad North Shore Railroad [NSHR]	2. State PENNSYLVANIA	3. County MONTOUR			
4. City / Municipality <input checked="" type="checkbox"/> In <input type="checkbox"/> Near DANVILLE	5. Street/Road Name & Block Number FERRY STREET (Street/Road Name) * (Block Number)	6. Highway Type & No. LS			
7. Do Other Railroads Operate a Separate Track at Crossing? <input type="checkbox"/> Yes <input checked="" type="checkbox"/> No If Yes, Specify RR	8. Do Other Railroads Operate Over Your Track at Crossing? <input type="checkbox"/> Yes <input checked="" type="checkbox"/> No If Yes, Specify RR				
9. Railroad Division or Region <input checked="" type="checkbox"/> None	10. Railroad Subdivision or District <input checked="" type="checkbox"/> None	11. Branch or Line Name <input type="checkbox"/> None NORTH SHORE	12. RR Milepost 0201.92 (prefix) (nnnn.nnn) (suffix)		
13. Line Segment *	14. Nearest RR Timetable Station * DANVILLE	15. Parent RR (if applicable) <input type="checkbox"/> N/A NSHR	16. Crossing Owner (if applicable) <input type="checkbox"/> N/A SDAC		
17. Crossing Type <input checked="" type="checkbox"/> Public <input type="checkbox"/> Private	18. Crossing Purpose <input checked="" type="checkbox"/> Highway <input type="checkbox"/> Pathway, Ped. <input type="checkbox"/> Station, Ped.	19. Crossing Position <input checked="" type="checkbox"/> At Grade <input type="checkbox"/> RR Under <input type="checkbox"/> RR Over	20. Public Access (if Private Crossing) <input type="checkbox"/> Yes <input checked="" type="checkbox"/> No	21. Type of Train <input checked="" type="checkbox"/> Freight <input type="checkbox"/> Intercity Passenger <input type="checkbox"/> Commuter <input type="checkbox"/> Transit <input type="checkbox"/> Shared Use Transit <input type="checkbox"/> Tourist/Other	22. Average Passenger Train Count Per Day <input type="checkbox"/> Less Than One Per Day <input type="checkbox"/> Number Per Day 0
23. Type of Land Use <input type="checkbox"/> Open Space <input type="checkbox"/> Farm <input type="checkbox"/> Residential <input checked="" type="checkbox"/> Commercial <input type="checkbox"/> Industrial <input type="checkbox"/> Institutional <input type="checkbox"/> Recreational <input type="checkbox"/> RR Yard					
24. Is there an Adjacent Crossing with a Separate Number? <input type="checkbox"/> Yes <input checked="" type="checkbox"/> No If Yes, Provide Crossing Number			25. Quiet Zone (FRA provided) <input checked="" type="checkbox"/> No <input type="checkbox"/> 24 Hr <input type="checkbox"/> Partial <input type="checkbox"/> Chicago Excused Date Established		
26. HSR Corridor ID <input checked="" type="checkbox"/> N/A	27. Latitude in decimal degrees (WGS84 std: nn.nnnnnnn) 40.9628562	28. Longitude in decimal degrees (WGS84 std: -nnn.nnnnnnn) -76.6156563	29. Lat/Long Source <input checked="" type="checkbox"/> Actual <input type="checkbox"/> Estimated		
30.A. Railroad Use *			31.A. State Use *		
30.B. Railroad Use *			31.B. State Use *		
30.C. Railroad Use *			31.C. State Use *		
30.D. Railroad Use *			31.D. State Use *		
32.A. Narrative (Railroad Use) *			32.B. Narrative (State Use) *		
33. Emergency Notification Telephone No. (posted) 877-635-2929		34. Railroad Contact (Telephone No.) 570-473-7949		35. State Contact (Telephone No.) 717-772-3079	

Part II: Railroad Information

1. Estimated Number of Daily Train Movements				
1.A. Total Day Thru Trains (6 AM to 6 PM) 2	1.B. Total Night Thru Trains (6 PM to 6 AM) 0	1.C. Total Switching Trains 0	1.D. Total Transit Trains 0	1.E. Check if Less Than One Movement Per Day How many trains per week? <input type="checkbox"/>
2. Year of Train Count Data (YYYY) 2021		3. Speed of Train at Crossing 3.A. Maximum Timetable Speed (mph) 10 3.B. Typical Speed Range Over Crossing (mph) From 5 to 10		
4. Type and Count of Tracks Main 1 Siding 0 Yard 0 Transit 0 Industry 0				
5. Train Detection (Main Track only) <input type="checkbox"/> Constant Warning Time <input type="checkbox"/> Motion Detection <input type="checkbox"/> AFO <input type="checkbox"/> PTC <input checked="" type="checkbox"/> DC <input type="checkbox"/> Other <input type="checkbox"/> None				
6. Is Track Signaled? <input type="checkbox"/> Yes <input checked="" type="checkbox"/> No		7.A. Event Recorder <input type="checkbox"/> Yes <input checked="" type="checkbox"/> No		7.B. Remote Health Monitoring <input type="checkbox"/> Yes <input checked="" type="checkbox"/> No

U. S. DOT CROSSING INVENTORY FORM

A. Revision Date (MM/DD/YYYY) 01/08/2024		PAGE 2		D. Crossing Inventory Number (7 char.) 264157K	
Part III: Highway or Pathway Traffic Control Device Information					
1. Are there Signs or Signals? <input checked="" type="checkbox"/> Yes <input type="checkbox"/> No		2. Types of Passive Traffic Control Devices associated with the Crossing			
2.A. Crossbuck Assemblies (count) 2		2.B. STOP Signs (R1-1) (count) 0	2.C. YIELD Signs (R1-2) (count) 0	2.D. Advance Warning Signs (Check all that apply; include count) <input type="checkbox"/> None <input checked="" type="checkbox"/> W10-1 2 <input type="checkbox"/> W10-3 _____ <input type="checkbox"/> W10-11 _____ <input type="checkbox"/> W10-2 _____ <input type="checkbox"/> W10-4 _____ <input type="checkbox"/> W10-12 _____	
2.E. Low Ground Clearance Sign (W10-5) <input type="checkbox"/> Yes (count _____) <input checked="" type="checkbox"/> No		2.F. Pavement Markings <input checked="" type="checkbox"/> Stop Lines <input type="checkbox"/> Dynamic Envelope <input type="checkbox"/> RR Xing Symbols <input type="checkbox"/> None		2.G. Channelization Devices/Medians <input type="checkbox"/> All Approaches <input type="checkbox"/> Median <input type="checkbox"/> One Approach <input checked="" type="checkbox"/> None	2.H. EXEMPT Sign (R15-3) <input type="checkbox"/> Yes <input checked="" type="checkbox"/> No
2.I. ENS Sign (I-13) Displayed <input checked="" type="checkbox"/> Yes <input type="checkbox"/> No		2.J. Other MUTCD Signs <input type="checkbox"/> Yes <input checked="" type="checkbox"/> No Specify Type _____ Count _____ Specify Type _____ Count _____ Specify Type _____ Count _____		2.K. Private Crossing Signs (if private) <input type="checkbox"/> Yes <input type="checkbox"/> No	2.L. LED Enhanced Signs (List types) NONE
3. Types of Train Activated Warning Devices at the Grade Crossing (specify count of each device for all that apply)					
3.A. Gate Arms (count) Roadway 0 Pedestrian _____	3.B. Gate Configuration <input type="checkbox"/> 2 Quad <input type="checkbox"/> Full (Barrier) Resistance <input type="checkbox"/> 3 Quad <input type="checkbox"/> Median Gates	3.C. Cantilevered (or Bridged) Flashing Light Structures (count) Over Traffic Lane 0 <input type="checkbox"/> Incandescent Not Over Traffic Lane 0 <input type="checkbox"/> LED		3.D. Mast Mounted Flashing Lights (count of masts) 2 <input type="checkbox"/> Incandescent <input checked="" type="checkbox"/> LED <input checked="" type="checkbox"/> Back Lights Included <input type="checkbox"/> Side Lights Included	3.E. Total Count of Flashing Light Pairs 4
3.F. Installation Date of Current Active Warning Devices: (MM/YYYY) _____/_____/_____ <input checked="" type="checkbox"/> Not Required		3.G. Wayside Horn <input type="checkbox"/> Yes Installed on (MM/YYYY) ____/____/_____ <input checked="" type="checkbox"/> No		3.H. Highway Traffic Signals Controlling Crossing <input type="checkbox"/> Yes <input checked="" type="checkbox"/> No	3.I. Bells (count) 1
3.J. Non-Train Active Warning <input type="checkbox"/> Flagging/Flagman <input type="checkbox"/> Manually Operated Signals <input type="checkbox"/> Watchman <input type="checkbox"/> Floodlighting <input checked="" type="checkbox"/> None				3.K. Other Flashing Lights or Warning Devices Count 0 Specify type _____	
4.A. Does nearby Hwy Intersection have Traffic Signals? <input type="checkbox"/> Yes <input checked="" type="checkbox"/> No	4.B. Hwy Traffic Signal Interconnection <input checked="" type="checkbox"/> Not Interconnected <input type="checkbox"/> For Traffic Signals <input type="checkbox"/> For Warning Signs	4.C. Hwy Traffic Signal Preemption <input type="checkbox"/> Simultaneous <input type="checkbox"/> Advance	5. Highway Traffic Pre-Signals <input type="checkbox"/> Yes <input checked="" type="checkbox"/> No Storage Distance * _____ Stop Line Distance * _____	6. Highway Monitoring Devices (Check all that apply) <input type="checkbox"/> Yes - Photo/Video Recording <input type="checkbox"/> Yes - Vehicle Presence Detection <input checked="" type="checkbox"/> None	
Part IV: Physical Characteristics					
1. Traffic Lanes Crossing Railroad Number of Lanes 2 <input type="checkbox"/> One-way Traffic <input checked="" type="checkbox"/> Two-way Traffic <input type="checkbox"/> Divided Traffic		2. Is Roadway/Pathway Paved? <input checked="" type="checkbox"/> Yes <input type="checkbox"/> No	3. Does Track Run Down a Street? <input type="checkbox"/> Yes <input checked="" type="checkbox"/> No	4. Is Crossing Illuminated? (Street lights within approx. 50 feet from nearest rail) <input checked="" type="checkbox"/> Yes <input type="checkbox"/> No	
5. Crossing Surface (on Main Track, multiple types allowed) Installation Date * (MM/YYYY) ____/____/_____ <input type="checkbox"/> 1 Timber <input type="checkbox"/> 2 Asphalt <input type="checkbox"/> 3 Asphalt and Timber <input type="checkbox"/> 4 Concrete <input checked="" type="checkbox"/> 5 Concrete and Rubber <input type="checkbox"/> 6 Rubber <input type="checkbox"/> 7 Metal <input type="checkbox"/> 8 Unconsolidated <input type="checkbox"/> 9 Composite <input type="checkbox"/> 10 Other (specify) _____ Width * 10 Length * 36					
6. Intersecting Roadway within 500 feet? <input checked="" type="checkbox"/> Yes <input type="checkbox"/> No If Yes, Approximate Distance (feet) 5			7. Smallest Crossing Angle <input type="checkbox"/> 0° - 29° <input type="checkbox"/> 30° - 59° <input checked="" type="checkbox"/> 60° - 90°		8. Is Commercial Power Available? * <input checked="" type="checkbox"/> Yes <input type="checkbox"/> No
Part V: Public Highway Information					
1. Highway System <input type="checkbox"/> (01) Interstate Highway System <input type="checkbox"/> (02) Other Nat Hwy System (NHS) <input type="checkbox"/> (03) Federal AID, Not NHS <input checked="" type="checkbox"/> (08) Non-Federal Aid		2. Functional Classification of Road at Crossing <input type="checkbox"/> (0) Rural <input checked="" type="checkbox"/> (1) Urban <input type="checkbox"/> (1) Interstate <input type="checkbox"/> (5) Major Collector <input type="checkbox"/> (2) Other Freeways and Expressways <input type="checkbox"/> (3) Other Principal Arterial <input type="checkbox"/> (6) Minor Collector <input type="checkbox"/> (4) Minor Arterial <input checked="" type="checkbox"/> (7) Local		3. Is Crossing on State Highway System? <input type="checkbox"/> Yes <input checked="" type="checkbox"/> No	4. Highway Speed Limit System 25 MPH <input checked="" type="checkbox"/> Posted <input type="checkbox"/> Statutory
5. Linear Referencing System (LRS Route ID) *					
6. LRS Milepost *					
7. Annual Average Daily Traffic (AADT) Year 2009 AADT 000887		8. Estimated Percent Trucks 03 %	9. Regularly Used by School Buses? <input type="checkbox"/> Yes <input checked="" type="checkbox"/> No Average Number per Day _____		10. Emergency Services Route <input type="checkbox"/> Yes <input type="checkbox"/> No
Submission Information - This information is used for administrative purposes and is not available on the public website.					
Submitted by _____ Organization _____ Phone _____ Date _____					
Public reporting burden for this information collection is estimated to average 30 minutes per response, including the time for reviewing instructions, searching existing data sources, gathering and maintaining the data needed and completing and reviewing the collection of information. According to the Paperwork Reduction Act of 1995, a federal agency may not conduct or sponsor, and a person is not required to, nor shall a person be subject to a penalty for failure to comply with, a collection of information unless it displays a currently valid OMB control number. The valid OMB control number for information collection is 2130-0017. Send comments regarding this burden estimate or any other aspect of this collection, including for reducing this burden to: Information Collection Officer, Federal Railroad Administration, 1200 New Jersey Ave. SE, MS-25 Washington, DC 20590.					