

**DOCUMENT TRANSMITTAL FORM**  
Copies of Railroad Crossing Application Documentation

---

**To:** The Secretary of the Commission  
Pennsylvania Public Utility Commission  
400 North Street  
Harrisburg, PA 17120

**From:** Randy Whitehead, Vice President, Regulatory Affairs & Underlying Rights  
FastBridge Fiber, LLC  
1050 Spring Street, Suite 2  
Wyomissing, PA 19610

**Date:** December 30, 2024

**RE:** Railroad Crossing Application documentation package, as required by  
the Pennsylvania Public Utilities Code.  
**PUC Docket Number:** Pending assignment by the PUC.

---

**DOCUMENTS ENCLOSED HEREWITH:**

1. This Document Transmittal Form.
2. Railroad Crossing Application.
3. Certificate of Service.
4. Verification Form.
5. RR Crossing Design Prints.
6. U.S. DOT RR Crossing Inventory Report Form.

**TO WHOM IT MAY CONCERN:**

The enclosed Railroad Crossing Application document package (the "Application") is being submitted to the Pennsylvania Public Utilities Commission (PUC) for processing in accordance with the Public Utility Code by FastBridge Fiber, LLC (the "Applicant"). Please direct any questions, comments, directions, or other correspondence concerning the contents hereof to the Applicant as indicated below:

**FastBridge Fiber, LLC**  
**Randy Whitehead, Vice President - Regulatory Affairs & Underlying Rights**  
Office (610) 956-9958 / Mobile (303) 547-6736  
**randy.whitehead@fastbridgefiber.com**  
1050 Spring Street, Suite 2  
Wyomissing, PA 19610

**BEFORE**  
**PENNSYLVANIA PUBLIC UTILITY COMMISSION**

In re: Application of FastBridge Fiber, LLC  
for approval of the alteration of the crossing  
264153H by the installation of a Fiber  
Optics wire line where Wall Street crosses  
at grade the tracks of North Shore Railroad,  
located in Danville in Montoursville  
County, PA.

Application  
Docket No. \_\_\_\_\_

**To: Pennsylvania Public Utility Commission**

1. The name and address of applicant are:

FastBridge Fiber, LLC  
1050 Spring Street, Suite 2  
Wyomissing, PA 19610

PA Public Utility Code: 3125259

2. The name and address of applicant's attorney are:

Randy Whitehead, Attorney-in-Fact  
Vice President - Regulatory Affairs & Underlying Rights  
FastBridge Fiber, LLC  
1050 Spring Street, Suite 2  
Wyomissing, PA 19610

[randy.whitehead@fastbridgefiber.com](mailto:randy.whitehead@fastbridgefiber.com)

3. Our purpose in contacting you is to provide notice that FastBridge Fiber, LLC (FastBridge) will be accessing the public right of way at Wall Street near Danville in Montoursville County, Pennsylvania for the purpose of extending its communications network. FastBridge's work will be in the public right of way, which we understand crosses the railroad corridor.

4. Attached is a copy of the proposed plan, cross-section, and specifications of this project. This installation will be an aerial Fiber Optics cable installation. The USDOT records indicate that the railroad crossing is a public crossing. A copy of this information is attached for your review.

5. We believe this installation conforms to all federal, state, county, and city laws applicable at this time. This installation will not have any impact on existing utilities and/or municipalities located within the project area. A certificate of FastBridge's General Liability Insurance is available upon request. In response to any request for purchase of Railroad Protective Liability (RPL) request, we will provide the same or better coverage than that provided by RPL insurance and which meets all legal requirements for insurance at public crossings.

6. The estimated cost of this installation is less than \$10,000.00 USD and will be paid for with private funding provided by the applicant.

7. This installation is required due to customer growth and system integrity.

Wherefore, applicant prays your Honorable Commission to approve the application:

A handwritten signature in blue ink, appearing to be "K. J. Smith", written over a horizontal line.

(Signature of Applicant)

## CERTIFICATE OF SERVICE

I hereby certify that I have this day served a true copy of the foregoing document upon the participants, listed below, in accordance with the requirements of § 1.54 (*relating to service by participant*).

1. Mark J. Chappell P.E., Chief  
Pennsylvania Department of Transportation ROW & Utility Division, Bureau of Design -  
PennDOT, P.O. Box 3362, Harrisburg, PA 17105-3362  
[marchappel@pa.gov](mailto:marchappel@pa.gov)
2. Debra Pierce, Secretary  
Wernersville Borough  
100 North Reber Street  
Wernersville, PA 19565  
[dpierce@wernersvilleborough.org](mailto:dpierce@wernersvilleborough.org)
3. Lucine E. Sihelnik, Commissioner  
Berks County  
633 Court Street  
Reading, PA 19601  
[lsihelnik@berkscountypa.gov](mailto:lsihelnik@berkscountypa.gov)
4. Randy Ulrich, Superintendent of Operations  
North Shore Railroad Company  
356 Priestley Avenue  
Northumberland, PA 17857
5. Rana Souryal  
PPL  
P.O. Box 25239  
Lehigh Valley, PA 18002-5239  
[rsouryal@pplweb.com](mailto:rsouryal@pplweb.com)
6. Don Phillips  
Service Electric Cablevision  
3662 Point Township Drive  
Northumberland, PA 17857  
[don.phillips@secv.com](mailto:don.phillips@secv.com)
7. Matthew Kehr  
Verizon Pennsylvania Inc.  
1026 Hay Street  
Wilkinsburg, PA 15221  
[matthew.w.kehr@verizon.com](mailto:matthew.w.kehr@verizon.com)

8. Paul Erickson  
Level 3  
5095 Ritter Road Suite 101-A  
Mechanicsburg, PA 17055  
[paul.erickson@lumen.com](mailto:paul.erickson@lumen.com)
  
9. Mary Rodman  
CTSI, LLC d.b.a Frontier Communications  
100 CTE Drive  
Dallas, PA 18612  
[PA.Structure.Access@ftr.com](mailto:PA.Structure.Access@ftr.com)

Dated this 30th day of December, 2024.



---

(Signature)

**§ 1.36. Verification.**

(a) Applications, petitions, formal complaints, motions and answers thereto containing an averment of fact not appearing of record in the action or containing a denial of fact shall be personally verified by a party thereto or by an authorized officer of the party if a corporation or association. Verification means a signed written statement of fact supported by oath or affirmation or made subject to the penalties of 18 Pa. C.S. §4904 (relating to unsworn falsification to authorities). If verification is required, notarization is not necessary.

(b) The Verification form should comply substantially with the following:

**VERIFICATION**

I, Randy Whitehead, hereby state that the facts above set forth are true and correct (or are true and correct to the best of my knowledge, information and belief) and that I expect to be able to prove the same at a hearing held in this matter. I understand that the statements herein are made subject to the penalties of 18 Pa. C.S. § 4904 (relating to unsworn falsification to authorities).

Date: December 30, 2024



(Signature)

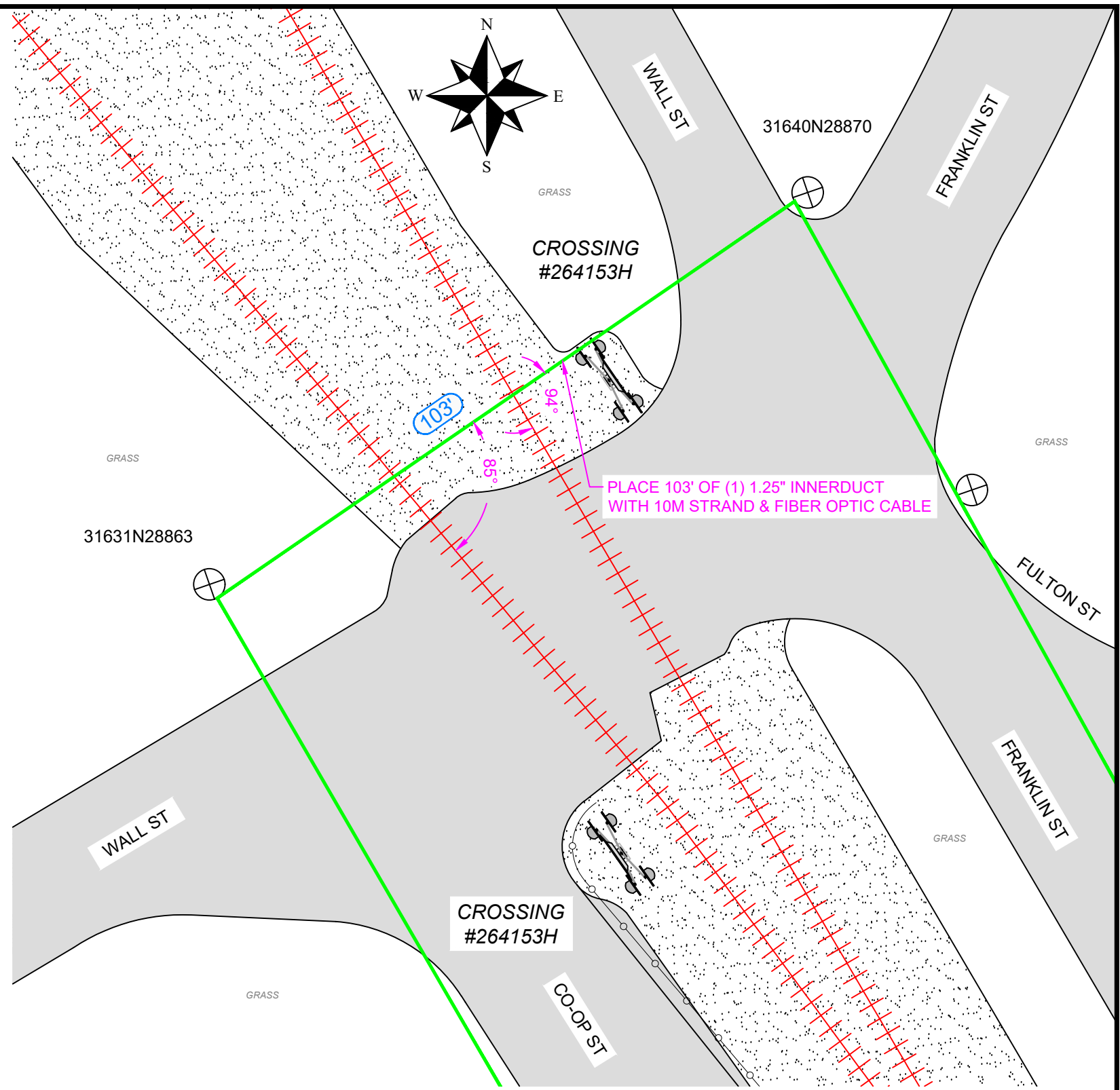
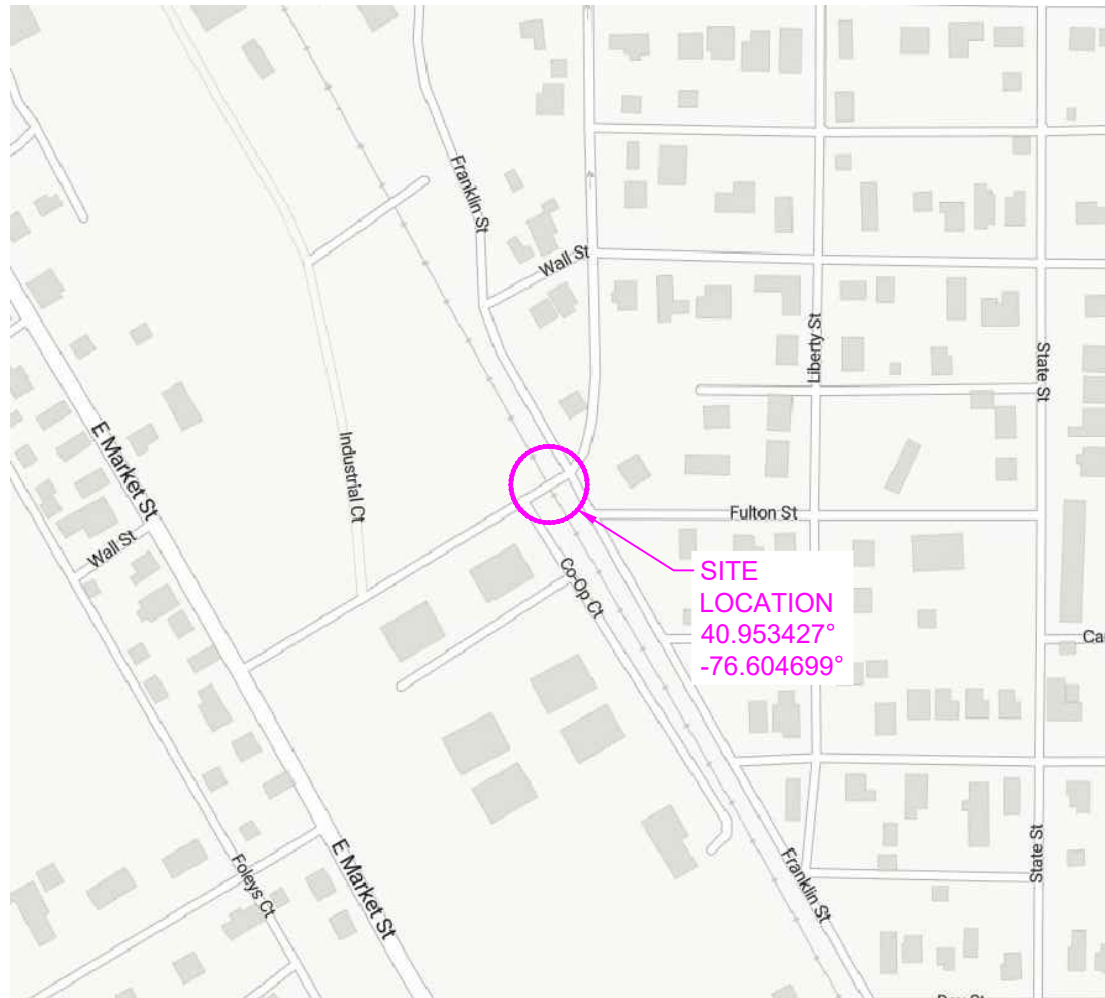

PLAN VIEW



B+T GROUP  
 1717 SOUTH BOULDER AVE  
 SUITE 300  
 TULSA, OK 74119  
 918-587-4630



FASTBRIDGE FIBER, LLC.  
 1050 SPRING STREET, UNIT 2  
 WYOMISSING, PA  
 PHONE (800) 661-0232

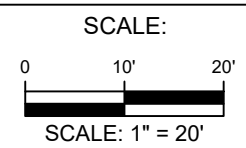

PUC PERMIT PLAN - WALL ST.

Drawn By	MEC	Date	12/03/2024
Rev.		Rev. Date	
Dwg #	SHEET 1	Job #	

POLE REPLACEMENT  
31631N28863  
(40.9534127°, -76.6049211°)

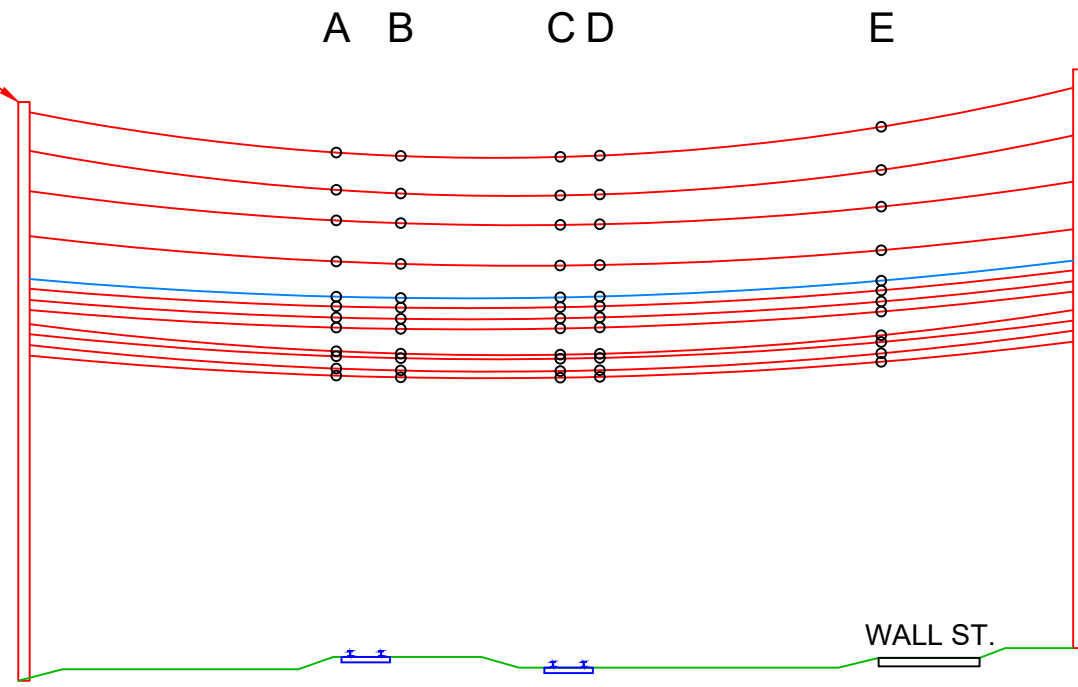

POLE REPLACEMENT  
31640N28870  
(40.9535643°, -76.6046050°)

SECTION VIEW (LOOKING NORTHWEST)

	WIRE	A PROPOSED	B PROPOSED	C PROPOSED	D PROPOSED	E PROPOSED
CABLES						
PPL PRIMARY	1/0 ACSR (6/1)	48'-4"	50'-3"	49'-10"	50'-3"	52'-2"
PPL PRIMARY	1/0 ACSR (6/1)	45'-3"	46'-8"	46'-3"	46'-7"	48'-0"
PPL PRIMARY	1/0 ACSR (6/1)	42'-3"	43'-7"	43'-1"	43'-4"	44'-3"
PPL NEUTRAL/SECONDARY	1/0 ACSR (6/1)	38'-7"	39'-6"	39'-2"	39'-3"	40'-2"
PROPOSED FASTBRIDGE		35'-5"	35'-11"	35'-11"	36'-0"	37'-1"
LEVEL 3		34'-5"	34'-11"	34'-11"	35'-0"	36'-1"
SERVICE ELECTRIC CATV		33'-5"	33'-10"	33'-11"	34'-0"	35'-0"
CTSI D/B/A FRONTIER		32'-3"	32'-8"	32'-10"	32'-11"	34'-1"
VERIZON OF PA INC. 1		30'-0"	30'-2"	30'-0"	30'-0"	31'-5"
VERIZON OF PA INC. 2		29'-10"	30'-1"	30'-0"	30'-1"	31'-3"
VERIZON OF PA INC. 3		28'-7"	28'-10"	28'-9"	28'-9"	29'-11"
VERIZON OF PA INC. 4		27'-11"	28'-2"	28'-2"	28'-3"	29'-2"



B+T GROUP  
1717 SOUTH BOULDER AVE  
SUITE 300  
TULSA, OK 74119  
918-587-4630



FASTBRIDGE FIBER, LLC.  
1050 SPRING STREET, UNIT 2  
WYOMISSING, PA  
PHONE (800) 661-0232

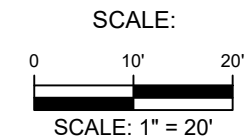

PUC PERMIT PLAN - WALL ST.

Drawn By	MEC	Date	12/03/2024
Rev.		Rev. Date	
Dwg #	SHEET 2	Job #	

# U. S. DOT CROSSING INVENTORY FORM

DEPARTMENT OF TRANSPORTATION  
FEDERAL RAILROAD ADMINISTRATION

OMB No. 2130-0017

Instructions for the initial reporting of the following types of new or previously unreported crossings: For public highway-rail grade crossings, complete the entire inventory Form. For private highway-rail grade crossings, complete the Header, Parts I and II, and the Submission Information section. For public pathway grade crossings (including pedestrian station grade crossings), complete the Header, Parts I and II, and the Submission Information section. For Private pathway grade crossings, complete the Header, Parts I and II, and the Submission Information section. For grade-separated highway-rail or pathway crossings (including pedestrian station crossings), complete the Header, Part I, and the Submission Information section. For changes to existing data, complete the Header, Part I Items 1-3, and the Submission Information section, in addition to the updated data fields. Note: For private crossings only, Part I Item 20 and Part III Item 2.K. are required unless otherwise noted. An asterisk \* denotes an optional field.

<b>A. Revision Date</b> (MM/DD/YYYY) 01 / 08 / 2024	<b>B. Reporting Agency</b> <input checked="" type="checkbox"/> Railroad <input type="checkbox"/> Transit <input type="checkbox"/> State <input type="checkbox"/> Other	<b>C. Reason for Update (Select only one)</b> <input type="checkbox"/> Change in Data <input type="checkbox"/> Re-Open <input type="checkbox"/> New Crossing <input checked="" type="checkbox"/> Date Change Only <input type="checkbox"/> Closed <input type="checkbox"/> No Train Traffic <input type="checkbox"/> Quiet Zone Update <input type="checkbox"/> Admin. Correction <input type="checkbox"/> Change in Primary Operating RR	<b>D. DOT Crossing Inventory Number</b> 264153H
---	--	--	--

## Part I: Location and Classification Information

<b>1. Primary Operating Railroad</b> North Shore Railroad [NSHR]		<b>2. State</b> PENNSYLVANIA		<b>3. County</b> MONTOUR	
<b>4. City / Municipality</b> <input checked="" type="checkbox"/> In <input type="checkbox"/> Near DANVILLE		<b>5. Street/Road Name &amp; Block Number</b> WALL STREET (Street/Road Name)   * (Block Number)		<b>6. Highway Type &amp; No.</b> LS	
<b>7. Do Other Railroads Operate a Separate Track at Crossing?</b> <input type="checkbox"/> Yes <input checked="" type="checkbox"/> No If Yes, Specify RR			<b>8. Do Other Railroads Operate Over Your Track at Crossing?</b> <input type="checkbox"/> Yes <input checked="" type="checkbox"/> No If Yes, Specify RR		
<b>9. Railroad Division or Region</b> <input checked="" type="checkbox"/> None		<b>10. Railroad Subdivision or District</b> <input checked="" type="checkbox"/> None		<b>11. Branch or Line Name</b> <input type="checkbox"/> None NORTH SHORE	
<b>12. RR Milepost</b> 0201.03 (prefix)   (nnnn.nnn)   (suffix)		<b>13. Line Segment</b> *		<b>14. Nearest RR Timetable Station</b> * DANVILLE	
<b>15. Parent RR (if applicable)</b> <input type="checkbox"/> N/A NSHR		<b>16. Crossing Owner (if applicable)</b> <input type="checkbox"/> N/A SDAC		<b>17. Crossing Type</b> <input checked="" type="checkbox"/> Public <input type="checkbox"/> Private	
<b>18. Crossing Purpose</b> <input checked="" type="checkbox"/> Highway <input type="checkbox"/> Pathway, Ped. <input type="checkbox"/> Station, Ped.		<b>19. Crossing Position</b> <input checked="" type="checkbox"/> At Grade <input type="checkbox"/> RR Under <input type="checkbox"/> RR Over		<b>20. Public Access (if Private Crossing)</b> <input type="checkbox"/> Yes <input checked="" type="checkbox"/> No	
<b>21. Type of Train</b> <input checked="" type="checkbox"/> Freight <input type="checkbox"/> Intercity Passenger <input type="checkbox"/> Commuter		<b>22. Average Passenger Train Count Per Day</b> <input type="checkbox"/> Transit <input type="checkbox"/> Shared Use Transit <input type="checkbox"/> Tourist/Other		<input type="checkbox"/> Less Than One Per Day <input type="checkbox"/> Number Per Day 0	
<b>23. Type of Land Use</b> <input type="checkbox"/> Open Space <input type="checkbox"/> Farm <input checked="" type="checkbox"/> Residential <input type="checkbox"/> Commercial <input type="checkbox"/> Industrial <input type="checkbox"/> Institutional <input type="checkbox"/> Recreational <input type="checkbox"/> RR Yard					
<b>24. Is there an Adjacent Crossing with a Separate Number?</b> <input type="checkbox"/> Yes <input checked="" type="checkbox"/> No If Yes, Provide Crossing Number			<b>25. Quiet Zone (FRA provided)</b> <input checked="" type="checkbox"/> No <input type="checkbox"/> 24 Hr <input type="checkbox"/> Partial <input type="checkbox"/> Chicago Excused Date Established		
<b>26. HSR Corridor ID</b> <input checked="" type="checkbox"/> N/A		<b>27. Latitude in decimal degrees</b> (WGS84 std: nn.nnnnnnn) 40.9534272		<b>28. Longitude in decimal degrees</b> (WGS84 std: -nnn.nnnnnnn) -76.6046994	
<b>29. Lat/Long Source</b> <input checked="" type="checkbox"/> Actual <input type="checkbox"/> Estimated		<b>30.A. Railroad Use *</b>			
<b>30.B. Railroad Use *</b>		<b>30.C. Railroad Use *</b>			
<b>30.D. Railroad Use *</b>		<b>30.E. Railroad Use *</b>			
<b>31.A. State Use *</b>			<b>31.B. State Use *</b> NSHR		
<b>31.C. State Use *</b>			<b>31.D. State Use *</b>		
<b>32.A. Narrative (Railroad Use) *</b>			<b>32.B. Narrative (State Use) *</b>		
<b>33. Emergency Notification Telephone No. (posted)</b> 877-635-2929		<b>34. Railroad Contact (Telephone No.)</b> 570-473-7949		<b>35. State Contact (Telephone No.)</b> 717-772-3079	

## Part II: Railroad Information

<b>1. Estimated Number of Daily Train Movements</b>				
<b>1.A. Total Day Thru Trains (6 AM to 6 PM)</b> 2	<b>1.B. Total Night Thru Trains (6 PM to 6 AM)</b> 0	<b>1.C. Total Switching Trains</b> 0	<b>1.D. Total Transit Trains</b> 0	<b>1.E. Check if Less Than One Movement Per Day</b> <input type="checkbox"/> How many trains per week? _____
<b>2. Year of Train Count Data (YYYY)</b> 2021		<b>3. Speed of Train at Crossing</b> 3.A. Maximum Timetable Speed (mph) 10 3.B. Typical Speed Range Over Crossing (mph) From 5 to 10		
<b>4. Type and Count of Tracks</b> Main 1 Siding 0 Yard 0 Transit 0 Industry 1				
<b>5. Train Detection (Main Track only)</b> <input type="checkbox"/> Constant Warning Time <input type="checkbox"/> Motion Detection <input type="checkbox"/> AFO <input type="checkbox"/> PTC <input checked="" type="checkbox"/> DC <input type="checkbox"/> Other <input type="checkbox"/> None				
<b>6. Is Track Signaled?</b> <input type="checkbox"/> Yes <input checked="" type="checkbox"/> No		<b>7.A. Event Recorder</b> <input type="checkbox"/> Yes <input checked="" type="checkbox"/> No		<b>7.B. Remote Health Monitoring</b> <input type="checkbox"/> Yes <input checked="" type="checkbox"/> No

# U. S. DOT CROSSING INVENTORY FORM

A. Revision Date (MM/DD/YYYY) 01/08/2024		PAGE 2		D. Crossing Inventory Number (7 char.) 264153H		
<b>Part III: Highway or Pathway Traffic Control Device Information</b>						
1. Are there Signs or Signals? <input checked="" type="checkbox"/> Yes <input type="checkbox"/> No		2. Types of Passive Traffic Control Devices associated with the Crossing				
2.A. Crossbuck Assemblies (count) 4		2.B. STOP Signs (R1-1) (count) 0	2.C. YIELD Signs (R1-2) (count) 0	2.D. Advance Warning Signs (Check all that apply; include count) <input type="checkbox"/> None <input checked="" type="checkbox"/> W10-1 5 <input type="checkbox"/> W10-3 <input type="checkbox"/> W10-11 <input type="checkbox"/> W10-2 <input type="checkbox"/> W10-4 <input type="checkbox"/> W10-12		
2.E. Low Ground Clearance Sign (W10-5) <input type="checkbox"/> Yes (count _____) <input checked="" type="checkbox"/> No		2.F. Pavement Markings <input checked="" type="checkbox"/> Stop Lines <input type="checkbox"/> Dynamic Envelope <input type="checkbox"/> RR Xing Symbols <input type="checkbox"/> None		2.G. Channelization Devices/Medians <input type="checkbox"/> All Approaches <input type="checkbox"/> Median <input type="checkbox"/> One Approach <input checked="" type="checkbox"/> None	2.H. EXEMPT Sign (R15-3) <input type="checkbox"/> Yes <input checked="" type="checkbox"/> No	2.I. ENS Sign (I-13) Displayed <input checked="" type="checkbox"/> Yes <input type="checkbox"/> No
2.J. Other MUTCD Signs Specify Type R8-8 Count 3 Specify Type R15-2P Count 2 Specify Type _____ Count _____		<input checked="" type="checkbox"/> Yes <input type="checkbox"/> No	2.K. Private Crossing Signs (if private) <input type="checkbox"/> Yes <input type="checkbox"/> No	2.L. LED Enhanced Signs (List types) NONE		
3. Types of Train Activated Warning Devices at the Grade Crossing (specify count of each device for all that apply)						
3.A. Gate Arms (count) Roadway 2 Pedestrian _____	3.B. Gate Configuration <input checked="" type="checkbox"/> 2 Quad <input type="checkbox"/> Full (Barrier) Resistance <input type="checkbox"/> 3 Quad <input type="checkbox"/> Median Gates	3.C. Cantilevered (or Bridged) Flashing Light Structures (count) Over Traffic Lane 0 <input type="checkbox"/> Incandescent Not Over Traffic Lane 1 <input checked="" type="checkbox"/> LED		3.D. Mast Mounted Flashing Lights (count of masts) 3 <input type="checkbox"/> Incandescent <input checked="" type="checkbox"/> LED <input checked="" type="checkbox"/> Back Lights Included <input checked="" type="checkbox"/> Side Lights Included	3.E. Total Count of Flashing Light Pairs 9	
3.F. Installation Date of Current Active Warning Devices: (MM/YYYY) _____/_____/_____ <input checked="" type="checkbox"/> Not Required		3.G. Wayside Horn <input type="checkbox"/> Yes Installed on (MM/YYYY) ____/____/_____ <input checked="" type="checkbox"/> No		3.H. Highway Traffic Signals Controlling Crossing <input type="checkbox"/> Yes <input checked="" type="checkbox"/> No	3.I. Bells (count) 1	
3.J. Non-Train Active Warning <input type="checkbox"/> Flagging/Flagman <input type="checkbox"/> Manually Operated Signals <input type="checkbox"/> Watchman <input type="checkbox"/> Floodlighting <input checked="" type="checkbox"/> None				3.K. Other Flashing Lights or Warning Devices Count 0 Specify type _____		
4.A. Does nearby Hwy Intersection have Traffic Signals? <input type="checkbox"/> Yes <input checked="" type="checkbox"/> No	4.B. Hwy Traffic Signal Interconnection <input checked="" type="checkbox"/> Not Interconnected <input type="checkbox"/> For Traffic Signals <input type="checkbox"/> For Warning Signs	4.C. Hwy Traffic Signal Preemption <input type="checkbox"/> Simultaneous <input type="checkbox"/> Advance	5. Highway Traffic Pre-Signals <input type="checkbox"/> Yes <input checked="" type="checkbox"/> No Storage Distance * _____ Stop Line Distance * _____	6. Highway Monitoring Devices (Check all that apply) <input checked="" type="checkbox"/> Yes - Photo/Video Recording <input type="checkbox"/> Yes - Vehicle Presence Detection <input type="checkbox"/> None		
<b>Part IV: Physical Characteristics</b>						
1. Traffic Lanes Crossing Railroad Number of Lanes 2 <input type="checkbox"/> One-way Traffic <input checked="" type="checkbox"/> Two-way Traffic <input type="checkbox"/> Divided Traffic		2. Is Roadway/Pathway Paved? <input checked="" type="checkbox"/> Yes <input type="checkbox"/> No	3. Does Track Run Down a Street? <input type="checkbox"/> Yes <input checked="" type="checkbox"/> No	4. Is Crossing Illuminated? (Street lights within approx. 50 feet from nearest rail) <input checked="" type="checkbox"/> Yes <input type="checkbox"/> No		
5. Crossing Surface (on Main Track, multiple types allowed) Installation Date * (MM/YYYY) ____/____/_____ <input type="checkbox"/> 1 Timber <input type="checkbox"/> 2 Asphalt <input type="checkbox"/> 3 Asphalt and Timber <input type="checkbox"/> 4 Concrete <input checked="" type="checkbox"/> 5 Concrete and Rubber <input type="checkbox"/> 6 Rubber <input type="checkbox"/> 7 Metal <input type="checkbox"/> 8 Unconsolidated <input type="checkbox"/> 9 Composite <input type="checkbox"/> 10 Other (specify) _____						
6. Intersecting Roadway within 500 feet? <input checked="" type="checkbox"/> Yes <input type="checkbox"/> No If Yes, Approximate Distance (feet) 50		7. Smallest Crossing Angle <input type="checkbox"/> 0° - 29° <input type="checkbox"/> 30° - 59° <input checked="" type="checkbox"/> 60° - 90°		8. Is Commercial Power Available? * <input checked="" type="checkbox"/> Yes <input type="checkbox"/> No		
<b>Part V: Public Highway Information</b>						
1. Highway System <input type="checkbox"/> (01) Interstate Highway System <input type="checkbox"/> (02) Other Nat Hwy System (NHS) <input type="checkbox"/> (03) Federal AID, Not NHS <input checked="" type="checkbox"/> (08) Non-Federal AID		2. Functional Classification of Road at Crossing <input type="checkbox"/> (0) Rural <input checked="" type="checkbox"/> (1) Urban <input type="checkbox"/> (1) Interstate <input type="checkbox"/> (5) Major Collector <input type="checkbox"/> (2) Other Freeways and Expressways <input type="checkbox"/> (3) Other Principal Arterial <input type="checkbox"/> (6) Minor Collector <input type="checkbox"/> (4) Minor Arterial <input checked="" type="checkbox"/> (7) Local		3. Is Crossing on State Highway System? <input type="checkbox"/> Yes <input checked="" type="checkbox"/> No	4. Highway Speed Limit 25 MPH <input checked="" type="checkbox"/> Posted <input type="checkbox"/> Statutory	
5. Linear Referencing System (LRS Route ID) *						
6. LRS Milepost *						
7. Annual Average Daily Traffic (AADT) Year 2009 AADT 000887		8. Estimated Percent Trucks 02 %	9. Regularly Used by School Buses? <input type="checkbox"/> Yes <input checked="" type="checkbox"/> No Average Number per Day _____		10. Emergency Services Route <input type="checkbox"/> Yes <input type="checkbox"/> No	
<b>Submission Information - This information is used for administrative purposes and is not available on the public website.</b>						
Submitted by _____ Organization _____ Phone _____ Date _____						
Public reporting burden for this information collection is estimated to average 30 minutes per response, including the time for reviewing instructions, searching existing data sources, gathering and maintaining the data needed and completing and reviewing the collection of information. According to the Paperwork Reduction Act of 1995, a federal agency may not conduct or sponsor, and a person is not required to, nor shall a person be subject to a penalty for failure to comply with, a collection of information unless it displays a currently valid OMB control number. The valid OMB control number for information collection is 2130-0017. Send comments regarding this burden estimate or any other aspect of this collection, including for reducing this burden to: Information Collection Officer, Federal Railroad Administration, 1200 New Jersey Ave. SE, MS-25 Washington, DC 20590.						