

CAPTION SHEET

WASTE MANAGEMENT SYSTEM

1. REPORT DATE: 00/00/00 :
 2. BUREAU: TAS :
 3. SECTION(S) : :
 5. APPROVED BY: : 4. PUBLIC MEETING DATE:
 DIRECTOR: : 00/00/00
 SUPERVISOR: :
 6. PERSON IN CHARGE: : 7. DATE FILED: 01/20/95
 8. DOCKET NO: A-230073 : 9. EFFECTIVE DATE: 00/00/00

PARTY/COMPLAINANT: COUNTRY PLACE WASTE TREATMENT COMPANY

RESPONDENT/APPLICANT: PENNA AMERICAN WATER CO

COMP/APP COUNTY: MONROE

UTILITY CODE: 230073

ALLEGATION OR SUBJECT

APPLICATION OF PENNSYLVANIA AMERICAN WATER COMPANY AND COUNTRY PLACE WASTE TREATMENT COMPANY, INC. FOR APPROVAL OF (1) THE TRANSFER, BY SALE, OF ALL THE SANITARY SEWAGE COLLECTION PROPERTY AND RIGHTS OF COUNTRY PLACE WASTE TREATMENT COMPANY, INC. TO PENNSYLVANIA-AMERICAN WATER COMPANY, (2) THE RIGHT OF PENNSYLVANIA-AMERICAN WATER COMPANY TO BEGIN TO OFFER OR FURNISH SANITARY SEWAGE COLLECTION AND DISPOSAL SERVICE TO THE PUBLIC IN PORTIONS OF COOLBAUGH TOWNSHIP, MONROE COUNTY, AND (3) THE ABANDONMENT BY COUNTRY PLACE WASTE TREATMENT COMPANY, INC. OF ALL SEWAGE SERVICE TO THE PUBLIC.

DOCKETED
 APR 10 1997

DOCUMENT
 FOLDER

ORIGINAL

Pennsylvania-American Water Company

800 West Hersheypark Drive • P.O. Box 888 • Hershey, PA 17033-0888
(717) 533-5000

Velma A. Redmond
Corporate Counsel

January 20, 1995

RECEIVED
95 JAN 20 PM 3:54
PA. P. U. C.
INFO. CONTROL DIV.

HAND-DELIVERED

Mr. John G. Alford, Secretary
Pennsylvania Public Utility
Commission
New Filing Section, Room B-18
North Office Building
P.O. Box 3265
Harrisburg, PA 17120

In re: Application of Pennsylvania-American Water Company and Country Place Waste Treatment Company, Inc. for Approval of (1) the transfer, by sale, of the sanitary sewage collection, treatment service and rights of Country Place Waste Treatment Company, Inc., to Pennsylvania-American Water Company, and (2) the rights of Pennsylvania-American Water Company to begin to offer or furnish service to the public in portions of Coolbaugh Township, Monroe County, Pennsylvania, and (3) the permanent discontinuance by Country Place Waste Treatment Company, Inc. of all service to the public and the cessation of all rights and obligations of Country Place Waste Treatment as a public utility and the termination of all regulatory responsibility for the operation of the Country Place Waste Treatment Company, Inc.

Application No. A-21228570024
²³⁰⁰⁷³

Dear Mr. Alford:

Enclosed please find an original and two copies of the above-captioned Application which is being filed on behalf of Pennsylvania-American Water Company and Country Place Waste Treatment Company, Inc.

Also included is a check for the \$350 filing fee.

Sincerely,

Velma A. Redmond

DOCUMENT
FOLDER

eth

Attachments

cc: D.L. Guskey w/Attachment

DOCKETED

JAN 23 1995



BEFORE THE
PENNSYLVANIA PUBLIC UTILITY COMMISSION

In re: Application of Pennsylvania-American Water Company and Country Place Waste Treatment Company, Inc. for Approval of (1) the transfer, by sale, of the sanitary sewage collection, treatment service and rights of Country Place Waste Treatment Company, Inc., to Pennsylvania-American Water Company, and (2) the rights of Pennsylvania-American Water Company to begin to offer or furnish service to the public in portions of Coolbaugh Township, Monroe County, Pennsylvania, and (3) the permanent discontinuance by Country Place Waste Treatment Company, Inc. of all service to the public and the cessation of all rights and obligations of Country Place Waste Treatment as a public utility and the termination of all regulatory responsibility for the operation of the Country Place Waste Treatment Company, Inc.

Application No. A 2300-73
A 212285-71124

To Pennsylvania Public Utility Commission:

1. The name and address of applicants are:

Pennsylvania-American Water Company
("Pennsylvania-American")
800 West Hersheypark Drive
Hershey, PA 17033

Country Place Waste Treatment Company, Inc.
("Country Place Waste Treatment")
P.O. Box 178
Mount Pocono, PA 18344

2. The name and address of the applicants' attorneys are:

For Pennsylvania-American:

Velma A. Reimond, Esq.
800 West Hersheypark Drive
Hershey, PA 17033

For Country Place Waste Treatment:

Thomas J. Sniscak, Esq.
Malatesta Hawke & McKeon
100 North Tenth Street
P.O. Box 1778
Harrisburg, PA 17105

3. Attached hereto as Exhibit A-1 is a statement containing (a) a brief history of Country Place Waste Treatment; (b) a statement of the purpose for which it was incorporated, and (c) a description of the service that it

RECEIVED
95 JAN 20 PM 3:54
PA. P. U. C.
INFO. CONTROL DIV.

DOCUMENT
JAN 20 1995

JAN 20 1995

furnishes to the public. Also attached as Exhibit A-2 is a map outlining the location of Country Place Waste Treatment's system.

4. Attached hereto as Exhibit B is a statement containing (a) a brief corporate history of the Pennsylvania-American; (b) a statement of the purpose for which it was incorporated; (c) a description of its corporate territory and of the territory in which it actually furnishes service to the public, and (d) a description of the service that it furnishes to the public.

A. TRANSFER, BY SALE, OF THE PROPERTY AND RIGHTS OF COUNTRY PLACE WASTE TREATMENT TO PENNSYLVANIA-AMERICAN

All of the preceding and succeeding paragraphs are incorporated by reference into this sub-part A.

5. Country Place Waste Treatment furnishes sanitary sewage services to a total of 4,930 customers, as of December 31, 1993, consisting of:

Residential-Available-Gravity	1,053
Residential-Available-Pressure	834
Residential-Usage -Gravity	1,887
Residential-Usage-Pressure	1,124
Public-Available-Gravity	8
Public-Available-Pressure	9
Public-Usage-Gravity	7
Public-Usage-Pressure	6
Commercial-Gravity	1
Commercial-Pressure	1

6. Pennsylvania-American does not currently furnish sanitary sewage services. Pennsylvania-American furnishes water service to a total of 374,642 customers, as of December 31, 1993, consisting of:

residential	342,421
commercial	28,040
industrial	609
fire service	1,814
other	1,758

7. There are attached hereto balance sheets of Country Place Waste Treatment as of December 31, 1993 (Exhibit C) and the balance sheets of Pennsylvania-American as of August 31, 1994 (Exhibit D).

8. There are attached hereto income statements of Country Place Waste Treatment for the 12 months ended December 31, 1993 (Exhibit E) and Pennsylvania-American for the 12 months ended August 31, 1994 (Exhibit F).

9. All the annual reports, tariffs, certificates of notification, applications for certificates of valuation, applications for approval of the issuance of securities, and securities certificates filed with your Honorable Commission by Pennsylvania-American and Country Place Waste Treatment and by their predecessor and constituent companies are made part hereof by reference.

10. The property to be transferred is all assets of Country Place Waste Treatment free and clear of any liens, claims or encumbrances. The terms and conditions of the sale are set forth in the Order Approving Sale Free and Clear of Liens issued by the United States Bankruptcy Court for the Middle District of Pennsylvania, dated September 19, 1994 (Exhibit G). The sale of Country Place Waste Treatment is conditioned upon the concurrent sale of Country Place Water Company, Inc. to Pennsylvania-American. A copy of the executed purchase agreement will be supplied by amendment.

11. The purchase price for Country Place Waste Treatment was determined by bid at an auction in United States Bankruptcy Court for the Middle District of Pennsylvania on September 14, 1994. Cost Control Marketing and Management, Inc., the owner of 100% of the stock of Country Place Water Company, Inc. and Country Place Waste Treatment Company, Inc. offered the assets of the two utilities jointly for sale. Pennsylvania-American was the successful bidder

at the auction for a total purchase price of \$4.2 million cash and the assumption of a loan in the principal amount of \$450,000 with the Pennsylvania Water Facilities Loan Board. The transaction is at arm's length. The portion of the total purchase price allocated to Country Place Waste Treatment is \$2,479,380, determined as follows:

	<u>WATER</u>	<u>SEWER</u>	<u>TOTAL</u>
Utility Plant	\$2,082,345	\$2,481,365	\$4,563,710
Accumulated Depreciation	<447,750>	<614,378>	<1,062,128>
Net Utility Plant	<u>\$1,634,595</u>	<u>\$1,866,987</u>	<u>\$3,501,582</u>
Percentage	46.68%	53.32%	100.00%
Allocation	\$2,170,620	\$2,479,380	\$4,650,000

12. The fixed capital installed and depreciation accumulated thereon as stated on the books and records of Country Place Waste Treatment as of December 31, 1993 are contained in Exhibit H. PAWC has reason to believe, however, that the depreciated original cost and book value set forth in Country Place Waste Treatment's books are inaccurate as stated. PAWC is undertaking an original cost study to establish the depreciated original cost of Country Place Waste Treatment's utility plant. Upon completion of the original cost study, Pennsylvania-American will seek Commission approval to establish depreciated original cost for Country Place Waste Treatment based on the results of the study.

13. No investment securities will be transferred.

14. There is attached hereto a pro forma balance sheet of Pennsylvania-American as of August 31, 1994, giving effect to the transfer (Exhibit I). However, as noted in Paragraph 12, above, Pennsylvania-American is

undertaking an original cost study for the purpose of establishing the depreciated original cost of the treatment plant of Country Place Waste Treatment. Once the original cost study is completed and the proper depreciated original cost and book value are established and approved by the Commission, Pennsylvania-American will amend the pro forma balance sheet giving effect to the transfer, accordingly.

15. There is attached hereto a pro forma consolidated income statement of Pennsylvania-American and Country Place Waste Treatment for the twelve months ended December 31, 1993 (Exhibit J).

16. Tentative journal entries to record the transfer in Pennsylvania-American's accounts are set forth as Exhibit K, based upon the original cost and book depreciation reserve set forth in Country Place Waste Treatment's books and records as of December 31, 1993. However, as stated above, Pennsylvania-American has reason to believe that the depreciated original cost stated on the books and records of Country Place Waste Treatment are incorrect both for ratemaking and accounting purposes, and Pennsylvania-American is in the process of undertaking an extensive original cost study for Country Place Waste Treatment. Upon completion of the original cost study, Pennsylvania-American will seek Commission approval to establish depreciated original cost for Country Place Waste Treatment, for both ratemaking and accounting purposes, based on the results of the study.

17. There is attached hereto a copy of the Order of the United States Bankruptcy Court for the Middle District of Pennsylvania approving the sale (Exhibit G). A certified copy of the resolutions adopted by the board of directors of Pennsylvania-American will be supplied by amendment.

18. The proposed transfer will have a beneficial effect on the customers of Country Place Waste Treatment in that they will have the benefit of Pennsylvania-American's resources and experience in managing and operating utility systems which should result in improvements in the service to the customers to be transferred.

19. This Application will have no effect on the rates charged to customers in the territory to be transferred. Pennsylvania-American will adopt the rates for service currently charged to those customers by Country Place Waste Treatment (Exhibit L).

There will be no effect on the rates to existing customers of Pennsylvania-American.

20. Pennsylvania-American will initially finance the transfer by short-term bank debt.

21. The reason for the proposed transfer is the purchase by Pennsylvania-American of the assets of Country Place Waste Treatment.

22. Pennsylvania-American and Country Place Waste Treatment are not affiliated with each other.

23. Country Place Waste Treatment has paid all special and general assessments made against it by your Honorable Commission pursuant to Section 1201 of the Public Utility Code.

24. Provision for the payment of the amounts of any and all lawful special and general assessments which your Honorable Commission may make, pursuant to said Section 1201 of said law, against Country Place Waste Treatment from the dates of the next preceding special and general assessments to the date

of the transfer herein proposed, will be made as follows: Country Place Waste Treatment shall pay the amounts of such assessments.

B. THE RIGHTS OF PENNSYLVANIA-AMERICAN TO OFFER OR FURNISH SERVICE TO THE PUBLIC IN PORTIONS OF COOLBAUGH TOWNSHIP, MONROE COUNTY

All of the preceding and succeeding paragraphs are incorporated by reference into this sub-part B.

25. Pennsylvania-American is now furnishing service in the service territory as outlined in paragraph 4.

26. The additional location of the proposed service is the service territory as outlined in paragraph 3.

27. No additional capital will be required by Pennsylvania-American for the purpose of financing the matters and things involved in this Application except as stated in paragraph 20.

28. No corporation, partnership or individual other than Country Place Waste Treatment is now furnishing or has corporate or franchise rights to furnish service similar to that to be rendered by Pennsylvania-American in the territory covered by this Application, and no competitive condition will be created. As part of this Application, Pennsylvania-American and Country Place Waste Treatment have requested approval for Country Place Waste Treatment to transfer, by sale, all its sanitary sewage collection, treatment service and rights to Pennsylvania-American. In addition, Country Place Waste Treatment will permanently discontinue all service to the public.

P R O L L
E N D O F R O L L

29. The facilities which will be employed by Pennsylvania-American in furnishing the subject service are as shown on Exhibit M.

30. Pennsylvania-American will charge the monthly rates for service as shown on Exhibit L for service in the Application territory and as amended from time to time.

31. The estimated annual revenues and expenses of Pennsylvania-American in the Application territory are set forth in Exhibit N.

32. Additionally, by this Application, Pennsylvania-American requests permission to render to customers in the Application area, a single monthly bill, containing both water and sewer charges. Attached as Exhibit O is a sample bill. The bill provides complete billing information, as required by Commission regulations, with regard to water and sewer services. Pennsylvania-American believes that this format will provide efficiencies to the customers in the Application area as well as to the Company. Approval would waive any portions of 52 Pa. Code §56.15 which may be interpreted to prohibit provision of this service.

C. THE PERMANENT DISCONTINUANCE BY COUNTRY PLACE WASTE TREATMENT OF ALL SERVICE TO THE PUBLIC AND THE CESSATION OF ALL RIGHTS AND OBLIGATIONS OF COUNTRY PLACE WASTE TREATMENT AS A PUBLIC UTILITY

All of the preceding and succeeding paragraphs are incorporated by reference into this sub-part C.

33. In accordance with the Purchase Agreement and this Application, Country Place Waste Treatment terminates all regulatory responsibility for the operation of the Country Place Waste Treatment system and will permanently discontinue all service to the public.

34. A summary of the revenue derived from the operation of the service sought to be discontinued, together with a statement of the expenses accruing from the maintenance of that service, is contained in the financial information provided in paragraph 8.

D. CONCLUSION

35. Approval of this Application is necessary or proper in order for the public now served by Country Place Waste Treatment to benefit by receiving water service from a public water supply company with the resources and personnel to provide a safe and reliable supply of potable water at reasonable prices.

WHEREFORE, Applicants pray your Honorable Commission to issue a Certificate of Public Convenience under the Public Utility Code, as amended, 66 Pa. C.S. §1102(a), authorizing:

- (a) the transfer, by sale, of the sanitary sewage collection, treatment service and rights of Country Place Waste Treatment Company, Inc. to Pennsylvania-American Water Company,
- (b) the rights of Pennsylvania-American Water Company to begin to offer sanitary sewage service to the public in portions of Coolbaugh Township, Monroe County, Pennsylvania,
- (c) the permanent discontinuance by Country Place Waste Treatment Company, Inc. of all service to the public and the cessation of all rights and obligations of Country Place Waste Treatment Company, Inc. as a public utility

and the termination of all regulatory responsibility for
the operation of the Country Place Waste Treatment
Company, Inc.

COUNTRY PLACE WASTE TREATMENT
COMPANY, INC.

PENNSYLVANIA-AMERICAN WATER COMPANY

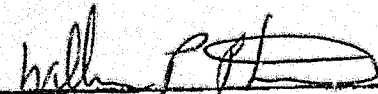
By: 
President

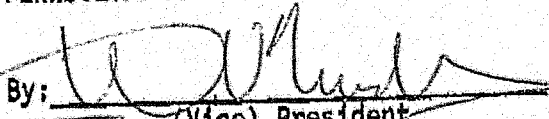
By: 
(Vice) President

ROLLS
END OF ROLL
END OF ROLL
END OF ROLL
END OF ROLL
END OF ROLL

COMMONWEALTH OF PENNSYLVANIA

COUNTY OF *MONROE*

)
) SS:
)

Personally appeared before me, a Notary Public in and for said Commonwealth and County, William P. Peterson, President of Country Place Waste Treatment Company, Inc., who being duly sworn according to law, deposes and says that the facts set forth in the foregoing Application are true and correct to the best of his knowledge, information and belief.

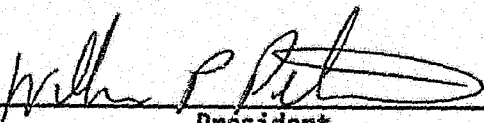

President

Sworn to and subscribed before me
this 19th day of January,
1995.



Notary Public

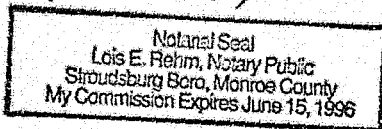

COMMONWEALTH OF PENNSYLVANIA)
) SS:
COUNTY OF DAUPHIN)

Personally appeared before me, a Notary Public in and for said Commonwealth and County, David V. Modeer, Vice President of Pennsylvania-American Water Company who, being duly sworn according to law, deposes and says that the facts set forth in the foregoing Application are true and correct to the best of his knowledge, information and belief.

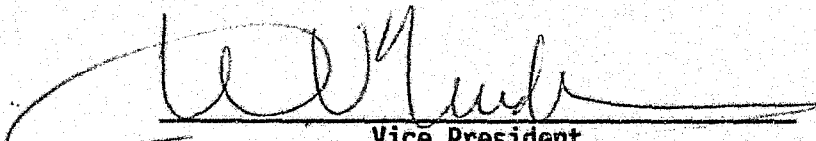
Vice President

Sworn to and subscribed before me
this 20th day of January,
1995.

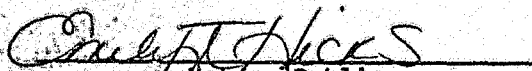
Notary Public

NOTARIAL SEAL
EMILY T. HICKS, Notary Public
Derry Twp., Dauphin County
My Commission Expires March 2, 1996

Country Place Waste Treatment Company, Inc. was incorporated in the State of Delaware on November 10, 1976 to provide sanitary sewage collection and treatment service for "A Pocono Country Place" development located north of Mt. Pocono on either side of Route 196, Coolbaugh Township, Monroe County. A map outlining the location of Country Place Waste Treatment Company, Inc.'s system is attached as Exhibit A-2.

EXHIBIT A-1

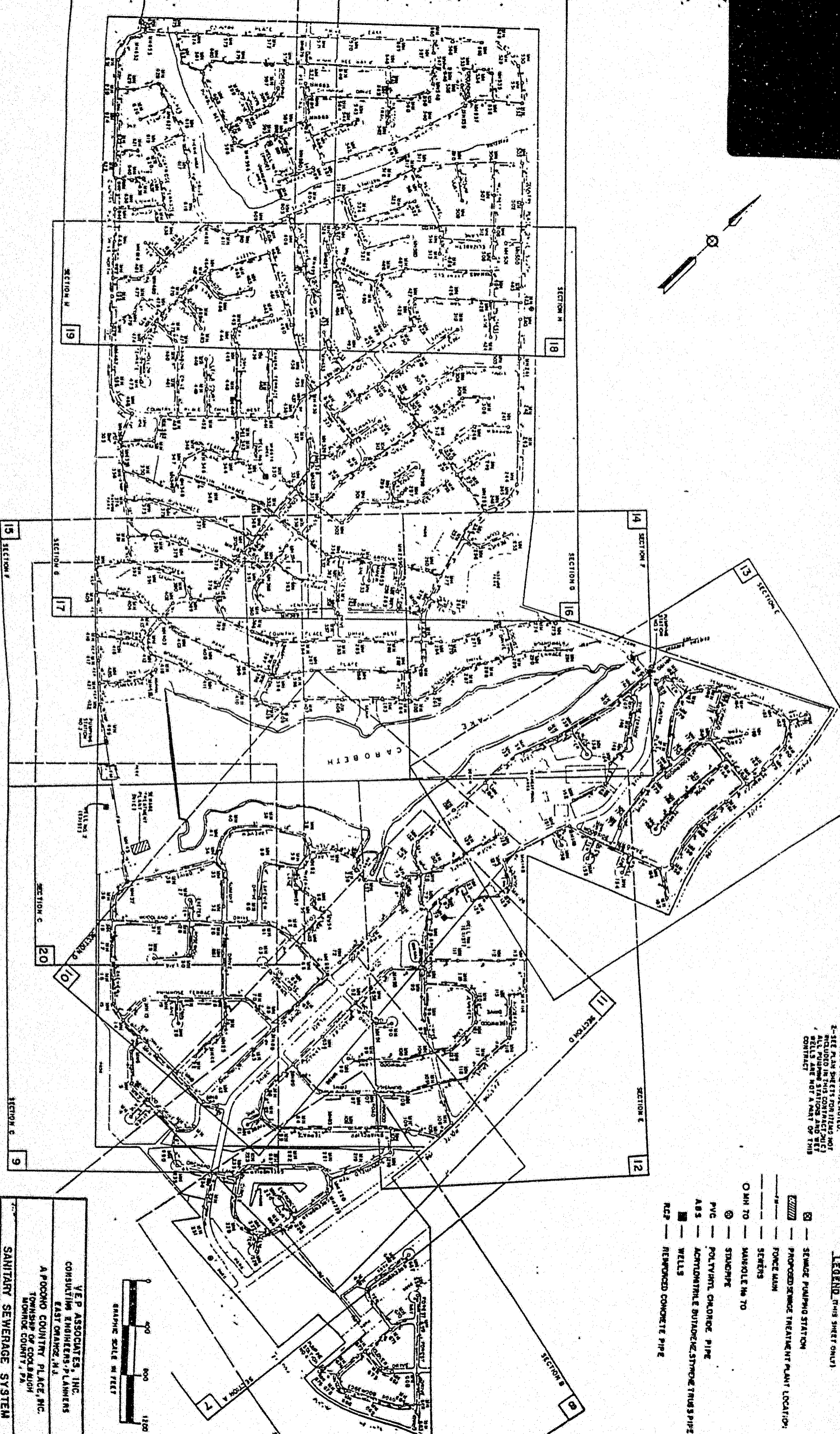
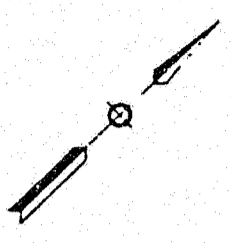

NOTES: 1 - ALL PIPING IS 8" S
 UNLESS OTHERWISE NOTED.
 2 - SEE PLAN SHEETS FOR ITEMS NOT
 INCLUDED IN THIS CONTRACT
 ALL PUMPING STATIONS AND WELLS
 ARE NOT A PART OF THIS
 CONTRACT

LEGEND (THIS SHEET ONLY)

- ☐ — SEWER PUMPING STATION
- ▨ — PROPOSED SEWER TREATMENT PLANT LOCATION
- — — — — FORCE MAIN
- — — — — SEWERS
- — MANHOLE No 70
- — MANHOLE No 70
- ⊙ — STAKEPIPE
- — — — — PVC — POLYVINYL CHLORIDE PIPE
- — — — — ABS — ACRYLONITRILE BUTADIENE STYRENE TRUSS PIPES
- — — — — WELLS
- — — — — REINFORCED CONCRETE PIPE

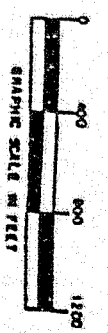

VEP ASSOCIATES, INC.
 CONSULTING ENGINEERS-PLANNERS
 EAST ORANGE, N.J.

APOONCO COUNTY PLACE, INC.
 TOWNSHIP OF COALBROUGH
 MONROE COUNTY, PA.

SANITARY SEWERAGE SYSTEM

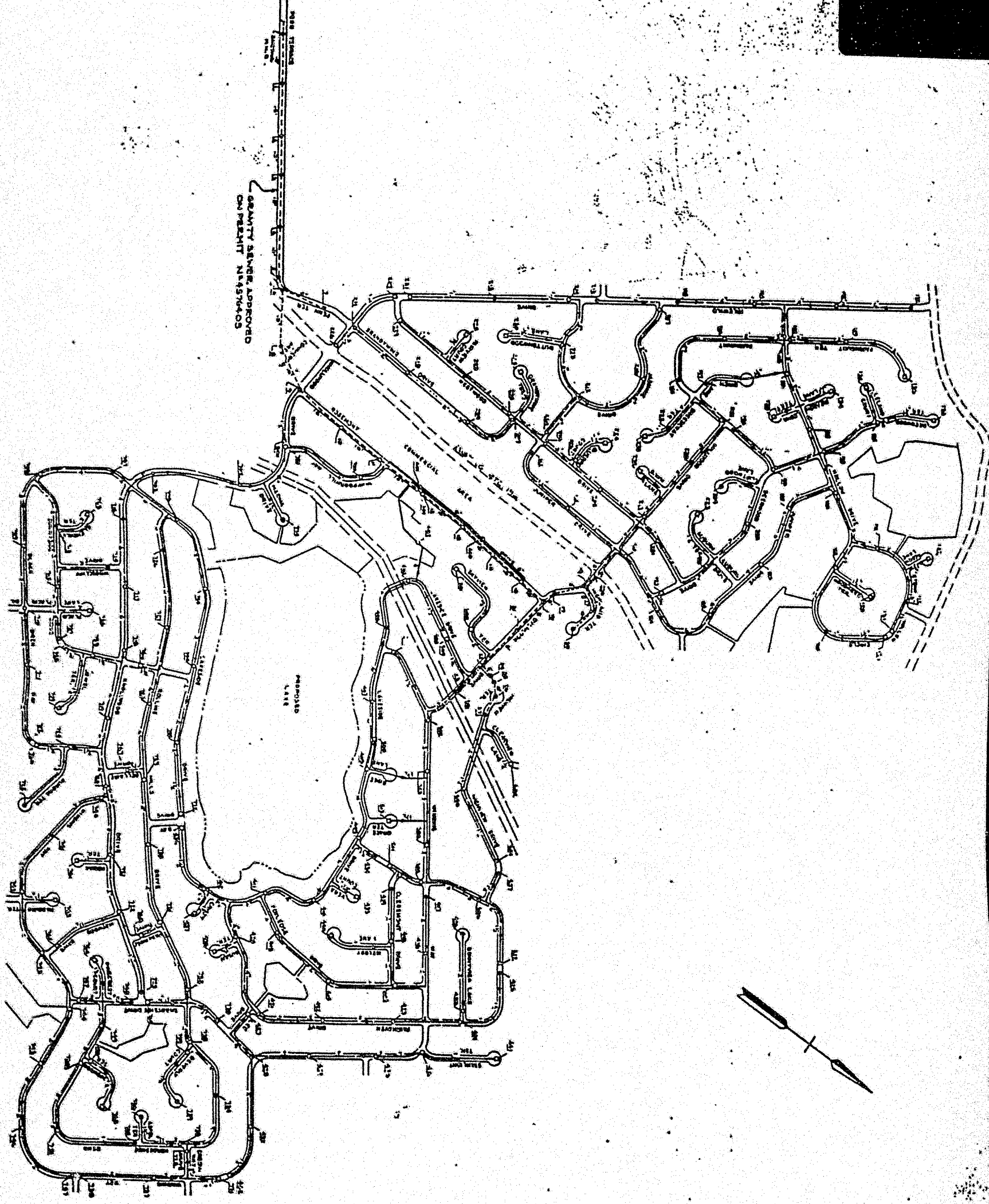

SEWAGE TREATMENT PLANT
 SANITARY SEWER APPROVED
 ON PERMIT N-857405

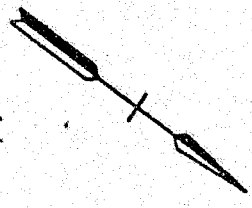

KEY

- SANITARY SEWER MANHOLE
- PRESS. SEWER MANHOLE
- PRESS. SEWER MANHOLE w/ AIR RELEASE VALVE
- TRENCH CLEANOUT ASSEMBLY
- DOUBLE LINE PRESS. SEWER MANHOLE

DATE	BY	DATE	APP'D
10/1/58	Overall		
MILNER ENGINEERING INC. 615 E. 10th Street Des Moines, Iowa 50319			
TITLE SANITARY SEWER SYSTEM GENERAL LAYOUT PROPOSED SEWERAGE PLANT COOK BAKING CO. MANHOLE CO. PA. PERMIT N-857405			

PENNSYLVANIA-AMERICAN WATER COMPANY

Pennsylvania-American Water Company, an investor-owned water company, with corporate offices at 800 West Hersheypark Drive, Hershey, is a subsidiary of American Water Works Company, Inc. On February 1, 1989, the then-existing Pennsylvania-American Water Company (the result of the January 1, 1987 merger of Riverton Consolidated Water Company into Keystone Water Company) was merged into Western Pennsylvania Water Company, and the name of the surviving corporation was changed to Pennsylvania-American Water Company. A brief summary of each of the three predecessor companies follows.

Riverton Consolidated Water Company was formed by the merger and consolidation of six operating water companies in 1904. It subsequently acquired seven additional systems, and at the time of its merger with Keystone, supplied water to 12 municipalities on the Harrisburg west shore, Cumberland County, and Fairview Township in York County.

Keystone Water Company resulted from the 1973 merger of 14 companies into White Deer Mountain Water Company. The Company later acquired four systems. It provided water service in 14 eastern Pennsylvania counties through the following district offices: Abington, Bangor, Berwick, Frackville, Hallstead, Hershey/Palmyra, Montrose, Moshannon Valley, Norristown, Northumberland, Susquehanna, Thompson, White Deer (Milton), and Yardley.

Western Pennsylvania Water Company was the product of the merger of 17 water companies into South Pittsburgh Water Company at various times from 1970 to 1973. WPW added six water distribution systems, extending its service territory into portions of 12 western Pennsylvania counties. The company operated through the following district offices: Butler, Clarion, Connellsville, Ellwood, Indiana, Kane, Kittanning, McDonald, Mon Valley, New Castle, Pittsburgh, Punxsutawney, Uniontown, Warren, and Washington.

After the merger of Riverton and Keystone in 1987, the former Pennsylvania-American Water Company purchased five systems: Red Land Water Company in York County, Campbelltown Water Company in Lebanon County, and three systems in the Moshannon Valley area, Clearfield County - Woodland-Bigler Area Authority, Allport Water Authority, and Graham Water Association.

Since the 1989 merger, the present Pennsylvania-American Water Company has acquired the Smith Township Municipal Authority (Washington County), Abington Township (Lackawanna County), Summit Township Municipal Authority (Butler County), Skyline Water Company (Dauphin County), Gregg Township Municipal Authority (Union County), and P-F Area Water Association (Washington County) systems. The Brownsville Water Company (Fayette County) and the California Water Company (Washington County) were also merged into the Company. In June, 1992, the Forge Road Acres water system (Cumberland County) was sold to South Middleton Township. As a result of its various mergers and acquisitions, the present Company furnishes water service to about 374,642 customers in the following municipalities:

All, or portions of, the Cities of Clairton and Pittsburgh (16th, 18th, 19th, 20th, 23rd, 29th, 30th, 31st and 32nd Wards), the Boroughs of Baldwin, Bethel Park, Brentwood, Bridgeville, Carnegie, Castle Shannon, Crafton, Dormont, Dravosburg, Elizabeth, Glassport, Greentree, Heidelberg, Homestead, Ingram, Jefferson, Liberty, Lincoln, Mt. Oliver, Munhall, Pleasant Hills, Port Vue, Rosslyn Farms, Thornburg, West Elizabeth, West Homestead, West Mifflin, Whitaker and Whitehall and the Townships of Baldwin, Collier, Elizabeth, Forward, Mt. Lebanon, North Fayette, Robinson, Scott, South Fayette, South Park and Upper St. Clair in Allegheny County;

All, or portions of, the Borough of Kittanning and the Townships of Manor and Rayburn in Armstrong County;

All, or portions of, the Boroughs of Ellwood City, Frankfort Springs and Koppel and the Townships of Franklin and North Sewickly in Beaver County;

All, or portions of, the Borough of Yardley and the Townships of Falls and Lower Makefield in Bucks County;

All, or portions of, the City of Butler, the Borough of East Butler and the Townships of Butler, Connoquenessing, Center, Oakland and Summit in Butler County;

All, or portions of, the Boroughs of Philipsburg and South Philipsburg and the Township of Rush in Centre County;

All, or portions of, the Borough of Clarion and the Townships of Clarion and Monroe in Clarion County;

All, or portions of, the Boroughs of Osceola Mills and Chester Hill and the Townships of Boggs, Bradford, Decatur, Graham and Morris in Clearfield County;

All, or portions of, the Borough of Berwick and the Township of Briar Creek in Columbia County;

All, or portions of, the Boroughs of Camp Hill, Lemoyne, New Cumberland, Shiremanstown, West Fairview and Wormleysburg and the Townships of East Pennsboro, Hampden, Lower Allen, Silver Spring and Upper Allen in Cumberland County;

All, or portions of, the Townships of Derry and South Hanover in Dauphin County;

All, or portions of, the Cities of Connellsville and Uniontown, the Boroughs of Brownsville, South Connellsville and West Brownsville and the Townships of Brownsville, Bullskin, Connellsville, Dunbar, Luzerne, Menallen, North Union, Redstone and South Union in Fayette County;

All, or portions of, the Borough of Indiana and the Township of White in Indiana County;

All, or portions of, the Boroughs of Big Run and Punxsutawney and the Townships of Bell, Gaskill, Henderson, McCalmont and Young in Jefferson County;

All, or portions of, the Boroughs of Clarks Green, Clarks Summit and Dalton and the Townships of Abington, Glenburn and South Abington in Lackawanna County;

All, or portions of, the City of New Castle; the Boroughs of Ellport, Ellwood City and South New Castle and the Townships of Hickory, Neshannock, Perry, Shenango, Taylor, Union and Wayne in Lawrence County;

All, or portions of, the Borough of Palmyra and the Townships of Annville, North Annville, North Londonderry, South Annville and South Londonderry in Lebanon County;

All, or portions of, the Borough of Nescopeck and the Township of Salem in Luzerne County;

All, or portions of, the Borough of Kane and the Township of Wetmore in McKean County;

All, or portions of, the Boroughs of Bridgeport and Norristown and the Township of East Norriton, Lower Providence, Plymouth, Upper Merion, West Norriton, Whitpain and Worcester in Montgomery County;

All, or portions of, the Boroughs of Bangor and Roseta and the Townships of Plainfield, Upper Mt. Bethel and Washington in Northampton County;

All, or portions of, the Boroughs of Milton, Northumberland and Watsonstown and the Townships of Delaware, East Chillisquaque, Point, Turbot, Upper Augusta and West Chillisquaque in Northumberland County;

All, or portions of, the Borough of Frackville and the Townships of Butler, Mahanoy, New Castle and West Mahanoy in Schuylkill County;

All, or portions of, the Boroughs of Great Bend, Hallstead, Lanesboro, Montrose, Susquehanna and Thompson and the Townships of Bridgewater, Great Bend, Harmony and Oakland in Susquehanna County;

All, or portions of, the Borough of Lewisburg and the Townships of Buffalo, East Buffalo, Gregg, Kelly and White Deer in Union County;

All, or portions of, the City of Warren and the Townships of Conewango, Glade, Meade, and Pleasant in Warren County;

All, or portions of, the Cities of Monongahela and Washington and the Boroughs of Burgettstown, California, Canonsburg, Coal Center, East Washington, Finleyville, Houston, McDonald, Midway and New Eagle and the Townships of Amwell, Canton, Carroll, Cecil, Chartiers, East Pike Run, Fallowfield, Hanover, Jefferson, Mt. Pleasant, North Franklin, North Strabane, Nottingham, Peters, Robinson, Smith, Somerset, South Franklin, South Strabane and Union in Washington County;

All, or portions of, the Townships of Fairview and Newberry in York County.

10/1/94

COMPARATIVE BALANCE SHEET

1. The utility shall classify its various assets and liabilities insofar as it is practical to do so under the various account titles given in this schedule. Additional spaces have been provided under the various divisions of assets and liabilities for the insertion of such account titles carried on the utility's books which will not permit of the classification given.

2. Column (b) entitled "Balance At Beginning of Year" and column (c), "Balance At Close of Year," have reference to the balances of the various accounts at the beginning and close of the year covered by this report.

		ASSETS			
		1993		1993	
Line No.	ACCOUNT TITLE (a)	BALANCE AT BEGINNING OF YEAR (b)	BALANCE AT CLOSE OF YEAR (c)	NET CHANGE DURING THE YEAR (d)	
1	I. FIXED CAPITAL	
2	Land	37 000	37 165	165	
3	Buildings or Structures	2 267 746	2 317 971	50 225	
4	Equipment	31 316	47 676	16 360	
5	Other Fixed Capital or Property Accounts: (Specify)	
6	Vehicles	47 148	47 148		
7	Office Equipment	4 890	13 276	8 386	
8	Franchises & Consents	18 129	18 129		
9					
10					
11					
12	Total Fixed Capital	2 406 229	2 481 365	75 136	
13	II. INVESTMENTS	
14	Investment Securities				
15	Other Investments: (Specify)				
16					
17					
18	Total Investments				
19	III. REACQUIRED SECURITIES	
20	Reacquired Capital Stock and Bonds				
21	IV. FUNDS	
22	Sinking Fund Assets				
23	Insurance and Other Reserve Fund Assets				
24	Total Funds				
25	V. SPECIAL DEPOSITS	
26	Interest Special Deposits				
27	Dividend Special Deposits				
28	Other Special Deposits				
29	Total Special Deposits				
30	VI. CURRENT ASSETS	
31	Cash	63 309	66 992	3 683	
32	Notes Receivable				
33	Accounts Receivable	334 485	415 789	81 304	
34	Materials and Supplies	6 560	5 770	(790)	
35	Other Current Assets: (Specify)				
36					
37	Total Current Assets	404 354	488 551	84 197	
38	VII. PREPAYMENTS	
39	Prepaid Insurance				
40	Prepaid Interest				
41	Prepaid Taxes				
42	Other Prepaid Accounts				
43	Total Prepayments				
44	VIII. DEFERRED CHARGES	
45	Unamortized Debt Discount and Expense				
46	Other Deferred Charges: (Specify)				
47					
48					
49					
50					
51	Total Deferred Charges				
52	GRAND TOTALS	2 810 593	2 969 916	159 323	

COMPARATIVE BALANCE SHEET

3. Column (d), entitled "Net Change During The Year" should show, for each account and division total, the difference between the amounts reported in columns (b) and (c). If the amount reported in column (c) is in excess of the amount reported in column (b), the difference should be shown in black ink and any reverse entries in red.

4. If the utility had any contingent assets and liabilities at the close of the year covered by this report, attach hereto a statement giving full particulars of parties, dates of maturity, amount of principal liability, dates of interest, etc. If there were no contingent assets or liabilities, state that fact.

LIABILITIES				
Line No.	ACCOUNT TITLE (a)	1993		NET CHANGE DURING THE YEAR (d)
		BALANCE AT BEGINNING OF YEAR (b)	BALANCE AT CLOSE OF YEAR (c)	
1	I. CORPORATE CAPITAL LIABILITY			
2	Capital Stock (page 7)	250 000	250 000	
3	II. NON CORPORATE PROPRIETORSHIP			
4	Sole proprietorship			
5	Partnership			
6	III. FUNDED DEBT			
7	Bonds (page 7)			
8	Real Estate Mortgages (page 7)			
9	Other Funded Debt: (Specify) (page 7)			
10				
11				
12	Total Funded Debt			
13	IV. CURRENT LIABILITIES			
14	Workmen's Compensation			
15	Notes Payable	4 706	4 706	
16	Accounts Payable	39 442	99 909	60 467
17	Matured Funded Debt			
18	Matured Interest			
19	Dividends Payable			
20	Other Current Liabilities: (Specify)			
21	Payable to Affiliates	1 318 631	1 447 369	128 738
22	Accrued Interest	862	1 419	557
23	Accrued Taxes	4 514	5 663	1 149
24				
25				
26				
27				
28				
29				
30				
31				
32				
33				
34	Total Current Liabilities	1 368 155	1 559 066	190 911
35	V. ACCRUED LIABILITIES			
36	Unmatured Interest Accrued			
37	Taxes Accrued			
38	Other Accrued Liabilities: (Specify)			
39	Accrued Payroll	9 332	16 622	7 290
40				
41				
42	Total Accrued Liabilities	9 332	16 622	7 290
43	VI. OPERATING RESERVES			
44	Reserve for Depreciation	557 911	614 378	56 467
45	Other Reserves: (Specify)			
46	Allowance for Doubtful Accounts	186 350	186 350	
47				
48	Total Operating Reserves	744 261	800 728	56 467
49	VII. CORPORATE SURPLUS			
50	Corporate Surplus (page 9)	436 835	343 500	(93 335)
51	GRAND TOTALS	2 810 583	2 969 916	159 333

PENNSYLVANIA - AMERICAN WATER CO.

BALANCE SHEET

ASSETS

AUG 31, 1994

LAST YEAR

UTILITY PLANT	\$710,851,653	\$656,028,831
CONSTRUCTION WORK IN PROGRESS	8,329,282	13,061,668
ACCUMULATED DEPRECIATION	91,932,418CR	78,318,465CR
UTILITY PLANT ACQUISITION ADJUSTMENTS	1,113,942CR	769,736CR
OTHER UTILITY PLANT ADJUSTMENTS		
	<u>626,134,575</u>	<u>590,002,298</u>
NONUTILITY PROPERTY	1,019,776	1,059,553
OTHER INVESTMENTS		1,000
CURRENT ASSETS		
CASH AND CASH EQUIVALENTS	3,094,316	4,822,295
TEMPORARY INV. - AT COST PLUS ACCRUED INT.		
CUSTOMER ACCOUNTS RECEIVABLE	11,548,572	11,858,564
ALLOWANCE FOR UNCOLLECTIBLE ACCOUNTS	203,545CR	270,309CR
UNBILLED REVENUES	11,581,967	9,943,077
FIT REFUND DUE FROM ASSOCIATED COMPANY		
MISCELLANEOUS RECEIVABLES	822,084	182,988
MATERIALS AND SUPPLIES - AT AVERAGE COST	1,565,800	1,259,001
OTHER	<u>5,377,967</u>	<u>4,903,818</u>
	<u>33,787,161</u>	<u>32,699,434</u>
DEFERRED DEBITS		
DEBT AND PREFERRED STOCK EXPENSE	2,016,238	2,056,996
EXPENSE OF RATE PROCEEDINGS	667,514	528,353
PRELIMINARY SURVEY AND INVESTIGATION CHARGES		
REG ASSET-INC TAX RECOVERABLE THRU RATES	97,818,365	98,726,961
OTHER	<u>7,110,038</u>	<u>5,749,118</u>
	<u>107,612,155</u>	<u>107,061,428</u>
	<u>\$768,553,667</u>	<u>\$730,823,713</u>

CAPITAL AND LIABILITIES

COMMON STOCK	\$ 19,548,199	\$ 18,935,158
PAID IN CAPITAL	76,113,075	70,653,442
RETAINED EARNINGS	103,687,549	98,043,514
TOTAL COMMON EQUITY	<u>199,348,823</u>	<u>187,632,114</u>
PREFERRED STOCK	18,542,600	21,820,000
LONG-TERM DEBT	295,525,000	263,535,000
TOTAL CAPITALIZATION	<u>513,416,423</u>	<u>472,987,114</u>
CURRENT LIABILITIES		
BANK DEBT - PENDING ISSUANCE OF SECURITIES	5,000,000	20,000,000
CURRENT PORTION OF LONG-TERM DEBT	6,010,000	5,260,000
ACCOUNTS PAYABLE	4,776,208	4,675,627
TAXES ACCRUED	5,572,535	6,095,904
INTEREST ACCRUED	8,051,003	6,248,970
CUSTOMER DEPOSITS	1,173	1,668
DIVIDENDS DECLARED	355,293	441,995
OTHER	<u>5,173,289</u>	<u>4,698,473</u>
	<u>34,939,501</u>	<u>47,422,637</u>
DEFERRED CREDITS		
CUSTOMER ADVANCES FOR CONSTRUCTION	41,160,404	33,740,102
DEFERRED INCOME TAXES	119,067,029	117,108,302
DEFERRED INVESTMENT TAX CREDITS	10,394,800	10,628,392
REG LIAB-INC TAX REFUNDABLE THRU RATES	10,549,165	12,081,900
OTHER	<u>7,082,394</u>	<u>6,235,654</u>
	<u>188,253,792</u>	<u>179,794,350</u>
CONTRIBUTIONS IN AID OF CONSTRUCTION	31,943,951	30,619,612
	<u>\$768,553,667</u>	<u>\$730,823,713</u>

PENNSYLVANIA - AMERICAN WATER CO.

(FORM 163)

EXHIBIT D

COMPARATIVE INCOME STATEMENT

Line No.	DESCRIPTION (a)	AMOUNTS APPLICABLE TO THE YEAR COVERED BY THIS REPORT 1993 (b)			COMPARISON WITH PRECEDING YEAR		
					AMOUNTS (c)		DIFFERENCE Inc—Black Dec—Red (d)
1	OPERATING INCOME
2	Operating Revenues (page 11, line 16, col. (b))	773	647	683	256		90 391
3	Operating Expenses (page 11, line 94, col. (b))	937	175	938	821		(1 646)
4	*Operating Income (2-3)	(163	528)	(255	565)		92 037
5	NON OPERATING INCOME
5	Non Operating Revenues: (Specify by account title)
7	Other non-operating Revenues	58	351	75	303		(16 952)
9	Interest Income		245		986		(741)
6	Total Non Operating Revenues	58	596	76	289		(17 693)
10	Non Operating Expenses: (Specify by account title)
11	Total Non Operating Expenses						
11	*Non Operating Income (6-13)	58	596	76	289		(17 693)
11	*GROSS INCOME (4+14)	(104	932)	(179	276)		74 344
12	Gross Income Deductions:
14	Interest		557		431		(126)
17	Long Term Rentals
18	Other Deductions: (Specify by account title)
25	Total Gross Income Deductions		557		431		(126)
26	*NET INCOME (15-25) (Transferred to line 29 below)	(105	489)	(179	707)		74 218

CORPORATE SURPLUS

Line No.	ITEM (a)	DEBITS (b)			CREDITS (c)		
27	Balance at Beginning of Year (page 6, line 51, col. (b))						438 835
28	Income Balance Transferred from Income Statement (Line 26 above, col. (b))			105 489			
30	Additions to Surplus: (Specify by Account Title or Description)						
31	Prior Period Adjustments for Plant in Service						10 154
32							
33							
34							
35							
36							
37							
38							
39							
40	Deductions from Surplus: (Specify by Account Title or Description)						
41	Dividends						
42							
43							
44							
45							
46							
47							
48							
49							
50							
51							
52	Balance at Close of Year (page 6, line 81, col. (c))						343 500
53	Totals						

PENNSYLVANIA - AMERICAN WATER CO.

STATEMENT OF INCOME AND RETAINED EARNINGS

TWELVE MONTHS TO DATE AUG 31, 1994

LAST YEAR

OPERATING REVENUES	\$ 171,993,299	\$ 162,022,351
OPERATING EXPENSES		
OPERATION AND MAINTENANCE	83,024,553	76,631,421
	15,905,167	13,857,810
DEPRECIATION		
TAXES ON OPERATING INCOME		
GENERAL	9,459,592	9,500,177
STATE INCOME	3,057,731	2,698,052
FEDERAL INCOME	12,148,086	10,877,407
	<u>123,595,129</u>	<u>113,564,867</u>
UTILITY OPERATING INCOME	48,398,170	48,457,484
OTHER INCOME		
ALLOWANCE FOR OTHER FUNDS USED DURING CONST	277,917	287,319
MISCELLANEOUS OTHER INCOME	160,381	211,693
GAIN (LOSS) ON SALE OF PROPERTY	285,036	78,600
	<u>49,121,504</u>	<u>49,035,096</u>
OTHER DEDUCTIONS		
AMORTIZATION OF PREFERRED STOCK EXPENSE	9,006	13,956
AMORTIZATION OF UTILITY PLANT ADJUSTMENTS	2,291CR	45,445
MISCELLANEOUS OTHER DEDUCTIONS	140,907	919,709
TAXES ON OTHER INCOME AND DEDUCTIONS		
GENERAL	90,126	58,962
STATE INCOME	27,346	17,397CR
FEDERAL INCOME	68,696	41,923CR
	<u>333,790</u>	<u>978,752</u>
INCOME BEFORE INTEREST CHARGES	48,787,714	48,056,344
INTEREST CHARGES		
INTEREST ON LONG-TERM DEBT	25,666,911	24,961,098
AMORTIZATION OF DEBT EXPENSE	215,215	212,477
INTEREST ON BANK DEBT	244,663	457,524
OTHER INTEREST	11,621	12,687
ALLOWANCE FOR BORROWED FUNDS USED DURING CONST	314,203CR	407,588CR
	<u>25,824,207</u>	<u>25,236,198</u>
NET INCOME	22,963,507	22,820,146
RETAINED EARNINGS AT BEGINNING OF PERIOD	98,043,515	92,164,735
	<u>121,007,022</u>	<u>114,984,881</u>
DIVIDENDS		
PREFERRED STOCK	1,460,987	1,776,367
COMMON STOCK	15,858,484	15,164,999
	<u>17,319,471</u>	<u>16,941,366</u>
RETAINED EARNINGS AT END OF PERIOD	\$ 103,687,551	\$ 98,043,515

PENNSYLVANIA - AMERICAN WATER CO.

(FORM 164 REV 1/93)

EXHIBIT F

IN THE UNITED STATES BANKRUPTCY COURT
FOR THE MIDDLE DISTRICT OF PENNSYLVANIA

In re : Chapter 11
: :
COST CONTROL MARKETING : :
AND MANAGEMENT, INC., : :
: :
Debtor. : No. 5-90-01155

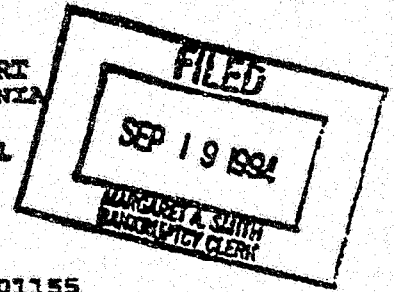

ORDER APPROVING SALE FREE AND CLEAR OF LIENS

AND NOW, this 19th day of September, 1994, upon consideration of the Motion of the Debtor for approval of the sale of the stock and/or assets of Country Place Water Company, Inc. and Country Place Waste Treatment Co., Inc., and after notice and hearing, the Court makes the following findings, conclusions and orders:

Findings of Fact

A. The above-captioned case was commenced by the filing of a voluntary petition for relief under Chapter 11 of the Bankruptcy Code on October 19, 1991. The Debtor has remained in possession of its assets and in operation of its business as a debtor-in-possession pursuant to Sections 1107 and 1108 of the Bankruptcy Code. To date, no trustee or examiner has been appointed.

B. The Debtor is the owner of 100% of the stock of Country Place Water Company, Inc. and Country Place Waste Treatment Co., Inc. (the "Country Place Utilities"). The assets of the Country Place Utilities are subject to a lien in favor of the Pennsylvania Water Facilities Loan Board to secure a loan in

the principal amount of \$450,000. In addition, the assets of the Country Place Utilities are asserted to be subject to a lien in favor of PNC Bank, N.A. as a result, *inter alia*, of a judgment in the approximate amount of \$2 million entered in favor of PNC and against the Country Place Utilities on December 2, 1993, arising out of various loans extended by PNC on which the Country Place Utilities were the obligors or co-obligors. The stock of the Country Place Utilities is asserted to be subject to a lien in favor of PNC securing in excess of \$10 million asserted to be owed to PNC by the Debtor. The Debtor disputes the validity of PNC's liens.

C. In addition to the foregoing liens, the Country Place Utilities are subject to various claims, some of which are in dispute, including a claim asserted by Donald J. Kessler, Sr., that is the subject of litigation presently pending in the United States District Court for the Middle District of Pennsylvania.

D. In May of 1994, following the entry of an order of the Court of Common Pleas of Monroe County denying a petition of the Country Place Utilities to open PNC's judgment, PNC executed on that judgment and caused a sheriff's sale of certain of the assets of the Country Place Utilities to be scheduled for June 16, 1994. The Debtor filed a motion in this Court seeking to enjoin that sale and this Court scheduled a hearing to consider that motion for June 15, 1994. On that date, PNC, the Debtor and the Country Place Utilities entered into an agreement under which the Debtor and the Country Place Utilities agreed to the sale of

the stock and/or assets of the Country Place Utilities free and clear of liens and claims, other than the lien in favor of the Pennsylvania Water Facilities Loan Board, under the supervision of this Court, pursuant to Section 363 of the Bankruptcy Code. The terms of the parties' agreement respecting the sale of the Country Place Utilities are reflected in the transcript of the June 15, 1994 hearing.

E. Pursuant to that Agreement, on August 5, 1994, the Debtor filed a motion for a free and clear sale of the stock and/or assets of the Country Place Utilities at auction to be held on September 14, 1994 and caused notice of that motion to be sent by first-class mail, postage pre-paid to all creditors and parties-in-interest as well as to various persons who had expressed interest in acquiring the Country Place Utilities. The Court finds that the form, content and distribution of the notice of sale was adequate and appropriate under the circumstances. The notice was mailed on August 12, 1994 and provided, *inter alia*, for any objection to the sale to be filed and served no later than 20 days after the notice.

F. Two timely objections to the sale were filed: one by the United States Trustee and the other on behalf of Chateau Associates, Richard and Barbara Davidheiser, Eulda Rosario and Kathleen Mazza, putative creditors of the Debtor. In addition, on September 13, 1994, a motion for a temporary restraining order, and preliminary and permanent injunctions against the sale were filed on behalf of Donald J. Kessler, Sr., a putative

creditor of the Country Place Utilities. Prior to the hearing on approval of the sale on September 14, 1994, the United States Trustee, Chateau Associates, Mr. and Mrs. Davidheiser, Mr. Rosario and Ms. Mazza, and Mr. Kessler withdrew their objections to the sale.

G. On September 14, 1994, the Debtor conducted an auction of the Country Place Utilities. Four bidders appeared and were qualified to bid at the auction. The highest bid was submitted by Pennsylvania-American Water Company, in the amount of \$4.2 million, plus its assumption of the obligation of the Country Place Utilities to the Pennsylvania Water Facilities Loan Board, with closing to take place within 90 days after the date of this Order or 10 days after the approval of the sale by the Pennsylvania Public Utilities Commission (which the purchaser undertakes to use its best efforts to obtain), whichever is later.

H. The amount of the bid of Pennsylvania-American Water Company compared favorably with the Debtor's opinion of the value of the Country Place Utilities as well as the opinion of Gary D. Shambaugh, an expert on the valuation of public utilities, offered at a hearing in this case earlier this year. Accordingly, the Court finds that the proposed sale to Pennsylvania-American Water Company is for fair value and is in the best interest of the Debtor and its estate.

I. The Court further finds that the proposed sale is an arm's length transaction. There is no affiliation between

Pennsylvania-American Water Company on one hand and the Debtor or any of its principals or affiliates on the other. Nor is there any agreement on the part of Pennsylvania-American Water Company to employ any employee, officer or director of the Debtor or the Country Place Utilities after its purchase. Accordingly, the Court finds that the sale of the Country Place Utilities to Pennsylvania-American Water Company is in good faith and for value within the meaning of Section 363(m) of the Bankruptcy Code and In re Abbotts Dairies of Pennsylvania, Inc., 788 F.2d 143 (3d Cir. 1986).

Conclusions and Orders

Accordingly, the Court hereby concludes and orders as follows:

1. The sale of the Country Place Utilities to Pennsylvania-American Water Company for the consideration of \$4.2 million cash and the assumption of the Country Place Utilities' obligations to the Pennsylvania Water Facilities Loan Board is hereby APPROVED.

2. Pursuant Section 363(F) of the Bankruptcy Code, such sale shall be free and clear of all liens, encumbrances and claims, other than the lien in favor of the Pennsylvania Water Facilities Loan Board to be assumed by the purchaser, with such liens, claims and encumbrances to attach to the proceeds of the sale in the order of priority of such liens, claims and

encumbrances in the underlying stock and assets of the Country
Place Utilities under applicable law.

3. The proceeds of the sale, including the deposit
made by the purchaser upon the Court's determination that its was
the highest and best bid, shall be held, in escrow, jointly in
the names of John H. Doran (counsel for the Debtor) and William
A. Slaughter (counsel for FNC Bank, N.A.) in an interest bearing
account pending further order of this Court.



John J. Thomas, U.S.B.C.

CERTIFICATE OF MAILING

The undersigned deputy clerk hereby certifies that a copy of this document was mailed today to the parties named below at their respective addresses as shown in documents on file or as otherwise indicated in the court's records.

1. J. Doran Esq.
2. S. Brewster Esq.
3. J. W. Stanger Esq.
4. H. G. Gunders Esq.
5. WST

6. W. W. W. W. W. Esq.
7. J. J. J. J. Esq.
8. J. J. J. J. Esq.
9. D. D. D. D.
- 10.

Dated: 9-19-94

Deputy Clerk J. A. Conroy

COMPARATIVE BALANCE SHEET

1. The utility shall classify its various assets and liabilities according as it is practical to do so under the various account titles given in this schedule. Additional spaces have been provided under the various divisions of assets and liabilities for the insertion of such account titles carried on the utility's books which will not permit of the classification given.

2. Column (b) entitled "Balance At Beginning of Year" and column (c), "Balance At Close of Year," have reference to the balances of the various accounts at the beginning and close of the year covered by this report.

ASSETS				
Line No.	ACCOUNT TITLE (a)	1993		NET CHANGE DURING THE YEAR (d)
		BALANCE AT BEGINNING OF YEAR (b)	BALANCE AT CLOSE OF YEAR (c)	
I. FIXED CAPITAL				
1	
2	Land	37 000	37 165	165
3	Buildings or Structures	2 267 746	2 317 971	50 225
4	Equipment	31 316	47 676	16 360
5	Other Fixed Capital or Property Accounts: (Specify)
6	Vehicles	47 148	47 148	
7	Office Equipment	4 890	13 276	8 386
8	Franchises & Consents	18 129	18 129	
9				
10				
11				
12	Total Fixed Capital	2 406 279	2 481 365	75 136
II. INVESTMENTS				
13	
14	Investment Securities			
15	Other Investments: (Specify)
16				
17				
18	Total Investments			
III. REACQUIRED SECURITIES				
19	
20	Reacquired Capital Stock and Bonds			
IV. FUNDS				
21	
22	Sinking Fund Assets			
23	Insurance and Other Reserve Fund Assets			
24	Total Funds			
V. SPECIAL DEPOSITS				
25	
26	Interest Special Deposits			
27	Dividend Special Deposits			
28	Other Special Deposits			
29	Total Special Deposits			
VI. CURRENT ASSETS				
30	
31	Cash	52 309	66 992	14 683
32	Notes Receivable			
33	Accounts Receivable	334 485	415 789	81 304
34	Materials and Supplies	6 560	5 770	(790)
35	Other Current Assets: (Specify)
36				
37	Total Current Assets	404 354	488 551	84 197
VII. PREPAYMENTS				
38	
39	Prepaid Insurance			
40	Prepaid Interest			
41	Prepaid Taxes			
42	Other Prepaid Accounts			
43	Total Prepayments			
VIII. DEFERRED CHARGES				
44	
45	Unamortized Debt Discount and Expense			
46	Other Deferred Charges: (Specify)
47				
48				
49				
50				
51	Total Deferred Charges			
52	GRAND TOTALS	2 810 583	2 969 916	159 333

COMPARATIVE BALANCE SHEET

3. Column (d) entitled "Net Change During The Year" should show, for each account and division total, the difference between the amounts reported in columns (b) and (c). If the amount reported in column (c) is in excess of the amount reported in column (b), the difference should be shown in black ink and not reverse entries in red.

4. If the utility had any contingent assets and liabilities at the close of the year covered by this report, attach hereto a statement giving full particulars of nature, date of maturity, amount of principal liability, date of interest, etc. If there were no contingent assets or liabilities, state that fact.

LIABILITIES				
Line No.	ACCOUNT TITLE (a)	1943		1942
		BALANCE AT BEGINNING OF YEAR (b)	BALANCE AT CLOSE OF YEAR (c)	NET CHANGE DURING THE YEAR (d)
I. CORPORATE CAPITAL LIABILITY				
1				
2	Capital Stock (page 7)	250 000	250 000	
II. NON CORPORATE PROPRIETORSHIP				
3				
4	Sole proprietorship			
5	Partnership			
III. FUNDED DEBT				
6				
7	Bonds (page 7)			
8	Real Estate Mortgages (page 7)			
9	Other Funded Debt: (Specify) (page 7)			
10				
11				
12	Total Funded Debt			
IV. CURRENT LIABILITIES				
13				
14	Workmen's Compensation			
15	Notes Payable	4 706	4 706	
16	Accounts Payable	39 442	99 909	60 467
17	Matured Funded Debt			
18	Matured Interest			
19	Dividends Payable			
20	Other Current Liabilities: (Specify)			
21	Payable to Affiliates	1 318 631	1 447 369	128 738
22	Accrued Interest	862	1 419	557
23	Accrued Taxes	4 514	5 653	1 149
24				
25				
26				
27				
28				
29				
30				
31				
32				
33				
34	Total Current Liabilities	1 368 155	1 559 066	190 911
V. ACCRUED LIABILITIES				
35				
36	Unmatured Interest Accrued			
37	Taxes Accrued			
38	Other Accrued Liabilities: (Specify)			
39	Accrued Payroll	9 332	16 622	7 290
40				
41				
42	Total Accrued Liabilities	9 332	16 622	7 290
VI. OPERATING RESERVES				
43				
44	Reserve for Depreciation	557 911	614 378	56 467
45	Other Reserves: (Specify)			
46	Allowance for Doubtful Accounts	186 350	186 350	
47				
48	Total Operating Reserves	744 261	800 728	56 467
VII. CORPORATE SURPLUS				
49				
50	Corporate Surplus (page 9)	438 835	343 500	(95 335)
51	GRAND TOTALS	2 810 583	2 969 916	159 333

PENNSYLVANIA-AMERICAN WATER COMPANY

BALANCE SHEET

PRO FORMA
AUG 31, 1994

ASSETS

UTILITY PLANT	713,333,018
CONSTRUCTION WORK IN PROCESS	8,329,282
ACCUMULATED DEPRECIATION	(92,546,796)
UTILITY PLANT ACQUISITION ADJ.	(803,750)
OTHER UTILITY PLANT ADJUSTMENTS	

628,311,754

NONUTILITY PROPERTY

1,019,776

OTHER INVESTMENTS

0

CURRENT ASSETS

CASH AND CASH EQUIVALENTS	3,161,308
TEMPORARY INVESTMENTS	
CUSTOMER ACCOUNTS RECEIVABLE	11,964,361
ALLOWANCE FOR UNCOLL. ACCT.	(389,895)
UNBILLED REVENUES	11,581,967
FIT REFUND DUE FROM ASSOC. COMPANY	0
MISCELLANEOUS RECEIVABLES	822,084
MATERIALS AND SUPPLIES	1,571,570
OTHER	5,377,967

34,089,362

DEFERRED DEBITS

DEBT AND PREF. STOCK EXPENSE	2,016,238
EXPENSE OF RATE PROCEEDINGS	667,514
PREL. SURVEY AND INVEST. CHARGES	
REG ASSET-INC TAX RECOVERABLE THRU RATES	97,818,365
OTHER	7,110,038

107,612,155

771,033,047

CAPITAL AND LIABILITIES

COMMON STOCK	19,548,199
PAID IN CAPITAL	76,113,075
RETAINED EARNINGS	103,687,549

TOTAL COMMON EQUITY

199,348,823

PREFERRED STOCK

18,542,600

LONG-TERM DEBT

295,525,000

TOTAL CAPITALIZATION

513,416,423

CURRENT LIABILITIES

BANK DEBT-PENDING ISSUANCE OF SEC.	7,479,380
CURR. PORTION OF LONG-TERM DEBT	6,010,000
ACCOUNTS PAYABLE	4,776,208
TAXES ACCRUED	5,572,535
INTEREST ACCRUED	8,051,003
CUSTOMER DEPOSITS	1,173
DIVIDENDS DECLARED	355,293
OTHER	5,173,289

37,418,881

DEFERRED CREDITS

CUSTOMER ADVANCES FOR CONSTR.	41,160,404
DEFERRED INCOME TAXES	119,067,029
DEFERRED INVESTMENT TAX CREDIT	10,394,800
REG LIAB-INC TAX REFUNDABLE THRU RATES	10,549,165
OTHER	7,082,394

188,253,792

CONTRIBUTIONS IN AID OF CONSTRUCTION

31,943,951

771,033,047

PENNSYLVANIA - AMERICAN WATER COMPANY
 STATEMENT OF INCOME AND RETAINED EARNINGS
 TWELVE MONTHS ENDED DECEMBER 31, 1993

	PAWC	PCP SEWER	PRO FORMA CONSOLIDATED
OPERATING REVENUES	166,310,829	1,044,057	167,354,886
OPERATION EXPENSES			
OPERATIONS AND MAINTENANCE	78,729,251	610,095	79,339,346
DEPRECIATION	14,527,343	74,441	14,601,784
TAXES ON OPERATING INCOME			
GENERAL TAXES	9,370,600	52,268	9,422,868
STATE INCOME	3,137,355	51,834	3,189,189
FEDERAL INCOME	12,051,741	136,257	12,187,998
	117,816,290	924,895	118,741,185
UTILITY OPERATING INCOME	48,494,539	119,162	48,613,701
OTHER INCOME			
ALLOW. FOR OTHER FUNDS FOR CONSTRUCT.	183,526		183,526
MISCELLANEOUS OTHER INCOME	170,654		170,654
GAIN (LOSS) ON SALE OF PROPERTY	281,388		281,388
	49,130,107	119,162	49,249,269
OTHER DEDUCTIONS			
AMORT. OF PREFERRED STOCK EXPENSE	13,371		13,371
AMORT. OF UTILITY PLANT ADJUSTMENTS	33,927	31,019	64,946
MISCELLANEOUS OTHER DEDUCTIONS	662,713		662,713
TAXES ON OTHER INCOME AND DEDUCTIONS			
GENERAL	79,961		79,961
STATE INCOME	31,324		31,324
FEDERAL INCOME	78,535		78,535
	899,831	31,019	930,850
INCOME BEFORE INTEREST CHARGES	48,230,276	88,143	48,318,419
INTEREST CHARGES			
INTEREST ON LONG-TERM DEBT	24,746,686		24,746,686
AMORTIZATION OF DEBT EXPENSE	227,755		227,755
INTEREST ON BANK DEBT	476,245	133,887	610,132
OTHER INTEREST	1,278		1,278
ALLOW. FOR BORROWED FUNDS FOR CONSTRUCT	(305,667)		(305,667)
	25,146,297	133,887	25,280,184
NET INCOME	23,083,979	(45,744)	23,038,235
RETAINED EARNINGS AT BEGINNING OF PERIOD	89,443,468		89,443,468
PRIOR PERIOD ADJUSTMENTS	112,527,447	(45,744)	112,481,703
DIVIDENDS			
PREFERRED STOCK	1,696,085		1,696,085
COMMON DIVIDENDS	15,767,822		15,767,822
	17,463,907	0	17,463,907
RETAINED EARNINGS AT END OF PERIOD	95,063,540	(45,744)	95,017,796

DEBITS

Utility plant	\$2,481,365
Cash	66,992
Materials & supplies	5,770
Accounts receivable	415,789
Utility plant acquisition adjustment	310,192

CREDITS

Accumulated depreciation	\$ 614,378
Allowance for uncollectible	186,350
Bank debt pending issuance of securities	2,479,380

EXHIBIT K

COUNTRY PLACE WASTE TREATMENT CO., INC.

SCHEDULE OF RATES

GRAVITY SYSTEM (C) (I)

Application

This schedule is available to all customers of the Gravity System.

Charges:

<u>Type</u>	<u>Per Month</u>
<u>Residential</u>	
Usage	\$20.06
Availability	9.72
<u>Property Owners Association</u>	
Usage	\$31.56
Availability	9.72
<u>Commercial</u>	
Usage	\$40.53

Definition:

The term "usage" for the gravity system shall be deemed to mean any building connected to the sewage collection system and containing any one or more of the following fixtures: wash stand, flush toilet, bathtub, shower, or kitchen faucet.

The term "availability" for the gravity system shall be deemed to mean a lot upon which no structure has been erected.

Terms of Payment:

Charges for customers of the gravity system will be billed and payable monthly, or quarterly, in arrears, at the option of Country Place Waste Treatment Co., Inc.

(C) Indicates Change
(I) Indicates Increase

Issued: October 14, 1993

Effective: October 15, 1993

COUNTRY PLACE WASTE TREATMENT CO., INC.

SCHEDULE OF RATES
(continued)

PRESSURE SYSTEM (C) (I)

Application

This schedule is available to all customers of the Pressure System.

Charges:

<u>Type</u>	<u>Per Month</u>
<u>Residential</u>	
Usage	\$26.09
Availability	8.43
<u>Property Owners Association</u>	
Usage	\$36.93
Availability	8.43
<u>Commercial</u>	
Usage	\$40.53

Definition:

The term "usage" for the pressure system shall be deemed to mean any building connected to the sewage collection system and containing any one or more of the following fixtures: wash stand, flush toilet, bathtub, shower, or kitchen faucet.

The term "availability" for the pressure system shall be deemed to mean a lot upon which no structure has been erected.

Terms of Payment:

Charges for customers of the pressure system will be billed and payable monthly, or quarterly, in arrears, at the option of Country Place Waste Treatment Co., Inc.

(C) Indicates Change
(I) Indicates Increase

Issued: October 14, 1993

Effective: October 15, 1993

Facilities which will be employed by Pennsylvania-American in furnishing service:

1. Collection system approximately 50 miles of 8" PVC mains and approximately 700 manholes
2. 3 pumping stations
3. Aeration lagoon - 370' x 268' x 12'
4. Accelapak flocculator/clarifier with gravity sand filter
5. Disinfection system

PENNSYLVANIA - AMERICAN WATER COMPANY
 ESTIMATED ANNUAL REVENUE AND EXPENSES

	SEWER
OPERATING REVENUES	1,044,057
OPERATION EXPENSES	
OPERATIONS AND MAINTENANCE	610,095
DEPRECIATION	74,441
TAXES ON OPERATING INCOME	
GENERAL TAXES	52,268
STATE INCOME	51,834
FEDERAL INCOME	136,257

	924,895

UTILITY OPERATING INCOME	119,162
OTHER INCOME	
ALLOW. FOR OTHER FUNDS FOR CONSTRUCT.	
MISCELLANEOUS OTHER INCOME	
GAIN (LOSS) ON SALE OF PROPERTY	

	119,162

OTHER DEDUCTIONS	
AMORT. OF PREFERRED STOCK EXPENSE	
AMORT. OF UTILITY PLANT ADJUSTMENTS	31,019
MISCELLANEOUS OTHER DEDUCTIONS	
TAXES ON OTHER INCOME AND DEDUCTIONS	
GENERAL	
STATE INCOME	
FEDERAL INCOME	

INCOME BEFORE INTEREST CHARGES	31,019

INCOME BEFORE INTEREST CHARGES	88,143

INTEREST CHARGES	
INTEREST ON LONG-TERM DEBT	
AMORTIZATION OF DEBT EXPENSE	
INTEREST ON BANK DEBT	133,887
OTHER INTEREST	
ALLOW. FOR BORROWED FUNDS FOR CONSTRUCT	

	133,887

NET INCOME	(45,744)
	=====



PENNSYLVANIA - AMERICAN WATER COMPANY

PO BX 871, 196 W JOHNSON H
NORRISTOWN PA 19404-0871

ACCOUNT NUMBER
540-07020023-00 1

AMOUNT DUE ▶ \$33.33

DUE DATE ▶ 11-08-94



DOE JANE
2932 MELODY LANE
TOBYHANNA PA 18466

AFTER
AMOUNT DUE

PA-AMERICAN WATER CO.
P.O. BOX 371412
PITTSBURGH PA 15250-7412

Please make checks payable to ▶ and indicate account no. on check. **PAWC**



Check here if address or telephone number has changed. See reverse side.

RETURN THIS PORTION WITH PAYMENT

BILLING PERIOD

Sep-12 TO Oct-12 (30 days)
Billing date 10-19-94
Next reading on/about Nov-09

METER INFORMATION

Meter number 000090494 Meter size 5/8

METER READING INFORMATION

Present-Actual 212900
Last 207900

Gallons used 5000



AMOUNT OF LAST BILL

\$35.88

You paid (Thank You) \$35.88-
Prior balance \$.00

CURRENT WATER CHARGES

BASIC CHARGES
4000 gal (Minimum) \$16.00
1000 gal X .000150 \$1.50
5000 gal \$17.50

OTHER CHARGES

Sewer service \$15.77
State Surcharge Water \$.04
State Surcharge Sewer \$.02

TOTAL CURRENT CHARGES \$33.33
Your prior balance was

TOTAL AMOUNT DUE \$33.33

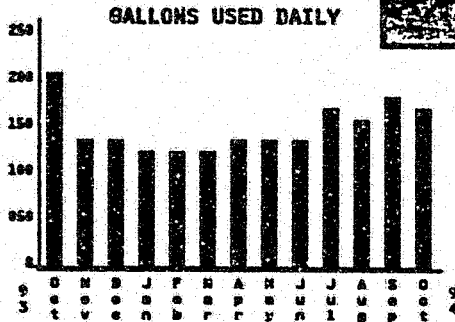

Average water used for this period was 167 gallons a day.

PENNSYLVANIA - AMERICAN WATER COMPANY
PO BX 871, 196 W JOHNSON H
NORRISTOWN PA 19404-0871

Business Telephone: 610-279-8616

Emergency Telephone: 610-275-1375

Service to: DOE JANE
2932 MELODY LANE
Account number: 540-07020023-00

MESSAGES TO YOU FROM PENNSYLVANIA - AMERICAN



COMMONWEALTH OF PENNSYLVANIA
PENNSYLVANIA PUBLIC UTILITY COMMISSION
P.O. BOX 3265, HARRISBURG, PA 17105-3265

January 27, 1995

IN REPLY PLEASE
REFER TO OUR FILE

A-230073
A-2122850024

Application of Pennsylvania-American Water Company and Country Place Waste Treatment Company, Inc. for approval of (1) the transfer, by sale, of all the sanitary sewage collection property and rights of Country Place Waste Treatment Company, Inc. to Pennsylvania-American Water Company, (2) the right of Pennsylvania-American Water Company to begin to offer or furnish sanitary sewage collection and disposal service to the public in portions of Coolbaugh Township, Monroe County, and (3) the abandonment by Country Place Waste Treatment Company, Inc. of all sewage service to the public.

Velma A. Redmond, Corporate Counsel
Pennsylvania-American Water Company
800 West Hersheypark Drive
P.O. Box 888
Hershey, Pennsylvania 17033-0888

Thomas J. Sniscak, Esquire
Malatesta, Hawke & McKean
100 North 10th Street
P.O. Box 1778
Harrisburg, Pennsylvania 17105

Receipt is acknowledged of the original and two copies of the application of Pennsylvania-American Water Company and Country Place Waste Treatment Company, Inc. which has been captioned and docketed to the above number. Receipt is also acknowledged of Pennsylvania-American Water Company's check No. 603066 in the amount of \$350.00 to cover the required filing fee.

It will be necessary for you to serve copies of said application upon the supervisors of Coolbaugh Township, and their planning commission, if any, as well as the Monroe County commissioners, and their planning commission, if any, and file proof of such service on all parties with the Commission.

Further, you are directed upon receipt of this letter to publish the enclosed notice once during each of the weeks of February 6 and 13, 1995, in a newspaper or newspapers having a general circulation in the areas involved and file proof of publication with the Commission on or before February 21, 1995.

The matter will receive the attention of the Commission and you will be advised of any further necessary procedure.

Very truly yours,

for JOHN G. ALFORD
Secretary

DOCKETED

JAN 27 1995

Enclosure
mpk

PENNSYLVANIA PUBLIC UTILITY COMMISSION

NOTICE TO BE PUBLISHED

Notice is hereby given that application has been made to the Pennsylvania Public Utility Commission, under the provisions of the Public Utility Code, by Pennsylvania-American Water Company and Country Place Waste Treatment Company, Inc. for approval of (1) the transfer, by sale, of all the sanitary sewage collection property and rights of Country Place Waste Treatment Company, Inc. to Pennsylvania-American Water Company, (2) the right of Pennsylvania-American Water Company to begin to offer or furnish sanitary sewage collection and disposal service to the public in portions of Coolbaugh Township, Monroe County, and (3) the abandonment by Country Place Waste Treatment Company, Inc. of all sewage service to the public. (A-^{A-230073}~~212285F0024~~)

Notice is hereby also given that this application may be considered by the Commission without a hearing. Protests or petitions to intervene may, however, be filed with the Public Utility Commission, Harrisburg, with a copy thereof served upon applicant on or before February 21, 1995, pursuant to Title 52 of the Pennsylvania Code.

PENNSYLVANIA-AMERICAN WATER COMPANY
and
COUNTRY PLACE WASTE TREATMENT COMPANY, INC.

Counsel for Pennsylvania-American Water Company

Velma A. Redmond, Corporate Counsel
Pennsylvania-American Water Company
800 West Hersheypark Drive
P.O. Box 888
Hershey, Pennsylvania 17033-0888

Counsel for Country Place Waste Treatment Co., Inc.

Thomas J. Sniscak, Esquire
Malatesta, Hawke & McKeon
100 North 10th Street
P.O. Box 1778
Harrisburg, Pennsylvania 17105

DATE: January 27, 1995

A-230073
SUBJECT: ~~A-212285F0024~~

TO: Legislative Reference Bureau
Pennsylvania Bulletin

FROM: ~~John G. Alford~~ Secretary

Application of Pennsylvania-American Water
Company and Country Place Waste Treatment
Company, Inc.

We attach hereto three copies of a notice to be published
in the Pennsylvania Bulletin at an appropriate time in connection with
the above checked proceeding.

Attachments
mpk

~~RECEIVED
FOLDER~~

DOCUMENT
FOLDER

INDEXED
JAN 27 1995
~~T~~

ORIGINAL



Pennsylvania-American Water Company

800 West Hersheypark Drive • P.O. Box 888 • Hershey, PA 17033-0888
(717) 533-5000

Velma A. Redmond
Corporate Counsel

April 4, 1995

RECEIVED
55 APR -5 11 9:07
PA: U.C. DIV.
INFO. CONTROL DIV.

A-230073

Mr. John G. Alford, Secretary
Pennsylvania Public Utility
Commission
New Filing Section, Room B-18
North Office Building
PO Box 3265
Harrisburg, PA 17120

Re: Application of Pennsylvania-American Water Company and Country Place Waste Treatment Company, Inc. for Approval of (1) the transfer, by sale, of all the sanitary sewage collection property and rights of Country Place Waste Treatment Company, Inc. to Pennsylvania-American Water Company, (2) the right of Pennsylvania-American Water Company to begin to offer or furnish sanitary sewage collection and disposal service to the public in portions of Coolbaugh Township, Monroe County, and (3) the abandonment by Country Place Waste Treatment Company, Inc. of all sewage service to the public; A-~~212285F0024~~

Dear Mr. Alford:

As directed in your letter of January 27, 1995 on the above-referenced application, attached is a proof of publication of the required notice.

Sincerely,

Velma A. Redmond

eth

Attachment

DOCUMENT
FOLDER



29

Proof of Publication of Notice in The Pocono Record

Under Act No. 587, Approved May 16, 1929

State of Pennsylvania
County of Monroe

ss:

A-230073

WILLIAM R. WHITE, JR.

.....An Executive of Pocono Record, of the County and State aforesaid, being duly sworn, deposes and says that THE POCONO RECORD, a newspaper of general circulation published at 511 Lenox Street, Borough of Stroudsburg, County and State aforesaid, was established April 2, 1894, since which date THE POCONO RECORD has been regularly issued in said County, and that the printed notice of publication attached hereto is exactly the same as was printed and published in the regular editions and issues of the said THE POCONO RECORD on the following dates, viz:—

MARCH 14th, &

and the 21st day of MARCH

19 95

Affiant further deposes that he is duly authorized by the POCONO RECORD, a newspaper of general circulation, to verify the foregoing statement under oath, and affiant is not interested in the subject matter of the aforesaid notice or advertisement, and that all allegations in the foregoing statements as to time, place and character of publication are true.

425

COPY OF NOTICE OR PUBLICATION

PENNSYLVANIA PUBLIC UTILITY COMMISSION NOTICE TO BE PUBLISHED

NOTICE IS HEREBY GIVEN that application has been made to the Pennsylvania Public Utility Commission, under the provisions of the Public Utility Code, by Pennsylvania-American Water Company and Country Place Waste Treatment Company, Inc. for approval of (1) the transfer, by sale, of all the sanitary sewage collection property and rights of Country Place Waste Treatment Company, Inc. to Pennsylvania-American Water Company, (2) the right of Pennsylvania-American Water Company to begin to offer or furnish sanitary sewage collection and disposal service to the public in portions of Coolbaugh Township, Monroe County, and (3) the abandonment by Country Place Waste Treatment Company, Inc. of all sewage service to the public. (A-212285F-0024)

Notice is hereby also given that this application may be considered by the Commission without a hearing. Protests or petitions to intervene may, however, be filed with the Public Utility Commission, Harrisburg, with a copy thereof served upon applicant on or before February 21, 1995, pursuant to Title 52 of the Pennsylvania Code.

PENNSYLVANIA-AMERICAN WATER COMPANY and COUNTRY PLACE WASTE TREATMENT COMPANY, INC.
Counsel for Pennsylvania-American Water Company
Valma A. Redmond,
Corporate Counsel
Pennsylvania-American Water Company
800 West Hersheypark Drive
P.O. Box 888
Hershey, Pennsylvania 17033-0888
Counsel for Country Place Waste Treatment Co., Inc.
Thomas J. Snijscek, Esquire
Malatesta, Hawke & McKeon
100 North 10th Street
P.O. Box 1778
Harrisburg, Pennsylvania 17105
PR — March 14, 21

For The Pocono Record

Sworn to and subscribed before me this 24th day of MARCH, 1995

My Commission Expires:

Barbara H. [Signature]
Notary Public

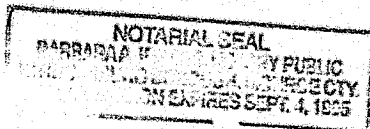

RECEIVED
95 APR -5 AM 9:07
I.A.P.U.C.
INFO. CONTROL DIV.

Statement of Advertising Costs

PA. AMERICAN WATER CO.
PA. PUBLIC UTILITY COMMISSION
COUNTRY PLACE WASTE TREATMENT CO., INC.

To POCONO RECORD

For publishing the notice or publication attached hereto on the above stated dates	\$ 81.24
Probating Same.....	\$ 1.00
Total	\$ 82.24

Receipt for Advertising Costs

DOCUMENT FOLDER

DOCKETED
APR 10 1995

THE POCONO RECORD, a newspaper of general circulation, hereby acknowledges receipt of the aforesaid notice and publication cost and certifies that the same have been duly paid.

The Pocono Record
a Newspaper of General Circulation

By

ORIGINAL

A-230073

BEFORE THE
PENNSYLVANIA PUBLIC UTILITY COMMISSION

In re: Application of Pennsylvania-American Water Company and Country Place Waste Treatment Company, Inc. for Approval of (1) the transfer, by sale, of all the sanitary sewage collection property and rights of Country Place Waste Treatment Company, Inc. to Pennsylvania-American Water Company, (2) the right of Pennsylvania-American Water Company to begin to offer or furnish sanitary sewage collection and disposal service to the public in portions of Coolbaugh Township, Monroe County, and (3) the abandonment by Country Place Waste Treatment Company, Inc. of all sewage service to the public; A-212285F0024

PROOF OF SERVICE

I hereby certify that I am this day serving the foregoing documents upon the persons and in the manner indicated below, which service satisfies the requirements of 52 Pa. Code §3.61 and §3.62 and 1 Pa. Code §33.36:

Service by first class mail addressed as follows:

Monroe County Commissioners
Monroe County Courthouse
Court House Square
Stroudsburg, PA 18360

Coolbaugh Township Planning Commission
242 Laurel Drive
Tobyhanna, PA 18466

Monroe County Planning Commission
Monroe County Courthouse
Court House Square
Stroudsburg, PA 18360

Coolbaugh Township Board of Supervisors
242 Laurel Drive
Tobyhanna, PA 18466

Velma A. Redmond, Esq.
800 West Hersheypark Drive
Hershey, PA 17033
(717) 533-5000
Counsel for
Pennsylvania-American Water Company

DOCKETED

FEB 6 1995

RECEIVED
95 FEB -3 AM 10:36
PA. P. U. C.
INFO. CONTROL DIV.

Dated: February 2, 1995

DOCUMENT
FOLDER

PENNSYLVANIA PUBLIC UTILITY COMMISSION

RECEIPT

The addressee named here has paid PA P.U.C. for the following bill

VELMA A REDMOND
800 WEST HERSHEY PARK DRIVE
HERSHEY PA 17033

DATE 01/31/95
RECEIPT # 190456

DOCUMENT
FOLDER

INDEXED
FEB 6 1995

RECEIVED
95 FEB -1 AM 9:06
PA-P.U.C.
INFO. CONTROL DIV.

In re Application of PA AMERICAN WATER COMPANY

~~A-212285, F.0024~~.....\$350.00

A-230073

REVENUE ACCOUNT: 001780-017601-102

CHECK NUMBER: 603066

CHECK AMOUNT: \$350.00

C. Joseph Meisinger
(for Dept. of Revenue)