

EWO: 1A7B2RK
 MUNICIPALITY: WASHINGTON TWP
 COUNTY: CAMBRIA
 Lat/Long: 40.436264, -78.618509
 Crossing #529248C, PT 0253.260

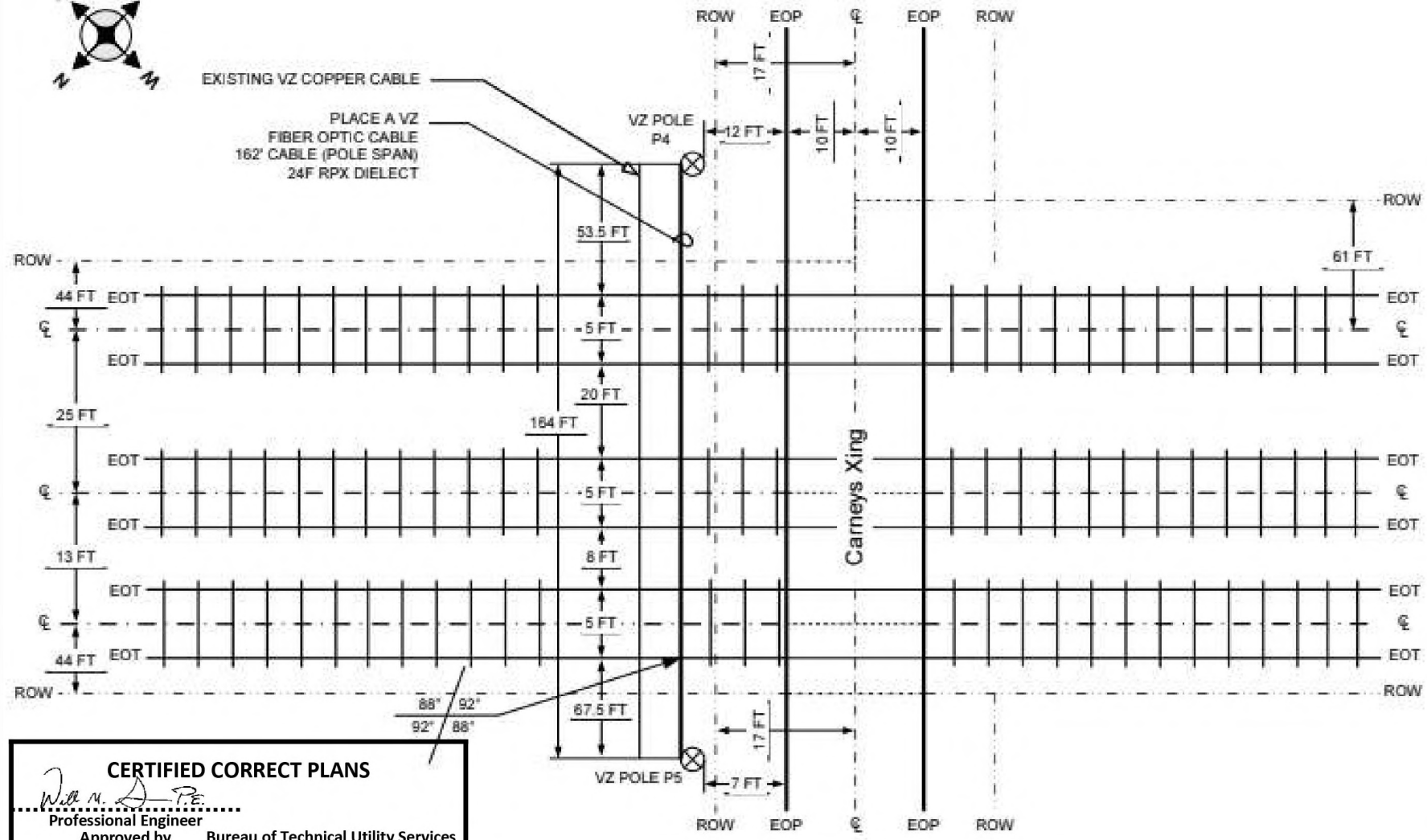

CERTIFIED CORRECT PLANS
Will M. D. PE
 Professional Engineer
 Approved by Bureau of Technical Utility Services

PA PUBLIC UTILITY COMMISSION
 ATTEST *Matthew L. Hunsch* 06/20/2025
 Secretary Docket: A-2025-3055378

EWO: 1A7B2RK
 MUNICIPALITY: WASHINGTON TWP
 COUNTY: CAMBRIA
 Lat/Long: 40.436264, -78.618509
 Crossing #529248C, PT 0253.260

