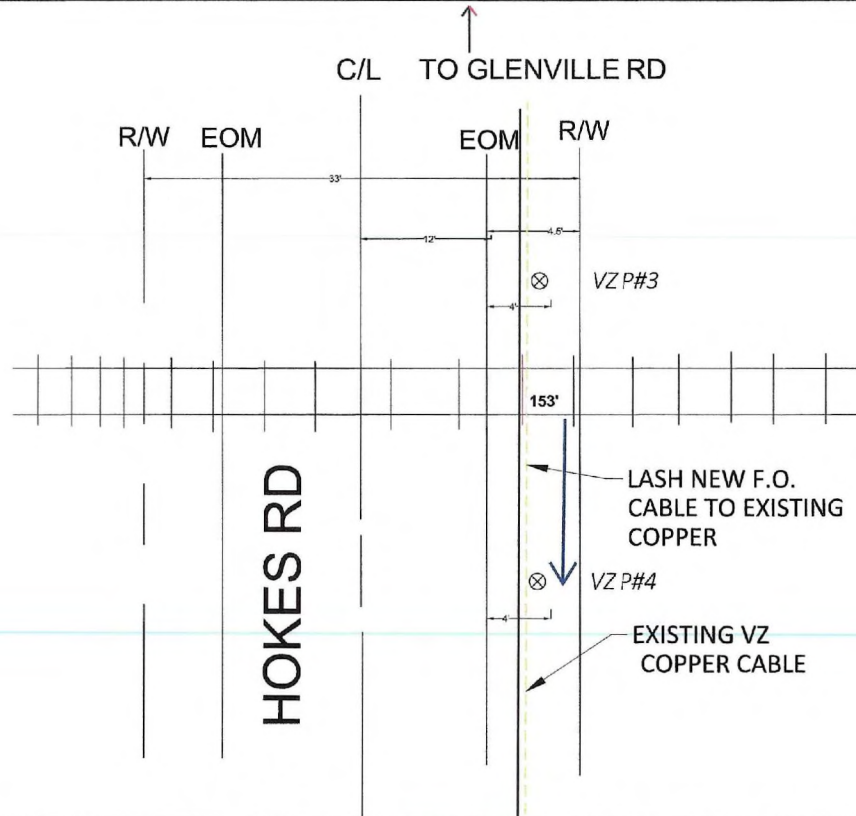

EXHIBIT A  
7-2-25



6/27/2025 C:\Users\jgromer\OneDrive - Ptk Enterprises, LLC\Desktop\3055342\001\A714101R PERMITS\A714101R PERMITS CROSSING S.L24.dwg

LEGEND: (PROPOSED ———), (EXISTING ———)		STRAND		VERIZON FTTP DETAIL ENGINEERING SURVEY		DRAWN & ENGINEERED BY:			
YYY BOX	[Symbol]	CORNING CLEAR TRACK SSB	[Symbol]	CONDUIT	<b>VERIZON AT GRADE X-ING N OF CSX #832065R/BAS 40.57 HOKES RD, S/O GLENVILLE RD, GLEN ROCK, MANHEIM TOWNSHIP, PA</b>		<b>PK&amp;E TELECOM</b> 740 Springdale Dr. Exton, PA 19341 www.pketelecom.org 1-508-337-7600		
COYOTE BOX	[Symbol]	COLLECTOR PLATE	[Symbol]	EMT				BUILDING CONTACT: WIRE CENTER:	WORK ORDER #: 1A7T4UQ
S-ONE BOX	[Symbol]	CORE DRILL	[Symbol]	FIBER CABLE/FDT TAIL STUB					
FIBER DISTRIBUTION HUB	[Symbol]	ELECTRIC OUTLET	[Symbol]	FUTUREPATH				GEO CODE:	MAP:
FIBER DISTRIBUTION TERMINAL	[Symbol]	FIBER DROP RISER	[Symbol]	IPP/SWID		GRID:			
HANDHOLE	[Symbol]	ONT	[Symbol]	MICRODUCT					
MANHOLE	[Symbol]	PENETRATION POINT	[Symbol]	PLASTIC MOLDING					
SLACK STORAGE BOX	[Symbol]	POLE	[Symbol]	CORNING CLEAR TRACK					

# ATGRADE CROSSING OF CSX PROPOSED PERPENDICULAR AERIAL CROSSING 6549 HOKES RD, GLEN ROCK, MANHEIM TOWNSHP, YORK CO., PA

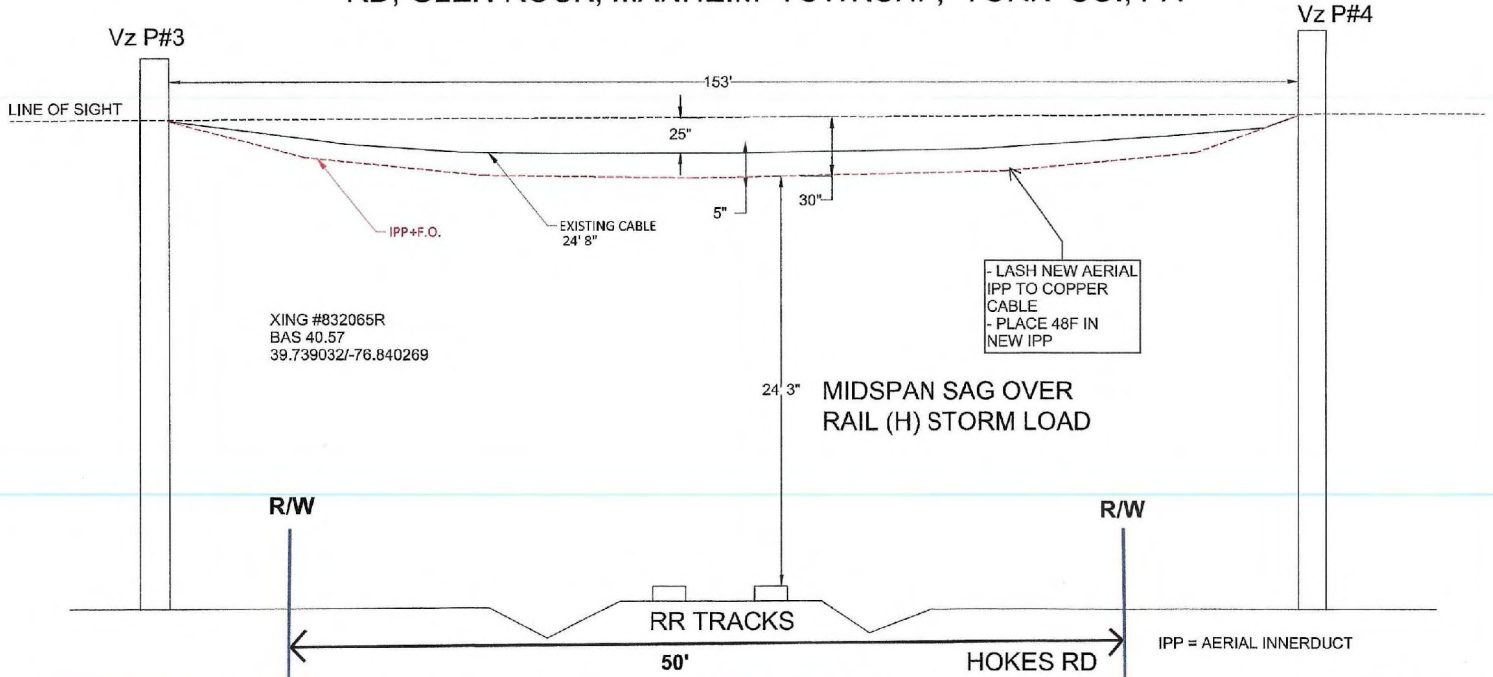

XING #832065R  
BAS 40.57  
39.739032/-76.840269

- LASH NEW AERIAL  
IPP TO COPPER  
CABLE  
- PLACE 48F IN  
NEW IPP

24' 3" MIDSPAN SAG OVER  
RAIL (H) STORM LOAD

R/W

R/W

RR TRACKS

HOKES RD

IPP = AERIAL INNERDUCT

LEGEND: (PROPOSED), (EXISTING)		CORNING CLEAR TRACK SSB		STRAND	
YYY BOX				CONDUIT	
COYOTE BOX				EMT	
S-ONE BOX				FIBER CABLE/FDT TAIL STUB	
FIBER DISTRIBUTION HUB				FUTUREPATH	
FIBER DISTRIBUTION TERMINAL				IPP/SWID	
HANDHOLE				MICRODUCT	
MANHOLE				PLASTIC MOLDING	
SLACK STORAGE BOX				CORNING CLEAR TRACK	

**VERIZON FTTP DETAIL ENGINEERING SURVEY**  
**HOKES RD S/O GLENVILLE RD**  
X-ING #832065R  
**ADDITION OF NEW VERIZON FIBER CABLE TO EXISTING CROSSING**

BUILDING CONTACT: \_\_\_\_\_  
WIRE CENTER: \_\_\_\_\_  
CONSTRUCTION TYPE: N/A  
COUNTY: YORK COUNTY

DRAWN & ENGINEERED BY:  
**PIKE TELECOM**  
740 Springdale Dr.  
Exton, PA 19341  
www.piketelcom.org  
1-508-337-7600

WORK ORDER #: \_\_\_\_\_  
**1A7T4UQ**

**SHEET: 1 OF 1**

C:\Users\james\OneDrive - Pike Enterprises, LLC\Desktop\1a7t4uq\1a7t4uq.dwg (1/23/2020 10:57:43 AM) P:\BNA\1337\FULL\BUNDLED\DETAIL CROSSING.dwg