



Pennsylvania
Department of Transportation

July 17, 2025

Matthew L. Homsher, Secretary
Pennsylvania Public Utility Commission
400 North Street
Harrisburg, PA 17120-0211

Application of the Department of Transportation of the Commonwealth of Pennsylvania for approval to replace the existing bridge where State Route 3005 (future State Route 3003), South 40th Street, crosses above the two (2) tracks of Norfolk Southern Railway Company, DOT Number 592 183 D in Swatara Township, Dauphin County, and the allocation of costs incident thereto.

Dear Secretary, Homsher:

Enclosed for filing, please find the Application of the Department of Transportation.

A copy of this Application and Exhibits has been served upon the parties in the Certificate of Service to the Application.

Sincerely,

A handwritten signature in black ink, appearing to read "Ahmed Lasloudji".

Ahmed Lasloudji
Grade Crossing Administrator
District 8-0
Department of Transportation

cc: Parties of Record
M. J. Chappell, P.E., Chief, Right-of-Way, Utilities and Grade Crossing Division
K. L. Cummings, Senior Counsel, Office of Chief Counsel
W. M. Sinick, P.E., Rail Safety Engineering Section, PUC

**BEFORE THE
PENNSYLVANIA PUBLIC UTILITY COMMISSION**

Application of the Department of Transportation of the Commonwealth of Pennsylvania for approval to replace the existing bridge where State Route 3005 (future State Route 3003), South 40th Street, crosses above the two (2) tracks of Norfolk Southern Railway Company, DOT Number 592 183 D in Swatara Township, Dauphin County, and the allocation of costs incident thereto.

Application
Docket No. _____

Electronically Filed

APPLICATION OF THE COMMONWEALTH OF PENNSYLVANIA, DEPARTMENT OF
TRANSPORTATION

Applicant, Commonwealth of Pennsylvania, Department of Transportation, files this Application pursuant to the provisions of 66 Pa.C.S § 2702 and 52 Pa. Code § 5.13 for the alteration of the public above grade crossing where State Route (SR) 3005 (future SR 3003), also known as South 40th Street, crosses above the two (2) tracks of Norfolk Southern Railway Company at DOT Number 592 183 D in Swatara Township, Dauphin County as described below:

1. The name and address of the applicant are Commonwealth of Pennsylvania, Department of Transportation, Richard A. Reisinger, P.E., Assistant District Executive – Design Engineering District 8-0, 2140 Herr Street, PA 17103-1699.

2. The name and address of the attorney for the Applicant are Karen L. Cummings, Senior Counsel, Commonwealth of Pennsylvania, Department of Transportation, Office of Chief Counsel, PO Box 8212, Harrisburg, PA 17105-8212.

3. The Applicant is an agency of the Commonwealth of Pennsylvania, organized and existing under the Administrative Code of 1929, 71 P.S. § 511, et seq. and generally 36 P.S. § 670 - 401 et seq.

4. The names and addresses of the persons, parties, and entities concerned in, or affected by the proposed construction, to the best of the Applicant's knowledge, are shown in the certificate of service. In addition to those served, the Applicant requests that the following also receive service of all documents in this matter:

Mark Chappell, P.E., Chief
Utilities, Right of Way, and Grade Crossing
Division
Pennsylvania Department of Transportation
P.O. Box 3362
Harrisburg, PA 17105-3362
marchappel@pa.gov

Karen L. Cummings, Senior Counsel
Office of Chief Counsel
Pennsylvania Department of Transportation
P.O. Box 8212
Harrisburg, PA 17105-8212
kcummings@pa.gov

5. The Applicant is seeking approval to replace the existing bridge carrying State Route 3005 (South 40th St.), Segment 0010, Offset 0617, over the tracks of Norfolk Southern Railway Company at railroad milepost (MP): HP-0108.86. At the completion of this project, State Route 3005 will be renumbered as State Route 3003 with the new Segment of 0090 and an Offset of 1533. The new railroad MP will be HP-0108.85. A Location Map is attached hereto and marked as Exhibit "A". A copy of the Preliminary Type, Size, and Location Plans are attached hereto and marked as Exhibit "B".

6. The Applicant is aware of prior Public Utility Commission orders for this crossing/these crossings at Docket Numbers: A-00118747, A-00117113, A-00108069, C-00005595, and M-860079.

7. The average daily traffic for State Route 3005 at this crossing is 2,762 vehicles, with 5% trucks.

8. The estimated total cost for the project described above is \$7,340,000.00. It is anticipated that the funding for the project will be 100% federal.

9. This project is necessary and proper for the safety and convenience of the public.

10. A conference of all parties of interest should be held to discuss the proposed alteration.

Wherefore, Applicant respectfully requests that the Public Utility Commission approve this application:

Respectfully Submitted:

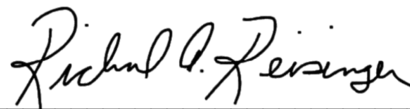

Richard A Reisinger, P.E.
Assitant District Executive
Engineering District 8-0
Department of Transportation
2140 Herr Street
Harrisburg, PA 17103
Phone (717) 787 - 8188
Fax (717) 705 2262
ricreising@pa.gov

Dated: July 17, 2025

**BEFORE THE
PENNSYLVANIA PUBLIC UTILITY COMMISSION**

Application of the Department of Transportation of the Commonwealth of Pennsylvania for approval to replace the existing bridge where State Route 3005 (future State Route 3003), South 40th Street, crosses above the two (2) tracks of Norfolk Southern Railway Company, DOT Number 592 183 D in Swatara Township, Dauphin County, and the allocation of costs incident thereto.

Application
Docket No. _____

Electronically Filed

Certificate of Service

I hereby certify that I have this day served a true copy of the foregoing document upon the participants listed below, in accordance with the requirements of 52 Pa. Code § 1.54, by electronic mail:

Mr. Douglas Starling, P.E
Senior Engineer, Public Improvement
Norfolk Southern Railroad Company
650 West Peachtree Street NW - Box 45
Atlanta, GA 30308
douglas.starling@nscorp.com

Ms. Julianne Freeman, Esquire
General Attorney
Norfolk Southern Railroad Company
Three Commercial Place
Norfolk, VA 23510-9241
Julianne.Freeman@nscorp.com

Mr. Justin Douglas, Chairman
Dauphin County Commissioners
Dauphin County Administrative Building
2 South Second Street, 4th Floor
Harrisburg, PA 17108
jdouglas@dauphincounty.org

Alison Wert, Secretary
Dauphin County Commissioners
Dauphin County Administrative Building
2 South Second Street, 4th Floor
Harrisburg, PA 17108
awert@dauphincounty.org

Mr. Jim Fosselman, Manager
Swatara Manager
599 Eisenhower Boulevard
Harrisburg, PA 17111
jfosselman@swatara.com

Mr. William Weaver
Lower Paxton Township Authority
425 Prince Street, Suite 139
Harrisburg, PA 17109
wweaver@lowerpaxton-pa.gov

Mr. Austin Calaman
Swatara Township Authority
595 Eisenhower Blvd
Harrisburg, PA 17111
director@swataratwpauthority-pa.gov

Mr. Saul Schmolitz
Paxtang Borough
3423 Derry Street
Paxtang, PA 17111-1813
paxdot@comcast.net

Ms. Faye Clark
Paxtang Borough
3423 Derry Street
Paxtang, PA 17111
paxtangboroffice@comcast.net

Mr. Robert Patterson
Brightspeed (The United Tel Co of PA)
1765 W. Trindle Street, BOX 1201
Carlisle, PA 17103-0905
robert.w.patterson@brightspeed.com

Mr. Dave Jones
Buckeye Pipe Line Company LP
5 TEK Park, 9999 Hamilton Blvd
Breinigsville, PA 18031
DAJones@buckeye.com

Mr. Shawn Watson
Verizon Pennsylvania LLC.
509 Cherry Drive
Hershey, PA 17033
shawn.k.watson@verizon.com

Mr. William McMillen
Comcast Cable Comm. Management, LLC.
4601 Smith Street
Harrisburg, PA 17109
William_McMillen@cable.comcast.com

Mr. Geoff Ferguson
UGI Utilities, Inc
1301 AIP Drive
Middletown, PA 17057
gferguson@ugi.com

Mr. David Hayward
Crown Castle Fiber, LLC
300 Barr Harbor Drive, Suite 300
Conshohocken, PA 19428
david.hayward@crowncastle.com

Mr. Jim Jacobson
Zayo Group LLC
800 Cabin Hill Drive
Greensburg PA 15601
james.jacobsen@zayo.com

Mr. Mike Varner
Swatara Township Authority
595 Eisenhower Blvd
Harrisburg, PA 17111
MVarner@swataratwpauthority-pa.gov

Mr. John Ruskay
Energy Transfer/Sunoco
525 Fritztown Road
Sinking Spring, PA 19606
john.ruskay@energytransfer.com

Mr. Jay Everly
AT&T Local Services
900 Old Marple Road
Springfield, PA 19064
jay@trecgroup.com

Phil Poliski
Pike Telecom
501 Holiday Drive
Pittsburgh, PA 15220
ppoliski@pike.com

Ms. Charlotte Krupa
PPL Electric Utilities
827 Hausman Road, LEHSC-2
Allentown, PA 17109
cakrupa@pplweb.com

Ms. Beatriz Dundas
Veolia Water PA Inc
6310 Allentown Blvd
Harrisburg, PA 17112
beatriz.dundas@veolia.com

Mr. Scott Dreiling
XO Communications Services, Inc.
630 Clark Avenue
King of Prussia 19406
Scott.j.dreiling@verizon.com

Dated this July Day of 16th of 2025



Ahmed Lasloudji
Grade Crossing Administrator
Engineering District 8-0
Department of Transportation
2140 Herr St.
Harrisburg PA 17103
(717) 787-4732
alasloudji@pa.gov

**BEFORE THE
PENNSYLVANIA PUBLIC UTILITY COMMISSION**

Application of the Department of Transportation of the Commonwealth of Pennsylvania for approval to replace the existing bridge where State Route 3005 (future State Route 3003), South 40th Street, crosses above the two (2) tracks of Norfolk Southern Railway Company, DOT Number 592 183 D in Swatara Township, Dauphin County, and the allocation of costs incident thereto.

Application
Docket No. _____

Electronically Filed

VERIFICATION

I, Ahmed Lasloudji, Grade Crossing Administrator, hereby state that the facts above set forth are true and correct to the best of my knowledge, information, and belief and that I expect to be able to prove the same at a hearing held in this matter. I understand that the statements herein are made subject to the penalties of 18 Pa.C.S. §4904 (relating to unsworn falsification to authorities).

Date: 7/16/2025



Ahmed Lasloudji
Grade Crossing Administrator
District 8-0

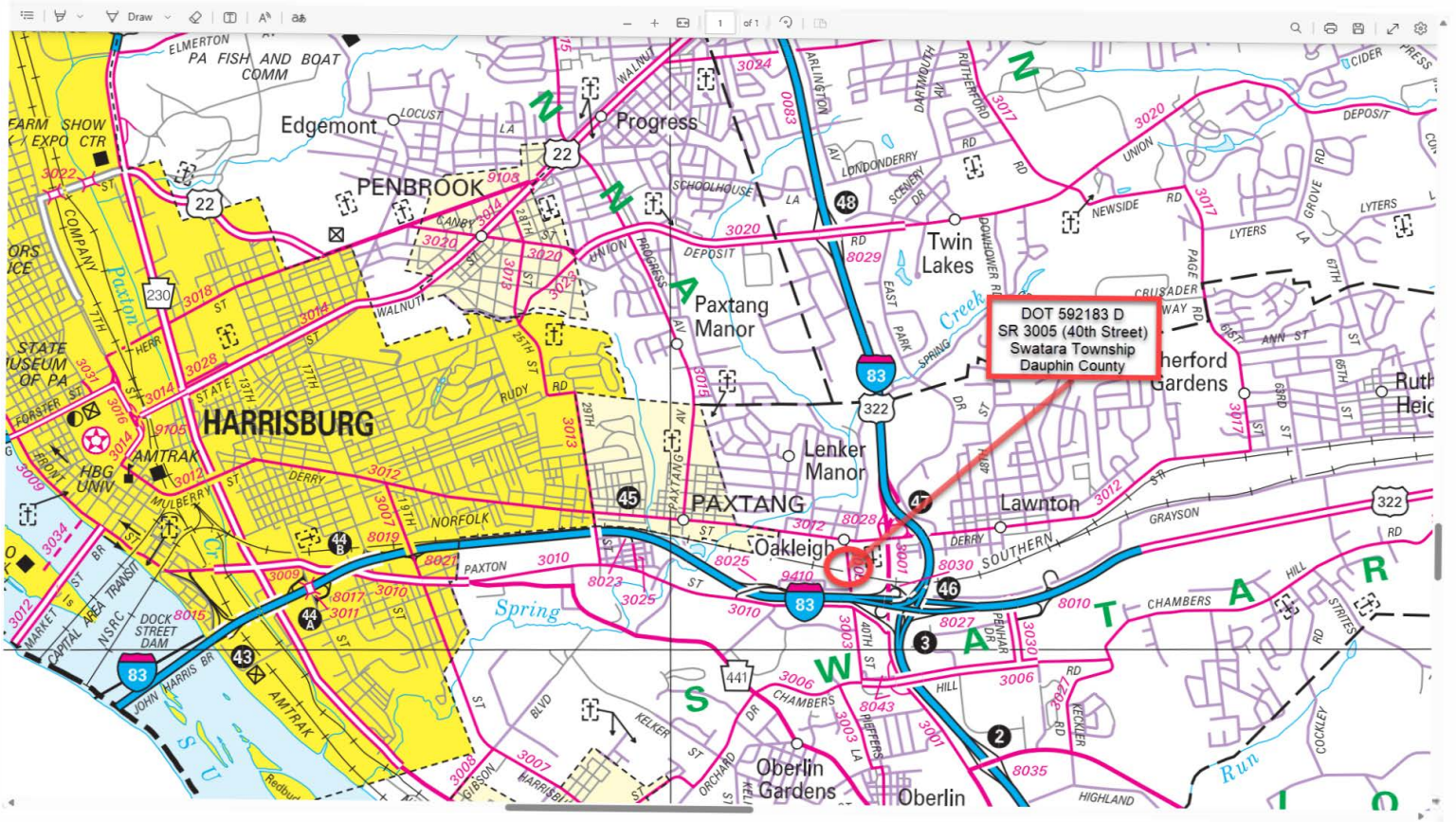
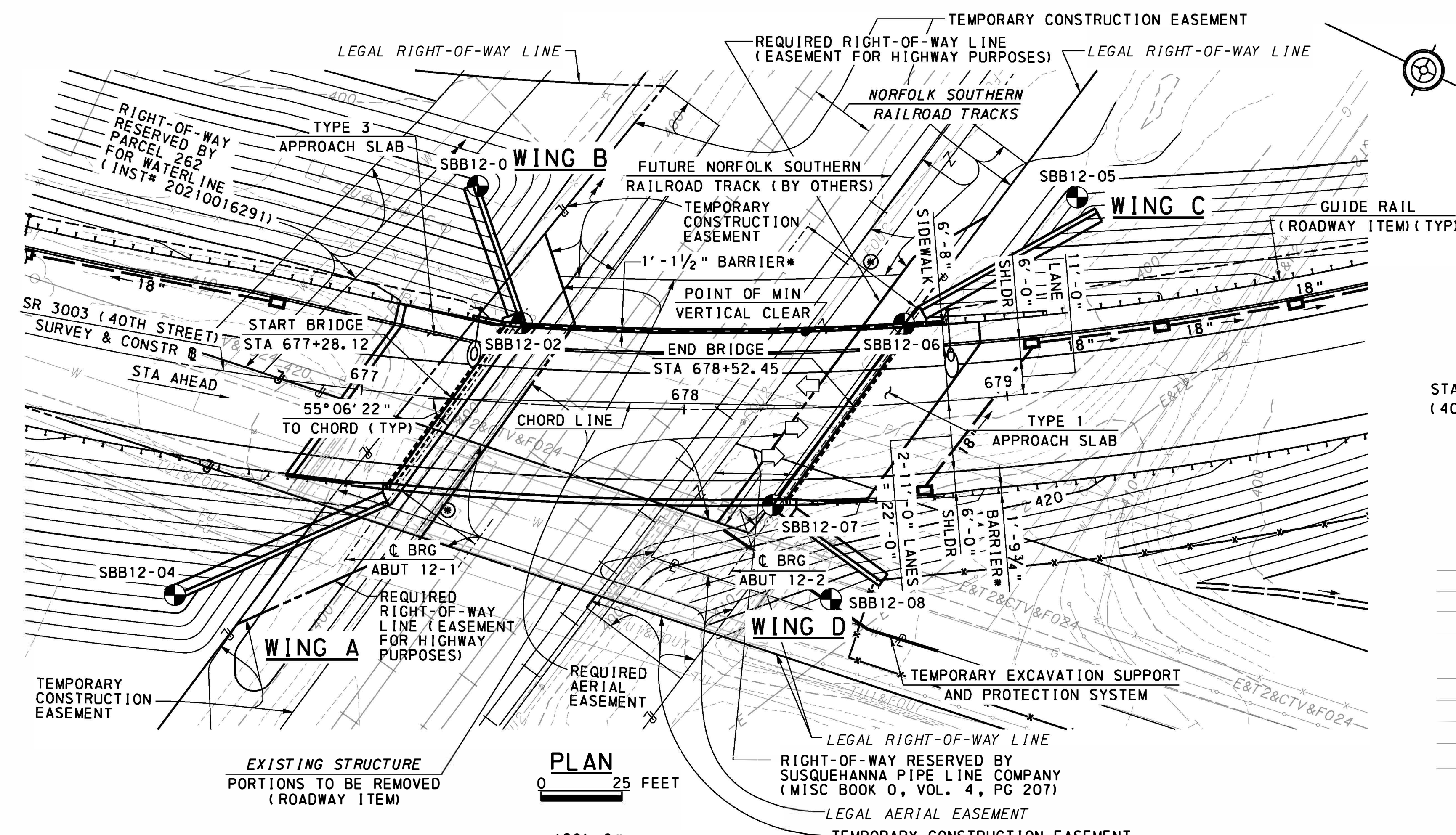
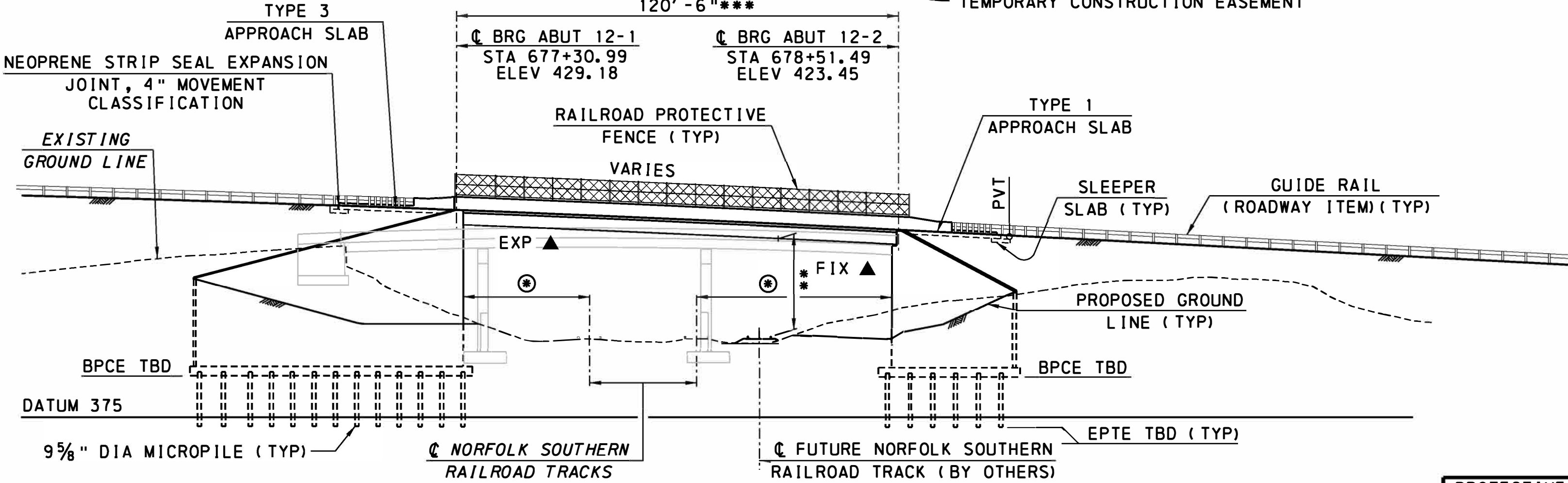

EXHIBIT "A"

FILE NAME: p:\mt-pw-bentley.com\mt-pw-01\Documents\Projects\5830_PA_PennDOTB-183\PE-SR0083-078\300_CADD\Plan_Single_Span\TS&L_Plan_Bridge_12.dgn
 PLOTED: 7/2/2025 11:11 AM



PLAN
0 25 FEET



ELEVATION
0 25 FEET

▲ ELASTOMERIC BEARINGS
 * INCLUDES 1 1/2" ARCHITECTURAL TREATMENT
 ** VERTICAL CLEARANCE: 23'-7 1/4" PROVIDED
 23'-7 1/4" REQUIRED
 VERTICAL CLEARANCE IS TO FUTURE TRACK LOCATED NORTH OF EXISTING TRACKS.
 ELEVATIONS OF FUTURE TRACK ASSUMED TO BE AT SAME ELEVATION OF ADJACENT EXISTING TRACK.
 *** MEASURED ALONG BASELINE BETWEEN C ABUT BRGS
 ⊙ HORIZONTAL CLEARANCE: 28'-0 1/2" AT ABUT 12-1 PROVIDED
 42'-0 1/2" AT ABUT 12-2 PROVIDED
 28'-0" AT ABUT 12-1 REQUIRED
 42'-0" AT ABUT 12-2 REQUIRED
 NOTE: 42'-0" INCLUDES WIDTH FOR FUTURE TRACK.
 NOTE:
 GRADING IN FRONT OF ABUTMENTS WILL BE DETERMINED IN FINAL DESIGN. BOTTOM OF FOOTING ELEVATION IS BASED ON PROVIDING A DITCH ALONG THE FUTURE TRACK AND EXISTING SOUTHERN TRACK PER NORFOLK SOUTHERN PUBLIC PROJECTS MANUAL, APPENDIX J.

PREPARED BY:
 McCORMICK TAYLOR
 5 CAPITAL DRIVE, SUITE 400
 HARRISBURG, PA 17110
 PREPARED FOR:
 THE PENNSYLVANIA
 DEPARTMENT OF TRANSPORTATION

PROFESSIONAL ENGINEER _____ DATE _____

BORING NO.	STATION	OFFSET
SBB12-01	677+30.66	66.20 LT
SBB12-02	677+48.16	24.87 LT
SBB12-04	676+53.05	70.84 RT
SBB12-05	679+29.08	58.74 LT
SBB12-06	678+69.58	24.75 LT
SBB12-07	678+26.88	29.77 RT
SBB12-08	678+43.30	58.77 RT

STATION/OFFSET INFORMATION MEASURED FROM SR 3003 (40TH STREET) SURVEY & CONSTR B

LEGEND

- 420 — PROPOSED CONTOURS, 2' INTERVALS
- - - 420 - - - EXISTING CONTOURS, 2' INTERVALS
- E&T2&CTV&FO24- EXISTING ELECTRIC & TELEPHONE & CABLE TV & FIBER OPTIC OVERHEAD LINE
- FOU2 EXISTING TELECOMMUNICATIONS DUCTBANK (UNDERGROUND)
- TU EXISTING TELEPHONE LINE (UNDERGROUND)
- TU1&FOU7 EXISTING TELEPHONE LINE & TELECOMMUNICATIONS DUCT BANK (UNDERGROUND)
- W EXISTING WATER LINE
- E EXISTING ELECTRIC LINE
- E&T2 EXISTING ELECTRIC & TELEPHONE LINE
- EU EXISTING ELECTRIC LINE UNDERGROUND
- G EXISTING GAS LINE
- P1 EXISTING PETROLEUM UNDERGROUND
- EXISTING JUNCTION BOX
- ⊙ EXISTING UTILITY POLE
- ▣ INLET (ROADWAY ITEM)
- — — PROPERTY LINE
- TRAFFIC DIRECTION
- ⊙ AS DRILLED BORING

NOTE: STATUS OF ALL UTILITIES TO BE DETERMINED IN FINAL DESIGN.

GENERAL NOTES:

- DESIGN SPECIFICATIONS**
- AASHTO LRFD BRIDGE DESIGN SPECIFICATIONS, 8TH EDITION, 2017, AND AS SUPPLEMENTED BY DESIGN MANUAL, PART 4, DECEMBER 2019. (INCLUDING LATEST REVISIONS)
 - DESIGN IS IN ACCORDANCE WITH THE LRFD METHOD.
- DESIGN LIVE LOADS**
- PHL-93, P-82, AND P2016-13.
- DEAD LOADS**
- INCLUDES A SURFACE AREA DENSITY OF 0.030 KSF FOR FUTURE WEARING SURFACE.
- GENERAL**
- PROVIDE MATERIALS AND PERFORM WORK IN ACCORDANCE WITH SPECIFICATIONS, PUBLICATION 408/2020, AND CONTRACT SPECIAL PROVISIONS.

NOTE:

- FOR TYPICAL SECTIONS, VERTICAL AND HORIZONTAL CURVE DATA, SEE SHEET 3.
- FOR FUTURE TS&L PLAN, SEE SHEET 2.
- FOR FRAMING PLAN, SEE SHEET 4.

BR-12

Mark	Description	By	Chk'd.	Recm'd.	Date
REVISIONS					

S.R. 0083 PREVIOUSLY KNOWN AS L.R. 0768
 BMS STR ID: 22-3003-0090-1533 MPMS/ECMS PROJ: 92931 BRKEY: 67964

COMMONWEALTH OF PENNSYLVANIA
 DEPARTMENT OF TRANSPORTATION

DAUPHIN COUNTY
 S. R. 0083 SECTION 078
 SEGMENT 0090 OFFSET 1533
 S. R. 3003 (40TH STREET) STA. 677+90.99
 OVER NORFOLK SOUTHERN RAILROAD
 SINGLE SPAN COMP STEEL PLATE GIRDER BRIDGE
TS&L PLAN & ELEVATION

RECOMMENDED _____	SHEET 1 OF 4
DISTRICT BRIDGE ENGINEER _____	+ SUPPLEMENTAL DRWS S-39931

DESCRIPTION	DWG. NO.	RECM'D DATE
PROTECTIVE FENCE	BC-701M	11-23-22
PERMANENT METAL DECK FORMS	BC-732M	11-23-22
ANCHOR SYSTEMS	BC-734M	2-19-21
WALL CONSTRUCTION & EXP. JOINT DETAILS	BC-735M	9-30-16
REINFORCEMENT BAR FABRICATION DETAILS	BC-736M	11-23-22
BRIDGE DRAINAGE	BC-751M	1-31-19
CONCRETE DECK SLAB DETAILS	BC-752M	11-23-22
STEEL GIRDER DETAILS	BC-753M	1-31-19
BEARINGS	BC-755M	1-31-19
STEEL PILE TIP REINFORCEMENT & SPLICES	BC-757M	9-30-16
PREFORMED NEOPRENE COMPRESSION SEAL JOINT FOR APPROACH SLABS	BC-766M	11-23-22
NEOPRENE STRIP SEAL DAM FOR P/S CONCRETE & STEEL I-BEAM BRIDGES	BC-767M	11-23-22
TYPICAL WATERPROOFING AND EXPANSION DETAILS	BC-788M	11-23-22
CLASSIFICATION OF EARTHWORK FOR STRUCTURES	RC-11M	6-01-10
BACKFILL AT STRUCTURES	RC-12M	11-1-22
GUIDE RAIL TO BRIDGE BARRIER TRANSITIONS	RC-50M	2-27-23
TYPE 31 STRONG POST GUIDE RAIL	RC-51M	9-1-23

SUPPLEMENTAL DRAWINGS

DES: DTR CKD: BSB DWN: TAD CKD: BSB

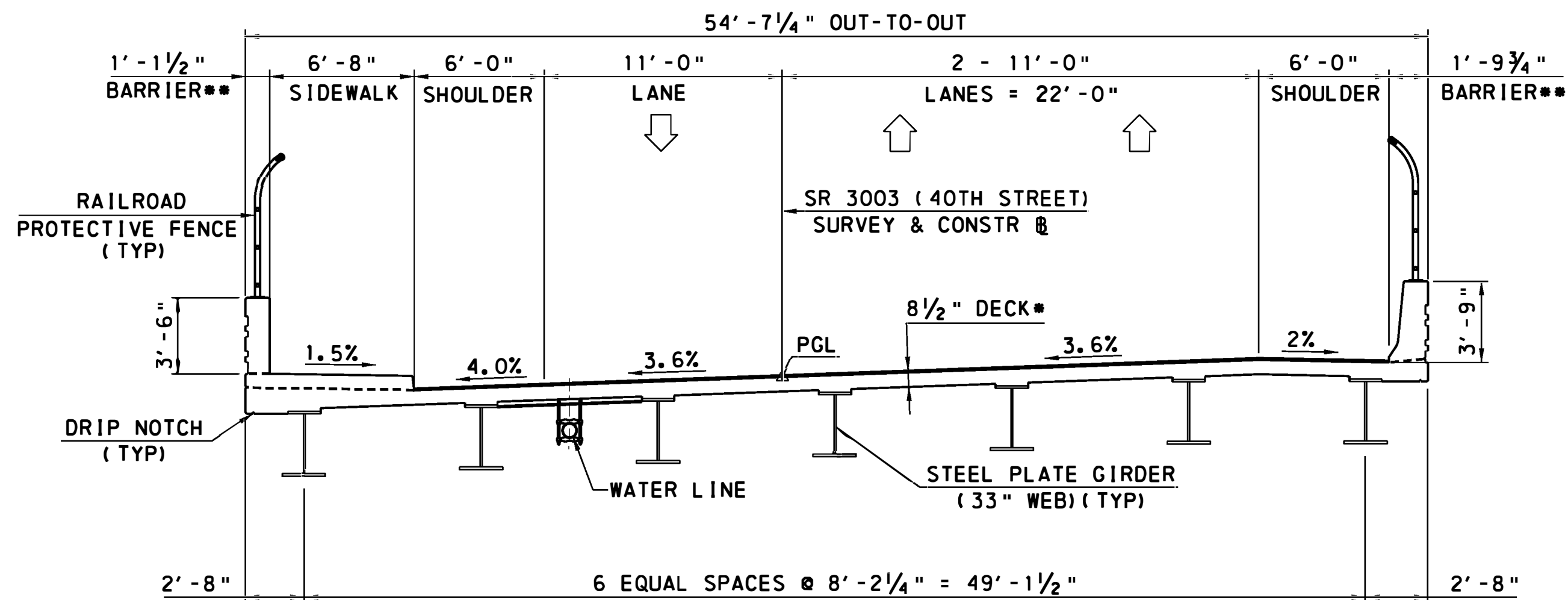

CROSS SLOPES (%)				
SR 3003 (40TH ST) STATION	LEFT SHLDR	LEFT LANE	RIGHT LANE	RIGHT SHLDR
676+46.00	-6.00	-3.60	3.60	-2.00
676+96.00	-4.00	-3.62	3.60	-2.00
679+66.00	-4.00	-3.60	3.60	-2.00
680+16.00	-6.00	-3.60	3.60	-2.00

NOTE: UTILITIES TO BE DETERMINED IN FINAL DESIGN.

TYPICAL SECTION
2 0 2 4 6 FEET

- * INCLUDES 7 1/2" DECK WITH 1" PPC OVERLAY
- ** INCLUDES 1 1/2" OF ARCHITECTURAL TREATMENT

**SR 3003 (40TH STREET)
HORIZONTAL CURVE DATA**

PI STA = 677+98.82
 $\Delta = 32^\circ 13' 37.42''$ LT
 T = 280.80'
 L = 546.72'
 R = 972.00'
 E = 39.75'
 PC STA = 675+18.01
 PT STA = 680+64.73

**SR 3003 (40TH STREET)
VERTICAL CURVE DATA**

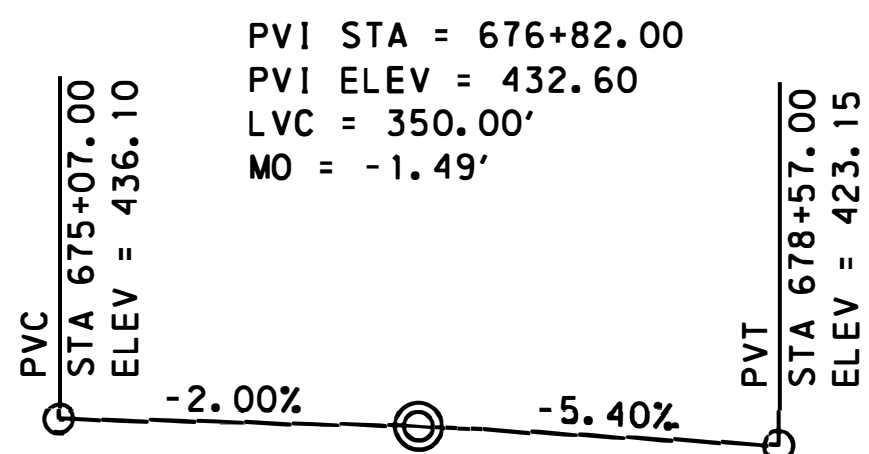

RAILROAD NOTES:

1. ALL WORK TO BE PERFORMED ON, OVER, UNDER, OR ADJACENT TO THE RAILROAD RIGHT-OF-WAY SHALL COMPLY WITH THE NORFOLK SOUTHERN RAILWAY COMPANY (RAILROAD), "NSR" OR "NS" PUBLIC PROJECTS MANUAL (APPENDIX E, SPECIAL PROVISIONS FOR THE PROTECTION OF RAILWAY INTERESTS, AND APPENDIX H1, OVERHEAD GRADE SEPARATION DESIGN CRITERIA). WHEN IN CONFLICT WITH OTHER PROJECT SPECIFICATIONS, THE MOST STRINGENT ONE SHALL APPLY.
2. "ONE CALL" SERVICES DO NOT LOCATE BURIED RAILROAD SIGNAL AND COMMUNICATIONS LINES. THE CONTRACTOR SHALL CONTACT THE RAILROAD'S REPRESENTATIVE 2 DAYS IN ADVANCE OF WORK AT THOSE PLACES WHERE EXCAVATION, PILE DRIVING, OR HEAVY LOADS MAY DAMAGE THE RAILROAD'S UNDERGROUND FACILITIES. UPON REQUEST FROM THE CONTRACTOR OR SPONSOR, RAILROAD FORCES WILL LOCATE AND PAINT MARK OR FLAG THE RAILROAD'S UNDERGROUND FACILITIES. THE CONTRACTOR SHALL AVOID EXCAVATION OR DISTURBANCE OF THESE FACILITIES. IF DISTURBANCE OR EXCAVATION IS REQUIRED NEAR A BURIED RAILROAD FACILITY, THE CONTRACTOR SHALL COORDINATE WITH THE RAILROAD TO HAVE FACILITY POTHOLED MANUALLY WITH CAREFUL HAND EXCAVATION. THE FACILITY SHALL BE PROTECTED BY THE CONTRACTOR DURING THE COURSE OF THE DISTURBANCE UNDER THE SUPERVISION AND DIRECTION OF THE RAILROAD'S REPRESENTATIVE. (SEE NS PUBLIC PROJECTS MANUAL, APPENDIX E, SECTION 3.D).
3. ALL UTILITY INSTALLATIONS OR RELOCATIONS THAT ARE REQUIRED IN CONJUNCTION WITH THIS PROJECT CAN BE INSTALLED OR RELOCATED AS PART OF THE PROJECT PROVIDED THE CONSTRUCTION IS PERFORMED BY THE PROJECT CONTRACTOR OR PROJECT CONTRACTOR'S SUB-CONTRACTOR. HOWEVER, THE UTILITY MUST SUBMIT AN APPLICATION FOR THE INSTALLATIONS OR RELOCATION TO AECOM FOR APPROPRIATE HANDLING FOR LICENSE AGREEMENT AND APPLICABLE FEES. FOR UTILITY APPLICATIONS FORWARD TO: WWW.NSCORP > REAL ESTATE > NS SERVICES > WIRE, PIPELINE, & FIBER OPTIC PROJECTS > AECOM. NOTE: LICENSE AGREEMENT MUST BE EXECUTED PRIOR TO UTILITY BEING INSTALLED OR RELOCATED.
4. THE CONTRACTOR SHALL NOT COMMENCE ANY WORK ON RAILROAD RIGHTS-OF-WAY UNTIL THEY HAVE COMPLIED WITH THE CONDITIONS PRESENTED ON NS PUBLIC PROJECTS MANUAL (SEE APPENDIX E, NORFOLK SOUTHERN SPECIAL PROVISIONS FOR PROTECTION OF RAILWAY INTERESTS)
5. THE CONTRACTOR SHALL SO ARRANGE AND CONDUCT WORK THAT WILL BE NO INTERFERENCE WITH THE RAILROAD'S OPERATIONS. WHENEVER WORK IS LIABLE TO AFFECT THE OPERATIONS OR SAFETY OF TRAINS, THE METHODS OF DOING SUCH WORK SHALL FIRST BE SUBMITTED TO THE RAILROAD ENGINEER FOR APPROVAL, BUT SUCH APPROVAL SHALL NOT RELIEVE THE CONTRACTOR FROM LIABILITY.
6. THE RAILROAD WILL BE PROVIDED AS-BUILT DRAWINGS SHOWING THE ACTUAL CLEARANCES AS CONSTRUCTED. DEPTH, SIZE, AND LOCATION OF ALL FOUNDATION COMPONENTS SHALL BE SHOWN ON THE DRAWINGS. (SEE NS PUBLIC PROJECTS MANUAL, APPENDIX H1, SECTION 8A).
7. FOR PROJECTS REQUIRING MORE THAN 30 CONSECUTIVE DAYS OF FLAGGING, CONTRACTOR SHALL PROVIDE THE FLAGMAN A SMALL WORK AREA WITH A DESK/COUNTER AND CHAIR WITHIN THE FIELD/SITE TRAILER, INCLUDING THE USE OF BATHROOM FACILITIES, WHERE THE FLAGMAN CAN CHECK IN/OUT WITH THE PROJECT, AS WELL AS TO THE FLAGMAN'S HOME TERMINAL. THE WORK AREA SHOULD PROVIDE ACCESS TO TWO (2) ELECTRICAL OUTLETS FOR RECHARGING RADIO(S), AND A LAPTOP COMPUTER; AND HAVE THE ABILITY TO PRINT OFF NEEDED DOCUMENTATION AND ORDERS AS NEEDED AT THE FIELD/SITE TRAILER. THIS SHOULD AID IN MAXIMIZING THE FLAGMAN'S TIME AND EFFICIENCY ON THE PROJECT.
8. THE PROPOSED PROJECT WILL NOT CHANGE THE QUANTITY AND/OR CHARACTER OF FLOW IN THE RAILWAY'S DITCHES AND/OR DRAINAGE STRUCTURES.
9. CONTACT INFORMATION FOR THE RAILROAD IS AS FOLLOWS:
 MR. D. SHAWN STARLING
 ENGINEER PUBLIC IMPROVEMENTS
 BRIDGES AND STRUCTURES
 NORFOLK SOUTHERN CORPORATION
 1200 PEACHTREE STREET NE
 ATLANTA, GA 30309
 TELEPHONE: (404) 527-2536
 EMAIL: DOUGLAS.STARLING@NSCORP.COM

BR-12

Mark	Description	By	Chk'd.	Recm'd.	Date
REVISIONS					

COMMONWEALTH OF PENNSYLVANIA
DEPARTMENT OF TRANSPORTATION

DAUPHIN COUNTY
 S. R. 0083 SECTION 078
 SEGMENT 0090 OFFSET 1533
 S. R. 3003 (40TH STREET) STA. 677+90.99
 OVER NORFOLK SOUTHERN RAILROAD
 SINGLE SPAN COMP STEEL PLATE GIRDER BRIDGE

TYPICAL SECTION

RECOMMENDED _____ SHEET 3 OF 4

S-39931

Exhibit "B"

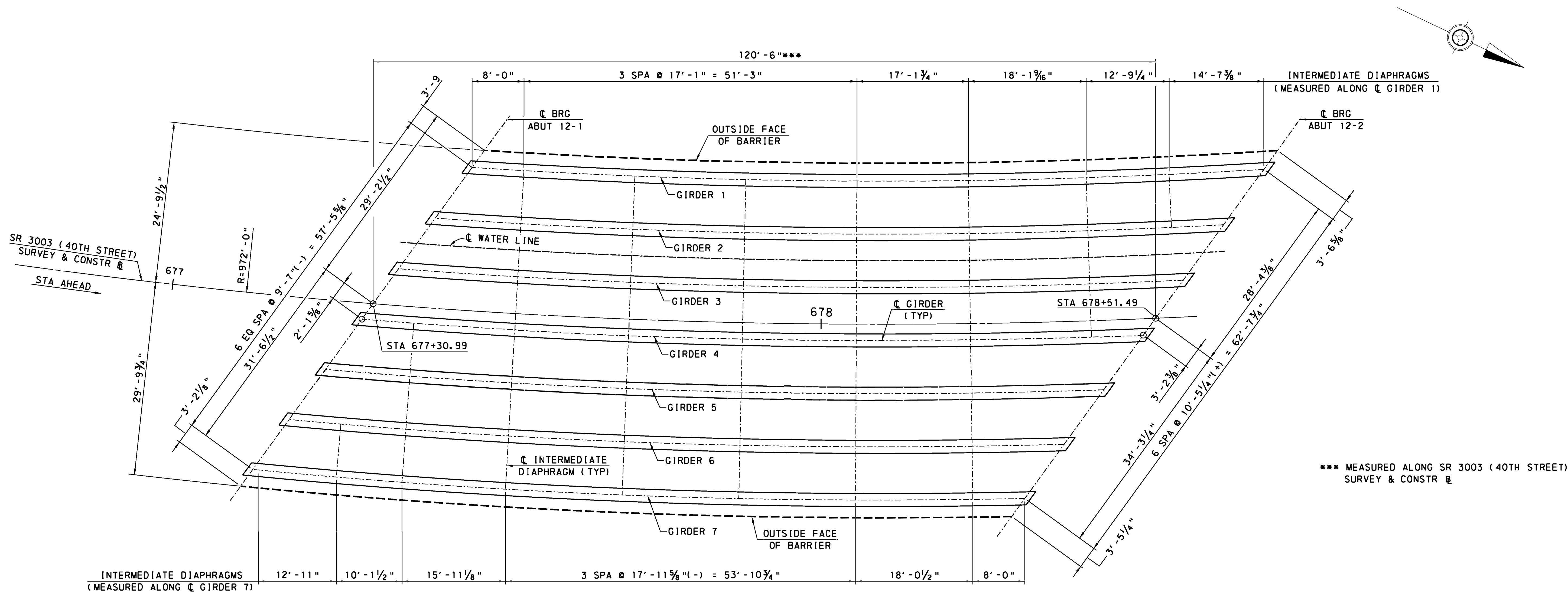

FRAMING PLAN
2 0 2 4 6 8 10 FEET

BR-12

Mark	Description	By	Chk'd.	Recm'd.	Date
REVISIONS					

COMMONWEALTH OF PENNSYLVANIA
DEPARTMENT OF TRANSPORTATION

DAUPHIN COUNTY
S. R. 0083 SECTION 078
SEGMENT 0090 OFFSET 1533
S. R. 3003 (40TH STREET) STA. 677+90.99
OVER NORFOLK SOUTHERN RAILROAD
SINGLE SPAN COMP STEEL PLATE GIRDER BRIDGE

FRAMING PLAN

RECOMMENDED _____	SHEET <u>4</u> OF <u>4</u>
	S-39931

Exhibit "B"