



121 Champion Way, Ste. 100
Canonsburg, PA 15317
(724) 416-6321
efarah@nisource.com

Emily Farah
Assistant General Counsel
Legal Department

December 16, 2025

VIA ELECTRONIC FILING

Matthew L. Homsher, Secretary
Pennsylvania Public Utility Commission
Commonwealth Keystone Building
400 North Street, 2nd Floor North
P.O. Box 3265
Harrisburg, PA 17105-3265

RE: Application of Columbia Gas of Pennsylvania, Inc. for approval of the alteration of the crossing (145324E) where South Pennsylvania Avenue meets, at grade, Tracks of Southwest Pennsylvania Railroad (Omega Railroad/Carload Express) and alteration of the facilities where South Pennsylvania Avenue parallels, at grade, the tracks of Southwest Pennsylvania Railroad, by the installation of natural gas distribution facilities
Docket No. A-2025-_____

Dear Secretary Homsher:

Pursuant 66 Pa.C.S. § 2702(a), **Columbia Gas of Pennsylvania, Inc. (“Columbia”)** submits herewith an application for the approval of a proposed railroad crossing and alteration in the City of Uniontown, Fayette County.

Thank you for your attention to this matter. Please let me know if you have any questions.

Sincerely,

A handwritten signature in blue ink, appearing to read "Emily Farah".

Emily Farah

/kak
Electronic Enclosure

**BEFORE THE
PENNSYLVANIA PUBLIC UTILITY COMMISSION**

Application of Columbia Gas of Pennsylvania, Inc. for approval of the alteration of the crossing (145324E) where South Pennsylvania Avenue meets, at grade, Tracks of Southwest Pennsylvania Railroad (Omega Railroad/Carload Express) and alteration of the facilities where South Pennsylvania Avenue parallels, at grade, the tracks of Southwest Pennsylvania Railroad, by the installation of natural gas distribution facilities.

Docket No. A-2025-_____

To the Pennsylvania Public Utility Commission:

Pursuant to 66 Pa. C.S. § 2702(a), Columbia Gas of Pennsylvania, Inc. (“Columbia” or the Company”) hereby requests that the Pennsylvania Public Utility Commission (“Commission”) issue an Order authorizing Columbia to alter the crossing (DOT Crossing 145324E) where South Pennsylvania Avenue crosses, at grade, the tracks of Southwest Pennsylvania Railroad (Omega Railroad/Carload Express), located in the City of Uniontown, Fayette County by installing natural gas distribution facilities consisting of 6-inch medium pressure plastic and 10-inch steel casing. In support of its request, Columbia states as follows:

1. The name and address of applicant are Columbia Gas of Pennsylvania, Inc., 121 Champion Way, Suite 100, Canonsburg, Pennsylvania 15317.
2. The name and address of applicant’s attorney are Emily Farah, Esq., 121 Champion Way, Suite 100, Canonsburg, Pennsylvania 15317.
3. Columbia is engaged in the business of selling and distributing natural gas to retail customers within the Commonwealth, and is therefore a “public utility” within the meaning of Section 102 of the Public Utility Code, 66 Pa.C.S. § 102, subject to the regulatory jurisdiction of the Commission. Columbia provides natural gas service to more than 448,000 customers in 26 counties of Pennsylvania, pursuant to certificates of public convenience granted by the Commission.
4. Columbia’s alteration to the areas described above is necessary to continue providing safe, reliable gas service to the City of Uniontown. Please see the attached Exhibit A for the exact location of the project.
5. 6-inch medium pressure plastic and 10-inch steel casing is to be directionally drilled in public right of way on Pennsylvania Avenue.

6. A design one-call was placed. Columbia has identified the following parties who may be affected by the proposed alteration:
 - Omega Railroad/Carload Express
 - Pennsylvania Department of Transportation
 - West Penn Power
 - Verizon Pittsburgh, LLC
 - North Union Township
 - Pennsylvania American Water
 - Atlantic Broadband
 - Fayette County
 - Vitalink
 - OmniFiber
 - North Fayette County Municipal Authority
 - CenturyLink
7. The estimated cost of installing the facilities described in the Application is \$500,000. Columbia will be responsible for installing, maintaining, inspecting, and funding said facilities.
8. The alteration is necessary or proper for the following reasons: the expansion of Columbia's medium pressure system and subsequent abandonment of the existing low-pressure (LP) system throughout the City of Uniontown. Columbia's existing line crosses the tracks at the specified location, but this proposed replacement will assist in the replacement of the LP system with an upgraded medium-pressure system.
9. The abandonment and replacement of the existing gas line will not impact rates or service provided to Columbia's customers.
10. The installation of Columbia's facilities will have no impact on the physical integrity of Southwest Pennsylvania Railroad (Carload Express) tracks or supporting terrain and, as such, compliance with Southwest Pennsylvania Railroad (Carload Express) construction requirements will be unnecessary.
11. Columbia seeks to cross the facilities of Southwest Pennsylvania Railroad (Carload Express) at an established public highway-rail crossing and, therefore, requests that the Commission approve Columbia's application without any obligation that Columbia remunerate Southwest Pennsylvania Railroad (Carload Express) for the privilege of occupying the right of way.

12. Columbia seeks to parallel facilities of Southwest Pennsylvania Railroad (Carload Express) within an established public right of way, and, therefore, requests that the Commission approve Columbia's application without any obligation that Columbia remunerate Southwest Pennsylvania Railroad (Carload Express) for the privilege of occupying the right of way.

Wherefore, Columbia Gas of Pennsylvania, Inc. requests that the Commission approve its application.

Dated: December 16, 2025

COLUMBIA GAS OF PENNSYLVANIA, INC.

By:

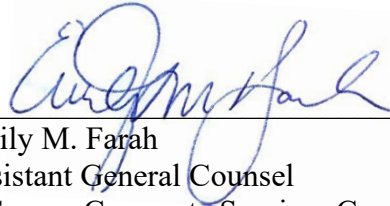

Emily M. Farah
Assistant General Counsel
NiSource Corporate Services Co.
121 Champion Way, Ste. 100
Canonsburg, PA 15317
efarah@nisource.com

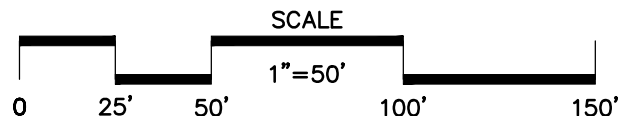
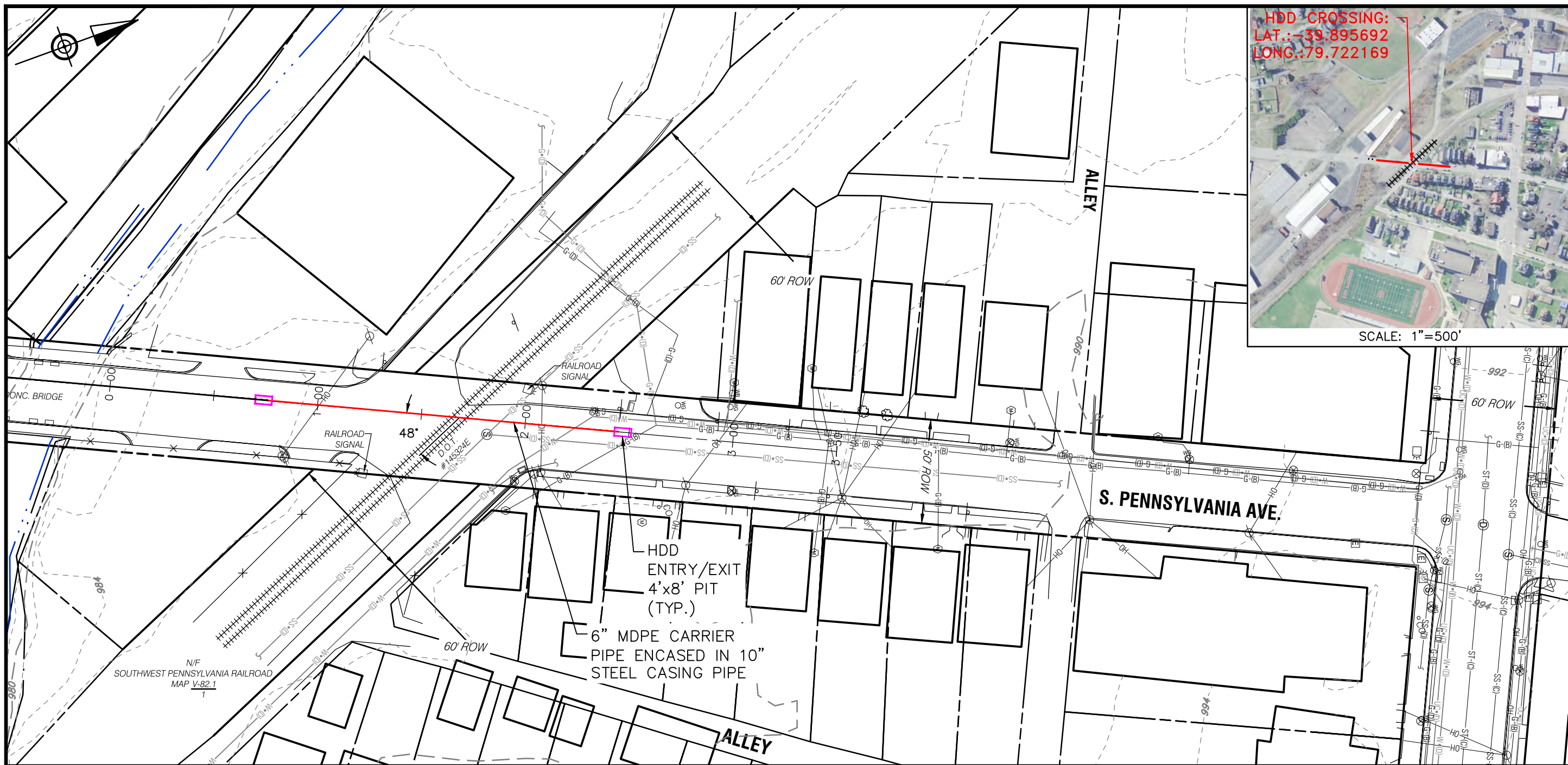

- NOTES:**
1. WITH THE EXCEPTION OF SOFT UTILITY EXCAVATION, ALL PHYSICAL WORK IS PLANNED TO BE CONDUCTED OUTSIDE OF RAILROAD RIGHT-OF-WAY. PERMIT APPLICATION IS FOR BORE ACTIVITIES UNDER EXISTING FACILITIES.
 2. PIPELINE AND CROSSING TO BE INSTALLED AND MAINTAINED IN ACCORDANCE WITH ALL REQUIREMENTS WITH SPECIFICATIONS REQUIRED BY THE AMERICAN RAILWAY ENGINEERING ASSOCIATION, NATIONAL ELECTRIC SAFETY CODE, AND REQUIREMENTS OF CARLOAD EXPRESS, INC. (SOUTHWEST PENNSYLVANIA RAILROAD).
 3. EXISTING UTILITIES SHOWN ON THESE PLANS WERE PREPARED USING ONE-CALL RESPONSES IN COMBINATION WITH FIELD OBSERVATION. ALL EXISTING UTILITY LOCATIONS AND DEPTH SHALL BE VERIFIED PRIOR TO COMMENCING WITH HDD AND WILL BE THE RESPONSIBILITY OF THE CONTRACTOR.
 3. THE HORIZONTAL DATUM IS PENNSYLVANIA STATE PLANE, NORTH AMERICAN DATUM 1983 (NAD 83), SOUTH ZONE.
 4. THE VERTICAL DATUM IS PENNSYLVANIA STATE PLANE, NORTH AMERICAN VERTICAL DATUM 1988 (NAVD 88).
 5. EMERGENCY SHUT-OFF VALVES SHALL BE INSTALLED ON THE GAS LINE BEING INSTALLED AND WITHIN PERMITTED DISTANCES ON EACH SIDE OF THE RAILROAD AND EASILY ACCESSIBLE IN THE EVENT OF AN EMERGENCY.
 6. BLASTING NOT PERMITTED

Columbia Gas
 12 SANDSTONE WAY
 DUNBAR, PA 15431
 A NiSource Company

REVISIONS		
REV. #	DATE	DESCRIPTION
1	12/08/2025	CARRIER PIPE MATERIAL CHANGE
0	11/06/2025	ISSUED FOR PERMITTING

RETTEW
 RETTEW Associates, Inc.
 3020 Columbia Avenue, Lancaster, PA 17603
 Phone (800) 738-8395
 Email: rettew@rettew.com
 Website: www.rettew.com

SOUTHWEST PENNSYLVANIA RAILROAD
 PERMIT PLAN
 PA AVE. GRANT ST. PH. 2
 CITY OF UNIONTOWN FAYETTE COUNTY

DRAWN BY: MEI
 DATE: 11/03/2025
 SCALE: AS NOTED
 DWG. NO. 0257002964

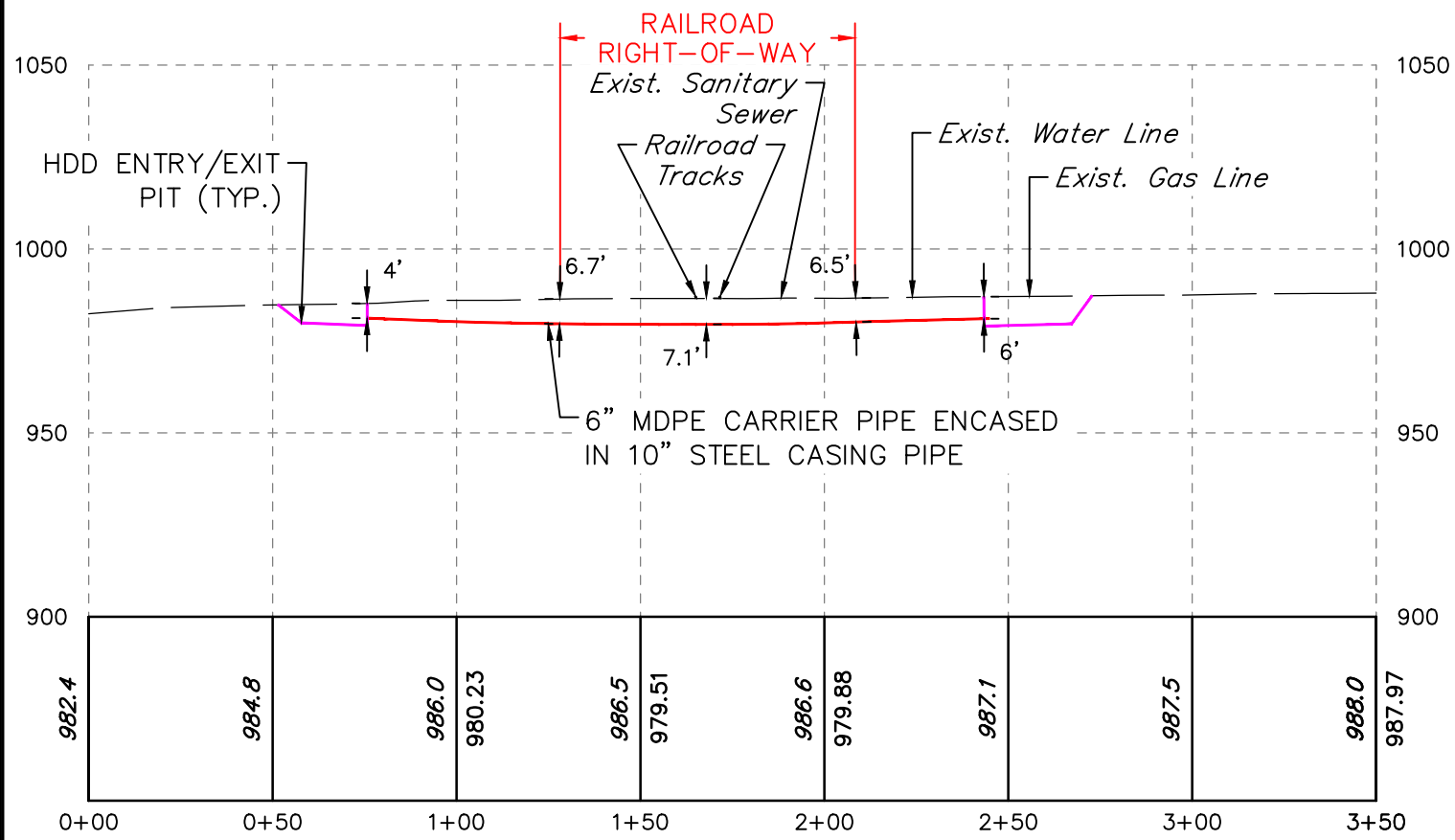

"CENTERLINE PROFILE OF RAILROAD X-ING EXHIBIT"

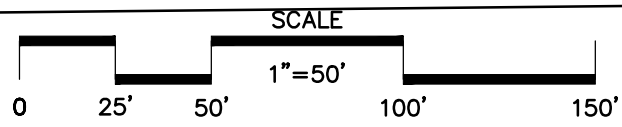

REVISIONS		
REV. #	DATE	DESCRIPTION
1	12/08/2025	CARRIER PIPE MATERIAL CHANGE
0	11/06/2025	ISSUED FOR PERMITTING

- NOTES:**
- WITH THE EXCEPTION OF SOFT UTILITY EXCAVATION, ALL PHYSICAL WORK IS PLANNED TO BE CONDUCTED OUTSIDE OF RAILROAD RIGHT-OF-WAY. PERMIT APPLICATION IS FOR BORE ACTIVITIES UNDER EXISTING FACILITIES.
 - PIPELINE AND CROSSING TO BE INSTALLED AND MAINTAINED IN ACCORDANCE WITH ALL REQUIREMENTS WITH SPECIFICATIONS REQUIRED BY THE AMERICAN RAILWAY ENGINEERING ASSOCIATION, NATIONAL ELECTRIC SAFETY CODE, AND REQUIREMENTS OF CARLOAD EXPRESS, INC. (SOUTHWEST PENNSYLVANIA RAILROAD).
 - EXISTING UTILITIES SHOWN ON THESE PLANS WERE PREPARED USING ONE-CALL RESPONSES IN COMBINATION WITH FIELD OBSERVATION. ALL EXISTING UTILITY LOCATIONS AND DEPTH SHALL BE VERIFIED PRIOR TO COMMENCING WITH HDD AND WILL BE THE RESPONSIBILITY OF THE CONTRACTOR.
 - THE HORIZONTAL DATUM IS PENNSYLVANIA STATE PLANE, NORTH AMERICAN DATUM 1983 (NAD 83), SOUTH ZONE.
 - THE VERTICAL DATUM IS PENNSYLVANIA STATE PLANE, NORTH AMERICAN VERTICAL DATUM 1988 (NAVD 88).
 - EMERGENCY SHUT-OFF VALVES SHALL BE INSTALLED ON THE GAS LINE BEING INSTALLED AND WITHIN PERMITTED DISTANCES ON EACH SIDE OF THE RAILROAD AND EASILY ACCESSIBLE IN THE EVENT OF AN EMERGENCY.
 - BLASTING NOT PERMITTED

PA ONE CALL UNDERGROUND UTILITY PROTECTION ACT

PURSUANT TO THE PROVISIONS OF ACT NO. 287 OF 1974, AS AMENDED BY ACT 187 OF 1996, ACT 181 OF 2006, ACT 160 OF 2016 AND ACT 50 OF 2017 OF THE PENNSYLVANIA STATE LEGISLATURE, RETTEW ASSOCIATES, INC. HAS PERFORMED THE FOLLOWING IN PREPARING THESE DRAWINGS REQUIRING EXCAVATION OR DEMOLITION WORK AT SITES WITHIN THE POLITICAL SUBDIVISION(S) SHOWN ON THE DRAWINGS:

- PURSUANT TO SECTION 4, CLAUSE (2) OF SAID ACT, RETTEW ASSOCIATES, INC. REQUESTED FROM EACH FACILITY OWNER DESIGNATED ON SUCH LIST PROVIDED BY THE ONE CALL SYSTEM NOTIFICATION, THE INFORMATION PRESCRIBED BY SECTION 2, CLAUSE (4) OF SAID ACT, NOT LESS THAN TEN (10) NOR MORE THAN NINETY (90) BUSINESS DAYS BEFORE FINAL DESIGN IS TO BE COMPLETED.
- PURSUANT TO SECTION 4, CLAUSE (5) OF SAID ACT, RETTEW ASSOCIATES, INC. HAS MET THEIR OBLIGATIONS OF CLAUSE (2) BY CALLING THE PENNSYLVANIA ONE CALL SYSTEM SERVING THE LOCATION WHERE THE WORK IS TO BE PERFORMED, AND SHOWING THE ASSOCIATED SERIAL NUMBER(S) ON THIS/THESE DRAWING(S).
- PURSUANT TO SECTION 4, CLAUSE (3) OF SAID ACT, RETTEW ASSOCIATES, INC. HAS SHOWN UPON THIS/THESE DRAWING(S) THE POSITION AND TYPE OF EACH FACILITY, AS DERIVED PURSUANT TO THE REQUEST MADE AS REQUIRED BY CLAUSE (2),
- PURSUANT TO SECTION 4, CLAUSE (5) OF SAID ACT, RETTEW ASSOCIATES, INC. HAS SHOWN UPON THIS/THESE DRAWING(S) THE TOLL-FREE NUMBER FOR THE ONE CALL SYSTEM AND THE SERIAL NUMBER(S) FOR THE ASSOCIATED ONE CALL SYSTEM NOTIFICATION(S),

ADDITIONALLY, RETTEW ASSOCIATES, INC. DOES NOT MAKE ANY REPRESENTATION, WARRANTY, ASSURANCE OR GUARANTEE THAT THE INFORMATION RECEIVED PURSUANT TO SAID REQUEST, AND AS REFLECTED ON THIS/THESE DRAWING(S), IS CORRECT OR ACCURATE. INFORMATION REFLECTED ON THIS/THESE DRAWING(S) IS SHOWN AS REQUIRED BY SAID ACT NO. 160 OF 2016, AND AS PROVIDED BY THE FACILITY OWNER PURSUANT TO SECTION 2, CLAUSE (4) OF SAID ACT.

DATE: 09/25/2025
 ONE CALL SYSTEM SERIAL NUMBER: 20251291705

IT IS THE CLIENT'S RESPONSIBILITY TO NOTIFY RETTEW NO LESS THAN 10 DAYS AND NO MORE THAN 90 DAYS PRIOR TO THE CONSTRUCTION BEGIN DATE. THIS NOTIFICATION WILL ALLOW US TO UPDATE THE PA811 ONE CALL TICKETS ASSOCIATED WITH THIS PROJECT, WHICH IS A REQUIREMENT UNDER ACT 287.



1-800-242-1776
CALL BEFORE YOU DIG!
 PENNSYLVANIA LAW REQUIRES THREE (3) WORKING DAYS NOTICE FOR CONSTRUCTION PHASE AND TEN (10) WORKING DAYS IN DESIGN STAGE - STOP CALL

DRAWN BY: MEI
 DATE: 10/30/2025
 SCALE: _____
 DWG. NO. 0287002964

RETTEW
 RETTEW Associates, Inc.
 3020 Columbia Avenue, Lancaster, PA 17603
 Phone (800) 738-8395
 Email: rettew@rettew.com
 Website: www.rettew.com

SOUTHWEST PENNSYLVANIA RAILROAD
 PERMIT PLAN
 PA AVE. GRANT ST. PH. 2
 CITY OF UNIONTOWN
 FAYETTE

VERIFICATION

I, Garrett Henry, hereby state that the facts above set forth are true and correct (or are true and correct to the best of my knowledge, information and belief) and that I expect to be able to prove the same at a hearing held in this matter. I understand that the statements herein are made subject to the penalties of 18 Pa. C.S. § 4904 (relating to unsworn falsification to authorities).

Date: 12/16/2025

Garrett Henry

(Garrett Henry virtual signature)

CERTIFICATE OF SERVICE

I hereby certify that I have this day served a true copy of the foregoing document upon the participants, listed below, in accordance with the requirements of § 1.54 (*relating to service by participant*).

VIA ELECTRONIC MAILING ONLY

Omega Railroad / Carload Express
Bldg 1, Suite 100
Oakmont, PA 15139
dennisshow@carloadexpress.com

Atlantic Broadband
320 Bailey Ave
Uniontown, PA 15401
djobs.uch@atlanticbbn.net

Pennsylvania Department of Transportation
District 12
825 North Gallatin Ave. Ext.
Uniontown, PA 15401
repley@pa.gov

Fayette County Housing Authority
624 Pittsburgh St
Uniontown, PA 15401
lkaefer@faycha.org

West Penn Power
800 Cabin Hill Dr
Greensburg, PA 15601
madams@firstenergycorp.com

Vitalink
213 Main St,
Markleysburg, PA 15459
JEFF.FRAZEE@VITALINK.US

Verizon Pittsburgh, LLC
416 Seventh Ave
Pittsburgh, PA 15219
victor.s.wood@verizon.com

OmniFiber
Physical Address Not Available
jarred.jeffrey@omnifiber.com

North Union Township
7 South Evans Station Road
Lemont Furnace, PA 15456
angela@nutwp.com

North Fayette County Municipal Authority
1634 University Dr
Dunbar, PA 15431
KENNY@NFCMA.ORG

Pennsylvania American Water
72 Coolspring St
Uniontown, PA 15401
ERIC.YARBROUGH@AMWATER.COM

CenturyLink
Physical Address Not Available
nolan.snyder@centurylink.com

Dated this 16th day of December, 2025.

By:

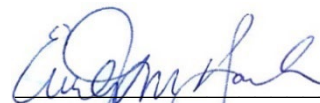

Emily M. Farah
Assistant General Counsel