

---

Tabatha Smith  
Engineering Coordinator

(717) 408 – 9112  
tabatha@americomm-llc.com

January 9, 2026

VIA ELECTRONIC FILING

Rosemary Chiavetta, Secretary  
Pennsylvania Public Utility Commission  
400 North Street  
Harrisburg, PA 17120

**RE: Application of Comcast Cable Communications Management, LLC, for Approval of the Installation of New Overhead Communications Facilities at a Highway and Railroad Crossing of Lewisburg and Buffalo Creek Railroad, and Buffalo Street located in Lewisburg, Union County, Pennsylvania**

Dear Secretary Chiavetta:

Enclosed please find the Application of Comcast Communications Management, LLC, for the approval of the installation of new 96 count fiber optic cable lashed to a .25" strand crossing over and across property owned by Lewisburg and Buffalo Creek Railroad and Buffalo Street in Lewisburg Borough, Union County. Copies of the Application have been served in accordance with the attached Certificate of Service.

Very truly yours,

Tabatha Smith  
Tabatha Smith

Enclosure

Cc: Application  
Exhibit A  
Verification  
Certificate of Service

**BEFORE  
THE PENNSYLVANIA PUBLIC UTILITIES COMMISSION**

**RE: Application of Comcast Cable Communications Management, LLC, for Approval of the Installation of New Overhead Communications Facilities at a Highway and Railroad Crossing of Lewisburg and Buffalo Creek Railroad, and Buffalo Street located in Lewisburg, Union County, Pennsylvania** : Docket No. \_\_\_\_\_  
: Comcast No. JB0001990529  
:  
:  
:  
:

To the Pennsylvania Public Utility Commission:

Comcast Cable Communications Management, LLC (“Comcast Cable” or “Applicant”), requests that the Pennsylvania Public Utility Commission (“Commission”) approve Comcast Cable’s Application for a rail crossing pursuant to Section 2702(a) of the Pennsylvania Public Utility Code, 66 Pa.C.S. § 2702(a). In support thereof, Comcast Cable submits as follows:

1. The name and address of Applicant:

Comcast Cable Communications Management, LLC  
1701 John F Kennedy Boulevard  
Philadelphia, PA 19103

2. The name and address of Applicant’s attorney:

Comcast Cable Communications Management, LLC  
1701 John F Kennedy Boulevard  
Philadelphia, PA 19103  
ATTN: General Counsel  
Legal\_Notices@comcast.com

3. Comcast Cable is a video, internet, and phone service provider in the Commonwealth of Pennsylvania. As such, Comcast Cable has the right to install and maintain its facilities at railroad crossings to provide reliable service to its customers in the Commonwealth of Pennsylvania.

4. The proposed installation will be a new 96 count fiber optic cable located on Buffalo Street, Lewisburg, Union County, at the road’s crossing of the railroad facilities of Lewisburg and Buffalo Creek Railroad (“LBCX”) located between existing wooden utility pole No. 23727N29265 and existing wooden utility pole No. 23712N29265 as shown in Exhibit A. Railroad facilities will not be disturbed during construction of Comcast Cable’s fiber optic cable and support strand. Construction of this facility is anticipated to begin as soon as approval is obtained. Construction will take approximately one (1) day to complete.

5. The cost of the construction of the fiber optic cable and support strand is approximately one thousand dollars (\$1000.00). Comcast Cable will bear the cost of this construction. Comcast Cable will be responsible for installing, maintaining, and inspecting the facilities.

6. The parties that may be affected by the proposed facilities are as follows: the Pennsylvania Department of Transportation, Union County, Lewisburg Borough, and LBCX. The Applicant has served a copy of this Application upon the parties referenced, as shown on the attached Certificate of Service.

7. The installation of the new facility will be used to boost and extend Comcast Cable's service in the immediate and surrounding area. The proposed midspan clearance height of 29' over and across LBCX property and Buffalo Street leaves ample space for train, traffic, and pedestrian operation.

WHEREFORE, Comcast Cable Communications Management, LLC, requests that the Pennsylvania Public Utility Commission approve the rail crossing described herein on or before February 9, 2026.

Respectfully submitted,

Dated: January 9, 2023

By: Tabatha Smith

Tabatha Smith, Engineering Coordinator  
Americomm LLC, Business Partner of Comcast Cable  
21 State Avenue, Suite 1  
Carlisle, PA 17013  
(717) 408 – 9112  
tabatha@americomm-llc.com

# COMCAST CABLE COMMUNICATIONS MANAGEMENT, LLC CONSTRUCTION PLANS BUFFALO STREET LEWISBURG - UNION COUNTY

**LEGEND**

Ex.	Existing
R.R.C.	Railroad Right of Way
M.P.	Railroad Mile Post
M.S.	Map-Splice
M.K.	Map-Knob
C.M.	Concrete Monument
T.M.P.	Top Map & Profile
	Handicap Symbol
	Concrete Monument
	Manhole
	Right of Way Line
	Sale Boundary
	Utility Pole
	Proposed Core Ditch
	Proposed Underground Line
	Proposed CATV Vault
	Light Pole/ Lamp
	Gas Valve
	Overhead Electric
	Overhead Telephone
	Overhead CATV
	Underground Electric
	Underground Telephone
	Underground CATV
	Electric Junction Box
	Electric Transformer
	Electric Meter
	Electric Manhole
	Telephone Manhole
	Telephone Box
	CATV Manhole
	CATV Pedestal
	Stormwater Pipe
	Stormwater Manhole
	Stormwater Inlet
	Water Line
	Water Manhole
	Water Valve
	Water Mch
	Pipe Hydrant
	Sanitary Sewer Line
	Sanitary Sewer Manhole
	Gas Valve
	Gas Meter
	Gas Line
	Crosscut
	Fence Line
	Sign
	Handicapped Symbol
	Concrete Monument
	Manhole

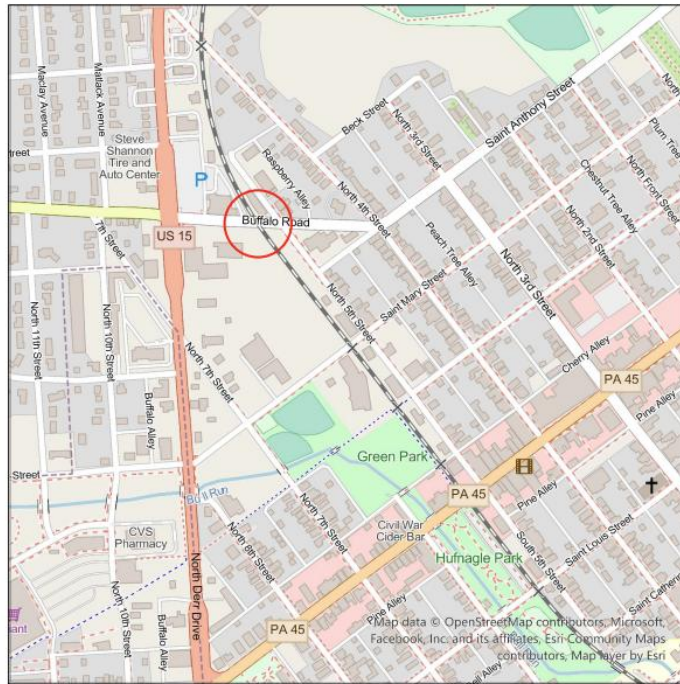

**GENERAL NOTES:**

1. THE LOCATIONS OF UNDERGROUND UTILITIES AS SHOWN HEREON ARE BASED ON ABOVEGROUND STRUCTURES AND RECORD DRAWINGS PROVIDED TO THE SURVEYOR. LOCATIONS OF UNDERGROUND UTILITIES/STRUCTURES/SERVICES MAY VARY FROM LOCATIONS SHOWN HEREON. ADDITIONAL BURIED UTILITIES/STRUCTURES/SERVICES MAY BE ENCOUNTERED. NO EXCAVATIONS WERE MADE DURING THE PROCESS OF THE SURVEY TO LOCATE BURIED UTILITIES. THE LOCATIONS OF UNDERGROUND UTILITIES ARE APPROXIMATE AND MUST BE VERIFIED IN THE FIELD PRIOR TO CONSTRUCTION. TO COMPLY WITH REQUIREMENTS OF PENNSYLVANIA ACT 287 OF 1974 AS AMENDED ENTITLED: "UNDERGROUND UTILITY LINE PROTECTION LAW."
2. EXISTING UTILITIES AND STORM DRAINAGE SYSTEMS ARE SHOWN TO ALERT THE PERMITTEE/CONTRACTOR TO THEIR PRESENCE AND THE PERMITTEE/CONTRACTOR IS SOLELY RESPONSIBLE FOR DETERMINING ACTUAL LOCATIONS AND ELEVATIONS OF ALL UTILITIES AND STORM DRAINAGE SYSTEMS INCLUDING SERVICES. APPROXIMATE LOCATIONS OF EXISTING UTILITIES AND SURFACE FEATURES ARE BASED ON FIELD SURVEY BY AMERICOMM-LLC AND/OR PA DESIGN ONE-CALL.
3. THE PERMITTEE/CONTRACTOR MUST CONTACT THE PENNSYLVANIA ONE-CALL SYSTEM AT 1-800-242-1776, THREE WORKING DAYS PRIOR TO THE START OF WORK TO HAVE ALL UTILITIES MARKED IN THE WORK AREA.

**SHEET INDEX**

SHEET 1	TITLE SHEET
SHEET 2	PROPOSED PLAN VIEW
SHEET 3	PROPOSED PROFILE VIEW

CALL BEFORE YOU DIG.  
PA STATE LAW REQUIRES 3 WORKING DAYS NOTICE FOR CONSTRUCTION PHASE AND 10 WORKING DAYS NOTICE IN DESIGN STAGE  
PENNSYLVANIA ONE CALL SYSTEM, INC. 1-800-242-1776



Americomm-LLC Corporate Office  
21 State Avenue Suite 101  
Carlisle, PA 17013  
717-408-9116

COMCAST CORPORATION

BUFFALO STREET,  
LEWISBURG, PA 17837

FIELDED \_\_\_\_\_

DRAWN H.W.

SITE LOCATION

APPROVED \_\_\_\_\_

**REVISIONS**

NO.	DATE	DESCRIPTION	CKD	APP



**PROPOSED  
RAILROAD CROSSING**

VICINITY MAP SCALE: 1" = 750'

**COMCAST** 1701 JFK BOULEVARD  
PHILADELPHIA, PA 19103

AERIAL CABLE CROSSING  
OVER UNION COUNTY INDUSTRIAL  
RAILROAD  
AT BUFFALO STREET,  
LEWISBURG, UNION COUNTY, PA

NW ±24' TO AAR/DOT #591757M &  
M.P. 166.48

LOCATION: BUFFALO STREET,  
LEWISBURG, PA  
LATITUDE: 40.866691  
LONGITUDE: -76.891133  
DRAWING NO: SHEET 1 OF 3  
DRAWING DATE: 01/16/2025  
DRAWING SCALE: 1 INCH = 30 FEET

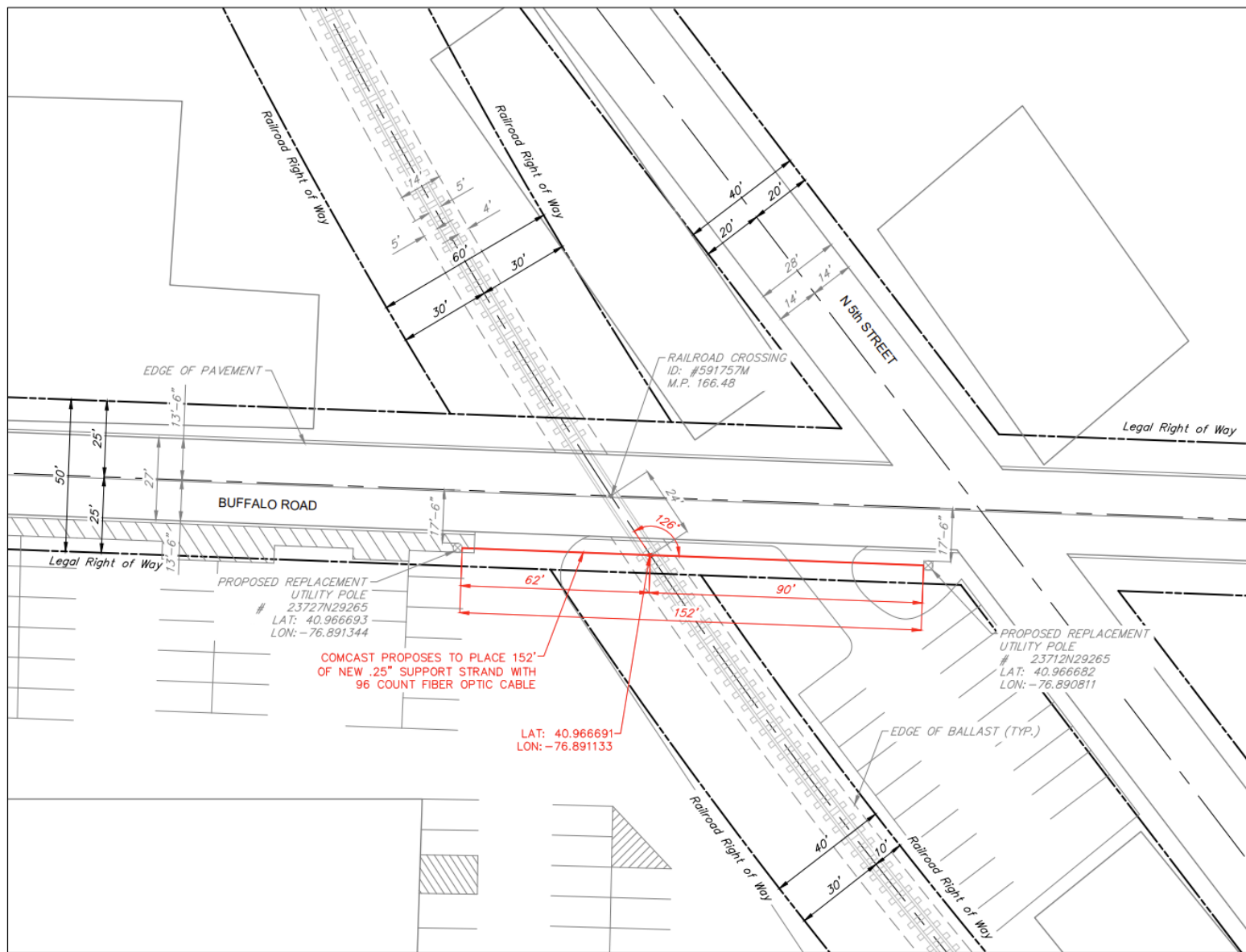

Americom-LLC Corporate Office  
 21 State Avenue Suite 101  
 Carlisle, PA 17013  
 717-408-9116

**COMCAST CORPORATION**

BUFFALO STREET,  
 LEWISBURG, PA 17837

FIELDED \_\_\_\_\_  
 DRAWN H.W. \_\_\_\_\_  
 APPROVED \_\_\_\_\_

**SITE LOCATION**

REVISIONS

NO.	DATE	DESCRIPTION	CKD	APP



**PROPOSED PLAN VIEW**

SCALE: 1" = 30'  
 GRAPHICAL SCALE IN FEET:

**COMCAST** 1701 JFK BOULEVARD  
 PHILADELPHIA, PA 19103

**AERIAL CABLE CROSSING  
 OVER UNION COUNTY INDUSTRIAL  
 RAILROAD  
 AT BUFFALO STREET,  
 LEWISBURG, UNION COUNTY, PA**

NW ±24' TO AAR/DOT #591757M &  
 M.P. 166.48

LOCATION: BUFFALO STREET,  
 LEWISBURG, PA  
 LATITUDE: 40.966691  
 LONGITUDE: -76.891133  
 DRAWING NO: SHEET 2 OF 3  
 DRAWING DATE: 01/16/2025  
 DRAWING SCALE: 1 INCH = 30 FEET

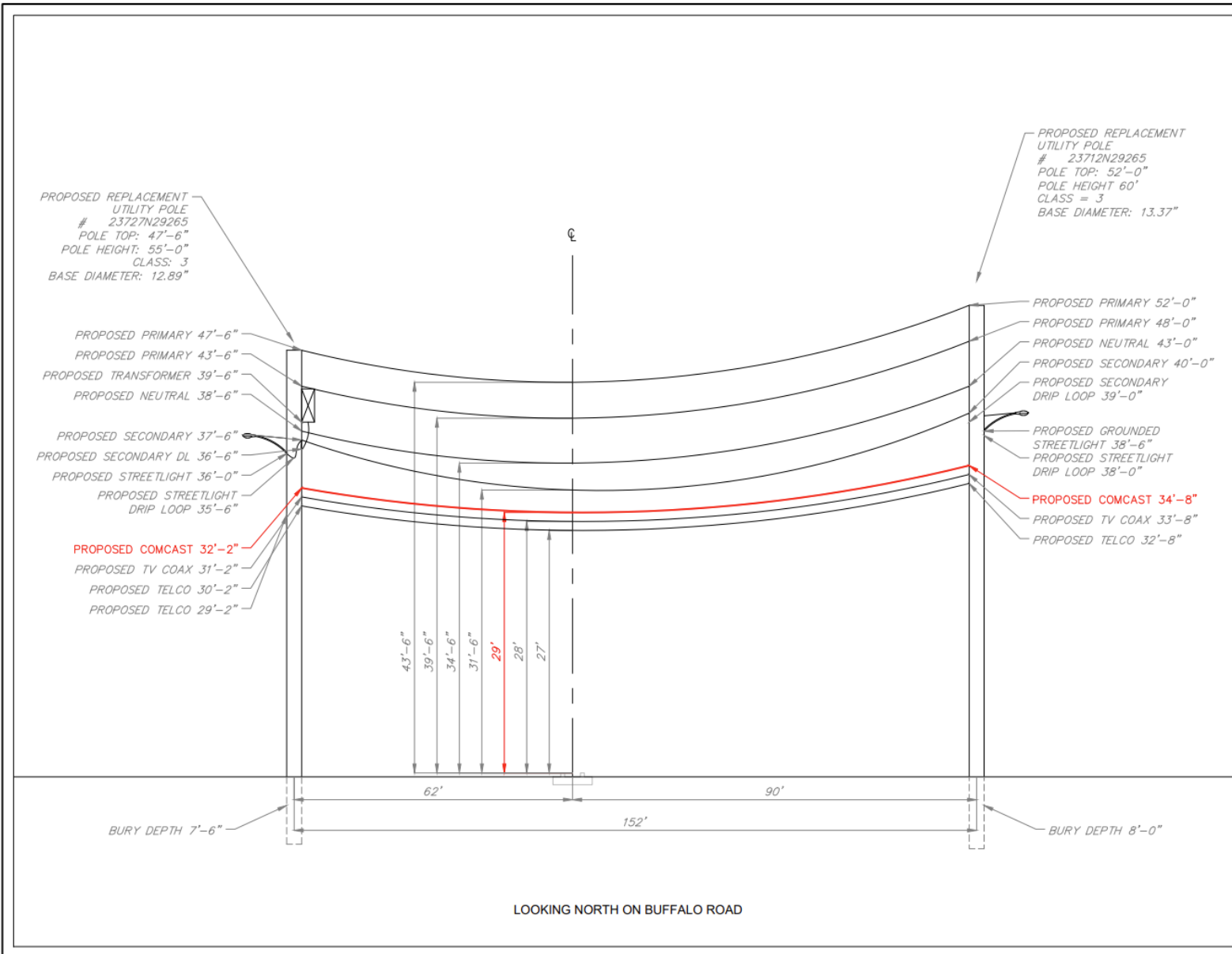

**Americom LLC**  
 Utility Specialist

Americom-LLC Corporate Office  
 21 State Avenue Suite 101  
 Carlisle, PA 17013  
 717-408-9116

**COMCAST CORPORATION**

BUFFALO STREET,  
 LEWISBURG, PA 17837

FIELDED \_\_\_\_\_  
 DRAWN H.W.  
 APPROVED \_\_\_\_\_

**SITE LOCATION**

**REVISIONS**

NO.	DATE	DESCRIPTION	CKD	APP

**PROPOSED PROFILE VIEW**

VERTICAL SCALE: 1" = 10'  
 GRAPHICAL SCALE IN FEET:  
 0 5 10 20

HORIZONTAL SCALE: 1" = 20'  
 GRAPHICAL SCALE IN FEET:  
 0 10 20 40

**COMCAST** 1701 JFK BOULEVARD  
 PHILADELPHIA, PA 19103

**AERIAL CABLE CROSSING  
 OVER UNION COUNTY INDUSTRIAL  
 RAILROAD  
 AT BUFFALO STREET,  
 LEWISBURG, UNION COUNTY, PA**

NW ±24' TO AAR/DOT #591757M &  
 M.P. 166.48

LOCATION: BUFFALO STREET,  
 LEWISBURG, PA  
 LATITUDE: 40.906691  
 LONGITUDE: -78.891133  
 DRAWING NO: SHEET 3 OF 3  
 DRAWING DATE: 01/18/2025  
 DRAWING SCALE: 1 INCH = 20 FEET / 10 FEET

SHEET 3 OF 3

**BEFORE  
THE PENNSYLVANIA PUBLIC UTILITIES COMMISSION**

**RE: Application of Comcast Cable Communications Management, LLC, for Approval of the Installation of New Overhead Communications Facilities at a Highway and Railroad Crossing of Lewisburg and Buffalo Creek Railroad, and Buffalo Street located in Lewisburg, Union County, Pennsylvania** : Docket No. \_\_\_\_\_  
: Comcast No. JB0001990529  
:  
:  
:  
:  
:

**VERIFICATION**

I, Tabatha Smith, Engineering Coordinator for Americomm LLC, a Business Partner of Comcast Cable, hereby state that the facts set forth in the Application of Comcast Cable Communications Management, LLC, are true and correct to the best of my knowledge, information, and belief. The statements herein are made subject to the penalties of 18 Pa.C.S. § 4904 relating to the unsworn falsification to authorities.

Dated: January 9, 2026

By: Tabatha Smith

Tabatha Smith, Engineering Coordinator  
Americomm LLC, Business Partner of Comcast Cable  
21 State Avenue, Suite 1  
Carlisle, PA 17013  
(717) 408 – 9112  
tabatha@americomm-llc.com

**BEFORE  
THE PENNSYLVANIA PUBLIC UTILITIES COMMISSION**

**RE: Application of Comcast Cable Communications Management, LLC, for Approval of the Installation of New Overhead Communications Facilities at a Highway and Railroad Crossing of Lewisburg and Buffalo Creek Railroad, and Buffalo Street located in Lewisburg, Union County, Pennsylvania** : Docket No. \_\_\_\_\_  
: Comcast No. JB0001990529  
:  
:  
:  
:

**CERTIFICATE OF SERVICE**

I hereby certify that I have this day served a true copy of the foregoing document upon the entities listed below in accordance with the requirements of 52 Pa. Code §1.54 (relating to service):

Pennsylvania Department of Transportation  
ROW & Utility Division, Bureau of Design  
P.O. Box 3362  
Harrisburg, PA 17105-3362  
[danleonard@pa.gov](mailto:danleonard@pa.gov)

Lewisburg and Buffalo Creek Railroad  
80 Hollow Road  
Lewisburg, PA 17837  
[wsand101@hotmail.com](mailto:wsand101@hotmail.com)

Pennsylvania Department of Transportation  
Office of Chief Counsel  
P.O. Box 8212  
Harrisburg, PA 17105-8212  
[kcummings@pa.gov](mailto:kcummings@pa.gov)

Lewisburg Borough  
55 South Fifth Street  
Lewisburg PA 17837  
Phone: (570) 523 3614  
Email: [office@lewisburgborough.org](mailto:office@lewisburgborough.org)

Union County  
155 N. 15th Street  
Lewisburg, PA 17837  
570-524-3840  
[SMcLaughlin@unionco.org](mailto:SMcLaughlin@unionco.org)  
[JDelVecchio@unionco.org](mailto:JDelVecchio@unionco.org)

Comcast Cable Communications Management, LLC  
Attn: Americomm LLC  
21 State Avenue, Suite 1  
Carlisle, PA 17013  
[tabatha@americomm-llc.com](mailto:tabatha@americomm-llc.com)

Dated: January 9, 2026

By: *Tabatha Smith*  
Tabatha Smith