

1. <u>REPORT DATE:</u> November 25, 1985	:	2. <u>BUREAU AGENDA NO.</u> JAN-86-SC-RS-4*
3. <u>BUREAU:</u> Safety and Compliance	:	
4. <u>SECTION(S):</u> Rail Safety Division	:	5. <u>PUBLIC MEETING DATE:</u> January 10, 1986
6. <u>APPROVED BY:</u> Director: Nicely 3-3846 Supervisor: Lehman 7-9732	:	
7. <u>MONITOR:</u>	:	
8. <u>PERSON IN CHARGE:</u> D. C. Hart 7-6805	:	
9. <u>DOCKET NO:</u> C-80011839	:	

10. (a) CAPTION (abbreviate if more than 4 lines)
 (b) Short summary of history & facts, documents & briefs
 (c) Recommendation

(a) Villanova University
 v.
 National Railroad Passenger Corporation (Amtrak),
 Consolidated Rail Corporation (Conrail), Southeastern
 Pennsylvania Transportation Authority (SEPTA), Pennsylvania
 Department of Transportation (PennDOT), County of
 Delaware and Radnor Township.

(b) On October 28, 1985, the Commission received a detailed inspection report from Amtrak for the bridge carrying Spring Mill Road over the tracks of Amtrak in Radnor Township, Delaware County recommending that the subject bridge be posted for 15 tons.

(c) The Bureau of Safety and Compliance recommends that the Commission ratify the emergency order signed by Linda C. Taliaferro on November 15, 1985, directing that the subject bridge be posted for a maximum weight limit of 15 tons.

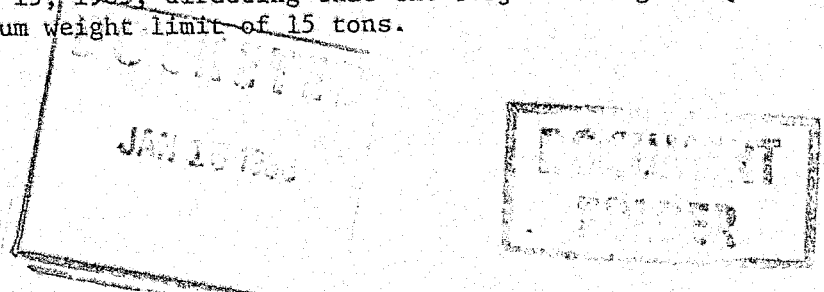

11. MOTION BY: Commissioner ~~Chm.~~ Taliaferro Commissioner Fischl - Yes.
 Commissioner
SECONDED: Commissioner Shane Commissioner

CONTENT OF MOTION: Staff recommendation adopted.



COMMONWEALTH OF PENNSYLVANIA
PENNSYLVANIA PUBLIC UTILITY COMMISSION
P. O. BOX 3265, HARRISBURG, Pa. 17120

January 15, 1985

IN REPLY PLEASE
REFER TO OUR FILE
C-80011839

TO ALL PARTIES
(Refer to Service List of Emergency
Order issued November 15, 1985)

Ratification of emergency order in re:

Villanova University
v.
National Railroad Passenger Corporation (Amtrak),
Consolidated Rail Corporation (Conrail), Southeastern
Pennsylvania Transportation Authority (SEPTA),
Pennsylvania Department of Transportation (PennDOT),
County of Delaware and Radnor Township.

To Whom It May Concern:

This is to advise you that an Order has been adopted by the Commission
in public meeting held January 10, 1986 in the above entitled proceeding.

A copy of this Order has been enclosed for your records.

Very truly yours,

Jerry Rich, Secretary

fao
Encls.
Certified Mail
Jay Cochran, Jr., Commissioner
Pennsylvania State Police
1800 Elmerton Avenue
Harrisburg, PA 17120

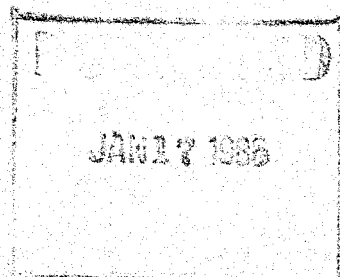
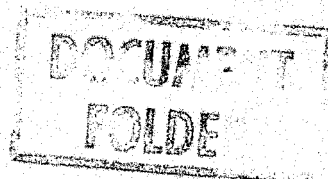

PENNSYLVANIA
PUBLIC UTILITY COMMISSION
Harrisburg, PA 17120

Public Meeting held January 10, 1986

Commissioners Present:

Linda C. Taliaferro, Chairman
Frank Fischl
Bill Shane

Ratification of emergency order in re:

Villanova University

C-80011839

v.

National Railroad Passenger Corporation
(Amtrak), Consolidated Rail Corporation
(Conrail), Southeastern Pennsylvania
Transportation Authority (SEPTA),
Pennsylvania Department of Transportation
(PennDOT), County of Delaware and Radnor
Township.

O R D E R

BY THE COMMISSION:

This matter comes before the Commission upon its own motion.
By emergency order issued November 15, 1985, Chairman Linda C. Taliaferro
ordered:

- "1. That Pennsylvania Department of Transportation, at its initial cost and expense, immediately erect and maintain signs at appropriate locations at the bridge and on the approaches thereto, posting the subject bridge for a maximum weight limit of fifteen (15) tons.
2. That Pennsylvania Department of Transportation, at its initial cost and expense, immediately and simultaneously furnish all material and do all work necessary to establish, mark and maintain a suitable detour for all vehicles weighing in excess of fifteen (15) tons.

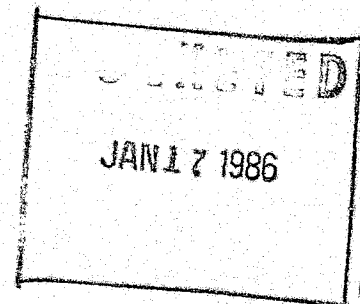
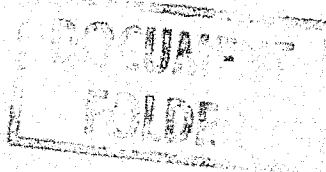

3. That National Railroad Passenger Corporation, at its initial cost and expense, furnish all material and do all work necessary to make any repairs required to the structure to ensure the safety of the bridge for the posted load limit of fifteen (15) tons.
4. That a copy of this order be served on the Commissioners of the Pennsylvania State Police."

Upon review of the circumstances surrounding the issuance of the emergency order, we conclude that it is in the public interest to make such action; THEREFORE,

IT IS ORDERED: That the emergency order issued November 15, 1985 at C-80011839, be and is hereby ratified.

BY THE COMMISSION,

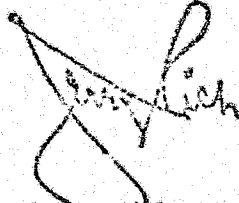
A handwritten signature in dark ink, appearing to read "Jerry Rich". The signature is stylized and somewhat cursive, with a large loop at the end.

Jerry Rich
Secretary

(SEAL)

ORDER ADOPTED: January 10, 1986

ORDER ENTERED: JAN 15 1986

RECEIVED

JAN 17 1986

SECRETARY'S OFFICE
Public Utility Commission

This 18th day of January, 1986

the undersigned hereby acknowledges receipt of

EXECUTED AND THREE COPIES OF ORDER

rendered by the Commission in Docket No. C-80011839

Under date of January 10, 1986 and accepts service

in behalf of PENNSYLVANIA DEPARTMENT OF TRANSPORTATION

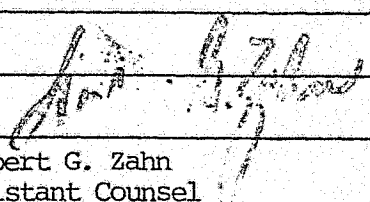
Herbert G. Zahn
Assistant Counsel

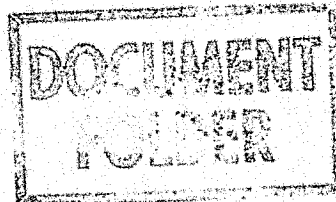

RECEIVED

JAN 21 1986

SECRETARY'S OFFICE
Public Utility Commission

This 17th day of January
the undersigned hereby acknowledges receipt of

COPY OF ORDER

rendered by the Commission in Docket No. C-80011839

Under date of January 10, 1986 and accepts service

in behalf of JAY COCHRAN, JR., COMMISSIONER

PENNSYLVANIA STATE POLICE

Harry A. Crytzer

Harry A. Crytzer
Major
Bureau of Patrol



COMMONWEALTH OF PENNSYLVANIA
DEPARTMENT OF TRANSPORTATION

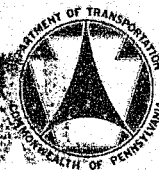

August 16, 1990

IN REPLY REFER TO

Delaware County
S.R. 0320, Section 12S (formerly L.R. 225)
Spring Mill Road
Radnor Township
PUC C-80011839

RECEIVED

AUG 20 1990

SECRETARY'S OFFICE
Public Utility Commission

Mr. Jerry Rich, Secretary
Public Utility Commission
Harrisburg, PA 17120

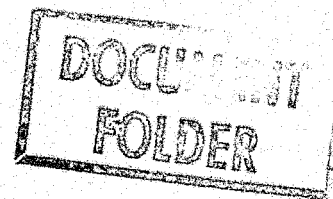

Dear Mr. Rich:

Paragraph 6 of the Commission's order adopted on December 17, 1982, in the proceeding docketed as C-80011839 directed the Department of Transportation to inform the Commission concerning the status of progress the Department may have made towards the replacement of the structure involved in the subject proceeding.

The Department of Transportation has prepared preliminary plans for the replacement of the subject structure, two (2) copies of which are attached herewith for the Commission's consideration.

The Department requests that a field investigation and conference be scheduled by the Commission to discuss these plans.

A copy of this letter and one (1) set of the aforementioned plans are being forwarded to the following parties of record:

Delaware County Commissioners, Mary Ann Arty, Chairman,
Government Center Building, Media, PA 19063

Radnor Township, Graham D. Andrews, President, 301 Iven
Avenue, Wayne, PA 19087

AMTRAK, Mr. Kenneth P. Felsburg, Jr., Senior Director,
Engineering Construction, 2000 Market Street - 6th Floor,
Philadelphia, PA 19103

Southeastern Pennsylvania Transportation Authority, Chief
Engineer, 200 West Wyoming Avenue, Philadelphia, PA 19140

Consolidated Rail Corporation, Mr. J. D. Cossel, Chief
Engineer, Design and Construction, 12th Floor - 15 N.
32nd Street, Philadelphia, PA 19104

Making It Happen

Mr. Jerry Rich, Secretary
Page 2
August 16, 1990

James W. Patterson, Esquire, Harper, George, Buchanan &
Driver, Attorney for Villanova University, 1200 West
Savings Bank Building, Broad and Chestnut Streets,
Philadelphia, PA 19107

A copy of this letter and one (1) set of plans are also
being forwarded to the following public utility companies whose
facilities may be affected by the proposed construction:

Philadelphia Electric Company, Edward G. Bauer, Jr., Vice
President & General Counsel, 2301 Market Street,
Philadelphia, PA 19101

The Bell Telephone Company of PA, William L. Leonard, Vice
President & General Counsel, Law Department, One Parkway,
16th Floor, Philadelphia, PA 19102

Philadelphia Suburban Water Company, 762 Lancaster Avenue,
Bryn Mawr, PA 19010

A T & T Communications, Room A-360, 3033 Chain Bridge Road,
Oakton, VA 22185

Sincerely,



For: William R. Moyer, P.E.
Chief Engineer
Highway Administration

Attachments

FE.U.	DISTRICT	COUNTY	TOWNSHIP	BOROUGH	ROUTE	SECTION	TOTAL SHEETS
6-0	DELAWARE	RADNOR			0320	12S RW	
STATE PROJECT NUMBER							
SYS	L.R. or W.O.	SPUR	PKA	SECTION	DIST.	CO.	
C	1013	210	0	7	1215	016	3

COMMONWEALTH OF PENNSYLVANIA



DEPARTMENT OF TRANSPORTATION
DRAWINGS AUTHORIZING ACQUISITION
OF
RIGHT-OF-WAY
FOR

STATE ROUTE 0320 SECTION 12S
IN DELAWARE COUNTY

FROM STA. 778+78 TO STA. 790+50 LENGTH 1172 FT. 0.222MI.
FROM SEG. 0320 OFFSET 598.5 TO SEG. 0320 OFFSET 1770.5

THIS PLAN PREPARED PURSUANT TO SECTION 2003 (e) OF THE ADMINISTRATIVE CODE (ACT OF APRIL 9, 1929, P.L. 177, AS AMENDED BY ACT 1979-100), AND SECTION 402 (b)(3) OF THE EMINENT DOMAIN CODE OF 1964 AS AMENDED.

THE PUBLIC UTILITY COMMISSION WILL APPROPRIATE PROPERTY IN APPLICATION DOCKET NO. BETWEEN STATION + AND STATION + PURSUANT TO THE PROVISIONS OF SECTION 2702 (b) OF THE ACT OF JULY 1, 1978, P.L. 598, NO. 116 (66 P.S. 2702).

L.R. 320 IS NOW KNOWN AS S.R. 0320

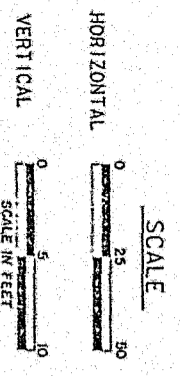

DESIGN DESIGNATION

HIGHWAY CLASSIFICATION - MINOR ARTERIAL	TRAFFIC DATA	CURRENT A.D.T.	12,900 (1990)
DESIGN SPEED - 30 M.P.H.	DESIGN YEAR A.D.T.	13,300 (2010)	
PAVEMENT WIDTH - 12' & 14' LANES	D.H.V.	-	
SHOULDER WIDTH - 8' LT.	D	-	
MEDIAN WIDTH, MAXIMUM - NONE	T	-8%	
MINIMUM - NONE			

PREPARED BY:

RECOMMENDED _____ 198
DISTRICT ENGINEER

RECOMMENDED _____ 198
DEPUTY SECRETARY

APPROVED _____ 198
SECRETARY OF TRANSPORTATION

ON BEHALF OF THE GOVERNOR AS WELL AS HIMSELF

DOCUMENT FOLDER

RECORDED
AUG 2 1990

RECEIVED
AUG 2 01990
SECRETARY'S OFFICE
Public Utility Commission
C-80011839

PRELIMINARY
JUL 25 1990
URBAN ENGINEERS, INC.
PHILADELPHIA, PA. 19103

RECORDED IN THE OFFICE FOR THE RECORDING OF DEEDS, ETC. IN COUNTY, PA.
BOOK _____ PAGE _____
WITNESS MY HAND AND SEAL OF OFFICE _____
RECORDER _____

COMMONWEALTH OF PENNSYLVANIA
COUNTY OF DAUPHIN
BEFORE ME, A NOTARY PUBLIC, PERSONALLY CAME
OF TRANSPORTATION, WHO ACKNOWLEDGED THE WITHIN
PLAN COMPRISING SEPARATE SHEETS,
TO BE AN OFFICIAL PLAN OF THE PENNSYLVANIA
DEPARTMENT OF TRANSPORTATION AND DESIRED THAT
THE SAME BE RECORDED AS SUCH.
WITNESS MY HAND AND NOTARIAL SEAL
NOTARY PUBLIC
MY COMMISSION EXPIRES _____

Limit of Authorization
 Sta. 778 + 90
 Seg. 0320 Offset S98.5
 S.R. 0320 Sec. 12S R/W
 Rodnor Township
 Delaware County

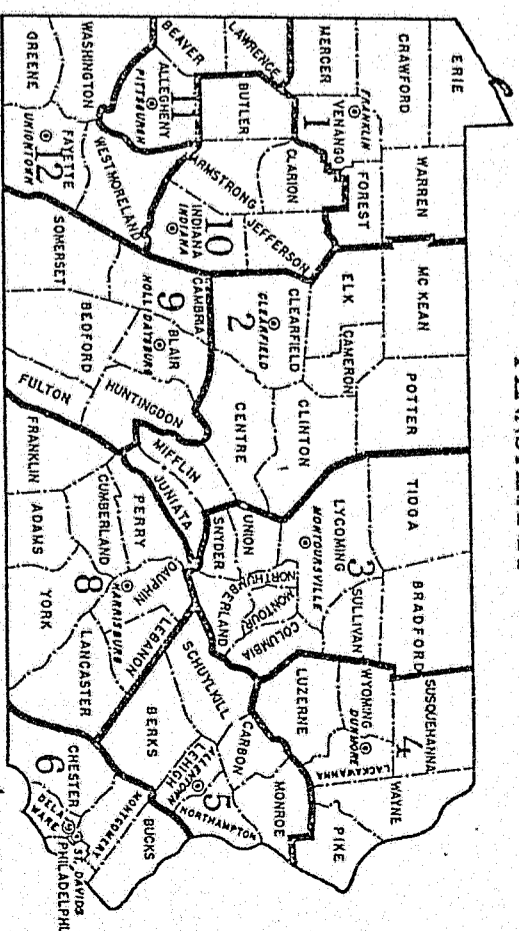
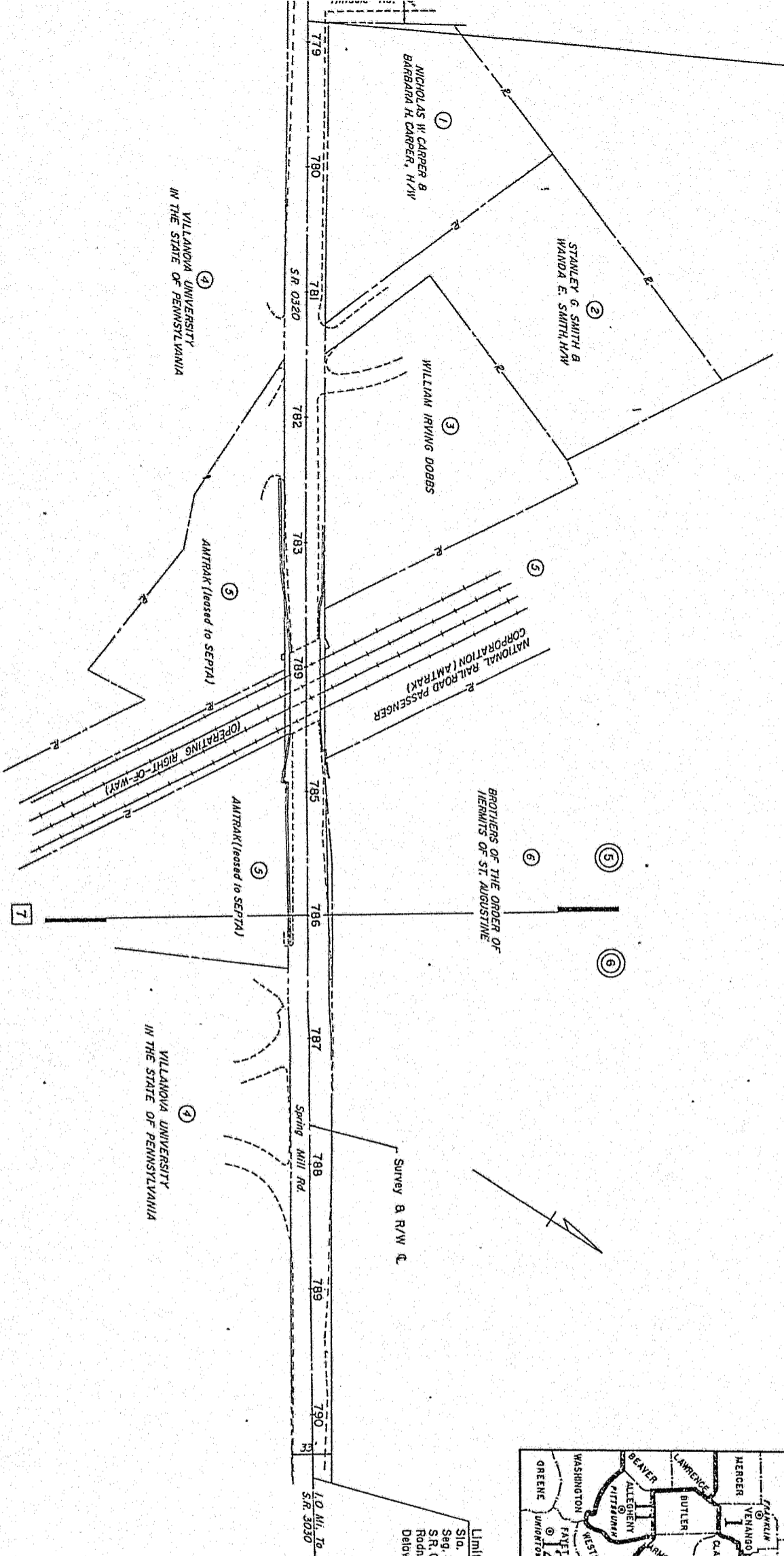

Limit of Authorization
 Sta. 790 + 50
 Seg. 0320 Offset 1770.5
 S.R. 0320 Sec. 12S R/W
 Rodnor Township
 Delaware County

LEGEND

- ⑤ PLAN
- ② PARCEL IDENTIFICATION NUMBER
- ⑥ PROFILE

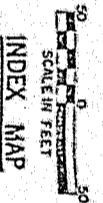

PUBLIC UTILITIES		
AT&T COMMUNICATIONS, INC. 3033 CHAIN BRIDGE ROAD ROOM A360 DOKTON, VA 22185 ATTN: D.H. EAGLE, JR., MANAGER	TOWNSHIP OF RADNOR 301 IVEN AVENUE WAYNE, PA. 19087 ATTN: ROBERT CROFORD TOWNSHIP MANAGER (215) 688-5600	SOUTHEASTERN PENNSYLVANIA TRANSPORTATION AUTHORITY 200 W. WYOMING AVENUE PHILADELPHIA, PA. 19140 ATTN: HARRY LUPA MANAGER OF CIVIL ENGINEERING & FACILITIES (215) 456-4664
TOWNSHIP OF MARPLE SPRINGFIELD AND SPROUL ROADS BROOMALL, PA. 19008 ATTN: HOPE S. SMITH, SECRETARY (215) 356-4040	PHILADELPHIA SUBURBAN WATER CO. 762 LANCASTER AVENUE BRYN MAWR, PA. 19010 ATTN: JOHN RANIERI HIGHWAY LIAISON (215) 525-1400	
RADNOR-HAVERFORD-MARPLE SEWER AUTHORITY c/o WESTON WESTON WAY WEST CHESTER, PA. 19380 ATTN: WALTER J. WUJOK, AUTHORITY ENGINEER (215) 692-3030	BELL OF PENNSYLVANIA OUTSIDE FACILITIES ENGINEERING VALEY FORGE EXECUTIVE MALL SUITE 401, BUILDING #8 WAYNE, PA. 19087 ATTN: CHARLES E. MAHAN, ASSISTANT MANAGER (215) 964-6115	
PHILADELPHIA ELECTRIC CO. 2301 MARKET STREET PHILADELPHIA, PA. 19101 ATTN: MICHAEL A. WILLIAMS, NEGOTIATOR (215) 841-5393	AMTRAK 2000 MARKET STREET 6TH FLOOR PHILADELPHIA, PA. 19103 ATTN: K.P. FELSBERG, JR., SENIOR DIRECTOR ENGINEERING & CONSTRUCTION (215) 557-1511	

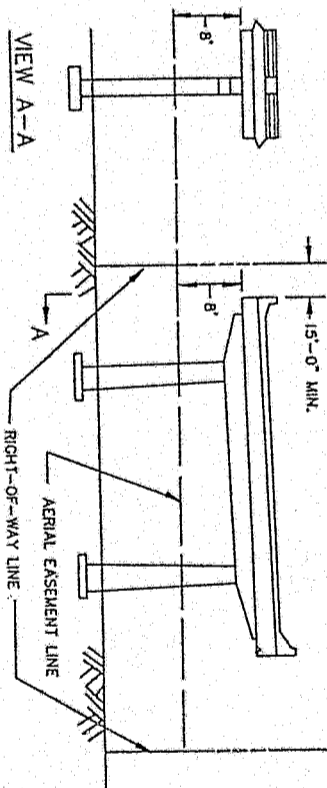
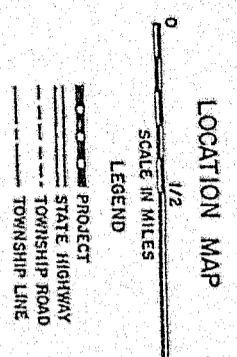
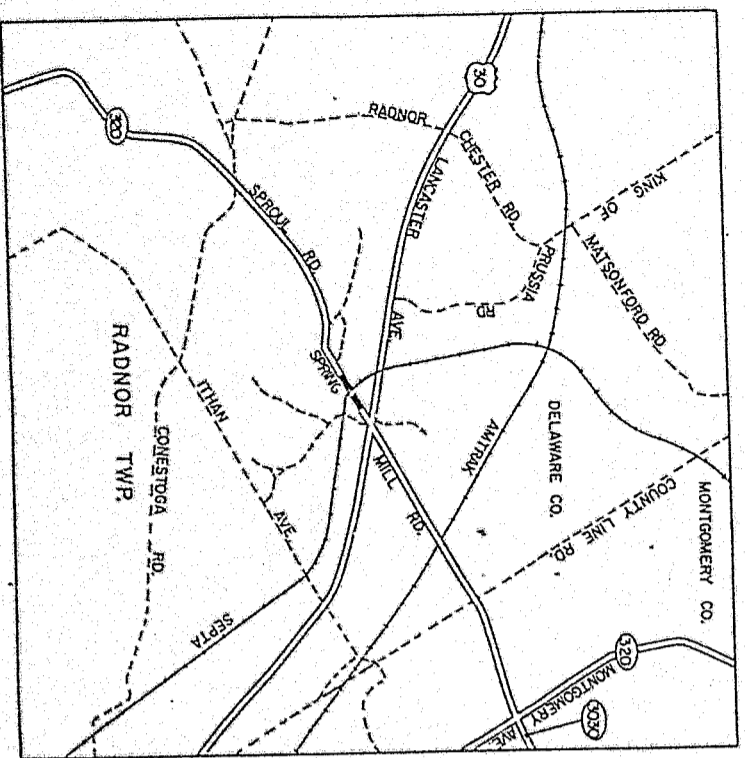

USE OF AIRSPACE BENEATH THE ESTABLISHED GRADELINE OF THE HIGHWAY SHALL PROVIDE SUFFICIENT VERTICAL AND HORIZONTAL CLEARANCES FOR THE CONSTRUCTION, OPERATION, MAINTENANCE, VENTILATION, AND SAFETY OF THE HIGHWAY FACILITY. THE ESTATE ACQUIRED ABOVE THE AERIAL EASEMENT LINE MAY BE ENCROACHED ON BY MOVING VEHICLES SUCH AS TRUCKS OR RAILROAD ROLLING STOCK.

SUMMARY OF PROJECT COORDINATES

ROUTE	STATION	POINT	COORDINATES		BEARING
			NORTH	EAST	
S.R. 0320 SURVEY & R/W	778+90 790+50	BEGIN STA. END STA.	4440.89 5039.40	4043.68 5037.36	N 58°56'21" E

LIST OF EQUALITIES
 NONE

GENERAL NOTES

THE LEGAL RIGHT-OF-WAY ON L.R. 320 IS 33 FEET, BASED ON THE ACT OF MAY 1, 1933 P.L. 103 SECTION 1105, AS AMENDED. THERE IS NO PUBLIC RECORD OF ANY OTHER WIDTH.
 THIS IS A FEDERAL-AID PROJECT, AND AS SUCH IS SUBJECT TO INSPECTION BY REPRESENTATIVES OF THE FEDERAL HIGHWAY ADMINISTRATION.

INDICATES SCALED DIMENSIONS

VERTICAL DATUM IS BASED ON AN ASSUMED BENCH MARK.
 HORIZONTAL CONTROL IS BASED ON AN ASSUMED COORDINATE SYSTEM AND MAGNETIC NORTH.
 LIMITS OF SLOPE ARE INDICATED AS FOLLOWS:

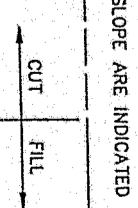

ALL REQUIRED RIGHT-OF-WAY FOR THIS PROJECT WILL BE ACQUIRED IN FEE SIMPLE UNLESS OTHERWISE NOTED. AREAS, IF ANY, DESIGNATED AS REQUIRED FOR OTHER THAN RIGHT-OF-WAY, WILL BE ACQUIRED IN SUCH LESSER ESTATE AS DESIGNATED.
 TEMPORARY AREA REQUIRED UNTIL THE CONSTRUCTION OR WORK INDICATED BY THE PLAN IS COMPLETED UNLESS SOONER REVERTED IN WRITING BY THE DEPARTMENT.

WHERE AN AERIAL EASEMENT IS TO BE ACQUIRED, IT SHALL INCLUDE A SURFACE EASEMENT UNLIMITED IN VERTICAL DIMENSION FOR THE ACCOMMODATION OF PIERS AND OTHER APPURTENANCES, A TEMPORARY AREA FOR CONSTRUCTION AND FOR STORAGE OF MATERIALS DURING CONSTRUCTION, THE FOLLOWING LIMITATIONS SHALL BE IMPOSED ON THE PROPERTY BENEATH THE AREA AFFECTED BY THE AERIAL EASEMENT:

1. NO USE SHALL BE MADE OF THE PROPERTY WHICH SHALL ENDANGER THE STRUCTURE OR THE HEALTH, SAFETY OR WELFARE OF THE TRAVELING PUBLIC.
2. NO FLAMMABLE, EXPLOSIVE, DANGEROUS OR HAZARDOUS MATERIALS SHALL BE USED, PLACED OR STORED ON THE PROPERTY.
3. NO BUILDING OR OTHER FACILITY SHALL BE CONSTRUCTED ON THE PROPERTY WITHOUT PRIOR AUTHORITY OF THE DEPARTMENT OF TRANSPORTATION, IF AND WHEN SUCH AUTHORITY IS GRANTED, THE PLANS FOR THE BUILDING OR FACILITY AND CONSTRUCTION METHOD SHALL BE SUBJECT TO THE APPROVAL OF THE DEPARTMENT OF TRANSPORTATION.
4. NO INTERFERENCE SHALL BE MADE WITH THE RIGHT OF THE DEPARTMENT OF TRANSPORTATION TO ENTER UPON THE PROPERTY FOR THE PURPOSES OF INSPECTION, MAINTENANCE, REPAIR, PAINTING, RECONSTRUCTION OR ALTERATION OF THE STRUCTURE OR ITS APPURTENANCES. MOVEABLE ITEMS MAY HAVE TO BE REMOVED BY THE OWNER DURING SOME OR ALL OF THE ABOVE OPERATIONS.
5. ANY SUBSTANTIAL CHANGE IN PROPERTY USE TO BE MADE SUBJECT TO THE ACQUISITION OF THE EASEMENT SHALL BE SUBJECT TO THE APPROVAL OF THE DEPARTMENT OF TRANSPORTATION.
6. THE NOTES ON THESE DRAWINGS SHALL NOT BE CONSTRUED, LIMITING OR INTERFERING IN ANY WAY WITH THE PRESENT AND FUTURE OPERATION, USE, MAINTENANCE, REPAIR, RENEWAL, CHANGE ADDITION, BETTERMENT OR ALTERATION OF THE RAILROAD AND ITS SUPPORTING FACILITIES.

PROJECT: 1970-71
108202 E. 50TH ST.

WILLIAM IRVING DCBBS

NOTICE OF THE ORDER OF
HEARINGS OF SA. ACQUISITION

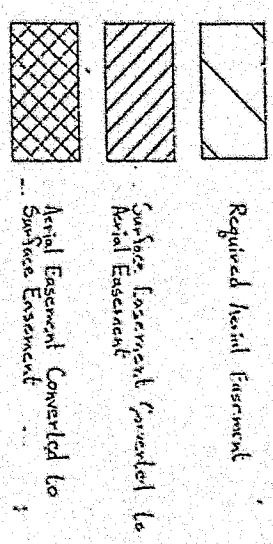
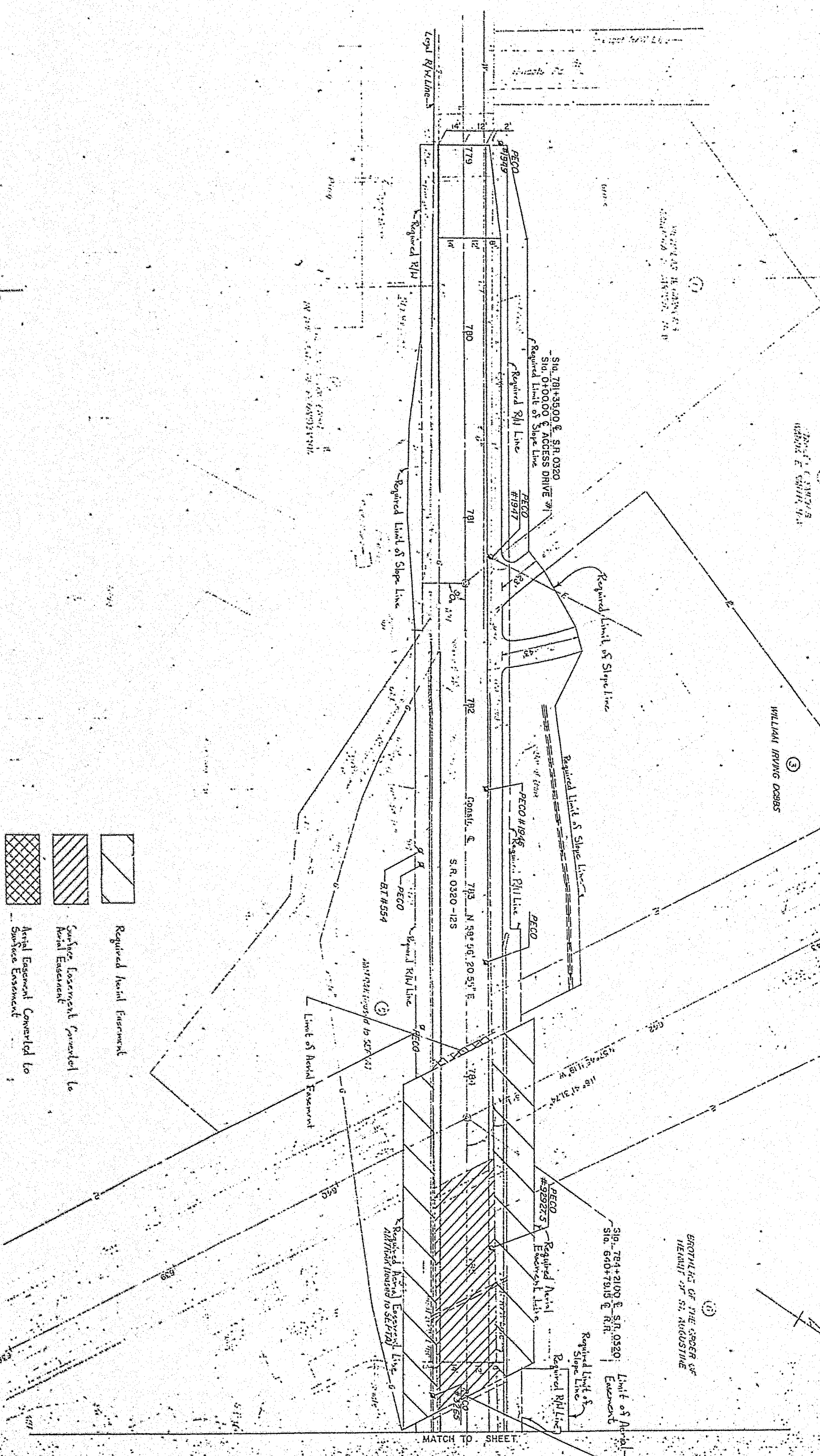

MATCH TO SHEET

6
BROTHERS OF THE ORDER OF
HERMIT OF ST AUGUSTINE

EXISTING HYDRANT
TO BE RELOCATED
BY OTHERS

PECO
Required R/W Line

Required Limit of Slope Line

786 12

14'

S. R. 0320-125

787

788

789

790

Consr. C

Spring Mill Road

Required R/W Line

Required R/W Line

Required R/W Line

Required R/W Line

Required R/W Line

Required R/W Line

Required R/W Line

Required R/W Line

Required R/W Line

Required R/W Line

Required R/W Line

Required R/W Line

Required R/W Line

Required R/W Line

Required R/W Line

Required R/W Line

Required R/W Line

Required R/W Line

Required R/W Line

Required R/W Line

Required R/W Line

Required R/W Line

5
AMTRAK (revised to SEPT 11)

4
VILLANOVA UNIVERSITY
IN THE STATE OF PENNSYLVANIA

Spring Mill

DISTRICT	COUNTY	DATE
S-0	DELAWARE	03 20 12S RW
PLAT/SECTION NUMBER	TOWNSHIP	DATE
	RADNOR TOWNSHIP	
REVISIONS		

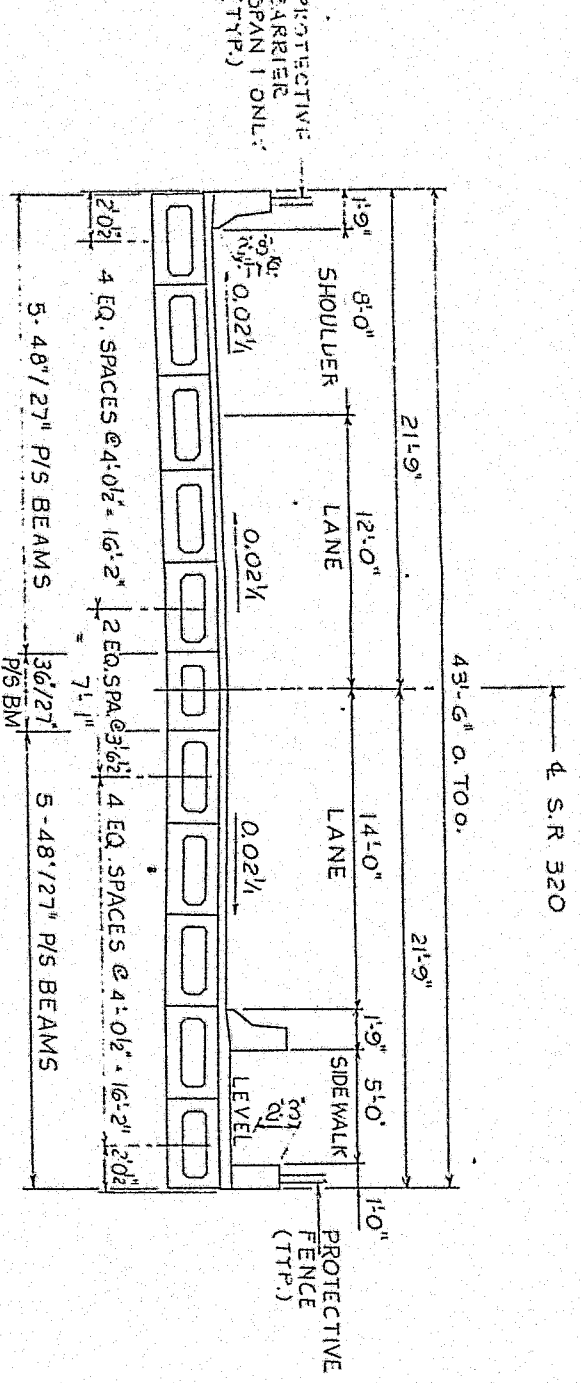

TYPICAL SECTION
SCALE: 1/4" = 1'-0"

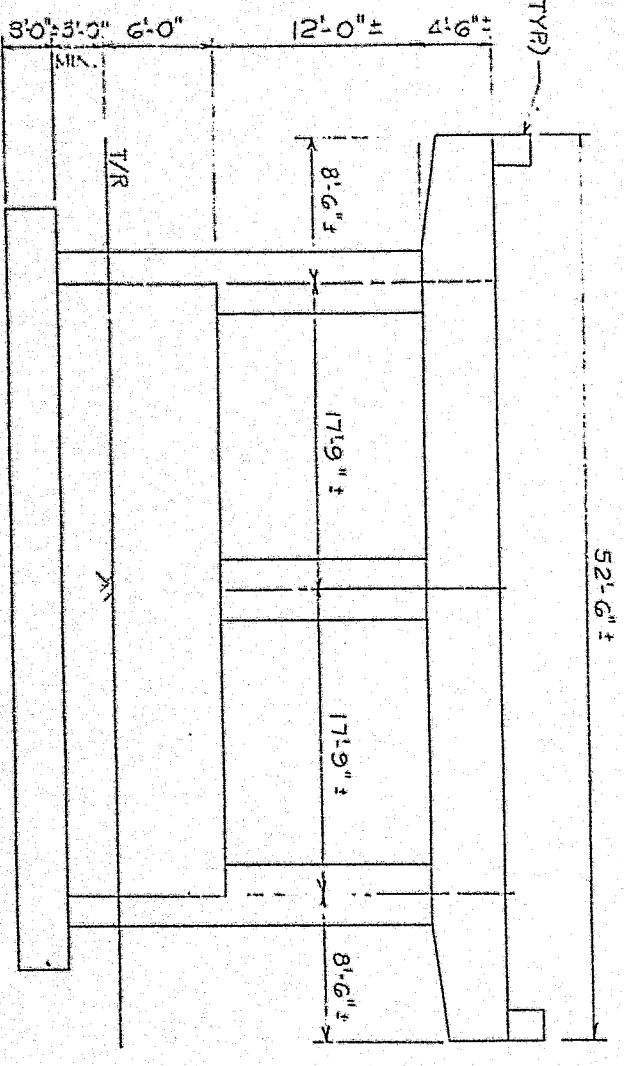

TYPICAL PIER ELEVATION
SCALE: 3/16" = 1'-0"

NOTE:
FOR PLAN ELEVATION,
SEE SHEET 1.

- 0 PROVIDE MATERIALS AND WORKMANSHIP AND CONTRACT SPECIAL SPECIFICATIONS. PUBLICATION 408/87
- 0 DESIGN SPECIFICATIONS:
- DESIGN DIVISION 1 OF ASHTO. STANDARD SPECIFICATIONS FOR HIGHWAY BRIDGES 1989 AND AS SUPPLEMENTED BY DESIGN MANUAL, PART 4 (NOVEMBER 1988).
- DESIGN IS IN ACCORDANCE WITH THE STRENGTH DESIGN METHOD (LOAD FACTOR DESIGN).
- 0 DESIGN LIVE LOAD:
- HS 25 LOADING, OR 125 PERCENT OF THE ALTERNATE MILITARY LOADING, OR P-92 (204K PERMIT LOAD) WITH THE ASHTO GROUP 1B LOADING.
- 0 DEAD LOAD:
- INCLUDES 30 POUNDS PER SQUARE FOOT FOR FUTURE WEARING SURFACE ON THE DECK SLAB.
- 0 DECK SLAB:
- CLASS AAA CEMENT CONCRETE F_c = 4,500 PSI
- REINFORCEMENT BARS F_y = 60,000 PSI
- 0 P/S BOX BEAMS:
- CONCRETE F_c = 6,500 PSI F_c'1 = 5,500 PSI
- REINFORCEMENT BARS F_y = 60,000 PSI
- STRAIDS 270 K LOR RELAXATION, 1/2" DIAMETER
- 0 SUBSTRUCTURE:
- CLASS A CEMENT CONCRETE F_c = 3,000 PSI
- REINFORCEMENT BARS F_y = 60,000 PSI

Mark	Description	By	Chk'd	App'd	Date
	REVISIONS				

Commonwealth of Pennsylvania
DEPARTMENT OF TRANSPORTATION
BUREAU OF DESIGN

DELAWARE COUNTY
S.R. 0320 SEC. 12 S
SEG. 0320 OFFSET 1106
S.R. 0320 STA. 784+21 OVER
AMTRAK MAIN LINE
3 SPAN CONT. ADJACENT BOX BEAM BRIDGE
GENERAL NOTES AND SECTIONS

RECOMMENDED _____ SHEET 2 OF 2
BRIDGE ENGINEER _____ S-17313

August 30, 1990

Mr. James W. Patterson, Esquire
Rubin, Quinn, Moss, Heaney & Patterson
Attorney for Villanova University
1800 Penn Mutual Tower
510 Walnut Street
Philadelphia, PA 19106-3619

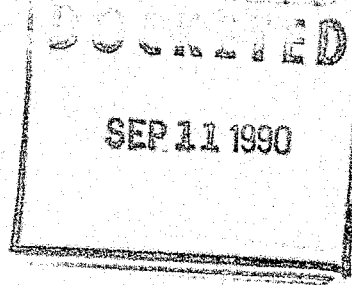

In re: C-80011839 - Villanova University

v.

National Railroad Passenger Corporation (Amtrak),
Consolidated Rail Corporation (Conrail), South-
eastern Pennsylvania Transportation Authority
(SEPTA), Pennsylvania Department of Transportation
(PennDOT), County of Delaware and Radnor Township.

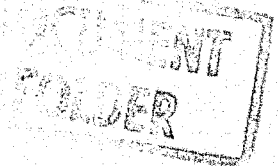

Dear Mr. Patterson:

The Pennsylvania Department of Transportation has requested a meeting of all interested parties to discuss preliminary plans for replacement of the bridge carrying Spring Mill Road (S.R. 320) over the tracks of AMTRAK in Radnor Township, Delaware County.

We have therefore scheduled a field investigation and conference which will be held at the site of the subject bridge on Tuesday, September 25, 1990 at 10:30 a.m.

Please arrange to have a representative present.

Very truly yours,

David T. Wilhelm, P.E.
Rail Safety Division
Bureau of Safety and Compliance

DTW:11

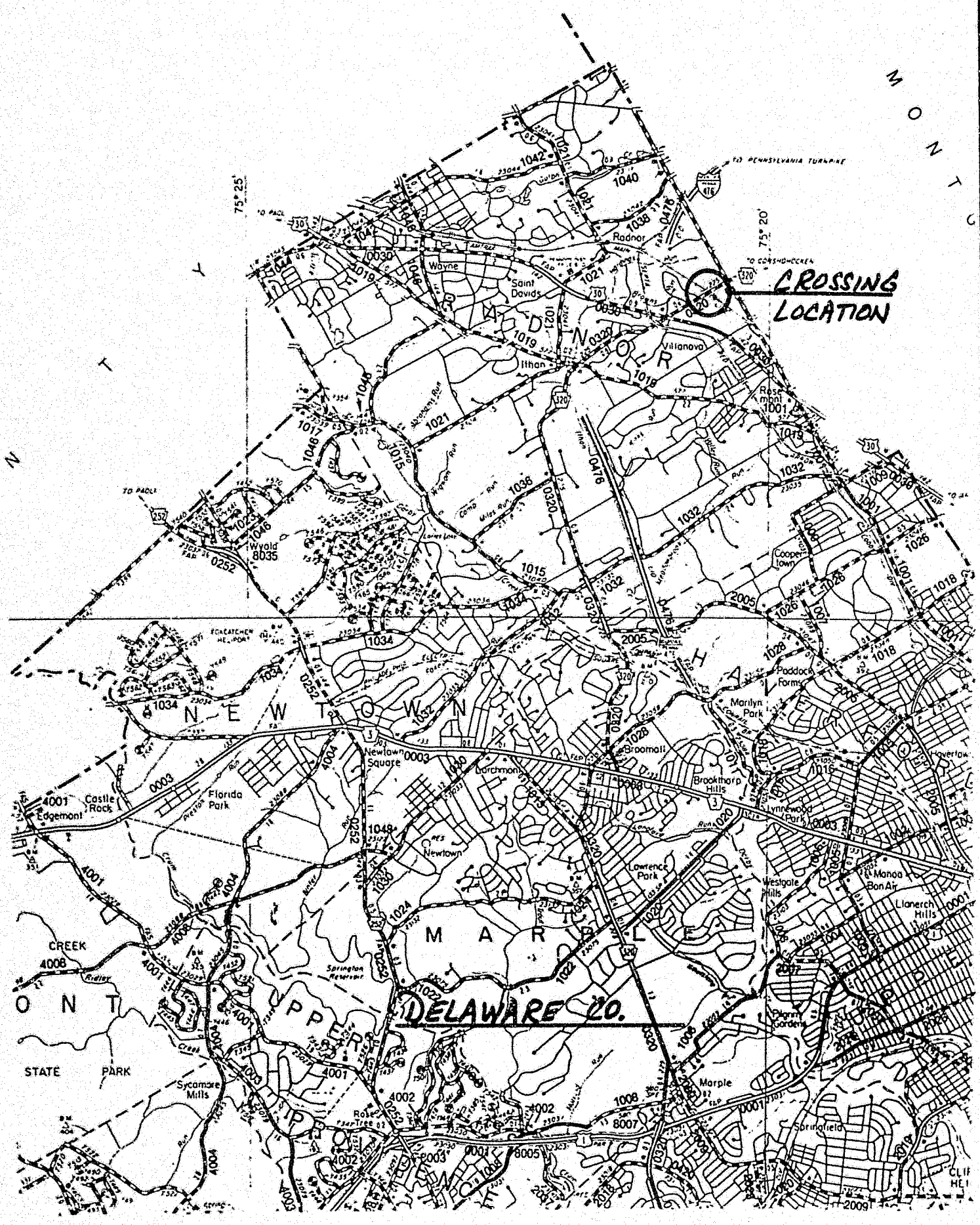

**CROSSING
LOCATION**

DELAWARE CO.

SIMILAR LETTER LIST

C-80011839

Mr. William D. Pickering, P.E., Chief
Right-of-Way and Utility Division
Pennsylvania Department of Transportation
509 Transportation and Safety Building
Harrisburg, PA 17120

AT&T Communications
Room A-360
3033 Chain Bridge Road
Oakton, VA 22185

Mr. Richard Cooper
National Railroad Passenger Corporation
6th Floor
2000 Market Street
Philadelphia, PA 19103

Mr. Harry Lupia, Deputy Chief Engineer
Southeastern Pennsylvania Transportation Authority
200 West Wyoming Avenue
Philadelphia, PA 19140

Mr. J. D. Cossel, Chief Engineer
Design and Construction
Consolidated Rail Corporation
15 North 32nd Street
Philadelphia, PA 19104

Mr. Robert M. Crofford, Manager
Radnor Township
301 Iven Avenue
Wayne, PA 19087

Ms. Joyce A. Lamont, County Clerk
Delaware County Commissioners
Government Center Building
Media, PA 19063

Mr. Edward J. Kennedy, Vice President
Regulatory and Government Center
The Bell Telephone Company of Pennsylvania
315 North Second Street
Harrisburg, PA 17101

Mr. Edward G. Bauer, Jr., Vice President
Philadelphia Electric Company
2301 Market Street
Philadelphia, PA 19101

Philadelphia Suburban Water Company
762 Lancaster Avenue
Bryn Mawr, PA 19010

C-80011839

S + C.
R.R. Section

**BUREAU OF
S & C**

SEP 14 1990

General Assembly of the Commonwealth
of Pennsylvania - Act 176

**RAIL SAFETY
DIVISION**

Date September 6, 1990

Case No. 9-959L

Commonwealth of Pennsylvania
Department of Transportation

Mr. Jerry Rich, Secretary
Public Utility Commission

Harrisburg, Pa. 17120

RECEIVED

SEP 17 1990

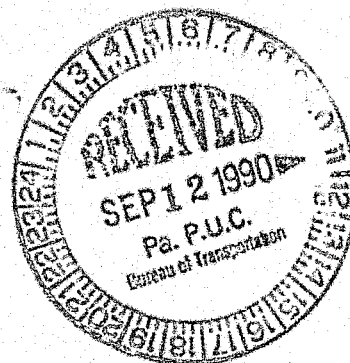

The above case number has been assigned to your request on the following location:

Spring Mill Road, Radnor Township, Delaware County

dated: August 16, 1990

We do not have facilities in your proposed work area at the location stated above. If you have further questions please feel free to call on 1-800-526-1515.

This reply is strictly in regard to AT&T facilities.

J. J. Shevenock
J. J. Shevenock

Supervisor
125 Porter Rd.
Pottstown, PA 19464

DOCUMENTED

SEP 23 1990

DOCUMENT
FOLDER

Wilhelm

BUREAU OF
S & C

DEC 17 1990



December 10, 1990 RAIL SAFETY
DIVISION

Southeastern Pennsylvania
Transportation Authority

Commonwealth of Pennsylvania
Pennsylvania Public Utility Commission
P.O. Box 3265
Harrisburgh, PA 17120

ATTN: David T. Wilhelm, P.E.
Rail Safety Division
Bureau of Safety and Compliance

RE: C-80011839
S.R. 320 Spring Mill Road
OH AMTRAK, Radnor Township,
Delaware County

Dear Mr. Wilhelm:

During the field investigation and conference held at Villanova Station on September 25, 1990 for the replacement of the bridge carrying Spring Mill Road (S.R. 320) over the tracks of AMTRAK in Radnor Township, Delaware County, SEPTA took exception to the proceedings because of possible ramifications caused by the tunnel flooding. Based on previous occurrences, students, SEPTA patrons, and university employees used the bridge (without sidewalks) to gain access across AMTRAK when the pedestrian tunnel under AMTRAK flooded. During the replacement of the bridge, there will be no means of obtaining access across AMTRAK in case the pedestrian tunnel floods. SEPTA is extremely concerned about the number of people who will gain access across the tracks by walking around the inner-track fence, through the inner-track fence or over the inner-track fence and the possibility of those people being injured or killed.

SECRETED
DEC 19 1990

DOCUMENT
FOLDER

Commonwealth of Pennsylvania
Page 2
December 10, 1990

Per PUC order C-80011839, effective December 17, 1982, AMTRAK was directed to, at its sole cost and expense, maintain the pedestrian tunnel in a safe and satisfactory condition. Because of the AMTRAK/SEPTA Station Lease Agreement, SEPTA inherited the responsibility of station maintenance as of January 1, 1983 and have maintained and upgraded the drainage system in the pedestrian tunnel over the past seven years. SEPTA, therefore withdraws its objection to the proceedings.

If there are questions or there is need for discussion, please contact me at (215) 580-4137.

Very truly yours,

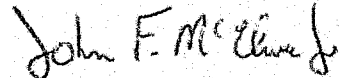

John F. McElwee, Jr.
Plant Engineering/Facilities

JFM/mm

cc: J. Ottinger (PADOT)